

PART #	DESCRIPTION
57810CP	07-UP FJ/03-UP 4 RUNNER 0-3" <a href="#">REAR 2.5 VS RR CDCV PAIR</a>

COMPONENTS INCLUDED	
(1) 154969C 07+ FJ/03+ 4RUNNER 0-3" REAR 2.5 RR CDCV (DRVR) (1) 154969C 07+ FJ/03+ 4RUNNER 0-3" REAR 2.5 RR CDCV (PASS)	(2) 611007 9/16" MED DUTY STEM BUSHING KIT (1) 611051 #40 2 1/16-3" HOSE CLAMP KIT (4) (2) 250002 7.50 UNIVERSAL RESI MT PLATE
HARDWARE INCLUDED	
(1) 605033 #14-14 X .750 HWH SELF DRILL SCREW CZINC (2) 605131 3/8 SPLIT LOCK WASHER	(2) 605934 #12 (3/4) ADEL CLAMP (2) 605144 3/8-12 X .750 FLANGED SELF TAP BOLT
611007 HARDWARE KIT	
(2) MED DUTY 9/16" ID STEM BUSHING (1) MED DUTY 9/16" ID STEM WASHER	(1) MED DUTY 12MM ID STEM WASHER (1) M12-1.25 LOCK NUT
611051 HARDWARE KIT	
(4) 605931 1/2 X 2 1/16-3" ID #40 SS HOSE CLAMP	
TOOLS REQUIRED	
JACK JACK STANDS DRILL CENTER PUNCH 21/64 DRILL BIT LOCKING PLIERS TORQUE WRENCH	8MM NUT DRIVER 3/8" SOCKET (FOR IMPACT DRIVER) 10MM SOCKET / WRENCH 14MM SOCKET / WRENCH 15MM SOCKET / WRENCH 17MM SOCKET / WRENCH 19MM SOCKET / WRENCH
TECH NOTES	
1. YOUR ICON SHOCK ASSEMBLIES COME FACTORY CHARGED TO 150 PSI. RELEASING NITROGEN PRESSURE MAY LEAD TO SHOCK MALFUNCTION AND REDUCED RIDE QUALITY. FAILURE CAUSED BY LOW NITROGEN PRESSURE IS NOT COVERED UNDER ICON'S WARRANTY POLICY.	
2. DRIVER AND PASSENGER SHOCKS DIFFER ONLY BY RESERVOIR STICKER ORIENTATION	



WARNING!
<b>** READ ALL INSTRUCTIONS THOROUGHLY FROM START TO FINISH BEFORE BEGINNING INSTALLATION! IF THESE INSTRUCTIONS ARE NOT PROPERLY FOLLOWED SEVERE FRAME, SUSPENSION AND TIRE DAMAGE MAY RESULT TO THE VEHICLE!</b>
<b>** ICON VEHICLE DYNAMICS RECOMMENDS THAT YOU EXERCISE EXTREME CAUTION WHEN WORKING UNDER A VEHICLE THAT IS SUPPORTED WITH JACK STANDS.</b>
<b>** ICON VEHICLE DYNAMICS RECOMMENDS ALL INSTALLTION TO BE PERFORMED BY A PROFESSIONAL SHOP/SERVICE TECHNICIAN. PRODUCT FAILURE CAUSED BY IMPROPER INSTALLATION WILL NOT BE COVERED UNDER ICON'S WARRANTY POLICY.</b>

## INSTALLATION

- Using a properly rated jack, raise the rear of the vehicle and support the frame rails with jack stands. Ensure the jack stands are secure and set properly before lowering the jack. NEVER WORK UNDER AN UNSUPPORTED VEHICLE. Remove the rear wheels.
- Place a floor jack under the axle housing and slightly raise the jack to remove tension from the shock. Loosen and remove the lower shock bolt using a 17mm socket/wrench. Make sure the axle is well supported, then remove the stem bushing nut and upper stem bushings using a 17mm socket/wrench.
- Remove the rear shock.
- Install the lower shock mount as follows: shock spacer, shock rod end, shock spacer, shin guard (56100)\*, factory stud bolt. [Torque to factory spec] \*(56100 shin guard optional) **NOTE:** If factory shock mount has been deformed, sand slightly to allow for proper spacer fitment.
- Use a jack to raise the axle housing far enough to guide the shock stem into position in the factory shock mount. Install stem hardware as seen in diagram. Use a 19mm socket/wrench to install the lock nut until lock is engaged. Do not overtighten bushing assembly as this can lead to premature bushing wear. Failure caused by incorrect installation of bushings is not covered under ICON's warranty policy.

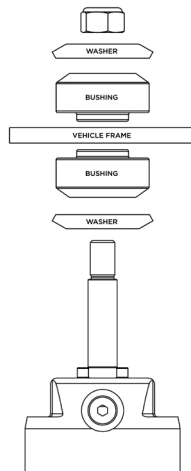

6. Use a 10mm socket/wrench to remove the (4) bolts and rivet clip that holds the driver side mud flap in place. Remove mud flap.
7. Reservoir hose should be oriented towards the rear of the vehicle. Mount the remote reservoir to the reservoir mount plate (250002) using the provided (605931) hose clamps. Be sure to install the hose clamp to the ends of the reservoir within the machined areas on the outer surface of the remote reservoir.
8. Orient the reservoir mounting bracket on frame rail forward of the body mount and mark center of the hole. The remote reservoir and bracket should not come in contact with any part of the frame or frame brackets. The reservoir bracket bolt can be measured to within the following approximate dimensions: 2" up from the bottom of the frame rail and 4" forward of the body mount. (FIGURE 1)

FIG.1



9. Using the hole in the bracket as a guide, center punch and drill to 21/64".
10. Use a 9/16" socket/wrench to thread the supplied (605144) self tap bolt into the frame rail, minimum 2 full rotations.
11. Remove the (605144) self tap bolt and secure remote reservoir bracket. [Torque to 30ft-lbs]
12. Place reservoir in the reservoir mounting bracket with the ICON shield logo oriented up into the fender well and secure reservoir with the supplied (605931) hose clamps using an 8mm nut driver. (FIGURE 2)

FIG.2



FIG.3



13. Install the supplied (605934) adel clamp at the center of the remote reservoir hose in the fender well. Use a 3/8" socket to drive the #14 self drill/tap screw (605033) and secure adel clamp to the pinch weld above the frame in the wheel well. (FIGURE 3)
14. Use a 10mm socket/wrench to reinstall the mud flap and rivet clip.
15. Repeat steps 2-14 on opposite side.
16. Install wheels and lower vehicle back to the ground. [Torque to factory spec]

**VERIFY ALL FASTENERS ARE PROPERLY TORQUED BEFORE DRIVING VEHICLE.**

**RETORQUE ALL NUTS, BOLTS AND LUGS AFTER 100 MILES AND PERIODICALLY THEREAFTER.**