

PART #	DESCRIPTION
56514	96-02 4RUNNER 0-2" REAR 2.0 VS NR

COMPONENTS INCLUDED	
(1) 154928 96-02 4RUNNER 0-2" REAR 2.0 NR	(1) 611007 STEM BUSHING HARDWARE KIT
HARDWARE INCLUDED	
611007 HARDWARE KIT	
(2) MED DUTY 9/16" ID STEM BUSHING (1) MED DUTY 9/16" ID STEM WASHER	(1) MED DUTY 12MM ID STEM WASHER (1) M12 - 1.25 NYLOCK NUT
TOOLS REQUIRED	
JACK JACK STANDS TORQUE WRENCH	14MM SOCKET / WRENCH 17MM SOCKET / WRENCH 19MM SOCKET / WRENCH
TECH NOTES	
<p>1. YOUR NEW SHOCK ASSEMBLIES COME CHARGED WITH THE CORRECT AMOUNT OF NITROGEN (150PSI). DO NOT RELEASE PRESSURE FROM THE CHARGE PORT, AS THIS CAN CAUSE THE SHOCK TO MALFUNCTION.</p>	



WARNING!
<p>** READ ALL INSTRUCTIONS THOROUGHLY FROM START TO FINISH BEFORE BEGINNING INSTALLATION! IF THESE INSTRUCTIONS ARE NOT PROPERLY FOLLOWED SEVERE FRAME, SUSPENSION AND TIRE DAMAGE MAY RESULT TO THE VEHICLE!</p> <p>** ICON VEHICLE DYNAMICS RECOMMENDS THAT YOU EXERCISE EXTREME CAUTION WHEN WORKING UNDER A VEHICLE THAT IS SUPPORTED WITH JACK STANDS.</p>

INSTALLATION

- Using a properly rated jack, raise the rear of the vehicle and support the frame rails with jack stands. Ensure the jack stands are secure and set properly before lowering the jack. NEVER WORK UNDER AN UNSUPPORTED VEHICLE. Remove the rear wheels.
 - Place a floor jack under the axle housing and slightly raise the jack to remove tension from the shock. Loosen and remove the lower shock bolt using a 17mm socket/wrench. Make sure the axle is well supported, then remove the stem bushing nut and upper stem bushings using a 17mm socket/wrench.
- NOTE:** There is a stock washer on either side of the rubber bushings. One comes off with the mounting bolt and one is on the stud. These washers will be reused. Note direction as they should be cupped away from the bushing to allow free articulation of the shock.
- Remove the rear shock.
 - Apply grease to the inner and sides of the ICON shock eye bushings and to the shank of the mounting stud.
 - Install the lower shock mount in the factory location and reinstall the factory shock bolt, washers, and nut using a 17mm socket/wrench. [Torque to factory spec]
 - Install stem hardware as seen in diagram. Install the lock nut until lock is engaged. Do not overtighten bushing assembly as this can lead to premature bushing wear. Failure caused by incorrect installation of bushings is not covered under ICON's warranty policy.
 - Install wheels and lower vehicle back to the ground. [Torque to factory spec]

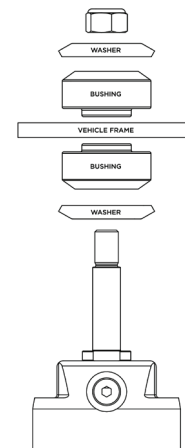

VERIFY ALL FASTENERS ARE PROPERLY TORQUED BEFORE DRIVING VEHICLE.

RETORQUE ALL NUTS, BOLTS AND LUGS AFTER 100 MILES AND PERIODICALLY THEREAFTER.