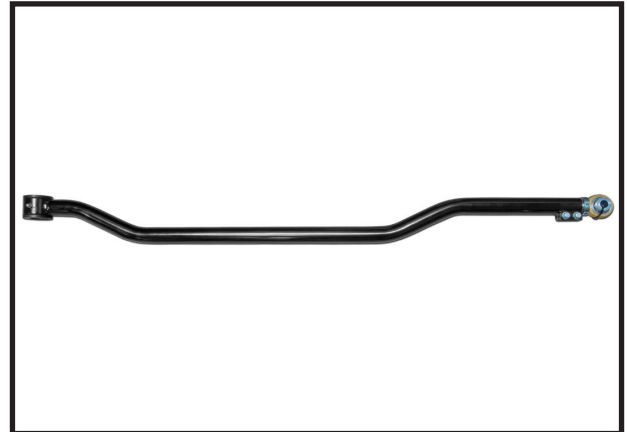

PART #	DESCRIPTION
21025	07-UP JEEP WRANGLER JK <u>ADJUSTABLE REAR TRACK BAR</u>

COMPONENTS INCLUDED	
(1) 124003 JK REAR ADJUSTABLE TRACK BAR (1) 157520 L-R ADJUSTER SLEEVE (2) 217200 HEIM SPACER .565 X 1.625 (1) 219006 SLEEVE 1.000 X 14MM X 1.625	(1) 295511 JM12T ROD END (2) 297027 URETHANE BUSHING (1) 297036 URETHANE LOAD RING
HARDWARE INCLUDED	
(2) 605145 3/8-16 X 1.000 12 PT BOLT	(1) 605902 1/4-28 STRAIGHT ZERK FITTING
TOOLS REQUIRED	
TORQUE WRENCH CUTTING WHEEL (IF NECESSARY) BLACK SPRAY PAINT (IF NECESSARY)	21MM SOCKET / WRENCH 5/16" SOCKET / WRENCH 3/8" SOCKET WRENCH
TECH NOTES	
1. If used with the stock track bar bracket, trimming is required.	

**WARNING!**

**\*\* READ ALL INSTRUCTIONS THOROUGHLY FROM START TO FINISH BEFORE BEGINNING INSTALLATION! IF THESE INSTRUCTIONS ARE NOT PROPERLY FOLLOWED SEVERE FRAME, SUSPENSION AND TIRE DAMAGE MAY RESULT TO THE VEHICLE!**

**\*\* ICON VEHICLE DYNAMICS RECOMMENDS THAT YOU EXERCISE EXTREME CAUTION WHEN WORKING UNDER A VEHICLE THAT IS SUPPORTED WITH JACK STANDS.**

**BEGIN INSTALLATION**

1. Remove the stock track bar from the frame and axle using (2) 21mm. Vehicle may shift slightly.
2. Hand grease bushings prior to installing. When greasing bushings, try to fill all bushing veins with grease, with minimal grease on outside and inside surfaces. Also lightly grease inside rim and both ends of bushing. Lightly grease support ring. Push bushing into bushing housing, then turn over and put support ring in, then push the second bushing in. Lightly grease 1 end of the bushing sleeve and push in until flush with bushings (FIG. 1). **FAILURE TO INSTALL LOAD RING WILL CAUSE DAMAGE TO THE BUSHINGS AND EXCESSIVE PLAY IN THE STEERING.**

FIG.1

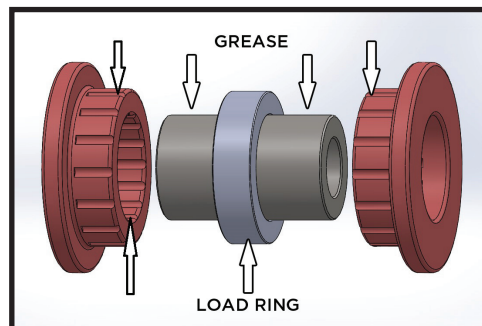

3. Install the supplied grease fitting into the bushing housing using a 5/16" [Tighten only until snug].
4. Using factory hardware, install the rear track bar using a 21mm [Torque to factory spec].
5. If installing in factory mount, the track bar bracket will need to be cleared. Some cutting is required (FIG. 2).

FIG.2

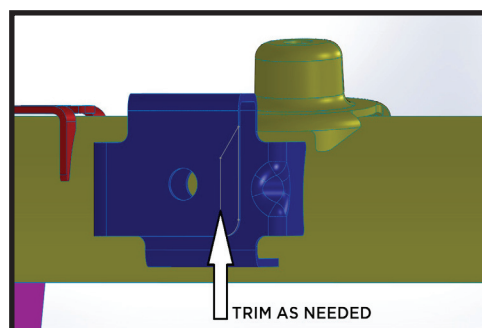

**6.** Paint exposed metal after trimming.

**7.** The rear track bar features a left/right adjusting collar for on vehicle adjustment. The adjustable end goes towards the axle using the factory hardware. The bend goes toward the rear, allowing for coil and differential clearance.

**8.** Once installed, the track bar can be adjusted to center the axle under the jeep. Loosen the pinch bolts using a 3/8" 12pt. Turn collar to desired length. Line up the slit in the collar with the slit in the tube and alternate tightening of pinch bolts [Torque pinch bolts to 35 ft-lbs].

***VERIFY ALL FASTENERS ARE PROPERLY TORQUED BEFORE DRIVING VEHICLE.***

***RETORQUE ALL NUTS, BOLTS AND LUGS AFTER 100 MILES AND PERIODICALLY THEREAFTER.***