

JEEP WRANGLER – REAR MUD GUARD INSTALLATION INSTRUCTIONS

Please read instructions thoroughly before installation.

Tools Required

- Short Phillips screwdriver
- Drill / 1/8" drill bit

Package Contents

- Driver & passenger side rear mud guard
- #10 SEM Screws (qty. 8)
- Instruction sheet

MUD GUARD INSTALLATION

NOTE: *It may be necessary to remove the wheels before mud guard installation.*

1. Using the mud guard as a template, mark and drill 1/8" holes at locations A, B, C and D (see Figure 1).
2. Install #10 SEM Screws at locations A, B, C and D. Check Mud Guard fit and alignment before tightening.

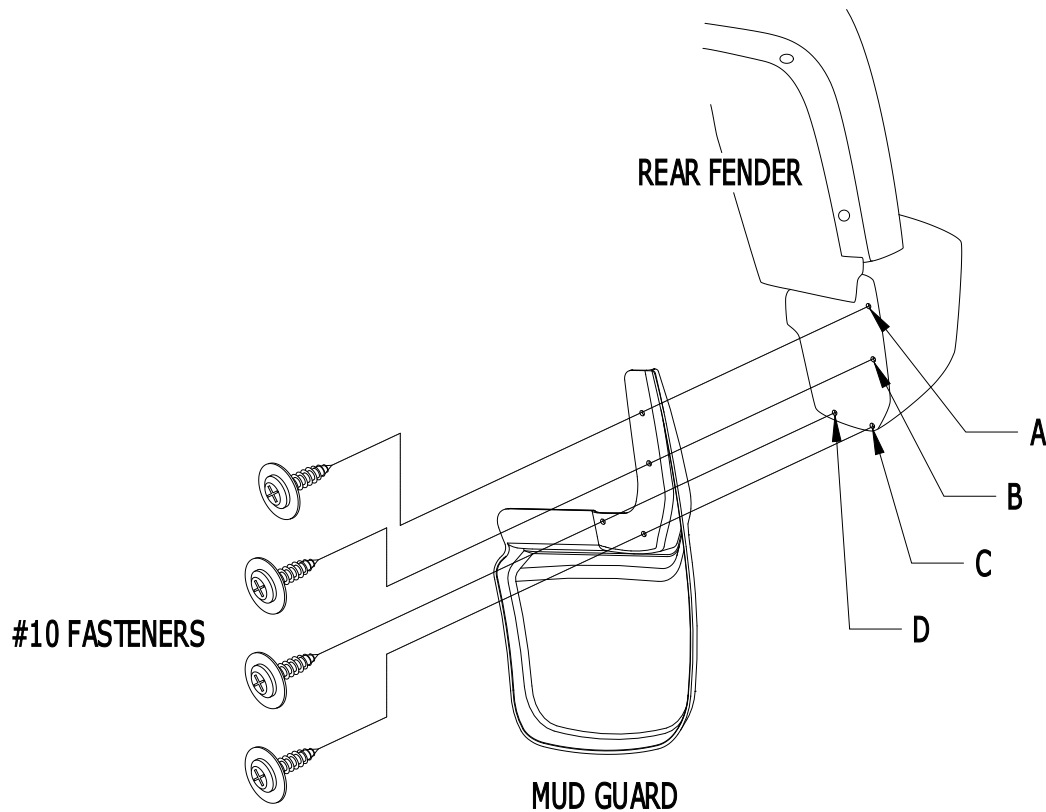

Figure A

PAINTING INSTRUCTIONS

1. Clean mud guard with soap and water to remove dirt and other contaminants.
2. Sand painting surface with 320 grit sand paper.
3. Apply a coating of flexible primer-adhesion promoter.
4. Apply a flexible paint as directed by the paint manufacturer.