



# Xact CONTOUR™

## CARE AND USE INSTRUCTIONS – PN:53321

---

Thank you for selecting Xact Contour™ Front Floor Liners from Winfield Consumer Products. Your new front floor liners are custom molded to fit your specific vehicle's floor board. The liners are made to take the place of your factory floor mats. ***For correct fit, it is necessary to remove the factory floor mats before installing your new floor liners.*** However, do not remove the factory-installed carpeting.

Your liners are made from an engineering resin that is lightweight and extremely tough and durable. The easiest way to clean your liners is with a damp cloth or sponge and soap and water. Windex®, 409® and ArmorAll® type cleaners work as well.



LEFT OR DRIVER

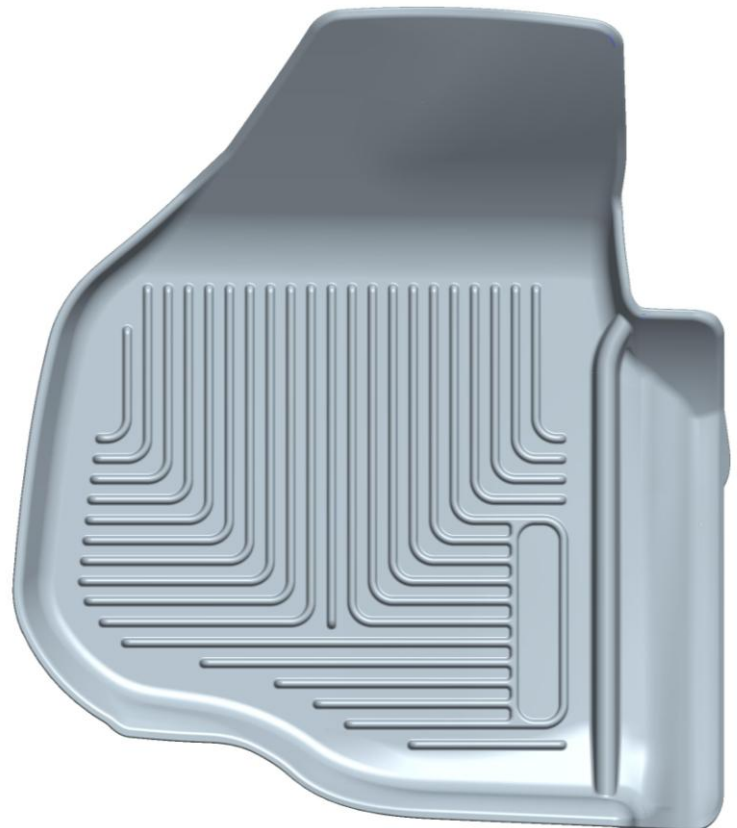

RIGHT OR PASSENGER

\*Attn: 2012 Super Duty owners: Please see reverse side of page for information regarding foot rest added mid-Year that may affect the fit of your liner.



**BELOW IS A PHOTO OF THE FOOT REST ADDED MID-YEAR TO THE 2012 SUPER DUTY. IF YOUR TRUCK DOES NOT HAVE THIS FEATURE, YOU WILL NEED PART #53301 FOR THE PROPER FITMENT.**

