

HUSKY Hitch Mount Bicycle Carrier Instructions (2 or 4 Bikes)



HUSKY
TOWING PRODUCTS

Tools required:

- 17mm open wrench or socket
- 19mm open wrench or socket
- 24mm open wrench or socket

Refer to Figure 1 to reference the items in the following parts tables.

Part#	Description	Qty
1	Draw Bar	1
2	Hinge Bracket	1
3	Center Tube	1
4	M16X80 Bolt	1
5	M16 Nut	1
6	Pin	1
7	Clip	1
8	M12X80 Bolt	2

Part#	Description	Qty
9	M12 Nut	2
10	Elbow	1
11	2-Bike Extension	1*
12	M10X65 Bolt	1 (2*)
13	M10 Nut	1 (2*)
14	Clamping Plate	1 (2*)
15	Threaded Knob	1 (2*)
16	Reflector	1

* — Asterisk indicates hardware quantity for the 4-bike carrier kit.

1. Install the hinge bracket (Part# 2) to the draw bar (Part# 1) using the M16x80 bolt (Part# 4) with the M16 nut (Part# 5).
Note: Do not over-tighten the nut, so that it does not bind the hinge bracket and prevent the carrier from rotating normally when fully assembled.
2. Insert the pin (Part# 6) through the hinge bracket and the draw bar, using the clip (Part# 7) to secure it.
3. Insert the center tube (Part# 3) into the hinge bracket (Part# 2), securing it with the M12x80 bolts (Part# 8) and the M12 nuts (Part# 9).
4. Mount the elbow (Part# 10) onto the center tube (Part# 3), securing it with the M10x65 bolt (Part# 12) and the M10 nut (Part# 13).
5. **[If assembling a 4-bike carrier kit]** Mount the 2-bike extension (Part# 11) to the elbow, securing it with an M10x65 bolt (Part# 12) and an M10 nut (Part# 13).
6. Fasten the clamping plate (Part# 14) to the mating clamping plate welded to the elbow **(and the 2-bike extension, if applicable)** (Part# 10), using the threaded knob (Part# 15).
7. Snap the reflector (Part# 16) into place on the end of the elbow **(or the 2-bike extension, if applicable)**.

The hitch mounted carrier rack is now assembled. The hitch mount can be rotated downward for access to the rear of your vehicle by removing the clip and pin.

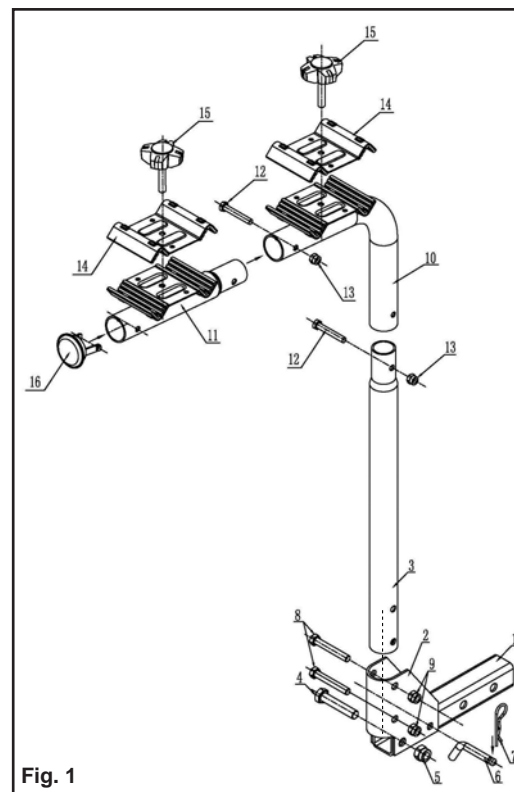

Fig. 1