



# Assembly, Installation, Operation and Maintenance Instructions

**P/N: 33056**

## GM 5<sup>TH</sup> WHEEL ADAPTOR

<b>Dealer / Installer:</b>	Provide a copy of these Instructions to the end user of this product. These Instructions provide important operating and safety information for proper usage of this product. Demonstrate the proper use of the product with the end user. Have the end user demonstrate that they understand the proper use of the product.
<b>End User:</b>	Read and follow all instructions included in this manual. Ask your Dealer / Installer for assistance if you do not understand the proper use of the product. Never remove any decals from the product.

**APPLICATION: GM 2016 to Current.**  
Vehicle must have OEM 5<sup>th</sup> wheel/Gooseneck Hitch Prep Package

### **This kit is to be used with Husky 5<sup>TH</sup> Wheel Kits:**

31664 (HUSKY 16KS / CROSSMEMBER WITH HUSKY 16K UPRIGHTS)  
32354 (HUSKY 16KS / CROSSMEMBER WITH HUSKY 16K ROLLER)  
31665 (HUSKY 16KS / CROSSMEMBER WITH HUSKY 16K GLIDER)  
31313 & 31314 (HUSKY 16KS / CROSSMEMBER WITH HUSKY 16K UPRIGHTS)  
31313 & 32220 (HUSKY 16KS / CROSSMEMBER WITH HUSKY 16K ROLLER)  
31313 & 31196 (HUSKY 16KS / CROSSMEMBER WITH HUSKY 16K GLIDER)  
31666 (HUSKY 16KW / CROSSMEMBER WITH HUSKY 16K UPRIGHTS)  
32392 (HUSKY 16KW / CROSSMEMBER WITH HUSKY 16K ROLLER)  
31667 (HUSKY 16KW / CROSSMEMBER WITH HUSKY 16K GLIDER)  
31326 & 31314 (HUSKY 16KW / CROSSMEMBER WITH HUSKY 16K UPRIGHTS)  
31326 & 32220 (HUSKY 16KW / CROSSMEMBER WITH HUSKY 16K ROLLER)  
31326 & 31196 (HUSKY 16KW / CROSSMEMBER WITH HUSKY 16K GLIDER)

### **WARNING**

THE 33056 GM 5<sup>TH</sup> WHEEL ADAPTOR LIMITS ALL 5<sup>TH</sup> WHEEL CAPACITIES TO 16,000 LBS. GVWR AND 4,000 LBS. PIN WEIGHT OR LESS.  
**DO NOT EXCEED 16,000 LBS. FOR ANY 5<sup>TH</sup> WHEEL HITCH. DO NOT EXCEED VEHICLE TOWING LIMITS.**  
READ YOUR OWNERS MANUAL.

### **WARNING:**

If the truck is raised, be sure that the truck is properly blocked and restrained to prevent the truck from falling. Failure to do so may result in the truck suddenly falling, causing death or serious injury.

### **CAUTION:**

These instructions are guidelines only. Actual installation is the responsibility of the installer and the owner. Always measure truck and trailer before installing hitch to be sure that there is clearance at the cab and at the bumper to allow for turns.

### **WARNING**

Failure to follow ALL of these instructions may result in death or serious injury

### **WARNING**

This product is **NOT** to be used with rotating pin boxes or pin boxes that require a "wedge"; such as the REESE Sidewinder, REESE Revolution, 5<sup>th</sup> Airborne Sidewinder. Use of these products may damage this product and will void the warranty.

### **NOTICE**

Husky recommends to always drive the king pin into the hitch throat and not drop the king pin from above into the hitch head to avoid incorrect hook-ups. Please read Operating Instruction to understand how this important Safety Feature operates.

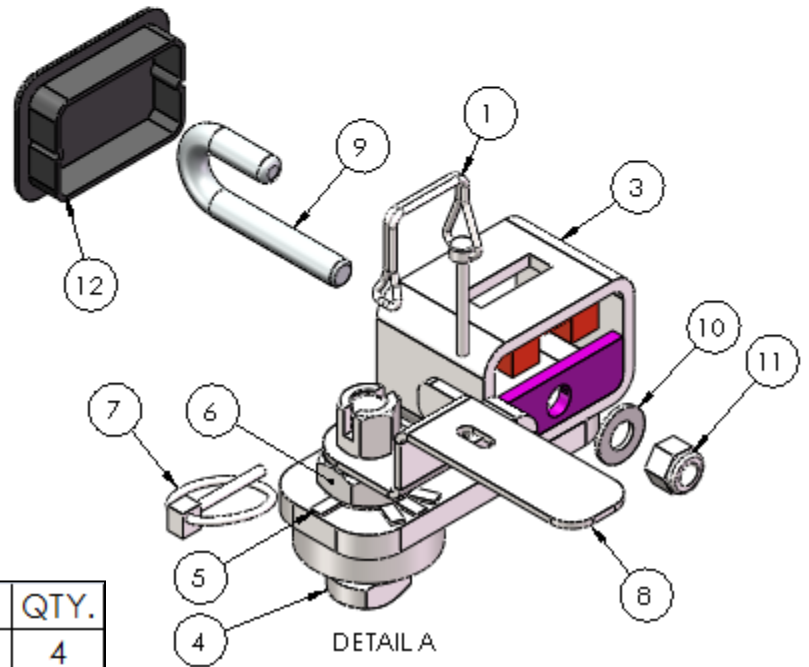
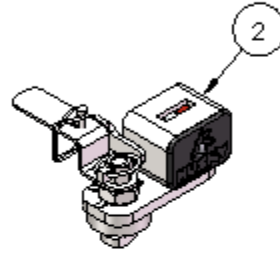
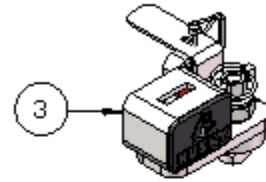
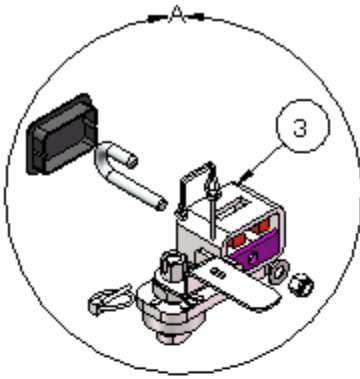

**Parts Diagram**

ITEM #	DESCRIPTION	QTY.
1	LOCK PIN	4
2	ADAPTER "A"	2
3	ADAPTER "B"	2
4	T BOLT	4
5	TAB WASHER	4
6	1"-14 HEX JAM NUT	4
7	3/16" SAFETY LOCK PIN WITH LOOP	4
8	HANDLE	4
9	FOOT HOOK	4
10	FLATWASHER 1/2	4
11	NYLON LOCK NUT, 1/2-13	4
12	TUBE END COVER	4

**TOOLS**  
 3/4" Socket & Open End Wrenches.  
 Torque Wrench capable of 75 ft.lbs.  
 1-1/2" Open end or adjustable wrench.  
 Flat blade screwdriver.

1. Place adapters into the 5<sup>th</sup> Wheel “Pucks” that were installed in your truck bed from the factory. The handles and T-bolts must be rotated into the Un-locked position as shown.

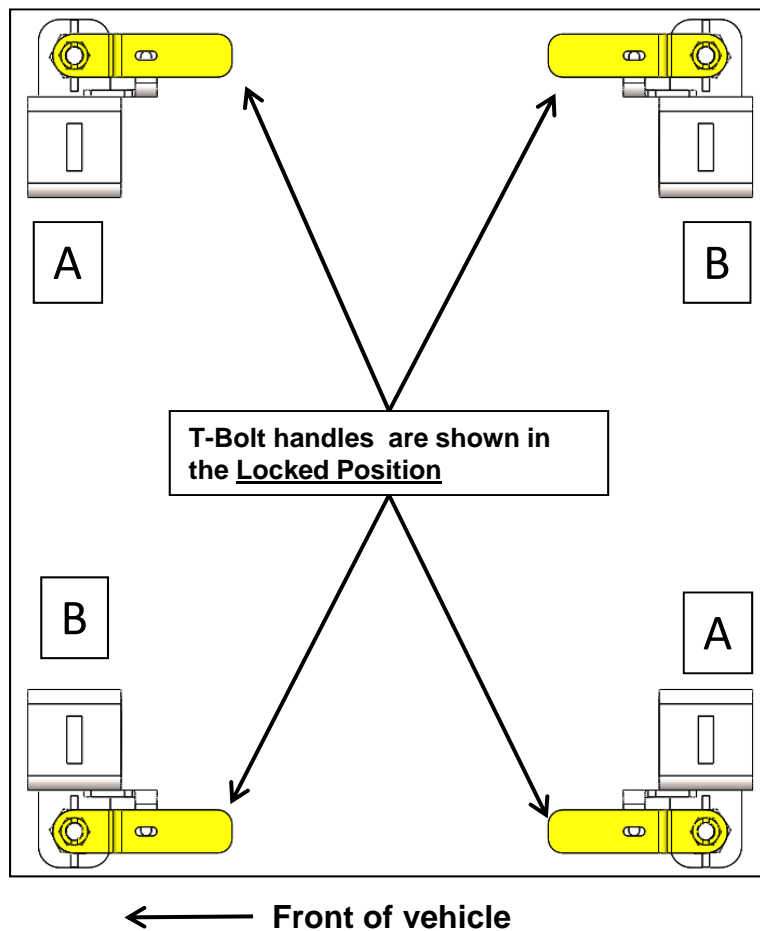
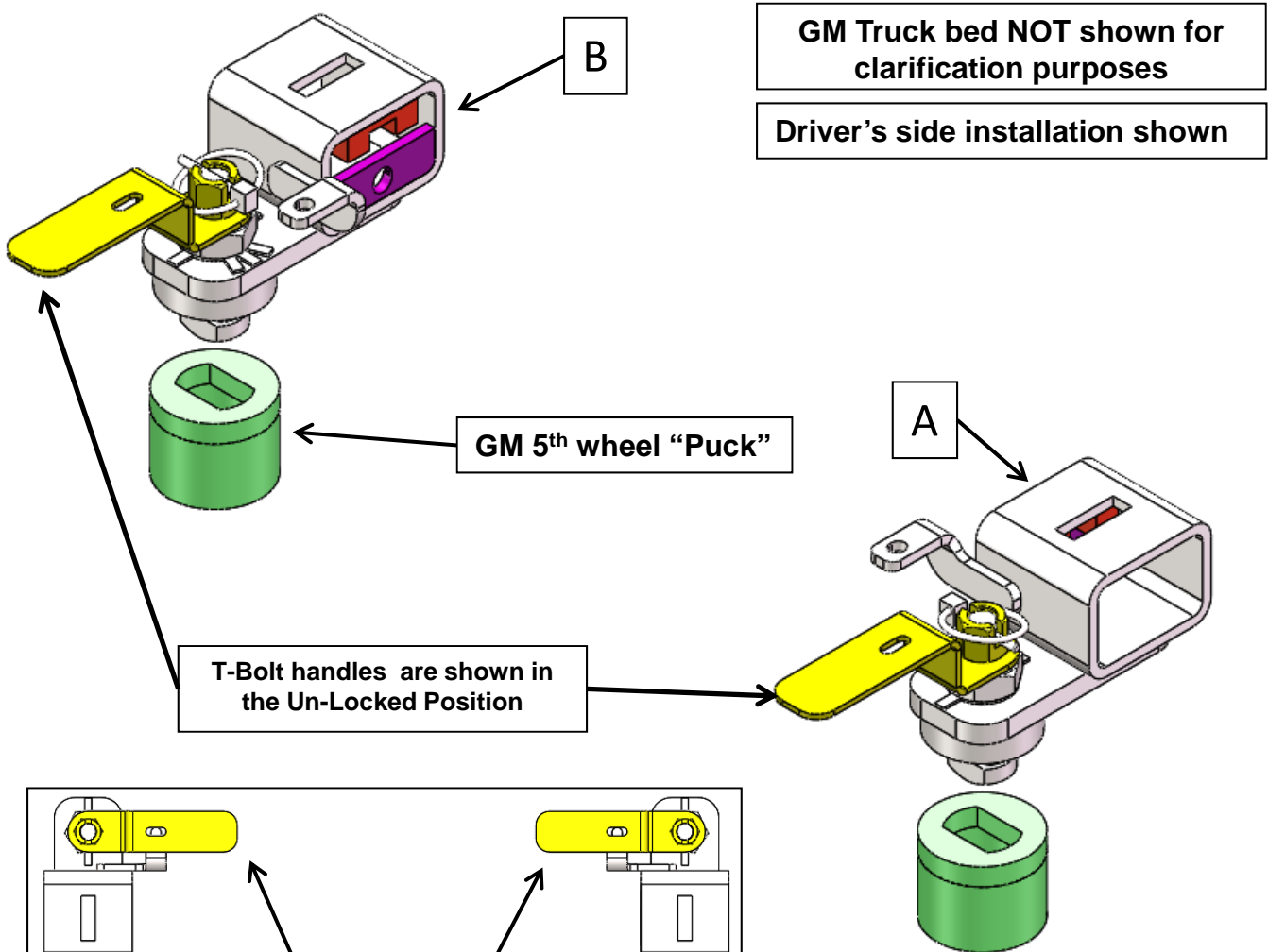

2. **NOTICE:** There are 2 different adapters, “A” and “B”. One each is used on the drivers side and one each on the passenger’s side. When installed properly and locked, the lock handles will face each other.
3. Once the Adaptors are installed; install safety lock pin thru the T-Bolt if not already installed, then turn handles into the locked position. This may require adjusting the 1” bolts on the T-bolts for a looser or tighter fit.

4. Install the uprights and cross member for your hitch into the adapters. Do not fully torque the bolts for the cross member at this time, only lightly snug them.
5. Install a "Foot Hook" , 1/2" Flat Washer and 1/2-13 Nylock Nut on each adapter as shown in the picture below. make sure the hook passes through the hole in the upright tab and is centered in the adapter guide slot. Torque the 1/2-13 Nylock Nuts to 50 ft lbs.

**NOTE: Husky brand uprights and cross member shown for illustration only. Your installation may be different.**

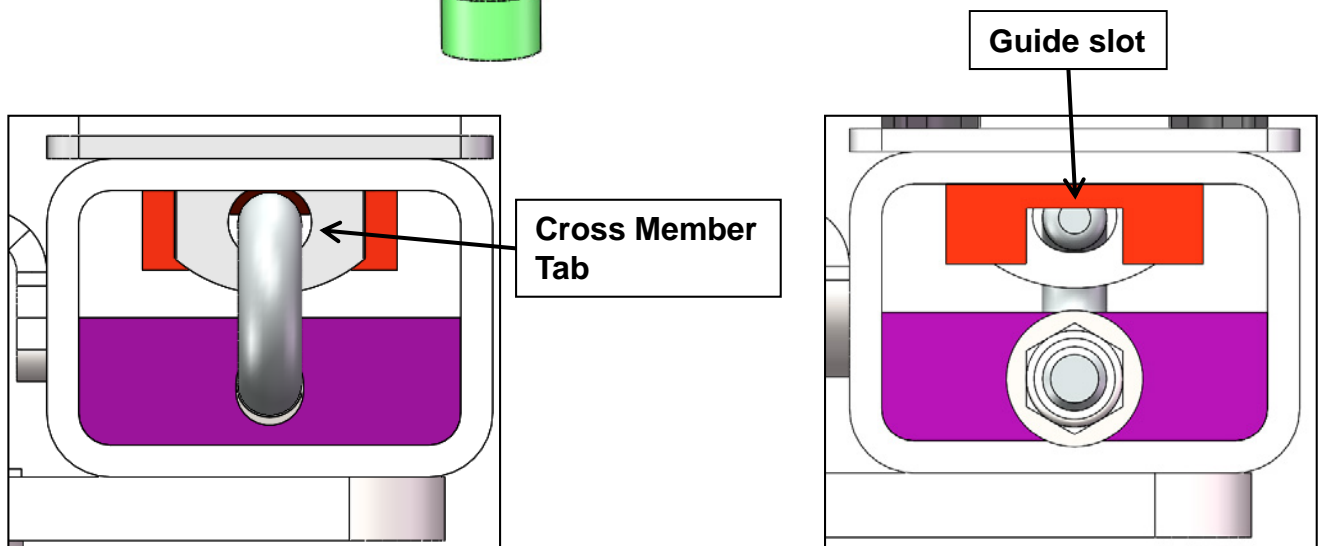
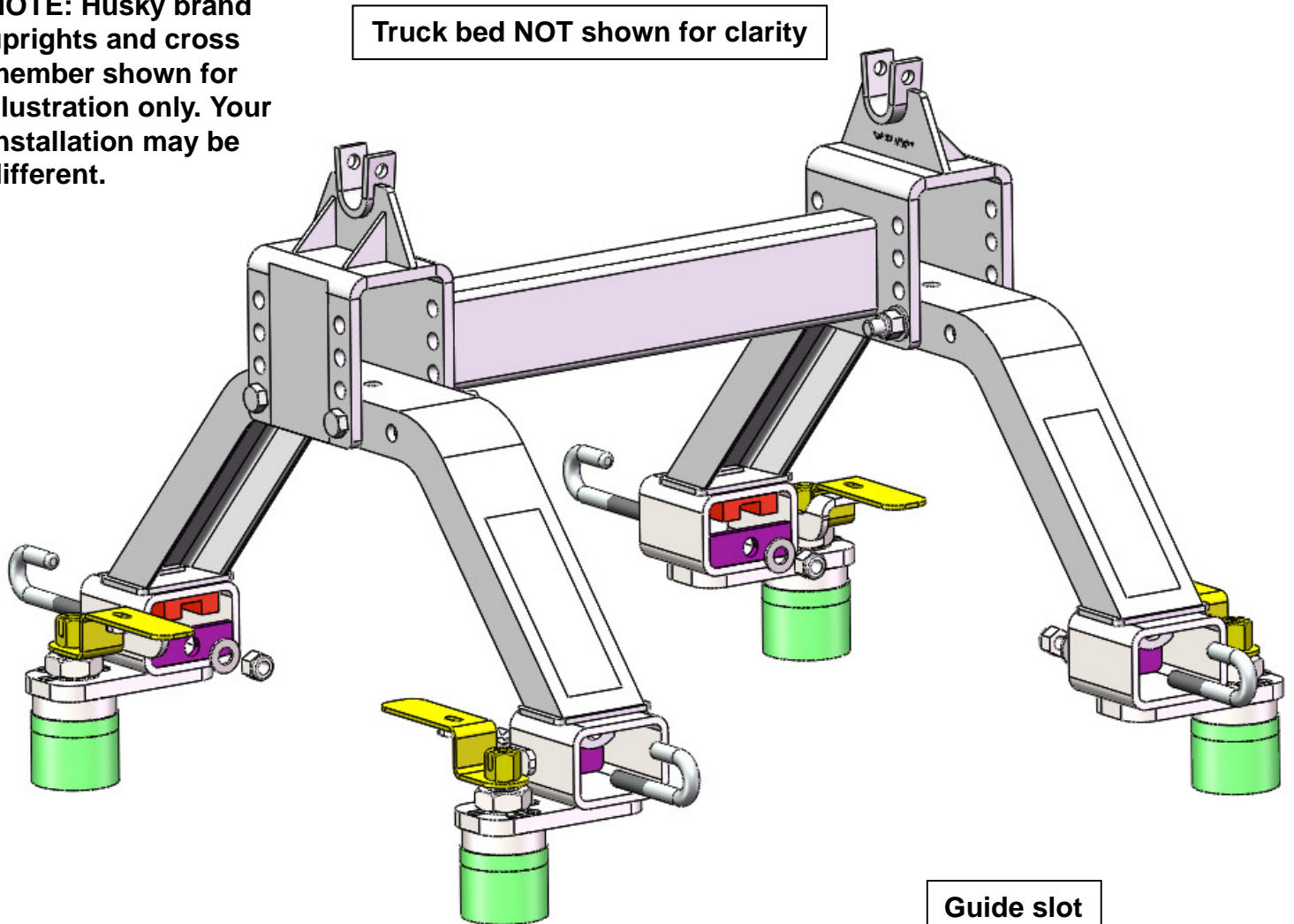

6. Looking from above, check that the uprights and cross member are square and parallel to the bed of the truck. Adjust and shim as necessary. When satisfied with the alignment, tighten the upright bolts per the manufacturer's instructions.
7. Rotate the handles to the locked and unlocked positions. All 4 handles should rotate easily. Check to be sure that the Adaptor does NOT "rock" back and forth easily and that the Adaptor Rails remain **FLAT** on the GM 5<sup>th</sup> wheel "pucks". If the handles do not rotate easily OR if the hitch assembly "rocks" and does not stay flat; adjust the T-bolts up or down by rotating them in the handles. We recommend you do this in half turn increments. This may take a few times to get adjusted correctly. All trucks are not made the same and require different amounts of adjustment. **Be PATIENT.**
8. Rotate handles to the unlocked position and remove the assembled Adaptors, uprights and cross member from the GM 5<sup>th</sup> wheel "pucks". **IF** the Adaptor does **NOT** remove easily; loosen the 1" jam nuts and adjust the Adaptor T-Bolts so that the assembled Adaptor removes easily. Re-tighten the 1" jam nuts.
9. Once the assembled Adaptor, uprights and crossover removes easily, the handles rotate easily **AND** there is no "rock" in the assembled Adaptor with the GM 5<sup>th</sup> Wheel "Pucks" you can tighten the 1" jam nuts with an adjustable wrench until tight.
10. Install a Tube End Cover on each foot as shown on the next page. You may tap them in place with a soft mallet if necessary.

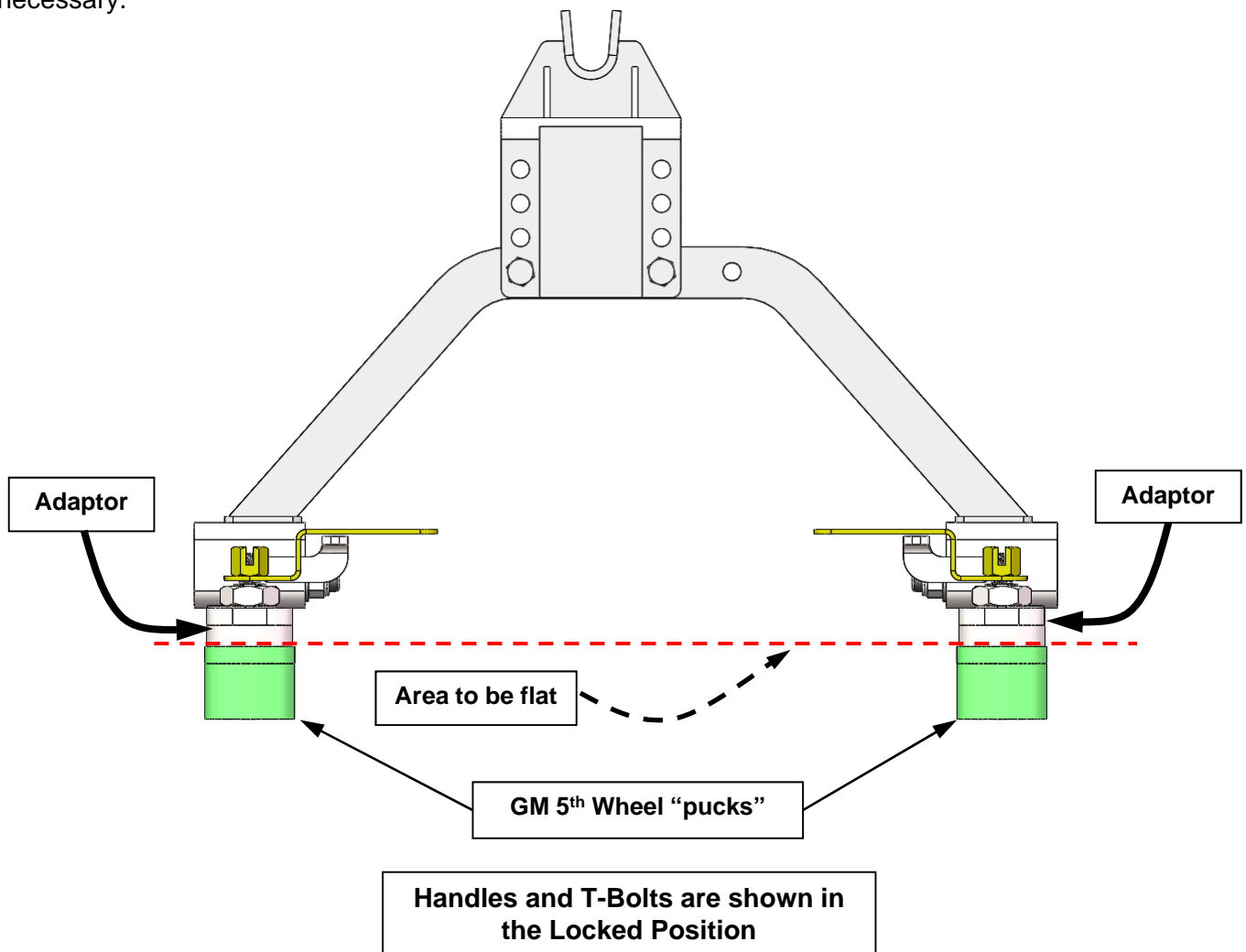

8. Bend 1 of the tabs on each of the tab washers up and against the side of the jam nut. This will keep the 1" jam nut from loosening.

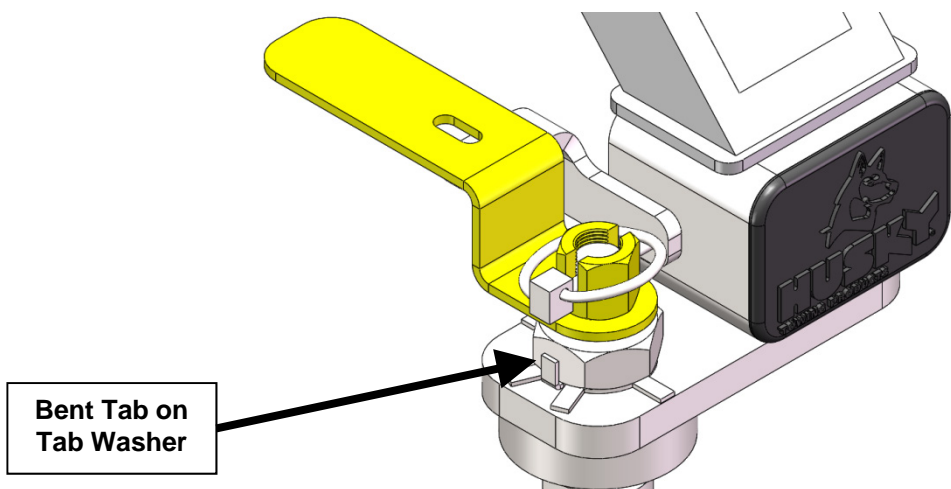

9. Finally, install the 3/16" D-Lock pins (or padlock) through the handles and the uprights.

**WARNING: NEVER TOW WITHOUT LOCKING THE 5<sup>TH</sup> WHEEL HITCH HANDLES WITH EITHER THE PROVIDED 3/16" D-LOCK PINS OR A PAD LOCK**

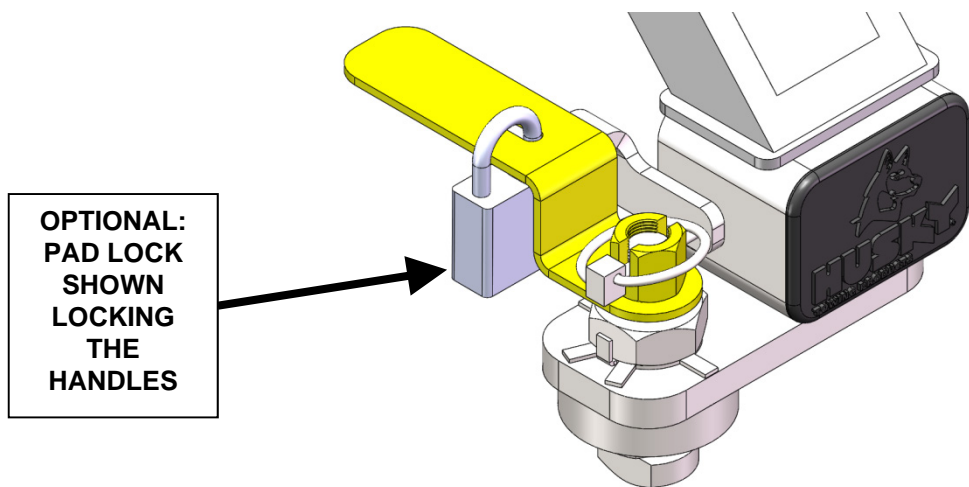
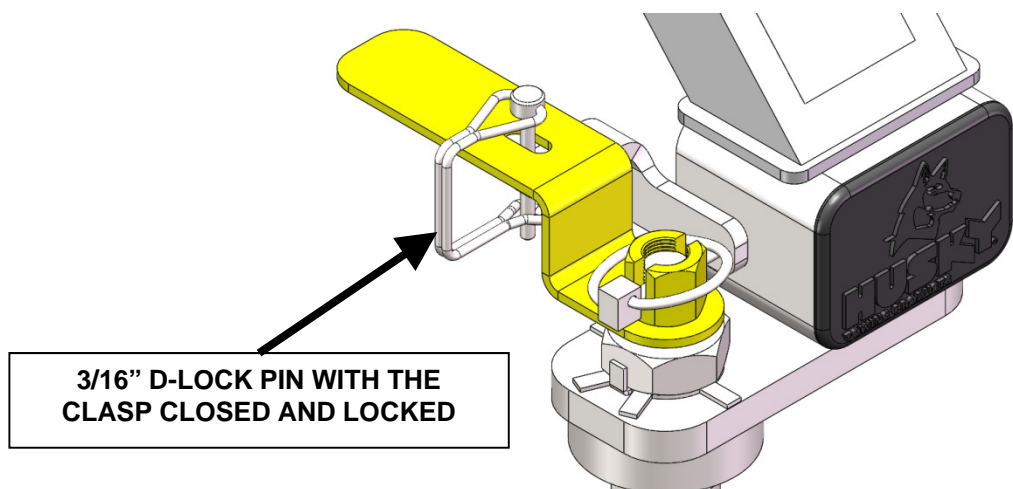

10. Install the recommended HUSKY 5<sup>th</sup> Wheel hitch according to the provided instructions with that specific product.

# Maintenance

1. After coupling, always visually check that the 5<sup>th</sup> wheel jaw or slide bar has closed completely across the rear of the king pin and that the indicators are working properly.  
**IMPORTANT! All indicating features must work when you are done hitching up for travel.**
2. After the first 100 miles, and at least once a year thereafter, inspect all bolts for proper tightness. Re-tighten nuts if needed.
3. Once or twice a week when traveling, apply a few drops of lubricant to the pivot areas of the hitch.
4. Once or twice a year, apply a light coating of wheel bearing grease to the surfaces of the slide bar that holds the king pin in place. For best results, apply the grease with the slide bar or jaw surfaces of the 5<sup>th</sup> wheel in the closed position.

**Caution: The 5<sup>th</sup> wheel jaw or slide bar can close with heavy force. Use extreme care to keep fingers, hands, extremities & clothing out of the path of the slide bar. Failure to do so could result in severe injury.**

5. Periodically inspect your product for wear or damage.
6. Husky Towing Products recommends the use of a lube disc, contact your local Husky dealer to purchase one.

## **TOWING TIPS**

### **Driving Tow Vehicle**

Good habits for normal driving need extra emphasis when towing a trailer. The additional weight of the trailer affects acceleration and braking. Extra time should be allowed for passing, stopping and changing lanes. Signal well in advance of a maneuver to let other drivers know your intentions. Severe bumps and badly undulating roads can damage your towing vehicle, hitch and trailer, and should be negotiated at a slow, steady speed. If any part of your towing system “bottoms out” or if you suspect damage may have occurred in any other way, pull over and make a thorough inspection. Correct any problems before resuming travel.

Turning and backing up present new problems-plan ahead. It is highly recommended that a spotter be used when backing up to alert the driver of possible obstacles and prevent jack knifing the trailer.

Towing a trailer will change your turning radius, the longer the trailer the larger radius turn.

### **Driving Conditions**

When driving in conditions where the pavement is wet, icy, snowy, loose gravel, grass and dirt, reduce speed and do not make any sudden maneuvers. Allow ample distance/time for stopping and changing lanes. If possible, wait for road conditions to improve before driving.

Follow all state, local and provincial driving and towing laws in the location you are driving in.

Not following your tow vehicle, trailer, and Husky instructions/manuals can result in a fatal accident.

### **Check Your Equipment**

Please refer to the MAINTENANCE section. Periodically check the condition of all your towing equipment and keep it in top condition.

### **Tire Inflation**

Unless specified otherwise by the towing vehicle or trailer manufacturer, tires should be inflated to their manufacturer's towing recommendations.

### **Towing Vehicle and Trailer Manufacturers Recommendations**

Review the owner's manual for your towing vehicle and trailer for specific recommendations, capacities and requirements.

### **Passengers in Trailers**

Trailers should not be occupied while being towed. Most states enforce this regulation.

### **Trailer Lights, Turn Signals, Electric Brakes**

Always hook up all of the trailer lights, electric brakes and break-away switch connection whenever trailer is being towed. Also periodically check functionality of all lights before towing and repair any problems as needed.

### **Remove Hitch When Not Towing**

Remove hitch from the towing vehicle when not towing a trailer to reduce chances of accidental damage and to reduce the chance of parts being stolen.

### **Maintenance**

Keep movable hitch assembly parts (jaw, pivot pin, etc...) lubricated when not in use.

Remove 5<sup>th</sup> wheel hitch from receiver and store in clean, dry place when not in use.

### **At The Beginning of Every Towing Day:**

If electric brakes are used ensure the emergency break away cable is attached to the tow vehicle.

Check to see that all electrical hook-ups are in working order and that the safety chains are securely connected.

Towing safely is the responsibility of the driver of the vehicle. Failure to tow safely can result in vehicle damage, bodily injury or death.



# Warranty Terms:

## 10 Year Limited Warranty:

This warranty applies solely to Husky 5<sup>th</sup> Wheel adaptor manufactured by DTS Manufacturing for Husky Towing Products.

Husky Towing Products and DTS Manufacturing make no guarantees or warranties for products not manufactured by DTS Manufacturing. Such products are covered solely under any applicable warranty of the manufacturer. It is always recommended that the operating instructions and guarantee instructions provided by the manufacturer are followed.

DTS Manufacturing warrants its products to be free from manufacturing and material defects to the original purchaser for the length of warranty stated above from the date of retail purchase. If any products are found to have a manufacturing or material defect, the product will be replaced or repaired at the option of Husky Towing Products and DTS Manufacturing with proof of purchase by the original purchaser. The original purchaser shall pay all transportation and shipping costs associated with the return of the defective product and the defective product shall become the property of DTS Manufacturing.

The Warranty applies to DTS Manufacturing products used for individual and recreational purposes. Commercial usage of the DTS Manufacturing products limits the warranty to 90-days from date of purchase.

The Warranty applies only to DTS Manufacturing products which are found to be defective in manufacturing or material. This warranty does not apply to normal wear and tear of the finished product placed on DTS Manufacturing products.

Husky Towing Products and DTS Manufacturing are not responsible for any labor costs incurred for removal or replacement of the defective product.

Husky Towing Products and DTS Manufacturing are not responsible for repair or replacement of any product under the limited warranty where the product was improperly installed, misapplied, altered, abused, neglected, overloaded, misused or damaged as a result of an accident, including any use of the product not in accordance with all product operating and safety instructions.

Without limiting the generality of the foregoing, Husky Towing Products and DTS Manufacturing shall under no circumstances be liable for any incidental or consequential loss or damage whatsoever arising out of, or in any way relating to any such breach of warranty or claimed defect in, or non-performance of the products. Some states do not allow the exclusion or limitation of incidental or consequential damages, so the above exclusion or limitation may not apply to you.

This limited warranty gives you specific legal rights, and you may also have other rights that vary from state to state.