

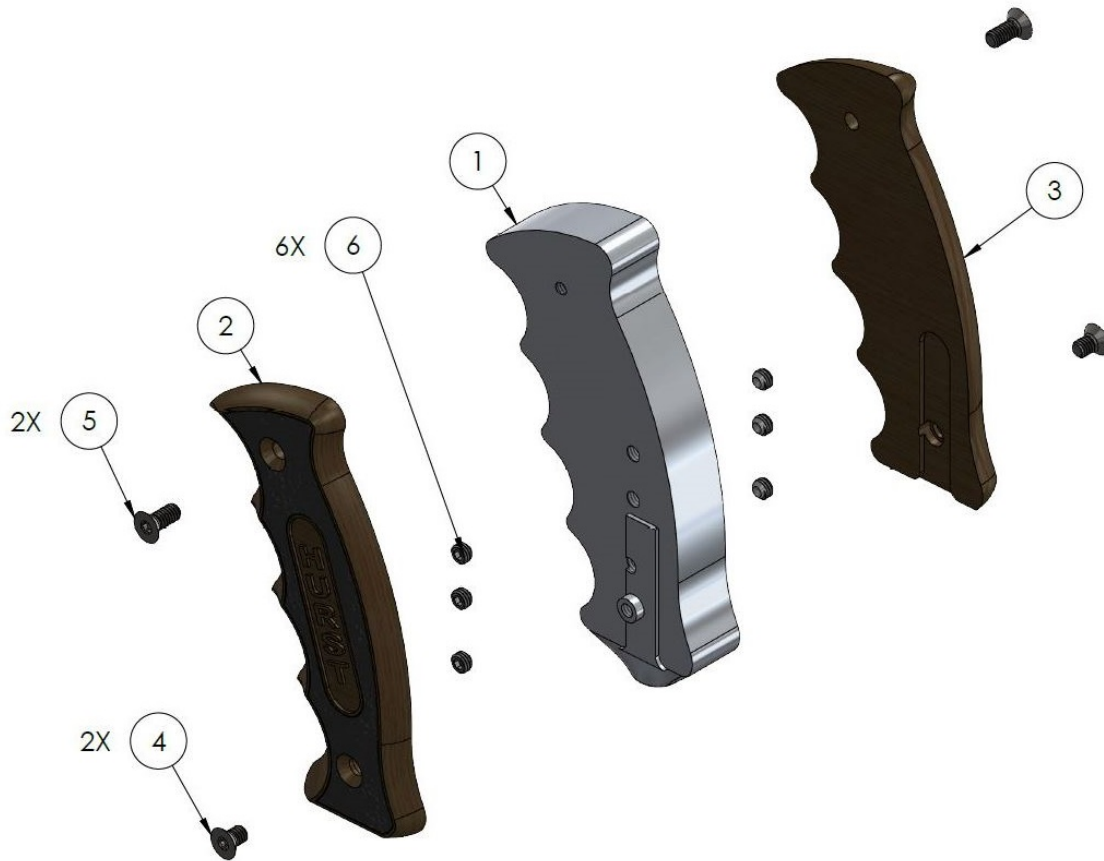

Installation Instructions for Catalog # 5380439

**BILLET PLUS SHIFTER HANDLE**  
**for Automatic Transmission-Equipped**  
**2005-14 CHRYSLER 300**  
**2006-14 DODGE CHARGER**  
**2005-08 DODGE MAGNUM and**  
**2008-14 DODGE CHALLENGER**



ITEM NO.	PART NO.	DESCRIPTION	QTY.
1	2380436-88	BODY, NITRO AUTO HANDLE, 05-14 MOPAR CARS	1
2	4048658-88	GRIP PLATE, PISTOL AUTO, LEFT, BLACKWOOD	1
3	4048659-88	GRIP PLATE, PISTOL AUTO, RIGHT, BLACKWOOD	1
4	97003153	TORX SCREW, 8-32 × 1/4" L, STAINLESS	2
5	97003154	TORX SCREW, 8-32 × 1/2" L, STAINLESS	2
6	97003161	SET SCREW, CUP POINT, 10-32 × 1/8", STAINLESS	6

## BEFORE STARTING

- Take a moment to read and understand these instructions before installing your Hurst Billet Plus Shifter Handle.
- Use the parts drawing and list (front page) to verify your kit's contents. In the unlikely event of missing parts, please contact Hurst Technical Support for replacements.
- We highly recommend that you retain all factory parts.
- Work safely! Turn off your vehicle's ignition and set the parking brake.

## REMOVE THE STOCK SHIFTER HANDLE

Shifter handles are attached to shifter sticks by different mechanisms, depending on vehicle model and year:



1. **Threaded** – Threaded shifter handles simply twist off the shifter stick in a counterclockwise direction.



3. **Friction Snap** – With a small flat-tip screwdriver, carefully spread the locking fingers apart while pulling the shifter handle upward, until the handle comes free.



2. **If your shifter handle is not threaded**, carefully pry the chrome trim ring off the shifter handle. This will reveal the how your handle is attached. NOTE: Do not pry the trim ring off threaded shifter handles!



4. **Spring Clip** – Use pliers to pull the spring clip out of the shifter handle, then lift the handle off the shifter stick.

## INSTALL THE HURST SHIFTER HANDLE



5. Install 3 set screws (Item 6) on each side of the shifter handle body (1). Leave about 1 or 2 threads showing.



6. Slip the handle body onto the shifter stick.



7. Properly align the shift handle, then tighten all six set screws.



8. Install grip plates (2) and (3), using 1/2" long flathead screws (5) in the top holes, and 1/4" long flathead screws (4) in the bottom holes.



**Congratulations, the installation of your Hurst Billet Plus Shifter Handle is now complete!**