

HOTCHKIS SPORT SUSPENSION

1213 ADJUSTABLE UPPER TRAILING ARMS 59-64 CHEVROLET B-BODY



INSTALLATION OF HOTCHKIS PERFORMANCE ADJUSTABLE UPPER TRAILING ARMS

- 1) Securely block the front wheels of the vehicle. Use a jack to raise the rear of the vehicle and support with jack stands to the frame.
- 2) Remove the stock upper trailing arm by unbolting it from the frame and axle. **For Vehicles with two upper arms, remove and replace only one arm at a time** as this will help keep the axle aligned properly and make it easier for removal and replacement.



- 3) Check the stock arm mounting hole center-to-center measurement. The stock arm length should match the length of the Hotchkis upper arm center-to-center measurement.



If the Hotchkis arm does not match the center-to-center length of the stock arm then you should adjust the length to match. Loosen the jam nut and rotate the head. Turn the head **clockwise to shorten** the length, and **counter-clockwise to extend** the arm. Hand-tighten the jam nut against the head to hold it in place for the installation.

- 4) With the stock arm length matched, use the grease pack provided to apply a thick coat of grease to the bushing sides at each end of the arm. Apply a light coat of grease to the bushing contact areas on the frame and axle.



- 5) Install the Hotchkis arm with the bend in the arm towards the top and the adjustable head nearest to the axle. Insert the included hardware into the ends, and tighten the hardware at each end.



- 6) With the arm(s) in place, determine if any pinion angle adjustment is necessary. *For stock vehicles no adjustment should be required.* If the pinion angle needs to be adjusted **downwards**, the arm length needs to be **shortened**. If the angle needs to be adjusted **upwards**, the arm length should be **extended**.

You should only remove the bolt at the axle end of the arm to rotate the head once the arm is installed in the vehicle. One full rotation of the head (360deg) is approximately equal to 1/16" (.0625") of travel and 1/2 degree of camber adjustment.

The **stock Chevrolet** upper arm center-to-center length is **13-3/4" (13.750")**

The **maximum suggested** center-to-center length of the **Hotchkis** upper arm is **14" (14.00")**

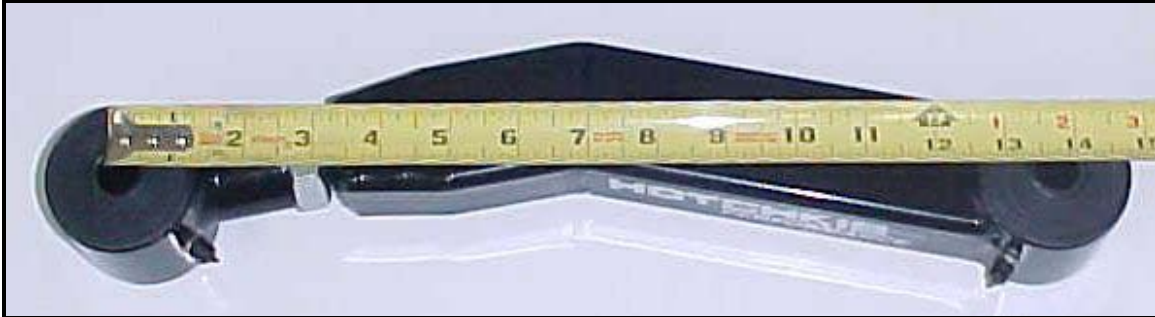

The **minimum suggested** center-to-center length of the **Hotchkis** upper arm is **13-1/2" (13.50")**

Hotchkis arms can be lengthened or shortened 4 turns or 1/4" length over stock for a total of 2 degrees of positive pinion angle or 2 degrees negative.

IMPORTANT! There **MUST** be a **minimum of 1/2 inch** of thread engagement into the head for maximum strength!

- 7) Tighten the jam nut to secure the arm at the desired length and pinion angle.



IMPORTANT! The jam nut **MUST** be tight before usage. Then re-torque the jam nut after the first use.

- 8) Make sure the grease fittings are covered with the included zerk caps, and that all hardware has been properly tightened. Remove jack stands from under the vehicle with a jack and you're done!

IMPORTANT! Check all hardware after the first five miles. For maintenance, use the zerk fittings to grease the bushings at least once a year (15,000 miles) or when excessive noise occurs. Use a non-lithium based grease only. Lithium based grease can wash out with water.

59-64 Chevrolet B-Body Adj. Rear Upper Arm Kit, Parts List
P/N 1213

	Hotchkis P/N	Item Description	Quantity Per Kit
1	16410005	Bushing Sleeve, 59-64 Chevrolet B-body	2
2	12910005	Upper Trailing Arm Body, 59-64 Chevrolet B-body	1
3	2438.01	Trailing Arm Bushing, 59-64 Chevrolet B-body	4
4	7/8-14 JAM	7/8" Right Hand Jamb Nut	1
5	7201	Short Zerk Fitting	2
6	12410148	Adjustable Head, 1200 Series	1

Hardware Included in Kit 1733 (one per kit 1213)

7	5/8-18X4HEX	5/8" Hex Head Bolt	2
8	5/8 SAE	5/8" Flat Washer	4
9	5/8-18NYLOCK	5/8" Nylock Nut	2

Items Not Shown

10	GC-5B	Grease Zerk Caps, Black	2
11	9.11108	Grease Pack	1
12	n/a	Instruction Set	1

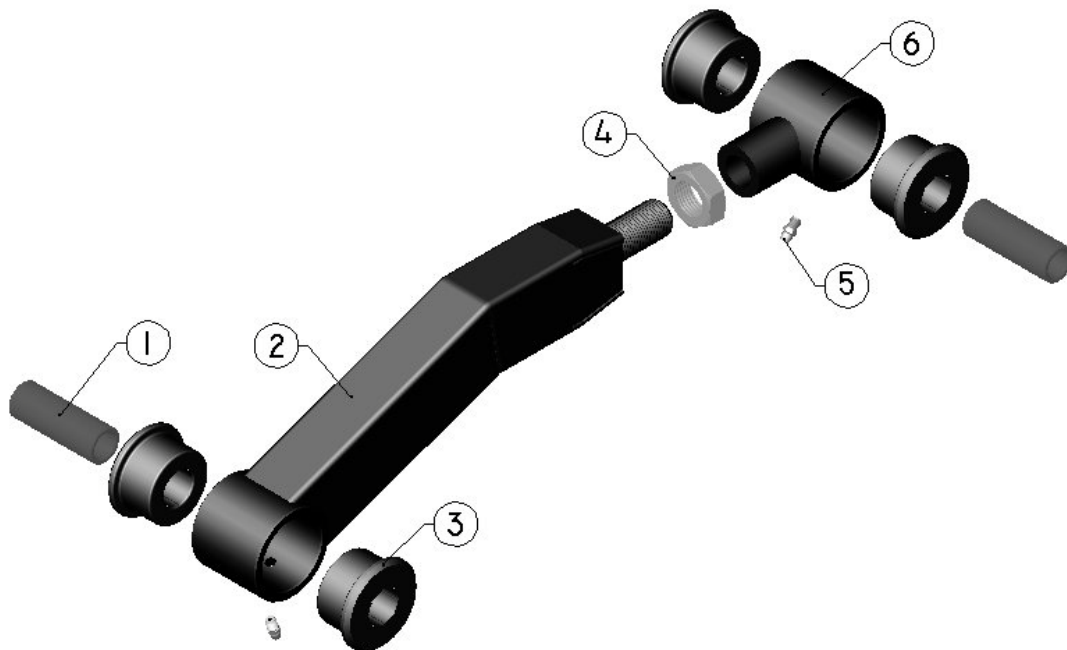

TMS

TOTAL VEHICLE SYSTEM

CHECK OUT EVERYTHING ELSE HOTCHKIS PERFORMANCE MAKES FOR YOUR 59-64
B-BODY CHEVROLET!!



Tubular front and rear sport sway bar set!

- ✓ *Improves handling without adding extra pounds!*
- ✓ *Includes brackets to add a stock power steering unit and front end-link mounts for cars without a stock sway bar!*



Boxed lower trailing arms to help stiffen up the rear end!



Double adjustable pan-hard rod to help center the axle!