

1967-1969 GM F-Body Convertible 1404 Center X-Brace Installation Instructions

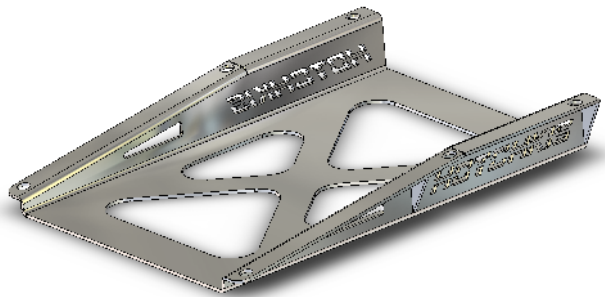

Thank you for your purchase of this Hotchkis Performance product. Your X-Brace was designed with the performance and durability you've come to expect from Hotchkis Performance. This lower profile brace will allow you to run larger exhaust piping while still bracing the center section of your convertible chassis.

Note: Please read the entire installation instructions before starting. Having the right tools will ensure a smooth install process.

X-BRACE INSTALLATION

- 1 Jack the vehicle up and support it on jack stands.
- 2 Creep underneath the car and locate the stock X-Brace and remove it by undoing the 6 bolts that secure it. You may discard the brace and hardware.

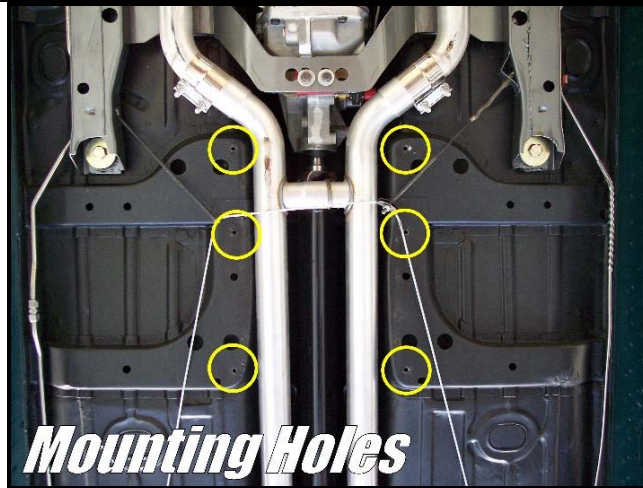

- 3 Using the provided stainless hardware, coat each bolt with a small amount of anti-seize.



- 5 Slide your new Hotchkis Brace into position. Start each bolt by hand then fully tighten.





5 You are finished installing your new Hotchkis X-Brace.

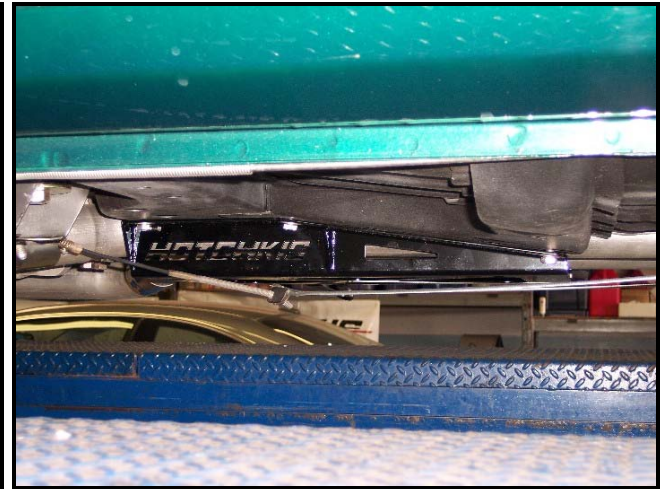
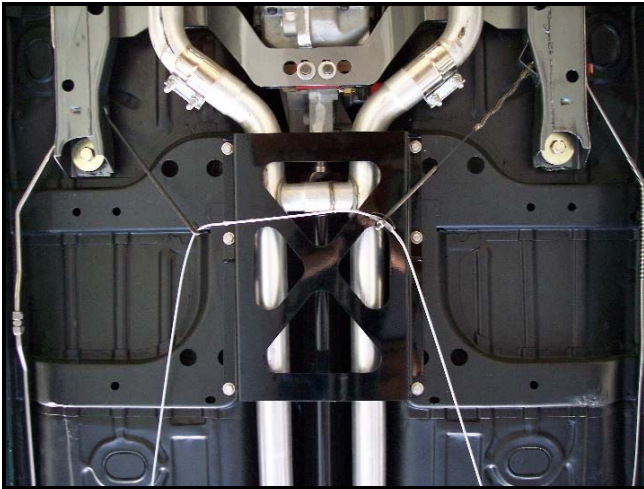

Note:

Hooker Super Comp headers may have clearance issues with this brace or any cross brace due to the header's low profile.