

WIRE IDENTIFICATION

- (GD) = Ground
- (LT) = Left Turn
- (TL) = Taillight
- (BU) = Backup
- (AX) = Auxiliary
- (RT) = Right Turn
- (EB) = Electric Brake

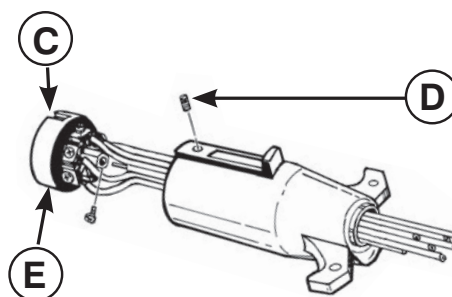
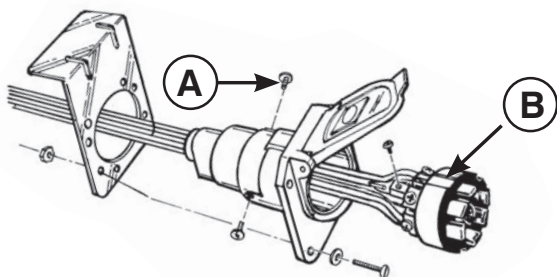

Vehicle Connector

1. Install mounting bracket with screws provided.
2. Loosen the set screw (A) on the connector and remove the socket from the housing. Route wiring through socket housing. Strip wires 1/4" and tightly secure them to socket terminals.

NOTE: Locate wires on vehicle by function only. Color coding is not standard with all manufacturers.

3. Align socket keyway with housing key (B) and insert socket into housing. Tighten set screws.
4. Mount the completed socket assembly to the bracket.

CAUTION: Connect auxiliary power lead to fuse block or fused battery lead. 20 Amp.

Trailer Connector

1. Loosen the set screw (D) and remove the terminal assembly (E) from housing. Route wiring through housing. Strip wires 1/4" and tightly secure them to the terminal assembly. It is important to attach wires to the terminal assembly in the same positions as found on the vehicle side 7-way socket. Leave 18" of slack between tow vehicle and trailer to allow trailer to turn. Align terminal assembly keyway (C) with housing key and insert assembly into housing. Tighten set screw.
2. Plug trailer into vehicle and test all functions.