

WIRING DIAGRAM WITH CHARGER (#20001, #20004 & #20019)

● Splices

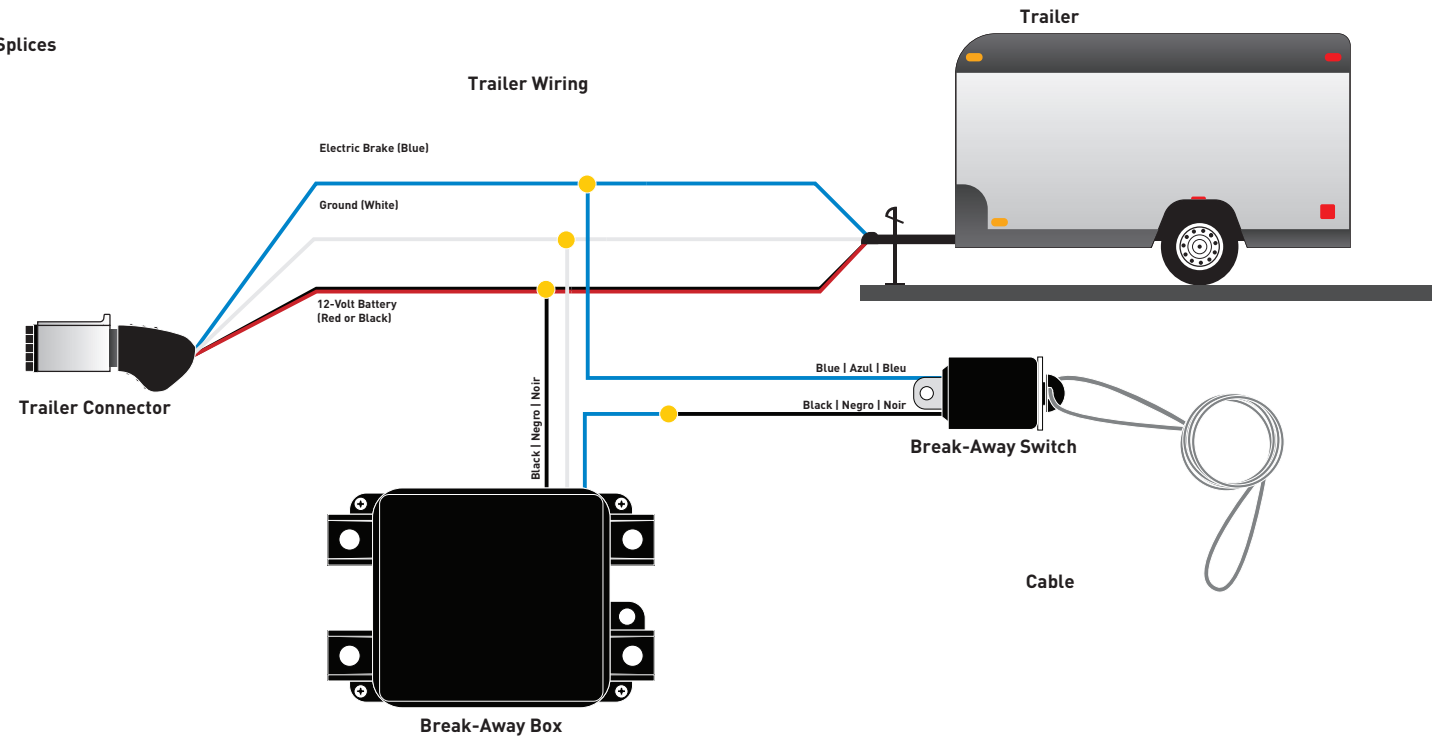

Wire by function ONLY. Color coding is not standard among all manufacturers

WIRING DIAGRAM WITHOUT CHARGER (#20002 & #20003)

● Splices

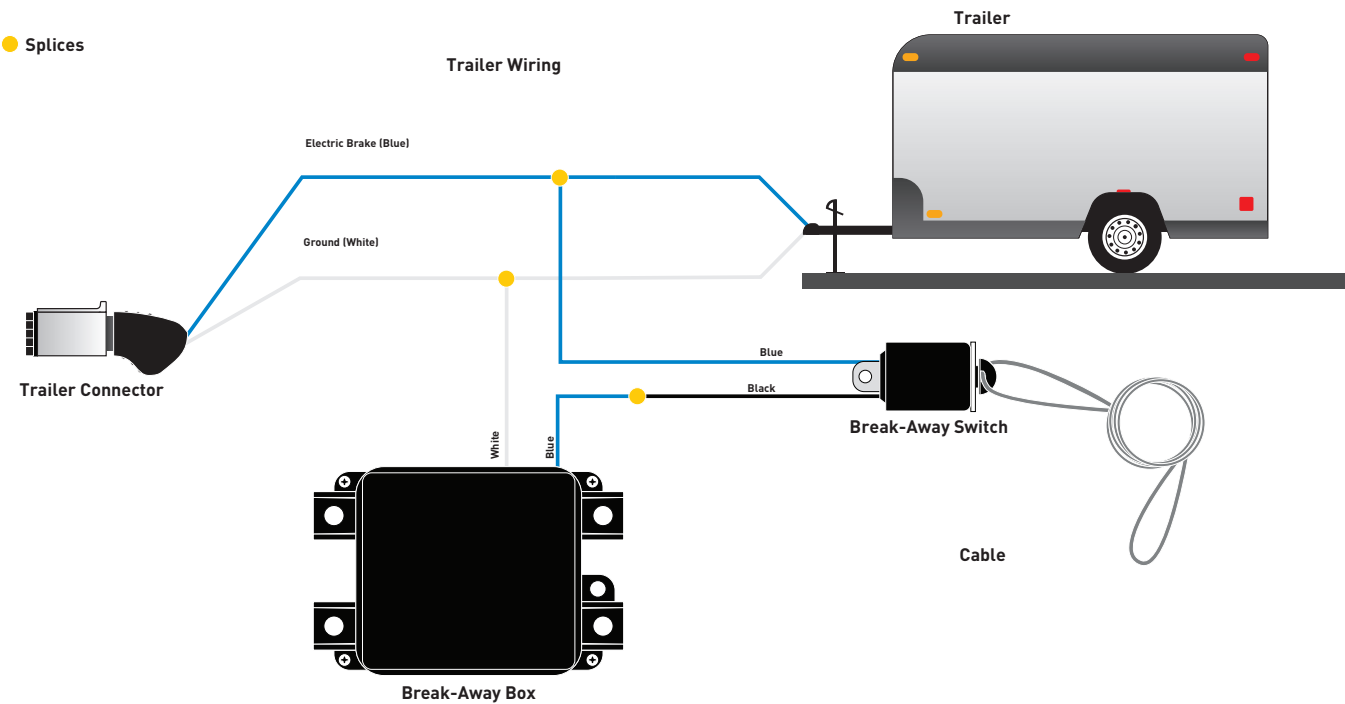

BREAK-AWAY SYSTEM INSTRUCTIONS

for 1 - 2 axle trailers

Make sure you have all parts before you start your installation.
*Kits #20003, #20004 & #20019 do not include mounting hardware.

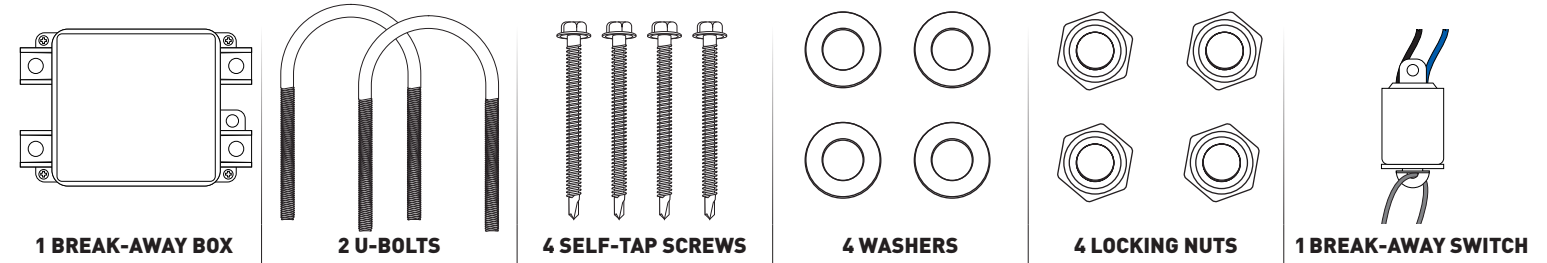

The following instructions must be precisely followed to ensure proper operations.
Please read the following instructions thoroughly before installing this product.

The Break-Away System is designed to bring trailers safely to a stop by activating electric brakes, should a trailer be disconnected while driving. This type of safety system is required in most states on trailers rated over 3,000 GVW. **Note: Contact your department of transportation for complete towing law information.** Your trailer must have operational electric brakes before installation. Once you determine your trailer brakes work, find a secure location on your trailer to mount the Break-Away Box. You have two options to mount this kit.

OPTION 1 - U-Bolt Mounting Instructions:

1. Use included U-Bolts and wrap around a secure mounting surface on trailer (jack, frame, etc.)
2. Attach Brake-Away Kit by routing U-Bolts through holes provided on each side of the plastic casing.
3. Place one flat washer over each bolt with locking nut. Use 1/2" wrench and tighten. **Note: Be careful not to over tighten, housing could crack.**
4. Next mount Brake-Away Switch close enough on trailer that the cable can be attached to vehicle.
5. Follow "Wiring Installation".

OPTION 2 - Self-Tapping Screw Mounting Instructions:

1. Locate secure surface on trailer to mount Break-Away Kit.
2. With flat washers on each screw, route through provided holes in each corner of the Break-Away kit plastic casing. Use screwdriver or drill and secure to trailer.
3. Next mount Brake-Away Switch close enough on trailer that the cable can be attached to vehicle.
4. Follow "Wiring Installation".

Wiring Installation **WIRING DIAGRAM ON BACK**

1. Splice the blue wire of the Break-Away Switch to the electric brake wire coming from the trailer side connector
2. Connect the black (labeled battery) wire of the Break-Away Switch to the blue wire (labeled brake) from the Break-Away Box
3. Splice white wire from Break-Away Box to existing ground wire on trailer or ground directly to trailer frame
4. Splice black wire on Break-Away Box to trailer 12-Volt auxiliary power lead. This will charge the Break-Away Battery when vehicle is in use. **NOTE: The black wire is found only on Model 20001, 20004 and 20019**

Break-Away Switch Setup

1. Test unit by pulling firmly on cable of Break-Away Switch. Battery will activate brakes. **Note: Do not pull pin from the Break-Away switch if the trailer is electrically connected to the tow vehicle. This could result in damage to the tow vehicle.**
2. Once tested, Break-Away Switch cable should be secured to vehicle bumper or frame. The cable can be attached many different ways. Two of the most common are: I. Pull the pin out of the Break-Away Switch (FIG 1) and route through safety chain pocket (FIG 2), then through cable loop and reconnect pin. II. Attach cable loop to a bumper clevis (FIG 3). Do not loop cable over hitch ball. Cable could bounce off while vehicle is moving. **Note: Pin must be facing the rear of the vehicle, directly behind the location of the cable on your vehicle. Anything else may cause Break-Away Switch failure.**

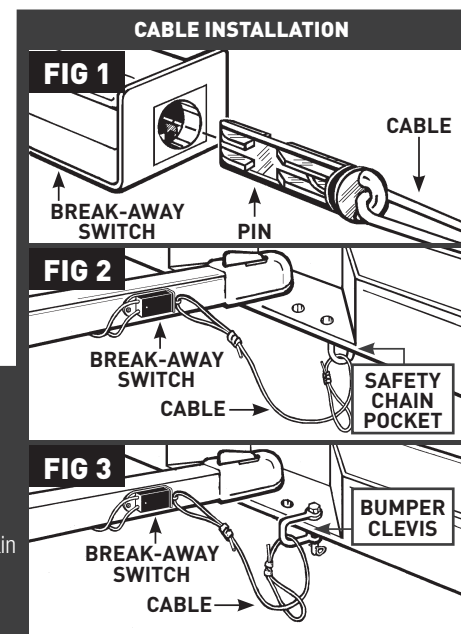

YOUR TRAILER MUST HAVE OPERATIONAL ELECTRICAL BRAKES TO USE THIS PRODUCT