

557-100 Pump

Specs:

VOLTAGE: 12 VDC Nominal

PRESSURE SWITCH: None

LIQUID TEMPERATURE: 180 Degrees Fahrenheit (82 Degrees Centigrade) Max.

PRIME: Self-Priming Up To 9.0 Ft. Vertical,

Max. Inlet Pressure 30 PSI (2.1 Bar)

PORTS: 3/8"-18 NPT Female

NET WEIGHT: 4.5 Lbs. (2.0 Kg)

DUTY CYCLE: Continuous (See Temperature Rise Chart)

BYPASS: 145 PSI Max.

DIMENSIONS:

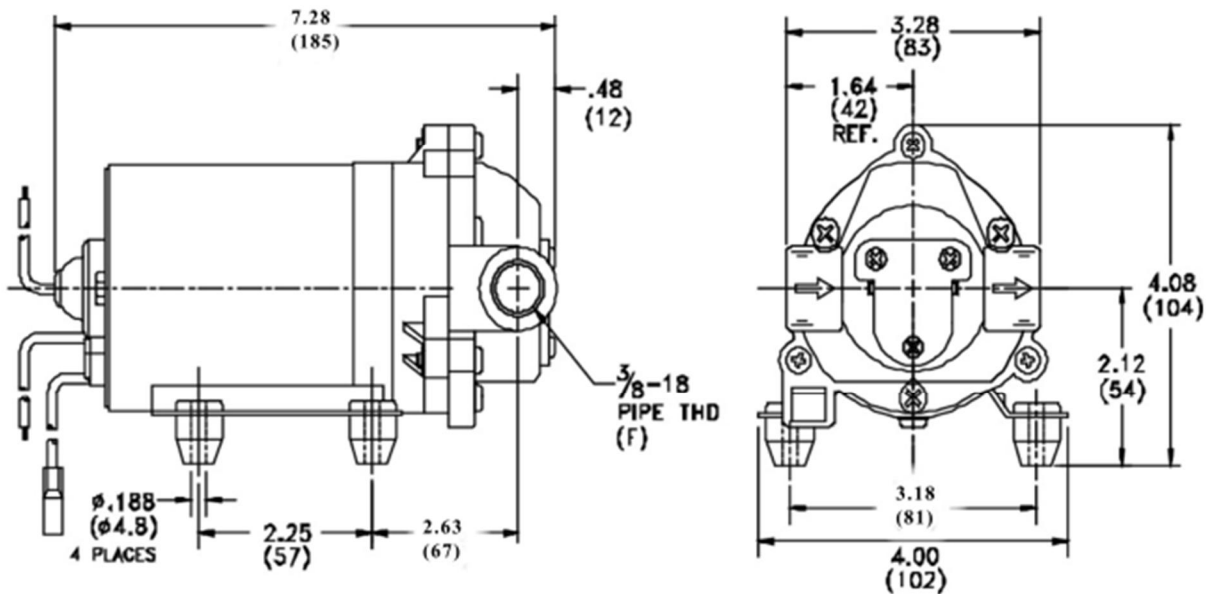

TYPICAL PERFORMANCE

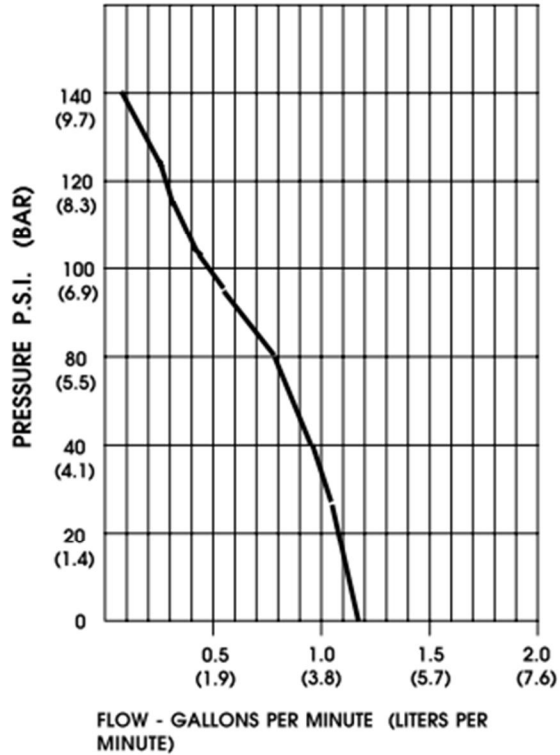

| PRESSURE (PSI) | FLOW (GPM/LIT) | RPM MIN/MAX | CURRENT (AMPS) | VOLTAGE (VOLTS) |
|----------------|----------------|-------------|----------------|-----------------|
| OPEN | 1.18/4.5 | 2340/2350 | 2.1 | 12 VDC |
| 10 | 1.14/4.3 | 2325/2340 | 2.5 | |
| 20 | 1.05/4.0 | 2290/2300 | 3.0 | |
| 30 | 0.98/3.7 | 2250/2275 | 3.6 | |
| 40 | 0.94/3.5 | 2225/2235 | 4.1 | |
| 50 | 0.88/3.3 | 2190/2205 | 4.6 | |
| 60 | 0.84/3.2 | 2155/2185 | 5.0 | |
| 70 | 0.78/3.0 | 2125/2155 | 5.4 | |
| 80 | 0.75/2.8 | 2100/2120 | 5.8 | |
| 100 | 0.57/2.2 | 2075/2095 | 6.5 | |
| 120 | 0.21/0.8 | 1970/2045 | 7.2 | |
| 140 | 0.10/0.4 | 1945/2015 | 7.5 | |

-SPECIFICATIONS SUBJECT TO CHANGE WITHOUT NOTICE.
-ALL DATA BASED ON TESTING WITH WATER AT AMBIENT TEMPERATURE.

TEMPERATURE RISE

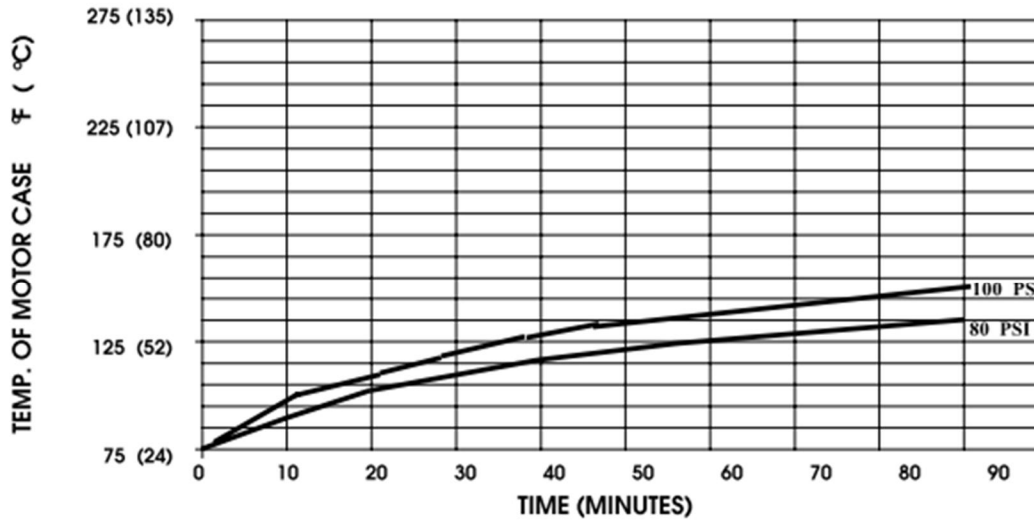

THIS GRAPH IS FOR USE AS A DESIGN GUIDE. IT IS BASED ON RUNNING CONTINUOUSLY WITH AN AMBIENT TEMPERATURE OF 70° F IN STILL AIR.