

Hellwig PRODUCTS

INSTALLATION INSTRUCTIONS REAR STABILIZER BAR

Thank you for purchasing a quality Hellwig Product.

PLEASE READ THIS INSTRUCTION SHEET COMPLETELY BEFORE STARTING YOUR INSTALLATION

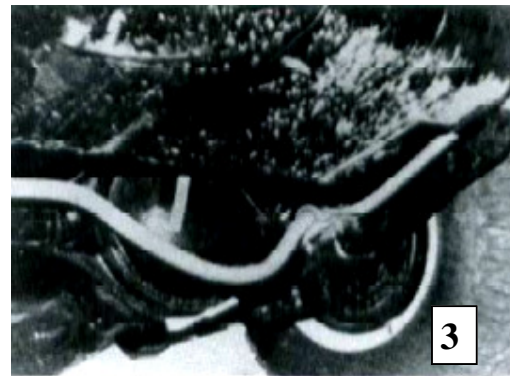
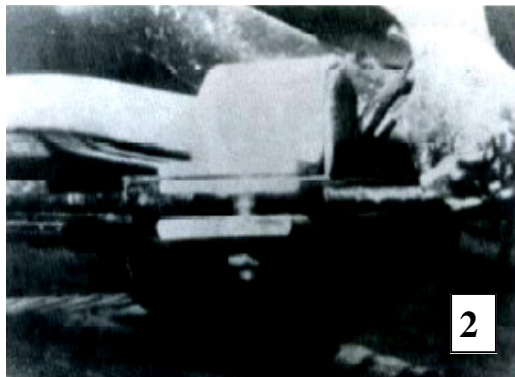
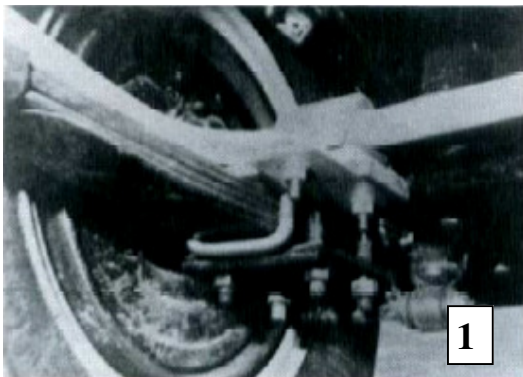

1 Sway Bar

2 Rear Spring D-Bushing and Bracket

3 U-Bolt and Mounting Plates

4 Sway Bar D-Bushing

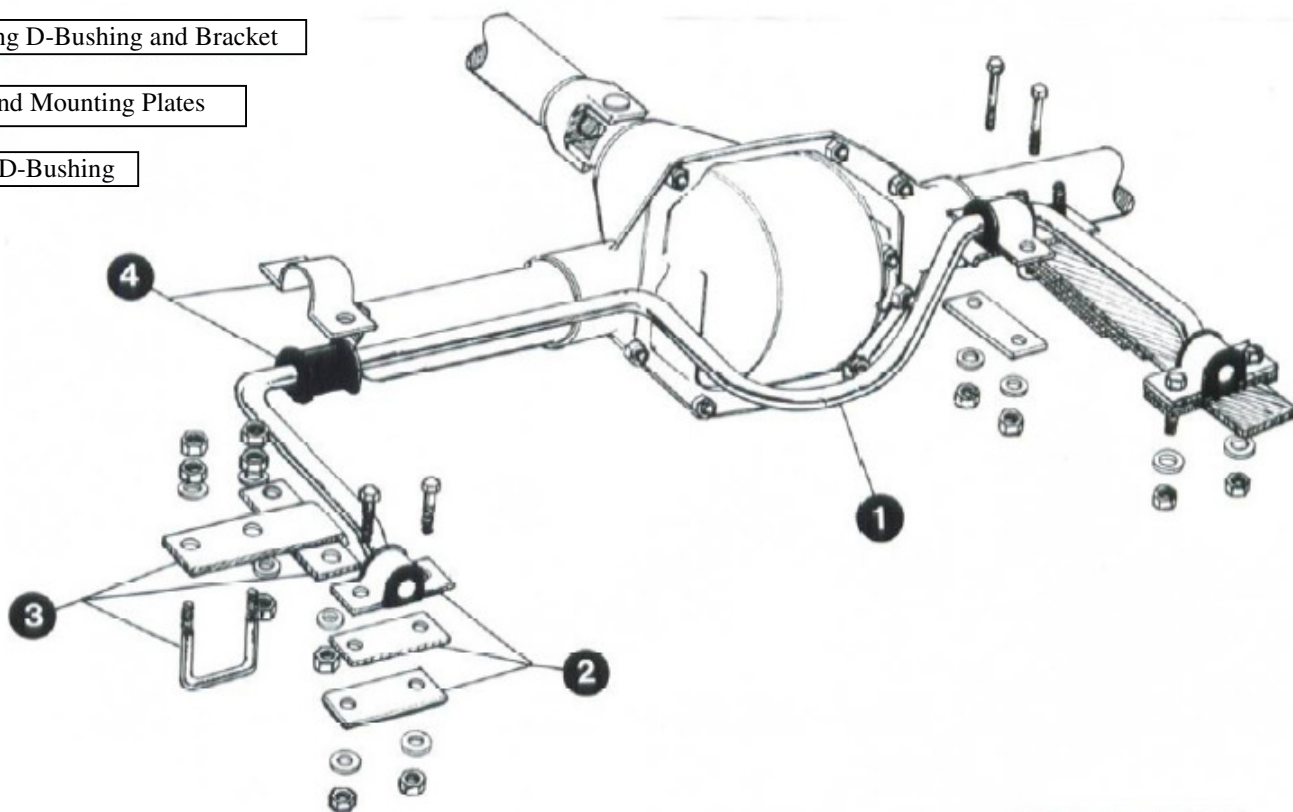

CAUTION
Stay Clear of Brake Lines

Hellwig PRODUCTS

SAFETY: BEFORE STARTING YOUR INSTALLATION, BE SURE TO SET PARKING BRAKE AND CHOCK TIRES.

NOTE: TO EASE INSTALLATION AND TO PROPERLY ADJUST THE BAR, THE WEIGHT OF THE VEHICLE MUST BE ON THE SUSPENSION, AS IF DRIVING DOWN THE ROAD. DO NOT RAISE VEHICLE BY THE FRAME.

NOTE: THIS KIT MAY INCLUDE LOCK NUTS WHICH REQUIRES TIGHTENING WITH A WRENCH AFTER BEING STARTED BY HAND.

TORQUE TABLE

BOLT SIZE: 3/8" = 20-30 ft. lbs. – 7/16" = 35-45 ft. lbs. – 1/2" = 50-70 ft. lbs. – 9/16" = 70-90 ft. lbs.-5/8"=120 ft. lbs.

1. Place U-bolt and mounting plate on spring behind rear axle, place offset holes in plate toward axle, Photo 1. Secure tightly.
2. Lubricate the inside and place four poly bushings on sway bar, place bar on the rear spring behind axle, see illustration.
3. Install plates, bolts and nuts, as shown in illustrations. Do not tighten
4. Align sway bar arms so arms are directly centered over vehicle springs.
5. Tighten all brackets, U-bolts and nuts securely.
6. Bounce the vehicle and check for clearance on all undercarriage components. Be sure all nuts and bolts are securely fastened and double nuts used where necessary or provided.
7. Recheck your installation, look for clearance between gas lines, exhaust pipes, brake lines, wiring, etc. After one week of driving check your installation and periodically thereafter.