



Micro DE

Mounting Instructions
Fog lamps



Kit includes (with sets)

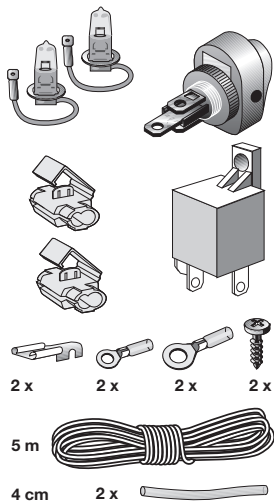
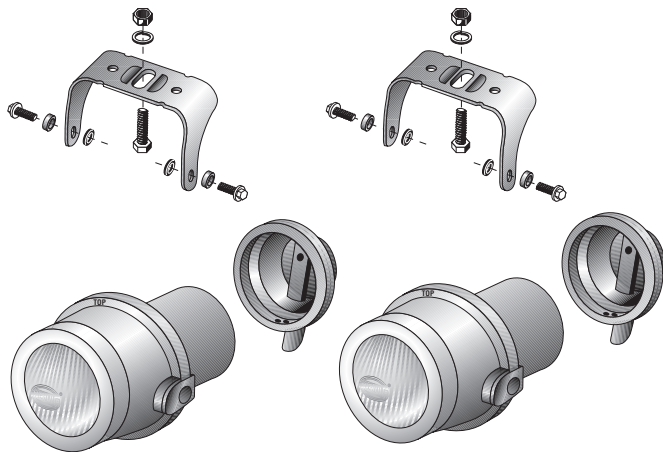

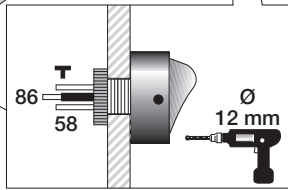
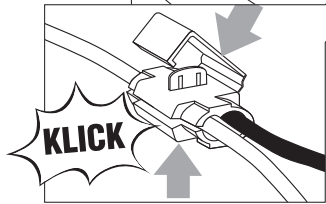
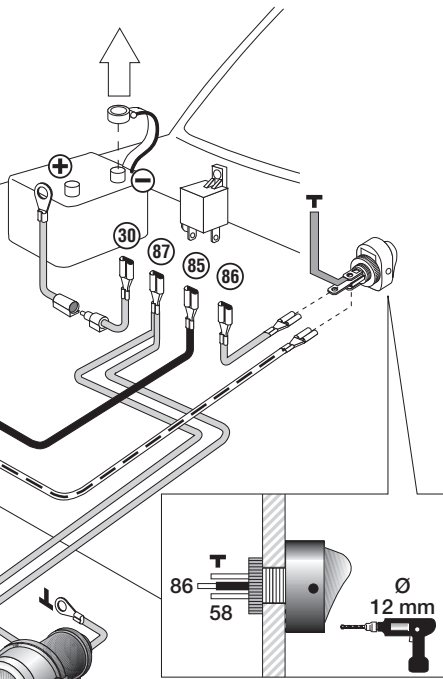
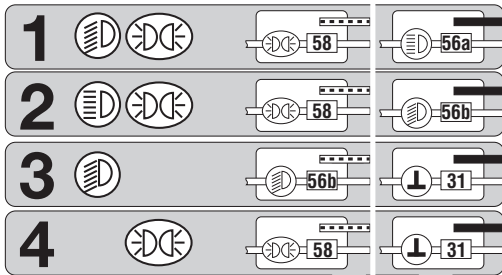

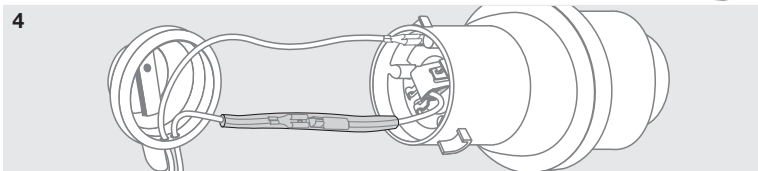
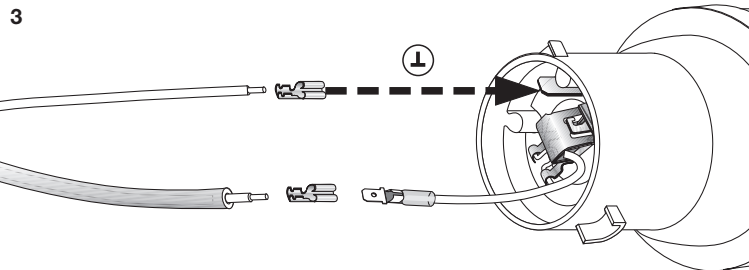
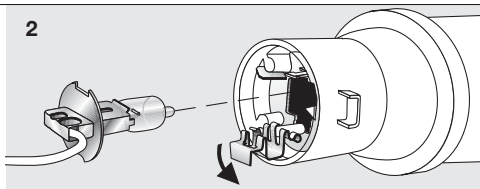
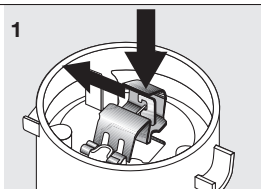
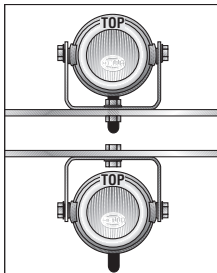

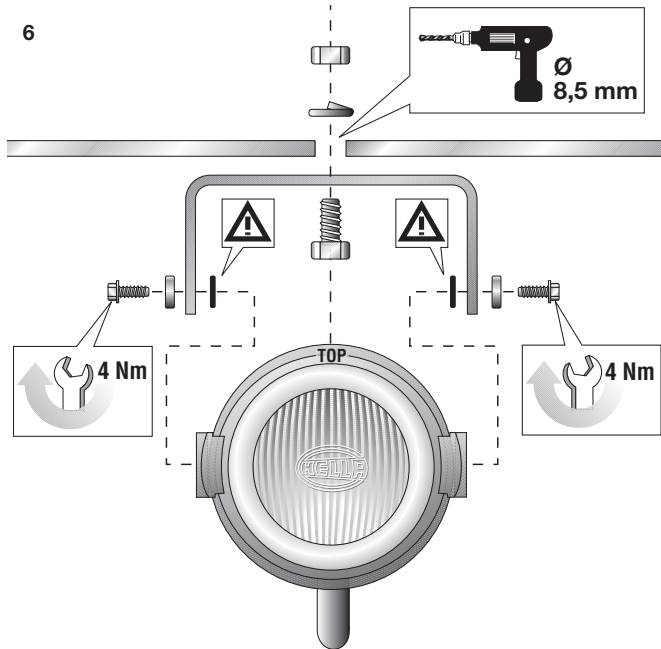
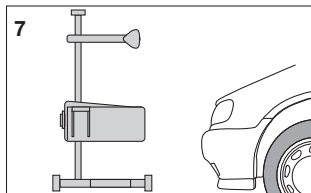
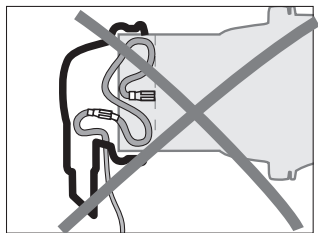
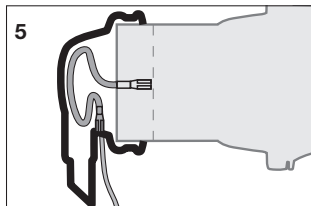

Accessories

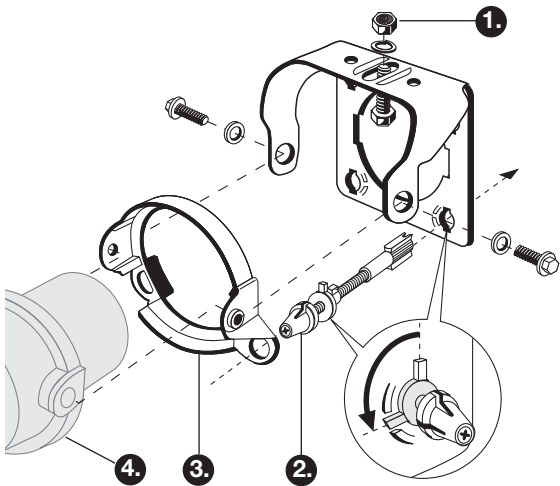

8 KA 002 309-811

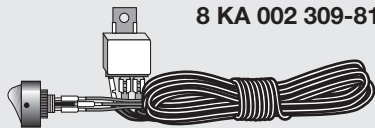

8 HG 153 152-001

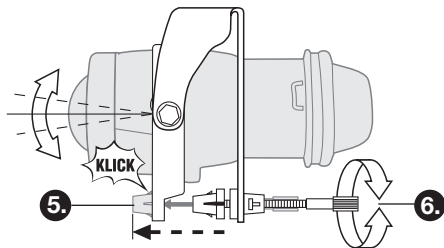
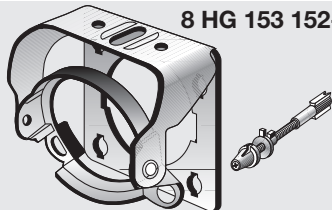

Accessories, see Fig. page 6

(not included with kit)

1. Adjusting frame

2. Wiring harness with relay

Attachment dimensions:

For upright/pendant mounting. Lamps should neither vibrate nor extend higher than the bonnet and must be fitted symmetrically.

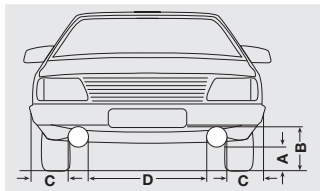

The table shows the possibilities permitted in the various countries:

			(also see "One more tip")
		●	
		●	

Tools required:

- Ruler
- Combination pliers
- 10 mm open-end or box wrench
- Drill with 3, 8, 12 mm dia. bits
- Screwdriver for recessed-head screws

Mounting steps:

1. Determine mounting position and mark mounting points according to attachment dimensions given above.
2. Drill pilot hole with 3 mm dia. bit and then bore out to 8 mm. Protect drilled metal parts with rust protection paint.
3. Remove lamp set, press rubber grommet in from inside and install stabilization ring (Fig.1; 2).
4. Preinstall bracket and tighten bolts hand-tight.

Electrical connection:

Install relay with connection terminals pointing downwards so that they are protected against splashing water (Fig. 5).

Install switch in dashboard: Either switch supplied with set or special switch for your vehicle (Fig. 6).

Final installation:







1. Install bulb. Do not touch glass with bare fingers (Figs. 1-2).
2. Lay ends of wires to lamps, insert into lamp housing through rubber grommet. Push protecting tube over bared + lead and crimp on cable terminal (Fig. 3).
3. Connect + lead to bulb connector and earth lead to retaining spring. Push the protecting tube completely over the bare lead connection to the bulb connector (Fig. 4).

Careful! Danger of short-circuit.

Disconnect earth lead (-) from battery for safety.

Lay and connect wires according circuit diagram (page 3).

The symbols mean: Fog lamps illuminate when they are switched on together with:

Dipped beam headlamps	
Dipped beam headlamps and parking lamps	 
Parking lamps	
Main beam headlamps and parking lamps	 

4. Place leads from lamp housing in the rubber grommet and push grommet over them up to stop (drain hole always downward) (Fig. 5).
5. Screw lamp in correct position ("Top" upwards, „Hella" visible, drain hole downwards) in pre-fitted holder and tighten hand-tight.
6. Reconnect battery earth lead (-). Check lights. Align lamp, tighten screws and secure connecting leads.

Have the fog lamps adjusted at a workshop or service station.

The table below shows which lights can be combined with the fog lamps.

Only properly adjusted lamps provide optimum illumination without dazzling on-coming traffic.

One more tip:

Keep the lenses clean. Dirt can absorb up to 80 % of the light. You drive more safely when you can see and be seen well.

Do you have spare bulbs and fuses in your vehicle? If you have any questions or installation problems: Ring the Hella service department.