

# INSTALL INSTRUCTIONS

## C-DMM-2012 Dash Monitor Mount

### 2011-2019 Nissan Frontier

**Notes:**

1. *The C-DMM-2000 series Dash Monitor Mount brackets are specifically designed to work with Havis, Inc, model # TSD-101 Touch Screen Display.*
2. *The display mount bracket includes a VESA 75 hole pattern that can also be used for some light weight tablet docking station applications under 5 lbs. . Acceptable positioning must be determined by end user.*

**TOOLS REQUIRED:** *(some tools are not needed for all vehicle installations)*

- Socket set - metric & standard      • Drill & drill bits      • Tape measure
- Phillips screwdriver      • Trim removal tools      • Pencil / Marker

**MOUNT BRACKET PARTS and HARDWARE:**

*Installation parts with \* come loose in hardware kit bag. Other parts are preassembled*

QTY:	DESCRIPTION:	PART #:
1	Main dash mount bracket	CM008530
1	Pivot / display mount bracket	MT-0320-SA *
1	Tilt swivel hinge	GSM22005
1	Tilt swivel adaptor	CM008531
1	Lower rear support bracket	CM008528
1	Lower front support bracket	CM008527
1	PVC spacer washer	CM008582
2	1/4" x 3/4" Carriage bolts	GSM32000
2	Nylon 1/16" spacer washer	CM86600
2	1/4" Nylock nut	GSM30016
2	1/4" Flat washer	GSM31005
1	M8 hex nut SS	GSM30113
1	M8 lock washer SS	GSM31217
3	Machine Screw 10-32 x 1/2"	GSM33118
3	#10 Flat washer	GSM31003
1	Vinyl cap (.50" high x .312 - .375 id)	GSM41127
2	M5 x 10mm Thread forming screw	GSM33774
2	Pull through bumper (3mm head)	GSM21109
2	Push in bumper (10mm head)	GSM21108
1	Grommet (1.75" wide)	GSM20091

**ALWAYS!**  
• Read all instructions before installing any Havis, Inc products.  
• Use hardware provided with install kit

C-DMM-2012 assembly

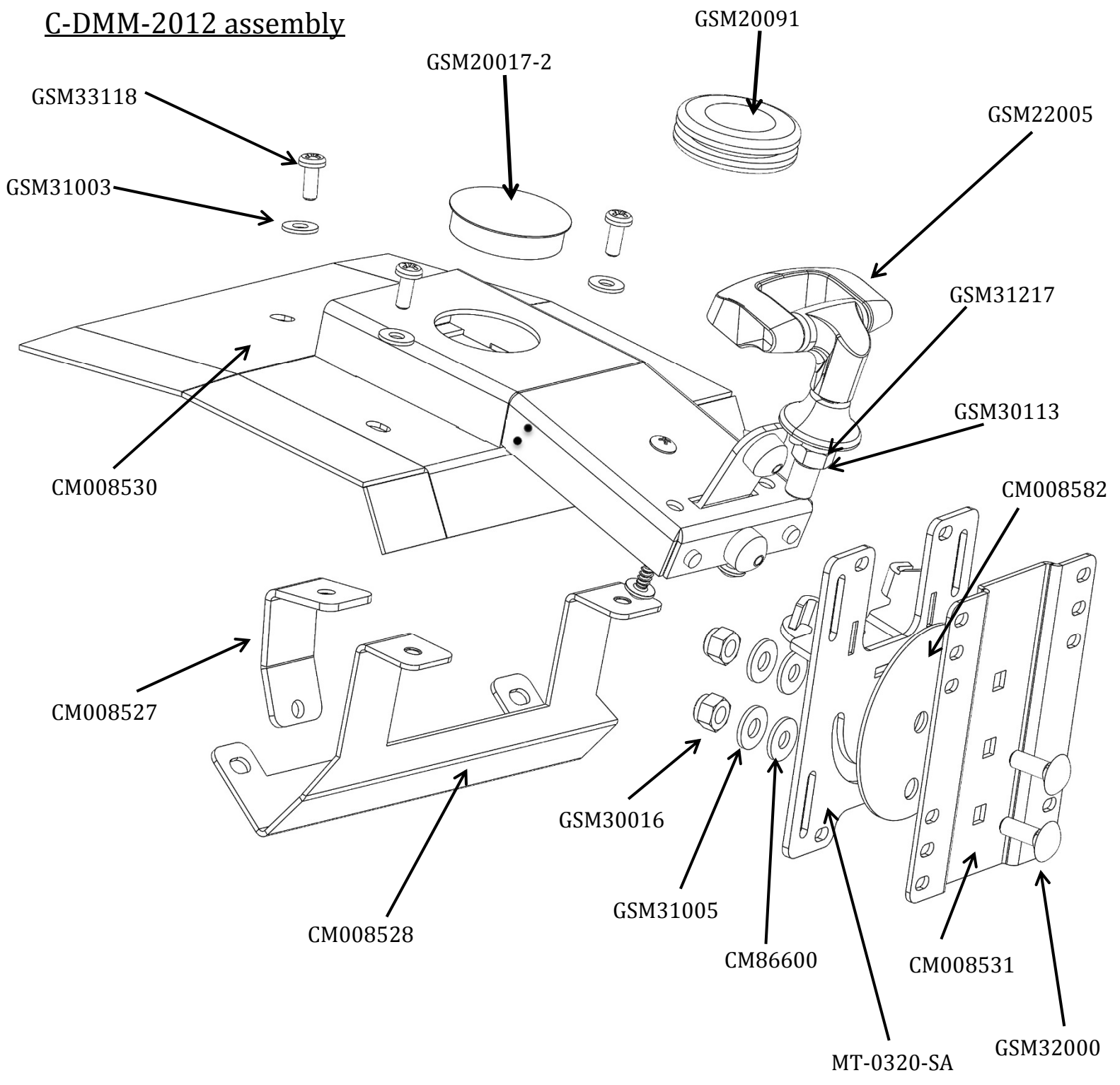



View of Frontier prior to installation.



Remove top center trim panel by gently prying along the edges with a panel removal tool.



Remove three (3) Phillips head screws.



Pull the center IP away from the dash slightly. Full removal is not necessary.



Slip the lower rear mounting bracket under the IP and into place. Re-attach the IP into the dash.



Re-install the OEM hardware for the front and rear support brackets and tighten.



If you desire to run wiring harnesses inside the dash, it should be done at this time.



Install the main dash mount bracket and secure using three (3) 10-32 x 1/2" screws and flat washers.



Connect harnesses to the back of the TSD-101 display. It is important to also double wire tie the harnesses to provide sturdy strain relief for the plugs.  
**USB connection from remote Docking station must plug into USB plug closest to front of display.**



Attach pivot / display mount bracket to display with M4 x 0.7 x 10mm Phillips head machine screws, lock washers and flat washers. Display mount hardware is included with TSD-101 hardware kit



Attach bracket with display to the tilt swivel hinge with M8 hex nut and lock washer. Tighten nut and attach vinyl cap on M8 bolt threads.



**Refer to TSD-101 owner's manual for power and computer connection details.**

When it comes to quality car mounts & chargers, Havis is the brand you can depend on.