

# INSTALL INSTRUCTIONS

## C-DMM-2007 Dash Monitor Mount

### 2008-2016 Ford F-250, 350 and 450 Super Duty Pickup truck

**Notes:**

1. *The C-DMM-2000 series Dash Monitor Mount brackets are specifically designed to work with Havis, Inc, model # TSD-101 Touch Screen Display.*
2. *The display mount bracket includes a VESA 75 hole pattern that can also be used for some light weight tablet docking station applications under 5 lbs. . Acceptable positioning must be determined by end user.*
3. *The C-DMM-2007 will work with all Havis, Inc. consoles made for the Super Duty.*
4. *The C-DMM-2007 Does NOT work with the upgraded radio with touchscreen. Please review photos to confirm what OEM dash is required for this application.*

**TOOLS REQUIRED:** *(some tools are not needed for all vehicle installations)*

- Socket set - metric & standard
- Drill & drill bits
- 1.5" hole saw
- Tape measure
- Phillips screwdriver
- Trim removal tools
- Pencil / Marker

**MOUNT BRACKET PARTS and HARDWARE:**

*Installation parts with \* come loose in hardware kit bag. Other parts are preassembled*

<b>QTY:</b>	<b>DESCRIPTION:</b>	<b>PART #:</b>
1	Main dash mount bracket	MT-0314-SA
1	Pivot / display mount bracket	MT-0320-SA *
1	PVC spacer washer	CM008582
1	Tilt swivel adaptor	CM008531
2	1/4" x 3/4" Carrage bolts	GSM32000
2	1/4" Nylock nut	GSM30016
2	1/4" Flat washer	GSM31005
2	Nylon 1/16" spacer washer	CM86600
1	Tilt swivel hinge	GSM22005
1	F-250 Display mount support bracket	MT-0316-SM
2	Standoff plate	MT-0317-SM
1	F-250 Rear mount support bracket	MT-0315-SM
1	M8 hex nut SS	GSM30113
1	M8 lock washer SS	GSM31217
4	Machine Screw 10-32 x 3/4"	GSM33119
4	#10 Flat washer	GSM31003
1	Vinyl cap (.50" high x .312 - .375 id)	GSM41127
1	Stop bracket	MT-0291-SM
2	M5 x 10mm Thread forming screw	GSM33774
2	Pull through bumper (3mm head)	GSM21109
2	Push in bumper (10mm head)	GSM21108
1	8-32 x .312" Phillips truss head machine screw	GSM34077 *
1	M6 hex nut	GSM30201
1	1/4" Flat washer	GSM31005
2	1/4" Serrated nut	GSM30023

**ALWAYS!**  
• Read all instructions before installing any Havis, Inc products.  
• Use hardware provided with install kit

C-DMM-2007 assembly

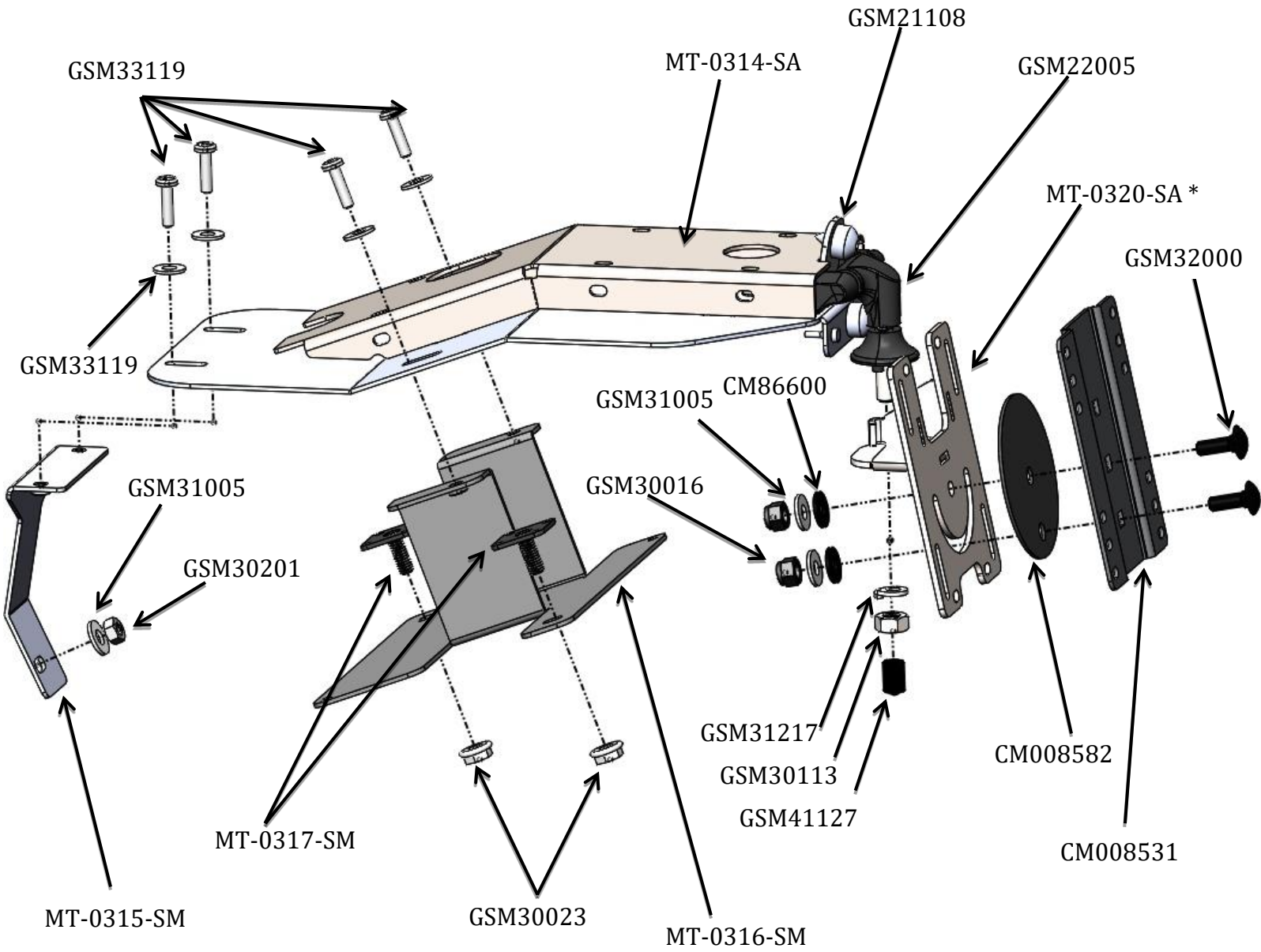



View of F-250 Super Duty prior to installation.



Remove panel containing OEM 12v socket.  
Remove fastener.  
(7 mm socket)

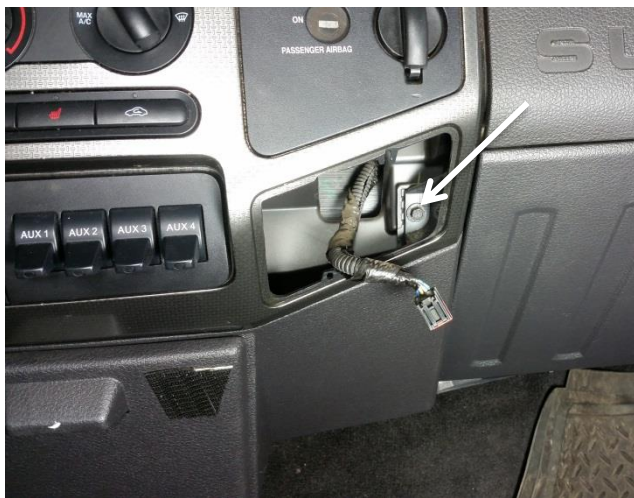

Remove panel containing aux input.  
Remove fastener.  
(7 mm socket)



Remove dash panel by gently prying along edges with a panel removal tool.

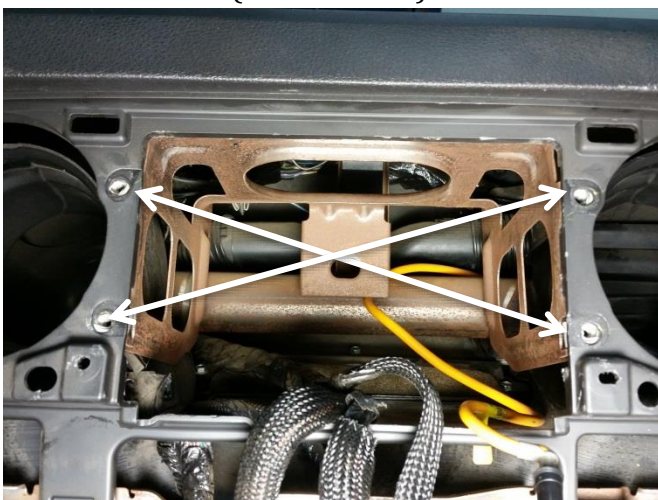

Remove four (4) fasteners and remove radio.

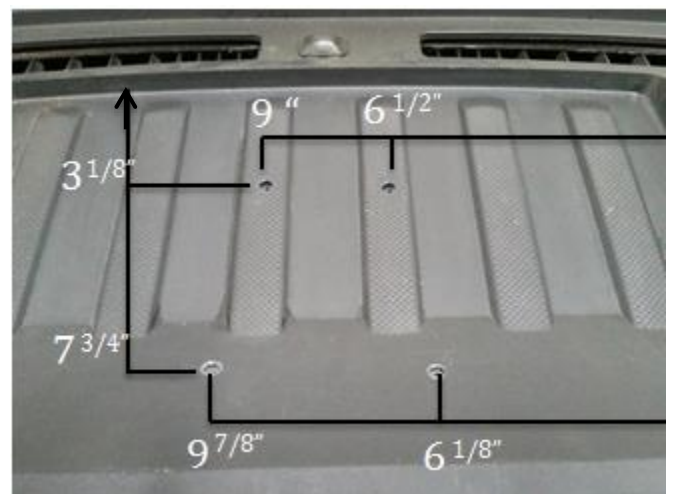

Following measurements above, drill four (4) 5/16" holes in top tray area.

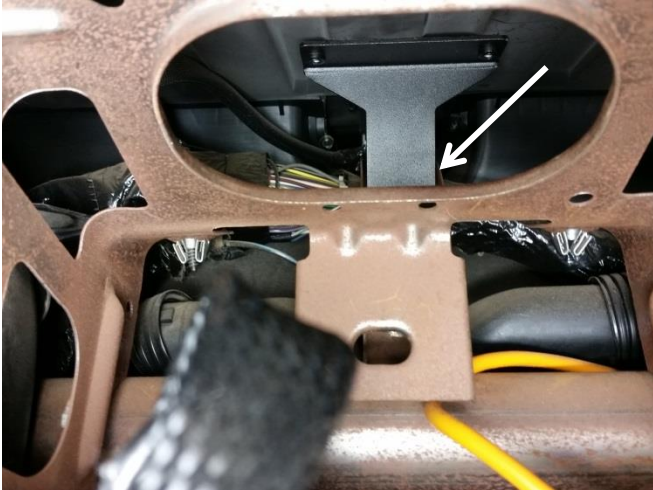

Install forward mount support bracket onto OEM stud on brace.



Use M6 nut and 1/4" washer to attach bracket to existing threaded stud.



Tighten hardware.  
(10mm socket)

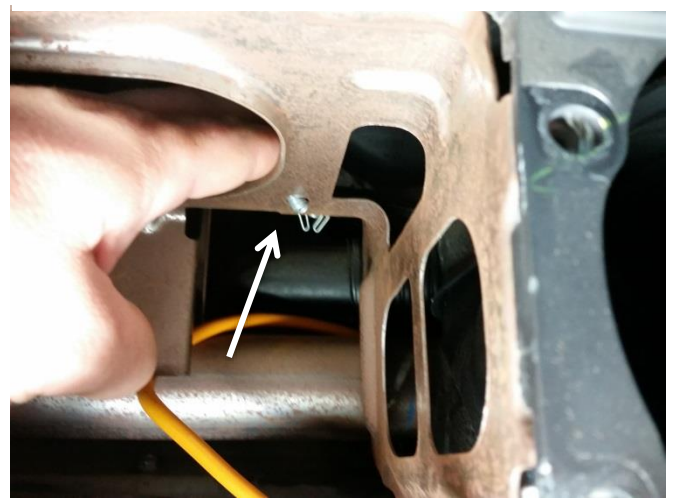

Insert MT-0317-SM standoff plates into the forward hole in upper radio frame.

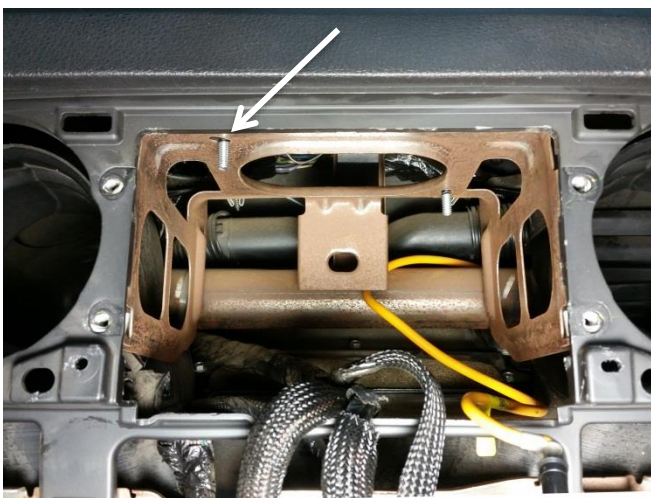

Repeat process for rear hole.

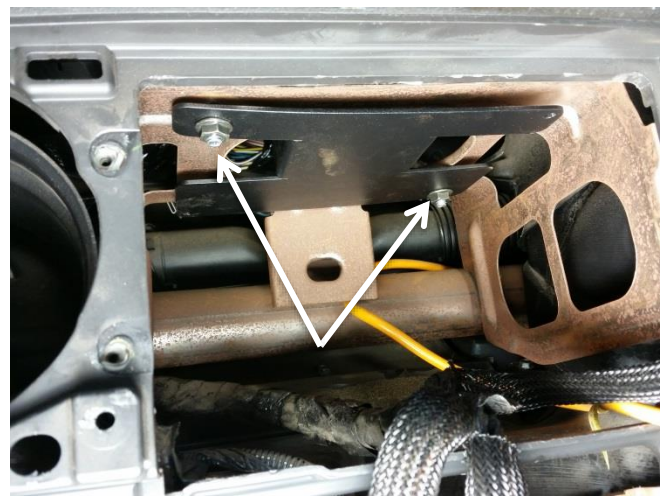

Attach display mount support bracket MT-0316-SM to the stand off plates using 1/4" serrated nuts.  
***Do not overtighten***



Recommended location for hole for wire harness run.

Attach the main mount bracket to the dash using 10-32 machine screws and washers.  
**Re-assemble dash at this time**



Connect harnesses to the back of the TSD-101 display. It is important to also double wire tie the harnesses to provide sturdy strain relief for the plugs.  
**USB connection from remote Docking station must plug into USB plug closest to front of display.**



Attach pivot / display mount bracket to display with M4 x 0.7 x 10mm Phillips head machine screws, lock washers and flat washers. Display mount hardware is included with TSD-101 hardware kit



Attach bracket with display to the tilt swivel hinge with M8 hex nut and lock washer. Tighten nut and attach vinyl cap on M8 bolt threads.



**Refer to TSD-101 owner's manual for power and computer connection details.**



Installation of C-DMM-2007 with TSD-101 complete.