



DreamGlider™

Owner's Manual



1 WARNING

Pages 3-10

2 Features

Pages 11

2-A Parts List

3 Assembly

Pages 12-24

3-A Frame Assembly

3-B Attaching Swing Arms

3-C Assembling Seat

3-D Attaching Seat to Frame

3-E Mobile

4 Use

Pages 25-37

4-A To Adjust Recline

4-B To Secure Infant

4-C To Use Vibration

4-D Installing Batteries

4-E To Use Wall Plug

4-F Starting Swing (6 Speeds)

4-G Problem Solving

5 Cleaning

Pages 38-44

5-A Care & Maintenance

5-B Replacement Parts

5-C Product Registration

WARNING

Prevent serious injury or death: Failure to follow these warnings and the assembly instructions could result in serious injury or death.

• **PLEASE SAVE OWNER'S MANUAL FOR FUTURE USE.**

• **THIS PRODUCT REQUIRES ADULT ASSEMBLY. Follow assembly instructions carefully.** If you experience any difficulties, please contact the Customer Service Department.

FALL HAZARD: To prevent falls, stop using the product in lowest 2 recline positions when:

- The infant begins to roll over or
- the child can pull up on sides (approx. 5 months)

• **TO PREVENT SERIOUS INJURY OR DEATH FROM INFANTS FALLING OR BEING STRANGLER IN STRAPS:**

- Always secure infant in the restraint system provided. After fastening buckles, adjust belts to get a snug fit around your infant.
- Never leave infant unattended in swing.
- Discontinue use of swing when infant attempts to climb out or becomes too active.
- Discontinue use of product when infant can roll over or push up on hands and knees.
- Never carry swing with infant in it.

- Discontinue use of swing when infant attempts to climb out or reaches 30 pounds (13.6 kg).

- **ALWAYS** place swing on floor. Never use on any elevated surface.

SUFFOCATION HAZARD:

Infants have suffocated:

- On added pillows, blankets and extra padding.
- **ONLY** use the pad provided by the manufacturer.
- **NEVER** place extra padding under or beside infant.
- Never place baby face down in product.
- To reduce the risk of SIDS, pediatricians recommend healthy infants be placed on their backs to sleep, unless otherwise advised by your physician.

• **STRANGULATION HAZARD:**

- Child can strangle in loose restraint straps. **NEVER** leave child in product when straps are loose or undone.
- **DO NOT** place swing in any location where there are cords, such as window blind cords, drapes, phone cords, etc.

! WARNING

- Strings can cause strangulation! **DO NOT** place items with a string around your child's neck, such as hood strings or pacifier cords.
- **DO NOT** suspend strings over the product or attach strings to toys.
- **DISCONTINUE USING YOUR SWING** should it become damaged or broken.
- Seat pad for use only with this product.
- **DO NOT** place product near water and moisture. Do not use the product near possible wet areas, such as a bathtub, shower, wash basin, sink, laundry tub, swimming pool, wet basement, etc.
- **DO NOT** use the AC adapter if it has been exposed to liquids, has been dropped, or is damaged.
- Protect the power cord. Place it so it is not walked on or pinched by furniture or other items.
- **DO NOT** use with an extension cord.
- Use only power cord provided.
- Only use the two lowest recline positions for sleep.
- Always use product with seat pad assembled.

WARNING

FOR SAFE BATTERY USE:

Keep the batteries out of children's reach.

Any battery may leak battery acid if mixed with a different battery type, if inserted incorrectly (put in backwards) or if all batteries are not replaced or recharged at the same time. Do not mix old and new batteries. Do not mix alkaline, standard (carbon-zinc) or rechargeable (nickel-metal hydride, nickel-cadmium) batteries.

Any battery may leak battery acid or explode if disposed of in fire or an attempt is made to charge a battery not intended to be recharged. Never recharge a cell of one type in a recharger made for a cell of another type.

Discard leaky batteries immediately. Leaky batteries can cause skin burns or other personal injury. When discarding batteries, be sure to dispose of them in the proper manner, according to your state and local regulations.

Remove batteries before storing product for a prolonged period of time. Batteries left in the unit may leak and cause damage.

Recommended type batteries—alkaline disposables, 5-D (LR20-1.5V). NEVER mix battery types. Change batteries when product ceases to operate satisfactorily.

WARNING

Changes or modifications not expressly approved by the party responsible for compliance could void the user's authority to operate the equipment.

NOTE: This equipment has been tested and found to comply with the limits for a Class B digital device, pursuant to Part 15 of the FCC Rules. These limits are designed to provide reasonable protection against harmful interference in a residential installation. This equipment generates, uses and can radiate radio frequency energy and, if not installed and used in accordance with the instructions, may cause harmful interference to radio communications.

However, there is no guarantee that interference will not occur in a particular installation. If this equipment does cause harmful interference to radio or television reception, which can be determined by turning the equipment off and on, the user is encouraged to try to correct the interference by one or more of the following measures:

- Reorient or relocate the receiving antenna.
- Increase the separation between the equipment and receiver.
- Connect the equipment into an outlet on a circuit different from that to which the receiver is needed.
- Consult the dealer or an experienced radio/TV technician for help.

This Class B digital apparatus meets all requirements of the Canadian Interference-Causing Equipment Regulations. CAN ICES-3 (B) /NMB-3 (B).

2-A Parts list

This model may not include some features shown below. **Check** that you have all the parts for this model **BEFORE** assembling your product. If any parts are missing, call Customer Service.

Tools required:
Philips Screwdriver

ALL MODELS

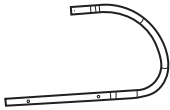
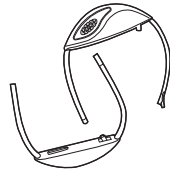
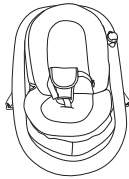
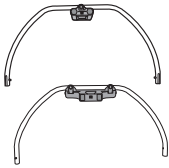

Six sided hole

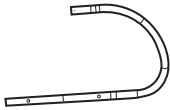

Oval shaped hole



2X

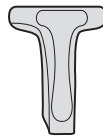
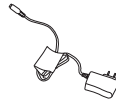

2X



Toy style may vary

3X

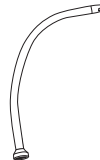

3-A Frame Assembly

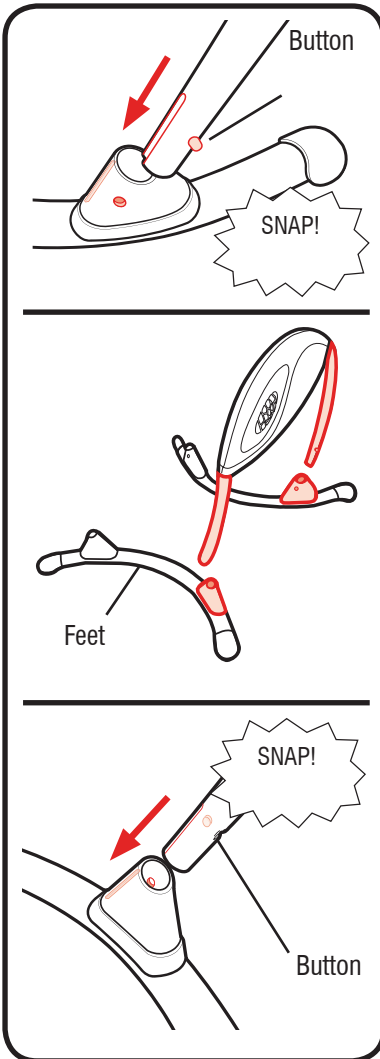
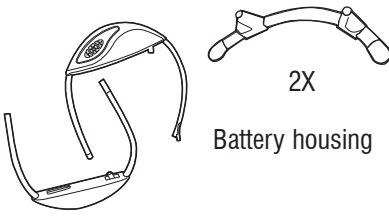

1. Lay feet on floor. Insert battery housing leg tubes into both feet as shown.

2. Insert the other leg tubes into both feet as shown.

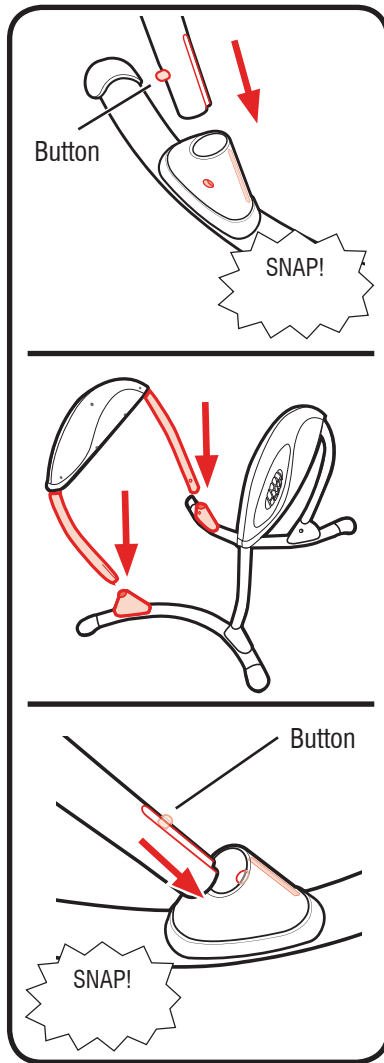

3-B Attaching Swing Arms

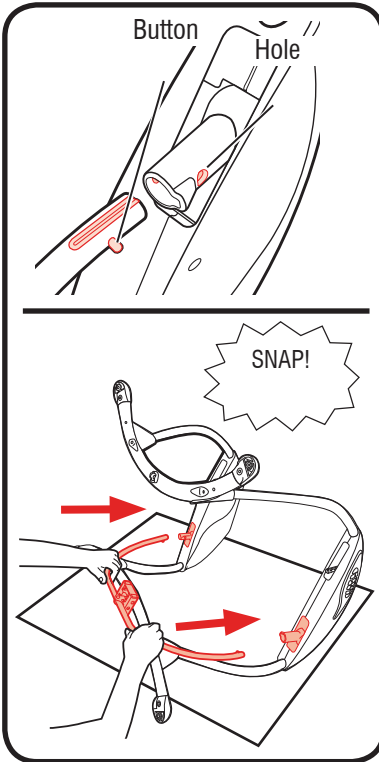
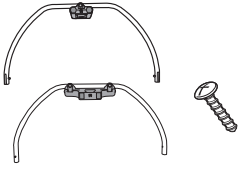

1. Insert the single hinge swing arm into the housing with buttons lining up with the hole in the housing as shown.

2. Attach hanger tube with double hinge until the buttons snap into place as shown.

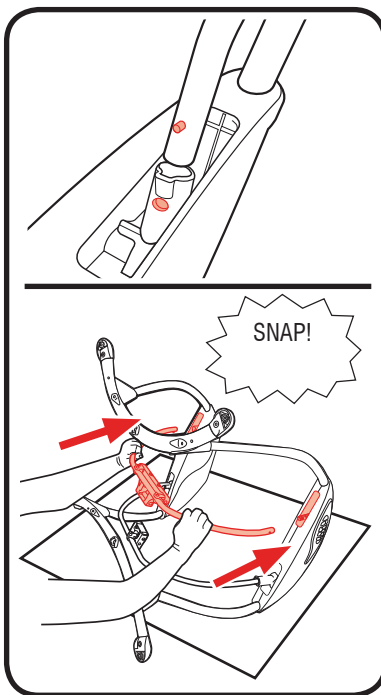

3. Fasten the screw as shown into hanger mount.

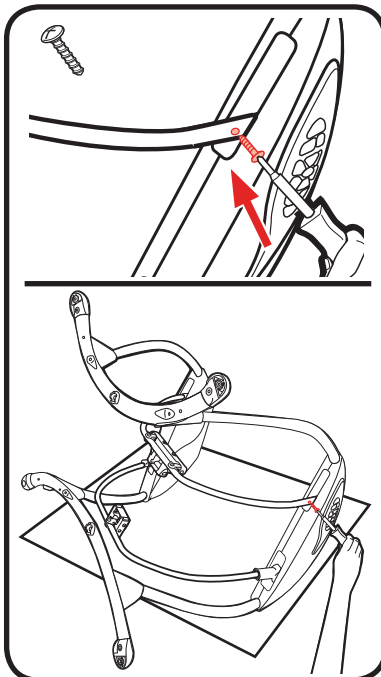

3-C Assembling Seat

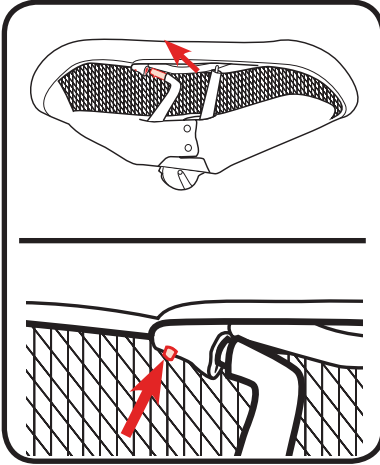

1. Insert side tube of seat into connector on tube as shown. CHECK that button is visible in hole in connector.

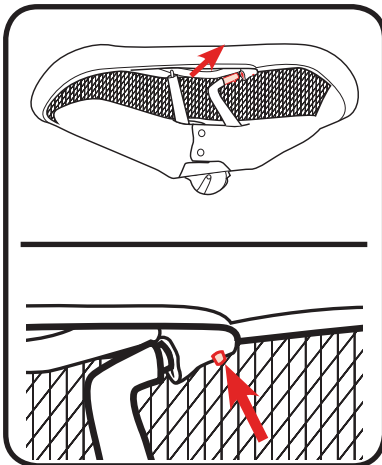

2. Insert side tube on other side of seat into connector on tube as shown. CHECK that button is visible in hole in connector.

3. Insert side wire into hole in tube as shown.

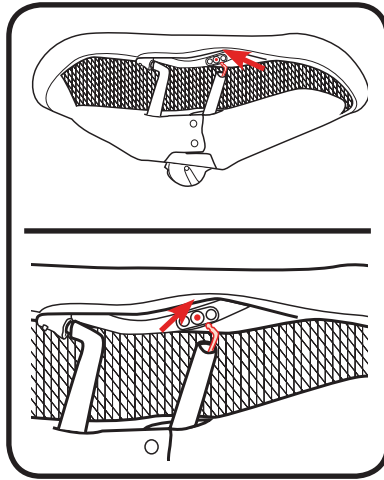

4. Insert side wire on other side of seat into hole in tube as shown.

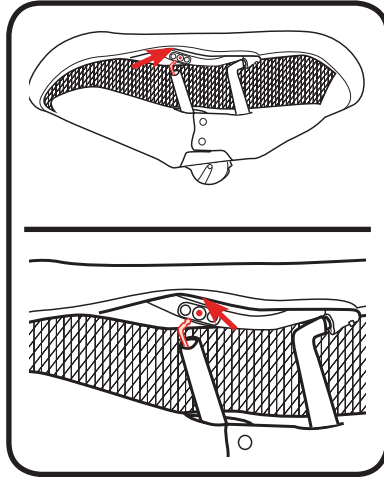

5. Attach hook and loop tape on both sides of seat.

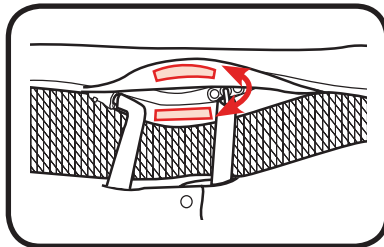

3-D Attaching Seat to Frame

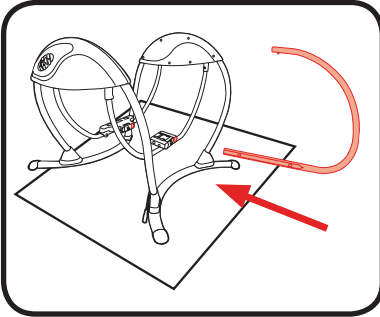
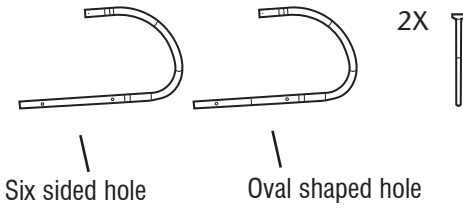

1. Insert the hanger tube with the six-sided holes into the swing arm bracket as shown.

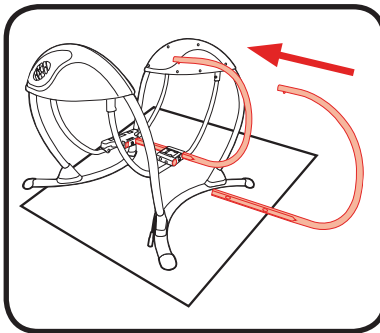

2. Insert the hanger tube with the oval-shaped holes into the swing arm bracket as shown.

3. Insert a bolt through the holes in the swing arm bracket as shown. Tighten bolt with the wrench provided. Repeat with the other bolt on the other bracket.

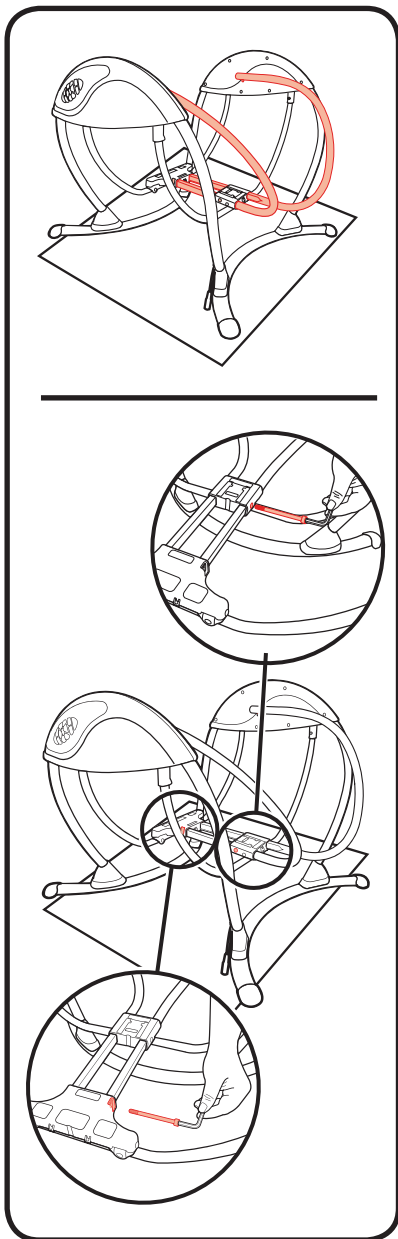

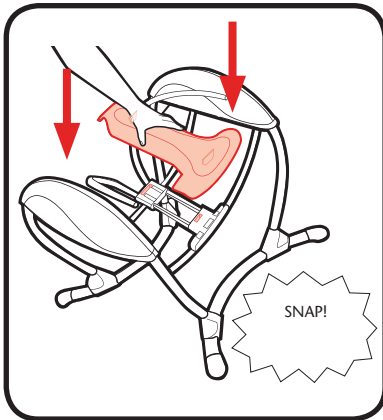
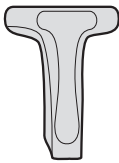

4. Attach plastic cover over tubes as shown until it snaps into place.

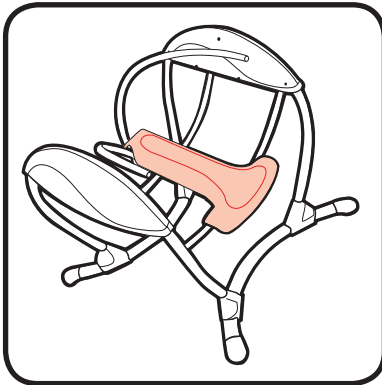

5. CHECK to make sure the cover is attached by pulling up on it.

6. Place assembly onto the side and insert the hanger tube into the sides of the seat tube until it clicks into place.

CHECK to make sure hanger tubes are attached by pulling on them.

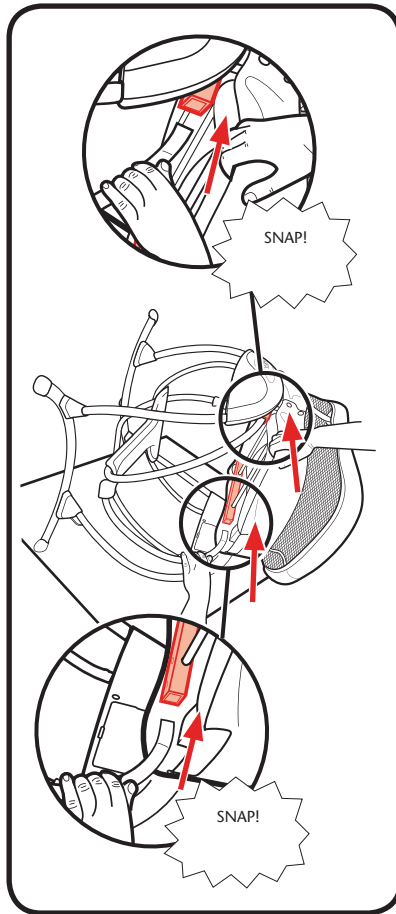

3-E Mobile

! WARNING

- Possible entanglement injury. Keep out of baby's reach. Remove mobile from product when baby begins to push up on hands and knees. Recommended use from birth to 5 months.
- This mobile is intended for visual stimulation and is not intended to be grasped by the child.
- Always attach all provided fasteners (strings, straps, clamps, etc.) tightly to the product according to the instructions. Check frequently.
- Do not add additional strings or straps to attach to any other product.
- The mobile is not a carry handle. Never use mobile to lift or carry product.

Toy style may vary

3X

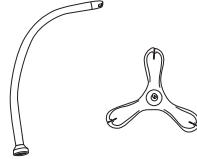

1. Attach elastic loop on the mobile around the hook on the mobile arm.

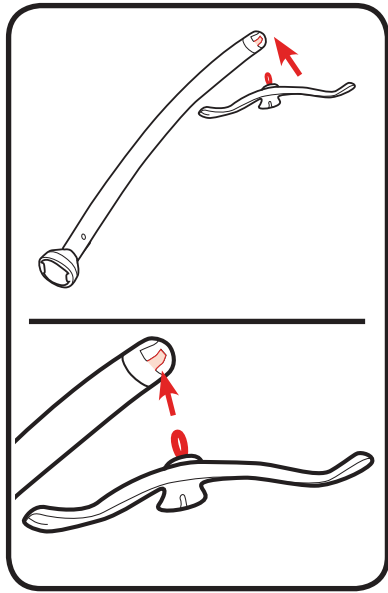

2. Attach toys to mobile by sliding ropes on toys into slots in mobile.

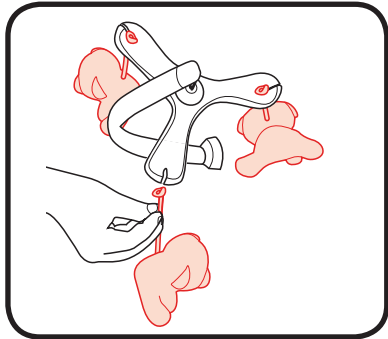

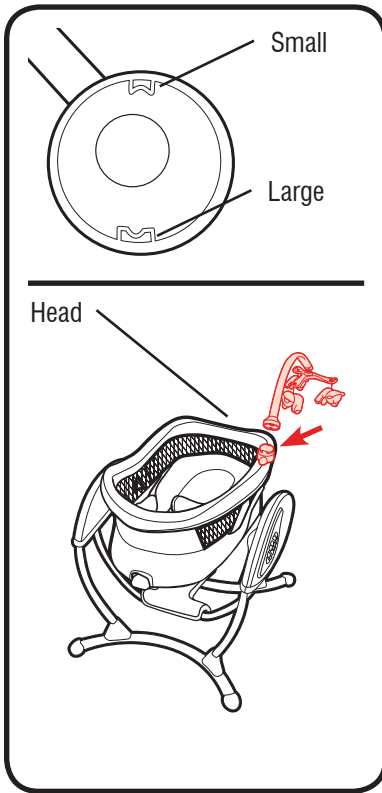

3. With small tab inside of mobile towards the head end of the swing, insert the tabs into the grooves in the mobile mounts and push down.

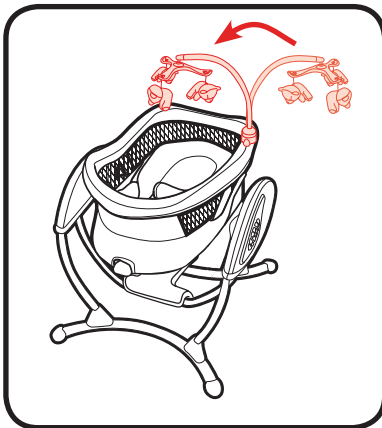

4. Twist mobile around counter-clockwise and lock mobile in place over child area of swing.

4-A To Adjust Recline (3 positions)

Use the most reclined position for newborn and young babies.
Use the more upright position for older, more active infants.

1. To raise or recline, squeeze handle and push seat up or down.

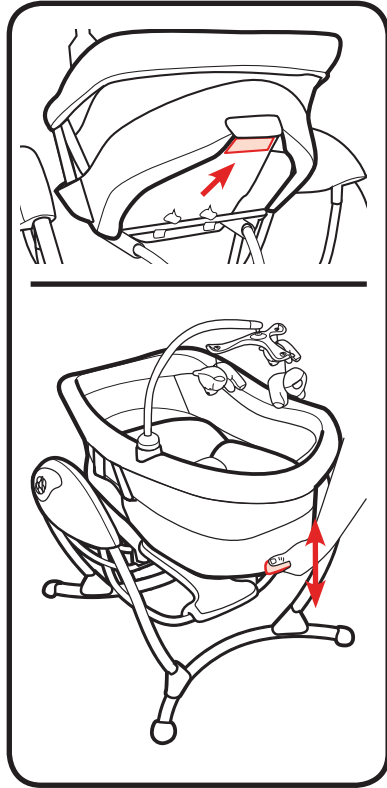

4-B To Secure Infant

! WARNING **Falling Hazard:** Always use the seat belt.

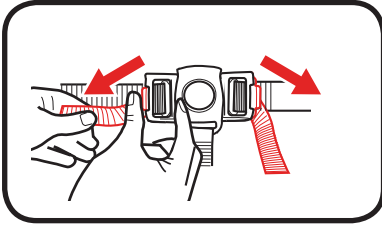

1. Use slide adjuster at waist for further adjustment.

2. To release press button in center of buckle.

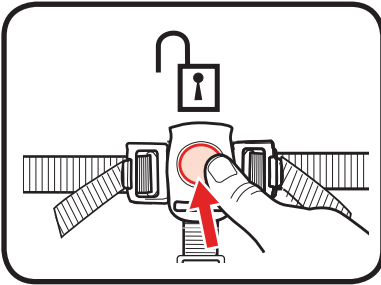

3. To secure waist straps into sides of buckle.

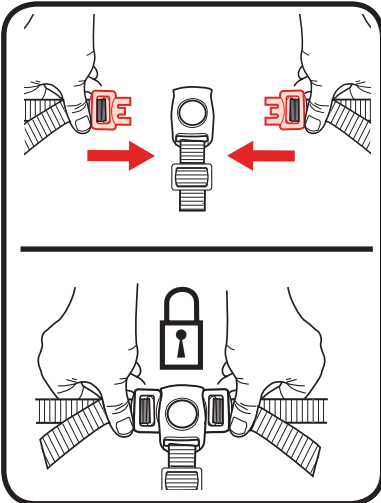

4-C To Use Vibration

1. Remove battery lid, found under seat, with a key and insert 1-D (LR20-1.5V) battery in module. Replace lid.

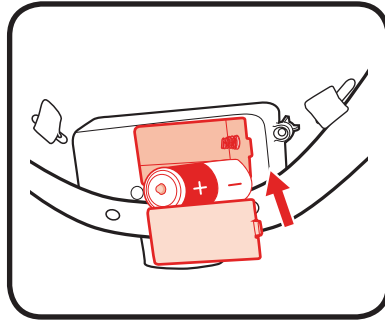

2. **Vibration:** To use integrated vibration switch, slide button to left or right for hi or lo speed.

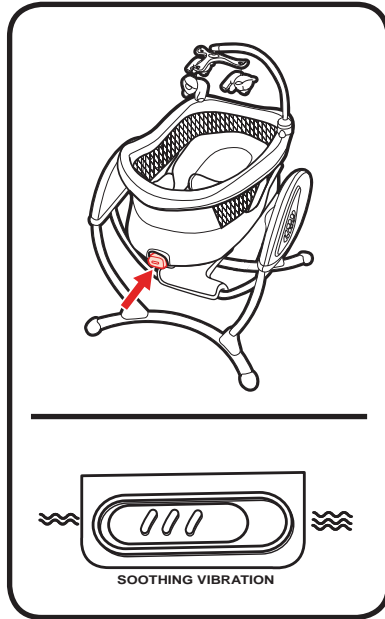

4-D Installing Batteries (not included)

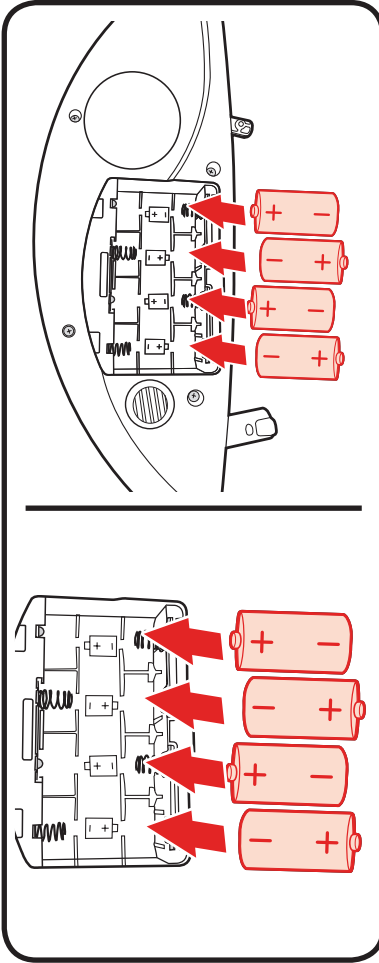

1. **With baby out of swing**, open the battery compartment lid by inserting a key into the slot. Insert four D (LR20 -1.5V) batteries. Replace battery lid.

CHECK that the batteries are put in correctly. Your swing will not run if the batteries are put in backwards. Refer to WARNINGS, For Safe Battery use.

4-E To Use Wall Plug

! WARNING Product does not recharge batteries. When AC adapter is in use, batteries will automatically shut off.

DO NOT place product near water and moisture. Do not use the product near possible wet areas, such as a bathtub, shower, wash basin, sink, laundry tub, swimming pool, wet basement, etc.

DO NOT use the AC adaptor if it has been exposed to liquids, has been dropped, or is damaged.

Protect the power cord. Place it so it is not walked on or pinched by furniture or other items.

! WARNING Strangulation Hazard: Keep this cord out of the reach of children. **DO NOT** use with an extension cord.

Use only power cord provided.

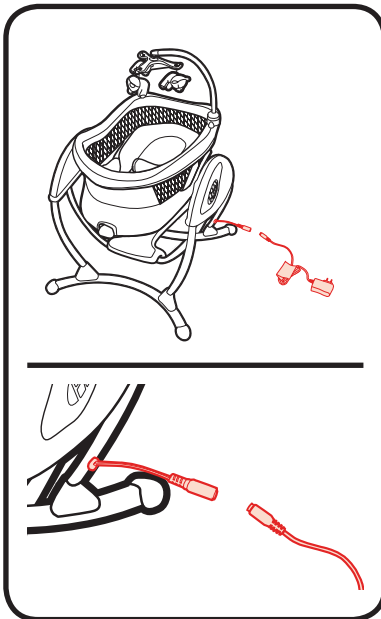
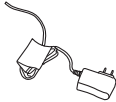

4-F Starting Swing (6 Speed)

! WARNING Avoid serious injury from falling or sliding out. Always use seat belt. After fastening buckles, adjust belts to get a snug fit around your infant.

TO TURN SWING ON:

Press On /Off button or press any speed from 1 to 6. When pressing On/Off button, it automatically starts with the last speed setting that was selected before the swing was turned off.

Observe the swinging motion for a minute. It takes time for the swing to adjust to a setting. Change setting if needed.

A small, quiet baby will swing higher on each setting than a larger, more active baby.

Your seat may be stopped at any time the motor is running without damaging the motor. Push swing to restart.

If your swing motor stops operating by itself, a protective device may have been activated. Turn off motor, wait three minutes, then restart swing.

TO TURN SWING OFF: Press On /Off button.

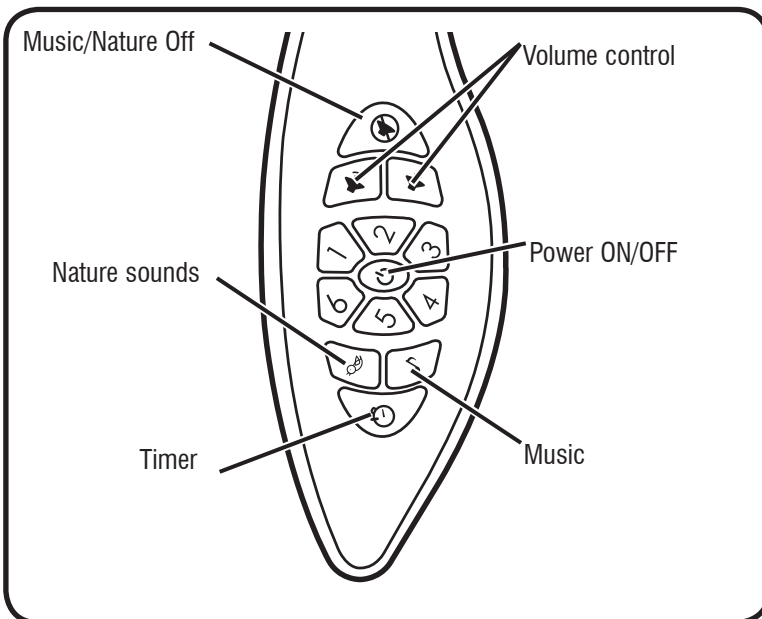

SPEED - Press On /Off button or press any speed from 1 to 6. When pressing On/Off button, it automatically starts with the last speed setting that was selected before the swing was turned off.

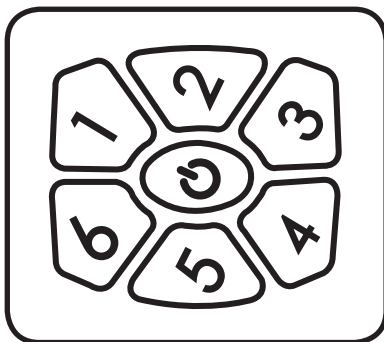

ON/OFF POWER - Press to turn ON and turn OFF. Press button to stop swing motion.



MUSIC - Push “**Music**” button to turn on music. Push button again to advance to next track. There are 10 songs.

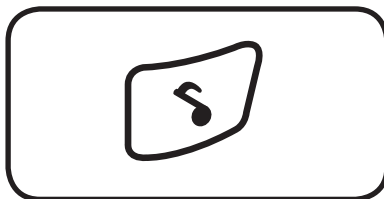

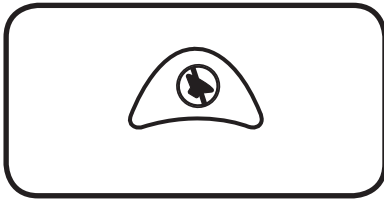

MUSIC/NATURE OFF - Press button to turn OFF.

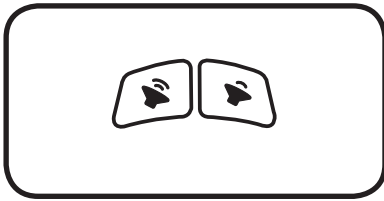

VOLUME— Press the plus (+) to raise the volume and the minus (-) to lower the volume. There are 5 volume settings.

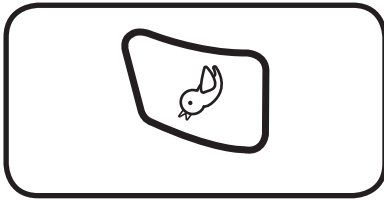

NATURE SOUNDS— Push “**Nature**” button to turn on nature sound selection. Each press will change to the next nature sound. After the 5th sound is selected, it will return to the first track.

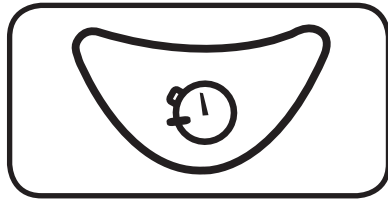

TIMER— Push “**Timer**” button to set the timer for the swing and/or Music/Nature sounds. If the timer button is not pushed, the swing and/or music/nature sound will continue to play until the power on/off button is pushed or the music/nature off button is pushed.

When using the timer with the swing on, if the button is pushed once, the red speed light will flash once and timer is set for 10 minutes. Pushing the timer button a second time will increase the run time to 20 minutes and the red speed light will flash twice. Pushing a third time will increase the time to 30 minutes and the red speed light will flash three times.

When using the timer with the Music/Nature sounds on, the timer will set to 10, 20 or 30 minutes as described for the swing, but there will be no flashing light.

4-G Problem Solving

SWING WON'T OPERATE:

1. No batteries in swing.
2. Batteries dead.
3. Speed setting too low.
4. Batteries in backwards — check “+” and “-”.
5. Corrosion on battery terminals. Rotate batteries in place against terminals, or clean with sandpaper or steel wool if corrosion is severe.
6. Baby leaning too far forward.
7. Baby grabbing swing legs. (Discontinue use.)
8. Seat not pushed high enough for a good start.

SEAT DOESN'T SWING VERY HIGH:

1. Control setting too low.
2. Blanket hanging down, causing increased wind resistance.
3. Batteries too weak.
4. Baby too heavy or too active. (Discontinue use.)
5. Soft carpet (swings higher on hard floors).

A Care and Maintenance

6-**FROM TIME TO TIME CHECK YOUR SWING** for loose screws, worn parts, torn material or stitching. Replace or repair the parts as needed. Use only Graco replacement parts.

7-**TO CLEAN SEAT**, wipe clean with damp cloth.

8-**TO CLEAN HARNESS COVER AND SEAT PAD:** (if so equipped) Refer to your care tag on your seat pad for washing instructions. NO BLEACH.

9-**TO CLEAN FRAME**, use only household soap and warm water. NO BLEACH OR DETERGENT.

10-**EXCESSIVE EXPOSURE TO SUN OR HEAT** could cause fading or warping of parts.

To Remove Harness Cover and Seat Pad for Cleaning

1. Lift flap on harness cover.

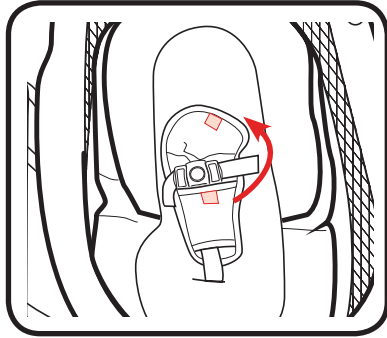

2. Open harness.

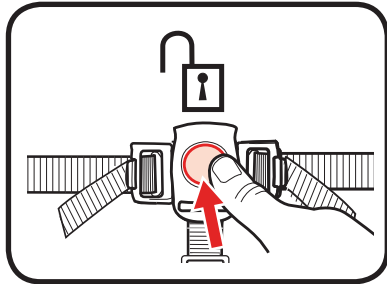

3. Remove harness cover.

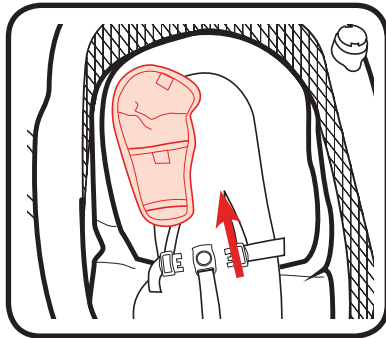

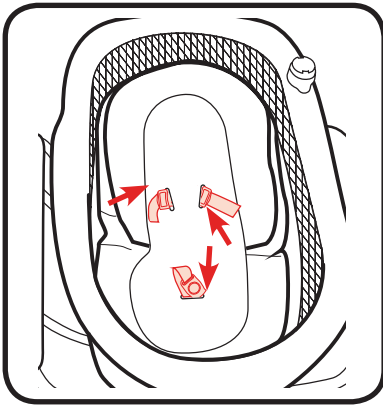

4. Slide harness straps through seat pad.

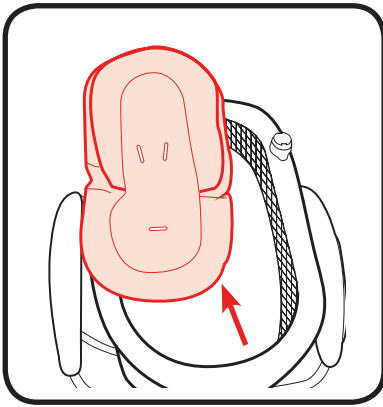

5. Remove seat pad.

6. Reverse steps to re-attach crotch pad and seat pad.