



Side Window Deflectors

**Before installing the deflector, please, read the manual.
Incorrect installation of deflectors can cause danger or injury.**

CAUTION! IMPORTANT INFORMATION!



CAUTION! Before installation, make sure the deflectors are compatible with your vehicle. The size and modification of each set is unique and never universal.

- In case you having hard time to adjust the deflector please follow the procedures below:
 - Make sure you install the deflector on the correct side of the vehicle. Otherwise, try to install the deflector on the other side.
 - Try to adjust the position of the deflector by moving it up/down or sideways.
- Before the trip, make sure the deflectors are securely installed.
- Do not use automatic car washing machines.
- Do not use cleaners that contain dissolving agents.
- It is recommended not to wash the vehicle for the first 24 hours after installation, as it can cause detaching.

Contents (according to the purchased set):

2 Piece Set (the product may differ from the shown in the instruction)

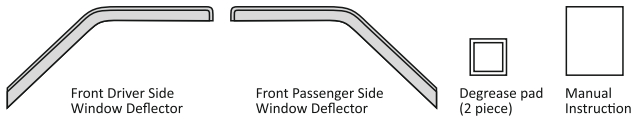

4 Piece Set (the product may differ from the illustration in the instruction)

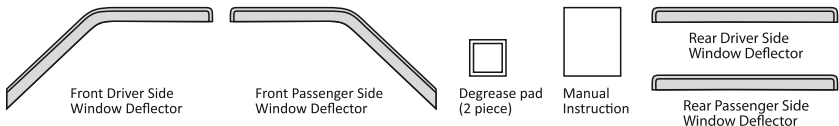

Preparing the vehicle and the product for installation

- **CAUTION!** Before installing the deflector, make sure the deflector is compatible with your car model.
- Attach the deflector to installation point BEFORE removing the tape protective liner. Make sure the deflector looks harmonious on the door of the vehicle.
- Make sure the installation point is absolutely dry and clean (take care to remove any possible dirt and/or dust).
- Deflectors are recommended for installation indoor without direct sunlight and moisture, temperature in range from +15°C to +25°C (from +59°F to +77°F).

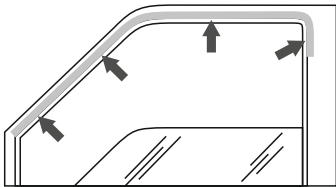
1

Wipe the installation point with the degrease prep-pad provided in the set (**CAUTION!** If you neglect this step deflectors won't be installed properly resulting in detaching from the vehicle door).

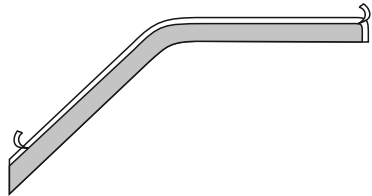
2

Remove 1 inch (2 cm) of the tape liner from the both flanges (front and rear) of the deflector.

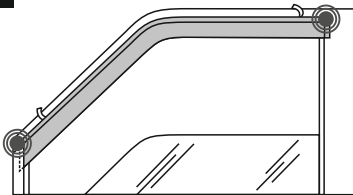
3

Attach the deflector and press it slightly to the best suited installation point (in your view) at the vehicle door.

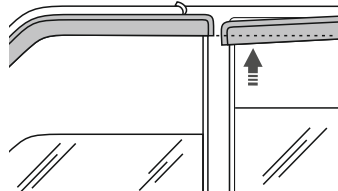
4

If you have 4 Piece Set, first attach FrontDriver Side Window Deflector and then the rear one. Align height of the rear deflector and front. Both parts should visually produce one straight line.

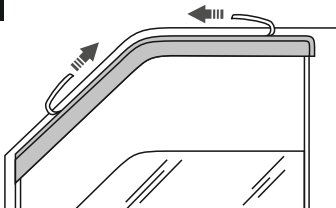
5

Totally remove the tape protective liner by pulling on free ends on the installed and aligned deflector(s) in sliding manner.

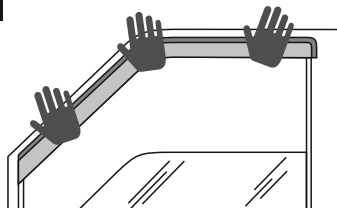
6

Tightly press the deflector to the installation point from one flange to another.



To avoid loose detaching of deflector(s) shortly it **SHOULD NOT** be removed and attached again to a vehicle door. Do the same (re-do steps 1-5) for the Opposite Side of the vehicle.

Maintenance and cleaning

- The deflector is durable and flexible. **CAUTION!** To prevent scratches on deflectors we recommend not cleaning deflectors frequently with dry hard while washing, cleaning and dusting the vehicle.
- The recommended vehicle speed within 72 hours after installation is no more than 55 m/hr.
- Do not drive the vehicle for 24 hours after installation for better adhesion (cohesion) between the deflector and the vehicle door.
- Keep the vehicle out of direct sunlight, rain or snow during 24 hours after deflectors' installation.

Congratulations!

Your Unique Durable deflectors GoodYear are installed and gives joy to you with it! From this moment you could enjoy their appearance!

We are glad to work for you and your vehicle to produce high quality products, which have ideal fitment, easy installation and you could enjoy using them every day.



Goodyear (and winged foot design) and Blimp are trademarks of The Goodyear Tire & Rubber Company.
Copyright 2018 The Goodyear Tire & Rubber Company.

Discover other rain guards and wind deflectors on our website.