

# INSTALLATION INSTRUCTIONS

BRACKET	WIDESIDER BAR 4"	WTW 4"	RUNNING BOARD 5" & 6"	APPLICATION	MODEL
390305	394030	-	39087	FORD SUPER DUTY CREW CAB.	99 - 10
	394032	-	39080	FORD SUPER DUTY EXT. CAB.	99 - 10
	-	394330	-	FORD SUPER DUTY CREW CAB. 6'	99 - 10
	-	394332	-	FORD SUPER DUTY EXT. CAB. 6'	99 - 10
	64180	-	680087	FORD SUPER DUTY CREW CAB.	99 - 10
	64176	-	680080	FORD SUPER DUTY EXT. CAB.	99 - 10

**Parts List:**

ITEM	QTY	CODE	DESCRIPTION	MAX. TORQUE
1	3	390304BB	Brackets set	-
			<b>KTE-390305 Hardware kit includes:</b>	
2	12	-	5/16" Box head bolt	11 lb.ft
3	12	-	5/16" Flat washer	-
4	12	-	5/16" Lock washer	-
5	12	-	5/16" Hex nut	11 lb.ft
6	8	-	3/8 x 1 1/4" Hex head bolt	30 lb.ft
7	6	-	3/8" Flat washer	-
8	12	-	3/8" Lock washer	-
9	12	-	3/8" Hex nut	30 lb.ft
10	12	-	3/8" Clip nut	30 lb.ft
11	1	-	Oval 4" Widesider bar set	-

**Tools required not including:**

DESCRIPTION	QTY
Socket / wrench 1/2"	1
Socket / wrench 9/16"	1
Socket 17mm / Wrench 15mm	1
Ratchet	1
Extension ratchet	1

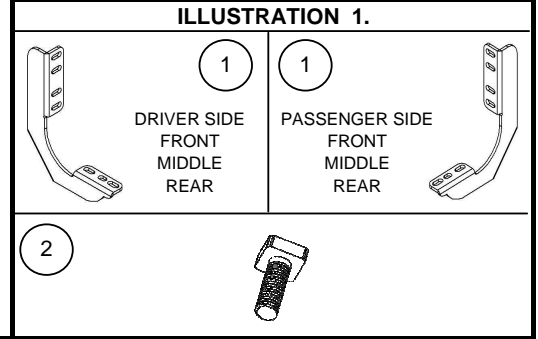

**NOTA: 394030(9-8-6-0) / 394032(9-8-6-0) / 394330(9-6) / 394332(9-6) / 64180(B-C-PS-SB) / 64176(B-C-PS-SB) ADEMÁS:**

**Approximated installation time: 30 min.**

**Instructions:**

1. Before beginning the installation read all instructions thoroughly and verify that all hardware is accounted for. If there are any listed parts missing, please notify your distributor immediately.

**ILLUSTRATION 2.**

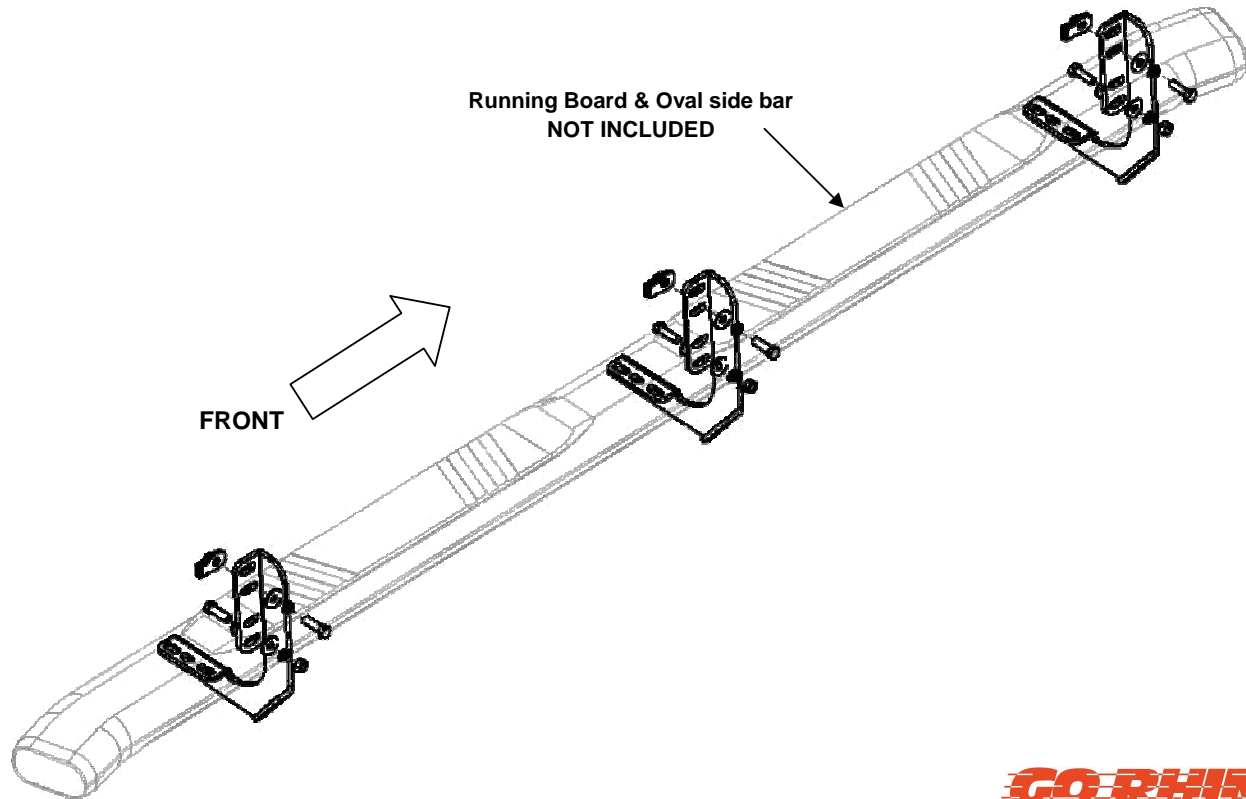

Illustration driver side.



**Cleaning and care instructions:**

Protect the finish with a non-abrasive automotive wax, (e.g. Pure Carnauba) on a regular basis. The use of any soap, polish, or wax that contains an abrasive is detrimental to the finish, as the compounds scratch the finish and cause corrosion.

Design:

Quality:

## INSTALLATION INSTRUCTIONS

2. Located holes inside the body in vehicle, front, middle, rear, place a clip nut in upper part. **See illustration 3.**

### ILLUSTRATION 3.

To install the brackets in rocker panel.

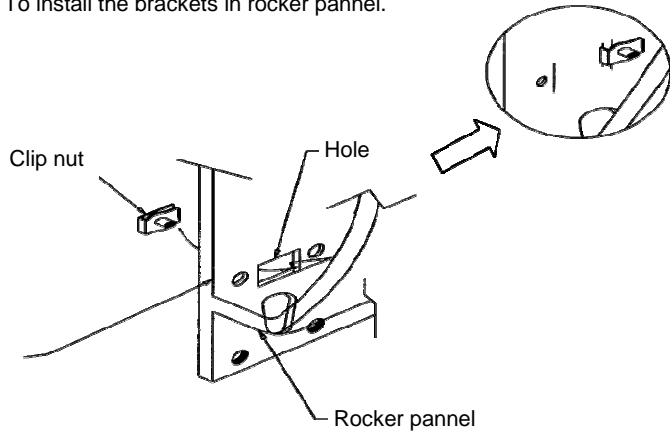

3. Mount bracket and attach with: ( 1 ) 3/8 x 1 1/4" hex head bolt, ( 1 ) 3/8" flat and lock washers, in lower part attach with: ( 1 ) 3/8 x 1 1/4" hex head bolt, ( 2 ) 3/8 flat washer, ( 1 ) 3/8" lock washer, ( 1 ) 3/8" hex nut. **See illustration 4.** By each bracket. Leave loose.

### ILLUSTRATION 4.

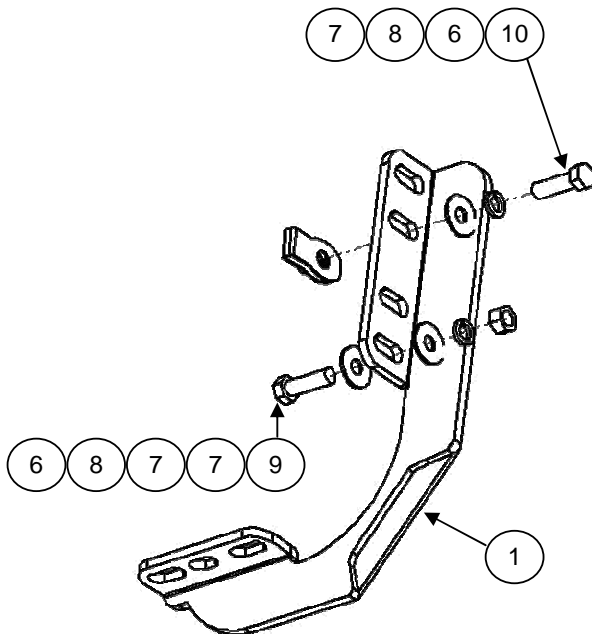
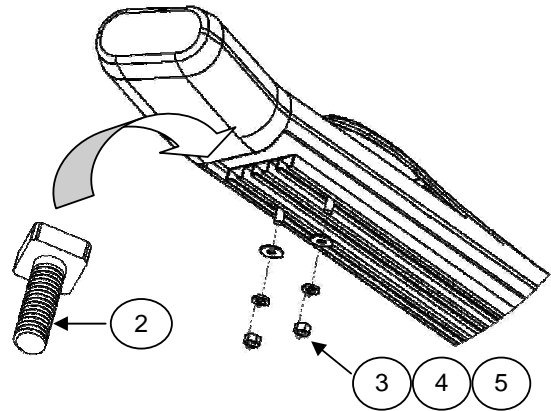

Illustration to front, middle and rear part. Driver side.

4. For Installation Running Board 5" & 6", inserting ( 3 ) square head bolt within each lateral rail of the side bar. **See illustration 5.** Mounts the side bar on brackets, aligns and attach with: ( 2 ) 5/16" flat and lock washers, ( 2 ) 5/16" hex. nut. Repeats for bracket each. Leave loose.

### ILLUSTRACION 5.



5. For installation oval side bar 4". **See illustration 6.**

6. Align Side bar, and then get tighten all bolts. It repeats to install the opposite side ( Passenger ).

7. Do not use abrasive substances to clean your product.

8. Periodically check your product because it may need a re-tighten of bolts.

9. Fill the warranty card and place it inside your vehicle's glove box.

### ILLUSTRACION 6.

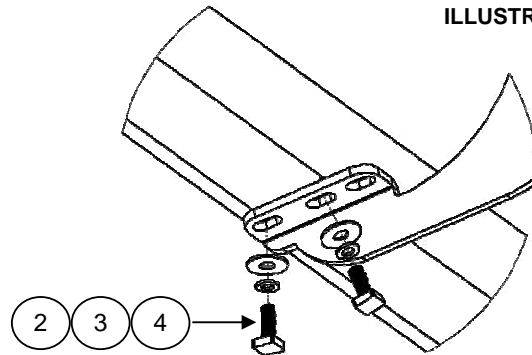

#### Cleaning and care instructions:

Protect the finish with a non-abrasive automotive wax, (e.g. Pure Carnauba) on a regular basis. The use of any soap, polish, or wax that contains an abrasive is detrimental to the finish, as the compounds scratch the finish and cause corrosion.

Design:

Quality: