

# INSTALLATION INSTRUCTIONS

| BRACKET | OVAL SIDE BAR<br>WIDESIDER 4" | WHEEL TO WHEEL<br>WIDESIDER 4" | RUNNING BOARD<br>WIDESIDER 5" & 6" | APPLICATION                      | MODEL          |
|---------|-------------------------------|--------------------------------|------------------------------------|----------------------------------|----------------|
| 684049  | 64046<br>67046                | -                              | 39087                              | GMC SIERRA / SILVERADO CREW CAB. | 99 - 06 & 2011 |

## Parts List:

| ITEM                                      | QTY | CODE       | DESCRIPTION                            | TORQUE MAX. |
|---|-----|------------|--|-------------|
| 1   | 1   | 391014AA   | Front mounting bracket set             | -           |
| 2   | 1   | 391014DA   | Middle mounting bracket set            | -           |
| 3   | 1   | 391014BA   | Rear mounting bracket set              | -           |
| 4   | 2   | 391014FA   | Front and middle auxiliary bracket set | -           |
| 5   | 1   | 391014EA   | Rear auxiliary bracket set             | -           |
| 6   | 6   | 3713312    | 5/16" bolt plate                       | 11 Lb-Ft    |
| 7   | 12  | KTE-391015 | Hardware kit including:                | 11 Lb-Ft    |
| 8   | 18  | -          | 5/16" Square head bolt                 | -           |
| 9   | 18  | -          | 5/16" Flat washer                      | -           |
| 10  | 18  | -          | 5/16" Lock washer                      | -           |
| 11  | 6   | -          | 5/16" hex nut                          | 11 Lb-Ft    |
| 12  | 6   | -          | M12 x 120mm Hex head bolt              | 70 Lb-Ft    |
| 13  | 6   | -          | 1/2" Flat washer                       | -           |
| 14  | 6   | -          | 1/2" Lock washer                       | -           |
| 15  | 6   | -          | 3/8 x 1" Carriage head bolt            | 30 Lb-Ft    |
| 16  | 6   | -          | 3/8" Flat washer                       | -           |
| 17  | 6   | -          | 3/8" Lock washer                       | -           |
| 18  | 6   | -          | 3/8" Hex nut                           | 30 Lb-Ft    |
| <b>NOTE: 64046-67046 (B-PS) INCLUDES:</b> |     |            |  |             |
| 18  | 1   | -          | Oval side bar widesider 4"             |             |

## Tools required not including:

| DESCRIPTION  | QTY |
|--|-----|
| Socket hex 18mm-19mm -9/16" - 1/2"                 | 1   |
| 17mm Double hex socket ( 12 point ) or 15mm Wrench | 1   |
| Ratchet  | 1   |
| Extension ratchet                                  | 1   |

## ILLUSTRATION 1

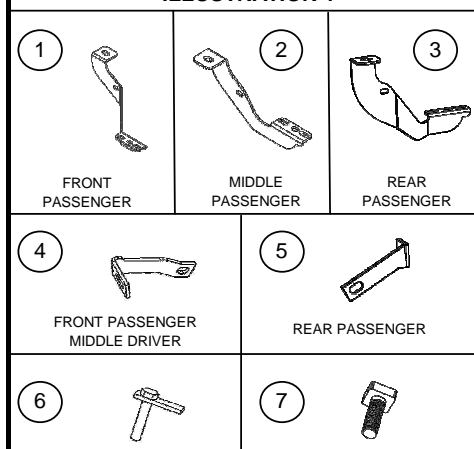

## Instructions:

Approximated installation time: 40 min.

1. Before beginning the installation read all instructions thoroughly and verify that all hardware is accounted for. if there are any listed parts missing, please notify your distributor immediately.

## ILLUSTRATION 2

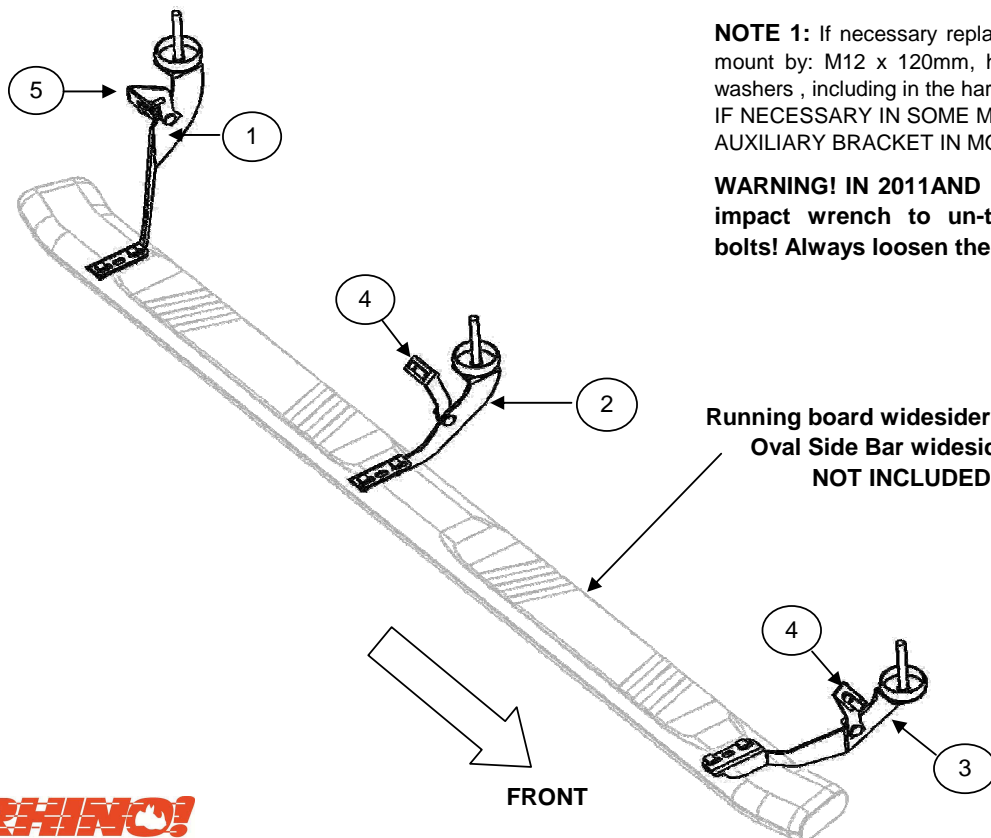

**NOTE 1:** If necessary replace each bolt that holds the body mount by: M12 x 120mm, hex head bolt, 1/2" flat and lock washers , including in the hardware kit.  
IF NECESSARY IN SOME MODELS DRILL TO INSTALL THE AUXILIARY BRACKET IN MODEL 99 - 02

**WARNING! IN 2011AND UP MODELS. Do not use an impact wrench to un-tighten the body mounting bolts! Always loosen them by hand.**

Running board widesider 5" & 6" /  
Oval Side Bar widesider 4"  
NOT INCLUDED

**GO RHINO!**  
PRODUCTS®

Illustration driver side.

## Cleaning and care instructions:

Protect the finish with a non-abrasive automotive wax, (e.g. Pure Carnauba) on a regular basis. The use of any soap, polish, or wax that contains an abrasive is detrimental to the finish, as the compounds scratch the finish and cause corrosion.

Design:

Quality:

## INSTALLATION INSTRUCTIONS

2. Locate and remove the body mount in the front part. **SEE PICTURE 1.**

**PICTURE 1**

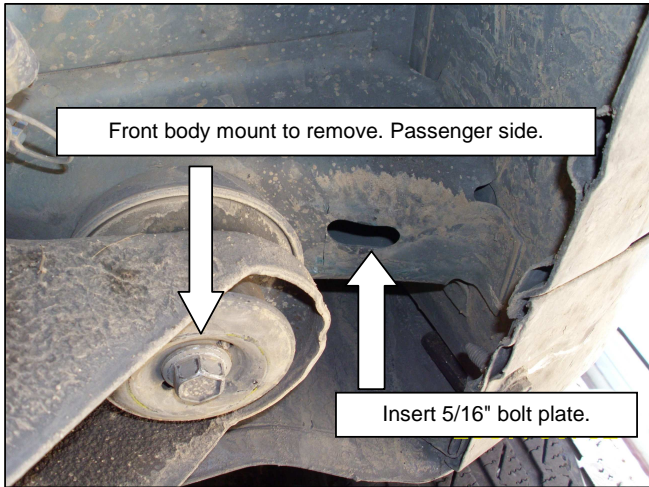

3. Install the front bracket and attach with bolts before removed. Locates the hole that is in the rocker of the vehicle and inserts 5/16" bolt plate.

Mounts the front auxiliary bracket and attach with: 5/16" flat and lock washers, 5/16" hex nut. In the other side of the bracket attach with the front bracket: 3/8 x 1" carriage head bolt, 3/8" flat and lock washers, 3/8" hex nut. **SEE PICTURE 1, ILLUSTRATION 3.** Leave loose.

**ILLUSTRATION 3**

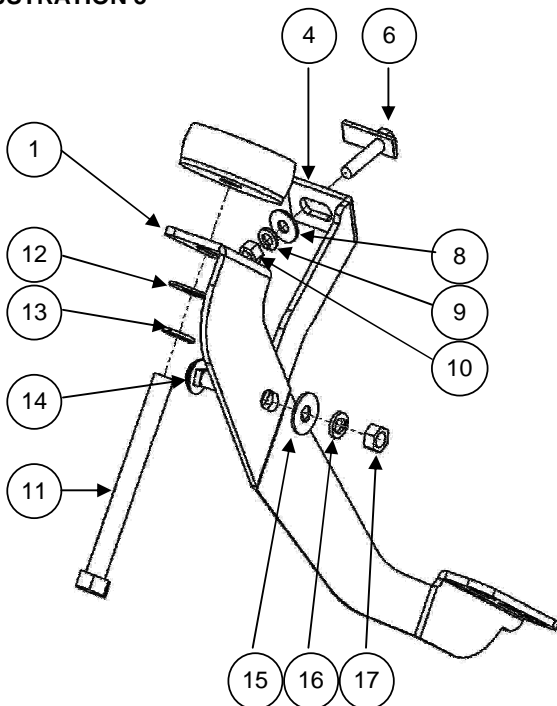

Use ratchet & 18mm - 19mm - 9/16" - 1/2" hex socket.  
Remove the bolt OEM with: ratchet & 18mm hex socket.

**PICTURE 2**

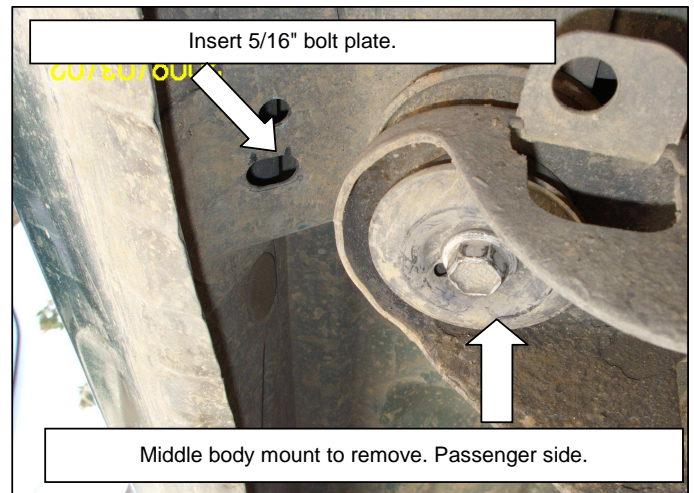

5. Install the middle bracket and attach with bolts before removed. Locates the hole that is in the rocker of the vehicle and inserts 5/16" bolt plate.

Mounts the middle auxiliary bracket and attach with: 5/16" flat and lock washers, 5/16" hex nut. In the other side of the bracket attach with the middle bracket: 3/8 x 1" carriage head bolt, 3/8" flat and lock washers, 3/8" hex nut. **SEE PICTURE 2, ILLUSTRATION 4.** Leave loose.

**ILLUSTRATION 4**

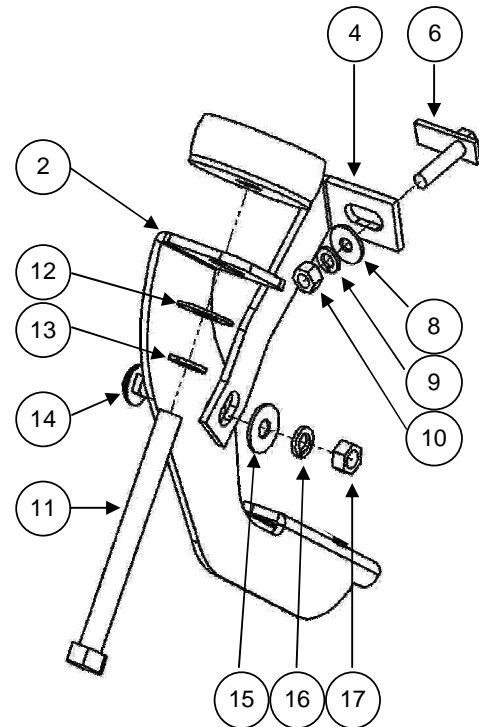

Use ratchet & 18mm - 19mm - 9/16" - 1/2" hex socket.  
Remove the bolt OEM with: ratchet & 18mm hex socket.

4. Locate and remove the body mount in the middle part. **SEE PICTURE 2.**
6. Locate and remove the body mount in the rear part. **SEE PICTURE 3.**

### Cleaning and care instructions:

Protect the finish with a non-abrasive automotive wax, (e.g. Pure Carnauba) on a regular basis. The use of any soap, polish, or wax that contains an abrasive is detrimental to the finish, as the compounds scratch the finish and cause corrosion.

Design:

Quality:

## INSTALLATION INSTRUCTIONS

**PICTURE 3**

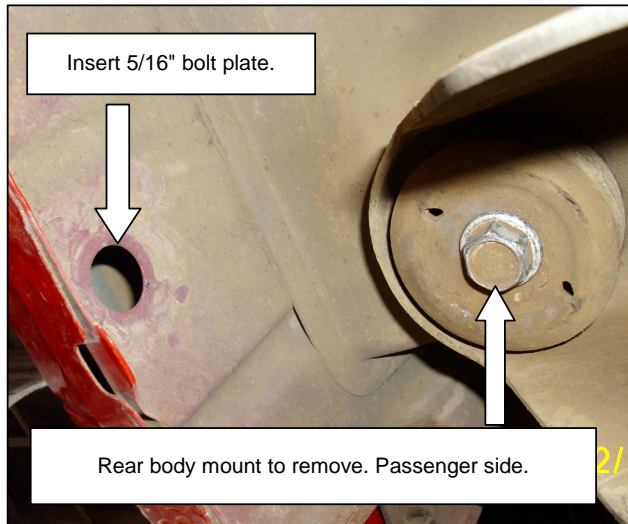

7. Install the middle bracket and attach with bolts before removed. Locates to the rubber plug that is in the rocker of the vehicle, remove and insert 5/16" bolt plate.

Mounts the rear auxiliary bracket and attach with: 5/16" flat and lock washers, 5/16" hex nut. In the other side of the bracket attach with the rear bracket: 3/8 x 1" carriage head bolt, 3/8" flat and lock washers, 3/8" hex nut. **SEE PICTURE 3, ILLUSTRATION 5.** Leave loose.

**ILLUSTRATION 5**

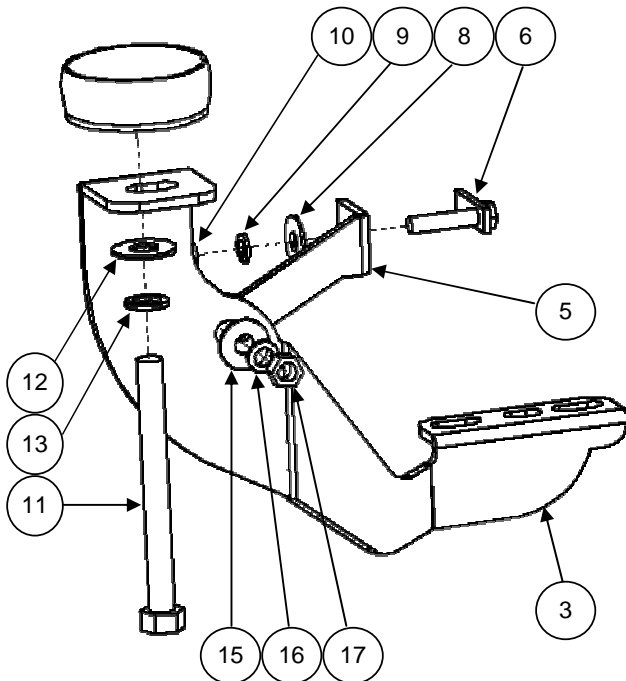

Use ratchet & 18mm - 19mm - 9/16" - 1/2" hex socket.  
Remove the bolt OEM with: ratchet & 18mm hex socket.

8. If you acquired a Running board widesider 5" & 6", insert 5/16" square head bolt on rail, place on brackets and attach with: 5/16" Flat and lock washer, 5/16" hex hut. **SEE ILLUSTRATION 6.** Repeat for the opposite side. Leave loose.

**Note 2: If the front and rear bracket does not agree totally with the aluminum structure, rotate so they're inside the aluminum structure and tighten.**

**ILLUSTRATION 6**

### RUNNING BOARD WIDESIDER 5" & 6" INSTALLATION

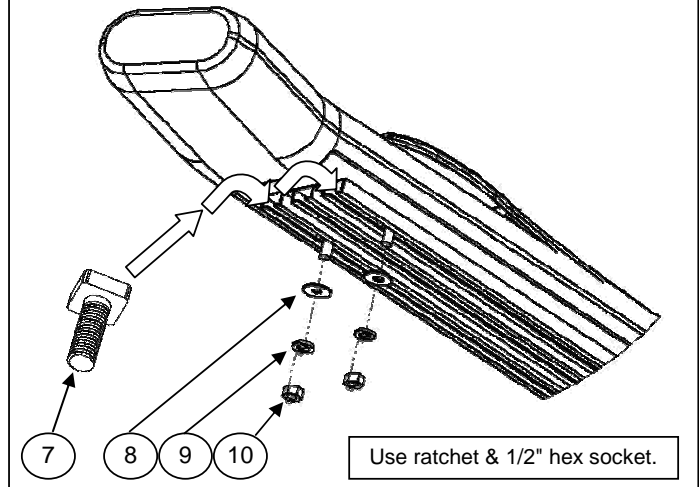

9. If you acquired a Oval side bar widesider 4", place on brackets and attach with: 5/16" square head bolt, 5/16" Flat and lock washer. **SEE ILLUSTRATION 7.** Repeat for the opposite side. Leave loose.

10. Align Running board widesider 5" & 6" or Oval side bar widesider 4" and then tighten all bolts.

11. Periodically check your product because it may need a re-tighten of bolts.

12. Fill the warranty card and place it inside your vehicle's glove box.

**ILLUSTRATION 7**

### OVAL SIDE BAR WIDESIDER 4" INSTALLATION

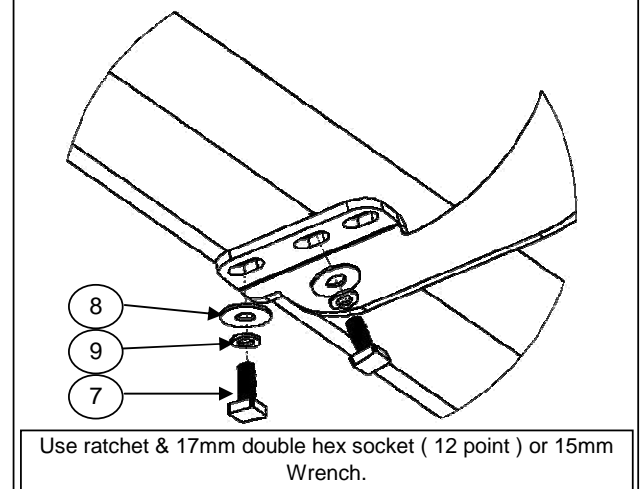

#### Cleaning and care instructions:

Protect the finish with a non-abrasive automotive wax, (e.g. Pure Carnauba) on a regular basis. The use of any soap, polish, or wax that contains an abrasive is detrimental to the finish, as the compounds scratch the finish and cause corrosion.

Design:

Quality:

## INSTALATION INSTRUCTIONS

### UNIVERSAL RUNNING BOARD

| Parts List |       |          |                   |
|------------|-------|----------|-------------------|
| Item       | QTY   | Code     | Description       |
| 1          | 1 set |          | Running Board     |
| 2          | 6 pcs | 397872AA | U (clamp) bracket |

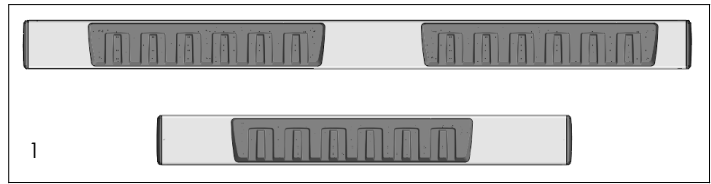

#### Required Tool:

- A. Ratchet w/5" extension
- B. 15mm wrench
- C. 17mm 12-point socket

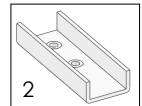

1. Before beginning the installation read all instructions thoroughly and verify that all hardware is accounted for. if there are any listed parts missing, please notify your distributor immediately.
2. To maintain and care this product keep it clean and do not use abrasive cleaners or polish waxes. It is recommended to use only non-abrasive automotive wax such as pure carnauba to avoid scratches and rust.
3. Once the main brackets are installed **(sold separately)**, the approximate installation time is **15 min.**
4. Identify the outboard side of the running board prior to install. **See illustration 1.**
5. Place the U brackets inside the Running Board. Move them to align to the main brackets.
6. Place the flat and lock washers with the square head bolts. This hardware kit is included on the main brackets that are **(sold separately)**. **See illustration 2.**
7. Align the Running board and tighten the bolts using the wrench or the socket.
8. **NOTE: For some regular cabs only two U brackets are needed per side.**

Illustration 1

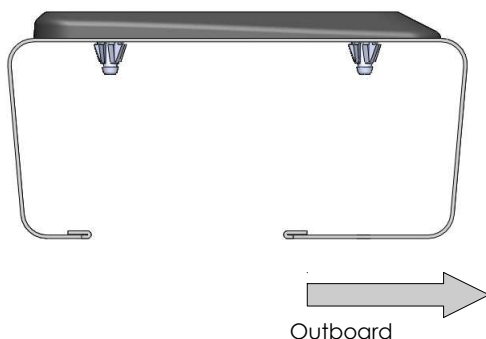

Illustration 2

