

Parts List				
Item	Qty.	Code	Description	Max. Torque
1	1 Set	370450AA-0BA	Side bars.	-
1	BRK-37045	BRACKETS KIT INCLUDES:		-
2	1 Set	372244BB	Front bracket	-
3	1 Set	372244AB	Rear bracket	-
4	1 Set	370452AA	Auxiliary front bracket	-
5	1 Set	370452BA	Auxiliary rear bracket	-
6	4 Piece	372240BA	"T" Plate	-
1	KTE-37045	HARDWARE KIT INCLUDES:		-
7	4 Piece	-	1/2 x 2" Hex head bolt.	75 Lb.Ft
8	4 Piece	-	1/2" Flat washer.	-
9	4 Piece	-	1/2" Lock washer.	-
10	10 Piece	-	3/8 x 1 1/4" Hex head bolt.	30 Lb.Ft
11	6 Piece	-	3/8" Hex nut.	30 Lb.Ft
12	14 Piece	-	3/8" Flat washer.	-
13	14 Piece	-	3/8" Lock washer.	-
14	4 Piece	-	2 1/2 x 5/16" Vinyl gaskets	-

Required Tools (Not included)	
Qty.	Description
1	3/4" Socket & Wrench
1	9/16" Socket & Wrench
1	18mm Socket
1	Ratchet
1	Extension ratchet

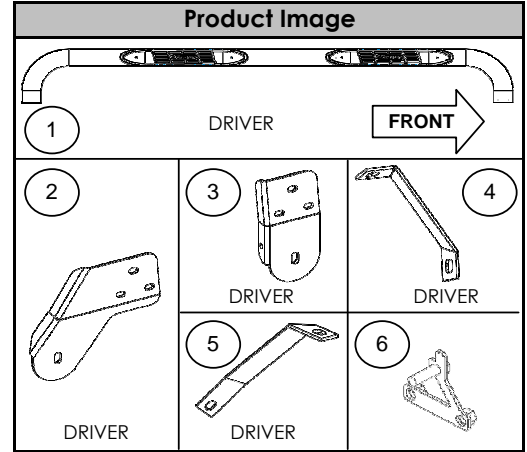

Instructions

1. Before beginning the installation, please read all directions carefully and verify that all necessary hardware is accounted for. If any parts are missing, stop the installation and contact your distributor immediately.
2. To maintain and care this product, keep it clean and do not use abrasive cleaners or polish waxes. We recommend to use only automotive wax such as pure carnauba to avoid scratches and rust.
3. The approximate installation time is 60 min.
4. Begin the installation on the driver side of the vehicle.
5. Locate the obround hole covered with tape and (2) hexagon holes in the body panel at the front of the cab. Remove the tape covering the obround hole and install (1) 3/8" T-Plate in the body panel and install (1) vinyl gasket over the threads to prevent the 3/8" T-Plate from falling into the body. **(Photo 1).**
6. Attach the driver side front bracket to the body panel using the 3/8" T- Plate, (2) 3/8" x 1 1/4" hex head bolts, (3) 3/8" flat washers, (3) 3/8" lock washers and (1) 3/8" hex nut. **(Photo 2).** Leave the nut and bolts loose for final adjustment.

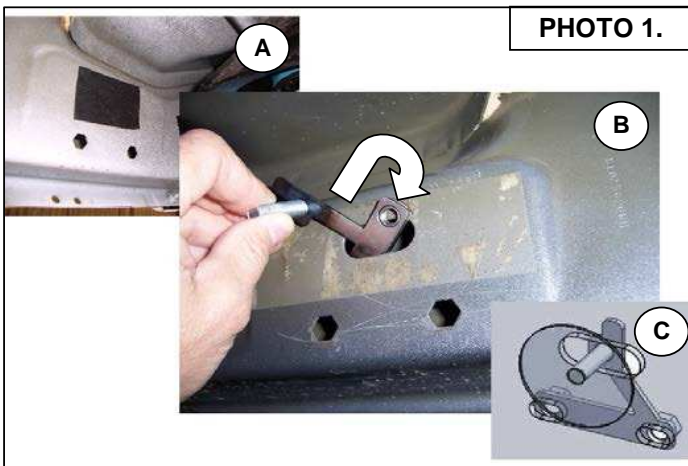

Installing sequence of 3/8" T plate in the body panel. Front, driver's side.

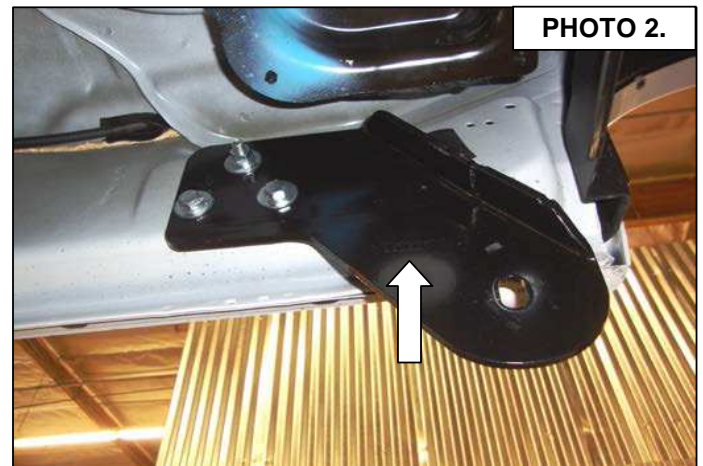

The front bracket installed, photo driver's side front shown.

7. Repeat the above steps to install the driver side rear bracket. **(Photo 3 & 4).**

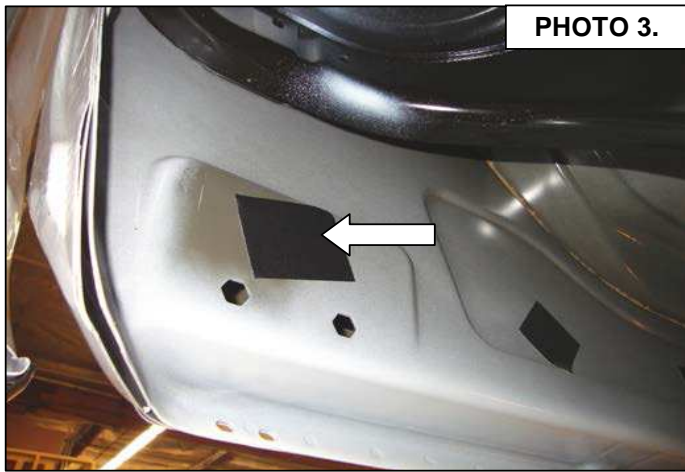

Remove the protective tape and install 3/8" T plate in the body panel. Rear driver's side.



The rear bracket installed, photo driver's side rear shown.

8. Locate and remove the driver side front factory body mount bolt and washer. **(Photo 5).**
9. Insert the factory body bolt through the slot hole in the top of the driver side front auxiliary bracket, and reinstall the body mount bolt. **(Photo 6).**
- 6). Leave the bolt loose for final adjustment.

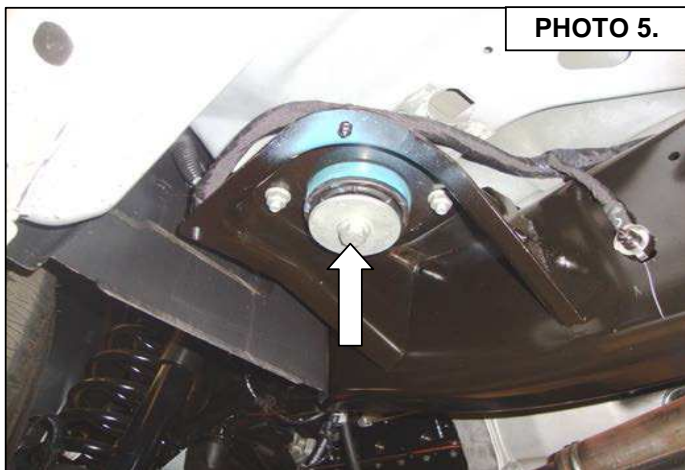

Remove this bolt and washer to attach the front auxiliary bracket. Front driver's side.

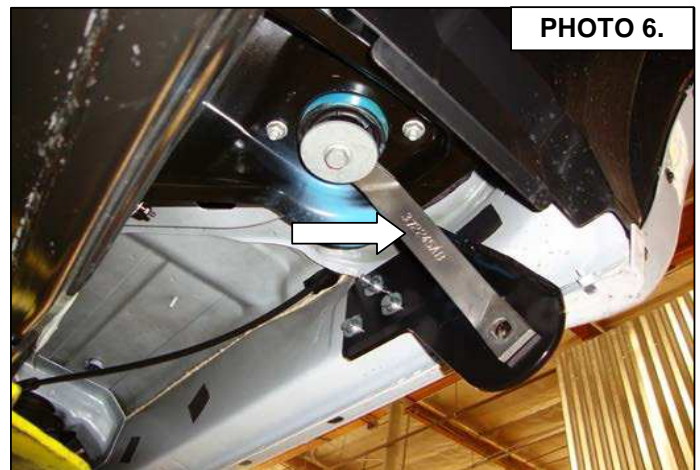

The front auxiliary bracket installed, photo driver's side front shown.

10. Locate and remove the driver side rear factory body mount bolt and washer. **(Photo 7).**
11. Insert the factory body bolt and washer through the slot hole in the top of the driver side rear auxiliary bracket, reinstall the body mount bolt and attach the opposite end of the auxiliary bracket to the rear bracket using (1) 3/8" x 1 1/4" hex bolt, (1) 3/8" flat washer, (1) 3/8" lock washer and (1) 3/8" hex nut. **(Photo 8).** Leave the nut and bolts loose for final adjustment.

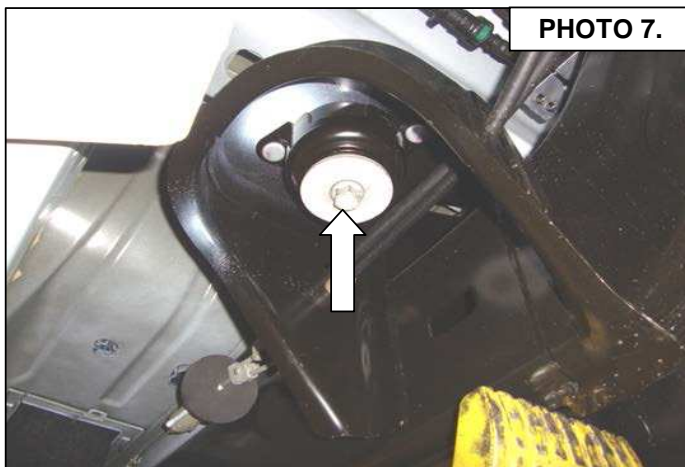

Remove this bolt and washer to attach the rear auxiliary bracket. Rear driver's side.

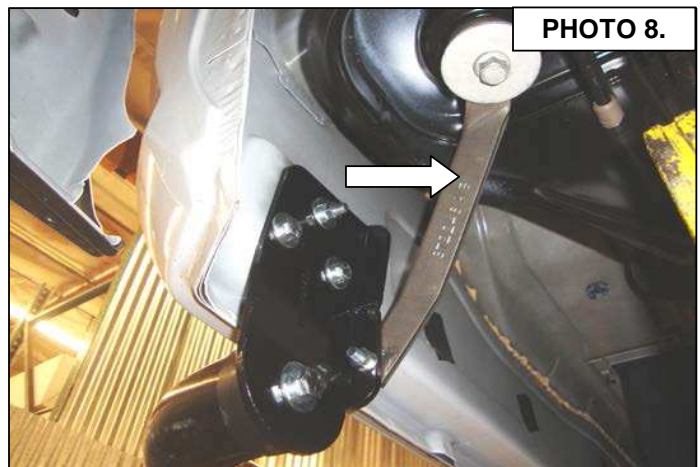

The rear auxiliary bracket installed, photo driver's side rear shown.

12. Attach the driver side step to each of the brackets using (1) 1/2" x 2" hex bolt, (1) 1/2" lock washers and (1) 1/2" flat washer. (Photo 9 & 10).

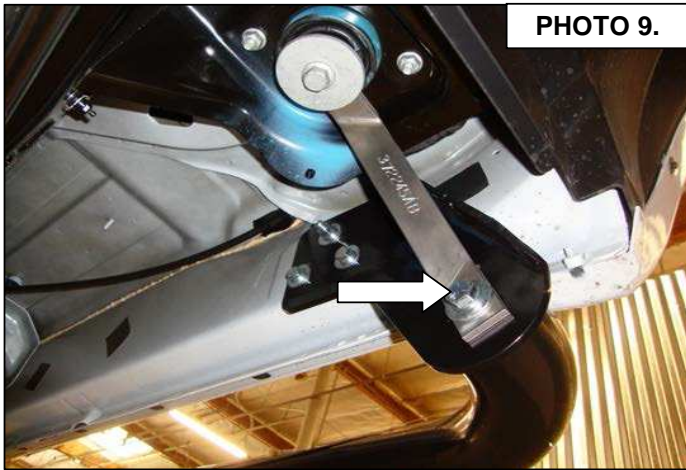

PHOTO 9.

Front assembly to the bracket brackets shown. Driver's side.



PHOTO 10.

Rear assembly to the bracket brackets shown. Driver's side.

13. Align the side step with the vehicle and tighten all factory, side step and bracket nuts and bolts. Repeat the installation steps to install the passenger side brackets and side step.

14. Remember to check and retighten all nuts and bolts periodically.

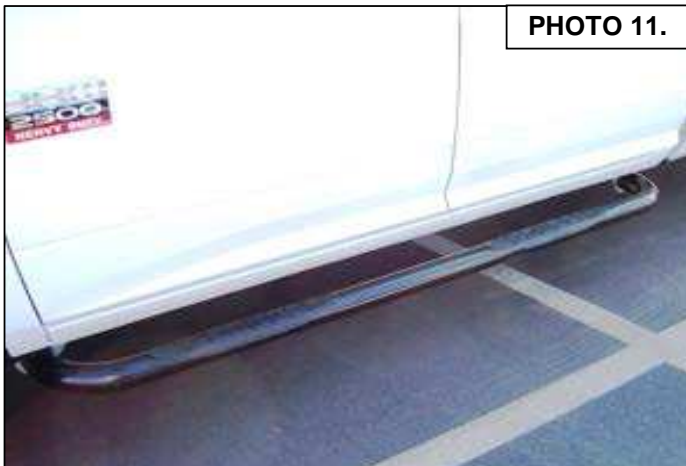

PHOTO 11.