

GO RHINO®

INSTALLATION INSTRUCTIONS

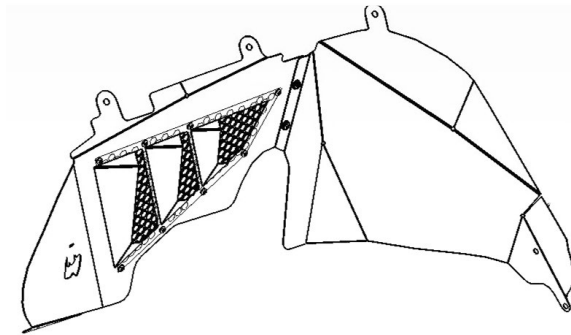
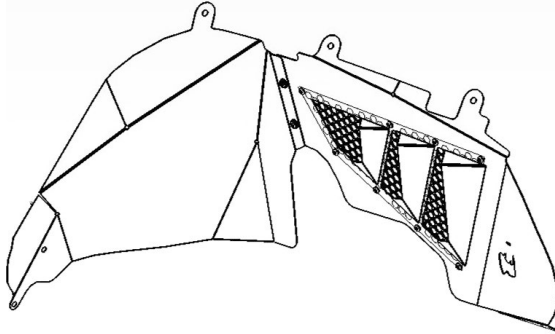

PART NO.

- 702011T

PRODUCT DESCRIPTION:

- FRONT INNER FENDER LINER SET

APPLICATION:

- JEEP WRANGLER JL

PRODUCT SAFETY & LEGAL DISCLAIMER

- **IMPORTANT READ ALL INSTRUCTIONS CAREFULLY BEFORE INSTALLING, FAILURE TO DO SO MAY CAUSE PERSONAL INJURY OR DAMAGE TO PRODUCT AND/OR PROPERTY.**
- **Review the product package and contents prior to beginning the installation.** Take care when opening the packaging and removing items. If a return is needed you will want to return the product in its original packaging if possible.
- This instruction guide is provided as a GENERAL installation guide, some vehicles vary dimensionally and may require additional steps.
- Test fit the product on the vehicle prior to any third party modifications and or finishing. The manufacturer and/or distributors do not accept responsibility for third party charges, labor and or third part replacement modifications. Some modifications may void the factory warranty.
- Exercise due-diligence when installing this product. The manufacturer and distributors of this product do not accept any responsibility for vehicle damage or personal injury resulting from the installation of this product. Careless installation and operation can result in serious injury or equipment damage.
- This product is for general off-road use. All liability for installation and use rests with the owner/operator.
- **INSTALLER:** Once installation is complete, please return this guide along with other documentation included in this product back to the consumer for future reference. The manufacturer/distributors of this product do not guarantee this particular version will be available at a later date.



INSTALLATION INSTRUCTIONS

INJURY HAZARD

Please complete a shop and tool inspection prior to beginning the installation.

- Always make sure you have a clean, dry and well lit work area.
- Always remove jewelry, loose fitting clothing and wear protective gloves and eye protection.
- Always use extreme caution when jacking or raising a vehicle for work. Set the emergency brake and use tire/wheel blocks and jack stands. Refer to the vehicle manufacturer hand book. Utilize the vehicle manufacturers designated lifting points.
- Always use appropriate and adequate care in lifting parts during disassembly and installation. Seek help in lifting heavy or large items into place. Utilize jacks and or lifting devices when available.
- Always insure products are secure during disassembly and installation.
- Always wear eye protection and take steps to protect any exposed skin during the installations. Drilling, cutting and grinding plastic and metal may create flying particles that can cause injury.
- Always use extreme caution when drilling, cutting and or grinding on a vehicle. Thoroughly inspect the area to be drilled, on both sides of material, prior to modification and relocate any objects that may become damaged.
- Always assemble and tighten all fasteners per the installation instructions.
- Always route electrical cables carefully. Avoid moving parts, parts that may become hot and rough or sharp edges.
- Always insulate and protect all exposed wiring and electrical connections.

MAINTENANCE AND CARE

- Always perform regular inspections and maintenance on mounts and related fasteners.
- Periodically check and tighten all fasteners.
- Stripped, fractured, or bent fasteners must be replaced.
- After washing the vehicle make sure to fully dry all surfaces.
- In areas with cold temperatures make sure to wash the product often to remove harmful materials used on road ways.
- Never use abrasive cleaners or polish compounds. Clean with a gentle soap and water. If you use wax use a non-abrasive automotive wax such as pure carnauba wax.

WARNING

Some products have been designed to work together with factory rear sensor systems, factory forward facing sensor systems and factory air bags.

- Installation of some of these products may alter the factory sensor system performance.
- Factory sensors may read shackles or hooks protruding from the fairlead and or tow hooks.
- All sensor testing is completed by Go Rhino Products and or third party testing labs on modified vehicles.
- Sensor sensitivity, factory sensor housing, orientation, and operating conditions are all variables that will influence functionality of the sensors.
- Installation of some product may effect the factory air bag systems.
- Some products allow the use of third party products such as winches, shackles, hooks, etc. Follow the respective manufacturers operating instructions for use with our products.
- Make sure to fully understand the product, it's intended use and operation prior to use.
- Above all... be safe!

GO RHINO®

INSTALLATION INSTRUCTIONS

PARTS INCLUDED IN THIS LIST:

ITEM	QTY.	DESCRIPTION	ITEM	QTY.	DESCRIPTION
A	10	1/4"-20 x 1" Hex Bolt	G	1	Driver Front Section Inner Fender Liner
B	6	1/4"-20 x 3/4" Button Head Hex Drive Screw	H	1	Driver Rear Section Inner Fender Liner
C	16	1/4" Lock Washer	I	1	Passenger Rear Section Inner Fender Liner
D	20	1/4" Flat Washer	J	1	Passenger Front Section Inner Fender Liner
E	4	1/4" Hex Nut	K	1	Rivet-Nut Installation Tool (Not Shown)
F	2	1/4" Rivet-Nut			

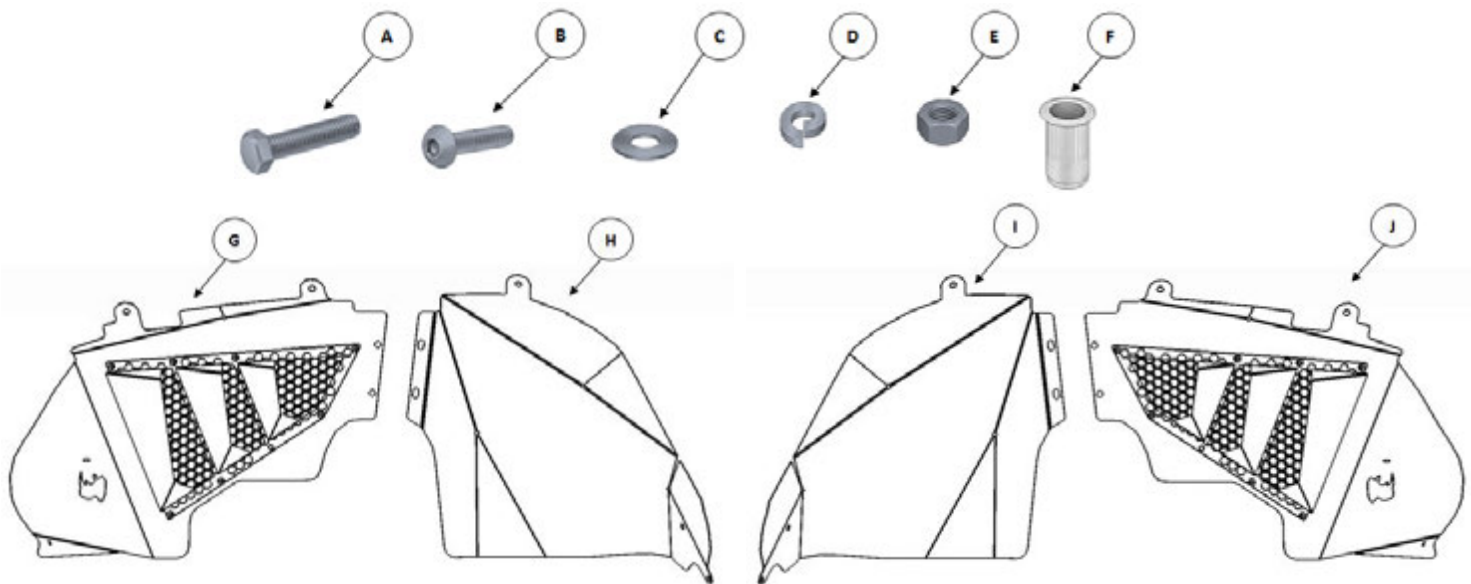

Go Rhino recommends you, the installer, read this installation instruction manual from front to back before installing the product. You may also view an installation video.

TOOLS NEEDED FOR INSTALLATION:

- 8mm, 10mm, 7/16" Sockets & Wrenches
- Ratchet, Ratchet Extensions & Swivel Joint Adapter
- 5/32" Hex Bit Socket
- Trim Panel Removal Tool
- Drill Motor 25/64" Drill Bit
- Nut-Sert Installation Tool (Included with Fender Liner Set)

ESTIMATED TIME FOR INSTALLATION:

1 1/2 Hour

GO RHINO®

INSTALLATION INSTRUCTIONS

Step-1 Beginning on the driver side, remove the fasteners and OEM fender liner and fender flair from the vehicle.

Step-2 Reference **Step 1** through **13** of the Go Rhino Rockline fender installation instructions, and proceed with installation of the driver side front fender.

Step-3 Enlarge the OEM inner fender liner attachment hole in the vehicle body structure as indicated, (FIGURE 1) using a drill motor and 25/64" drill bit.

FIGURE 1

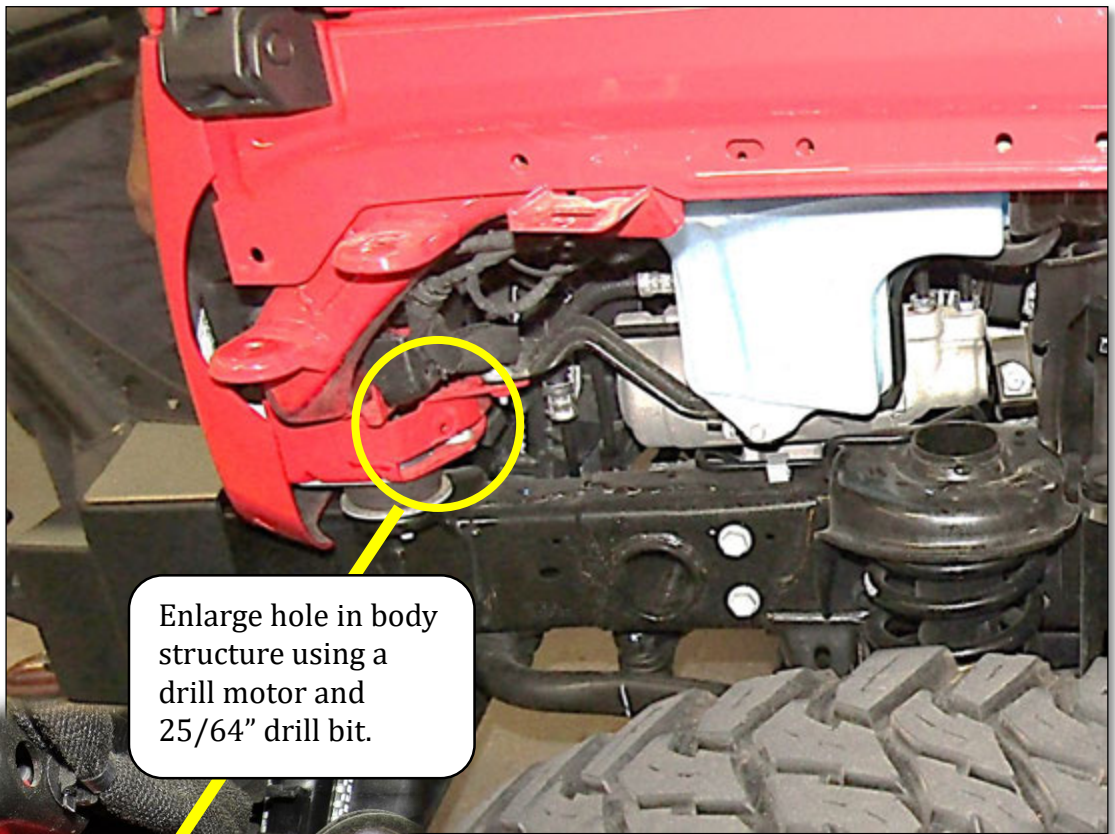

Enlarge hole in body structure using a drill motor and 25/64" drill bit.

Driver Side



GORRHINO®

INSTALLATION INSTRUCTIONS

Step-4 Assemble the rivet-nut, and tool components (flat washer, bearing, flat washer, bolt and nut).

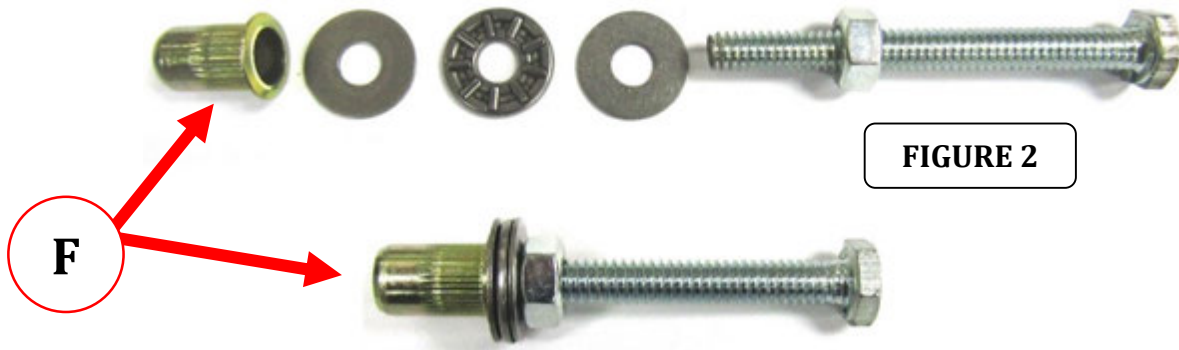

Step-5 Place the rivet-nut with the attached tool components into the enlarged hole in the body structure. Use a 7/16" wrench to hold the nut, and tighten the bolt using a 7/16" wrench or socket and ratchet. Continue tightening the bolt until the rivet-nut is fully compressed and no longer spins then remove the tool components, (FIGURE 3).

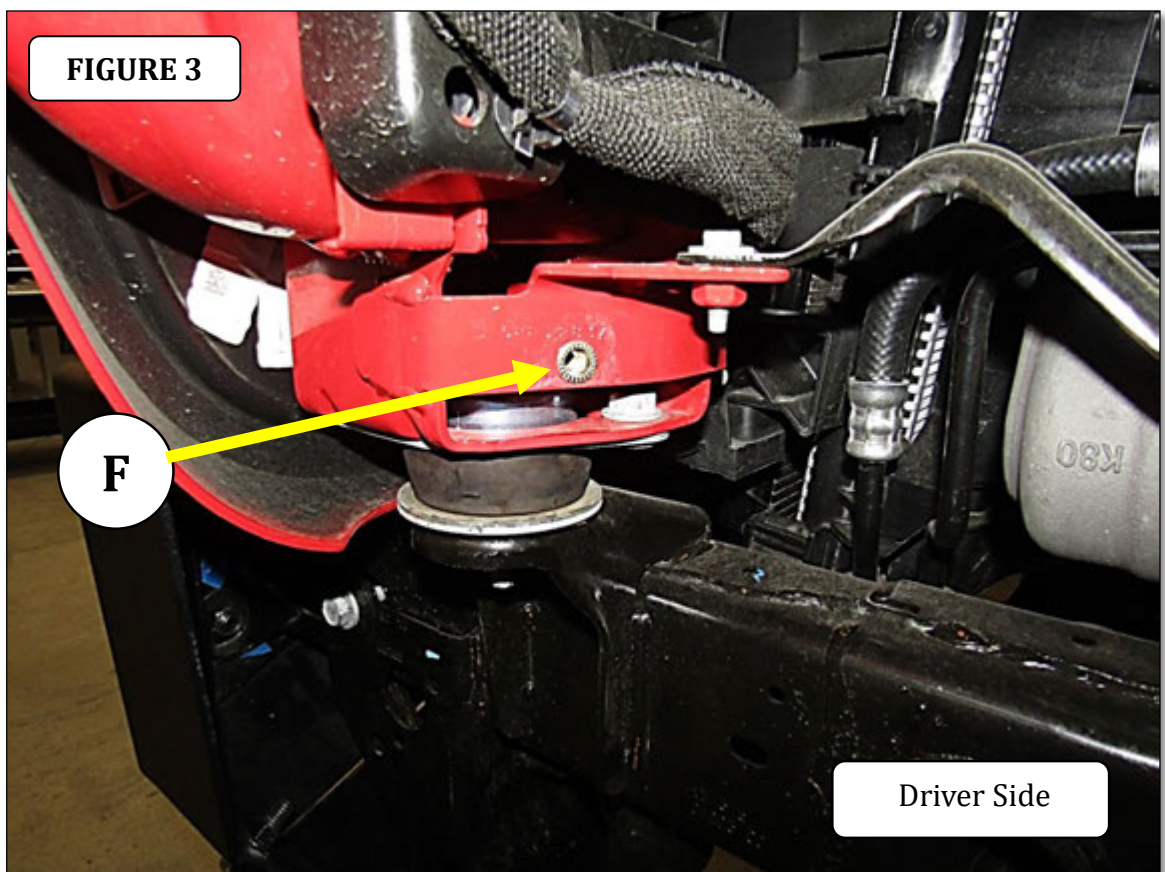

GO RHINO®

INSTALLATION INSTRUCTIONS

Step-6 Position the (2) tabs on the front section of the driver side inner fender liner between the outer body panel and the Go Rhino Rockline fender support bracket, (FIGURE 4).

Step-7 Use the Go Rhino logo cutout in the front section of the fender liner to access the nut-sert installed in the body structure, and secure the fender liner bracket to the body structure using (1) ¼" x 1" button head hex drive screw, (1) ¼" lock washer and (1) 1¼" flat washer, (FIGURE-4). Do not tighten the screw.

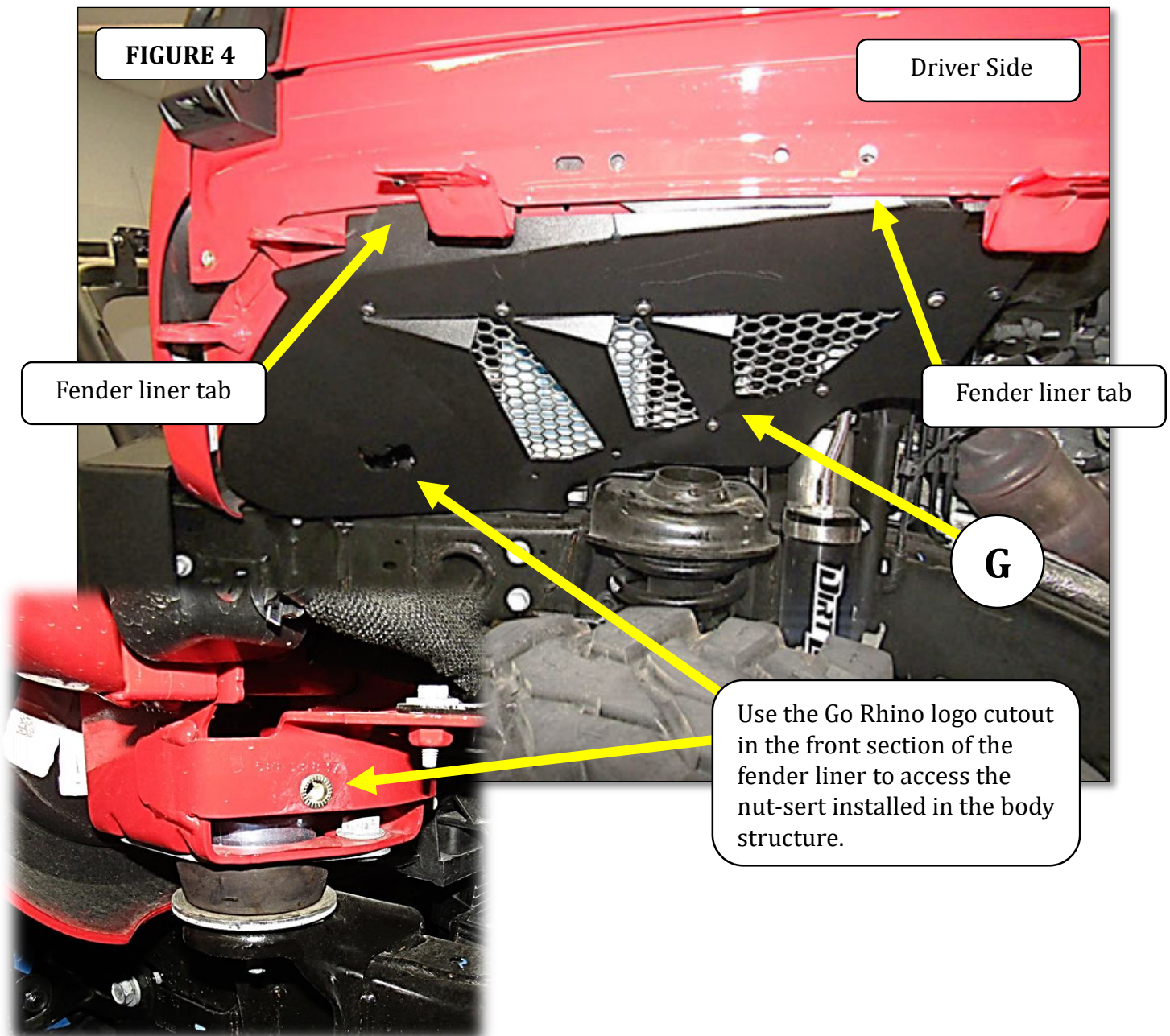

GO RHINO®

INSTALLATION INSTRUCTIONS

Step- 8 Attach the driver side Rockline front fender and the two tabs on the front section of the fender liner to the fender support bracket using (3) ¼"x 1" hex bolts, (3) ¼" lock washers and (3) ¼" flat washers, (FIGURE 5). Leave the bolts loose for final adjustment.

Step-9 Attach the Rockline front fender to the auxiliary bracket using (2) ¼"x 1" hex bolts, (2) ¼" lock washers, (2) ¼" flat washers and (2) ¼" hex nuts and to the body panel using (1) ¼"x 1" hex bolt, (1) ¼" flat washer, (1) ¼" lock washer and (1) ¼" hex nut, (FIGURE 5). Tighten the nuts and bolts.

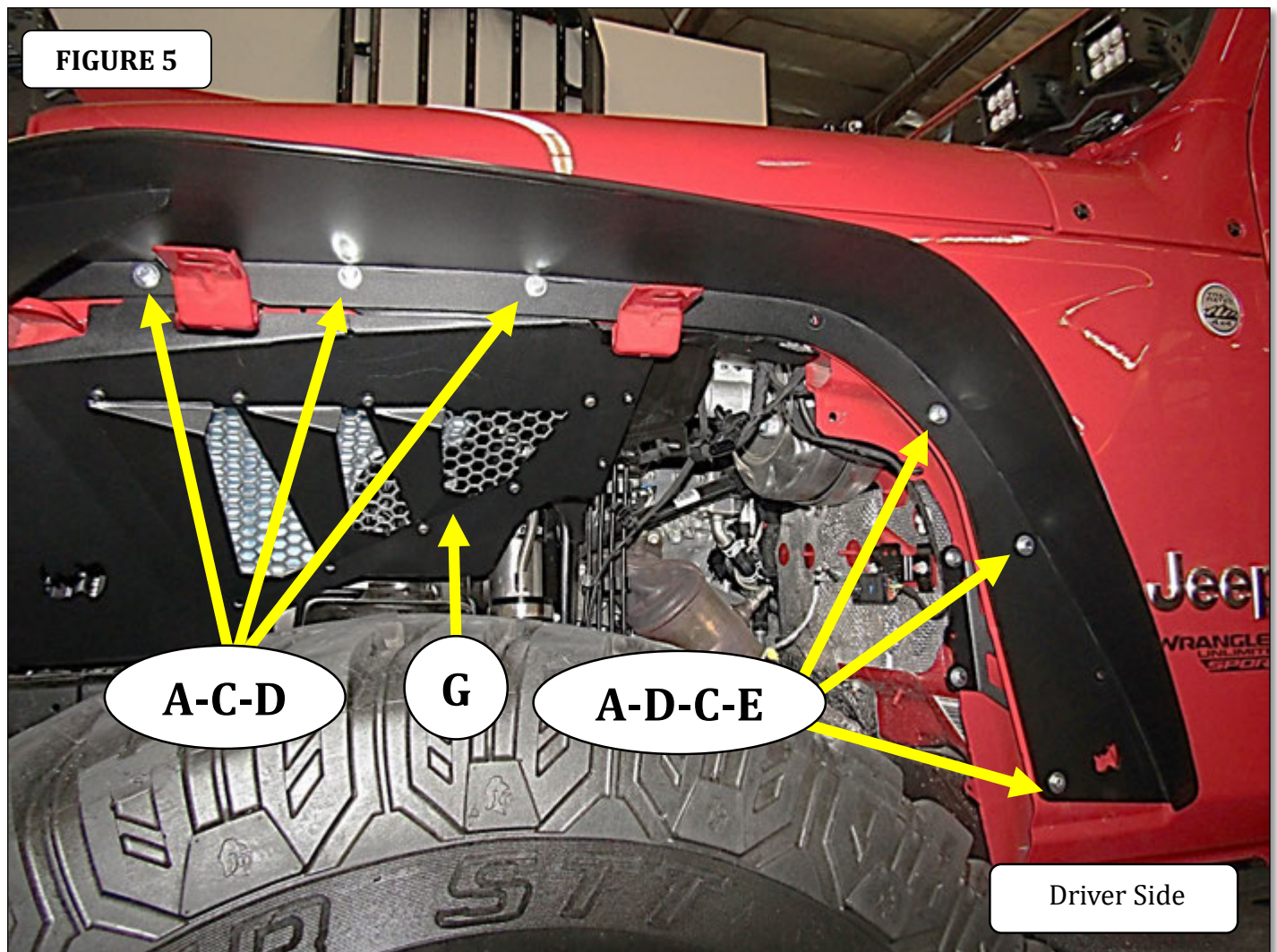

GO RHINO[®]

INSTALLATION INSTRUCTIONS

Step-10 Position the tab on the rear section of the driver side inner fender liner between the outer body panel and the Go Rhino Rockline fender support bracket, (FIGURE 6). Note: Overlap the end of the front liner with the rear liner.

Step-11 Attach the Rockline front fender and the tab on the rear section of the inner fender liner to the support bracket using (1) ¼" x 1" hex bolt, (1) ¼" lock washer and (1) ¼" flat washer, (FIGURE 6). Leave the bolt loose for final adjustment.

Step-12 Attach the (2) holes in the rear section of the inner fender liner to the nut-serts installed in the front section of the inner fender liner using (2) ¼" x 1/2" button head screws and (2) ¼" lock washers and (2) ¼" flat washers, (FIGURE 6). Leave the screws loose for final adjustment.

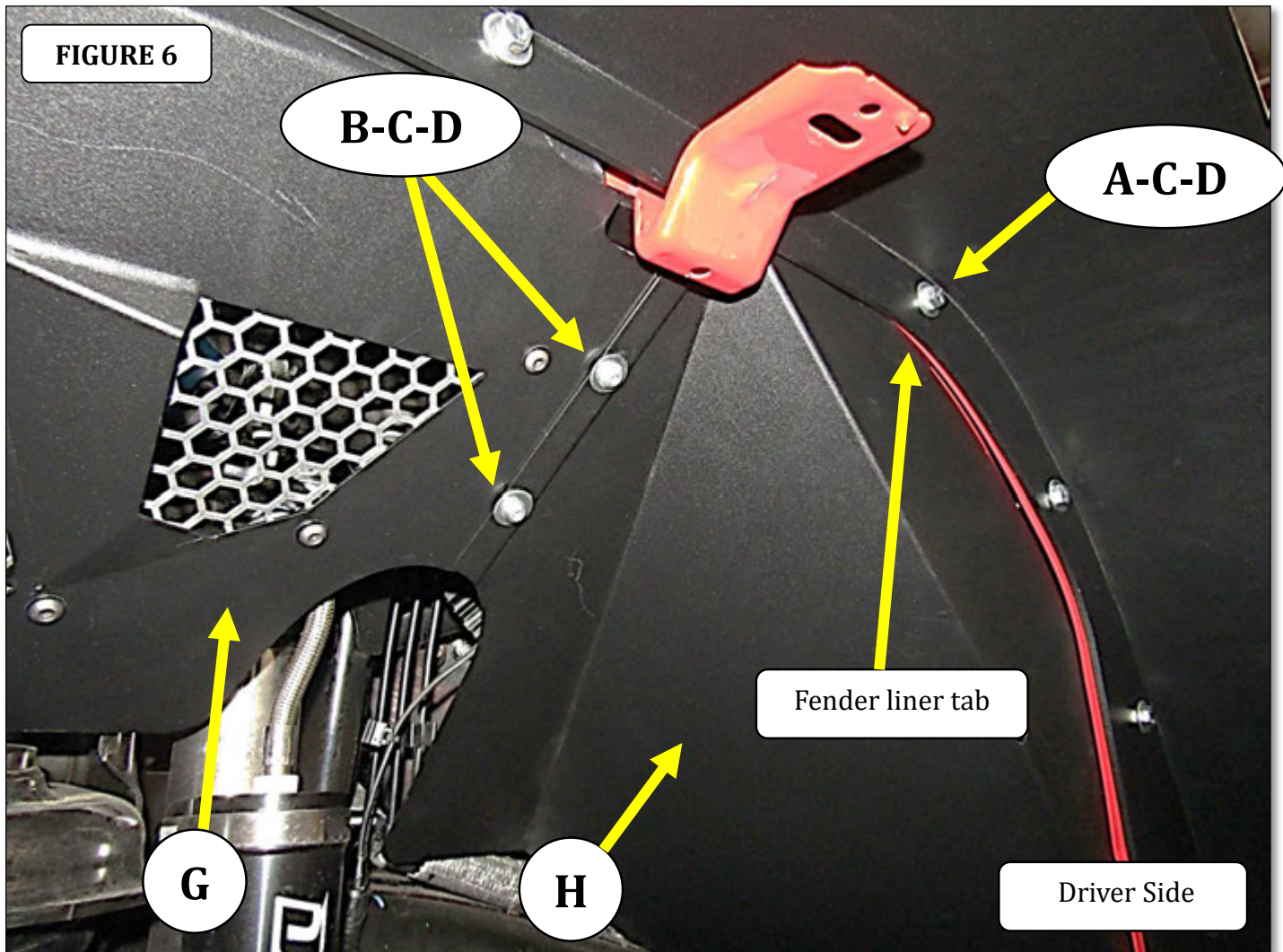

GO RHINO®

INSTALLATION INSTRUCTIONS

Step-13 Attach the rear section of the inner fender liner to the body panel using (2) ¼"x 1" hex bolts, (2) ¼" lock washers, (2) ¼" flat washers and (2) ¼" hex nuts, (FIGURE 7). Tighten the nuts and bolts.

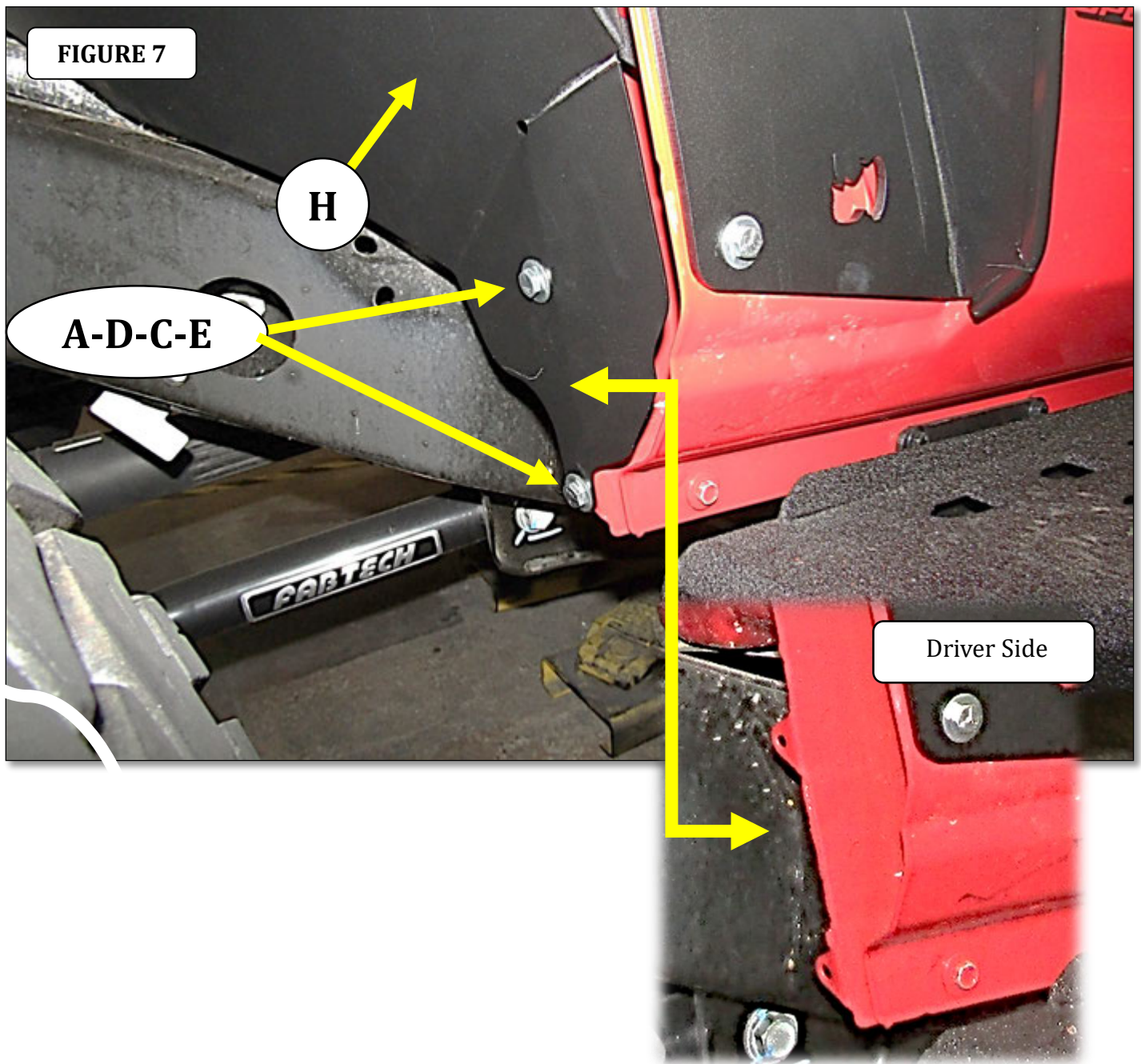

GORRHINO®

INSTALLATION INSTRUCTIONS

Step-14 Install the (2) remaining $\frac{1}{4}$ "x 1" hex bolts, (2) $\frac{1}{4}$ " lock washers and (2) $\frac{1}{4}$ " flat washers to secure the Rockline front fender to the body panel, then tighten all bolts and screws securing the Rockline fender and inner fender liner.

Repeat the steps listed to install the passenger side inner fender liner.

