

GO RHINO®

INSTALLATION INSTRUCTIONS

PART NO.

- 5910000T

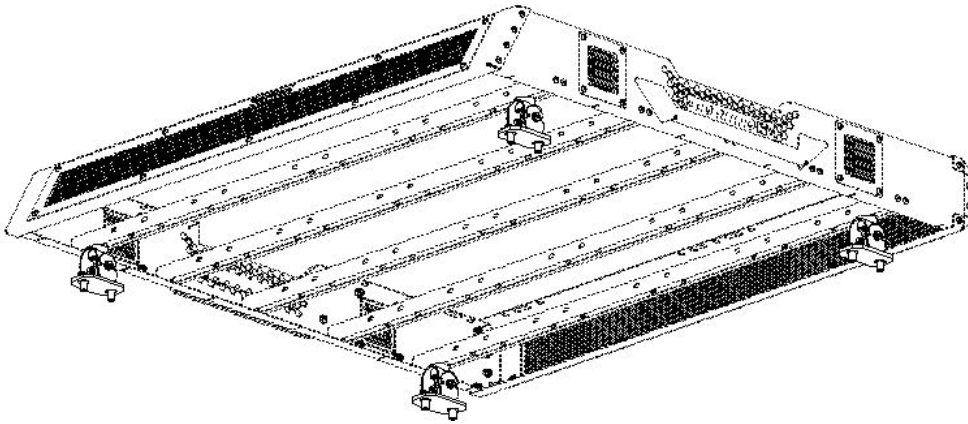

Rack sold separately
shown as reference only

PRODUCT DESCRIPTION:

SRM Series Adjustable Mounting Kit (drill)

PRODUCT SAFETY & LEGAL DISCLAIMER

- **IMPORTANT READ ALL INSTRUCTIONS CAREFULLY BEFORE INSTALLING, FAILURE TO DO SO MAY CAUSE PERSONAL INJURY OR DAMAGE TO PRODUCT AND/OR PROPERTY.**
- **Review the product package and contents prior to beginning the installation.** Take care when opening the packaging and removing items. If a return is needed you will want to return the product in its original packaging if possible.
- This instruction guide is provided as a GENERAL installation guide, some vehicles vary dimensionally and may require additional steps.
- Test fit the product on the vehicle prior to any third party modifications and or finishing. The manufacturer and/or distributors do not accept responsibility for third party charges, labor and or third part replacement modifications. Some modifications may void the factory warranty.
- Exercise due-diligence when installing this product. The manufacturer and distributors of this product do not accept any responsibility for vehicle damage or personal injury resulting from the installation of this product. Careless installation and operation can result in serious injury or equipment damage.
- This product is for general off-road use. All liability for installation and use rests with the owner/operator.
- **INSTALLER:** Once installation is complete, please return this guide along with other documentation included in this product back to the consumer for future reference. The manufacturer/distributors of this product do not guarantee this particular version will be available at a later date.



INSTALLATION INSTRUCTIONS

INJURY HAZARD

Please complete a shop and tool inspection prior to beginning the installation.

- Always make sure you have a clean, dry and well lit work area.
- Always remove jewelry, loose fitting clothing and wear protective gloves and eye protection.
- Always use extreme caution when jacking or raising a vehicle for work. Set the emergency brake and use tire/wheel blocks and jack stands. Refer to the vehicle manufacturer hand book. Utilize the vehicle manufacturers designated lifting points.
- Always use appropriate and adequate care in lifting parts during disassembly and installation. Seek help in lifting heavy or large items into place. Utilize jacks and or lifting devices when available.
- Always insure products are secure during disassembly and installation.
- Always wear eye protection and take steps to protect any exposed skin during the installations. Drilling, cutting and grinding plastic and metal may create flying particles that can cause injury.
- Always use extreme caution when drilling, cutting and or grinding on a vehicle. Thoroughly inspect the area to be drilled, on both sides of material, prior to modification and relocate any objects that may become damaged.
- Always assemble and tighten all fasteners per the installation instructions.
- Always route electrical cables carefully. Avoid moving parts, parts that may become hot and rough or sharp edges.
- Always insulate and protect all exposed wiring and electrical connections.

MAINTENANCE AND CARE

- Always perform regular inspections and maintenance on mounts and related fasteners.
- Periodically check and tighten all fasteners.
- Stripped, fractured, or bent fasteners must be replaced.
- After washing the vehicle make sure to fully dry all surfaces.
- In areas with cold temperatures make sure to wash the product often to remove harmful materials used on road ways.
- Never use abrasive cleaners or polish compounds. Clean with a gentle soap and water. If you use wax use a non-abrasive automotive wax such as pure carnauba wax.

WARNING

Some products have been designed to work together with factory rear sensor systems, factory forward facing sensor systems and factory air bags.

- Installation of some of these products may alter the factory sensor system performance.
- Factory sensors may read shackles or hooks protruding from the fairlead and or tow hooks.
- All sensor testing is completed by Go Rhino Products and or third party testing labs on modified vehicles.
- Sensor sensitivity, factory sensor housing, orientation, and operating conditions are all variables that will influence functionality of the sensors.
- Installation of some product may effect the factory air bag systems.
- Some products allow the use of third party products such as winches, shackles, hooks, etc. Follow the respective manufacturers operating instructions for use with our products.
- The addition of some products such as roof rack baskets and or mounting systems may cause additional road noise.
- Follow vehicle manufactures roof capacity requirements for installing and use of roof rack baskets and mounting systems.
- Make sure to fully understand the product, it's intended use and operation prior to use.
- Above all... be safe!

INSTALLATION INSTRUCTIONS

PARTS INCLUDED IN THIS LIST:

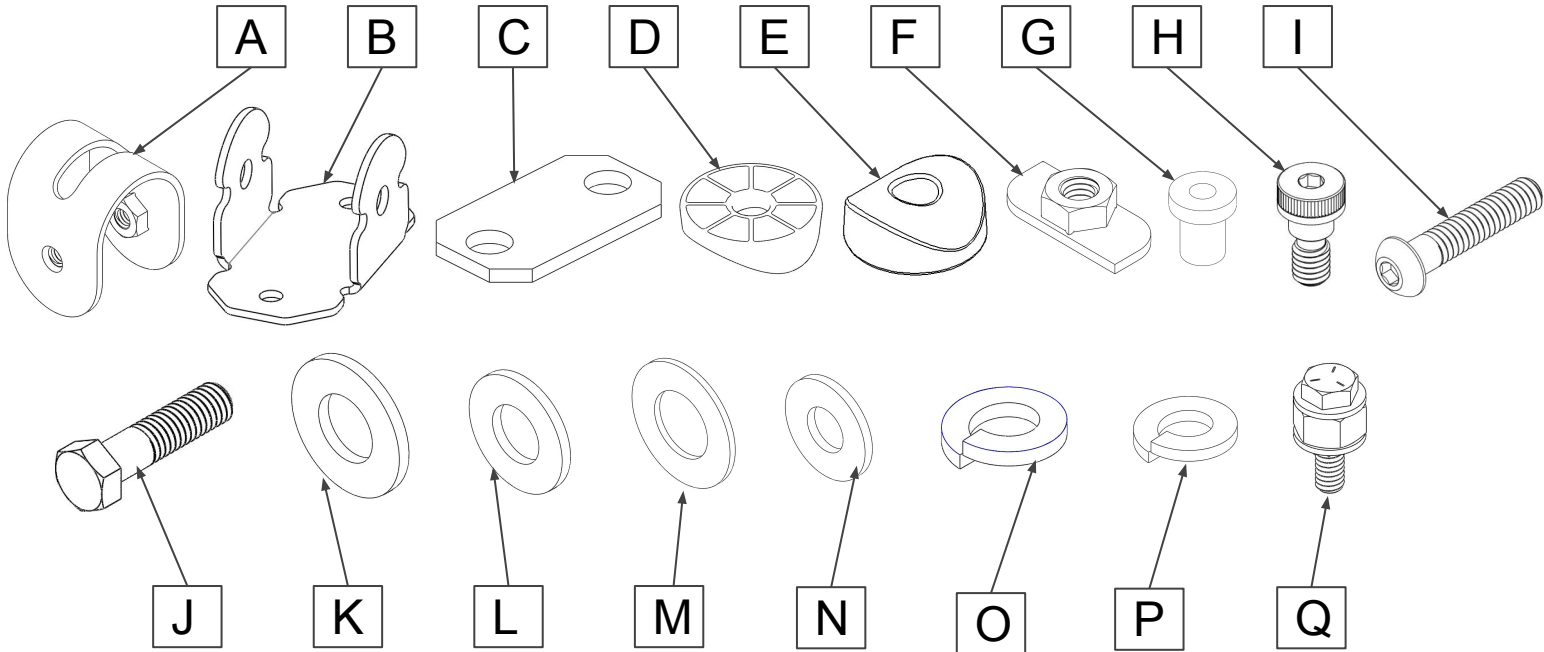

591000T
SRM SERIES ADJUSTABLE MOUNTING KIT (DRILL)

ITEM	QTY.	DESCRIPTION
A	4	UPPER MOUNTING BRACKET
B	4	LOWER MOUNTING BRACKET
C	4	GASKET
D	4	TOP SPACER
E	4	BOTTOM SPACER
F	4	T-NUT
G	8	1/4" RIVET NUT
H	8	3/8" SHOULDER BOLT
I	8	3/8" X 1 1/4" BUTTON HEAD BOLT
J	4	3/8" HEX HEAD BOLT
K	8	3/8" NYLON WASHER
L	8	3/8" NYLON WASHER
M	4	3/8" FLAT WASHER
N	8	1/4" FLAT WASHER
O	4	3/8" LOCK WASHER
P	8	1/4" LOCK WASHER
Q	1	1/4" RIVET NUT INSTALL TOOL

Go Rhino recommends you, the installer, read this installation instruction manual from front to back before installing the product. You may also [click here](http://www.gorhino.com/Installation-Videos) to view an installation video or visit <http://www.gorhino.com/Installation-Videos>.

TOOLS NEEDED FOR INSTALLATION:

- 5/32" Hex Driver
- 5/8" Drive Socket or Wrench
- 7/16" Drive Socket or Wrench
- 9/16" Wrench
- Power drill
- 13/32" Drill bit

ESTIMATED TIME FOR INSTALLATION:

90 Min.

GO RHINO®

INSTALLATION INSTRUCTIONS

STEP # 1

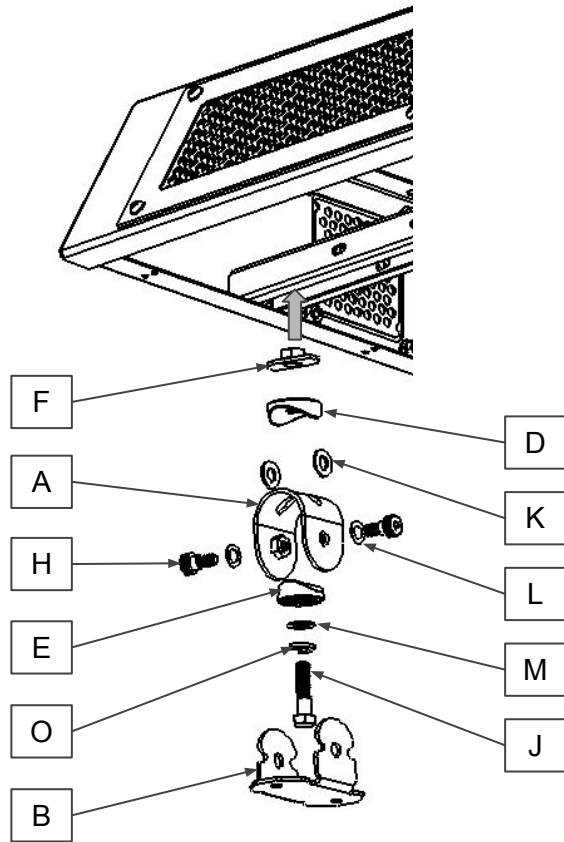

- Assemble Mounting bracket onto rack using:

- (1) T-Nut
- (1) Top Spacer
- (2) $\frac{3}{8}$ " Nylon Washers
- (1) Upper Mounting Bracket
- (2) $\frac{3}{8}$ " Shoulder Bolt
- (2) $\frac{3}{8}$ " Nylon Washer
- (1) Bottom Spacer
- (1) $\frac{3}{8}$ " Flat Washer
- (1) $\frac{3}{8}$ " Lock Washer
- (1) $\frac{3}{8}$ " Hex Head Bolt
- (1) Lower Mounting Bracket

STEP # 2

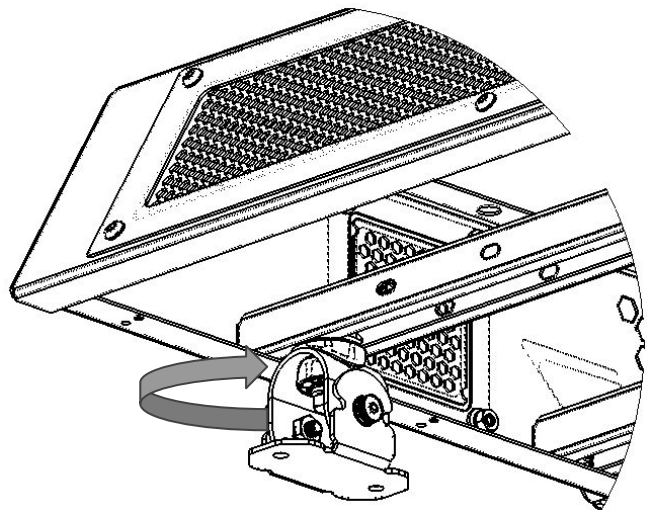

- Do not fully tighten $\frac{3}{8}$ " Hex head bolt.

GO RHINO®

INSTALLATION INSTRUCTIONS

STEP # 3

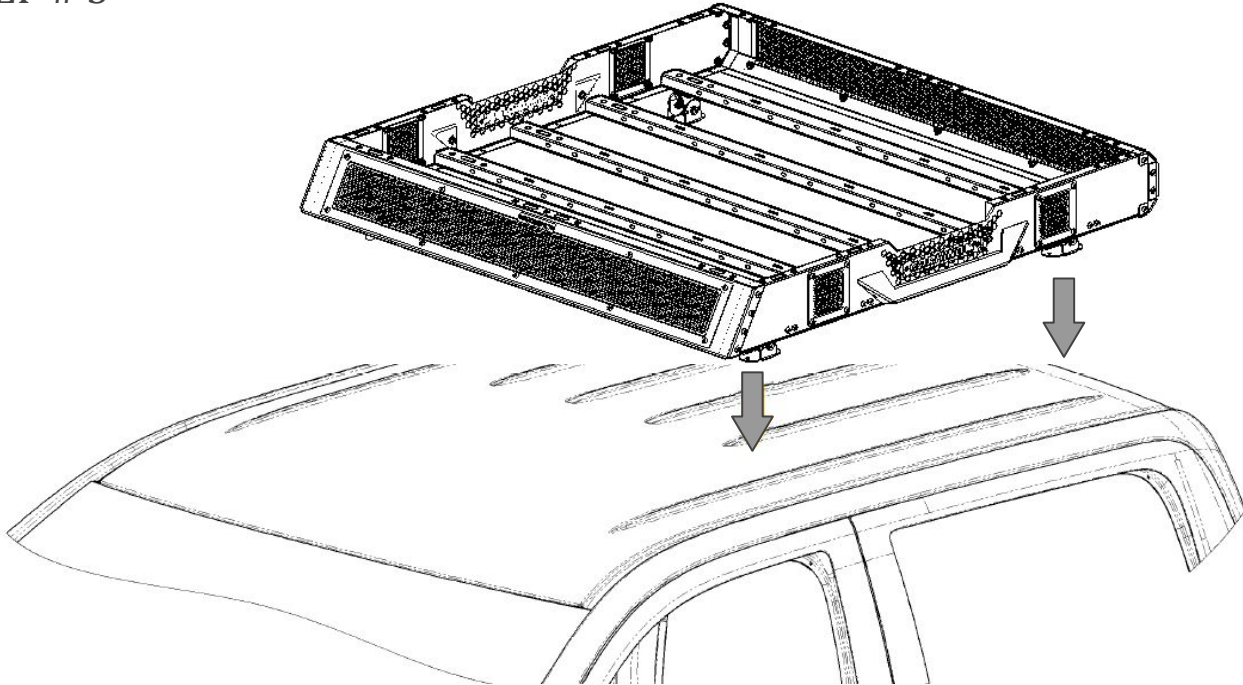

- Place rack on roof.
- Position rack and mark all 8 mounting holes.
- Center punch hole locations.
- Remove rack and drill 13/32" holes through roof.
- Use a step drill bit or drill several holes starting small and working up to 13/32".
- Remove sharp edges and or burrs and apply automotive primer to any exposed metal.

STEP # 4

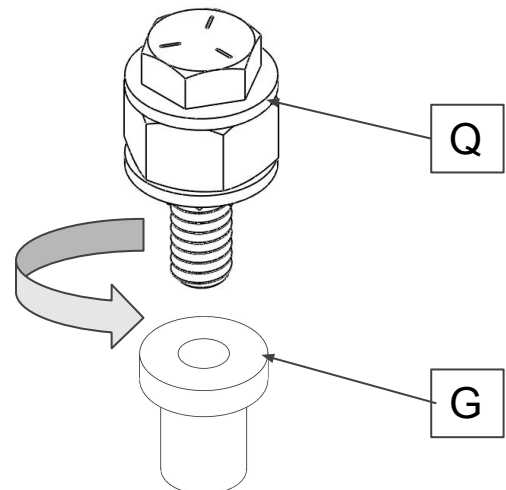

- Hand tighten 1/4" rivet nut onto installation tool as shown.

GO RHINO®

INSTALLATION INSTRUCTIONS

STEP # 5

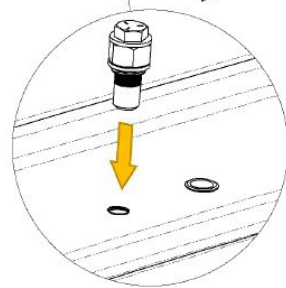
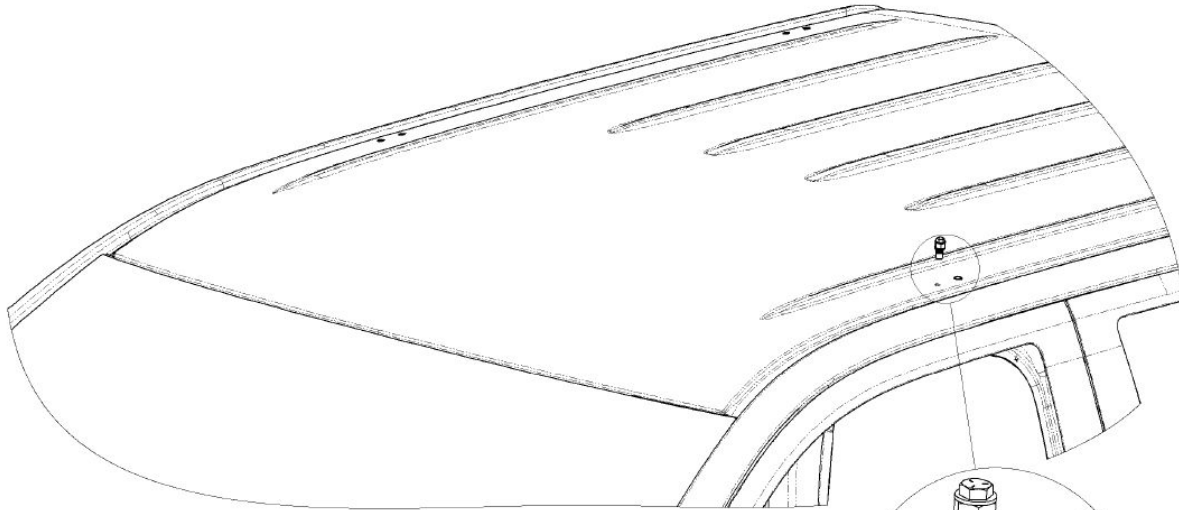

- Insert Rivet Nut into 13/32" hole.
- Hold spacer with 9/16" wrench
- Tighten bolt with 7/16" wrench or socket and ratchet, this will compress the rivet nut.
- Make sure to hold rivet nut against surface during activation.
- Once tight, unscrew the bolt and rivet nut will be installed

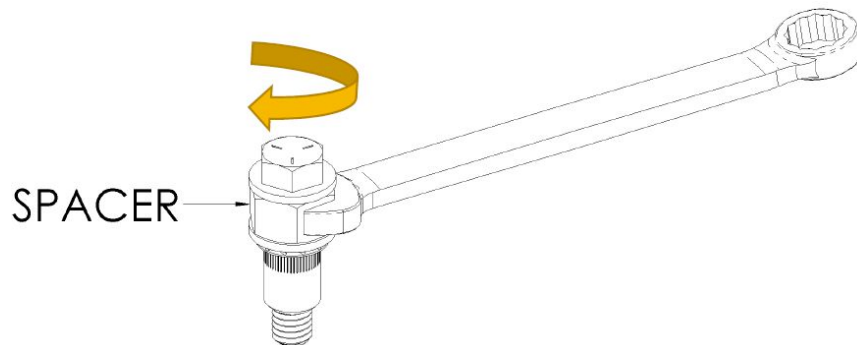

GO RHINO®

INSTALLATION INSTRUCTIONS

STEP # 6

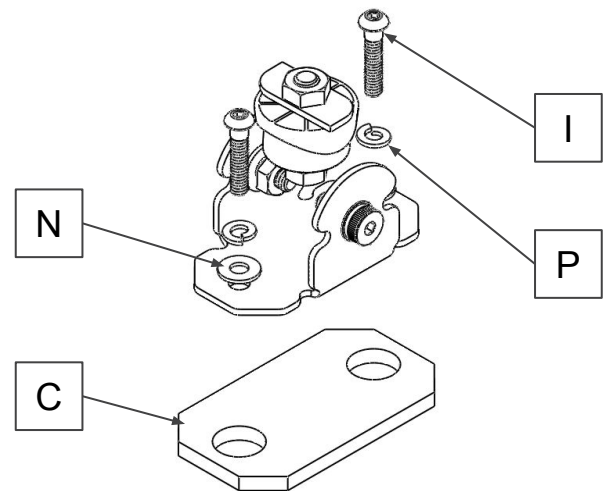
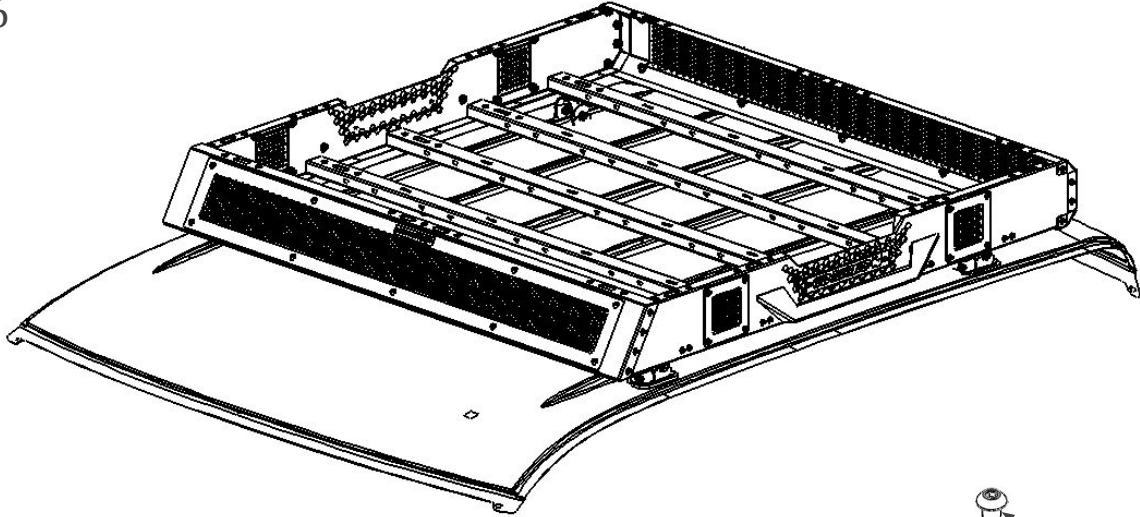

Install rack assembly (per bracket) using:

- (1) Gasket
 - (2) ¼" flat washers
 - (2) ¼" lock washers
 - (2) ⅜" x 1 ¼" Button head bolt
-
- To insure a leak free installation add an RTV silicone sealant (available at most hardware and automotive stores) to the bolts.

- Tighten ¼" bolts to 70 in/lbs Max. DO NOT OVERTIGHTEN BOLTS.
- Tighten ⅜" button head bolts to 26 ft/lbs Max. DO NOT OVERTIGHTEN BOLTS.
- Check and retighten nuts and bolts periodically.

Discover other roof racks and cargo carriers on our website.