

# GO RHINO®

## INSTALLATION INSTRUCTIONS

### PART NO.

- 24375T

### PRODUCT DESCRIPTION:

- BR11 BUMPER REPLACEMENT

### APPLICATION:

- FORD F-250 & F-350 SUPER DUTY

EXCLUDES MODELS WITH ADAPTIVE  
CRUIS CONTROL

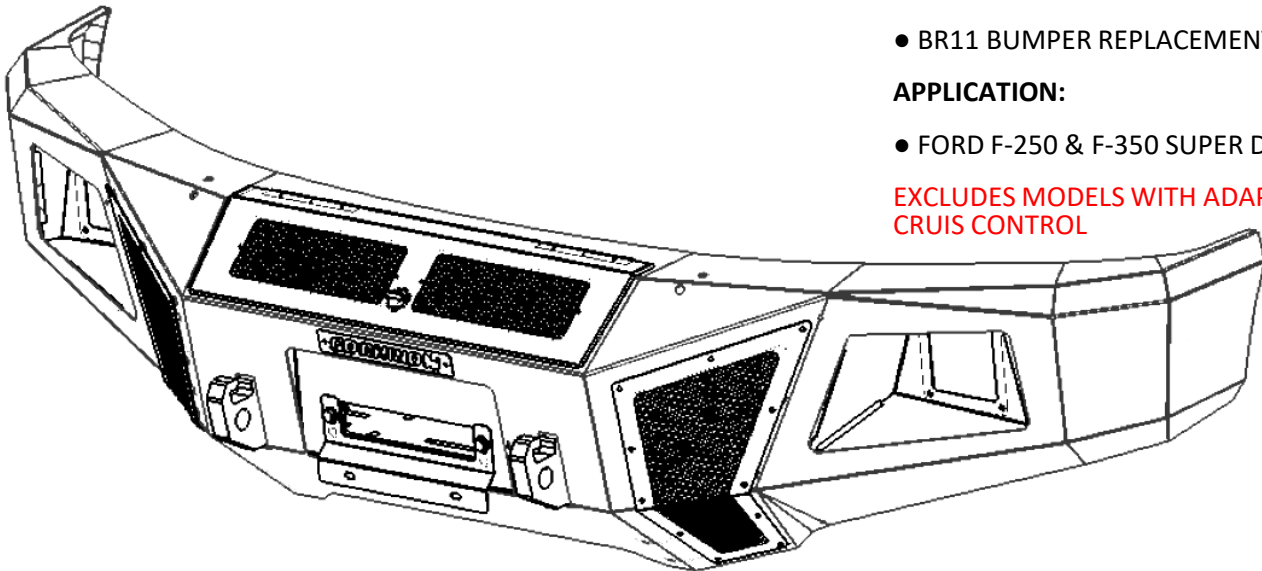

### PRODUCT SAFETY & LEGAL DISCLAIMER

- **IMPORTANT READ ALL INSTRUCTIONS CAREFULLY BEFORE INSTALLING, FAILURE TO DO SO MAY CAUSE PERSONAL INJURY OR DAMAGE TO PRODUCT AND/OR PROPERTY.**
- **Review the product package and contents prior to beginning the installation.** Take care when opening the packaging and removing items. If a return is needed you will want to return the product in its original packaging if possible.
- This instruction guide is provided as a GENERAL installation guide, some vehicles vary dimensionally and may require additional steps.
- Test fit the product on the vehicle prior to any third party modifications and or finishing. The manufacturer and/or distributors do not accept responsibility for third party charges, labor and or third part replacement modifications. Some modifications may void the factory warranty.
- Exercise due-diligence when installing this product. The manufacturer and distributors of this product do not accept any responsibility for vehicle damage or personal injury resulting from the installation of this product. Careless installation and operation can result in serious injury or equipment damage.
- This product is for general off-road use. All liability for installation and use rests with the owner/operator.
- **INSTALLER:** Once installation is complete, please return this guide along with other documentation included in this product back to the consumer for future reference. The manufacturer/distributors of this product do not guarantee this particular version will be available at a later date.



## INSTALLATION INSTRUCTIONS

### INJURY HAZARD

Please complete a shop and tool inspection prior to beginning the installation.

- Always make sure you have a clean, dry and well lit work area.
- Always remove jewelry, loose fitting clothing and wear protective gloves and eye protection.
- Always use extreme caution when jacking or raising a vehicle for work. Set the emergency brake and use tire/wheel blocks and jack stands. Refer to the vehicle manufacturer hand book. Utilize the vehicle manufacturers designated lifting points.
- Always use appropriate and adequate care in lifting parts during disassembly and installation. Seek help in lifting heavy or large items into place. Utilize jacks and or lifting devices when available.
- Always insure products are secure during disassembly and installation.
- Always wear eye protection and take steps to protect any exposed skin during the installations. Drilling, cutting and grinding plastic and metal may create flying particles that can cause injury.
- Always use extreme caution when drilling, cutting and or grinding on a vehicle. Thoroughly inspect the area to be drilled, on both sides of material, prior to modification and relocate any objects that may become damaged.
- Always assemble and tighten all fasteners per the installation instructions.
- Always route electrical cables carefully. Avoid moving parts, parts that may become hot and rough or sharp edges.
- Always insulate and protect all exposed wiring and electrical connections.

### MAINTENANCE AND CARE

- Always perform regular inspections and maintenance on mounts and related fasteners.
- Periodically check and tighten all fasteners.
- Stripped, fractured, or bent fasteners must be replaced.
- After washing the vehicle make sure to fully dry all surfaces.
- In areas with cold temperatures make sure to wash the product often to remove harmful materials used on road ways.
- Never use abrasive cleaners or polish compounds. Clean with a gentle soap and water. If you use wax use a non-abrasive automotive wax such as pure carnauba wax.

### WARNING

Some products have been designed to work together with factory rear sensor systems, factory forward facing sensor systems and factory air bags.

- Installation of some of these products may alter the factory sensor system performance.
- Factory sensors may read shackles or hooks protruding from the fairlead and or tow hooks.
- All sensor testing is completed by Go Rhino Products and or third party testing labs on modified vehicles.
- Sensor sensitivity, factory sensor housing, orientation, and operating conditions are all variables that will influence functionality of the sensors.
- Installation of some product may effect the factory air bag systems.
- Some products allow the use of third party products such as winches, shackles, hooks, etc. Follow the respective manufacturers operating instructions for use with our products.
- Make sure to fully understand the product, it's intended use and operation prior to use.
- Above all... be safe!

# GO RHINO®

## INSTALLATION INSTRUCTIONS

### PARTS INCLUDED IN THIS LIST:

ITEM	QTY.	DESCRIPTION	ITEM	QTY.	DESCRIPTION	ITEM	QTY.	DESCRIPTION
1	1	Frame Bracket (driver)	10	2	Vent Covers (pre installed)	19	6	1/2" x 1 1/2" Carriage Bolt
2	1	Frame Bracket (passenger)	11	2	Light Pod Plates (pre installed)	20	36	1/2" Flat Washer
3	1	Auxiliary Bracket (driver)	12	1	Light Pod Plates (pre installed)	21	26	1/2" Lock Washer
4	1	Auxiliary Bracket (passenger)	13	6	3/8" x 1 1/4" Hex Bolt	22	16	1/2" Hex Nut
5	1	Support Bracket (driver)	14	12	3/8" Flat Washer	23		
6	1	Support Bracket (passenger)	15	6	3/8" Lock Washer	24		
7	1	License Plate Bracket	16	6	3/8" Hex Nut	25		
8	1	Bumper Shell	17	12	1/2" x 1 1/2" Hex Bolt	26		
9	1	Winch Tray	18	8	1/2" x 2" Hex Bolt			

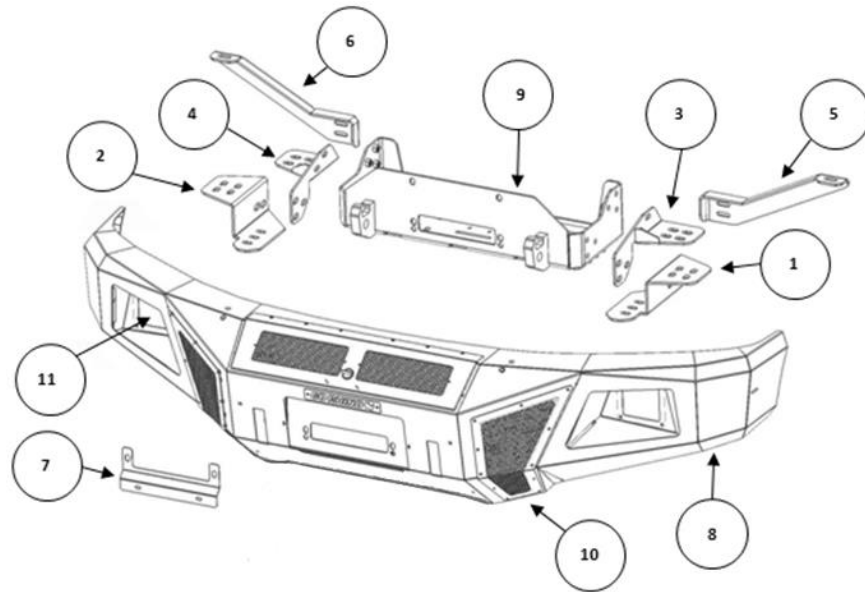

Go Rhino recommends you, the installer, read this installation instruction manual from front to back before installing the product.

### TOOLS NEEDED FOR INSTALLATION:

- 15mm, 18mm, 7/16", 9/16" & 3/4" Sockets
- 15mm, 18mm, 7/16", 9/16" & 3/4" Wrenches
- Slotted Blade Screw Driver
- 5/32" Hex Key
- Ratchet, Ratchet Extensions & Swivel Joint Adapter

ESTIMATED TIME FOR INSTALLATION:

2 Hour

# GORRHINO<sup>®</sup>

## INSTALLATION INSTRUCTIONS

### OEM Bumper Removal

**Step-1** Open the hood and disconnect the vehicle battery or batteries.

**Step-2** If the vehicle has these options or equipment.

#### Fog Lights

Unplug the fog light wiring harness and remove the plastic fastener securing the wiring harness to the bumper.

#### Engine Block Heater

Remove the plastic fastener securing the power cord to the bumper.

**Step-3** Using a 15mm socket and ratchet remove the bolts (2) per side securing the OEM bumper side supports to the frame, body mount bracket, (FIGURE-1).

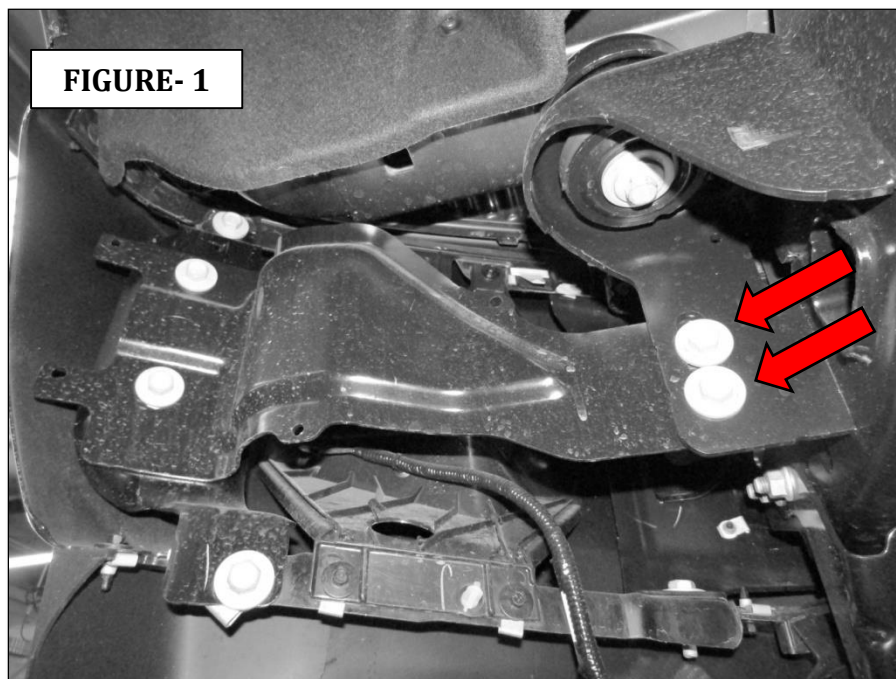

# GO RHINO<sup>®</sup>

## INSTALLATION INSTRUCTIONS

**Step-4** Remove the two plastic covers from around the tow hooks by unclipping the two top clips, (FIGURE-2).

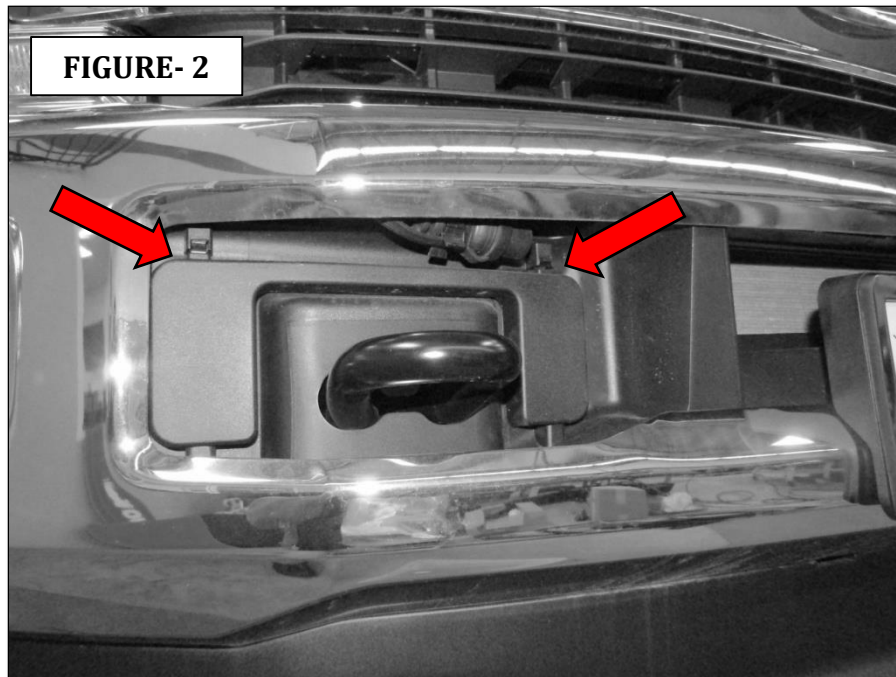

**Step-5** Using an 18mm socket and ratchet remove the bolts (4) per side around the tow hooks securing the OEM bumper to the bumper brackets, (FIGURE 3). With assistance, remove the OEM bumper from the vehicle and set it aside.

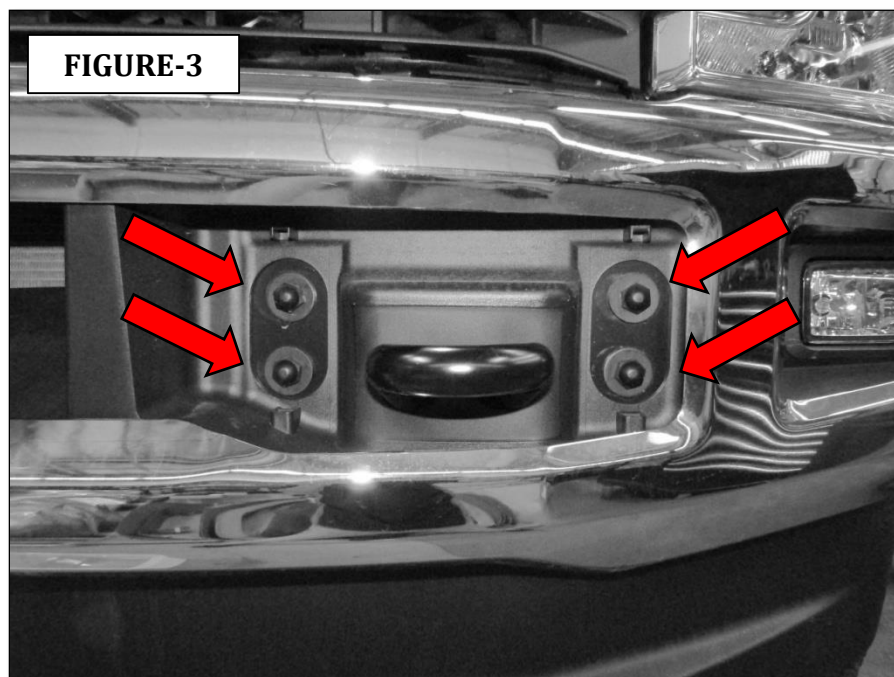

# GORRHINO®

## INSTALLATION INSTRUCTIONS

**Step-6** Using an 18mm socket and ratchet remove the bolts (4) per side securing the tow hook and bumper bracket assembly to the frame, (FIGURE 4).

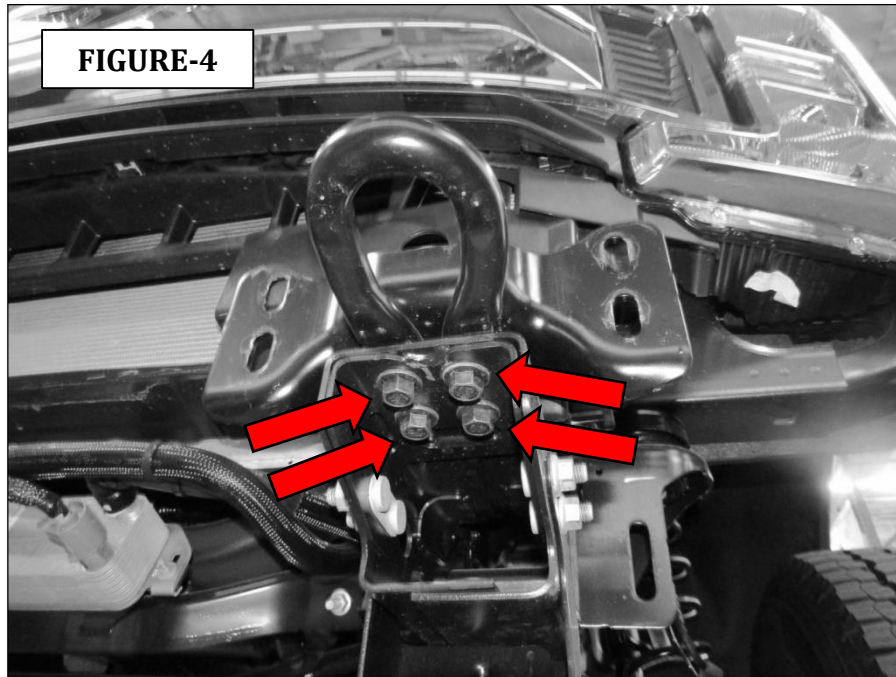

**Step-7** Using an 18mm socket and ratchet remove the nuts and paired bolts securing the under rider guards to the frame rails, (FIGURE 5). Retain the nuts and paired bolts as they will be used for installation of the frame brackets.

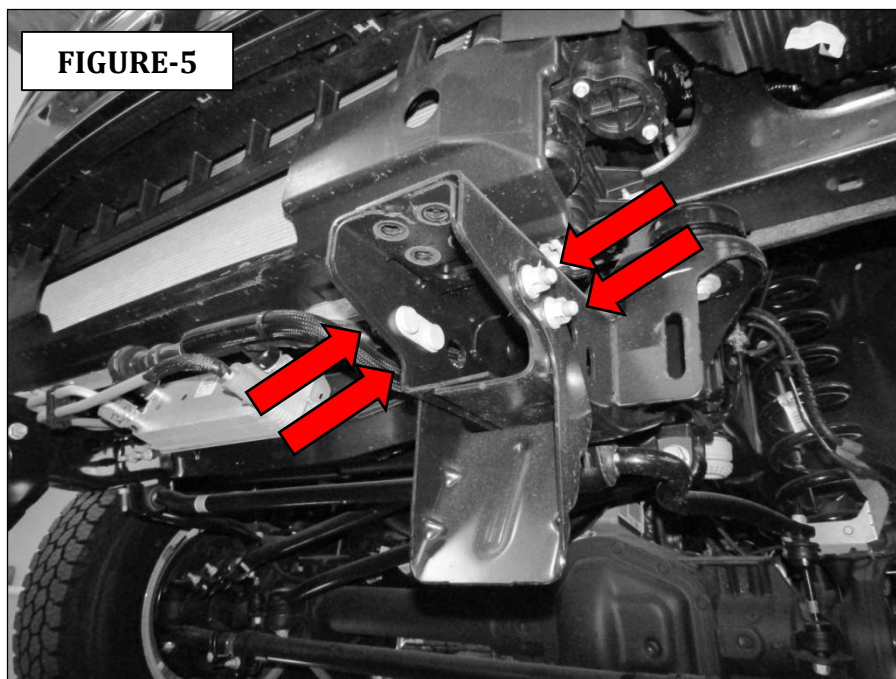

# GORRHINO®

## INSTALLATION INSTRUCTIONS

### BR10 Bumper Installation

**Step-1** Install the driver's side frame bracket by positioning the bracket over the top and side of the frame. Align the holes and secure the frame bracket to the side of the vehicle frame using one of the OEM paired bolts and nuts, (FIGURE-1). Leave the nuts and paired bolts loose for final adjustment. Repeat this step to install the passenger side frame bracket.

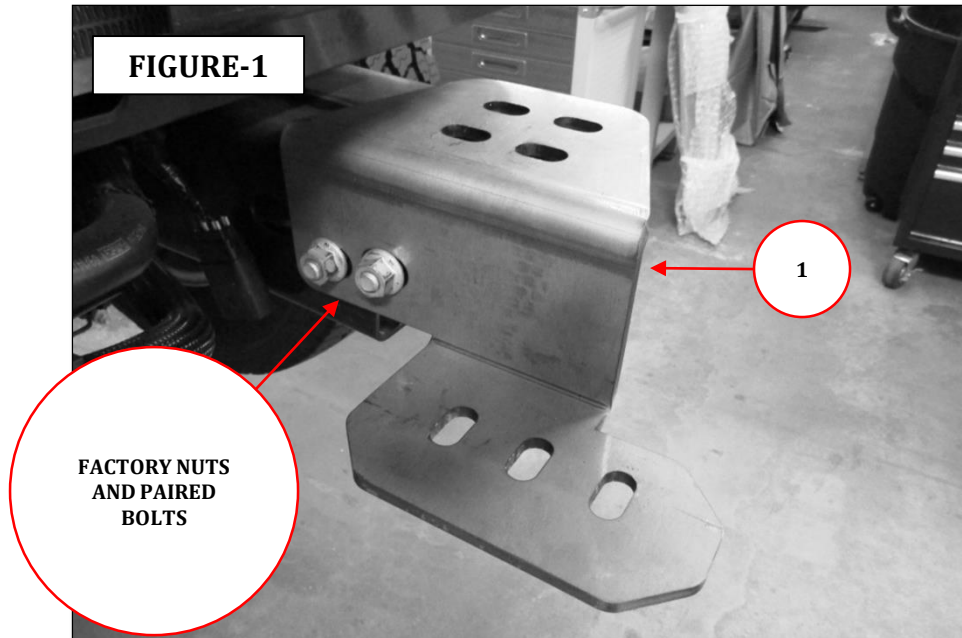

**Step-2** Install the driver's side auxiliary bracket by positioning the auxiliary bracket on top of the frame bracket, align the holes and secure the auxiliary bracket and frame bracket to the frame using (4) 1/2" x 2" hex bolts (8) 1/2" flat washers, (3) 1/2" lock washers and (4) 1/2" hex nuts. Leave the nuts and bolts loose for final adjustment, (FIGURE 2). Repeat this step to install the passenger side auxiliary bracket.

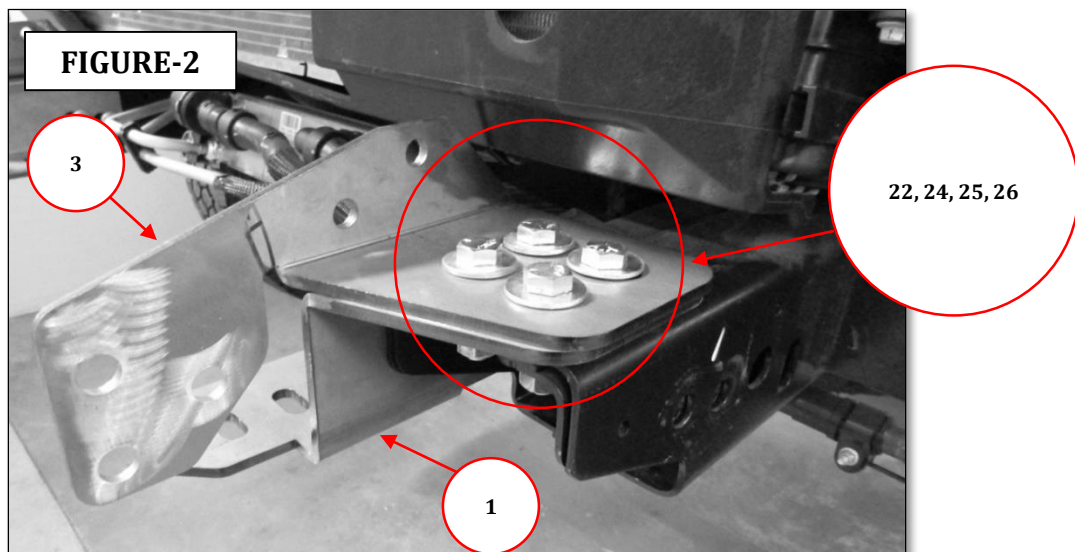

# GORRHINO®

## INSTALLATION INSTRUCTIONS

### BR10 Bumper Installation

**Step-3** Position the bottom of the winch tray on top of the frame brackets. Align the holes and secure the winch tray to each auxiliary bracket using (2) ½" x 1 ½" hex bolts, (2) ½" flat washers and (2) ½" lock washers, (FIGURE 3) and to each frame bracket using (3) ½" x 1 ½" carriage bolts, (3) ½" flat washers, (3) ½" lock washers and (3) ½" hex nuts, (FIGURE 4). Leave the nuts and bolts loose for final adjustment.

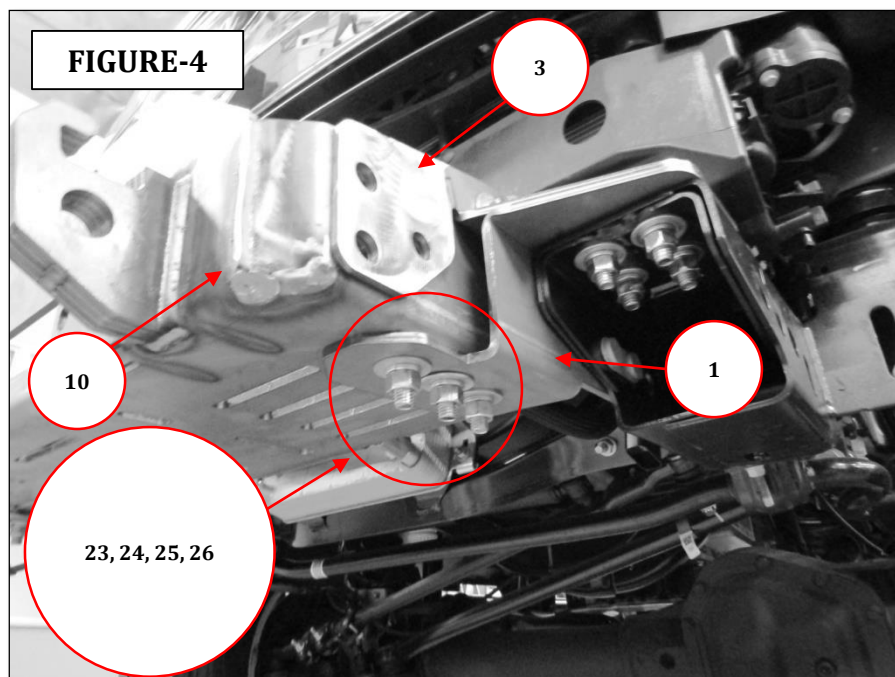
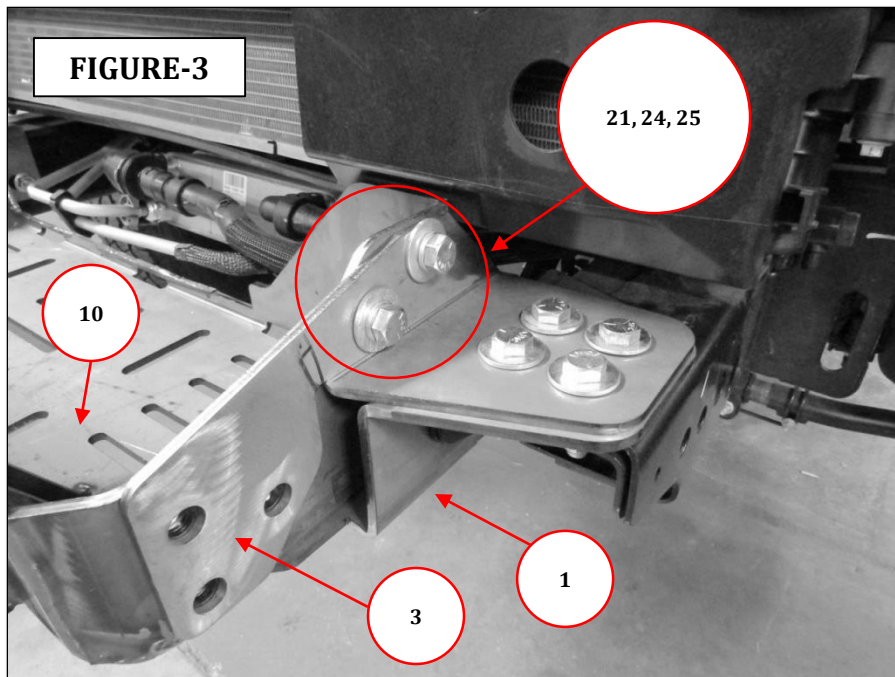



# GO RHINO®

## INSTALLATION INSTRUCTIONS

**Note:** If you are installing a winch, place the winch in the winch tray and refer to the winch manufacturer's instructions for installation. Do not install the fairlead at this time.

**Step-4** The pre-installed Mesh Vent Covers need to be removed using hand tools to slowly remove the bolts. Using an air assisted impact or ratchet will damage the bolt threads and Rubber Rivet-Nut assembly in the bumper shell.

**Step-5** With assistance lift the bumper shell up to the vehicle, align the holes in the bumper shell brackets with the auxiliary brackets, and weld nuts on the winch tray. Secure the bumper shell bracket and auxiliary bracket to each side of the winch tray using (3) ½" x 1 1/2" hex bolts, (3) ½" lock washers and (3) ½" flat washers, (FIGURE 5). Leave the bolts loose for final adjustment.

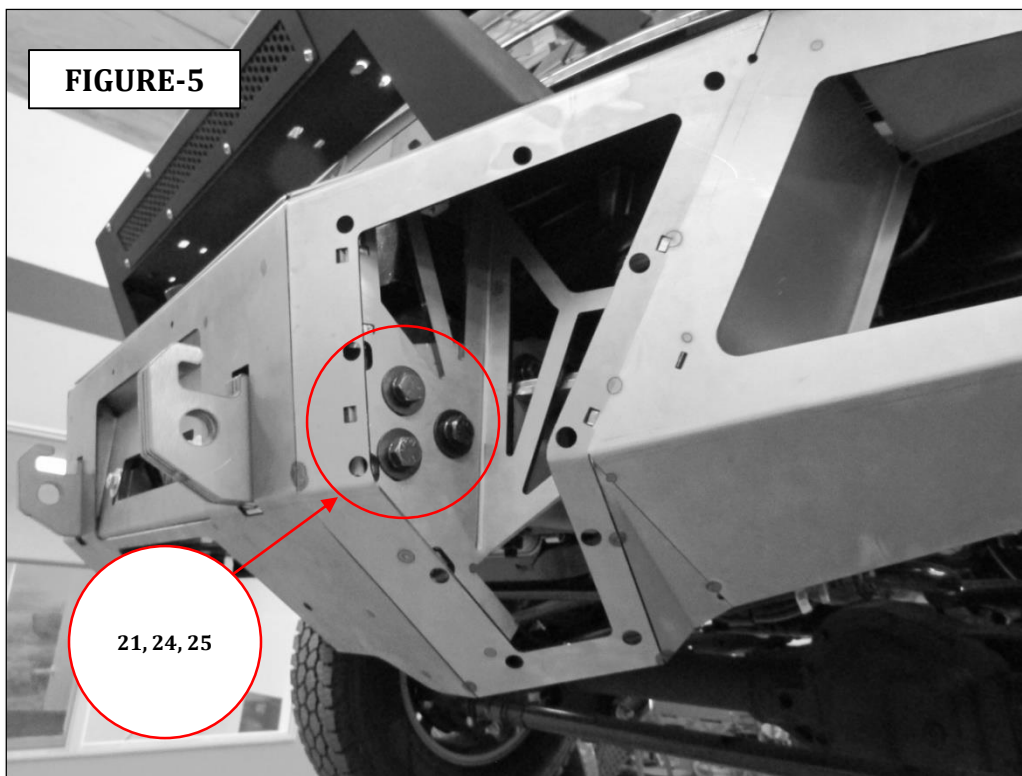

## INSTALLATION INSTRUCTIONS

**Step-6** Align the (2) holes in the bottom of the passenger side support bracket with the slot hole in the frame bracket used for attachment of the OEM bumper support bracket, and secure the passenger side support bracket to the frame using (2) 3/8" x 1 1/4" hex bolts, (2) 3/8" lock washers and (4) 3/8" flat washers and (2) 3/8" hex nuts. Attach the opposite end of the support bracket to the bumper shell bracket using (1) 1/2" x 1 1/2" hex bolt, (1) 1/2" lock washer, (2) 1/2" flat washers and (1) 1/2" hex nut, (FIGURE 6 & 7). Repeat step to install the driver side support bracket.

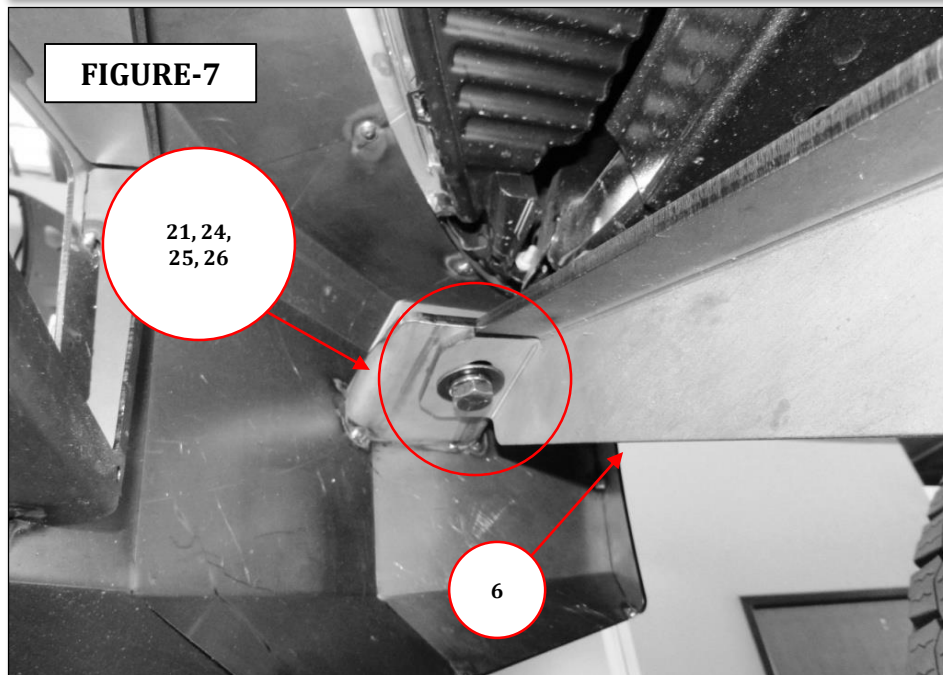
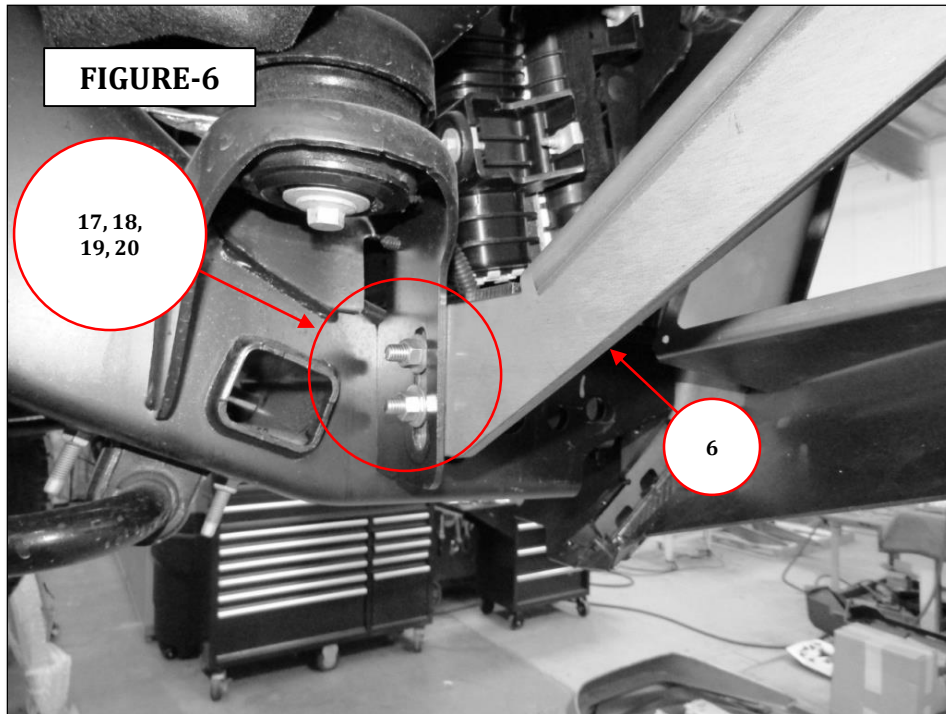

# GO RHINO®

## INSTALLATION INSTRUCTIONS

**Step-7** With assistance, adjust and hold the bumper shell visual alignment position, then tighten all factory and supplied nuts and bolts.

**Step-8** If installing a winch, install the roller fairlead to the bumper shell at this time. Refer to the winch manufacturer's instructions for installation. If installing an optional light bar, install the light bar to the bumper replacement at this time. Refer to the light bar instructions for installation.



FIGURE-8

**Step-9** Re-install the passenger and driver side front vent covers to the bumper shell using the 1/4" x 1" button head bolts, 1/4" plastic flat washers and 1/4" rubber rivet-nuts removed in step 4, (FIGURE 9).

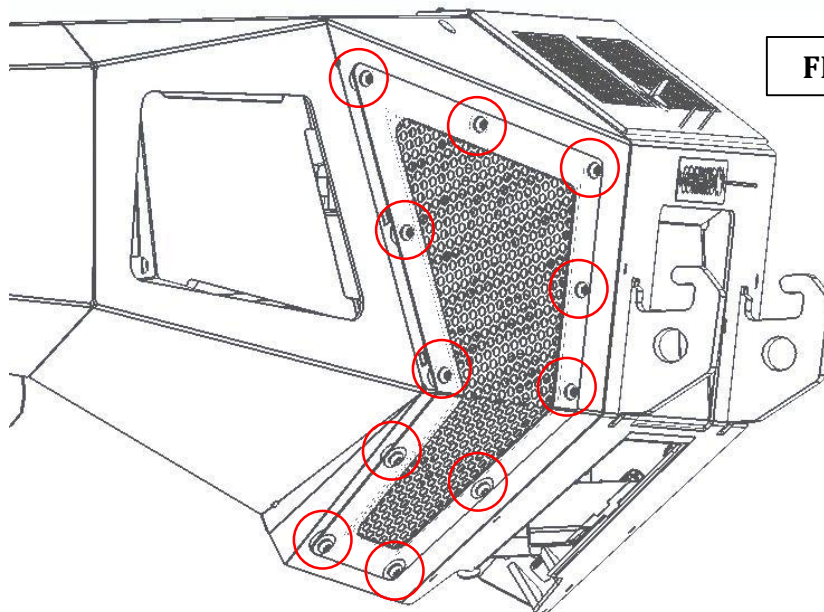

FIGURE-9

# GORRHINO®

## INSTALLATION INSTRUCTIONS

**Step-10** If your state law requires a front license plate, attach the license plate bracket to the holes in the face of the bumper shell, using the supplied 3/8" bolts, washers and nuts. If installing a winch, attach the license plate directly to the holes in the hitch cover, (FIGURE 9).

FIGURE-9

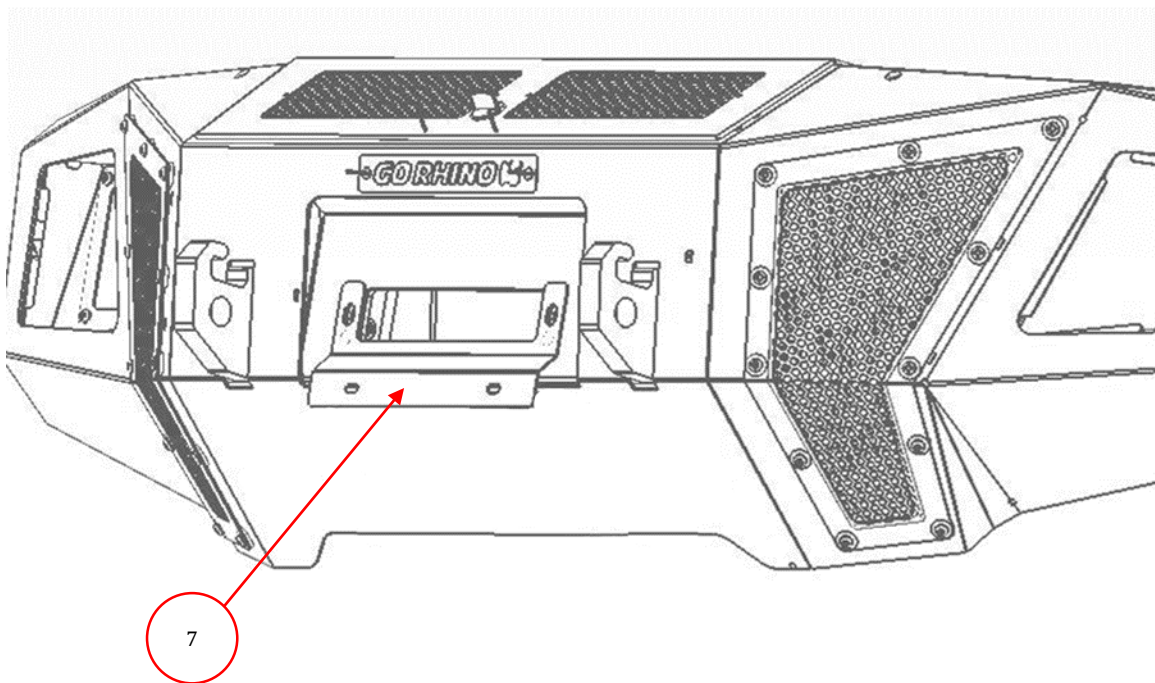

Remember to check and retighten all factory and supplied nuts and bolts periodically.