

GO RHINO!

PRODUCTS®

Built to demand respect!

Xtreme
Racks

Innovative Truck Racks!

QuickRack™

HitchStep™ Installation Instructions

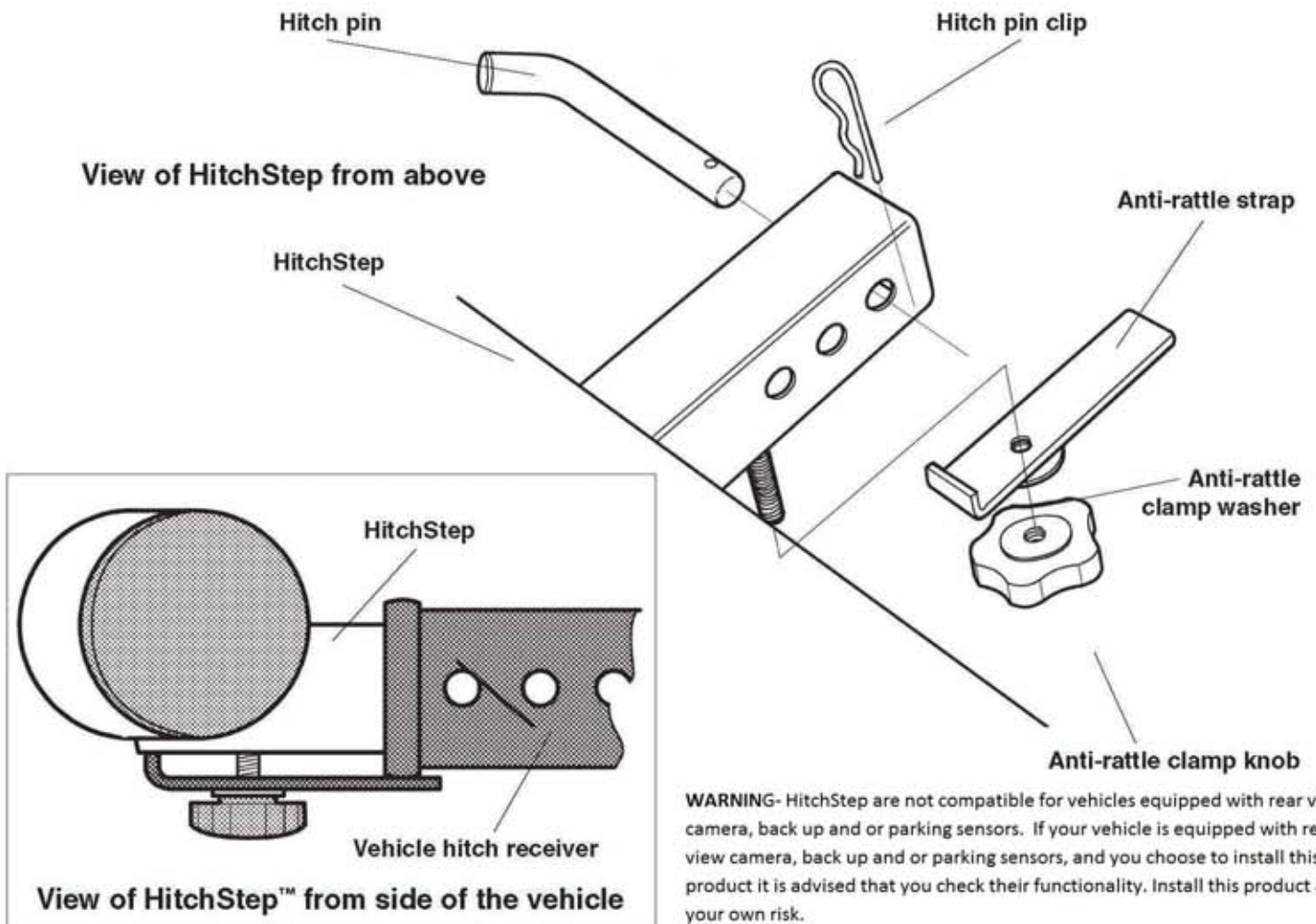

WARNING- HitchStep are not compatible for vehicles equipped with rear view camera, back up and or parking sensors. If your vehicle is equipped with rear view camera, back up and or parking sensors, and you choose to install this product it is advised that you check their functionality. Install this product at your own risk.

The Go Rhino! HitchStep™ is quick and easy to install requiring no special tools.

Insert the HitchStep post into the vehicle's hitch receiver. The HitchStep has 3 holes for alignment. Position the HitchStep to your liking and align up the nearest hole with the hole in the receiver. Push hitch pin through the holes and secure with the hitch pin clip provided. Note: You may prefer to use a locking hitch pin, any popular make will work with the HitchStep.

If you need to use the receiver for towing, remove the HitchStep and replace with your tow hitch. When the

HitchStep is not in use, it can be stored in the storage bag provided. This will keep the inside of your vehicle clean. The HitchStep should be cleaned and cared for in the same manner that you clean and care for your vehicle. Do not use abrasive cleaners on the finish. In extreme weather conditions, you may wish to lubricate the anti-rattle clamp knob thread with WD40 or grease. Thank you for choosing Go Rhino! Products.