

INSTALLATION INSTRUCTIONS

Dakar Sport 52289(1-4) / Dakar 52289(1BB-4BB) / Rhino Charger BB52289(1B-4PS)

TOYOTA TUNDRA 2007

Parts List:

Qty:		(1) Hardware kit including
1) 1	Bull Bar / Dakar Sport	3) 2 1/2 x 2" Hex head bolt
2) 1	Main mounting bracket set	4) 2 1/2" Flat washers
		5) 6 1/2" Lock washers

Bull Bar / Dakar Sport

1



2



Bracket, passenger side.

Tool Required:

3/4" Socket	17 mm Socket	Ratchet
3/4" Wrench	Extensión	

Instructions:

Approximated installation time: 30 min.

1. Before beginning installation, read the instructions thoroughly and completely. If any of the items listed above are missing, please do not proceed with the installation. Call your distributor immediately to obtain the necessary items.
2. Locate the factory tow hooks in front of the vehicle's frame and remove them.
3. Insert the bracket and the tow hook back into the original location. Re-attach using the original bolts and repeat on the opposite side. Leave loose. See Pictures 1 and 2.

PICTURE 1



Tow Hook

PICTURE 2



Bracket and tow hook. Passenger side.

Cleaning and care instructions:

Protect the finish with a non-abrasive automotive wax, (e.g. Pure Carnauba) on a regular basis. The use of any soap, polish, or wax that contains an abrasive is detrimental to the finish, as the compounds scratch the finish and cause corrosion.

INSTALLATION INSTRUCTIONS

Dakar Sport 52289(1-4) / Dakar 52289(1BB-4BB) / Rhino Charger BB52289(1B-4PS)

TOYOTA TUNDRA 2007

4. Install your Bull bar / Dakar sport over the main brackets with (1) 1/2 x2" hex head bolts, (1) 1/2" flat washers and (1) 1/2" lock washer to each side. Leave loose. Image 1.
5. Make any adjustment to your Bull Bar / Dakar Sport and tighten all hardware.
6. Periodically check and re-tighten bolts as necessary over the term of use.
7. Fill out included warranty card and place in the vehicle.

IMAGE 1

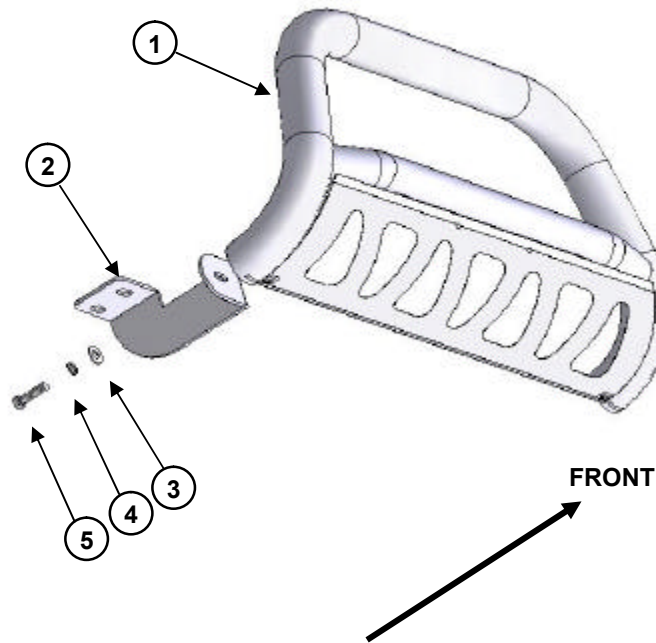

Image 1. Passenger side bracket.

Cleaning and care instructions:

Protect the finish with a non-abrasive automotive wax, (e.g. Pure Carnauba) on a regular basis. The use of any soap, polish, or wax that contains an abrasive is detrimental to the finish, as the compounds scratch the finish and cause corrosion.