

**11-14 Ford F250-F450 Installation
Instructions**
FBR #300-11-1005, XFBR #600-11-1005
SFBR # 120-11-1005

Bolt Bag Contents:

| Quantity | Description |
|----------|-------------------------|
| 2 | Bottom support brackets |
| 20 | 1/2" Flat Washers |
| 10 | 1/2" X 1-3/4" Bolts |
| 10 | 1/2" Hex Nuts |
| 10 | 1/2" Lock Washers |
| 10 | 1/4" Lock washers |
| 20 | 1/4" flat washers |
| 10 | 1/4" Lock nut |
| 10 | 1/4" X 1" hex bolts |
| 102 | Total Pieces |

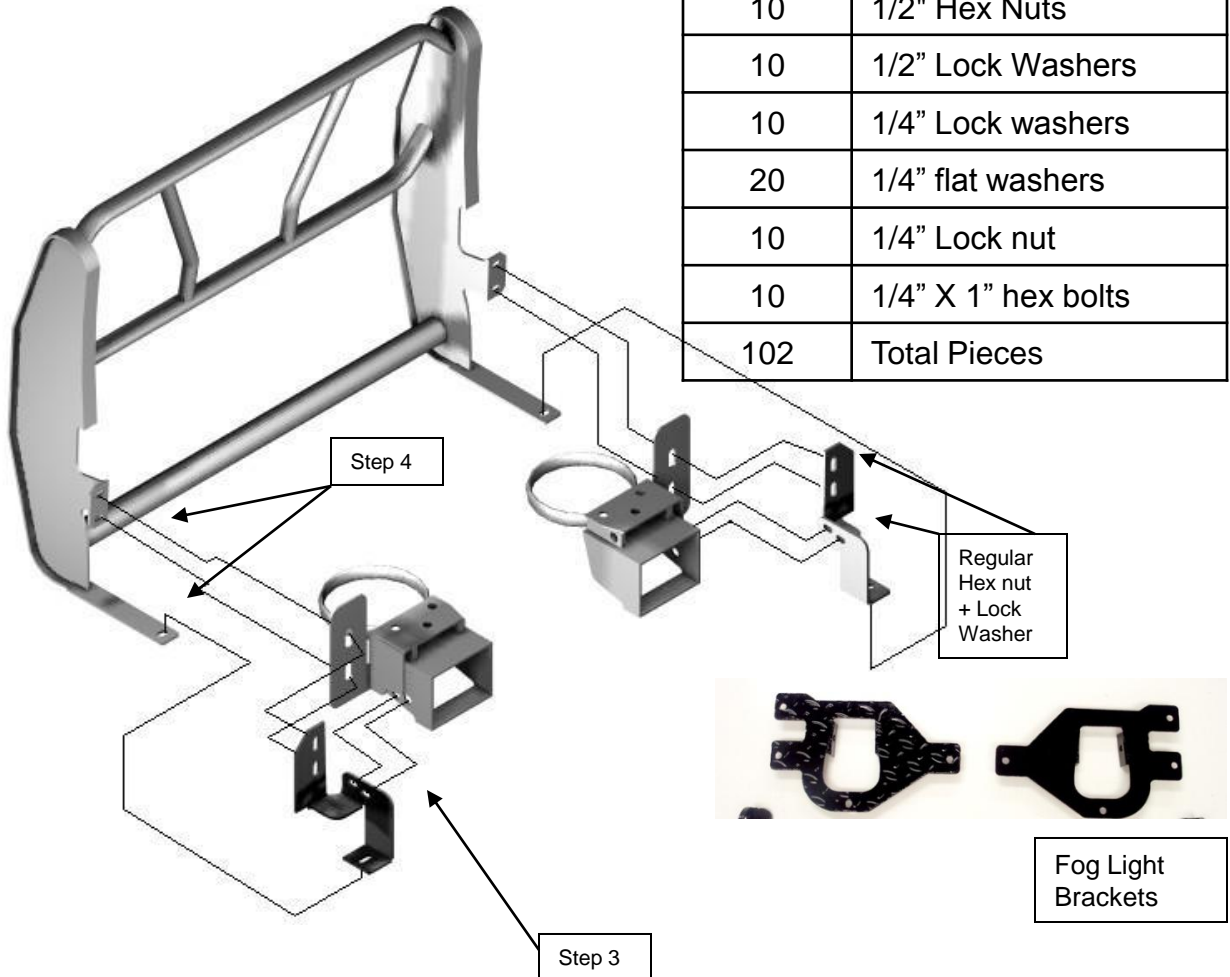

Step 1: [Remove factory bumper](#). Note: Do not remove factory tow hooks.

Step 2: Remove factory fog lights from factory bumper and attach to bracket provided. Attach this bracket and light to the pegs on the underside of FBR.

Step 3: Install bottom support bracket behind frame horn. NOTE: You must use regular 1/2" hex nuts and 1/2" lock washers on the bolts going through the truck frame!! You will access the bolt head through a small hole located on the inside/bottom of truck frame when you are tightening.

Step 4: Mount Front Bumper Replacement (FBR) to frame horn and Bottom Support Bracket using 1/2" lock nuts. Bolts will go through the FBR bracket and the frame horn on the front. Foot of FBR on the bottom goes UNDER bottom support bracket.

Step 5: Check alignment of FBR to truck and tighten all bolts.