

07-13 Chevrolet 1500, 07-10 2500HD, 3500HD Grille Guard & Xtreme [Grill Guard](#) Installation Instructions. Part # 200-20-7005(1500), 700-20-7005(XGG 1500), 200-20-7006 (HD) 700-20-7006 (XGG HD)

Total Bolt Bag Contents Packaged	
Quantity	Description
8	1/2" Flat Washers
4	1/2" Lock Washer
4	1/2" Hex Nuts
4	1/2" X 1 3/4" Bolts
2	Bumper Support Brackets
22	Total Pieces

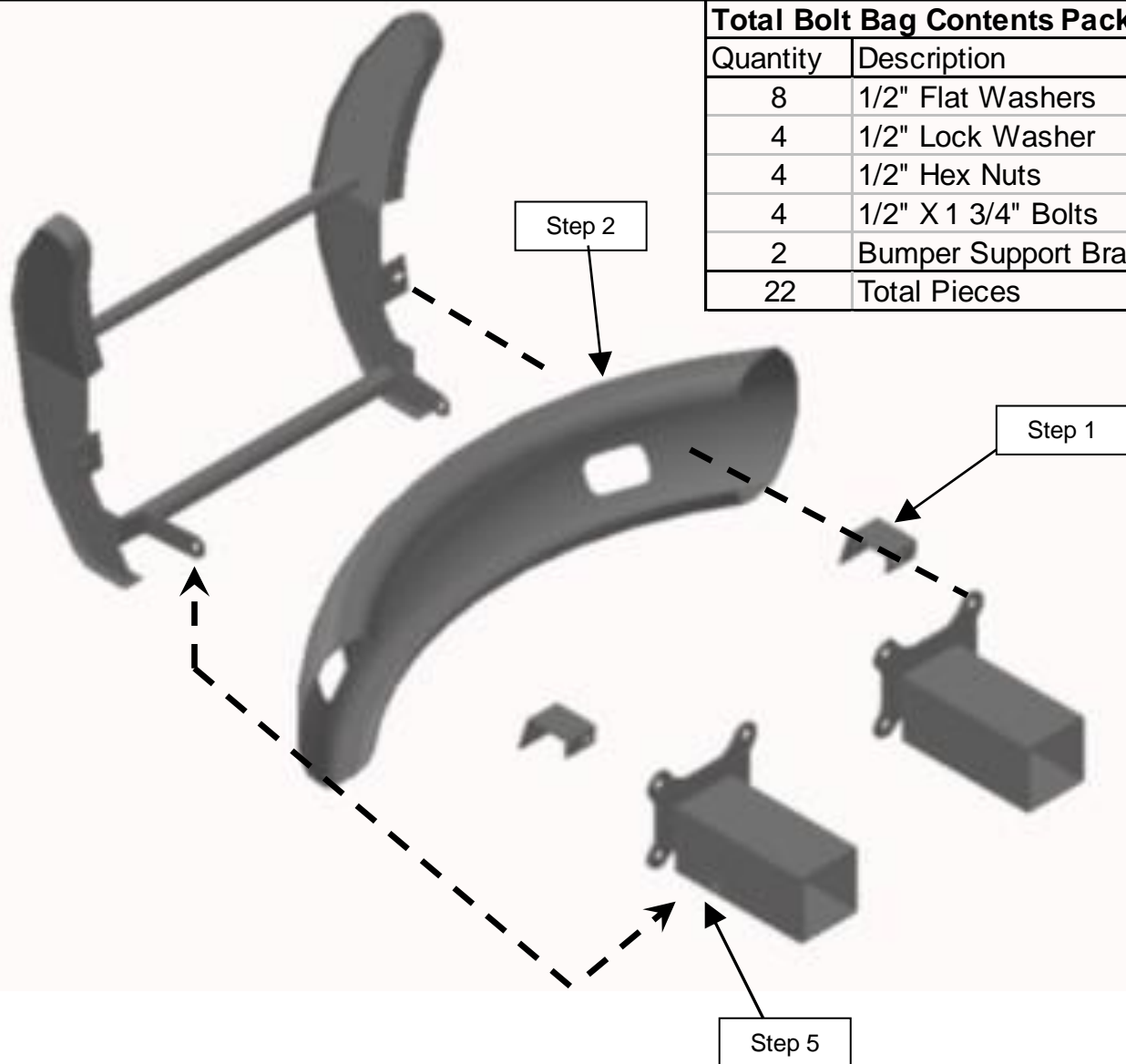

Step 1: Remove two top factory bumper bolts and the outside top factory bolt clip!! (Note: Do not remove factory bumper). Once the top outside factory clip is removed you can put the inside bolt back through bumper. Install Frontier bumper support bracket behind bumper and bolt to the frame hole that you just removed the factory bolt from. Tighten bolt using bolt supplied. (Hint – Brackets should fit snug against the back of the chrome bumper. You might have to loosen bottom bumper bolts in order to have enough room to remove the factory clip up top!!)

Step 2: Hold Grille Guard up to truck and measure loops to body and position grille guard evenly. Mark holes on bumper that you will drill next.

Step 3: Align grille guard to truck and drill 1/2 inch hole through chrome bumper and bumper support bracket installed in step 1.

Step 4: Insert 1/2 X 1-3/4 inch bolts through grille guard, chrome bumper, and bumper support bracket.

Step 5: Remove outside tow hook bolt (HINT: use the bolt that goes all the way through the frame) and Insert bottom of Grille Guard to the outside of the frame (tow hook hole). Re-Install tow hook bolt on both feet.

Step 6:

Check alignment of grille guard to truck and tighten all bolts.