



FRONT RUNNER
VEHICLE OUTFITTERS

FOOT RAIL
TOYOTA FJ CRUISER

FATF004

START HERE!

READ ME FIRST

Don't be a hero and muscle through this without first reading these fitting instructions! Improper installation of this gear may void certain aspects of your warranty.

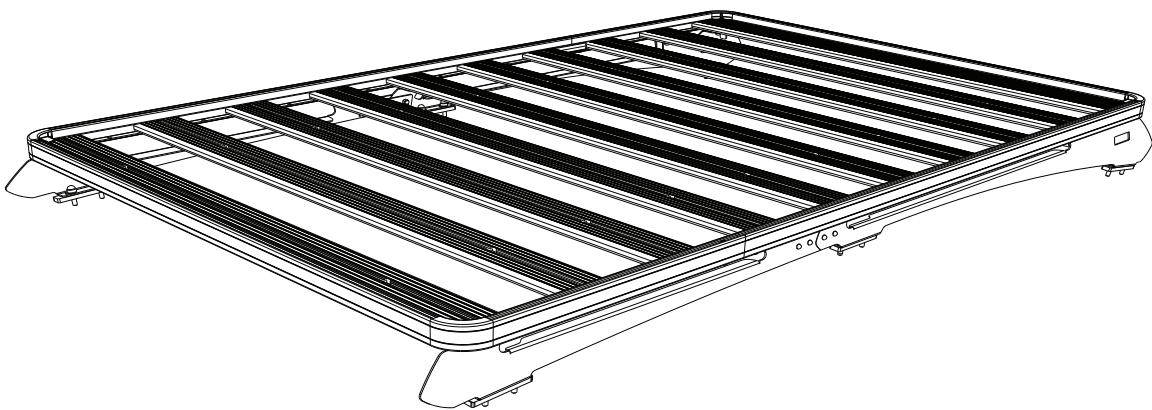
Before you begin, take a moment and open all your Front Runner rack kit boxes and gather the assembly instructions for the various components.

A complete kit will contain:

1. A Front Runner Mounting System specific to your vehicle
2. A Front Runner Rack Tray or Load Bar Slats

This document will guide you through the assembly of the mounting system and assist you in fitting the roof rack tray or load bars to your specific vehicle.

Please refer to the next page for a list of all the components, quantities and tools required.



IMPORTANT WARNING!

FRONT RUNNER CAN NOT RECOMMEND A MAXIMUM LOAD CARRYING CAPACITY. PLEASE REFER TO YOUR VEHICLE MANUFACTURER'S RECOMMENDATIONS. IT IS CRITICAL THAT ALL FRONT RUNNER PRODUCTS BE PROPERLY AND SECURELY ASSEMBLED AND ATTACHED TO YOUR VEHICLE. IMPROPER ATTACHMENT COULD RESULT IN AN AUTOMOBILE ACCIDENT, AND COULD CAUSE SERIOUS BODILY INJURY OR DEATH. YOU ARE RESPONSIBLE FOR ASSEMBLING AND SECURING ALL FRONT RUNNER PRODUCTS TO YOUR VEHICLE. CHECKING THE ATTACHMENTS PRIOR TO USE, AND PERIODICALLY INSPECTING THE PRODUCTS FOR ADJUSTMENT, WEAR AND DAMAGE. THEREFORE YOU MUST READ AND UNDERSTAND ALL OF THE INSTRUCTIONS AND PRECAUTIONS SUPPLIED WITH YOUR FRONT RUNNER PRODUCT PRIOR TO INSTALLATION OR USE. IF YOU DO NOT UNDERSTAND ALL OF THE INSTRUCTIONS AND CAUTIONS, OR IF YOU HAVE NO MECHANICAL EXPERIENCE AND ARE NOT THOROUGHLY FAMILIAR WITH THE INSTALLATION PROCEDURES, YOU SHOULD HAVE THE PRODUCT INSTALLED BY A PROFESSIONAL INSTALLER OR OTHER QUALIFIED PERSONNEL.

1

GET ORGANIZED

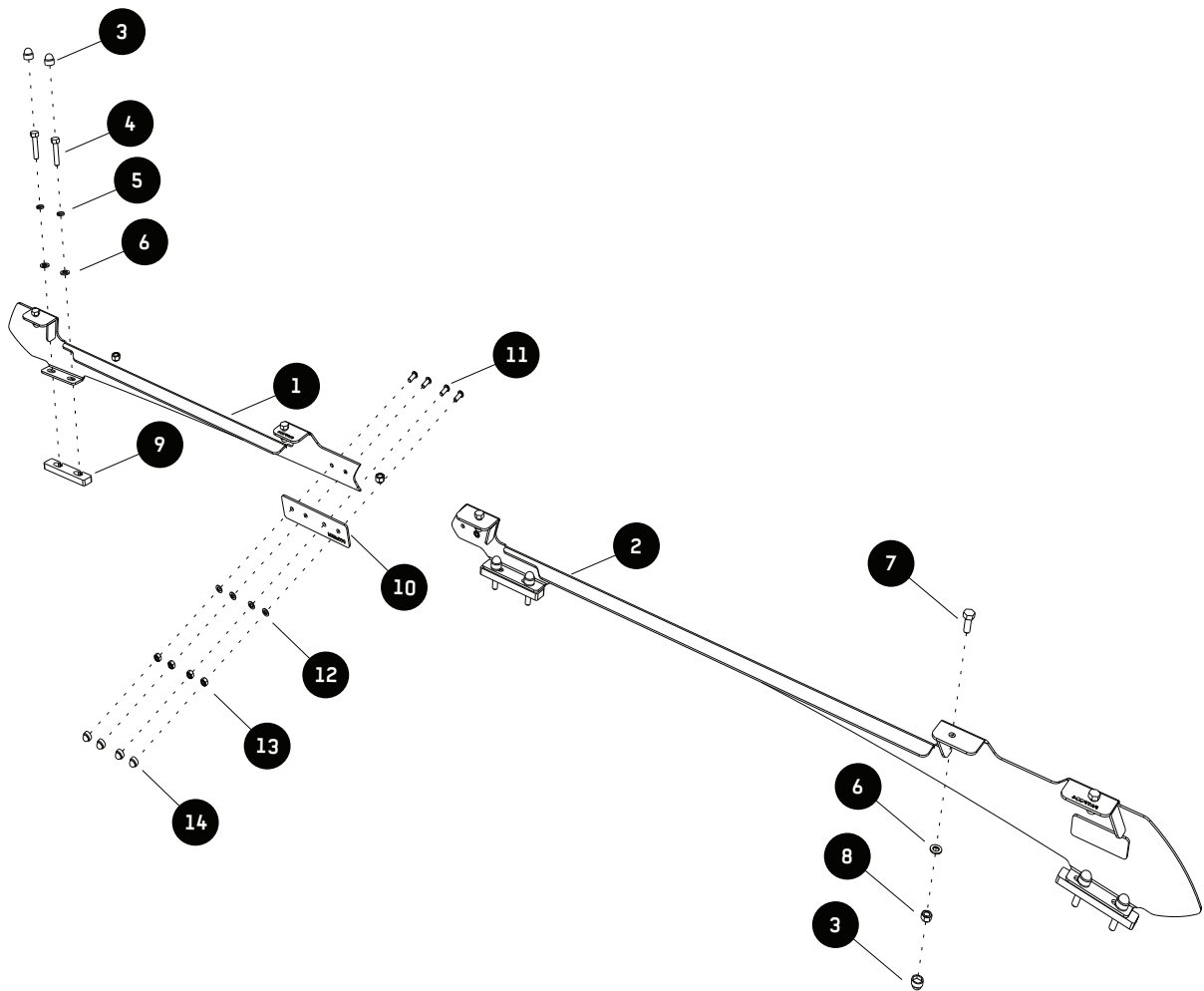
IN THE BOX

1	2 X	Foot Rail Front 1LH + 1RH
2	2 X	Foot Rail Rear 1LH + 1RH
3	22 X	M8 Nut Cap
4	12 X	M8 x 35 Hex Bolt
5	12 X	M8 SS Spring Washer
6	22 X	M8 x 16 x 1.6SS Flat Washer
7	10 X	M8 x 20 Hex Bolt
8	12 X	M8 Nyloc Nut
9	6 X	Spacer
10	2 X	Joiner Plate
11	8 X	M6 x 16 Button Head Bolt
12	8 X	M6 x 12 x 1SS Flat Washer
13	8 X	M6 Nyloc Nut
14	8 X	M6 Nut Cap

TOOLS NEEDED

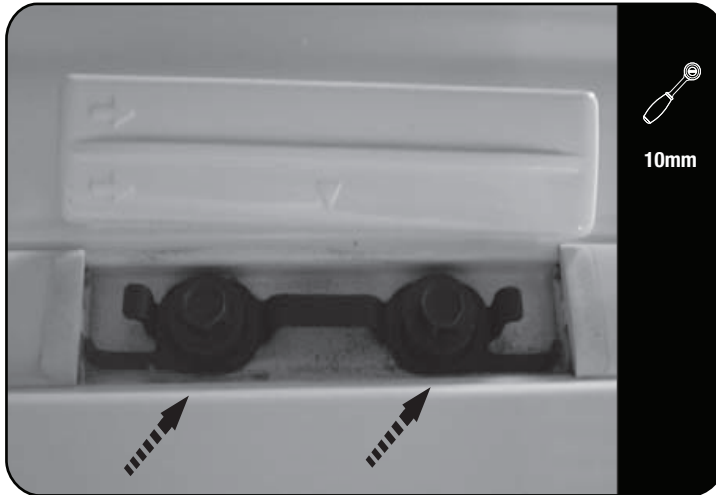


FIGURE 1.1



2**FIT AND SECURE THE FOOT RAIL**

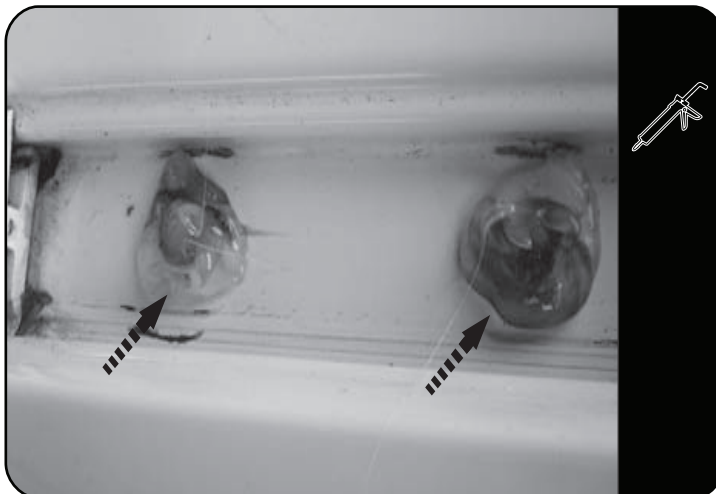
2.1



Unclip and remove the six covers on the top of the vehicle's roof to expose the vehicle's mounting points. There are three on each side of the roof in the front, middle and rear.

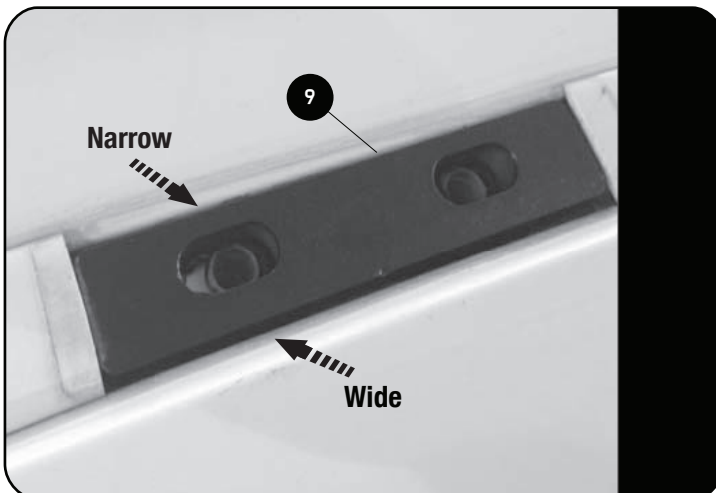
Remove the 8mm Bolts indicated by the arrows.

2.2



Clean the area around the bolt holes using a rag and methylated spirits/denatured alcohol. Place some silicone over each bolt hole.

2.3

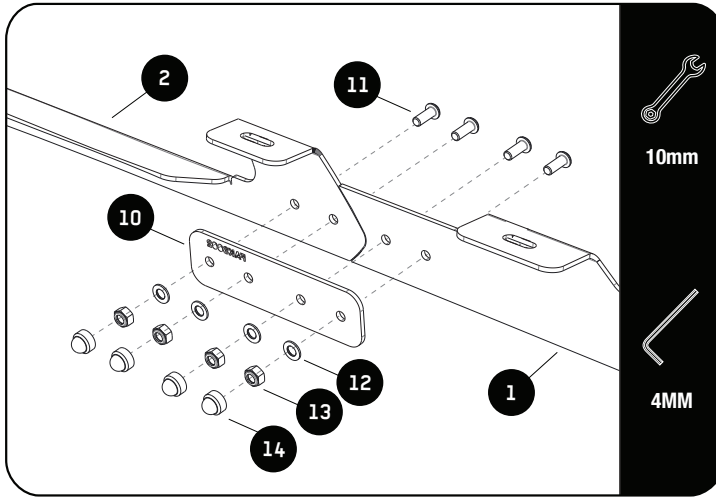


Place a Spacer (Item 90) into each of the mounting point recesses, lining up the holes in the Spacer with the bolt holes in the roof. Ensure that the wide section of the Spacers (as indicated in the image) go towards the outside of the vehicle.

2

FIT AND SECURE THE FOOT RAIL

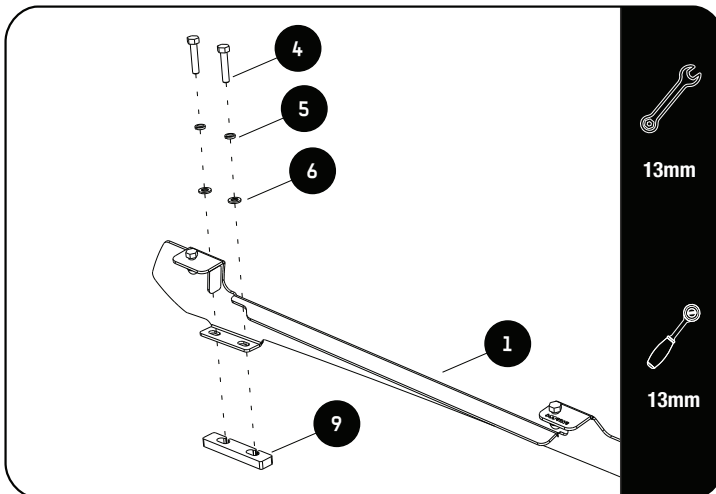
2.4



Join the Front and Rear Foot Rails (Items 1 & 2) together using M6 x 16 Button Head Bolts, M6 x 12 x 1SS Flat Washers, M6 Nyloc Nuts and the Joiner Plates (Items 10, 11, 12 & 13).

Place a M6 Nut Cap (Item 14) over each of the Nyloc Nuts.

2.5

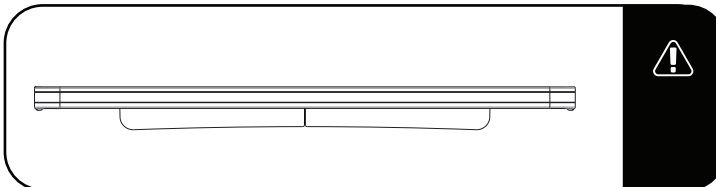


Place the assembled Foot Rail on the vehicle and line up the mounting holes in the Foot Rails with the mounting holes in the roof. The product sticker goes to the rear and outside of the vehicle. Starting from the front, loosely fasten the Foot Rail to the vehicle using M8 x 35 Hex Bolts, M8 x 16 x 1.6SS Flat Washers and M8 Spring Washers (Items 4, 5 & 6).

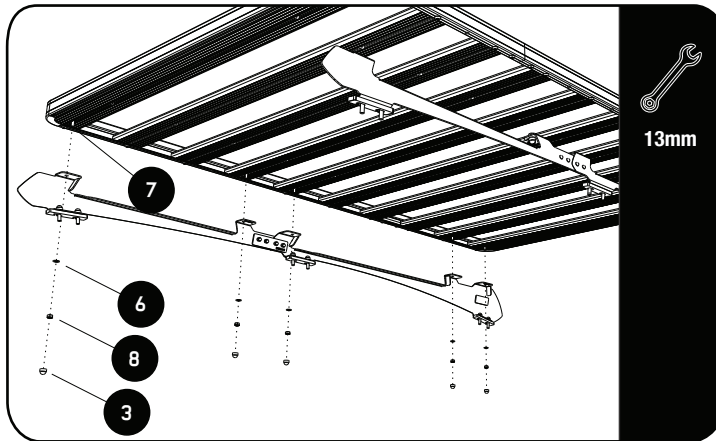
Tighten all bolts securing the Foot Rails to the vehicle and place a M8 Nut Cap (Item 3) over each bolt.

3**FIT AND SECURE THE RACK****3.1**

Refer to RRSUNI when assembling your Slimline II Tray.

**3.2**

Make sure that the wind deflector is installed before you proceed to the next step.

3.3

13mm



Fit your roof rack to the Foot Rails using M8 x 20 Hex Bolts, M8 x 16 x 1.6SS Flat Washers and M8 Nyloc Nuts (Items 6, 7 & 8) as shown.

3.4

Center the rack and tighten fully. Place M8 Nut Caps (Items 3) over all the nuts.



4

COMPLETION

4.1



Congratulations! You did it. Take a step back and admire your work!

5

Front Runner will not be responsible for any damage caused by the failure to install the product according to these instructions. Please call us if you have any questions about the installation of this product.

6

INSTALL OTHER VEHICLE AND RACK ACCESSORIES



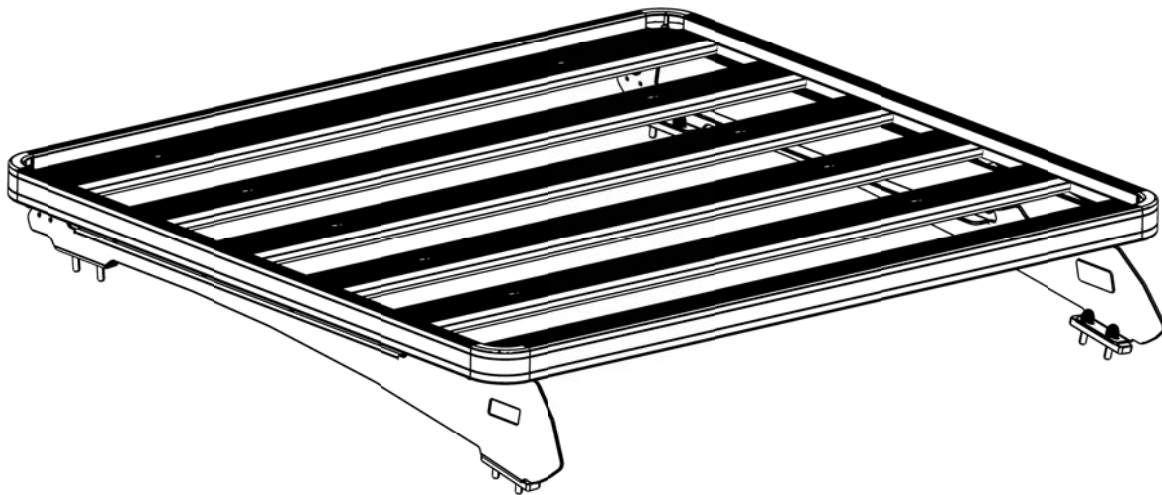
FRONT RUNNER

**TOYOTA FJ CRUISER
SLIMLINE II - HALF RACK
(1255MM X 1156MM)**

FATF004 / KRTF021T



INSTALL TIME: 60 mins



READ ME FIRST:



Thank you for purchasing a Front Runner Slimline II Rack.

This Roof Rack consists of a kit that contains:

- 1.) A Slimline II Tray
- 2.) A mounting system specific to your vehicle

This document will help you fit the Slimline II Tray to your specific vehicle.

IMPORTANT WARNING!

IT IS CRITICAL THAT ALL FRONT RUNNER PRODUCTS BE PROPERLY AND SECURELY ASSEMBLED AND ATTACHED TO YOUR VEHICLE. IMPROPER ATTACHMENT COULD RESULT IN AN AUTOMOBILE ACCIDENT, AND COULD CAUSE SERIOUS BODILY INJURY OR DEATH TO YOU OR TO OTHERS. YOU ARE RESPONSIBLE FOR ASSEMBLING AND SECURING ALL FRONT RUNNER PRODUCTS TO YOUR VEHICLE, CHECKING THE ATTACHMENTS PRIOR TO USE, AND PERIODICALLY INSPECTING THE PRODUCTS FOR ADJUSTMENT, WEAR, AND DAMAGE. THEREFORE, YOU MUST READ AND UNDERSTAND ALL OF THE INSTRUCTIONS AND CAUTIONS SUPPLIED WITH YOUR FRONT RUNNER PRODUCT PRIOR TO INSTALLATION OR USE. IF YOU DO NOT UNDERSTAND ALL OF THE INSTRUCTIONS AND CAUTIONS, OR IF YOU HAVE NO MECHANICAL EXPERIENCE AND ARE NOT THOROUGHLY FAMILIAR WITH THE INSTALLATION PROCEDURES, YOU SHOULD HAVE THE PRODUCT INSTALLED BY A PROFESSIONAL INSTALLER OR OTHER QUALIFIED PERSONNEL.



The Foot Rail Mounting Kit (FATF004) that you received is suitable for mounting a Half Rack (1255 x 1156 mm) or Full Rack (1255 x 1964 mm). You have chosen to mount a Half Rack and not all of the components supplied will be used. It is suggested that all additional components be stored for use at a later stage should you wish to upgrade to a Full Rack.

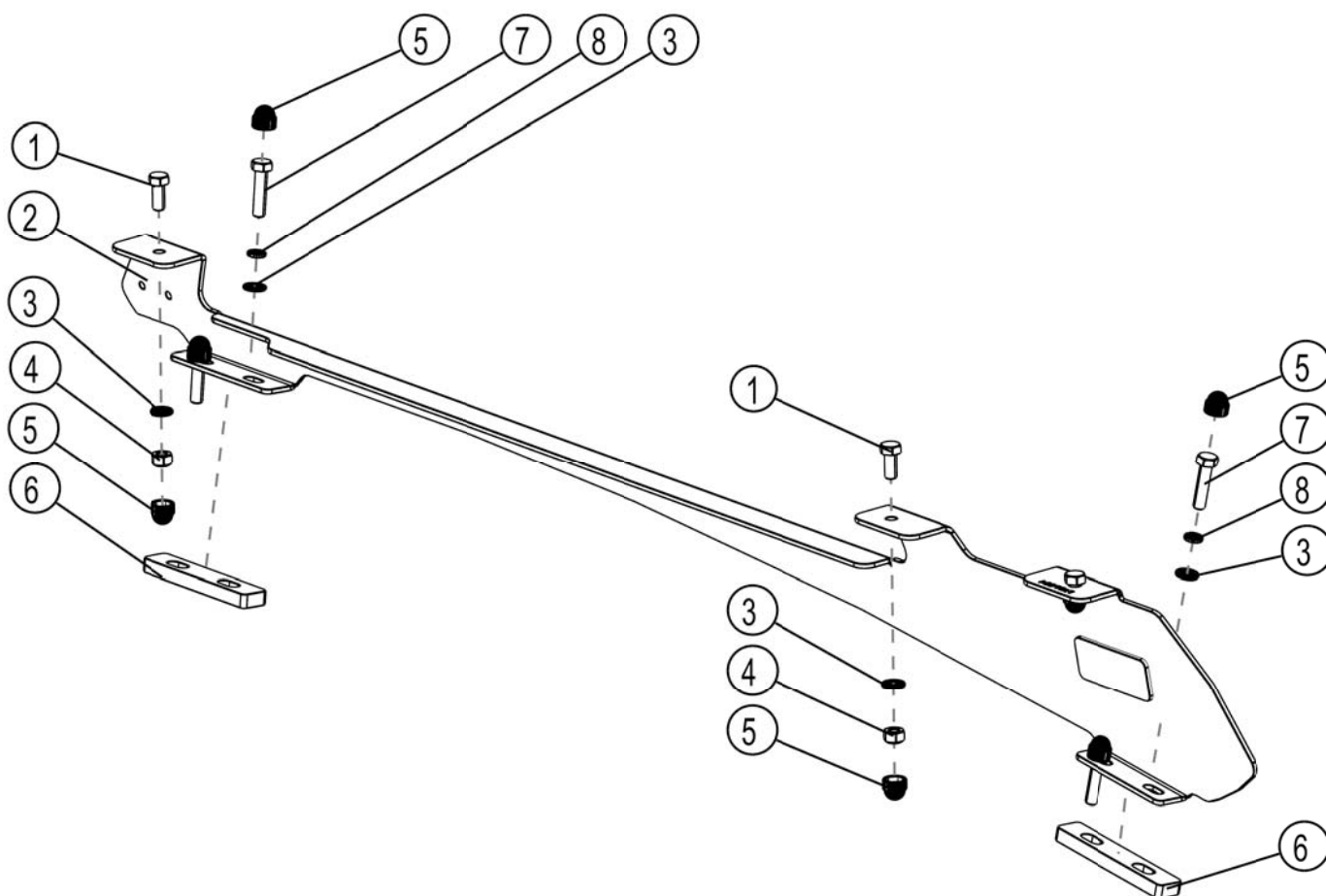
1 GET ORGANIZED...

Here is what you are looking at: Please note that only the right hand side's components have been shown.

Item #	Quantity	Description
1	6	M8 x 20 HEX BOLT
2	2	REAR FOOTRAIL - 1 LEFT, 1 RIGHT
3	14	M8 FLAT WASHER
4	6	M8 NYLOC NUT
5	14	M8 NUT CAP
6	6	SPACER
7	8	M8 x 35 HEX BOLT
8	8	M8 SPRING WASHER

You will need:

- 13 mm Flat or Socket Wrench
- 10 mm Flat or Socket Wrench
- 4 mm Hex Key
- Measuring Tape
- Rag and some Methylated Spirits / Denatured Alcohol
- Tube of Silicone



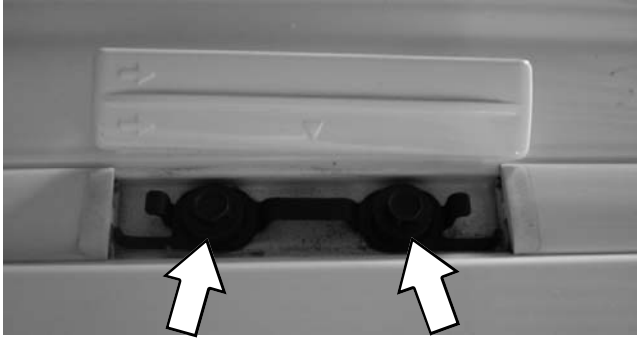
(A) Familiarize yourself with the parts and then step away from the work area and read through these instructions from beginning to end. Take a moment as a little prep now may save you a lot of time later.

2

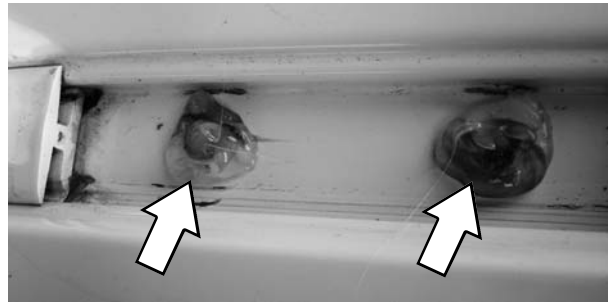
FIT THE FOOT RAILS

- (A) Unclip and remove the rear and middle covers each side on the top of the vehicle's roof to expose the vehicle's mounting points.

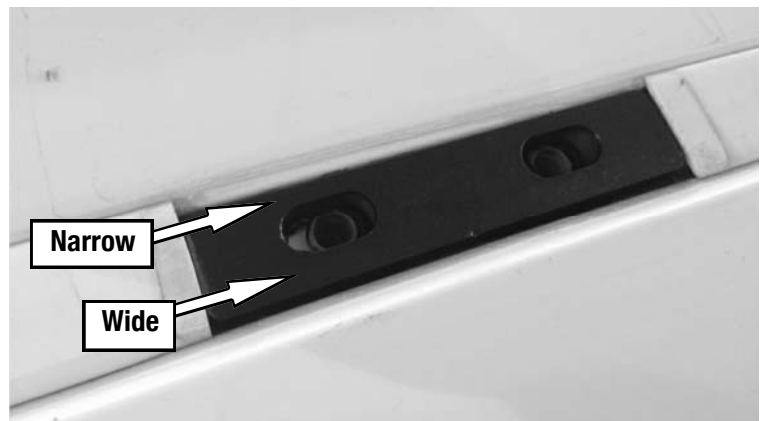
Remove the 8mm Bolts as indicated by the arrows using a 10mm Socket Wrench.



- (B) Clean the area around the bolt holes using a rag and methylated spirits/denatured alcohol. Place some Silicone over each bolt hole.



- (C) Place a Spacer (Items 6) into each of the Mounting Point Recess, lining up the holes in the Spacers with the bolt holes in the roof. Ensure that the wide section of the Spacers (as indicated in the image) go towards the outside of the vehicle.



2 FIT THE FOOT RAILS CONT...

- (D) Place the Rear Foot Rails (Item 2) onto the vehicle lining up the mounting holes in the Foot Rails with the mounting holes in the roof. The product sticker goes to the rear and outside of the vehicle. Starting from the front, loosely fasten the Foot Rails to the vehicle using the M8 x 35 Hex Bolts, M8 Flat Washers and M8 Spring Washers (Items 3, 7, 8) supplied. Tighten all bolts securing the Foot Rails to the vehicle and place a M8 Nut Cap (Item 5) over each Bolt.

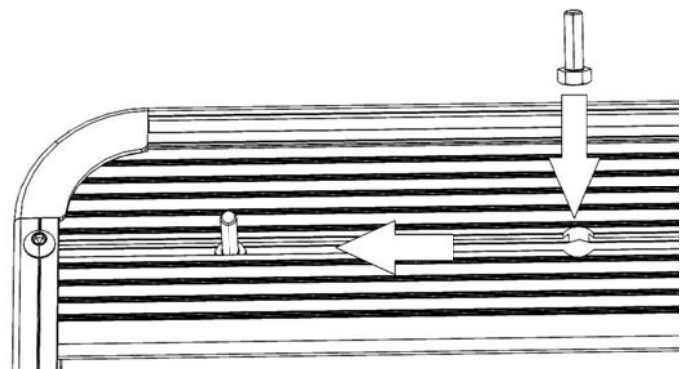


3 FIT THE RACK



Note: If your Slimline II Tray is not already assembled, assemble it as per the Slimline II Tray Universal Assembly Instruction (Document RRSUNI). Read Step 3A before fitting the Wind Deflector

- (A) Before fitting the Wind Deflector, and with the Rack in the upside down position, (Check with product sticker. It should be upside down), slide a M8x20 Hex Bolt into each end of the First Slat using the machined slot as shown.



3 FIT THE RACK CONT...

- (B) With your rack still upside down from Step 3A, slide a M8 x 20 Hex Bolt into each end of Slats 2 & 6 (Slat 1 is the Slat with the Wind Deflector attached to it).

Grab your Friend and with one of you on each side of the Rack, flip the Rack end over end (Prevents the Hex Bolts from falling out the machines slots) so that the M8 x 20 Hex Bolts are facing down. Approach the vehicle from the rear, with the Wind Deflector facing forward. Lift the Rack up and over the Roof positioning it above the Foot Rail. Bring the Rack down slowly, lining up the Bolts in the Rack with the holes in the top of the Foot Rail. Hand tighten the Rack to the Foot Rails using the M8 Washers and M8 Nyloc Nuts (Items 3 & 4) supplied.

Center the rack - left to right (check using a tape measure). Fasten all the Nuts securing the Rack to the Foot Rail. Cover the M8 Nyloc Nuts with the M8 Nut Caps (Item 1) supplied.

Congratulations, you have completed your installation. Take a step back and admire your work. Good Job!



4 TAKE A TRIP

- (A) After your first adventure, check that all nuts, bolts, screws and fittings are tight. Re-tighten where needed. You'll find a small amount of settling has happened.

Go on many more adventures, periodically checking all nuts, bolts, screws and fittings.



Front Runner can not recommend a maximum load carrying capacity. Please refer to your vehicle manufacturer's recommendations.