

REGULAR INSTALLATION

ADDENDUM - SUGGESTED WIRING CONFIGURATION

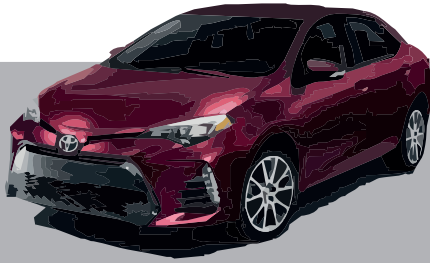

Vehicle functions supported in this diagram (functional if equipped) |

VEHICLE	YEARS	Transponder Bypass	T-Harness available (sold separately)	Lock	Unlock	Arm	Disarm	Parking Lights	Trunk (open)	Tachometer	Autolight Off	Door Status	Trunk Status	Hand-Brake Status	Foot-Brake Status	Hood Status*	R.S. OEM remote Stand Alone compatible	OEM remote Monitoring
<b>TOYOTA</b>																		
Corolla	H-KEY	2017-2019	•	•	•	•	•	•	•	•	•	•	•	•	•	•	•	•

**BYPASS FIRMWARE VERSION**

**79.[48]**

TOYOTA/LEXUS/SUBARU MINIMUM

To add the firmware version and the options, use the **FLASH LINK UPDATER** or **FLASH LINK MOBILE** tool, sold separately.

		UNIT OPTION	DESCRIPTION
	<p><b>Program bypass option:</b></p>	<b>C1</b>	OEM Remote status (Lock/Unlock) monitoring
		<b>D5</b>	Lock after start

	FUNCTION	MODE	DESCRIPTION
	<b>38</b>	<b>2</b>	<p><b>Program remote starter option for R.S. OEM REMOTE STAND ALONE:</b></p> <p>Enable Press 3x Lock to remote start with the OEM remote.</p>

**NOTES**

\*Hood Status functional if equipped with a factory hood switch.

**MANDATORY INSTALL**

\*HOOD PIN **HOOD STATUS:** THE HOOD PIN SWITCH (INCLUDED) MUST BE INSTALLED IF THE VEHICLE CAN BE REMOTE STARTED WITH THE HOOD OPEN.

**SECURITY STICKER**



**Notice:** the installation of safety elements are mandatory. The hood pin and the sticker are essential security elements and must be installed.

THIS MODULE MUST BE INSTALLED BY A QUALIFIED TECHNICIAN. A WRONG CONNECTION CAN CAUSE PERMANENT DAMAGE TO THE VEHICLE.

DESCRIPTION |

⑥ Steering column

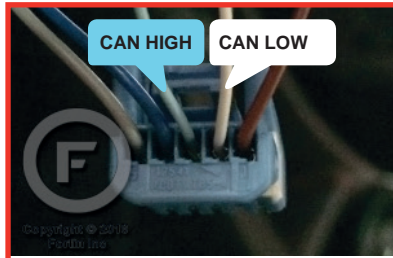

③ Under fuse box

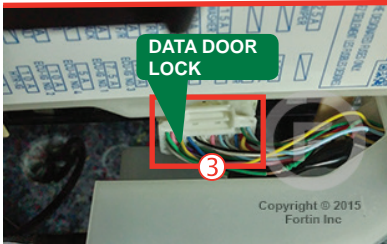

① Ignition switch

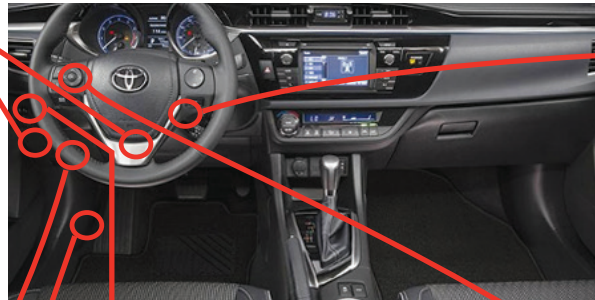
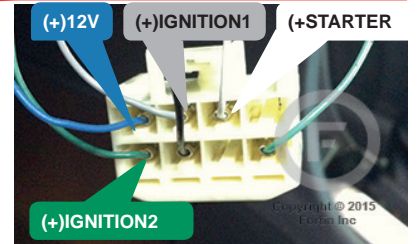

② OBD-II connector

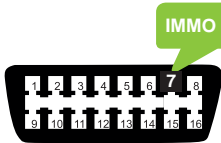

④ ⑤ Fuse box

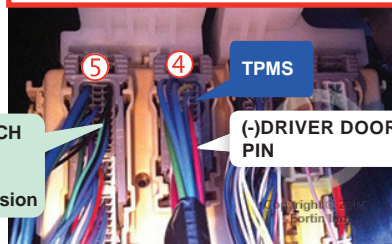

⑦ Parking Light Switch  
Commutateur des feux de stationnement.

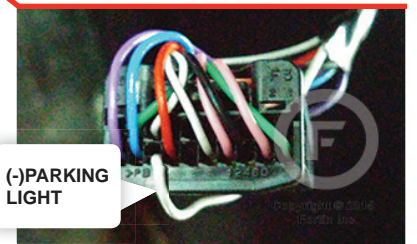

**TPMS**

CONNECTION ONLY REQUIRED IF REMOTE START CONTROL FROM OEM REMOTES IS DESIRED AND VEHICLE IS EQUIPPED WITH TIRE PRESSURE MONITORING SYSTEM (TPMS). CONNEXION

⑧ Driver kick panel

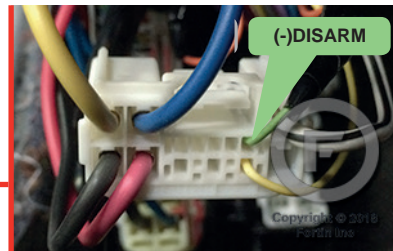
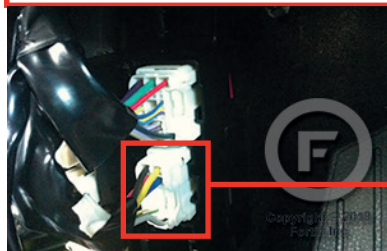

**AUTOMATIC TRANSMISSION WIRING CONNECTION |**

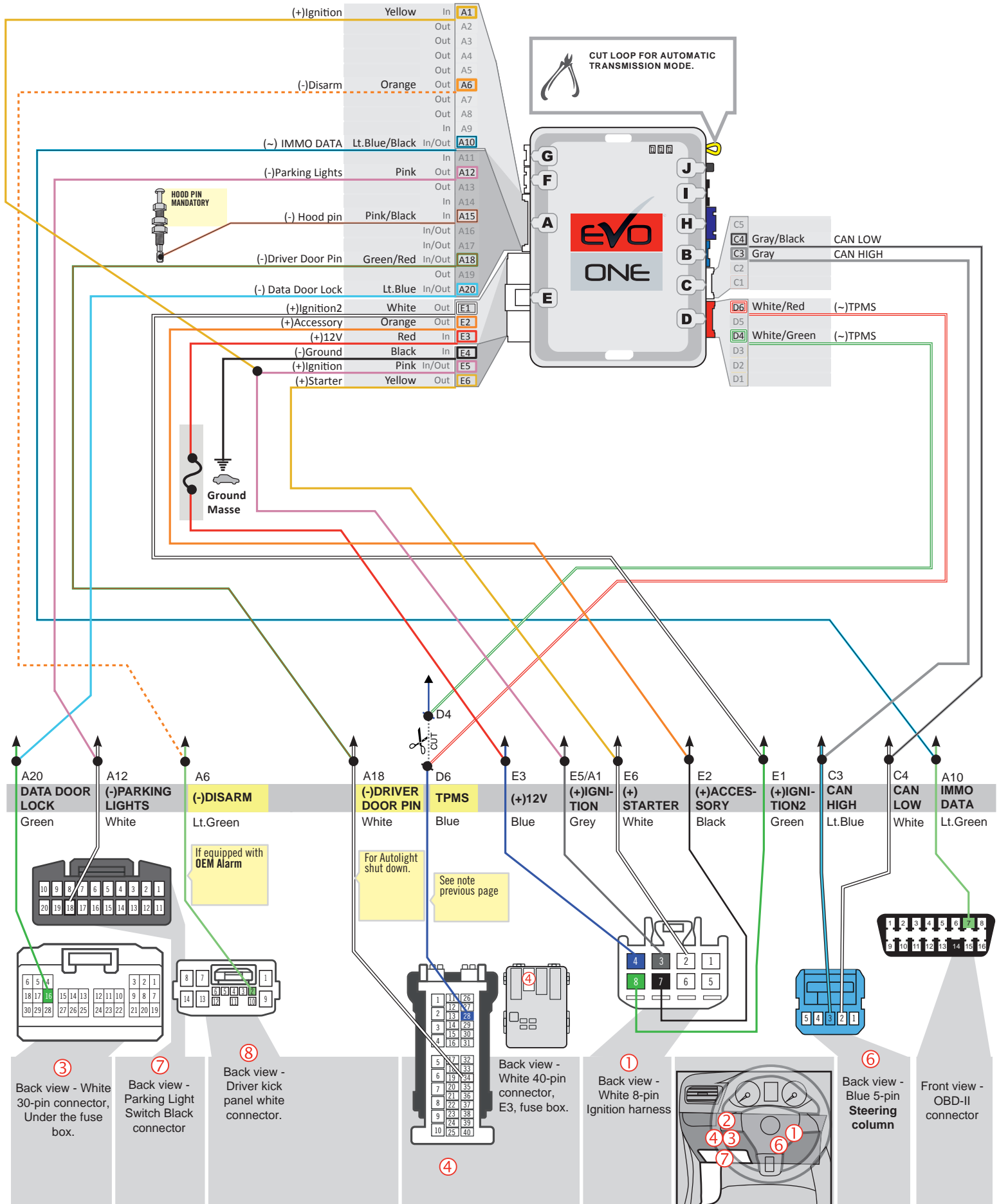

MANUAL TRANSMISSION WIRING CONNECTION |

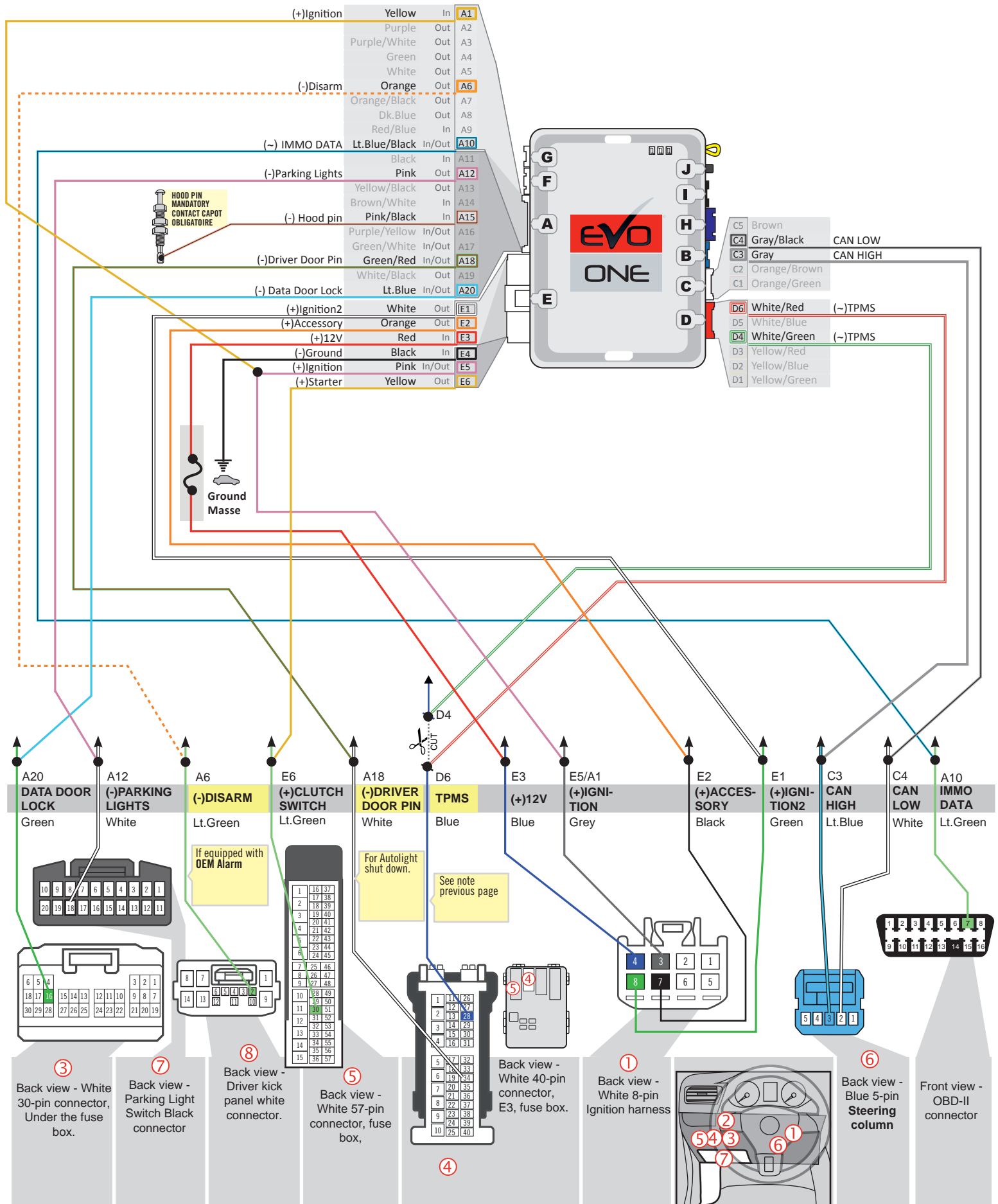

③ Back view - White 30-pin connector, Under the fuse box.

⑦ Back view - Parking Light Switch connector

⑧ Back view - Driver kick panel white connector.

⑤ Back view - White 57-pin connector, fuse box,

④ Back view - White 40-pin connector, E3, fuse box.

① Back view - White 8-pin Ignition harness

⑥ Back view - Blue 5-pin Steering column

Front view - OBD-II connector

**KEY BYPASS PROGRAMMING PROCEDURE |**



Do not use the grey key.



1

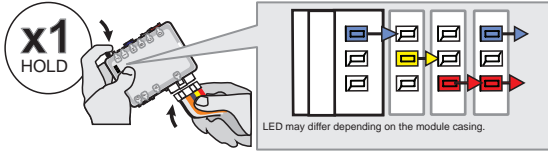

Press and hold the programming button:  
Insert the 6-Pin Main connector.

↳ The LEDs will alternate between BLUE, RED, YELLOW & BLUE/RED flashes.

2



Release the programming button when the LED's are RED and BLUE.

If the LED's are not solid BLUE and RED **disconnect** the 6-Pin connector (Main-Harness) and go back to step 1.

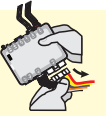

3

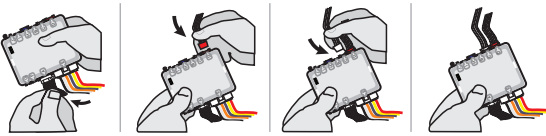

Insert the required remaining connectors.

4

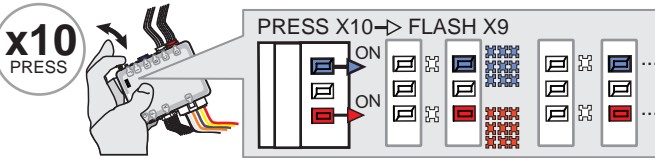

Press and release the programming button ten (10x) times.

↳ The RED and BLUE LED's will alternate between 9 flashes and a pause.

5

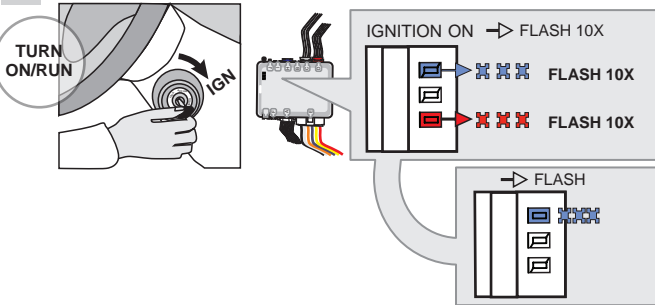

Turn the Ignition to the ON/RUN position.

↳ The RED and BLUE LED's will flash rapidly 10x times.  
Key bypass programmed.

↳ The BLUE LED will flash rapidly.  
CAN-Bus programmed.

6

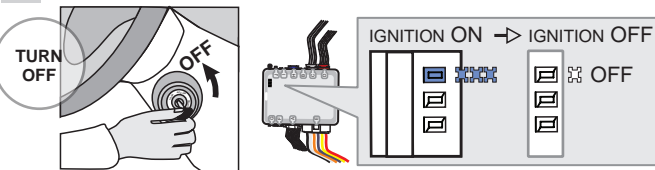

Turn the Ignition to the OFF position.

↳ The BLUE LED will turn off.



**The module is now programmed.**

Use the remote of the remote starter or security system to test all of the supported features to ensure proper programming.

REMOTE STARTER PROGRAMMING PROCEDURE |



REFER TO THE **QUICK INSTALL GUIDE** INCLUDED WITH THE MODULE FOR THE REMOTE STARTER PROGRAMMING.

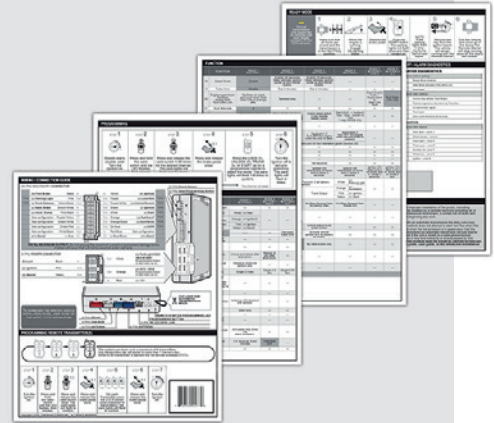

**THAR-ONE-TOY3 THARNES INSTALLATION**

## ADDENDUM - SUGGESTED WIRING CONFIGURATION

VEHICLE VEHICULES	YEARS	Vehicle functions supported in this diagram (functional if equipped)															
		Transponder Bypass	Lock	Unlock	Arm	Disarm	Parking Lights	Trunk (open)	Tachometer	Autolight Off	Door Status	Trunk Status	Hand-Brake Status	Hood Status*	Foot-Brake Status	OEM remote Monitoring	R.S. OEM remote Stand Alone compatible
<b>TOYOTA</b>																	
Corolla	H-KEY	2014-2016	•	•	•	•	•	•	•	•	•	•	•	•	•	•	•

**BYPASS FIRMWARE VERSION**

# 79.[41]

TOYOTA/LEXUS/SUBARU MINIMUM

**Program bypass option:**
**UNIT OPTION  
OPTION UNITE**
**DESCRIPTION**
**C1**

OEM Remote status (Lock/Unlock) monitoring

**D5**

Lock after start

**Program remote starter option for R.S. OEM REMOTE STAND ALONE:**
**FUNCTION**
**MODE**
**DESCRIPTION**
**38**
**2**

 Enable  
Press 3x Lock to remote start with the OEM remote.

**NOTES**

\*Hood Status functional if equipped with a factory hood switch.



DESCRIPTION

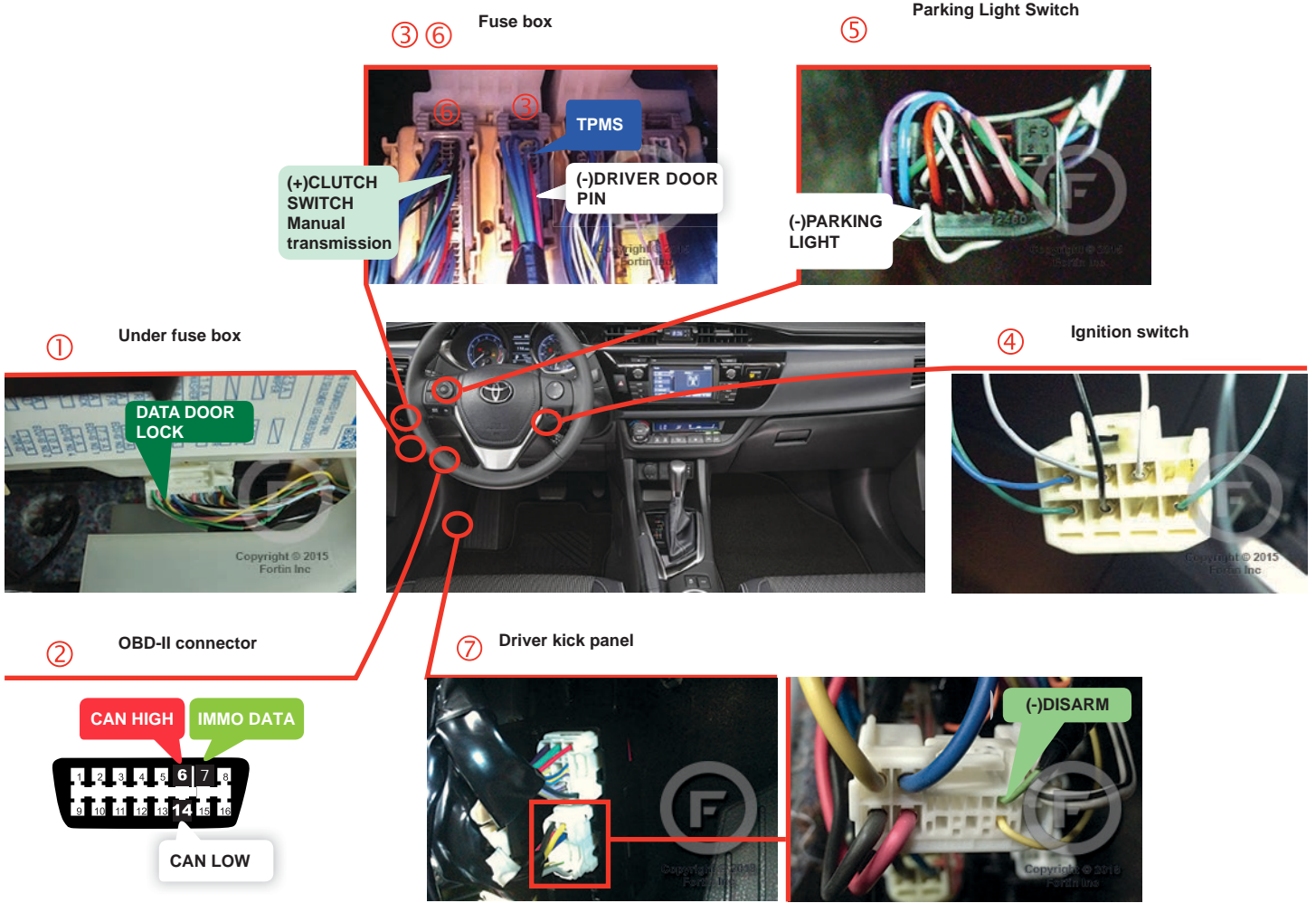



**AUTOMATIC TRANSMISSION WIRING CONNECTION**

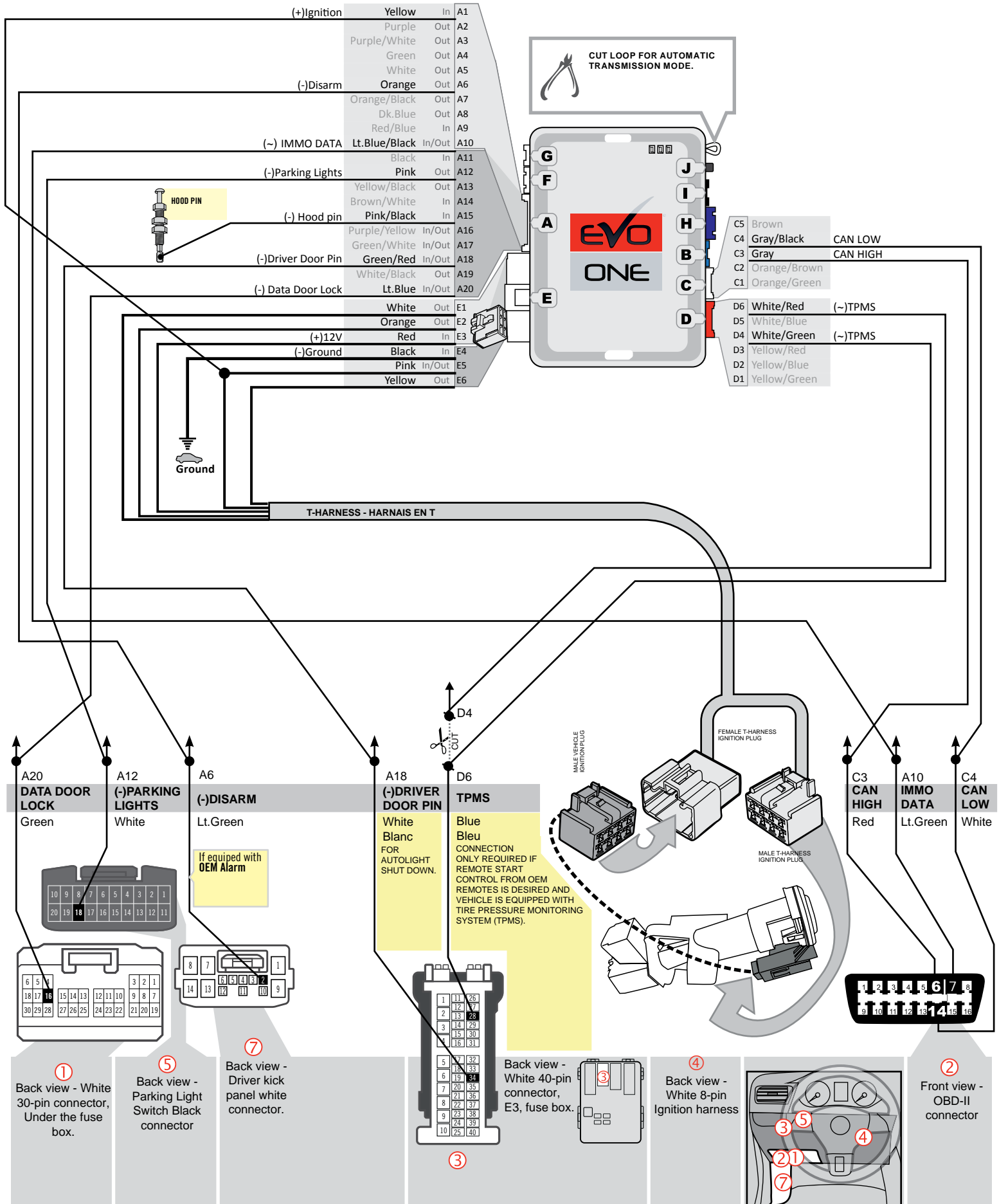

**MANUAL TRANSMISSION WIRING CONNECTION**

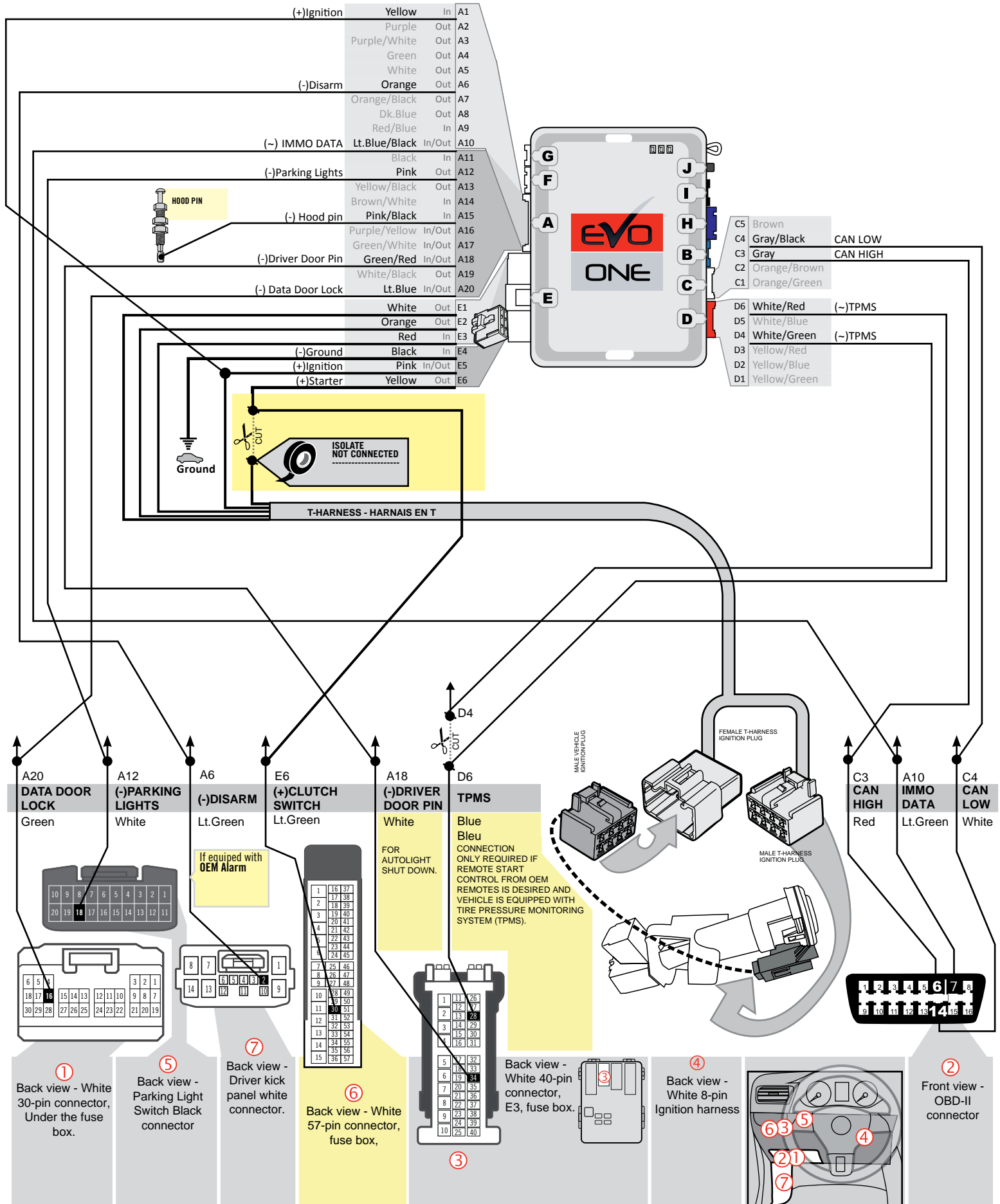

**KEY BYPASS PROGRAMMING PROCEDURE**



Do not use the grey key.



1

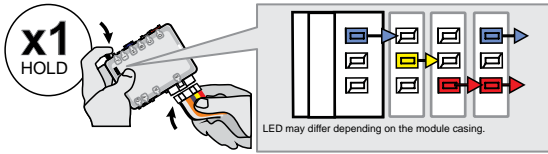

**Press and hold** the programming button:  
**Insert** the 6-Pin Main connector.

↳ *The LEDs will alternate between BLUE, RED, YELLOW & BLUE/RED flashes.*

2

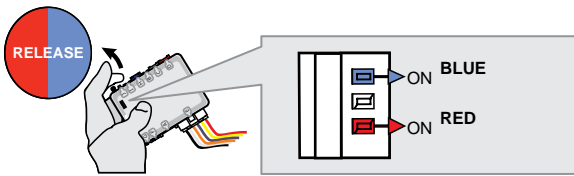

**Release** the programming button when the LED's are RED and BLUE.

*If the LED's are not solid BLUE and RED disconnect the 6-Pin connector (Main-Harness) and go back to step 1.*



3

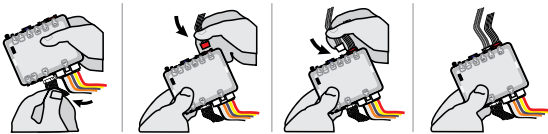

**Insert** the required remaining connectors.

4

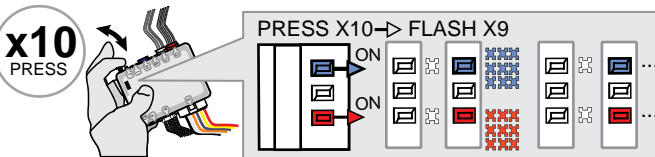

**Press and release** the programming button ten (10x) times.

↳ *The RED and BLUE LED's will alternate between 9 flashes and a pause.*

5

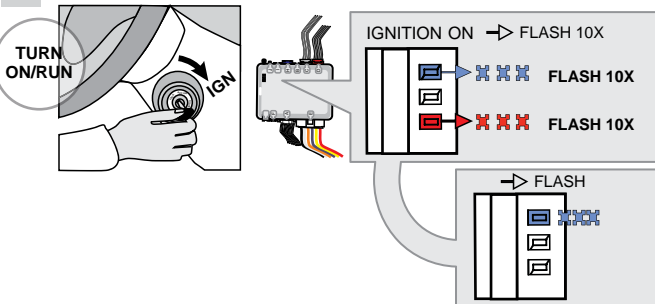

**Turn** the Ignition to the ON/RUN position.

↳ *The RED and BLUE LED's will flash rapidly 10x times. Key bypass programmed.*

↳ *The BLUE LED will flash rapidly. CAN-Bus programmed.*

6

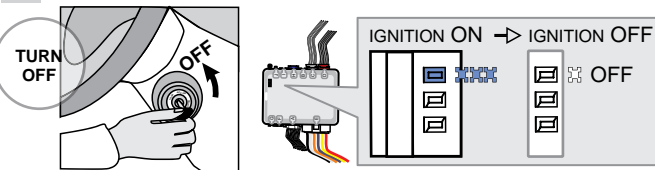

**Turn** the Ignition to the OFF position.

↳ *The BLUE LED will turn off.*



**The module is now programmed.**

Use the remote of the remote starter or security system to test all of the supported features to ensure proper programming.

REMOTE STARTER PROGRAMMING PROCEDURE



REFER TO THE **QUICK INSTALL GUIDE** INCLUDED WITH THE MODULE FOR THE REMOTE STARTER PROGRAMMING.

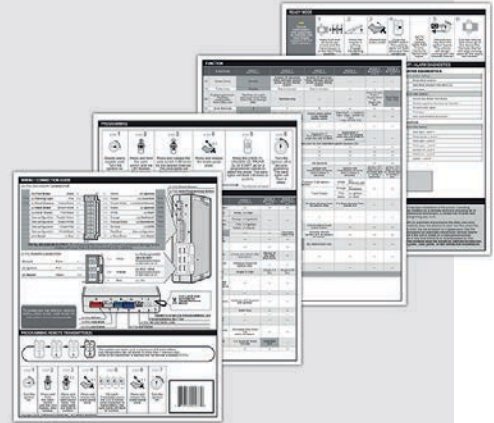

# THAR-ONE-TOY3 THARNSS INSTALLATION

## ADDENDUM - SUGGESTED WIRING CONFIGURATION

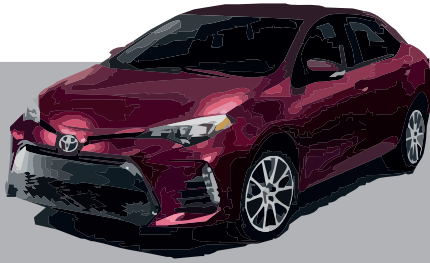

Vehicle functions supported in this diagram (functional if equipped)

VEHICLE	YEARS	Transponder Bypass	T-Harness	Lock	Unlock	Arm	Disarm	Parking Lights	Trunk (open)	Tachometer	Autolight Off	Door Status	Trunk Status	Hand-Brake Status	Foot-Brake Status	Hood Status*	R.S. OEM remote Stand Alone compatible	OEM remote Monitoring
<b>TOYOTA</b>																		
Corolla	H-KEY 2017-2019	•	•	•	•	•	•	•	•	•	•	•	•	•	•	•	•	•



**BYPASS FIRMWARE VERSION**

**79.[48]**

TOYOTA/LEXUS/SUBARU MINIMUM

To add the firmware version and the options, use the **FLASH LINK UPDATER** or **FLASH LINK MOBILE** tool, sold separately.



**Program bypass option:**

**UNIT OPTION**

**DESCRIPTION**

**C1**

OEM Remote status (Lock/Unlock) monitoring

**D5**

Lock after start



**Program remote starter option for R.S. OEM REMOTE STAND ALONE:**

**FUNCTION**

**MODE**

**DESCRIPTION**

**38**

**2**

Enable  
Press 3x Lock to remote start with the OEM remote.

**NOTES**

**\*Hood Status**

functional if equipped with a factory hood switch.

fonctionnel si équipé d'un commutateur de capot d'origine.

**MANDATORY INSTALL**

**\*HOOD PIN**



**HOOD STATUS:** THE HOOD PIN SWITCH (INCLUDED) MUST BE INSTALLED IF THE VEHICLE CAN BE REMOTE STARTED WITH THE HOOD OPEN.

**SECURITY STICKER**



Included

**Notice:** the installation of safety elements are mandatory. The hood pin and the sticker are essential security elements and must be installed.

THIS MODULE MUST BE INSTALLED BY A QUALIFIED TECHNICIAN. A WRONG CONNECTION CAN CAUSE PERMANENT DAMAGE TO THE VEHICLE.

DESCRIPTION

⑥ Steering column

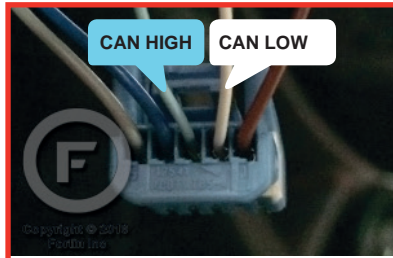

③ Under fuse box

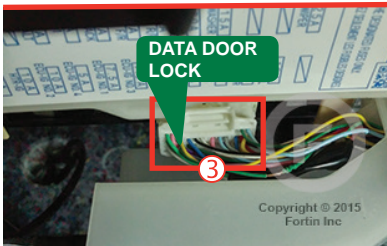

① Ignition switch

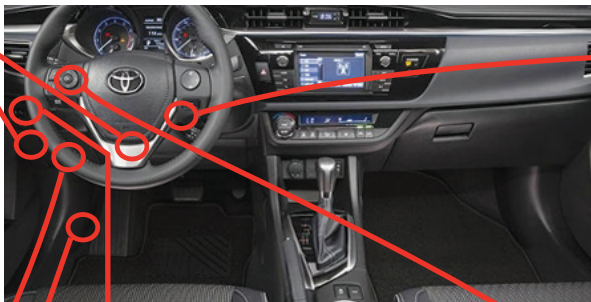
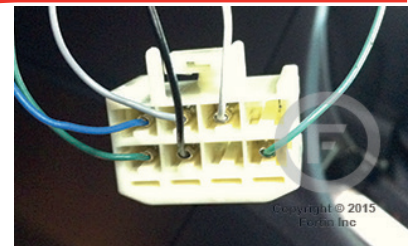

② OBD-II connector

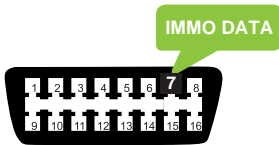

④ ⑤ Fuse box

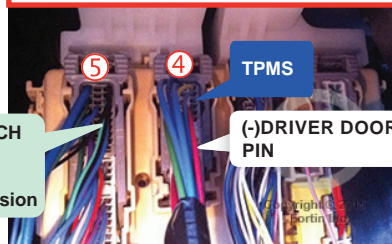

⑦ Parking Light Switch

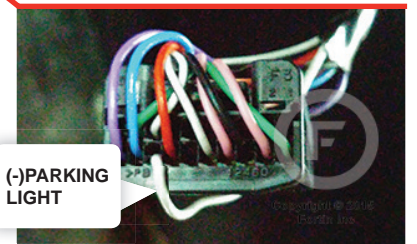

TPMS  
CONNECTION ONLY REQUIRED IF REMOTE START CONTROL FROM OEM REMOTES IS DESIRED AND VEHICLE IS EQUIPPED WITH TIRE PRESSURE MONITORING SYSTEM (TPMS).

⑧ Driver kick panel

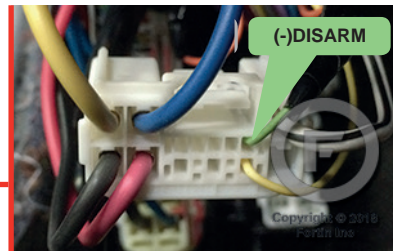
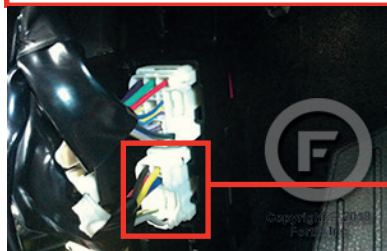



**AUTOMATIC TRANSMISSION WIRING CONNECTION**

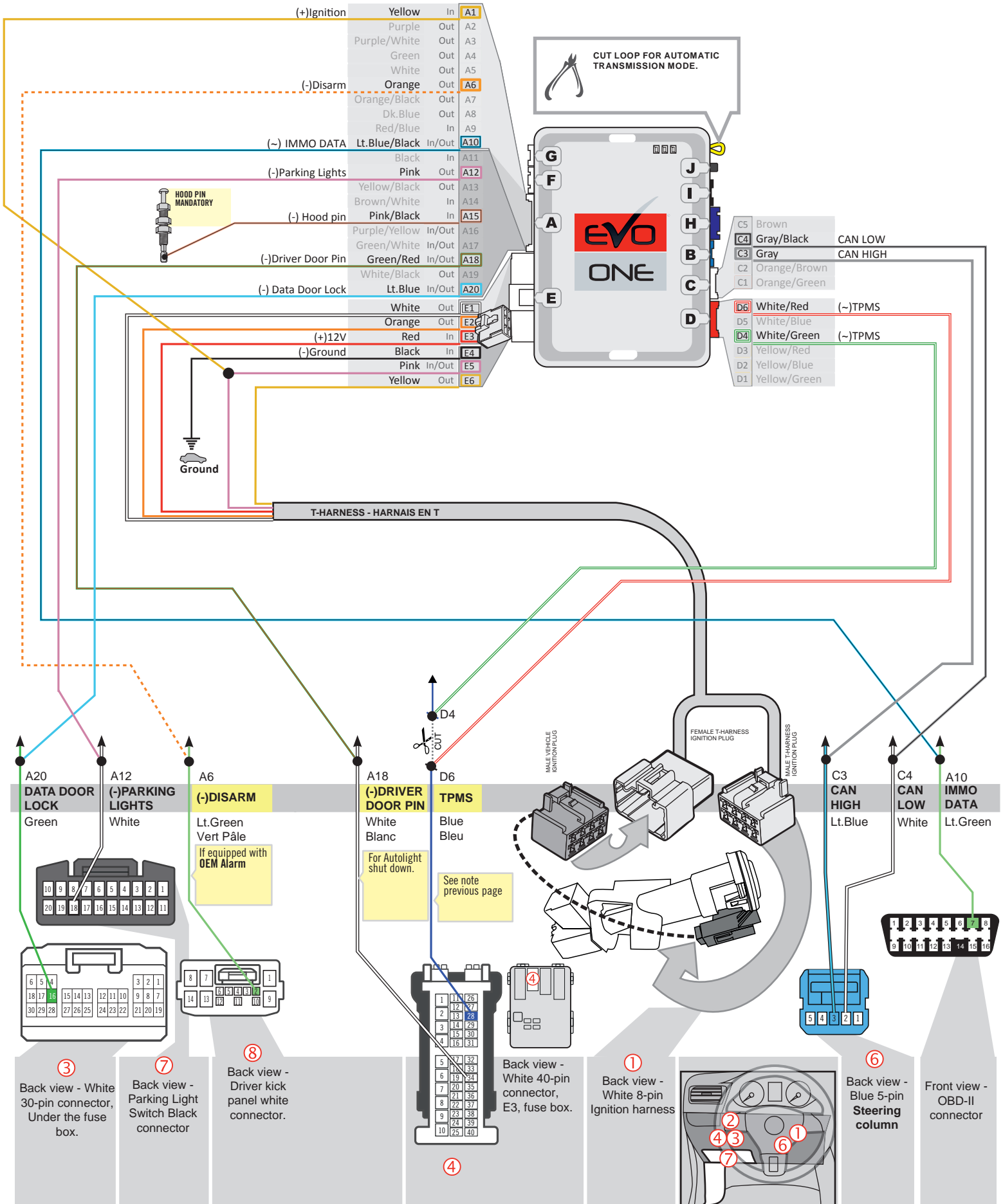

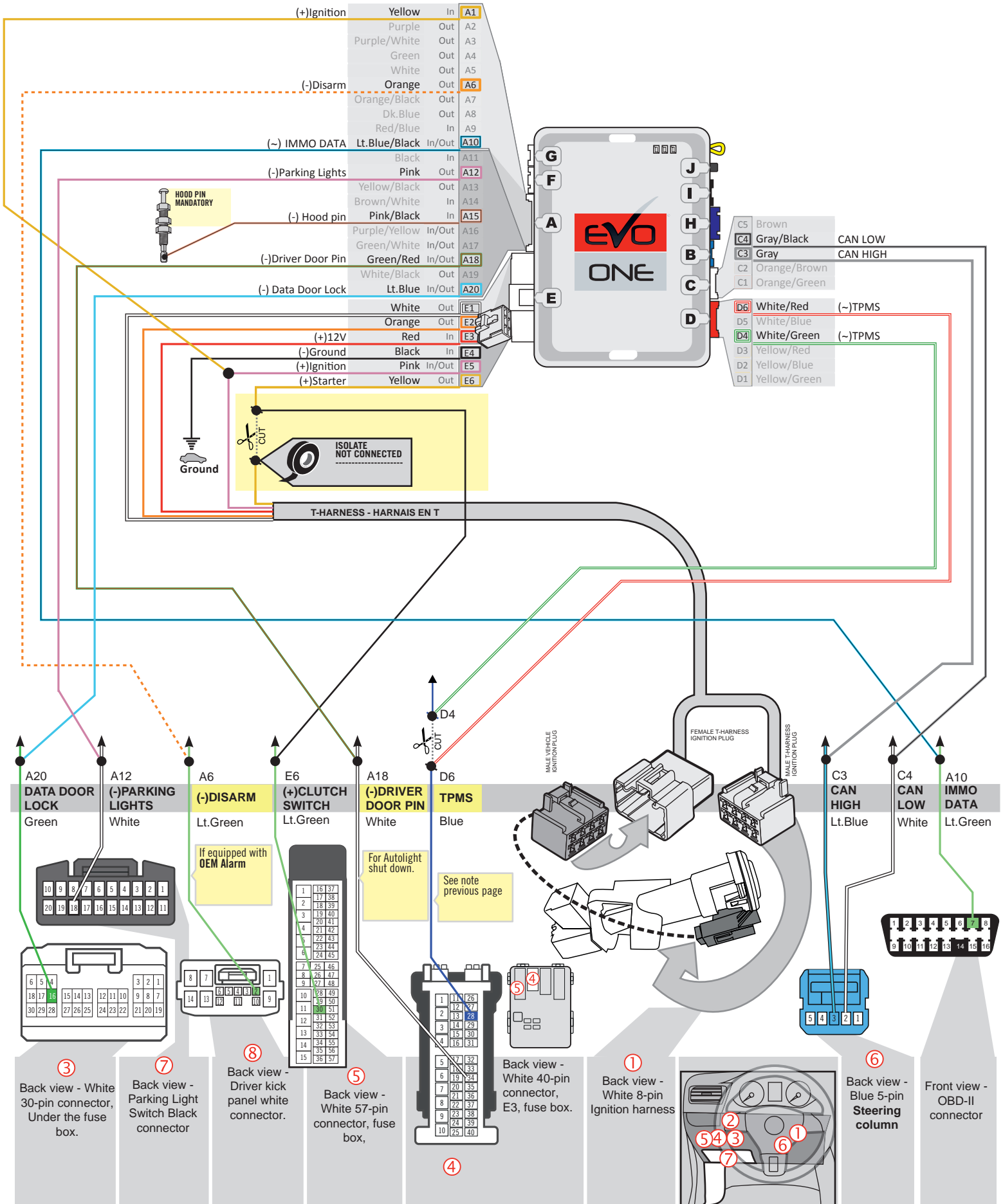

**KEY BYPASS PROGRAMMING PROCEDURE**



Do not use the grey key.



1

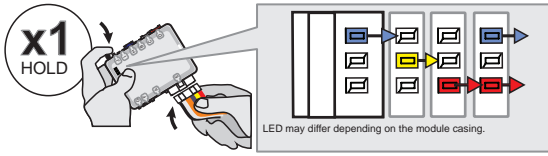

Press and hold the programming button:  
Insert the 6-Pin Main connector.

↳ The LEDs will alternate between BLUE, RED, YELLOW & BLUE/RED flashes.

2



Release the programming button when the LED's are RED and BLUE.

If the LED's are not solid BLUE and RED disconnect the 6-Pin connector (Main-Harness) and go back to step 1.

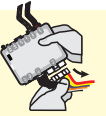

3

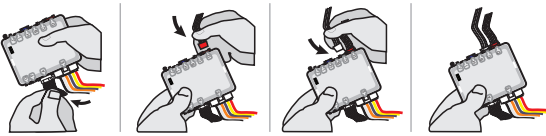

Insert the required remaining connectors.

4

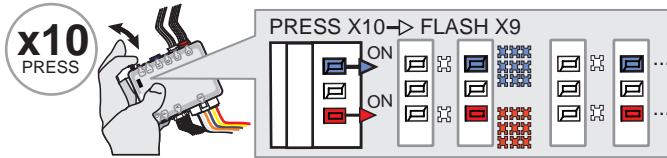

Press and release the programming button ten (10x) times.

↳ The RED and BLUE LED's will alternate between 9 flashes and a pause.

5

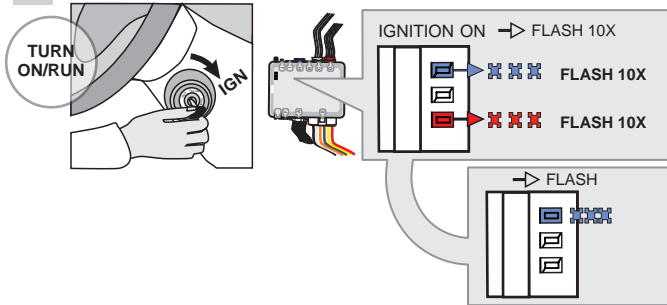

Turn the Ignition to the ON/RUN position.

↳ The RED and BLUE LED's will flash rapidly 10x times. Key bypass programmed.

↳ The BLUE LED will flash rapidly. CAN-Bus programmed.

6

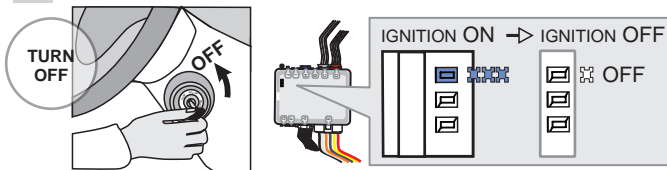

Turn the Ignition to the OFF position.

↳ The BLUE LED will turn off.



The module is now programmed.

Use the remote of the remote starter or security system to test all of the supported features to ensure proper programming.

REMOTE STARTER PROGRAMMING PROCEDURE



REFER TO THE **QUICK INSTALL GUIDE** INCLUDED WITH THE MODULE FOR THE REMOTE STARTER PROGRAMMING.

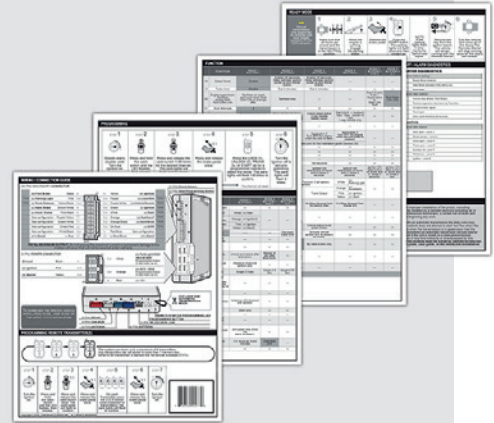

**THAR-ONE-TOY3 THARNES INSTALLATION**
**ADDENDUM - SUGGESTED WIRING CONFIGURATION**

Vehicle functions supported in this diagram (functional if equipped)



Vehicle                      Modele                      Years

Vehicle	Modele	Years	Transponder Bypass	T-Harness	Lock	Unlock	Arm	Disarm	Parking lights	Tachometer	Autolight Off	Door Status	Trunk Status	Hand-Brake Status	Foot-Brake Status	OEM Remote Monitoring	R.S. OEM remote Stand Alone compatible
Toyota																	
Corolla IM	Key	2017-2018	•	•	•	•	•	•	•	•	•	•	•	•	•	•	•

	<b>HARDWARE VERSION</b>	<b>REMOTE STARTER FIRMWARE VERSION</b>	<b>BYPASS FIRMWARE VERSION</b>	To add the firmware version and the options, use the <b>FLASH LINK UPDATER</b> or <b>FLASH LINK MOBILE</b> tool, sold separately.
	<b>7</b> MINIMUM	<b>1.[20]</b> MINIMUM	<b>79.[65]</b> TOYOTA/LEXUS/ SUBARU MINIMUM	

	<b>Program bypass option:</b>	<b>UNIT OPTION</b>	<b>DESCRIPTION</b>
		<b>C1</b>	OEM Remote status (Lock/Unlock) monitoring
		<b>D5</b>	Lock after start

	<b>Program remote starter option for R.S. OEM REMOTE STAND ALONE:</b>	<b>FUNCTION</b>	<b>MODE</b>	<b>DESCRIPTION</b>
		<b>38</b>	<b>2</b>	Enable Press 3x Lock to remote start with the OEM remote.

**MANDATORY INSTALL**
**\* HOOD PIN**

**HOOD STATUS:** THE HOOD PIN SWITCH (INCLUDED) MUST BE INSTALLED IF THE VEHICLE CAN BE REMOTE STARTED WITH THE HOOD OPEN, SET FUNCTION **A11** TO OFF.

**A11**
**OFF**
**SECURITY STICKER**



Included

**Notice:** the installation of safety elements are mandatory. The hood pin and the sticker are essential security elements and must be installed.

**THIS MODULE MUST BE INSTALLED BY A QUALIFIED TECHNICIAN. A WRONG CONNECTION CAN CAUSE PERMANENT DAMAGE TO THE VEHICLE.**

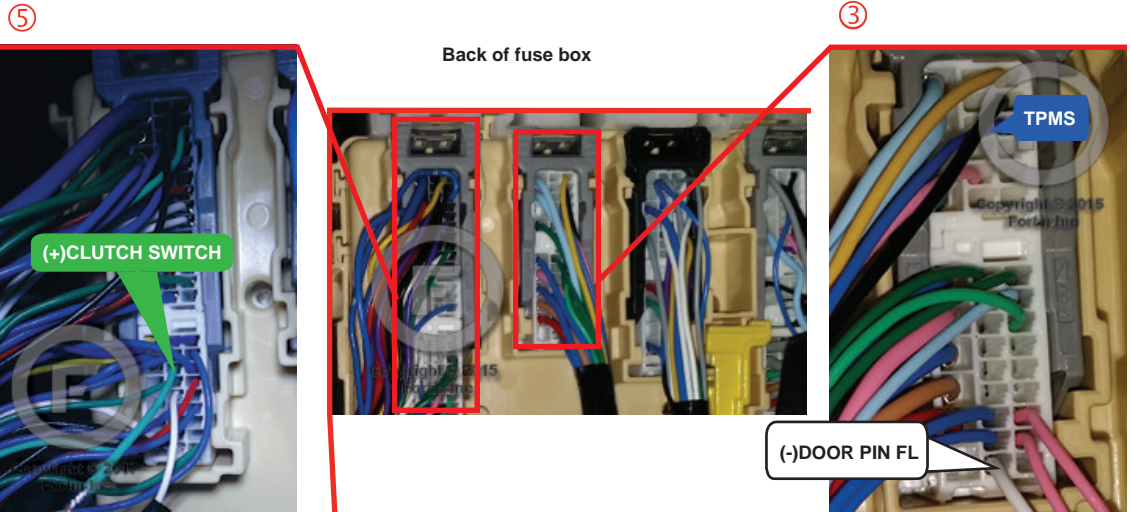

DESCRIPTION



② Fuse Box

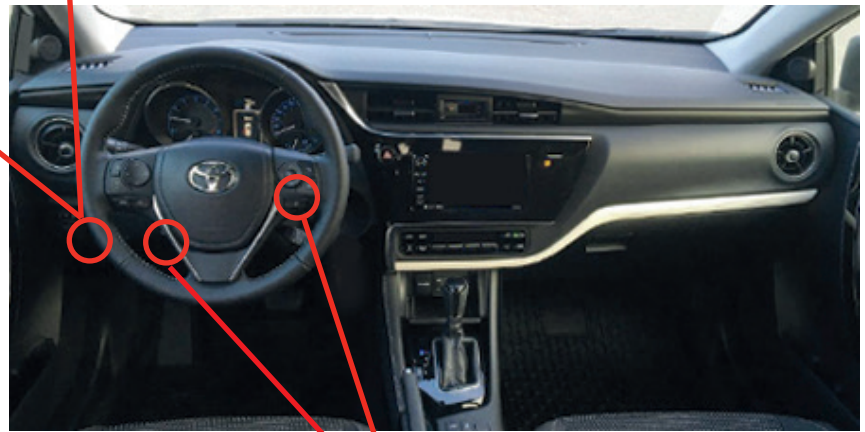
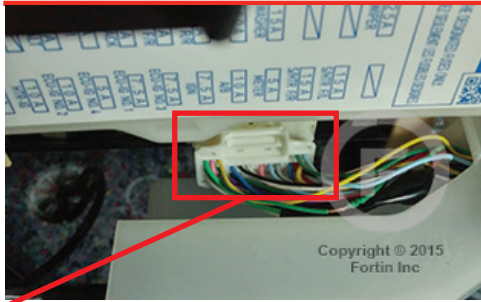

③ OBDII connector

① Ignition harness

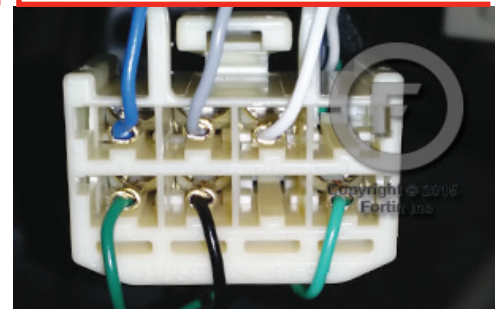
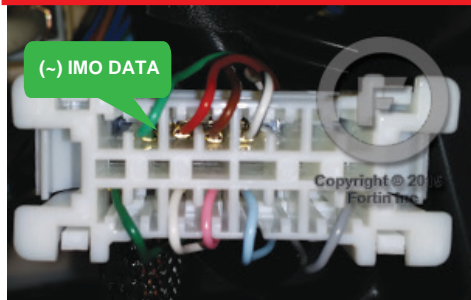
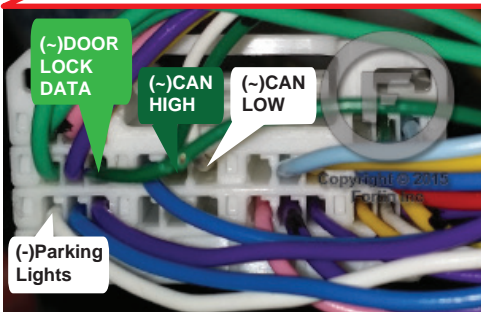



**AUTOMATIC TRANSMISSION WIRING CONNECTION**

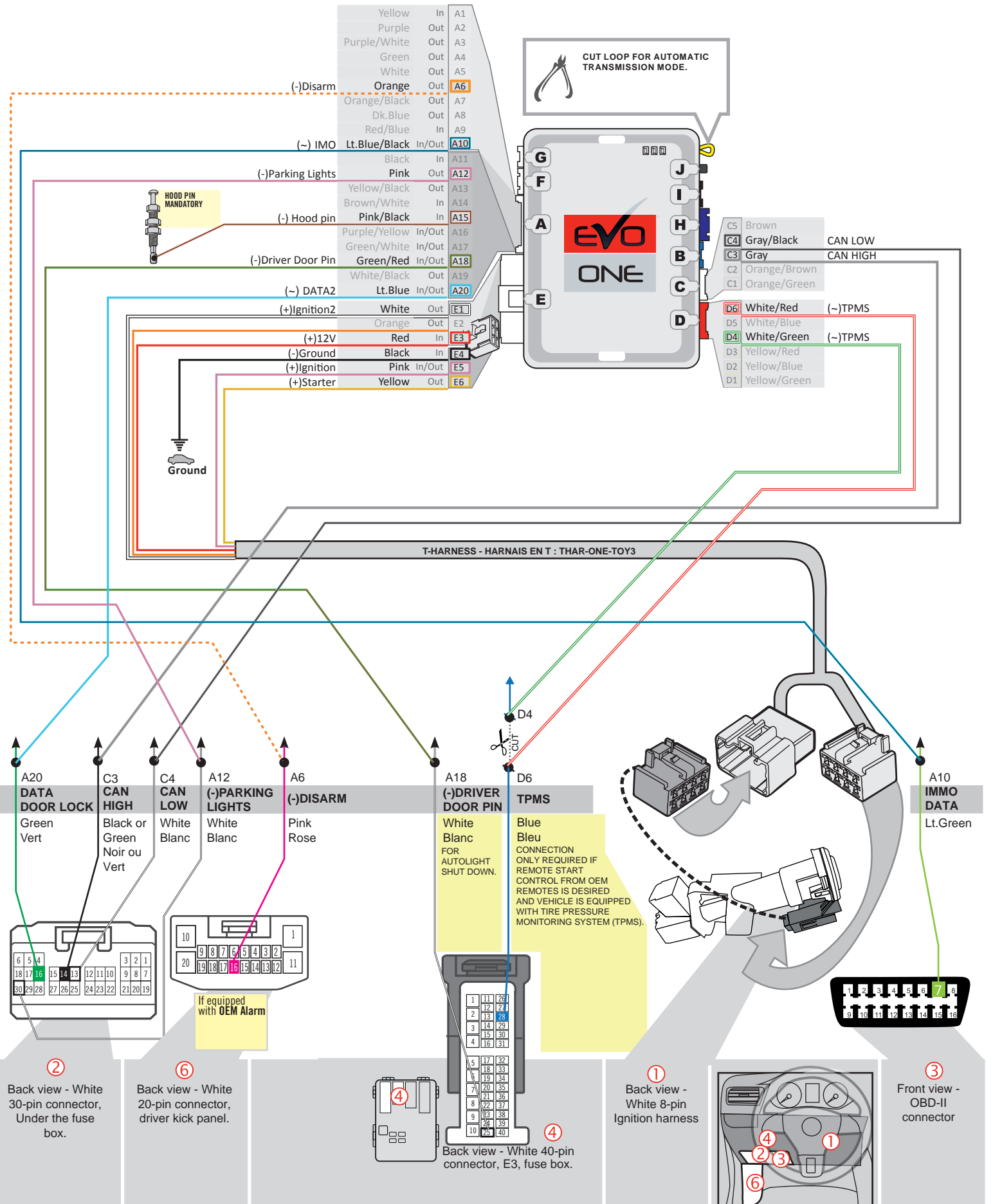

MANUAL TRANSMISSION WIRING CONNECTION

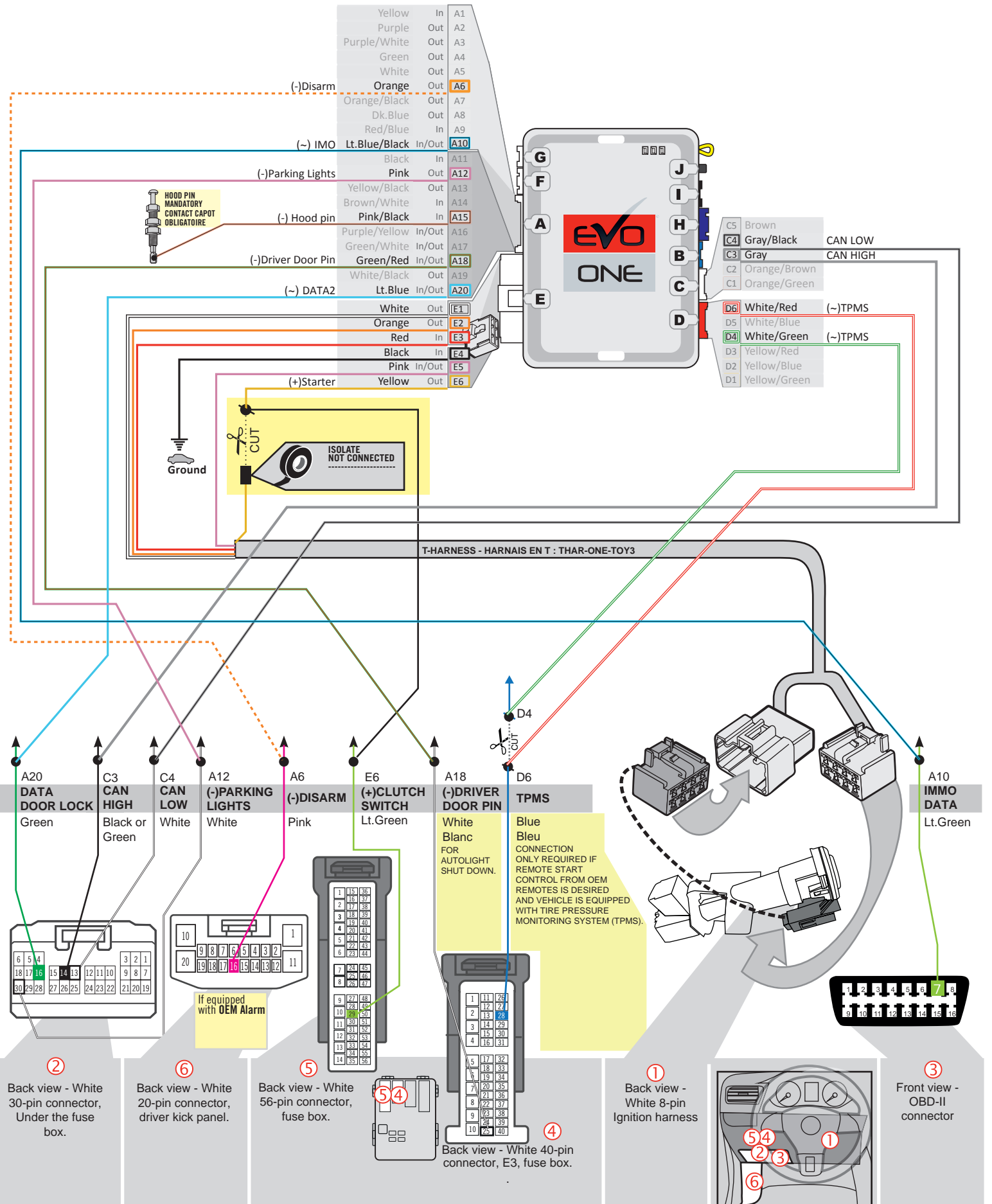

**KEY BYPASS PROGRAMMING PROCEDURE**



Do not use the grey key.



1

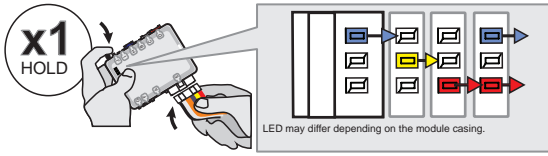

Press and hold the programming button:  
Insert the 6-Pin Main connector.

↳ The LEDs will alternate between BLUE, RED, YELLOW & BLUE/RED flashes.

2



Release the programming button when the LED's are RED and BLUE.

If the LED's are not solid BLUE and RED disconnect the 6-Pin connector (Main-Harness) and go back to step 1.



3

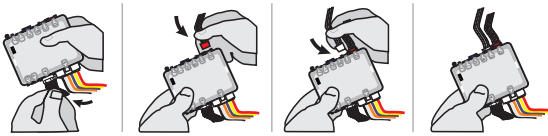

Insert the required remaining connectors.

4

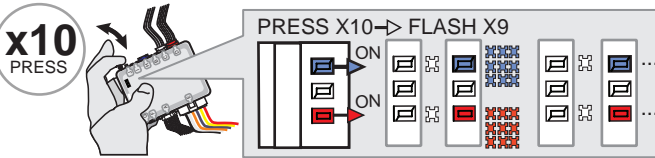

Press and release the programming button ten (10x) times.

↳ The RED and BLUE LED's will alternate between 9 flashes and a pause.

5

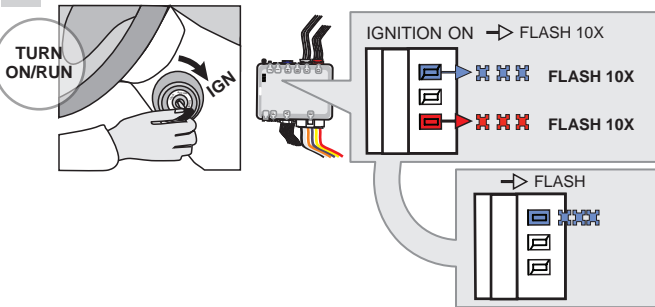

Turn the Ignition to the ON/RUN position.

↳ The RED and BLUE LED's will flash rapidly 10x times. Key bypass programmed.

↳ The BLUE LED will flash rapidly. CAN-Bus programmed.

6

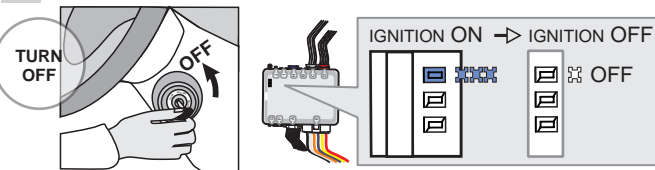

Turn the Ignition to the OFF position.

↳ The BLUE LED will turn off.



The module is now programmed.

Use the remote of the remote starter or security system to test all of the supported features to ensure proper programming.

REMOTE STARTER PROGRAMMING PROCEDURE



REFER TO THE **QUICK INSTALL GUIDE** INCLUDED WITH THE MODULE FOR THE REMOTE STARTER PROGRAMMING.

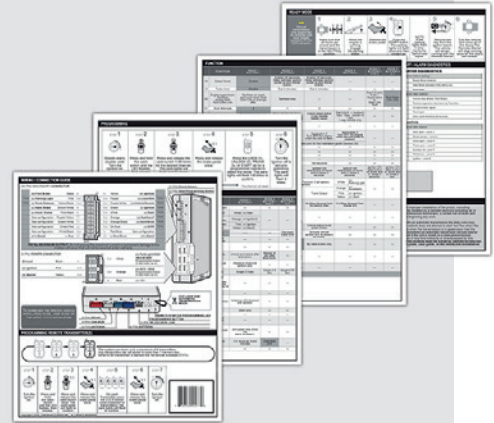

THAR-ONE-TOY3 THARNSS INSTALLATION

ADDENDUM - SUGGESTED WIRING CONFIGURATION

VEHICLE	YEARS	Vehicle functions supported in this diagram (functional if equipped)													
		Transponder Bypass	Lock	Unlock	Arm	Disarm	Tachometer	Parking Lights	Autolight Off	Door Status	Trunk Status	Hand-Brake Status	Foot-Brake Status	OEM remote Monitoring	R.S. OEM remote Stand-Alone compatible
TOYOTA															
Rav4	H-KEY 2013-2015	•	•	•	•	•	•	•	•	•	•	•	•	•	•

**BYPASS FIRMWARE VERSION**

**79.[65]**

TOYOTA/LEXUS/SUBARU MINIMUM

To add the firmware version and the options, use the **FLASH LINK UPDATER** or **FLASH LINK MOBILE** tool, sold separately.

	Program bypass option:	UNIT OPTION	DESCRIPTION
		<b>C1</b>	OEM Remote status (Lock/Unlock) monitoring
		<b>D5</b>	Lock after start

	IF THE VEHICLE IS NOT EQUIPPED WITH FUNCTIONAL HOOD PIN:	<b>A11</b>	OFF	Hood trigger (Output Status).
--	--	------------	-----	-------------------------------

	Program remote starter option for R.S. OEM REMOTE STAND ALONE:	FUNCTION	MODE	DESCRIPTION
		<b>38</b>	<b>2</b>	Enable Press 3x Lock to remote start with the OEM remote.

**MANDATORY INSTALL**

**\* HOOD PIN**

**HOOD STATUS:** THE HOOD PIN SWITCH (INCLUDED) MUST BE INSTALLED IF THE VEHICLE CAN BE REMOTE STARTED WITH THE HOOD OPEN, SET FUNCTION **A11** TO OFF.

**A11**

OFF

**SECURITY STICKER**

Included

**Notice:** the installation of safety elements are mandatory. The hood pin and the sticker are essential security elements and must be installed.

THIS MODULE MUST BE INSTALLED BY A QUALIFIED TECHNICIAN. A WRONG CONNECTION CAN CAUSE PERMANENT DAMAGE TO THE VEHICLE.



NOTES

⑤ Parking Light Switch



① Ignition switch

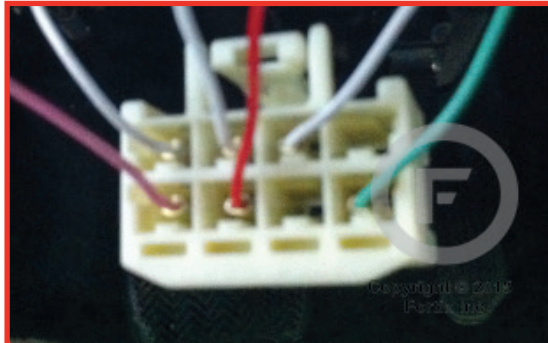

③ Under fuse box

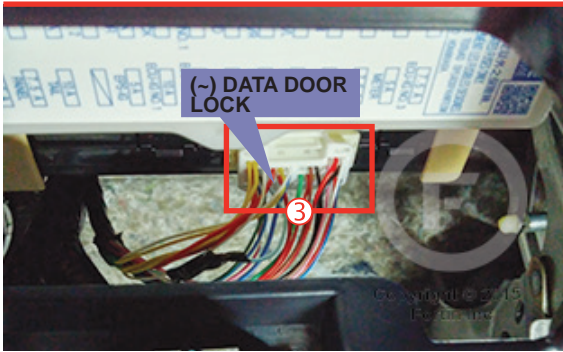

② OBD-II connector

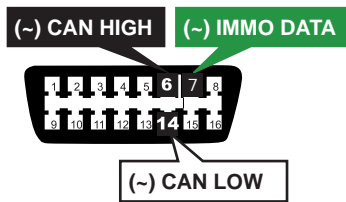

⑥ Fuse box

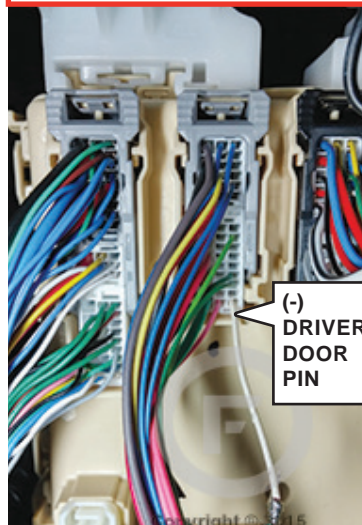

⑦ Driver kick panel

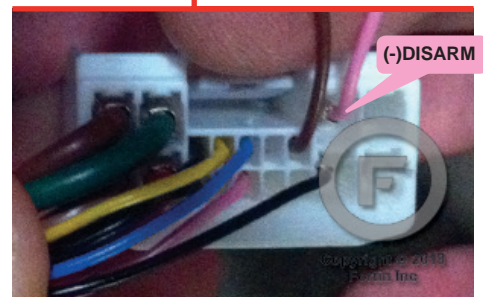
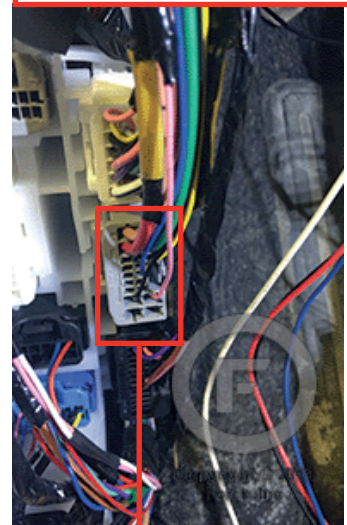



WIRING CONNECTION

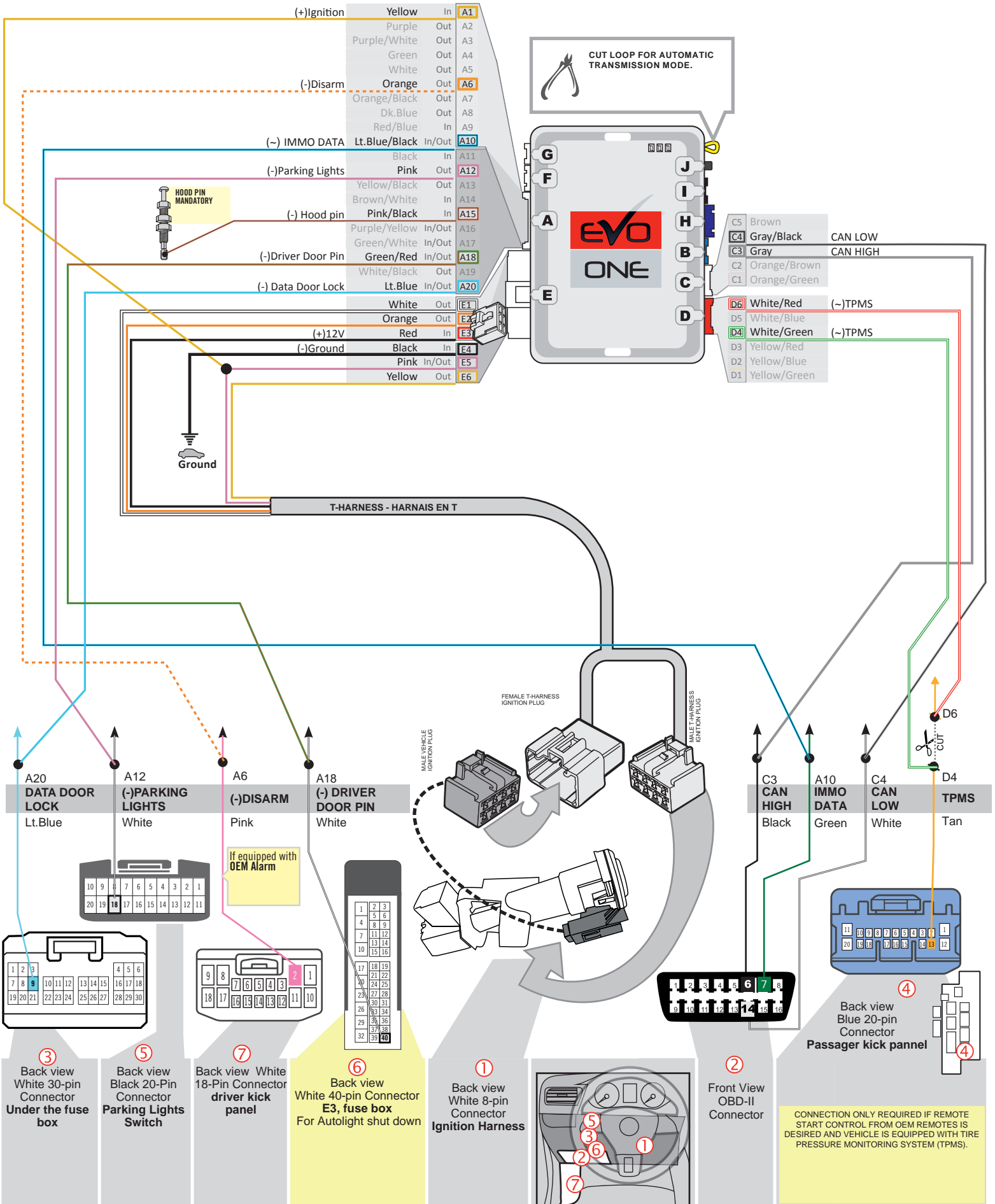

CONNECTION ONLY REQUIRED IF REMOTE START CONTROL FROM OEM REMOTES IS DESIRED AND VEHICLE IS EQUIPPED WITH TIRE PRESSURE MONITORING SYSTEM (TPMS).

**KEY BYPASS PROGRAMMING PROCEDURE**



Do not use the grey key.



1

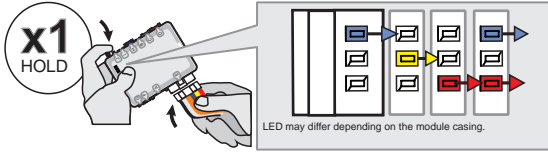

Press and hold the programming button:  
Insert the 6-Pin Main connector.

↳ The LEDs will alternate between BLUE, RED, YELLOW & BLUE/RED flashes.

2



Release the programming button when the LED's are RED and BLUE.

If the LED's are not solid BLUE and RED disconnect the 6-Pin connector (Main-Harness) and go back to step 1.

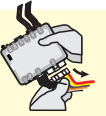

3

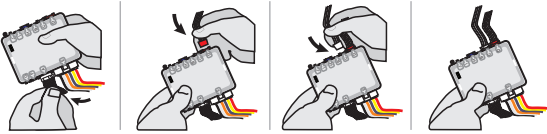

Insert the required remaining connectors.

4

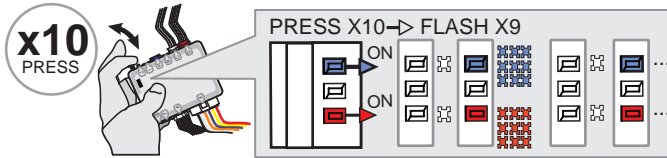

Press and release the programming button ten (10x) times.

↳ The RED and BLUE LED's will alternate between 9 flashes and a pause.

5

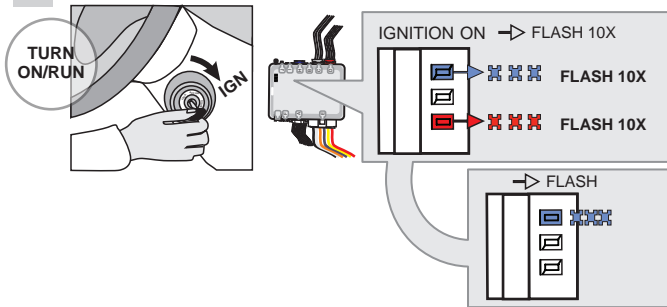

Turn the Ignition to the ON/RUN position.

↳ The RED and BLUE LED's will flash rapidly 10x times.  
Key bypass programmed.

↳ The BLUE LED will flash rapidly.  
CAN-Bus programmed.

6

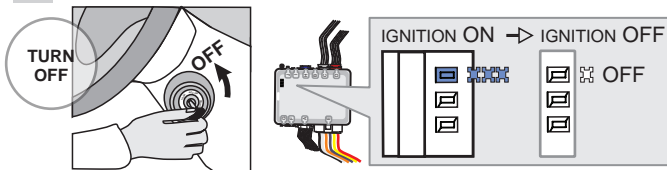

Turn the Ignition to the OFF position.

↳ The BLUE LED will turn off.



The module is now programmed.

Use the remote of the remote starter or security system to test all of the supported features to ensure proper programming.

REMOTE STARTER PROGRAMMING PROCEDURE



REFER TO THE **QUICK INSTALL GUIDE** INCLUDED WITH THE MODULE FOR THE REMOTE STARTER PROGRAMMING.

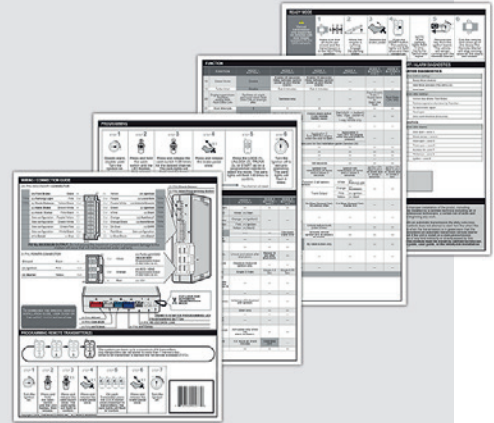

# THAR-ONE-TOY3 THARNESSE INSTALLATION INSTALLATION HARNAIS THAR-ONE-TOY3

## ADDENDUM - SUGGESTED WIRING CONFIGURATION

Vehicle functions supported in this diagram (functional if equipped)

VEHICLE	YEARS	Immobilizer bypass	T-Harness Harnais en T	Lock	Unlock	Arm	Disarm	Tachometer	Power lift Gate	Parking Lights	Autolight Off	Door Status	Trunk Status	Hand-Brake Status	Foot-Brake Status	OEM remote Monitoring	R.S. OEM remote Stand Alone compatible
TOYOTA																	
Rav4	H-KEY 2016-2018	•	•	•	•	•	•	•	•	•	•	•	•	•	•	•	•



BYPASS FIRMWARE VERSION

**79.[48]**

TOYOTA/LEXUS/SUBARU MINIMUM

To add the firmware version and the options, use the **FLASH LINK UPDATER** or **FLASH LINK MOBILE** tool, sold separately.

### (-)-POWER LIFT GATE



Program remote starter option:

FUNCTION	MODE	DESCRIPTION
<b>34</b>	<b>2</b>	TRUNK OUTPUT. Pulse 2.5 Seconds.
<b>34</b>	<b>3</b>	Trunk output : Unlock before trunk pulse 0.5 sec



Program remote starter option for R.S. OEM REMOTE STAND ALONE:

FUNCTION	MODE	DESCRIPTION
<b>38</b>	<b>2</b>	Enable Press 3x Lock to remote start with the OEM remote.



Program bypass option:

UNIT OPTION

DESCRIPTION

**C1**

OEM Remote status (Lock/Unlock) monitoring

**D5**

Lock after start



Program bypass option:

UNIT OPTION

DESCRIPTION

**A2**

**OFF**

Trunk Release

### MANDATORY INSTALL

\* HOOD PIN



**HOOD STATUS:** THE HOOD PIN SWITCH (INCLUDED) MUST BE INSTALLED IF THE VEHICLE CAN BE REMOTE STARTED WITH THE HOOD OPEN.

SECURITY STICKER

SÉCURITÉ



Included

**Notice:** the installation of safety elements are mandatory. The hood pin and the sticker are essential security elements and must be installed.

THIS MODULE MUST BE INSTALLED BY A QUALIFIED TECHNICIAN. A WRONG CONNECTION CAN CAUSE PERMANENT DAMAGE TO THE VEHICLE.

DESCRIPTION

⑤ Steering column

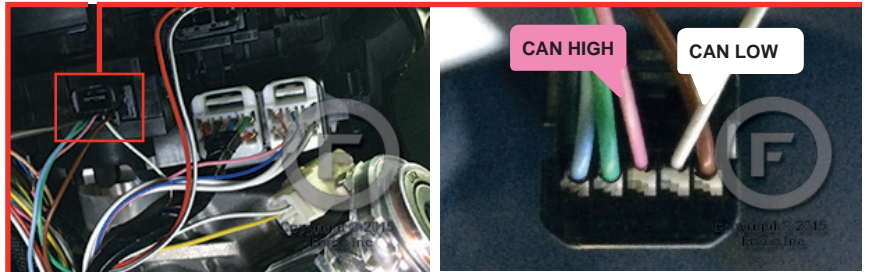

⑥ Under fuse box



① Ignition switch

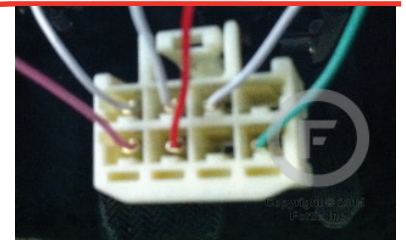

④ Parking Light Switch



⑨ OBD-II connector

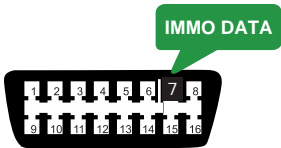

③ Fuse box

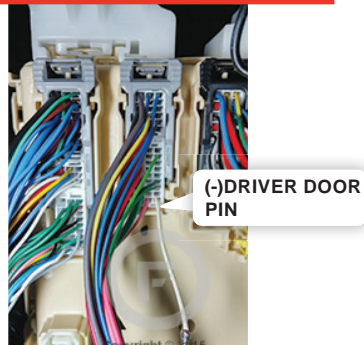

⑧ Driver kick panel

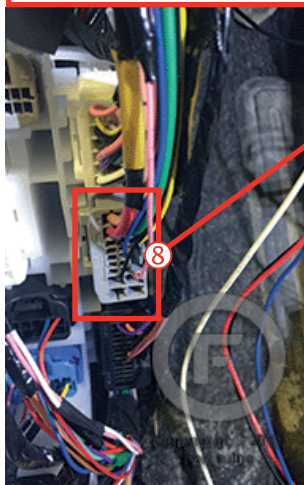

(-)DISARM

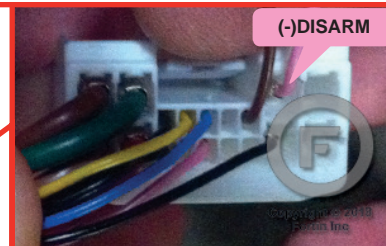



WIRING CONNECTION

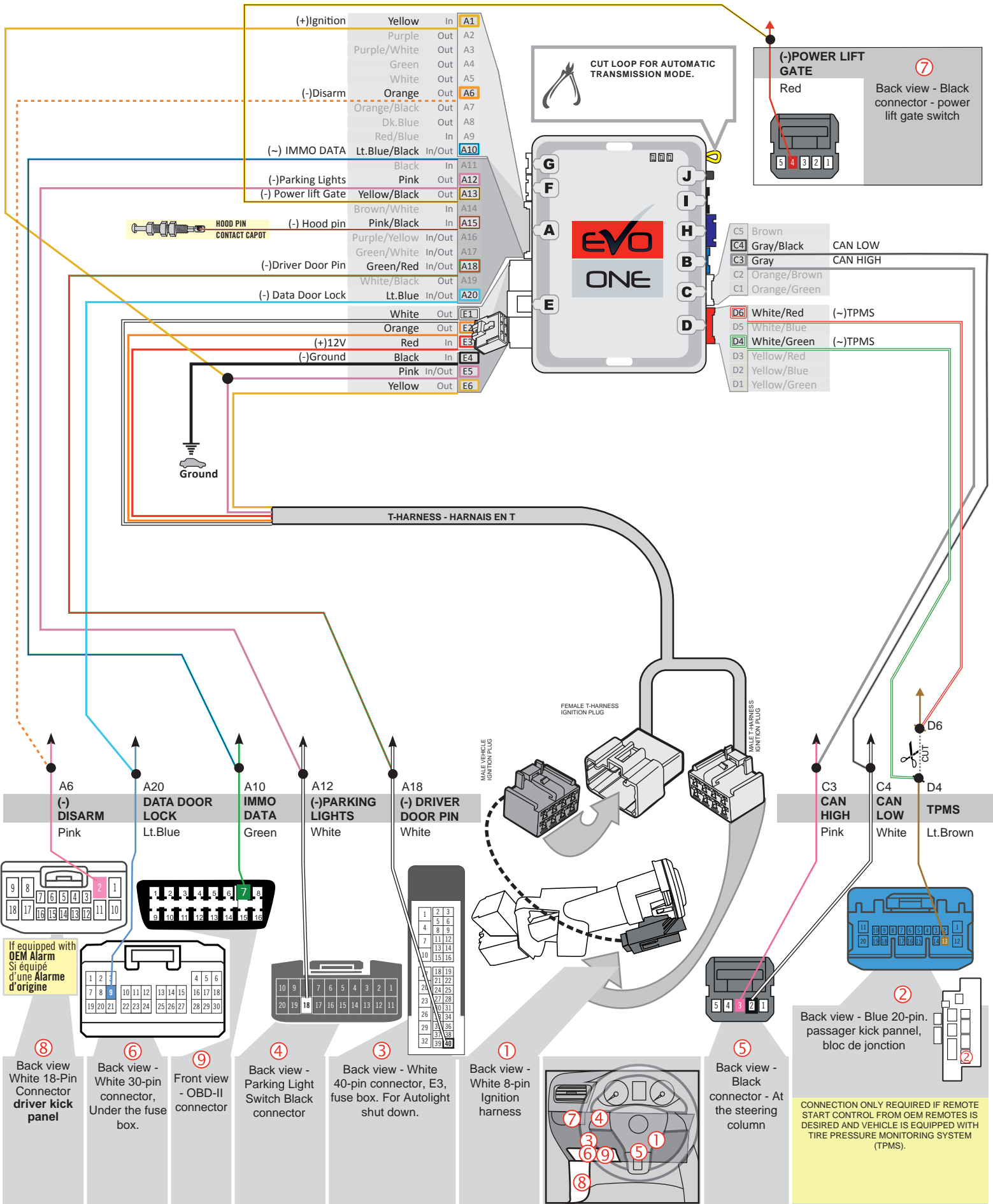



**KEY BYPASS PROGRAMMING PROCEDURE**



Do not use the grey key.



1

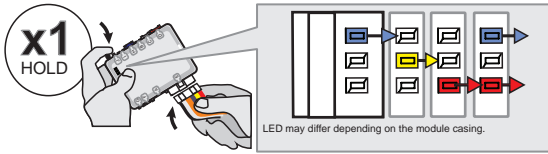

Press and hold the programming button:  
Insert the 6-Pin Main connector.

↳ The LEDs will alternate between BLUE, RED, YELLOW & BLUE/RED flashes.

2

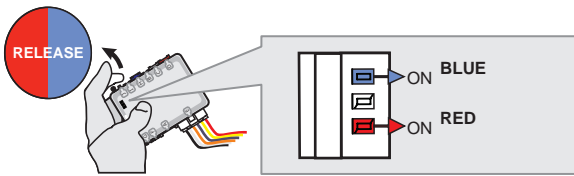

Release the programming button when the LED's are RED and BLUE.

If the LED's are not solid BLUE and RED disconnect the 6-Pin connector (Main-Harness) and go back to step 1.



3

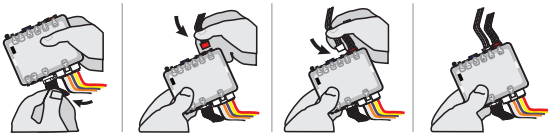

Insert the required remaining connectors.

4

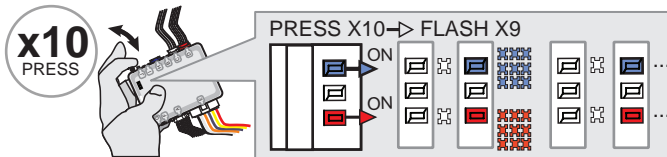

Press and release the programming button ten (10x) times.

↳ The RED and BLUE LED's will alternate between 9 flashes and a pause.

5

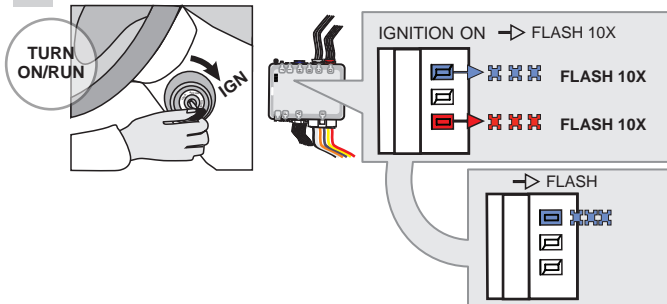

Turn the Ignition to the ON/RUN position.

↳ The RED and BLUE LED's will flash rapidly 10x times. Key bypass programmed.

↳ The BLUE LED will flash rapidly. CAN-Bus programmed.

6

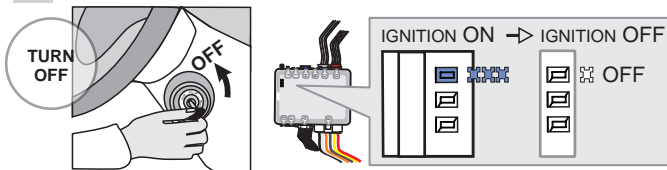

Turn the Ignition to the OFF position.

↳ The BLUE LED will turn off.



The module is now programmed.

Use the remote of the remote starter or security system to test all of the supported features to ensure proper programming.

REMOTE STARTER PROGRAMMING PROCEDURE



REFER TO THE **QUICK INSTALL GUIDE** INCLUDED WITH THE MODULE FOR THE REMOTE STARTER PROGRAMMING.

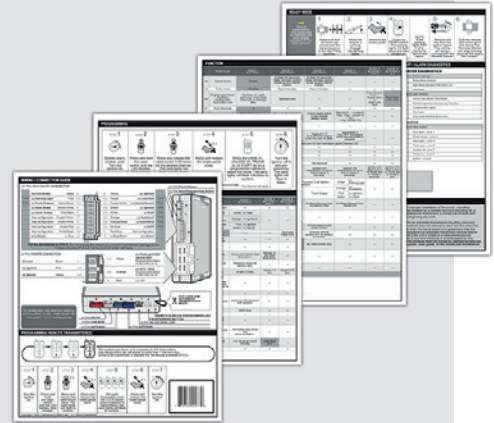

# THAR-ONE-TOY3 THARNESSE INSTALLATION

## ADDENDUM - SUGGESTED WIRING CONFIGURATION

VEHICLE	YEARS	Vehicle functions supported in this diagram (functional if equipped)														
		Transponder Bypass	T-harness Harmais en T	Lock	Unlock	Arm	Disarm	Parking Lights	Trunk (open)	Tachometer	Autolight Off	Door Status	Trunk Status	Hand-Brake Status	Foot-Brake Status	OEM remote Monitoring
<b>SCION</b>																
iM	H-KEY Automatic transmission page 3	2016	•	•	•	•	•	•	•	•	•	•	•	•	•	•
	H-KEY Manual transmission page 4	2016	•	•	•	•	•	•	•	•	•	•	•	•	•	•

**BYPASS FIRMWARE VERSION**

# 79.[65]

TOYOTA/LEXUS/SUBARU MINIMUM

 To add the firmware version and the options, use the **FLASH LINK UPDATER** or **FLASH LINK MOBILE** tool, sold separately.

**Program bypass option:**
**UNIT OPTION**
**DESCRIPTION**

# C1

OEM Remote status (Lock/Unlock) monitoring

# D5

Lock after start

**IF THE VEHICLE IS NOT EQUIPPED WITH FUNCTIONAL HOOD PIN:**

# A11

**OFF  
NON**

Hood trigger (Output Status).

**Program remote starter option for R.S. OEM REMOTE STAND ALONE:**
**FUNCTION**
**MODE**
**DESCRIPTION**

# 38

# 2

 Enable  
Press 3x Lock to remote start with the OEM remote.

### MANDATORY INSTALL

**\* HOOD PIN**

**HOOD STATUS:** THE HOOD PIN SWITCH (INCLUDED) MUST BE INSTALLED IF THE VEHICLE CAN BE REMOTE STARTED WITH THE HOOD OPEN, SET FUNCTION A11 TO OFF.

# A11

**OFF**
**SECURITY STICKER**



Included

**Notice:** the installation of safety elements are mandatory. The hood pin and the sticker are essential security elements and must be installed.

**THIS MODULE MUST BE INSTALLED BY A QUALIFIED TECHNICIAN. A WRONG CONNECTION CAN CAUSE PERMANENT DAMAGE TO THE VEHICLE.**

DESCRIPTION

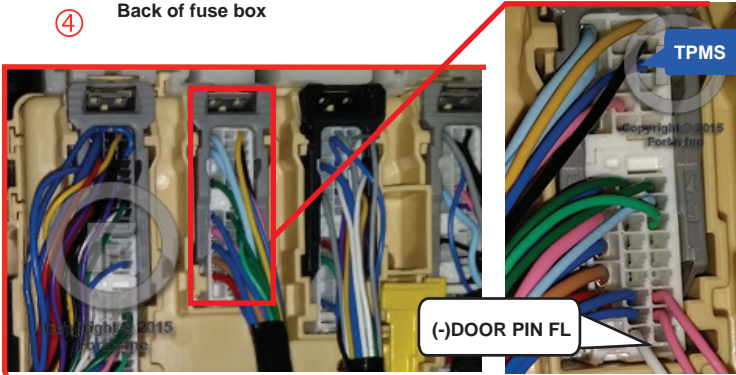
④ Back of fuse box



③ OBDII connector

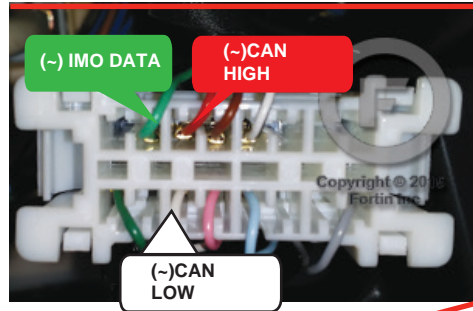

② Fuse Box

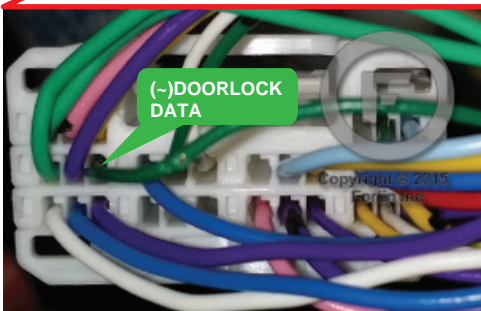
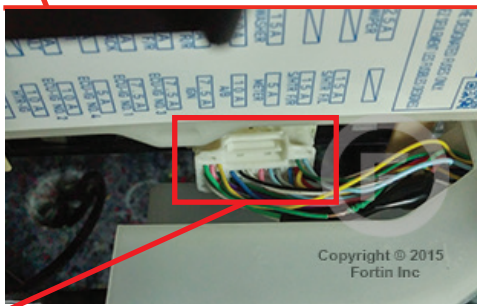

⑧ Driver kick panel



① Ignition harness

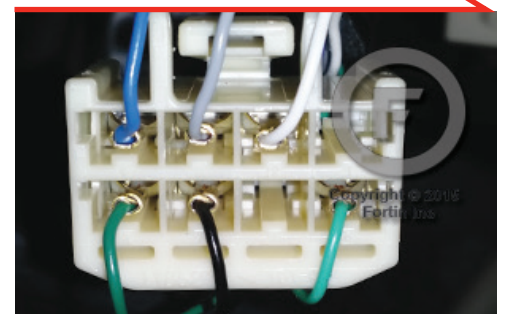

⑤ Parking Lights switch



⑥ Firewall

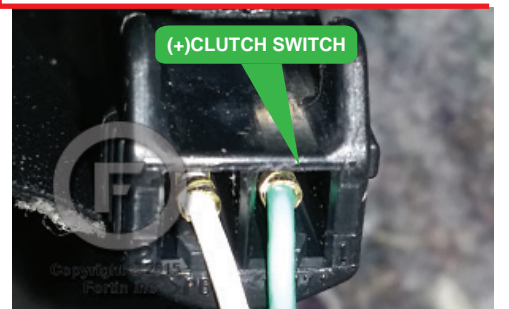

**AUTOMATIC TRANSMISSION WIRING CONNECTION**

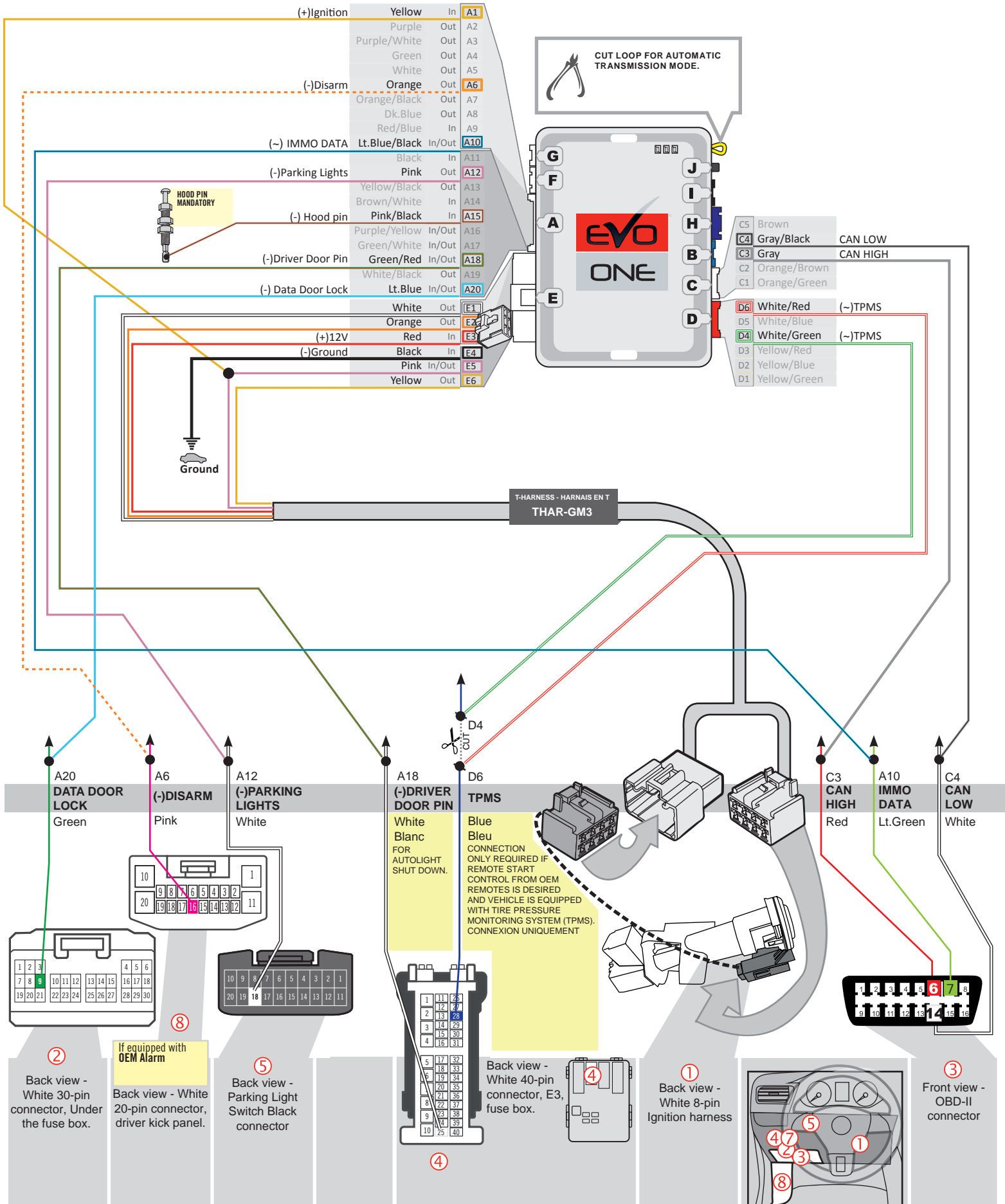



MANUAL TRANSMISSION WIRING CONNECTION

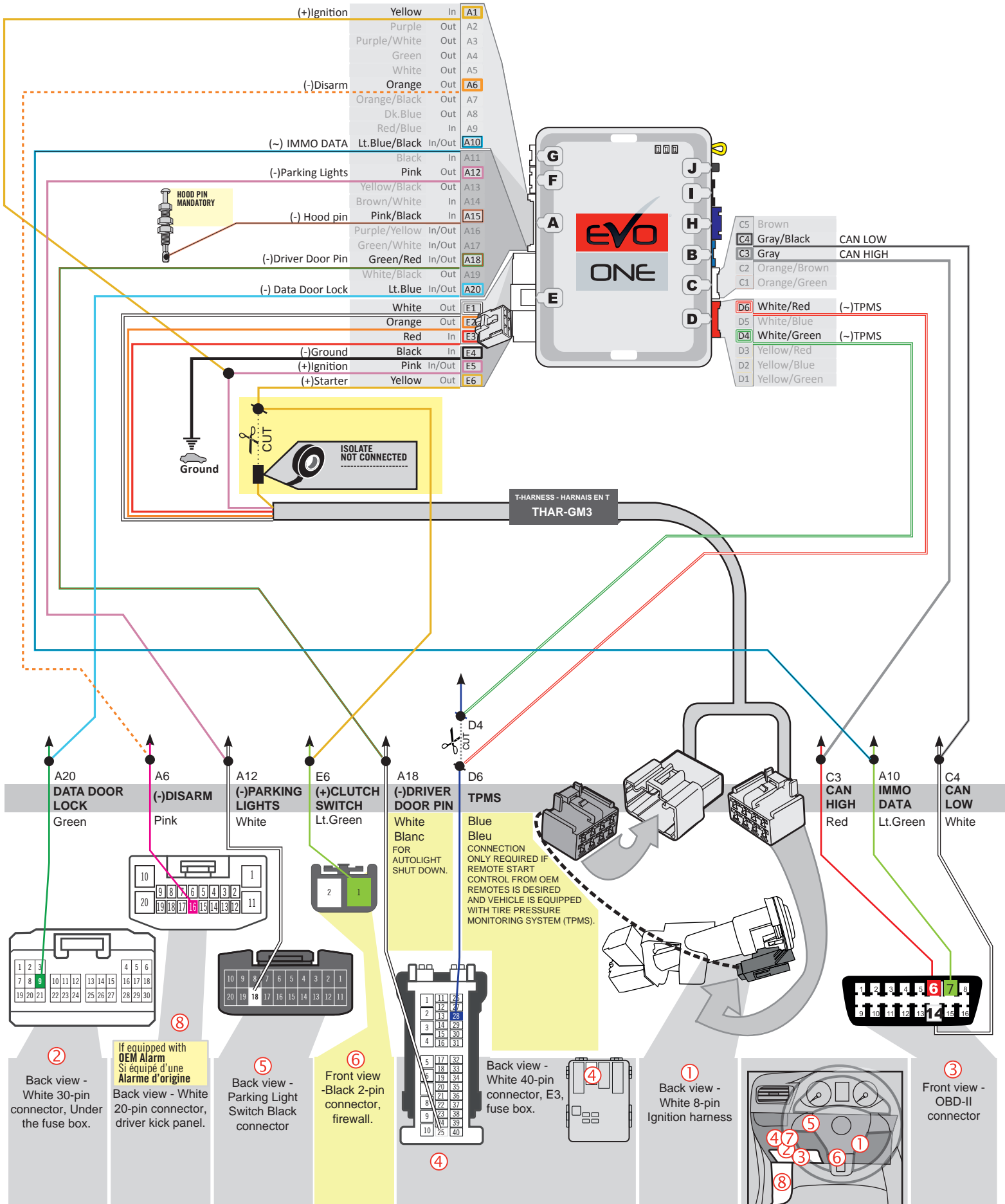

② Back view - White 30-pin connector, Under the fuse box.

⑧ If equipped with OEM Alarm Si équipé d'une Alarme d'origine  
Back view - White 20-pin connector, driver kick panel.

⑤ Back view - Parking Light Switch Black connector

⑥ Front view - Black 2-pin connector, firewall.

④ Back view - White 40-pin connector, E3, fuse box.

① Back view - White 8-pin Ignition harness

③ Front view - OBD-II connector

⑦

⑧

⑤

①

⑥

④

⑦

⑧



**KEY BYPASS PROGRAMMING PROCEDURE**



Do not use the grey key.



1

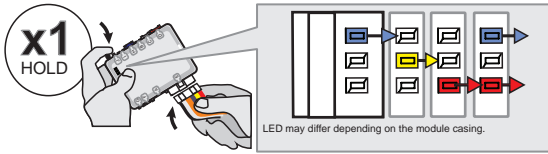

Press and hold the programming button:  
Insert the 6-Pin Main connector.

↳ The LEDs will alternate between BLUE, RED, YELLOW & BLUE/RED flashes.

2

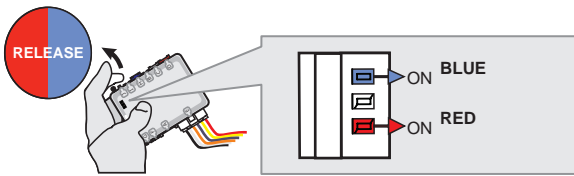

Release the programming button when the LED's are RED and BLUE.

If the LED's are not solid BLUE and RED disconnect the 6-Pin connector (Main-Harness) and go back to step 1.



3

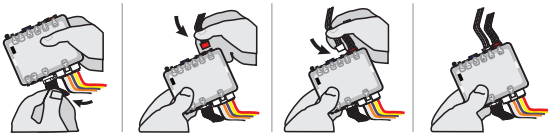

Insert the required remaining connectors.

4

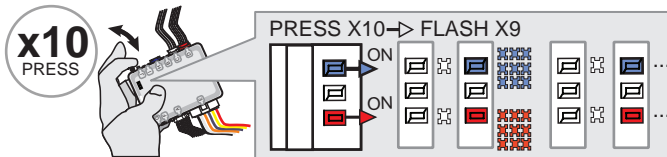

Press and release the programming button ten (10x) times.

↳ The RED and BLUE LED's will alternate between 9 flashes and a pause.

5

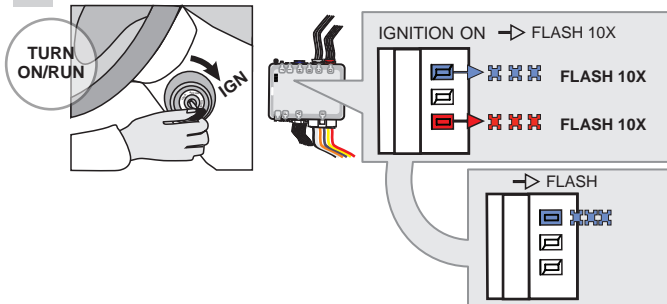

Turn the Ignition to the ON/RUN position.

↳ The RED and BLUE LED's will flash rapidly 10x times. Key bypass programmed.

↳ The BLUE LED will flash rapidly. CAN-Bus programmed.

6

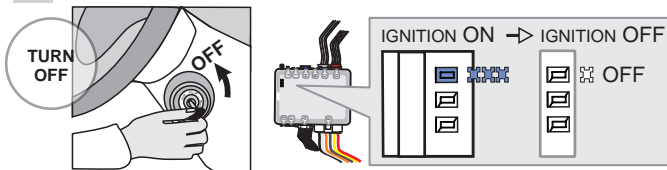

Turn the Ignition to the OFF position.

↳ The BLUE LED will turn off.



**The module is now programmed.**

Use the remote of the remote starter or security system to test all of the supported features to ensure proper programming.



REFER TO THE **QUICK INSTALL GUIDE** INCLUDED WITH THE MODULE FOR THE REMOTE STARTER PROGRAMMING.

