

THAR-ONE-TOY5 THARNSS INSTALLATION

 ADDENDUM - SUGGESTED WIRING
CONFIGURATION

VEHICLE			Vehicle functions supported in this diagram (functional if equipped)														
VEHICLE	YEARS		Transponder Bypass	T-harness Harnais en T	Lock	Unlock	Arm	Disarm	Parking Lights	Tachometer	Autolight Off	Door Status	Trunk Status	Hand-Brake Status	Foot-Brake Status	OEM remote Monitoring	R.S. OEM remote Stand Alone compatible
TOYOTA Highlander	H-KEY 2014-2016		•	•	•	•	•	•	•	•	•	•	•	•	•	•	•

	COMPATIBLE MODULE REQUIRED:	QR CODE ON THE LABEL MANUFACTURED AFTER: 2019	FIRMWARE VERSION 79.[59] TOYOTA/LEXUS MINIMUM	To add the firmware version and the options, use the FLASH LINK UPDATER or FLASH LINK MOBILE tool, sold separately.
		(Empty space for QR code)		

	Program bypass option IF THE VEHICLE IS NOT EQUIPPED WITH FUNCTIONAL HOOD PIN:	UNIT OPTION	DESCRIPTION
		A11	OFF

	Program bypass option:	UNIT OPTION	DESCRIPTION
		C1	OEM Remote status (Lock/Unlock) monitoring
		D5	Lock after start

	Program remote starter option:	FUNCTION	MODE	DESCRIPTION
		2	4	(+) Start 2 (E1)
				(+) Ignition 2 (E2)

	Program remote starter option for R.S. OEM REMOTE STAND ALONE:	FUNCTION	MODE	DESCRIPTION
		38	2	Enable Press 3x Lock to remote start with the OEM remote.

MANDATORY INSTALL !		Notice: the installation of safety elements are mandatory. The hood pin and the sticker are essential security elements and must be installed.		THIS MODULE MUST BE INSTALLED BY A QUALIFIED TECHNICIAN. A WRONG CONNECTION CAN CAUSE PERMANENT DAMAGE TO THE VEHICLE.
* HOOD PIN	HOOD STATUS : THE HOOD PIN SWITCH (INCLUDED) MUST BE INSTALLED IF THE VEHICLE CAN BE REMOTE STARTED WITH THE HOOD OPEN, SET FUNCTION A11 TO OFF.	A11	OFF	
		SECURITY STICKER		
		Included		

(-)POWER LIFT GATE

	Program remote starter option:	FUNCTION	MODE	DESCRIPTION
		34	2	TRUNK OUTPUT. Pulse 2.5 Seconds.
REMOTE STARTER FIRMWARE VERSION 1.[16] TOYOTA/LEXUS MINIMUM		34	3	Trunk output : Unlock before trunk pulse 0.5 sec
		34	4	Trunk output : trunk on Ignition only

③ ④ At BCM



① Ignition switch

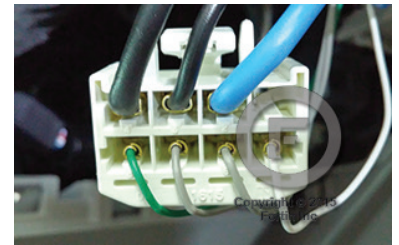

② OBD-II connector

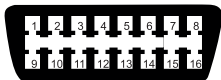

WIRING CONNECTION |

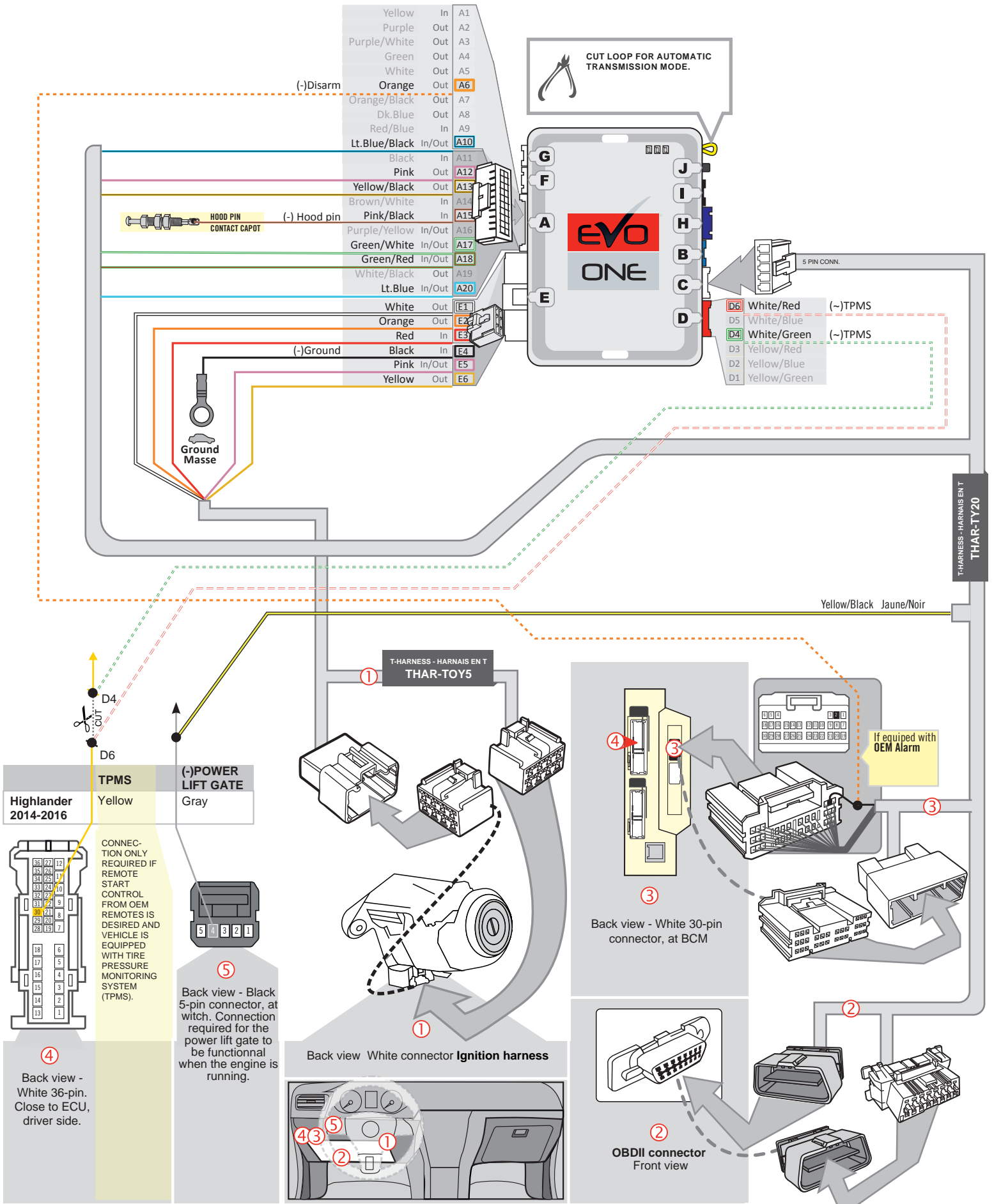

KEY BYPASS PROGRAMMING PROCEDURE |



Do not use the grey key.



1

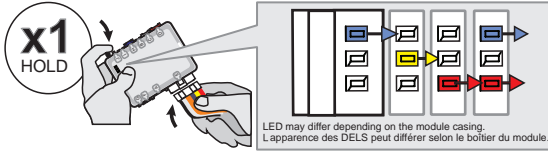

Press and hold the programming button:
Insert the 6-Pin Main connector.

↳ The LEDs will alternate between BLUE, RED, YELLOW & BLUE/RED flashes.

2



Release the programming button when the LED's are RED and BLUE.

If the LED's are not solid BLUE and RED disconnect the 6-Pin connector (Main-Harness) and go back to step 1.

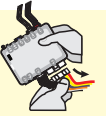

3

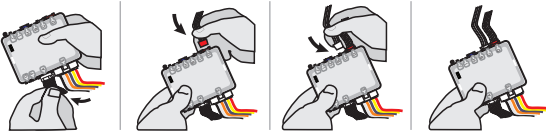

Insert the required remaining connectors.

4

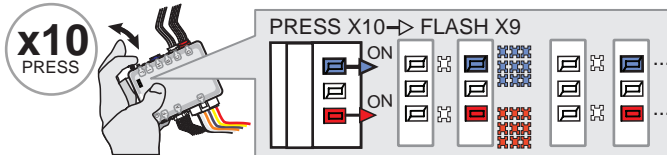

Press and release the programming button ten (10x) times.

↳ The RED and BLUE LED's will alternate between 9 flashes and a pause.

5

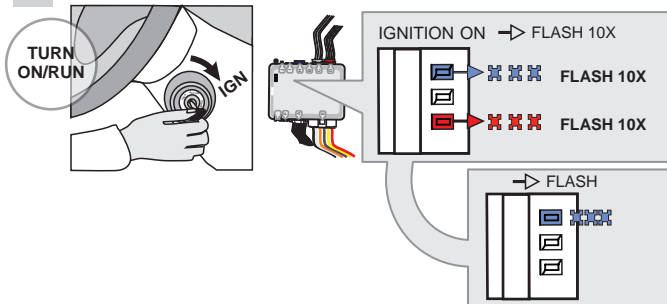

Turn the Ignition to the ON/RUN position.

↳ The RED and BLUE LED's will flash rapidly 10x times. Key bypass programmed.

↳ The BLUE LED will flash rapidly. CAN-Bus programmed.

6

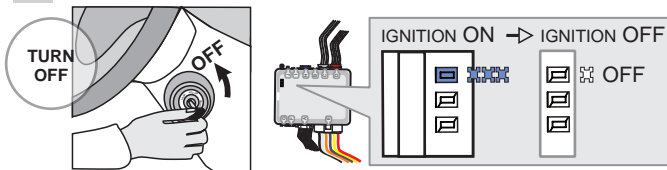

Turn the Ignition to the OFF position.

↳ The BLUE LED will turn off.



The module is now programmed.

Use the remote of the remote starter or security system to test all of the supported features to ensure proper programming.

REMOTE STARTER PROGRAMMING PROCEDURE |



REFER TO THE **QUICK INSTALL GUIDE** INCLUDED WITH THE MODULE FOR THE REMOTE STARTER PROGRAMMING.

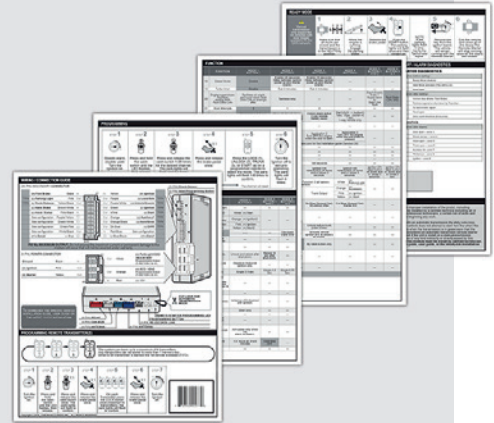

THAR-ONE-TOY5 THARNES

ADDENDUM - SUGGESTED WIRING CONFIGURATION



Vehicle functions supported in this diagram (functional if equipped)

Vehicle	Modelo	Years	Transponder Bypass	T-harness	Lock	Unlock	Arm	Disarm	Parking lights	Tachometer	Autolight Off	Power Lift gate	Door Status	Trunk Status	Hand-Brake Status	Foot-Brake Status	OEM Remote Monitoring	R.S. OEM remote Stand Alone compatible
TOYOTA																		
Highlander	H-KEY	2017-2019	•	•	•	•	•	•	•	•	•	•	•	•	•	•	•	•

	HARDWARE VERSION	BYPASS FIRMWARE VERSION	To add the firmware version and the options, use the FLASH LINK UPDATER or FLASH LINK MOBILE tool, sold separately.
	MINIMUM 2	79.[66]	
TOYOTA/LEXUS/SUBARU MINIMUM			

	Program bypass option IF THE VEHICLE IS NOT EQUIPPED WITH FUNCTIONAL HOOD PIN:	UNIT OPTION	DESCRIPTION
		A11	OFF

	Program bypass option:	UNIT OPTION	DESCRIPTION
		C1	OEM Remote status (Lock/Unlock) monitoring
		D5	Lock after start

MANDATORY INSTALL
*** HOOD PIN**

HOOD STATUS: THE HOOD PIN SWITCH (INCLUDED) MUST BE INSTALLED IF THE VEHICLE CAN BE REMOTE STARTED WITH THE HOOD OPEN, SET FUNCTION **A11** TO OFF.

A11
OFF
SECURITY STICKER



Included

Notice: the installation of safety elements are mandatory. The hood pin and the sticker are essential security elements and must be installed.

THIS MODULE MUST BE INSTALLED BY A QUALIFIED TECHNICIAN. A WRONG CONNECTION CAN CAUSE PERMANENT DAMAGE TO THE VEHICLE.

NOTES

	Program remote starter option:	FUNCTION	MODE	DESCRIPTION
		2	4	(+) Start 2 (E1)
				(+) Ignition 2 (E2)

	Program remote starter option for R.S. OEM REMOTE STAND ALONE:	FUNCTION	MODE	DESCRIPTION
		38	2	Enable Press 3x Lock to remote start with the OEM remote.

(-)POWER LIFT GATE

	Program remote starter option:	FUNCTION	MODE	DESCRIPTION
		34	2	TRUNK OUTPUT. Pulse 2.5 Seconds.
		34	3	Trunk output : Unlock before trunk pulse 0.5 sec
		34	4	Trunk output : trunk on Ignition only

DESCRIPTION | DESCRIPTION

TPMS : CONNECTION ONLY REQUIRED IF REMOTE START CONTROL FROM OEM REMOTES IS DESIRED AND VEHICLE IS EQUIPPED WITH TIRE PRESSURE MONITORING SYSTEM (TPMS).



① At BCM

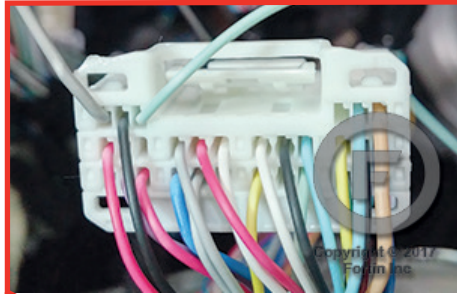

③ Ignition switch

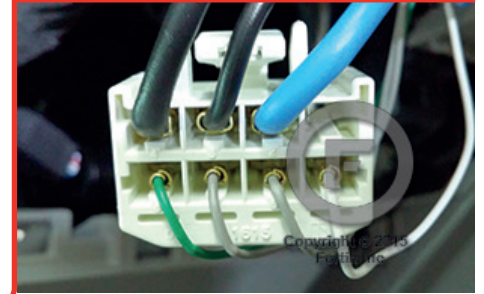

② OBD-II connector
Connecteur OBD-II

WITHOUT SANS

SEE PAGE 4

⑤ At BCM

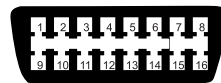
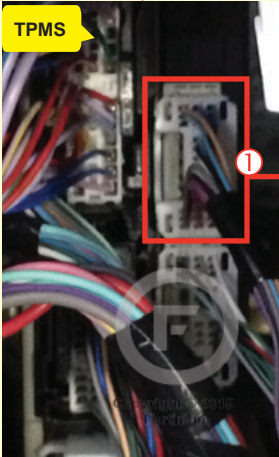

OR OU 08/2018 AND BELOW
AVANT 08/2018
WITH

SEE PAGE 5

⑤ Driver kick panel

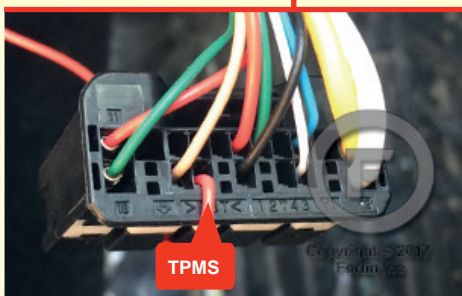

OR OU 09/2018 AND LATER
09/2018 ET PLUS
WITH

SEE PAGE 6

⑤ Driver kick panel

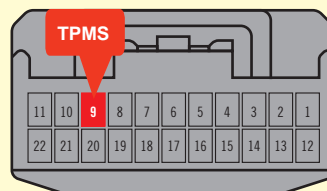

WITHOUT START-STOP

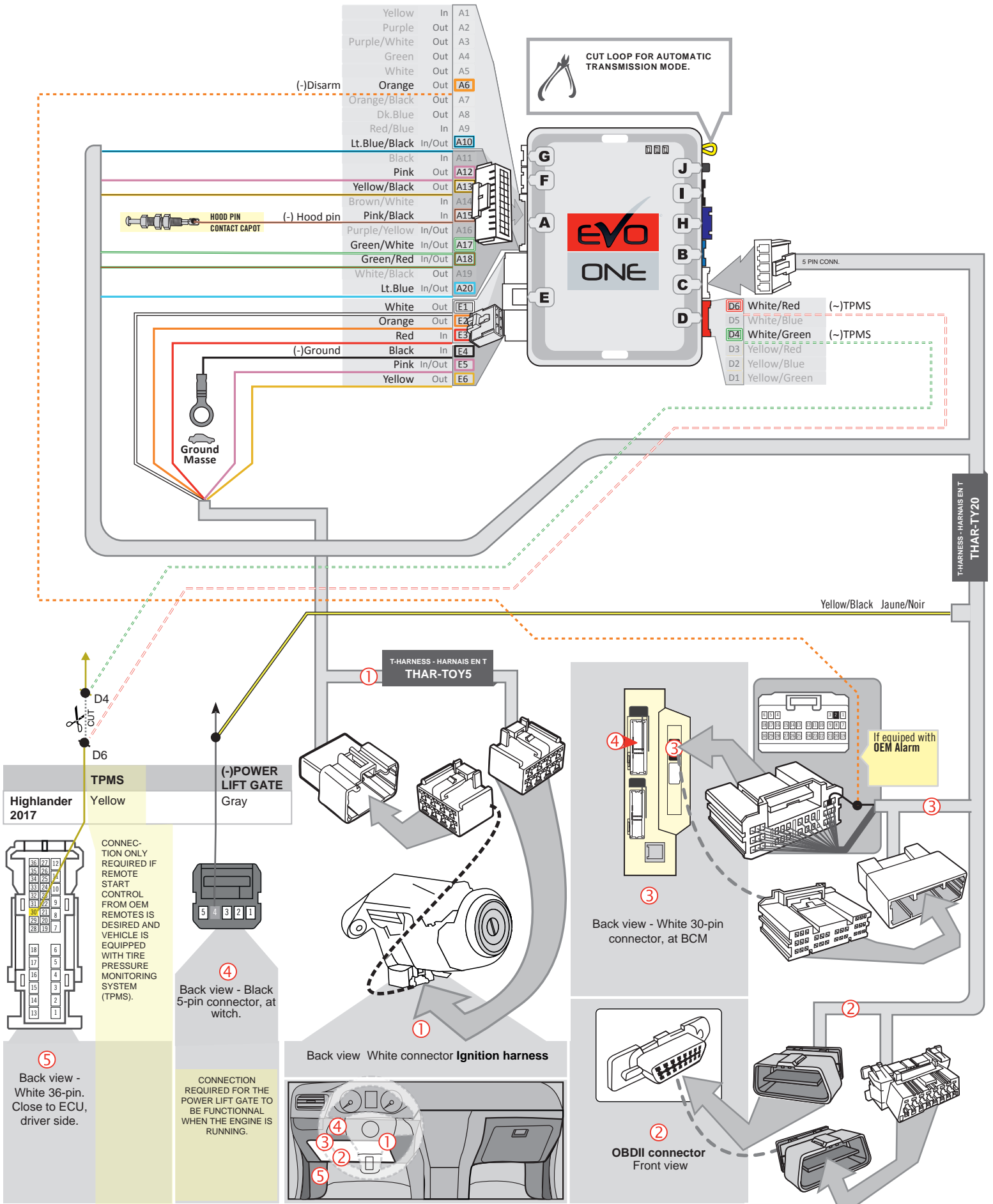

WIRING CONNECTION

WITH AUTOMATIC START-STOP BUTTON BEFORE 08/2018

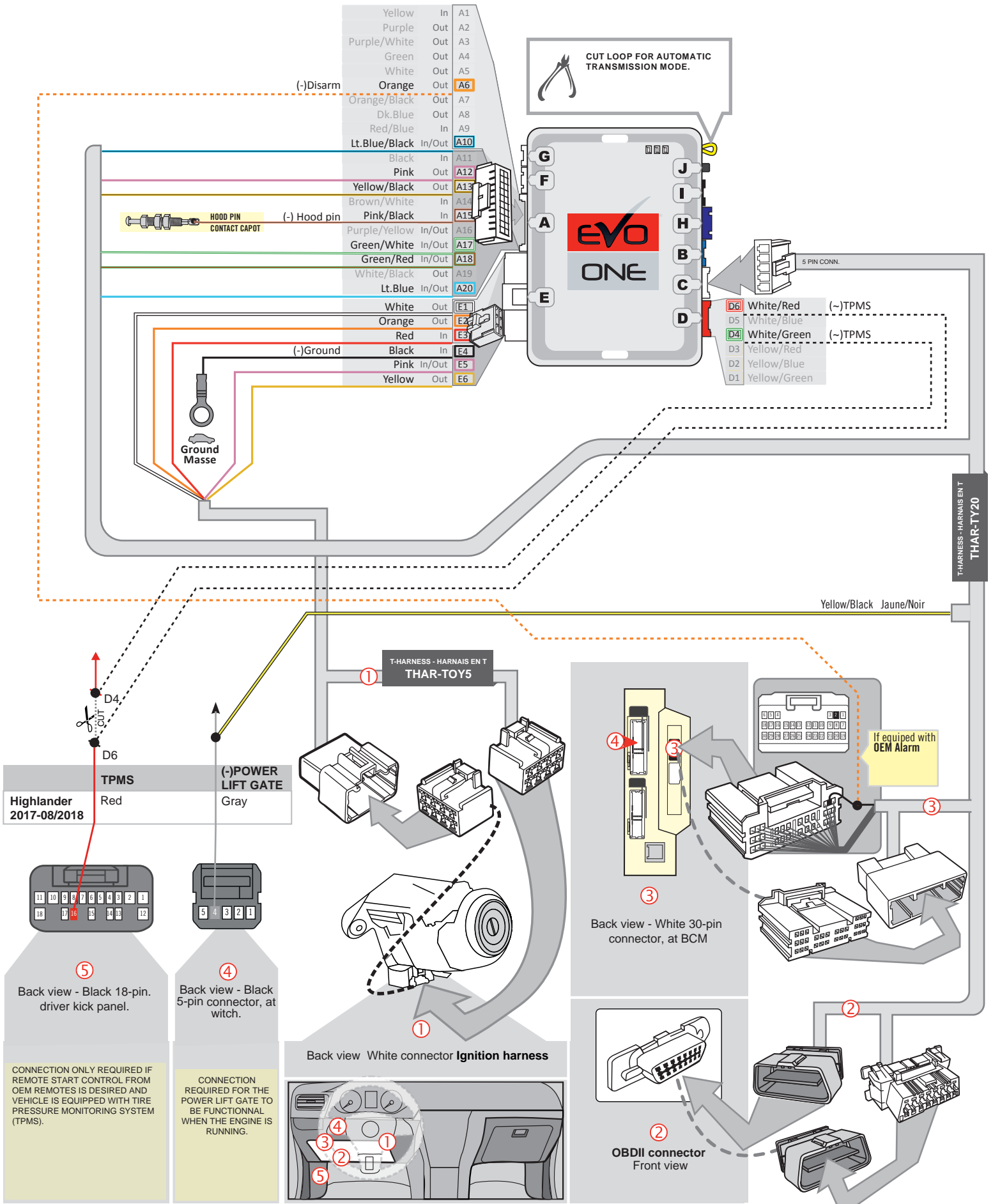

WITH AUTOMATIC START-STOP BUTTON AFTER 09/2018

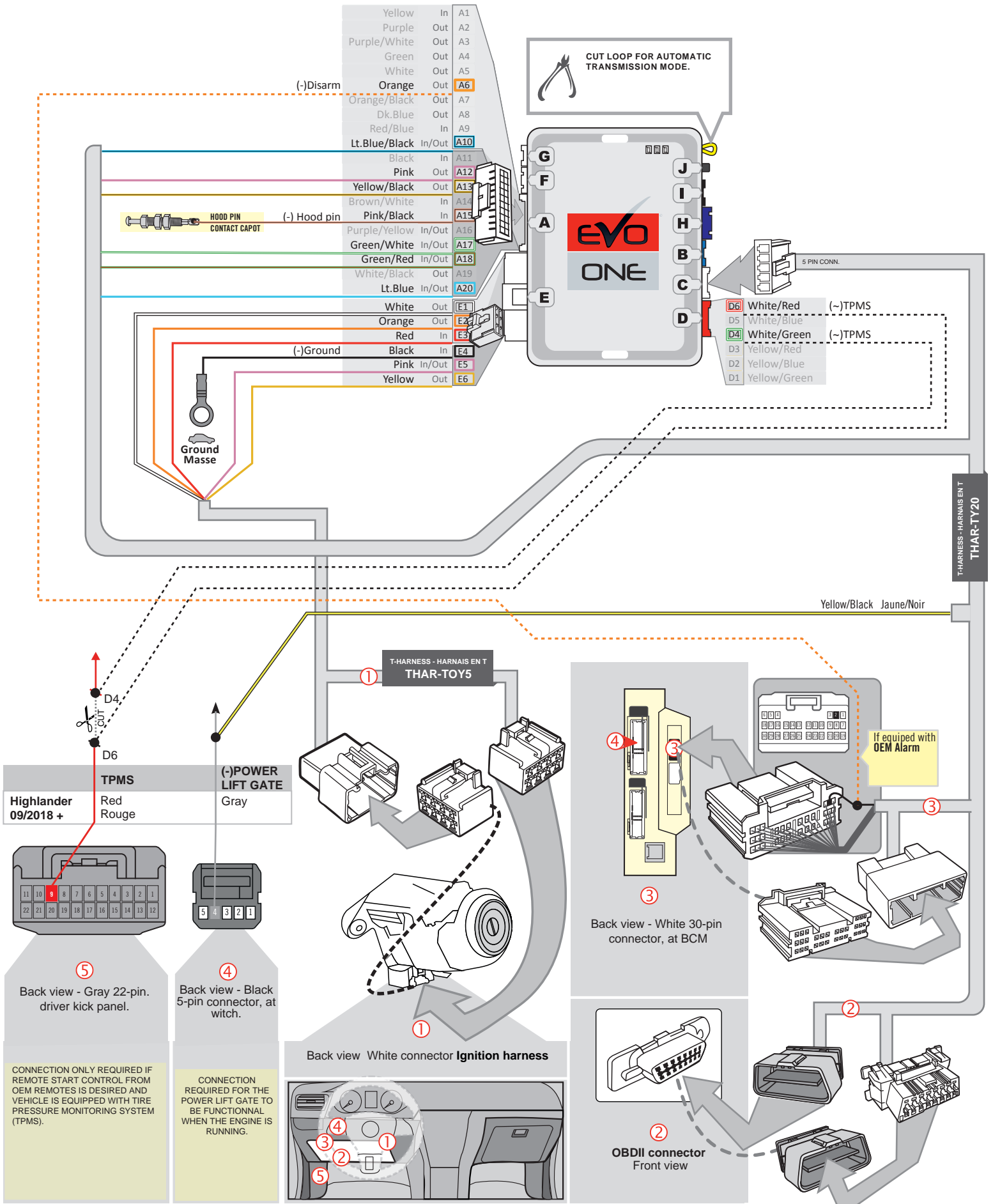

KEY BYPASS PROGRAMMING PROCEDURE



Do not use the grey key.



1

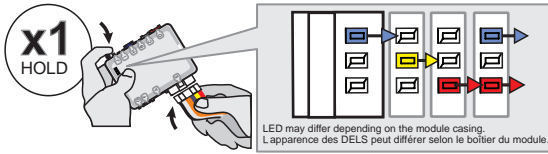

Press and hold the programming button:
Insert the 6-Pin Main connector.

↳ The LEDs will alternate between BLUE, RED, YELLOW & BLUE/RED flashes.

2

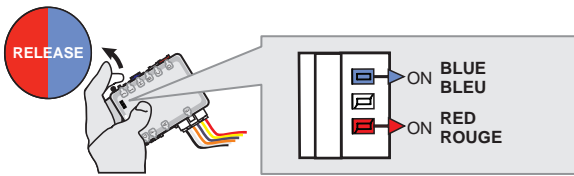

Release the programming button when the LED's are RED and BLUE.

If the LED's are not solid BLUE and RED disconnect the 6-Pin connector (Main-Harness) and go back to step 1.

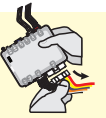

3

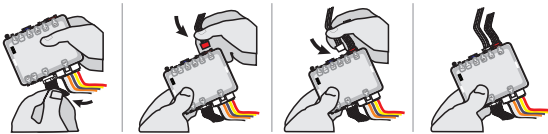

Insert the required remaining connectors.

4

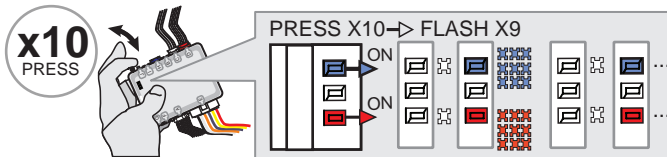

Press and release the programming button ten (10x) times.

↳ The RED and BLUE LED's will alternate between 9 flashes and a pause.

5

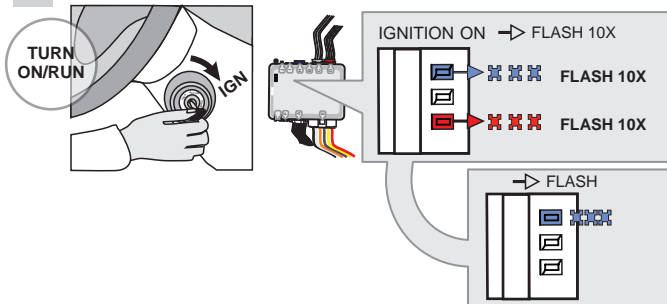

Turn the Ignition to the ON/RUN position.

↳ The RED and BLUE LED's will flash rapidly 10x times. Key bypass programmed.

↳ The BLUE LED will flash rapidly. CAN-Bus programmed.

6

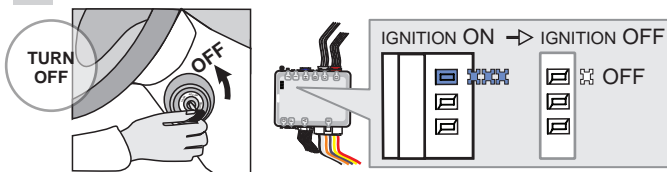

Turn the Ignition to the OFF position.

↳ The BLUE LED will turn off.



The module is now programmed.

Use the remote of the remote starter or security system to test all of the supported features to ensure proper programming.

REMOTE STARTER PROGRAMMING PROCEDURE



REFER TO THE **QUICK INSTALL GUIDE** INCLUDED WITH THE MODULE FOR THE REMOTE STARTER PROGRAMMING.

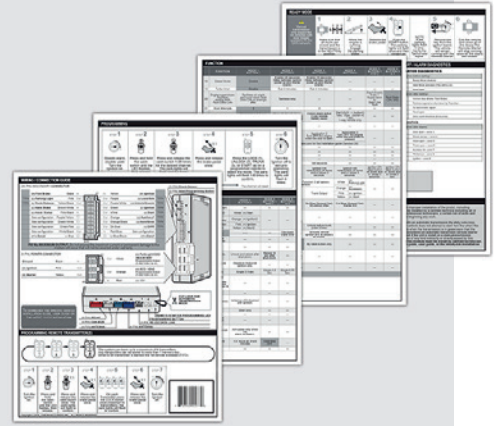

REMOTE STARTER FUNCTIONALITY



All doors must be closed.



Remote start the vehicle.



Unlock the doors with the remote-starter remote or the OEM remote.

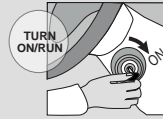

Insert and Turn the key to the Ignition ON/RUN position.



Press the brake pedal.





The vehicle can now be put in to gear and driven.

THAR-ONE-TOY5 THARNNESS INSTALLATION

ADDENDUM - SUGGESTED WIRING CONFIGURATION

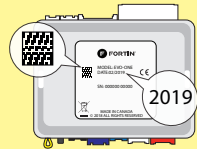
VEHICLE	YEARS	Vehicle functions supported in this diagram (functional if equipped)														
		Transponder Bypass	T-harness Harnais en T	Lock	Unlock	Arm	Disarm	Parking Lights	Autolight Off	Tachometer	Door Status	Hand-Brake Status	Foot-Brake Status	OEM remote Monitoring	R.S. OEM remote Stand Alone compatible	
																
TOYOTA																
Tacoma	H-KEY	2016-2021	•	•	•	•	•	•	•	•	•	•	•	•	•	•

	COMPATIBLE MODULE REQUIRED:	QR CODE ON THE LABEL MANUFACTURED AFTER: 2019	FIRMWARE VERSION	To add the firmware version and the options, use the FLASH LINK UPDATER or FLASH LINK MOBILE tool, sold separately.
			79.[66] TOYOTA/LEXUS MINIMUM	

	Program bypass option IF THE VEHICLE IS NOT EQUIPPED WITH FUNCTIONAL HOOD PIN:	UNIT OPTION		DESCRIPTION
		A11	OFF	Hood trigger (Output Status).

	Program bypass option:	UNIT OPTION		DESCRIPTION
		C1		OEM Remote status (Lock/Unlock) monitoring
		D5		Lock after start

	Program remote starter option:	FUNCTION	MODE	DESCRIPTION
		2	4	(+) Start 2 (E1) (+) Ignition 2 (E2)

	Program remote starter option for R.S. OEM REMOTE STAND ALONE:	FUNCTION	MODE	DESCRIPTION
		38	2	Enable Press 3x Lock to remote start with the OEM remote.

MANDATORY INSTALL				SECURITY STICKER  Included	Notice: the installation of safety elements are mandatory. The hood pin and the sticker are essential security elements and must be installed.	THIS MODULE MUST BE INSTALLED BY A QUALIFIED TECHNICIAN. A WRONG CONNECTION CAN CAUSE PERMANENT DAMAGE TO THE VEHICLE.
* HOOD PIN		HOOD STATUS: THE HOOD PIN SWITCH (INCLUDED) MUST BE INSTALLED IF THE VEHICLE CAN BE REMOTE STARTED WITH THE HOOD OPEN, SET FUNCTION A11 TO OFF.	A11			

DESCRIPTION

① At BCM

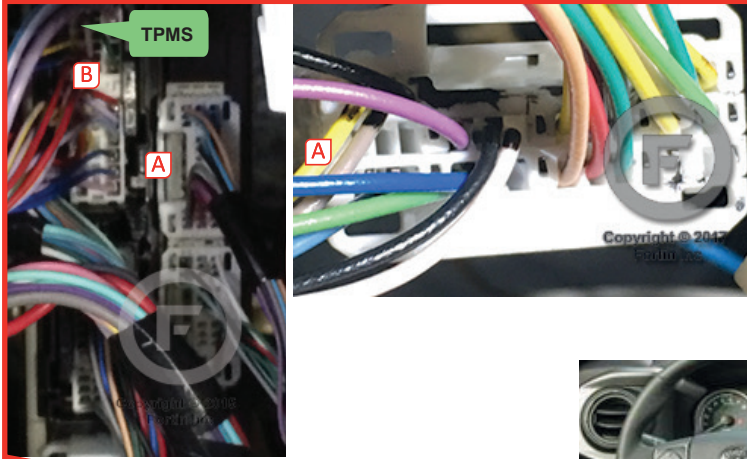

③ Ignition switch

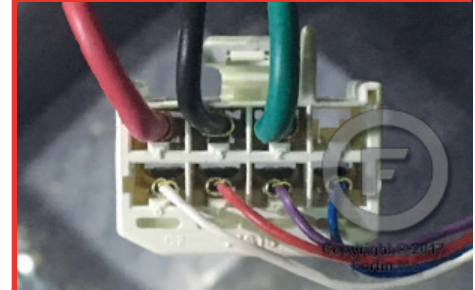

② OBD-II connector

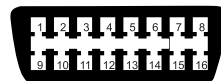

WIRING CONNECTION

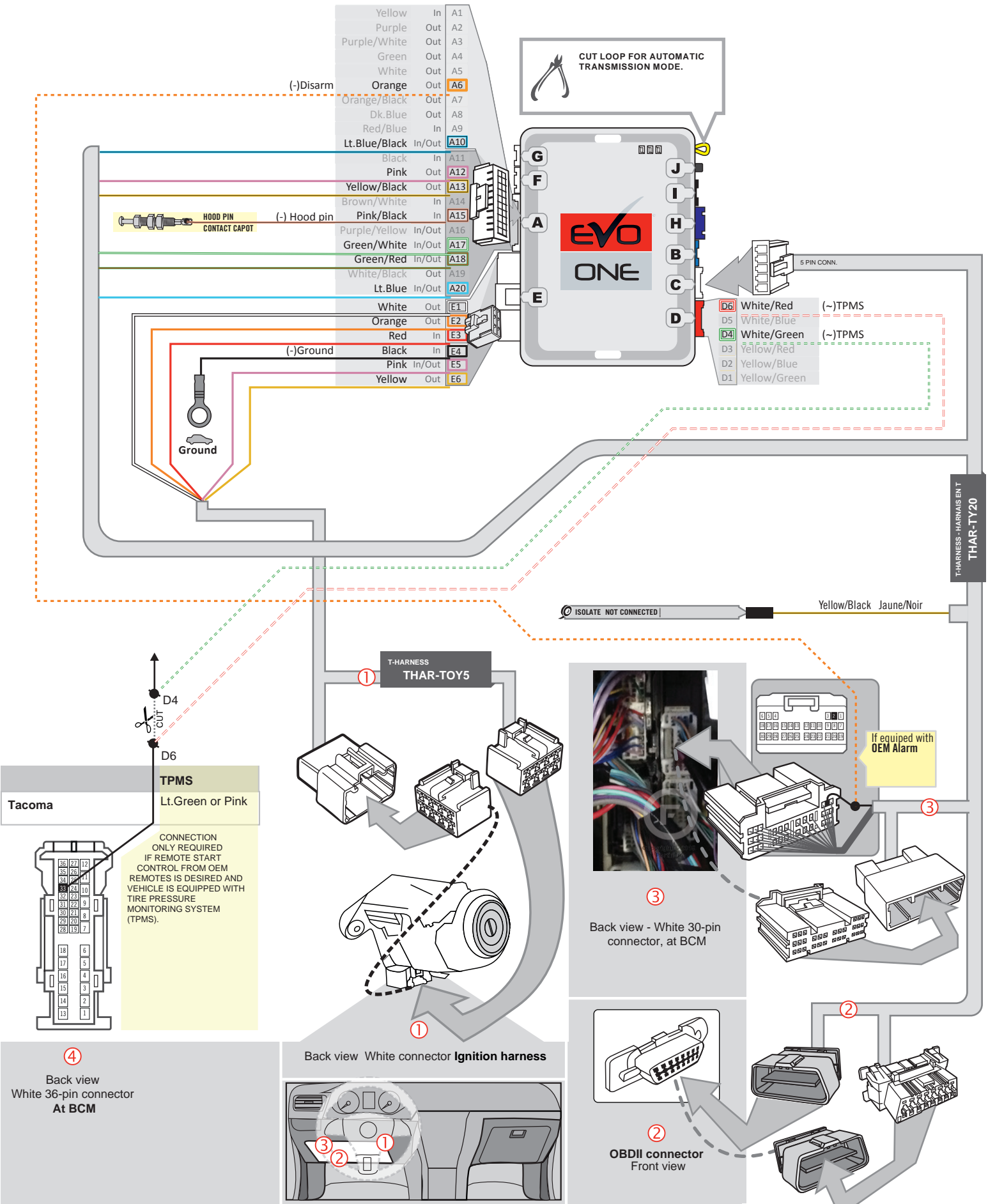

KEY BYPASS PROGRAMMING PROCEDURE



Do not use the grey key.



1

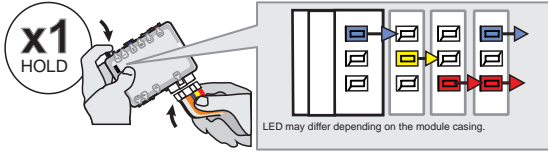

Press and hold the programming button:
Insert the 6-Pin Main connector.

↳ The LEDs will alternate between BLUE, RED, YELLOW & BLUE/RED flashes.

2



Release the programming button when the LED's are RED and BLUE.

If the LED's are not solid BLUE and RED disconnect the 6-Pin connector (Main-Harness) and go back to step 1.

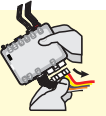

3

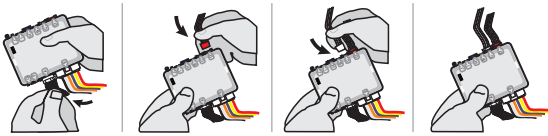

Insert the required remaining connectors.

4

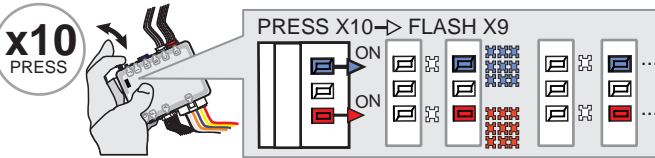

Press and release the programming button ten (10x) times.

↳ The RED and BLUE LED's will alternate between 9 flashes and a pause.

5

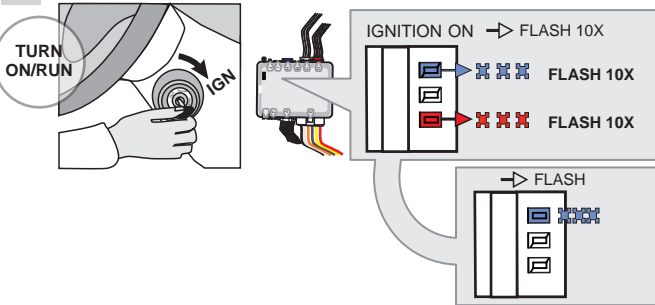

Turn the Ignition to the ON/RUN position.

↳ The RED and BLUE LED's will flash rapidly 10x times. Key bypass programmed.

↳ The BLUE LED will flash rapidly. CAN-Bus programmed.

6

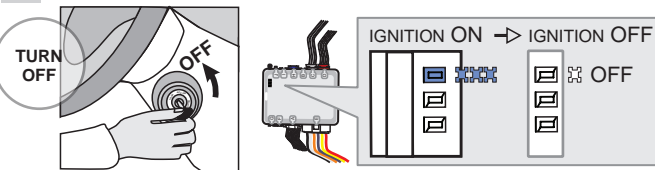

Turn the Ignition to the OFF position.

↳ The BLUE LED will turn off.



The module is now programmed.

Use the remote of the remote starter or security system to test all of the supported features to ensure proper programming.

REMOTE STARTER PROGRAMMING PROCEDURE



REFER TO THE **QUICK INSTALL GUIDE** INCLUDED WITH THE MODULE FOR THE REMOTE STARTER PROGRAMMING.

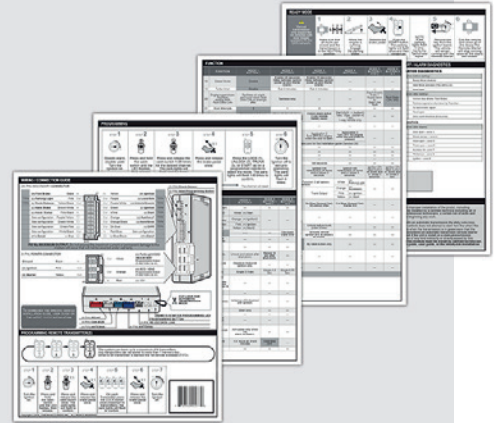

REMOTE STARTER FUNCTIONALITY |



All doors must be closed.



Remote start the vehicle.



Unlock the doors with the remote-starter remote or the OEM remote.

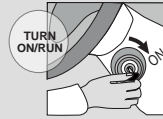

Insert and Turn the key to the Ignition ON/RUN position.



Press the brake pedal.



The vehicle can now be put in to gear and driven.