





**THAR-ONE-TOY4 THARNSS
INSTALLATION**

ADDENDUM - SUGGESTED WIRING
CONFIGURATION

Vehicle functions supported in this diagram (functional if equipped) |

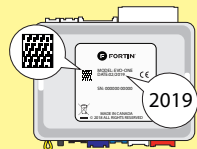
| | | | | | | | | | | | | | | | | |
|---|---------|-------|--------------------|------------------------|----------------|-----------|-----|--------|--------------|------------|-------------|--------------|-------------|-------------------|-------------------|--------------------|
|   <p>80-bit This guide is for vehicles having keys stamped with a G on the shaft.</p> | VEHICLE | YEARS | Immobilizer bypass | T-Harness Harnais en T | Lock | Unlock | Arm | Disarm | Trunk (open) | Tachometer | Door Status | Trunk Status | Hood Status | Hand-Brake Status | Foot-Brake Status | Auto-light Control |
| | | | TOYOTA | Camry | G-Key (80-BIT) | 2012-2014 | • | • | • | • | • | • | • | • | • | • |

| | | | | |
|---|------------------------------------|---|--|---|
|  | COMPATIBLE MODULE REQUIRED: | QR CODE ON THE LABEL MANUFACTURED AFTER: 2019 | FIRMWARE VERSION 79.[59] TOYOTA/LEXUS MINIMUM | To add the firmware version and the options, use the FLASH LINK UPDATER or FLASH LINK MOBILE tool, sold separately. |
| | | 2019 | | |

|  | Program remote starter option: | FUNCTION | MODE | DESCRIPTION |
|--|--------------------------------|----------|------|------------------|
| | | 2 | 4 | (+) Start 2 (E1) |

| | | | |
|---|------------|------------|-------------------------------|
| IF THE VEHICLE IS NOT EQUIPPED WITH FUNCTIONAL HOOD PIN: | A11 | OFF | Hood trigger (Output Status). |
|---|------------|------------|-------------------------------|

MANDATORY INSTALL

* HOOD PIN



HOOD STATUS: THE HOOD PIN SWITCH (INCLUDED) MUST BE INSTALLED IF THE VEHICLE CAN BE REMOTE STARTED WITH THE HOOD OPEN, SET FUNCTION A11 TO OFF.

A11

OFF

NON

SECURITY STICKER



Included

Notice: the installation of safety elements are mandatory. The hood pin and the sticker are essential security elements and must be installed.

THIS MODULE MUST BE INSTALLED BY A QUALIFIED TECHNICIAN. A WRONG CONNECTION CAN CAUSE PERMANENT DAMAGE TO THE VEHICLE.

DESCRIPTION

④ Parking Lights switch



③ ECU

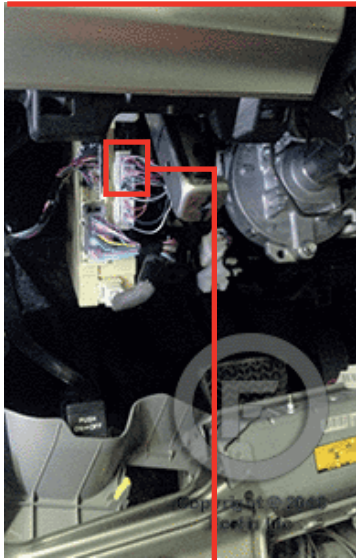

② OBD-II connector

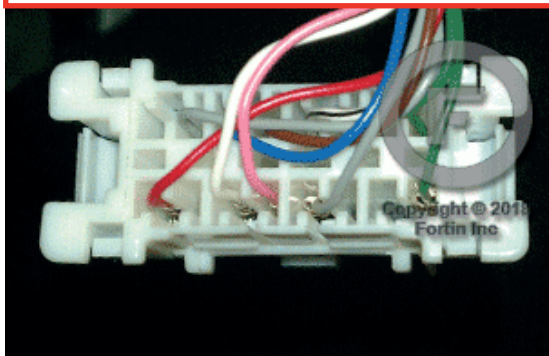

① Ignition Harness

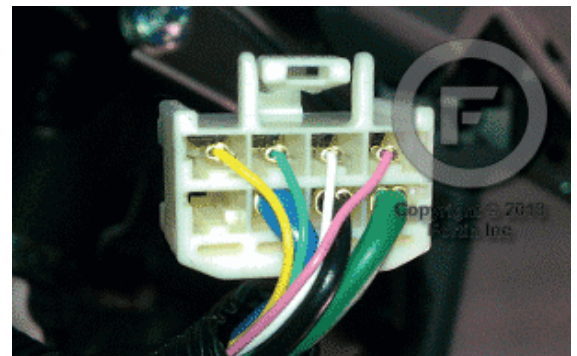
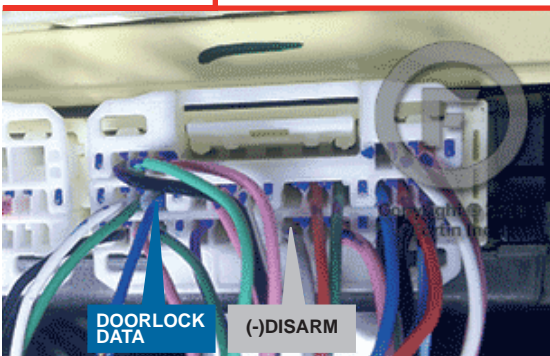
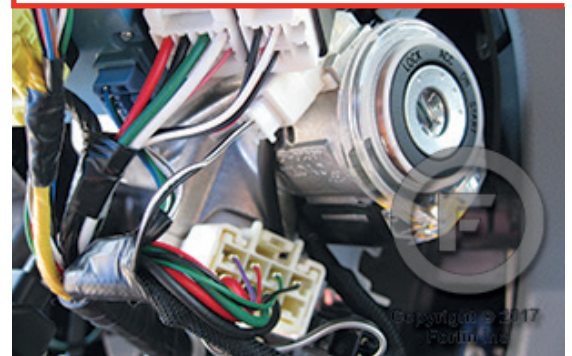

Camry

WIRING CONNECTION |

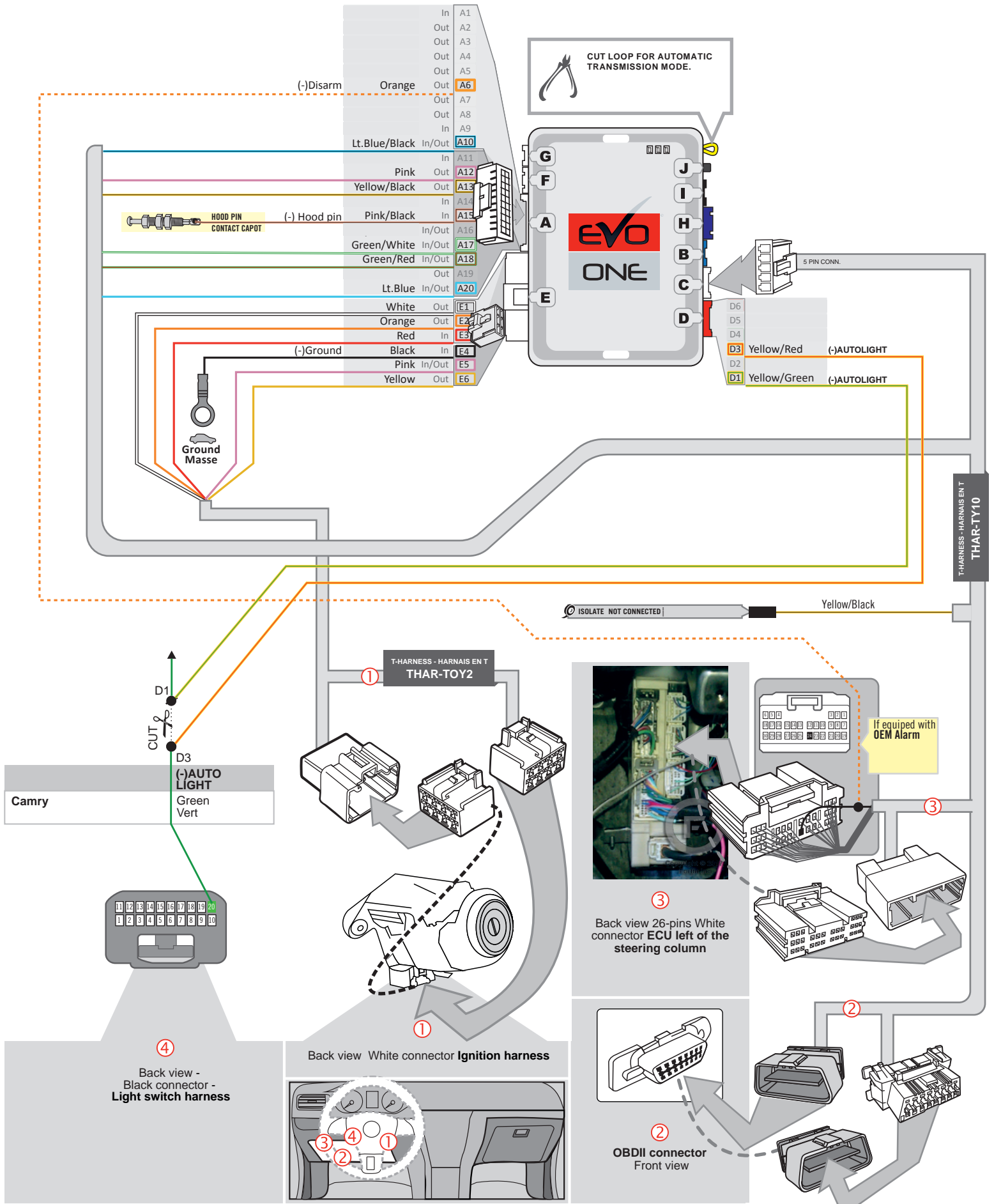

CUT LOOP FOR AUTOMATIC TRANSMISSION MODE.

HOOD PIN CONTACT CAPOT

Ground Masse

ISOLATE NOT CONNECTED

T-HARNESS - HARNAIS EN T THAR-TY10

T-HARNESS - HARNAIS EN T THAR-TOY2

If equipped with OEM Alarm

Camry



Back view - Black connector - Light switch harness

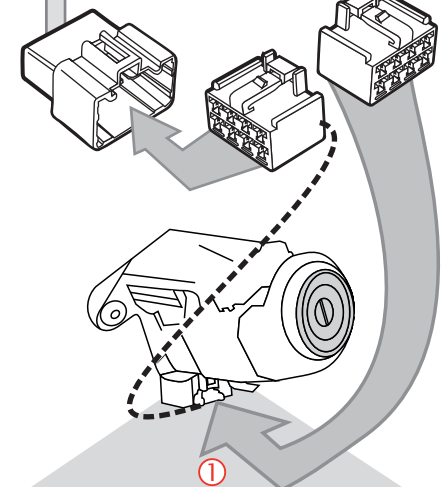

Back view White connector Ignition harness

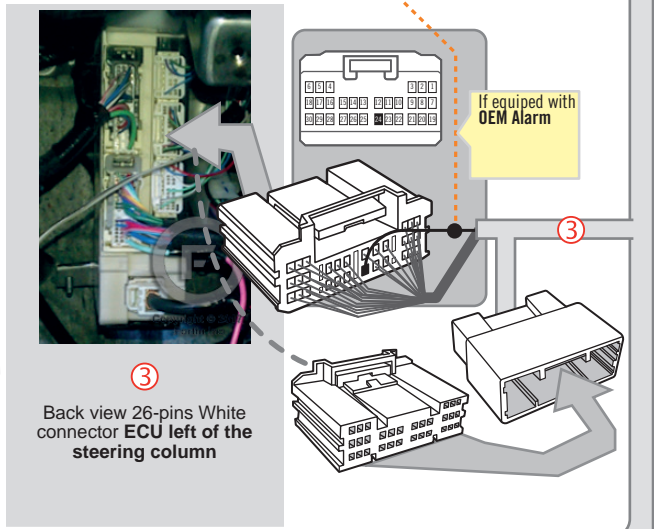
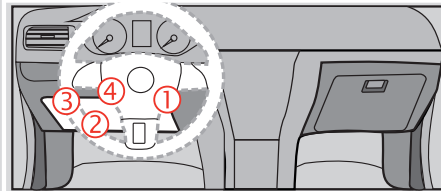

Back view 26-pins White connector ECU left of the steering column

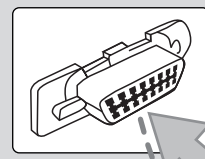

OBDII connector Front view

KEY BYPASS PROGRAMMING PROCEDURE |



Do not use the grey key.



1

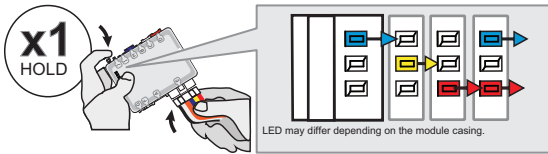

Press and hold the programming button:
Insert the 6-Pin Main connector.

↳ The LED will alternate between BLUE, YELLOW, RED, BLUE, YELLOW and RED flashes.

2

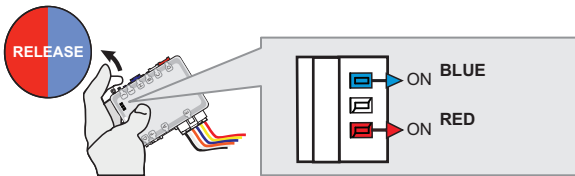

Release the programming button when the LED are BLUE & RED.

If the LED are not solid BLUE and RED **disconnect** the 6-Pin connector (Main-Harness) and go back to step 1.

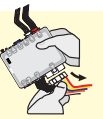

3

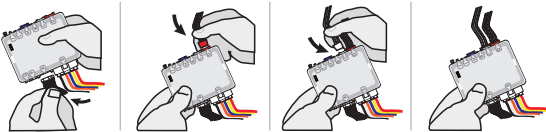

Insert the required remaining connectors.

4

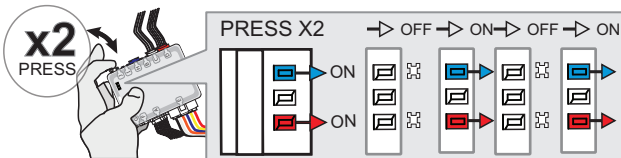

Press and release the programming button twice (2x).

↳ The RED and BLUE LED will flash.

5

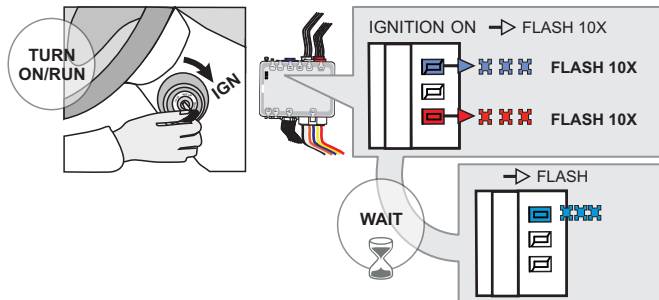

Turn the Ignition to the ON/RUN position.

↳ The RED and BLUE LEDs will flash rapidly 10x times.
 Key bypass programmed.

Wait

↳ The BLUE LED will flash rapidly.
 CAN-Bus programmed.

6

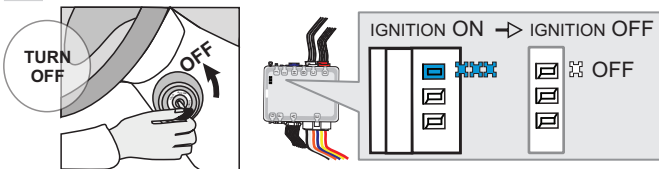

Turn the Ignition to the OFF position.

↳ The BLUE LED will turn off.



The module is now programmed.

Use the remote of the remote starter or security system to test all of the supported features to ensure proper programming.

REMOTE STARTER PROGRAMMING PROCEDURE |



REFER TO THE **QUICK INSTALL GUIDE** INCLUDED WITH THE MODULE FOR THE REMOTE STARTER PROGRAMMING.

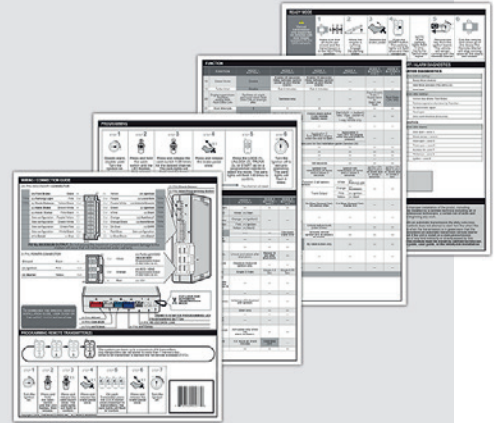

REMOTE STARTER FUNCTIONNALITY



All doors must be closed.



Remote start the vehicle.



Unlock the doors with the remote-starter remote or the OEM remote.



Insert and Turn the key to the Ignition ON/RUN position.



Press the brake pedal.



The vehicle can now be put in to gear and driven.

THAR-ONE-TOY4 THARNES INSTALLATION

ADDENDUM - SUGGESTED WIRING CONFIGURATION

| VEHICLE | YEARS | Vehicle functions supported in this diagram (functional if equipped) | | | | | | | | | | | | | | |
|---------------|-----------------|--|------|--------|-----|--------|----------------|------------|---------------|-------------|--------------|-------------------|--------------|-------------------|-----------------------|--|
| | | Transponder Bypass | Lock | Unlock | Arm | Disarm | Parking Lights | Tachometer | Autolight Off | Door Status | Trunk Status | Hand-Brake Status | Hood Status* | Foot-Brake Status | OEM remote Monitoring | R.S. OEM remote Stand Alone compatible |
| TOYOTA | | | | | | | | | | | | | | | | |
| Camry | H-KEY 2015-2017 | • | • | • | • | • | • | • | • | • | • | • | • | • | • | • |

BYPASS FIRMWARE VERSION

79.[48]
MINIMUM

To add the firmware version and the options, use the **FLASH LINK UPDATER** or **FLASH LINK MOBILE** tool, sold separately.

Program bypass option:
UNIT OPTION
DESCRIPTION

C1

OEM Remote status (Lock/Unlock) monitoring

D5

Lock after start

IF THE VEHICLE IS NOT EQUIPPED WITH FUNCTIONAL HOOD PIN:

A11

OFF

Hood trigger (Output Status).

Program remote starter option:
FUNCTION
MODE
DESCRIPTION

2

4

(+) Start 2 (E1)

(+) Ignition 2 (E2)

Program remote starter option for R.S. OEM REMOTE STAND ALONE:

38

2

Enable Press 3x Lock to remote start with the OEM remote.

MANDATORY INSTALL
*** HOOD PIN**

HOOD STATUS: THE HOOD PIN SWITCH (INCLUDED) MUST BE INSTALLED IF THE VEHICLE CAN BE REMOTE STARTED WITH THE HOOD OPEN, SET FUNCTION A11 TO OFF.

A11

OFF

NON

SECURITY STICKER



Included

Notice: the installation of safety elements are mandatory. The hood pin and the sticker are essential security elements and must be installed.

THIS MODULE MUST BE INSTALLED BY A QUALIFIED TECHNICIAN. A WRONG CONNECTION CAN CAUSE PERMANENT DAMAGE TO THE VEHICLE.

DESCRIPTION |

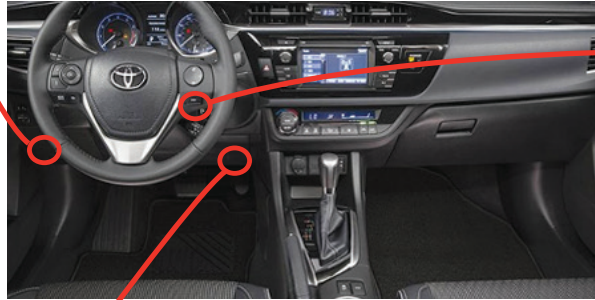
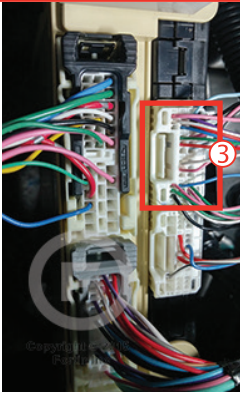
③ At BCM



① Ignition switch



② OBD-II connector

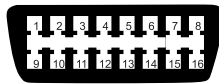

WIRING CONNECTION

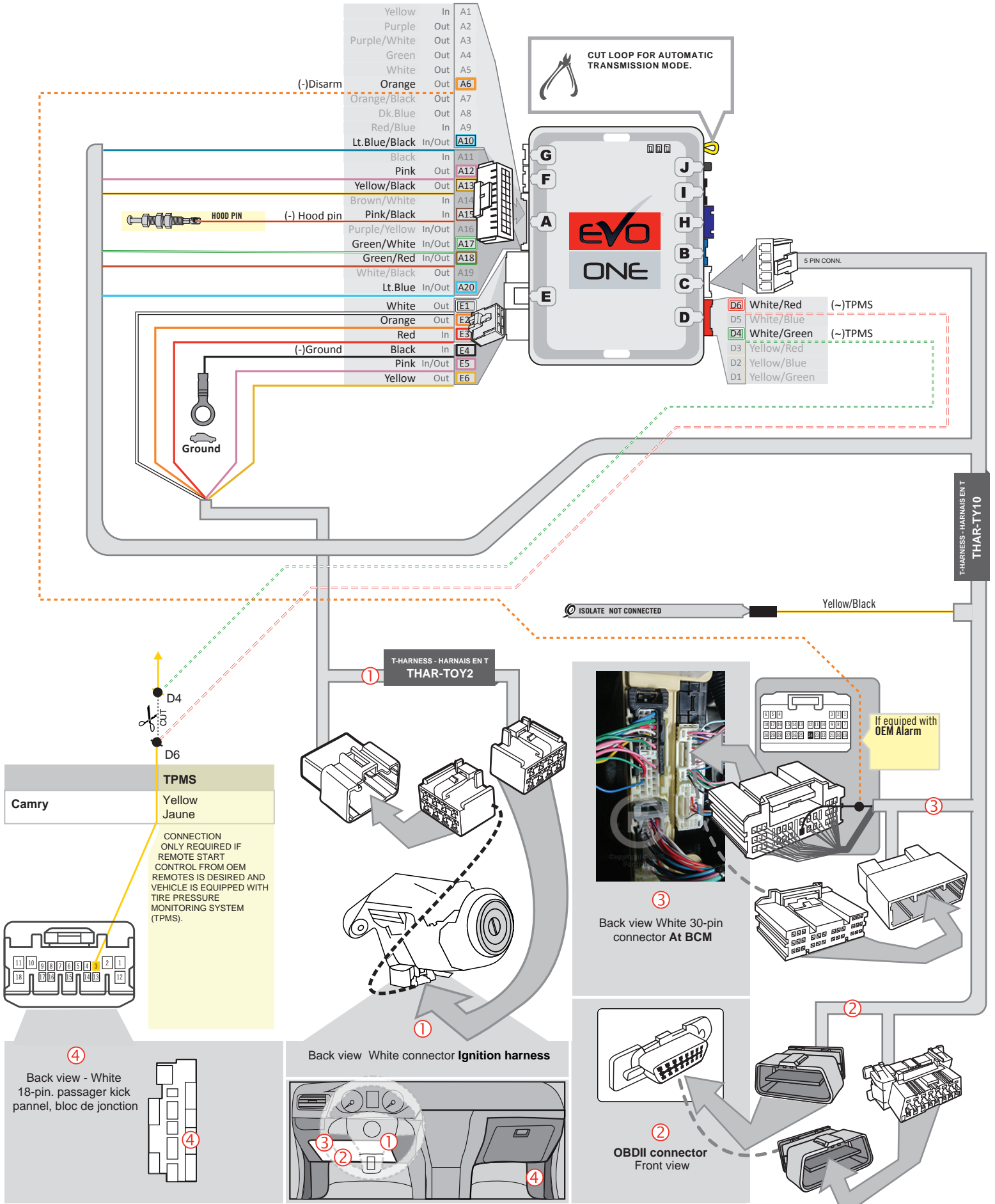

KEY BYPASS PROGRAMMING PROCEDURE



Do not use the grey key.



1

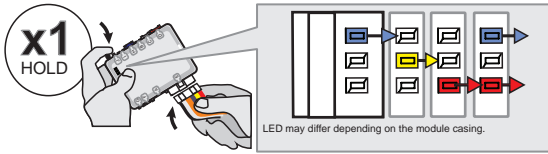

Press and hold the programming button:
Insert the 6-Pin Main connector.

↳ The LEDs will alternate between BLUE, RED, YELLOW & BLUE/RED flashes.

2

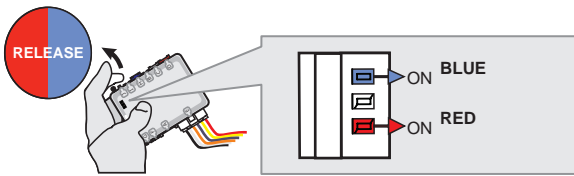

Release the programming button when the LED's are RED and BLUE.

If the LED's are not solid BLUE and RED disconnect the 6-Pin connector (Main-Harness) and go back to step 1.



3

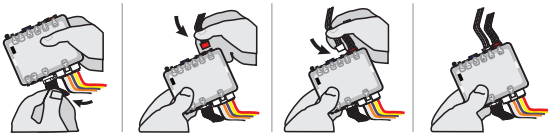

Insert the required remaining connectors.

4

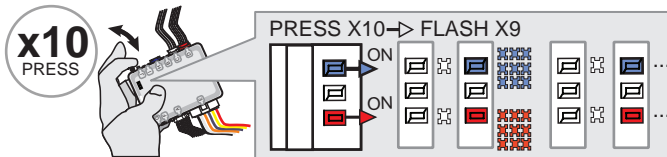

Press and release the programming button ten (10x) times.

↳ The RED and BLUE LED's will alternate between 9 flashes and a pause.

5

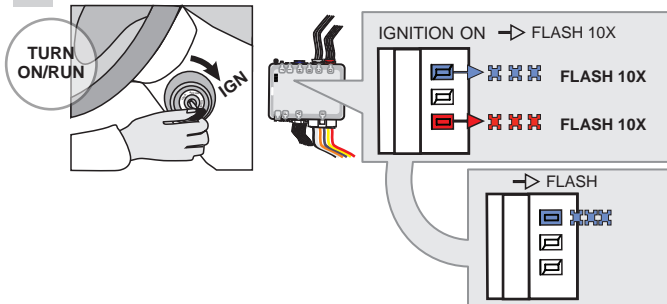

Turn the Ignition to the ON/RUN position.

↳ The RED and BLUE LED's will flash rapidly 10x times. Key bypass programmed.

↳ The BLUE LED will flash rapidly. CAN-Bus programmed.

6

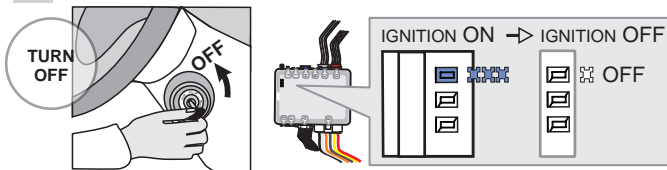

Turn the Ignition to the OFF position.

↳ The BLUE LED will turn off.



The module is now programmed.

Use the remote of the remote starter or security system to test all of the supported features to ensure proper programming.

REMOTE STARTER PROGRAMMING PROCEDURE



REFER TO THE **QUICK INSTALL GUIDE** INCLUDED WITH THE MODULE FOR THE REMOTE STARTER PROGRAMMING.

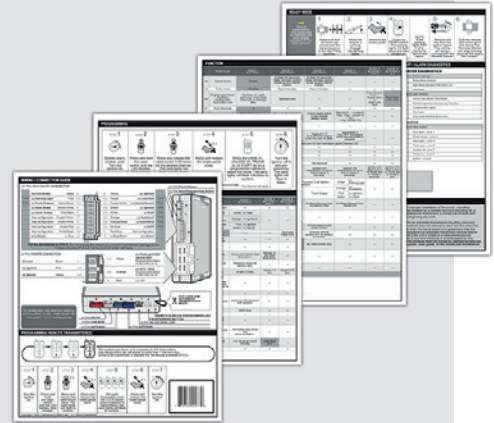

REMOTE STARTER FUNCTIONALITY



All doors must be closed.



Remote start the vehicle.



Unlock the doors with the remote-starter remote or the OEM remote.

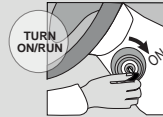

Insert and Turn the key to the Ignition ON/RUN position.



Press the brake pedal.



The vehicle can now be put in to gear and driven.

THAR-ONE-TOY4 THARNSS INSTALLATION

ADDENDUM - SUGGESTED WIRING CONFIGURATION

| VEHICLE | YEARS | Vehicle functions supported in this diagram (functional if equipped) | | | | | | | | | | | | | | |
|---------------|----------------|--|---------------------------|------|--------|-----|--------|--------------|------------|-------------|--------------|-------------|-------------------|-------------------|--------------------|---|
| | | Immobilizer bypass | T-Harness Harnais en T | Lock | Unlock | Arm | Disarm | Trunk (open) | Tachometer | Door Status | Trunk Status | Hood Status | Hand-Brake Status | Foot-Brake Status | Auto-light Control | |
| TOYOTA | | | | | | | | | | | | | | | | |
| Prius C | G-Key (80-BIT) | 2012-2014 | • | • | • | • | • | • | • | • | • | • | • | • | • | • |

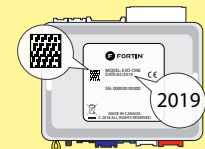

80-bit
This guide is for vehicles having keys stamped with a **G** on the shaft.
Ce guide est pour l

| | | | | |
|---|------------------------------------|---|--|---|
|  | COMPATIBLE MODULE REQUIRED: | QR CODE ON THE LABEL MANUFACTURED AFTER: 2019 | FIRMWARE VERSION | To add the firmware version and the options, use the FLASH LINK UPDATER or FLASH LINK MOBILE tool, sold separately. |
| | | | 79.[59] TOYOTA/LEXUS MINIMUM | |

|  | Program remote starter option: | FUNCTION | MODE | DESCRIPTION |
|--|--------------------------------|----------|----------|------------------|
| | | 2 | 4 | (+) Start 2 (E1) |

| | | | |
|---|------------|------------|-------------------------------|
| IF THE VEHICLE IS NOT EQUIPPED WITH FUNCTIONAL HOOD PIN: | A11 | OFF | Hood trigger (Output Status). |
|---|------------|------------|-------------------------------|

MANDATORY INSTALL

* **HOOD PIN**  **HOOD STATUS**: THE HOOD PIN SWITCH (INCLUDED) MUST BE INSTALLED IF THE VEHICLE CAN BE REMOTE STARTED WITH THE HOOD OPEN, SET FUNCTION **A11** TO OFF.

SECURITY STICKER  Included

Notice: the installation of safety elements are mandatory. The hood pin and the sticker are essential security elements and must be installed.

THIS MODULE MUST BE INSTALLED BY A QUALIFIED TECHNICIAN. A WRONG CONNECTION CAN CAUSE PERMANENT DAMAGE TO THE VEHICLE.

DESCRIPTION



③ ECU

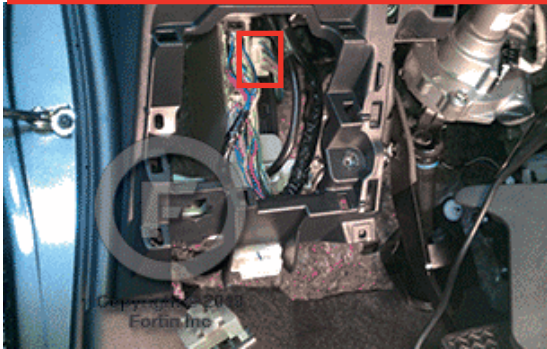

① Ignition Harness

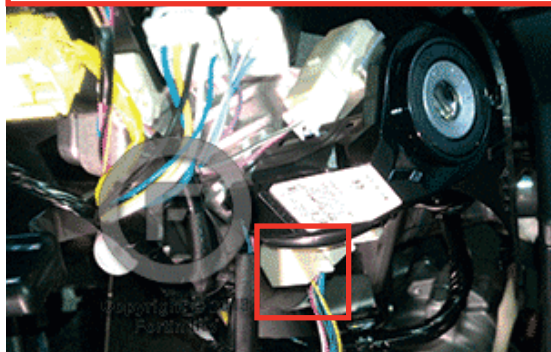

WIRING CONNECTION

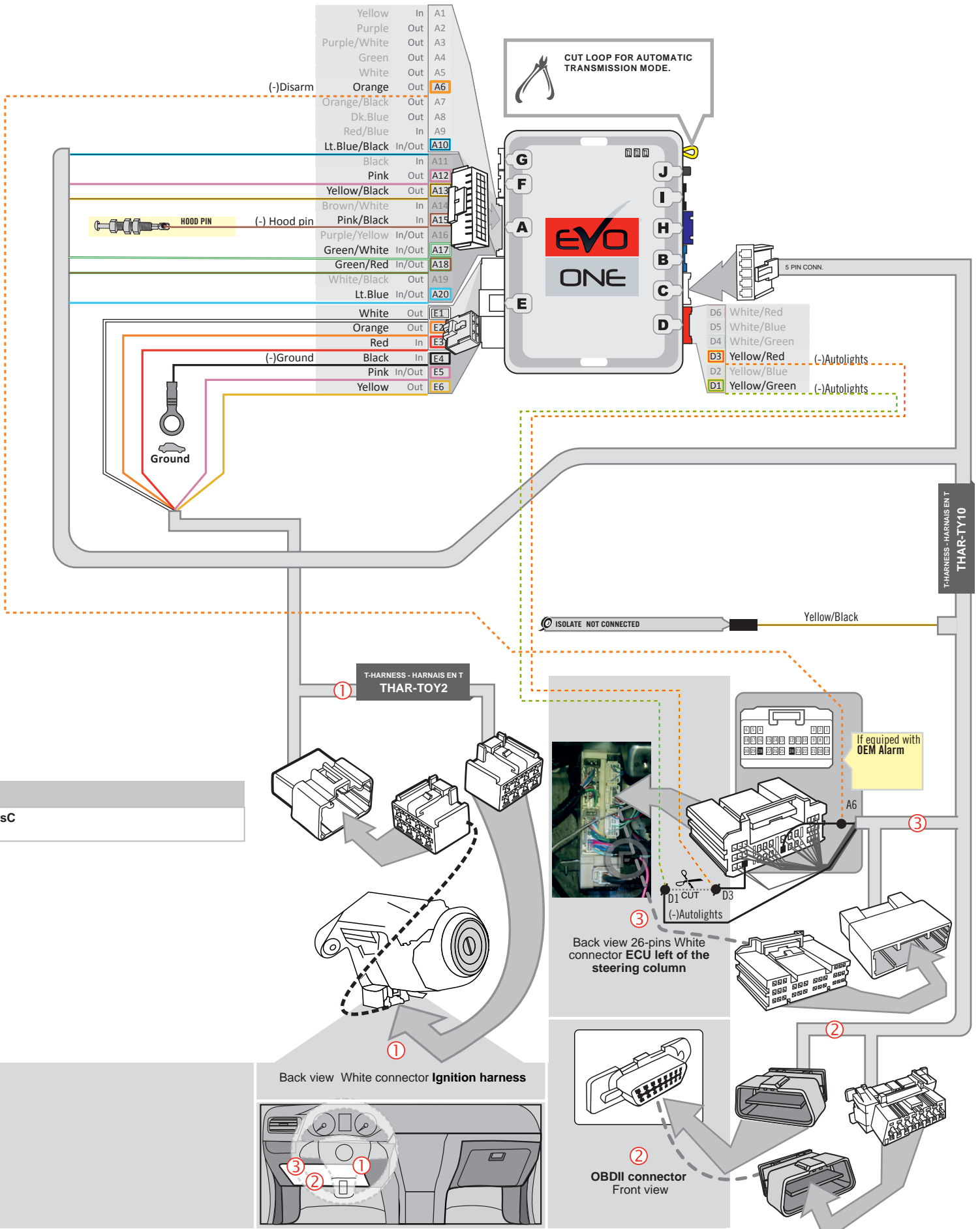

KEY BYPASS PROGRAMMING PROCEDURE



Do not use the grey key.



1

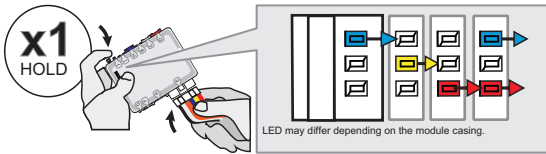

Press and hold the programming button:
Insert the 6-Pin Main connector.

↳ The LED will alternate between BLUE, YELLOW, RED, BLUE, YELLOW and RED flashes.

2

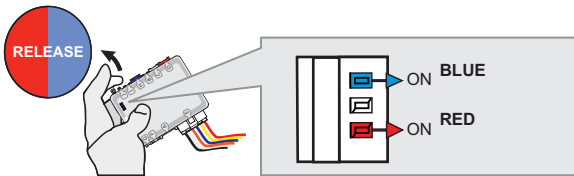

Release the programming button when the LED are BLUE & RED.

If the LED are not solid BLUE and RED **disconnect the 6-Pin connector (Main-Harness)** and go back to step 1.

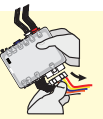

3

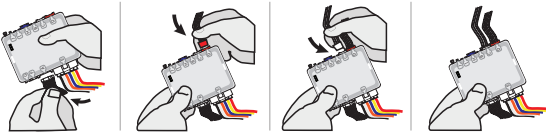

Insert the required remaining connectors.

4

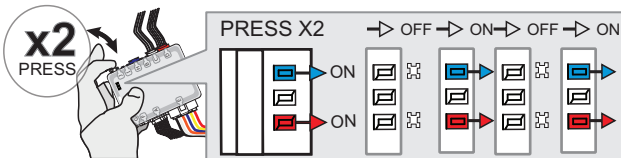

Press and release the programming button twice (2x).

↳ The RED and BLUE LED will flash.

5

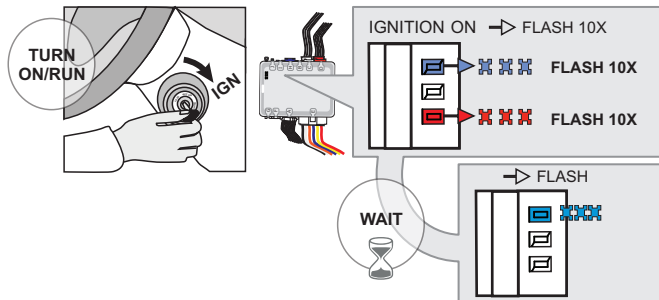

Turn the Ignition to the ON/RUN position.

↳ The RED and BLUE LEDs will flash rapidly 10x times.
 Key bypass programmed.

Wait

↳ The BLUE LED will flash rapidly.
 CAN-Bus programmed.

6

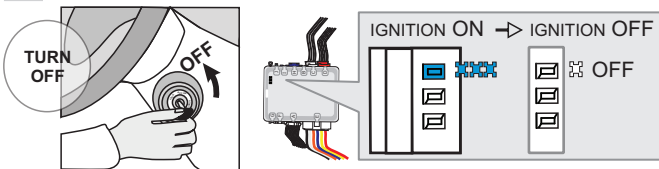

Turn the Ignition to the OFF position.

↳ The BLUE LED will turn off.



The module is now programmed.

Use the remote of the remote starter or security system to test all of the supported features to ensure proper programming.



REFER TO THE **QUICK INSTALL GUIDE** INCLUDED WITH THE MODULE FOR THE REMOTE STARTER PROGRAMMING.

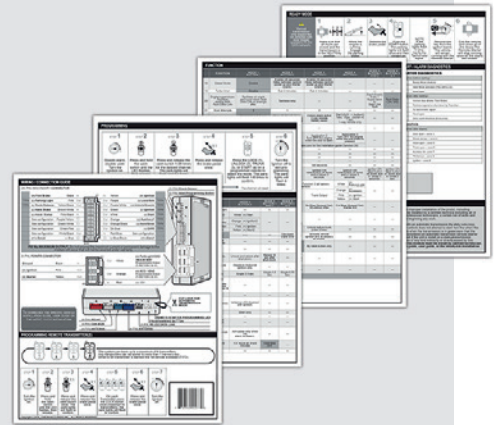

REMOTE STARTER FUNCTIONNALITY



All doors must be closed.



Remote start the vehicle.



Unlock the doors with the remote-starter remote or the OEM remote.

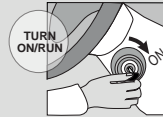

Insert and Turn the key to the Ignition ON/RUN position.



Press the brake pedal.



The vehicle can now be put in to gear and driven.

THAR-ONE-TOY4 THARNES INSTALLATION

ADDENDUM - SUGGESTED WIRING CONFIGURATION

| VEHICLE | YEARS | Vehicle functions supported in this diagram (functional if equipped) | | | | | | | | | | | | | | | | |
|---------------|------------------------|--|--|------|--------|-----|--------|------|------------|---------------|----------------|-------------|--------------|-------------------|-------------------|-----------------------|--|---|
| | | Transponder Bypass | T-Harness available (sold separately) Harnais en T disponible (vendu séparément) | Lock | Unlock | Arm | Disarm | Horn | Tachometer | Autolight Off | Parking Lights | Door Status | Trunk Status | Hand-Brake Status | Foot-Brake Status | OEM remote Monitoring | R.S. OEM remote Stand Alone compatible | |
| TOYOTA | | | | | | | | | | | | | | | | | | |
| Prius C | Hybrid H-KEY 2015-2016 | • | • | • | • | • | • | • | • | • | • | • | • | • | • | • | • | • |

BYPASS FIRMWARE VERSION

79.[59]

TOYOTA/LEXUS/SUBARU MINIMUM

To add the firmware version and the options, use the **FLASH LINK UPDATER** or **FLASH LINK MOBILE** tool, sold separately.

| | Program bypass option: | UNIT OPTION | DESCRIPTION |
|--|------------------------|-------------|--|
| | | C1 | OEM Remote status (Lock/Unlock) monitoring |
| | | D5 | Lock after start |
| | | D4 | Hybrid mode (Vehicle hybrid only) |
| IF THE VEHICLE IS NOT EQUIPPED WITH FUNCTIONAL HOOD PIN: | | A11 | OFF |
| | | | Hood trigger (Output Status). |

| | FUNCTION | MODE | DESCRIPTION |
|---|-----------|----------|---|
| | 2 | 4 | (+) Start 2 (E1) (+) Ignition 2 (E2) |
| Program remote starter option for R.S. OEM REMOTE STAND ALONE: | 38 | 2 | Enable Press 3x Lock to remote start with the OEM remote. |

MANDATORY INSTALL
*** HOOD PIN**

HOOD STATUS : THE HOOD PIN SWITCH (INCLUDED) MUST BE INSTALLED IF THE VEHICLE CAN BE REMOTE STARTED WITH THE HOOD OPEN, SET FUNCTION A11 TO OFF.

A11
OFF
SECURITY STICKER

Included

Notice: the installation of safety elements are mandatory. The hood pin and the sticker are essential security elements and must be installed.

THIS MODULE MUST BE INSTALLED BY A QUALIFIED TECHNICIAN. A WRONG CONNECTION CAN CAUSE PERMANENT DAMAGE TO THE VEHICLE.

DESCRIPTION



① Ignition switch
Commutateur d'ignition

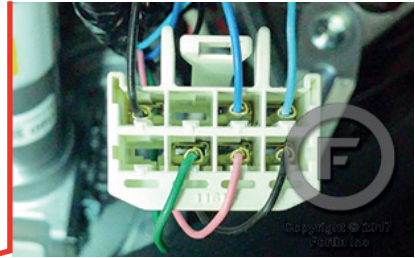
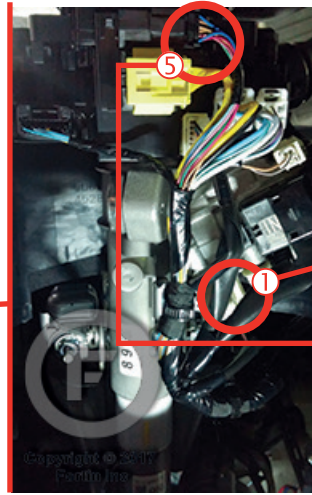

⑤ Under steering column

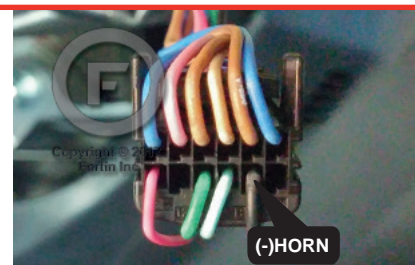

② OBD-II connector

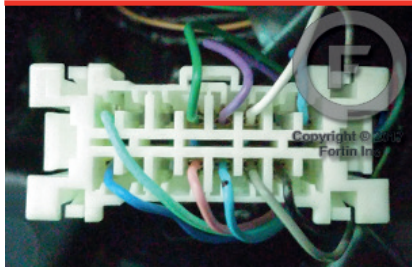

At BCM

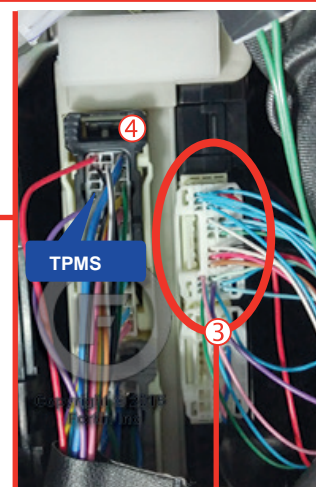
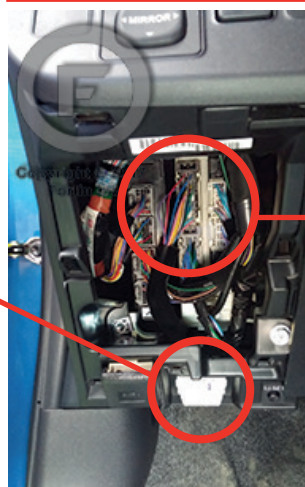

③



WIRING CONNECTION

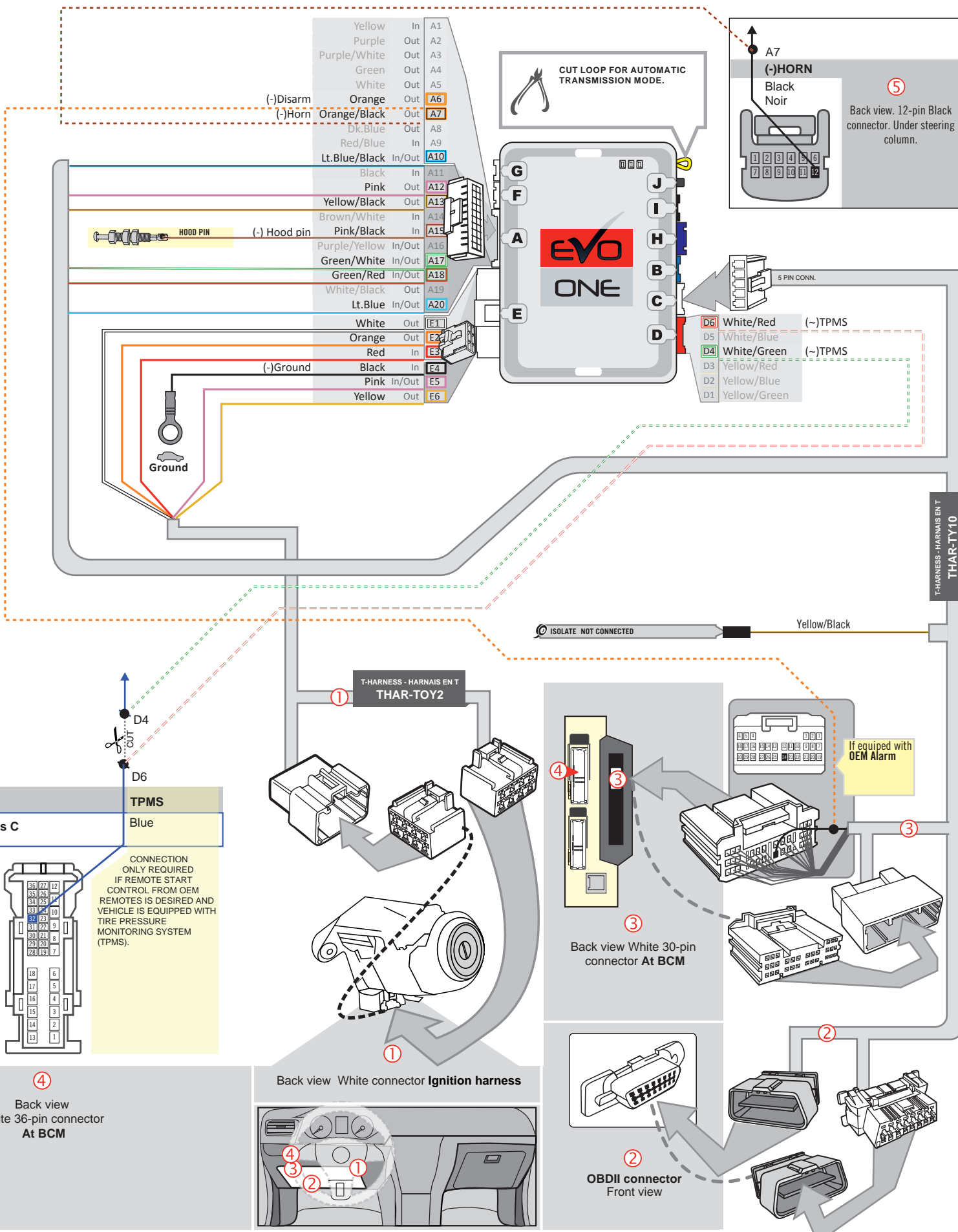

KEY BYPASS PROGRAMMING PROCEDURE



Do not use the grey key.



1

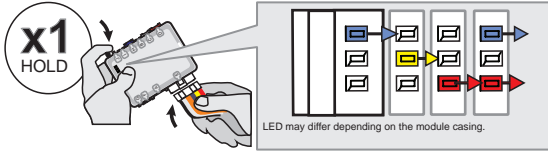

Press and hold the programming button:
Insert the 6-Pin Main connector.

↳ The LEDs will alternate between BLUE, RED, YELLOW & BLUE/RED flashes.

2



Release the programming button when the LED's are RED and BLUE.

If the LED's are not solid BLUE and RED **disconnect** the 6-Pin connector (Main-Harness) and go back to step 1.



3

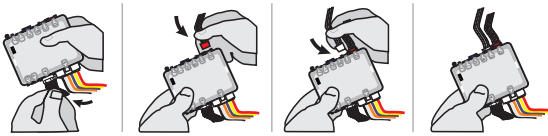

Insert the required remaining connectors.

4

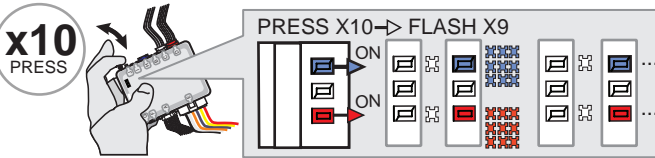

Press and release the programming button ten (10x) times.

↳ The RED and BLUE LED's will alternate between 9 flashes and a pause.

5

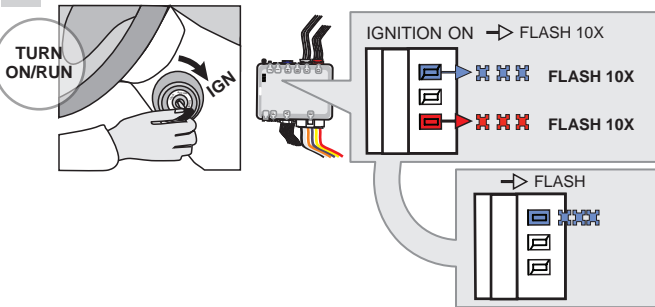

Turn the Ignition to the ON/RUN position.

↳ The RED and BLUE LED's will flash rapidly 10x times. Key bypass programmed.

↳ The BLUE LED will flash rapidly. CAN-Bus programmed.

6

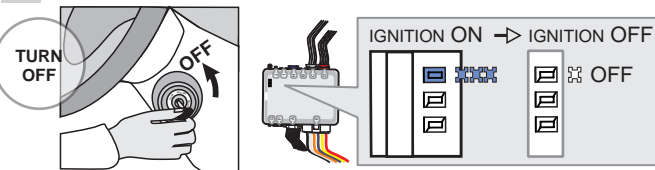

Turn the Ignition to the OFF position.

↳ The BLUE LED will turn off.



The module is now programmed.

Use the remote of the remote starter or security system to test all of the supported features to ensure proper programming.

REMOTE STARTER PROGRAMMING PROCEDURE



REFER TO THE **QUICK INSTALL GUIDE** INCLUDED WITH THE MODULE FOR THE REMOTE STARTER PROGRAMMING.

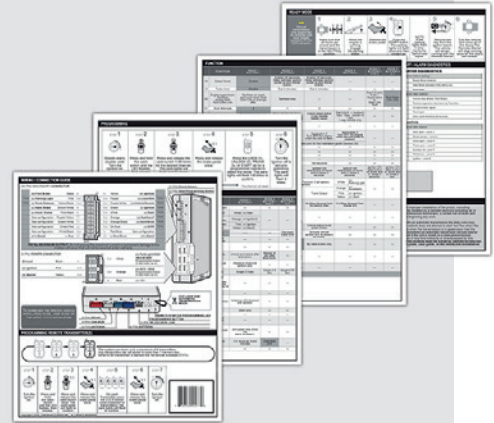

REMOTE STARTER FUNCTIONALITY



All doors must be closed.



Remote start the vehicle.



Unlock the doors with the remote-starter remote or the OEM remote.

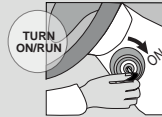

Insert and Turn the key to the Ignition ON/RUN position.



Press the brake pedal.





The vehicle can now be put in to gear and driven.

THAR-ONE-TOY4 THARNSS INSTALLATION

ADDENDUM - SUGGESTED WIRING CONFIGURATION

Vehicle functions supported in this diagram (functional if equipped)

| VEHICLE | YEARS | Transponder Bypass | T-Harness | Lock | Unlock | Arm | Disarm | Tachometer | Parking Lights | Autolight Off | Door Status | Trunk Status | Hand-Brake Status | Foot-Brake Status | OEM remote Monitoring | R.S. OEM remote Stand Alone compatible |
|---|-------|--------------------|-----------|------|--------|-----|--------|------------|----------------|---------------|-------------|--------------|-------------------|-------------------|-----------------------|--|
|  | | | | | | | | | | | | | | | | |
| TOYOTA | | | | | | | | | | | | | | | | |
| Yaris | H-KEY | 2015-2019 | • | • | • | • | • | • | • | • | • | • | • | • | • | • |

| | | | | |
|---|------------------------------------|--|---|---|
|  | COMPATIBLE MODULE REQUIRED: | QR CODE ON THE LABEL MANUFACTURED AFTER: 2019 | FIRMWARE VERSION 79.[59] TOYOTA/LEXUS MINIMUM | To add the firmware version and the options, use the FLASH LINK UPDATER or FLASH LINK MOBILE tool, sold separately. |
|---|------------------------------------|--|---|---|

|  | Program bypass option IF THE VEHICLE IS NOT EQUIPPED WITH FUNCTIONAL HOOD PIN: | UNIT OPTION | | DESCRIPTION |
|---|---|-------------|------------|-------------------------------|
| | | A11 | OFF | Hood trigger (Output Status). |

|  | Program bypass option: | UNIT OPTION | | DESCRIPTION |
|---|-------------------------------|-------------|--|--|
| | | C1 | | OEM Remote status (Lock/Unlock) monitoring |
| | | D5 | | Lock after start |

|  | Program remote starter option: | FUNCTION | MODE | DESCRIPTION |
|---|---------------------------------------|----------|----------|---------------------|
| | | 2 | 4 | (+) Start 2 (E1) |
| | | | | (+) Ignition 2 (E2) |

|  | Program remote starter option for R.S. OEM REMOTE STAND ALONE: | FUNCTION | MODE | DESCRIPTION |
|---|---|-----------|----------|---|
| | | 38 | 2 | Enable Press 3x Lock to remote start with the OEM remote. |

| | | | | | | |
|--------------------------|--|--|-----------------------|---|---|---|
| MANDATORY INSTALL | * HOOD PIN  | HOOD STATUS: THE HOOD PIN SWITCH (INCLUDED) MUST BE INSTALLED IF THE VEHICLE CAN BE REMOTE STARTED WITH THE HOOD OPEN, SET FUNCTION A11 TO OFF. | A11 OFF | SECURITY STICKER  Included | Notice: the installation of safety elements are mandatory. The hood pin and the sticker are essential security elements and must be installed. | THIS MODULE MUST BE INSTALLED BY A QUALIFIED TECHNICIAN. A WRONG CONNECTION CAN CAUSE PERMANENT DAMAGE TO THE VEHICLE. |
|--------------------------|--|--|-----------------------|---|---|---|

DESCRIPTION

④ ③ At BCM

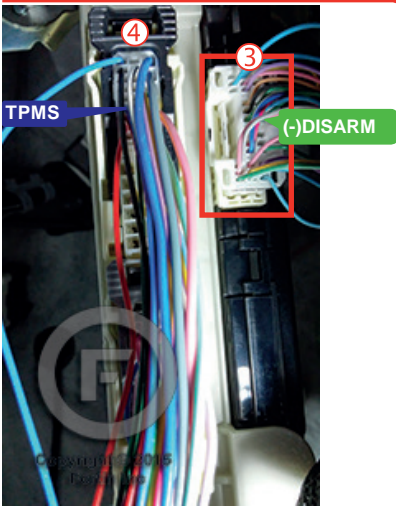

② OBD-II connector

① Ignition switch

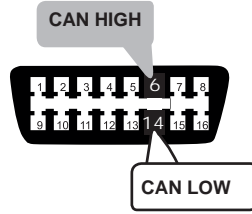
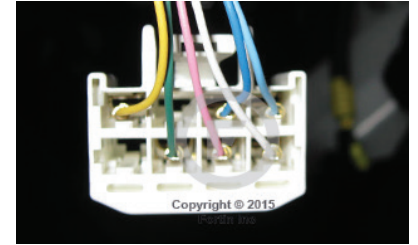

TPMS

CONNECTION ONLY REQUIRED IF REMOTE START CONTROL FROM OEM REMOTES IS DESIRED AND VEHICLE IS EQUIPPED WITH TIRE PRESSURE MONITORING SYSTEM (TPMS).

AUTOMATIC TRANSMISSION WIRING CONNECTION

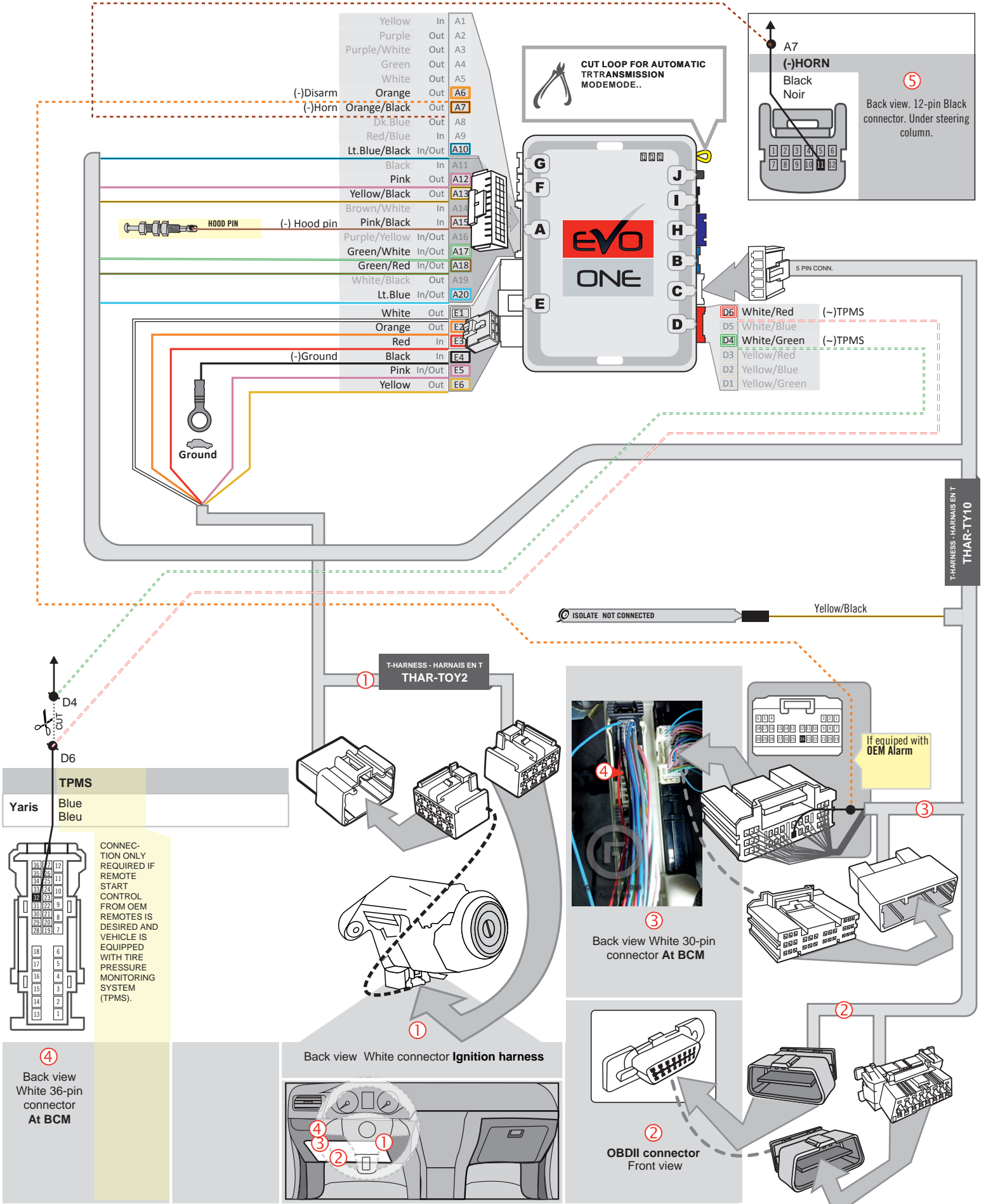

MANUAL TRANSMISSION WIRING CONNECTION

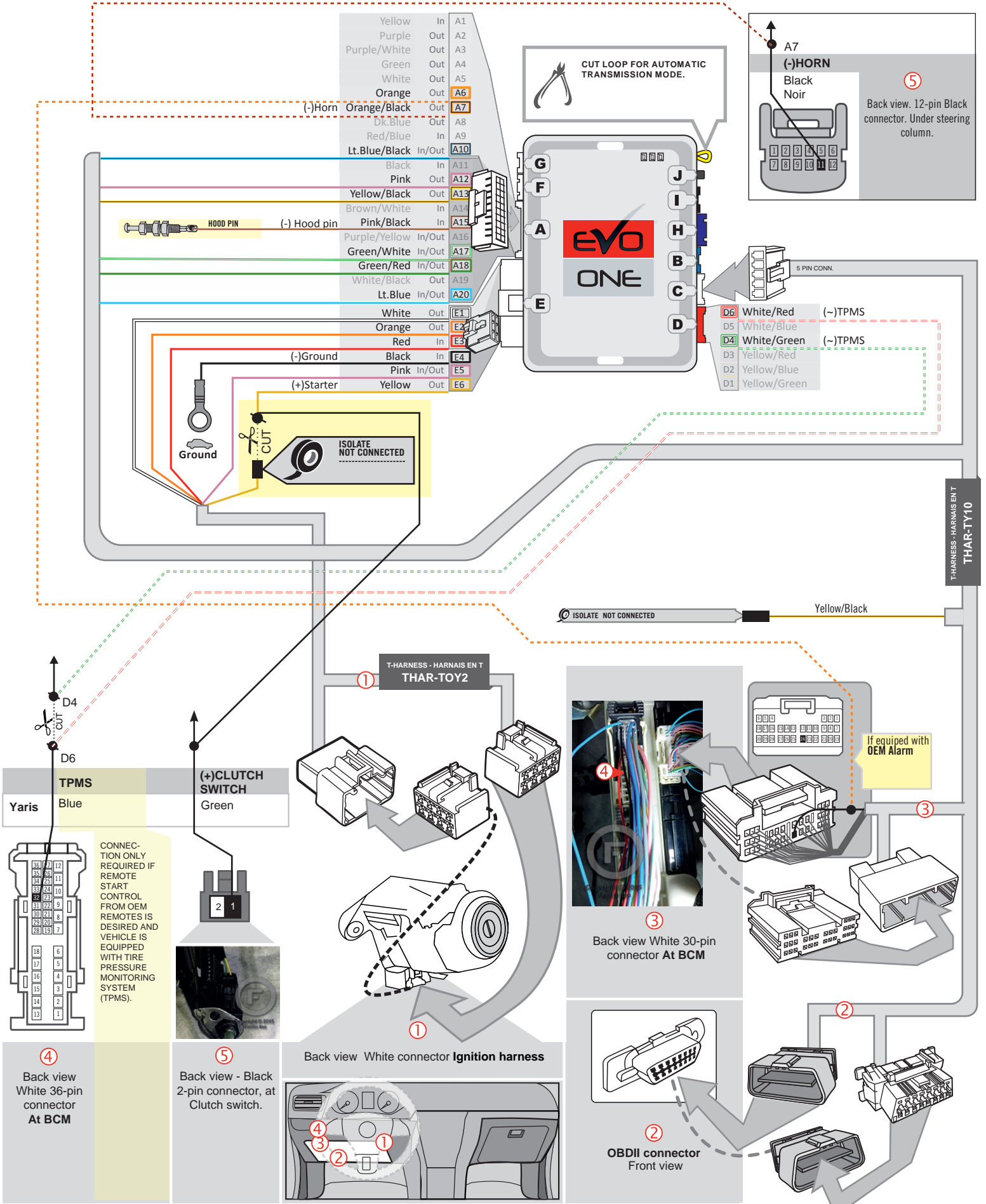

KEY BYPASS PROGRAMMING PROCEDURE



Do not use the grey key.



1

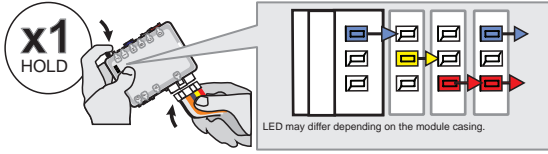

Press and hold the programming button:
Insert the 6-Pin Main connector.

↳ The LEDs will alternate between BLUE, RED, YELLOW & BLUE/RED flashes.

2



Release the programming button when the LED's are RED and BLUE.

If the LED's are not solid BLUE and RED disconnect the 6-Pin connector (Main-Harness) and go back to step 1.

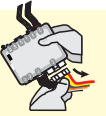

3

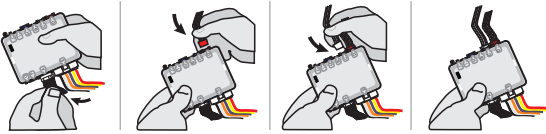

Insert the required remaining connectors.

4

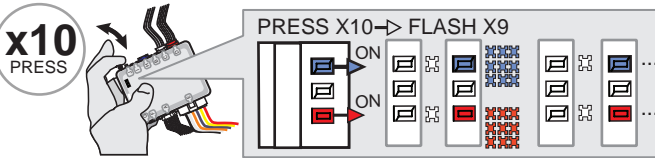

Press and release the programming button ten (10x) times.

↳ The RED and BLUE LED's will alternate between 9 flashes and a pause.

5

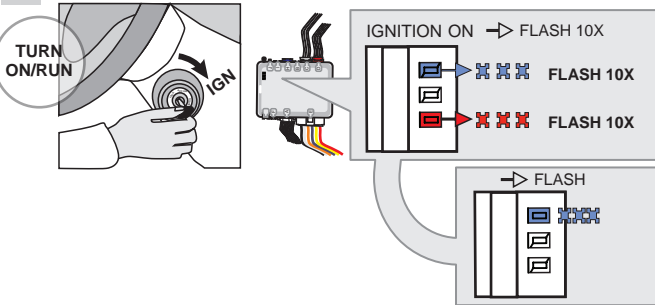

Turn the Ignition to the ON/RUN position.

↳ The RED and BLUE LED's will flash rapidly 10x times. Key bypass programmed.

↳ The BLUE LED will flash rapidly. CAN-Bus programmed.

6

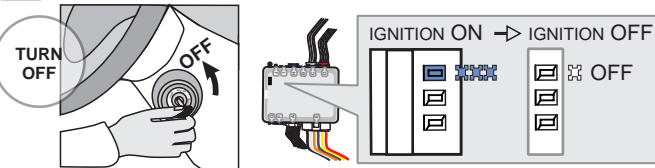

Turn the Ignition to the OFF position.

↳ The BLUE LED will turn off.



The module is now programmed.

Use the remote of the remote starter or security system to test all of the supported features to ensure proper programming.

REMOTE STARTER PROGRAMMING PROCEDURE



REFER TO THE **QUICK INSTALL GUIDE** INCLUDED WITH THE MODULE FOR THE REMOTE STARTER PROGRAMMING.

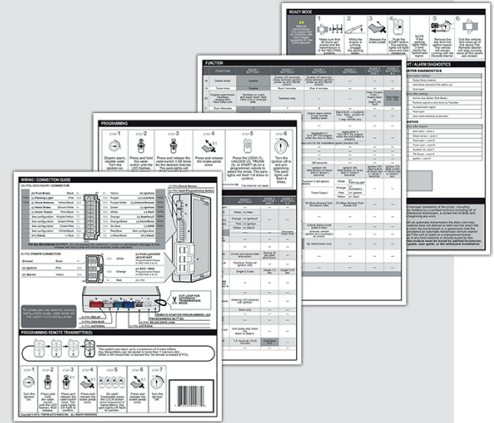

REMOTE STARTER FUNCTIONALITY



All doors must be closed.



Remote start the vehicle.



Unlock the doors with the remote-starter remote or the OEM remote.

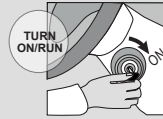

Insert and Turn the key to the Ignition ON/RUN position.



Press the brake pedal.



The vehicle can now be put in to gear and driven.