

# THAR-ONE-TOY10 THARNESS INSTALLATION

ADDENDUM - SUGGESTED WIRING  
CONFIGURATION



VEHICLE

YEARS

Vehicle functions supported in this diagram (functional if equipped) |

TOYOTA

Tundra

2020-2021

Transponder Bypass	T-harness Harnais en T	Lock	Unlock	Arm	Disarm	Parking Lights	Trunk (open)	Tachometer	Autolight Off	Door Status	Trunk Status	Hand-Brake Status	Foot-Brake Status	OEM remote Monitoring	R.S. OEM remote Stand Alone compatible
•	•	•	•	•	•	•	•	•	•	•	•	•	•	•	•

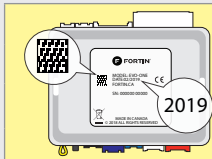

COMPATIBLE  
MODULE  
REQUIRED:

QR CODE ON THE  
LABEL  
MANUFACTURED  
AFTER: 2019  
CODE QR SUR

FIRMWARE VERSION

**79.[66]**  
TOYOTA/  
LEXUS MINIMUM

To add the firmware version and the options, use the  
**FLASH LINK UPDATER** or **FLASH LINK MOBILE** tool,  
sold separately.



Program bypass option:

UNIT OPTION

DESCRIPTION

**C1**

OEM Remote status (Lock/Unlock)  
monitoring

**D5**

Lock after start



Program bypass option  
IF THE VEHICLE IS NOT EQUIPPED  
WITH FUNCTIONAL HOOD PIN:

UNIT OPTION

DESCRIPTION

**A11**

**OFF**

Hood trigger (Output Status).

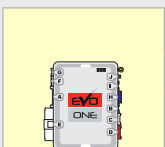

Program remote  
starter option:

FUNCTION

MODE

DESCRIPTION

**2**

**4**

(+) Start 2 (E1)  
(+) Ignition 2 (E2)

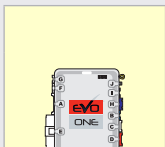

Program remote  
starter option for R.S.  
OEM REMOTE STAND  
ALONE:

FUNCTION

MODE

DESCRIPTION

**38**

**2**

Enable  
Press 3x Lock to remote start with the OEM remote.

## MANDATORY INSTALL I

\* HOOD  
PIN



HOOD STATUS: THE HOOD PIN SWITCH (INCLUDED)  
MUST BE INSTALLED IF THE VEHICLE CAN BE  
REMOTE STARTED WITH THE HOOD OPEN, SET FUNCTION A11 TO OFF.

**A11**

**OFF**

SECURITY STICKER



Included

Notice: the installation of safety  
elements are mandatory. The hood pin  
and the sticker are essential security  
elements and must be installed.

THIS MODULE MUST BE INSTALLED BY A  
QUALIFIED TECHNICIAN. A WRONG  
CONNECTION CAN CAUSE PERMANENT  
DAMAGE TO THE VEHICLE.

DESCRIPTION |

② OBD-II connector

Under steering column

① Ignition connector

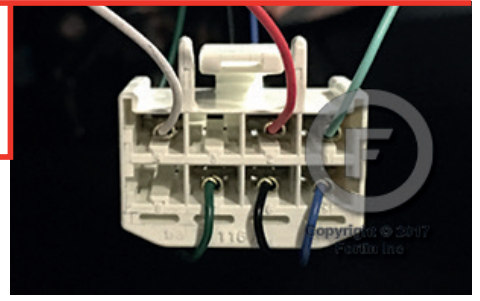
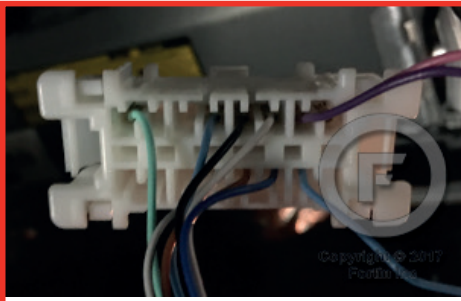

③ BCM

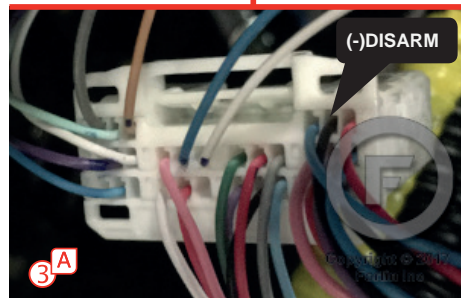
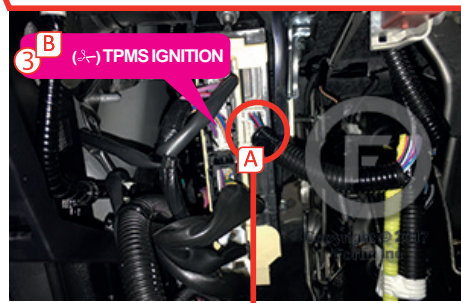

WIRING CONNECTION |

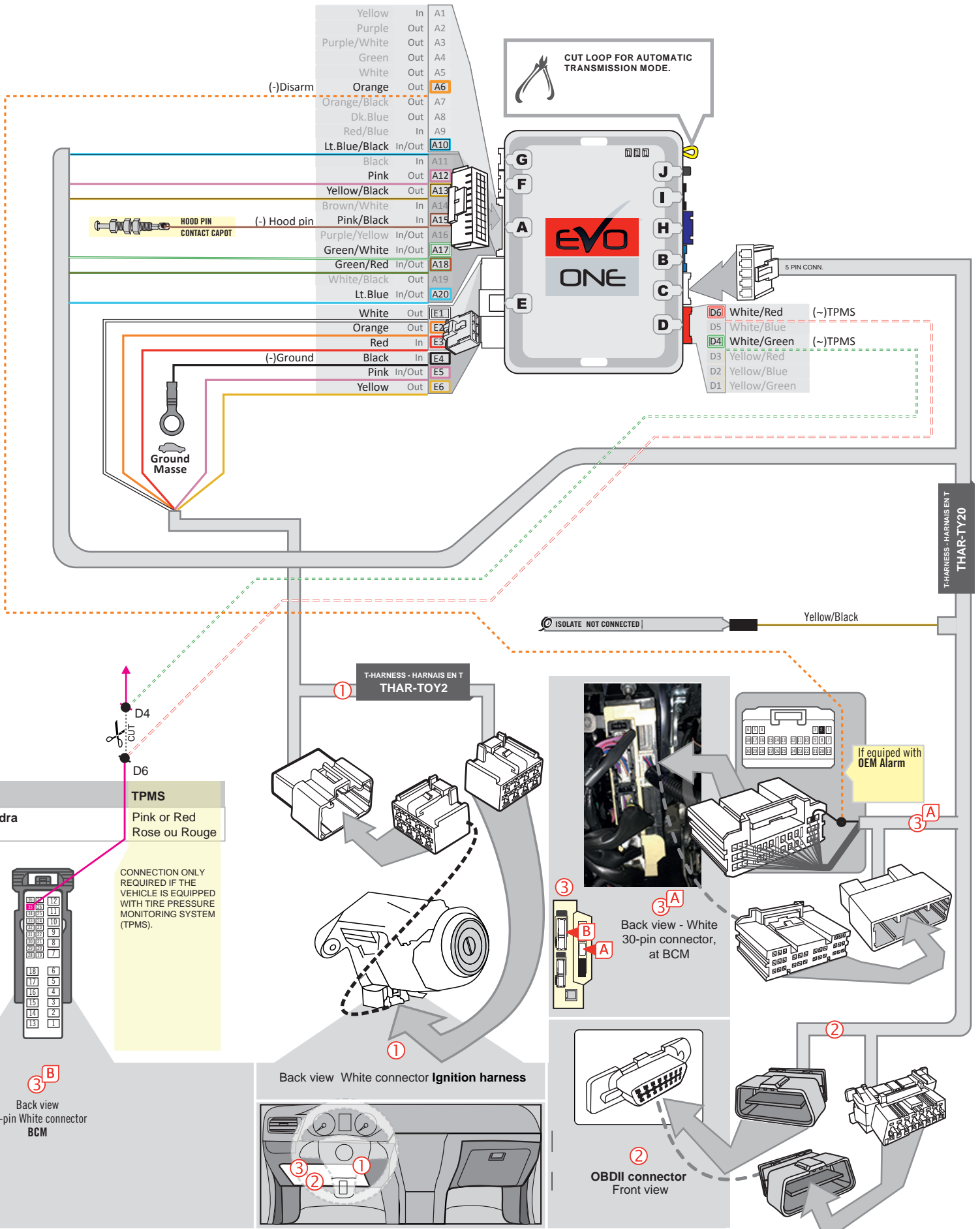

**KEY BYPASS PROGRAMMING PROCEDURE**

1

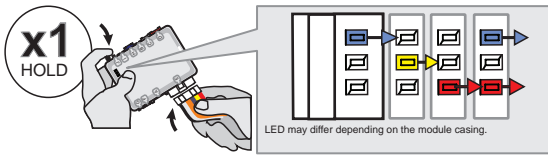

**Press and hold** the programming button:  
**Insert** the 6-Pin Main connector.

↳ *The LEDs will alternate between BLUE, RED, YELLOW & BLUE/RED flashes.*

2



**Release** the programming button when the LED's are RED and BLUE.

*If the LED's are not solid BLUE and RED disconnect the 6-Pin connector (Main-Harness) and go back to step 1.*

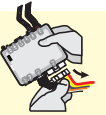

3

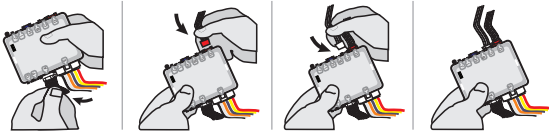

**Insert** the required remaining connectors.

4

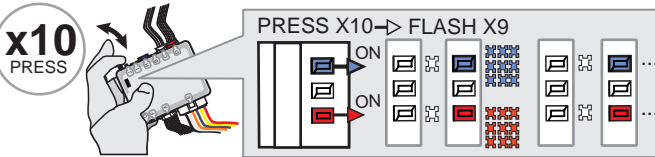

**Press and release** the programming button ten (10x) times.

↳ *The RED and BLUE LED's will alternate between 9 flashes and a pause.*

5

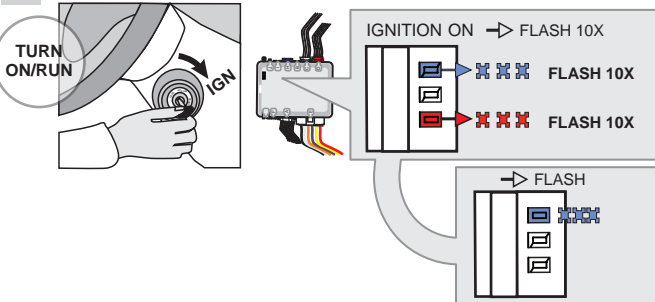

**Turn** the Ignition to the ON/RUN position.

↳ *The RED and BLUE LED's will flash rapidly 10x times. Key bypass programmed.*

↳ *The BLUE LED will flash rapidly. CAN-Bus programmed.*

6

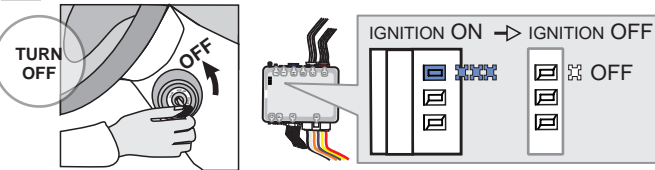

**Turn** the Ignition to the OFF position.

↳ *The BLUE LED will turn off.*



**The module is now programmed.**

Use the remote of the remote starter or security system to test all of the supported features to ensure proper programming.

REMOTE STARTER PROGRAMMING PROCEDURE



REFER TO THE **QUICK INSTALL GUIDE** INCLUDED WITH THE MODULE FOR THE REMOTE STARTER PROGRAMMING.

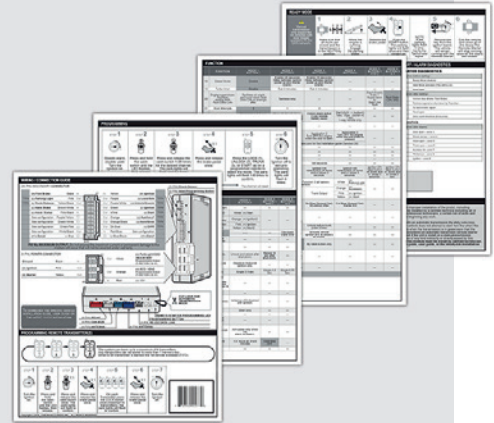

REMOTE STARTER FUNCTIONALITY



All doors must be closed.



Remote start the vehicle.



Unlock the doors with the remote-starter remote or the OEM remote.

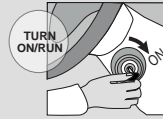

Insert and Turn the key to the Ignition ON/RUN position.



Press the brake pedal.



The vehicle can now be put in to gear and driven.

# THAR-ONE-TOY10 THARNES INSTALLATION

## ADDENDUM - SUGGESTED WIRING CONFIGURATION



VEHICLE

YEARS

Vehicle functions supported in this diagram (functional if equipped)

VEHICLE	YEARS	Transponder Bypass	T-harness	Lock	Unlock	Arm	Disarm	Parking Lights	Trunk (open)	Tachometer	Autolight Off	Door Status	Trunk Status	Hand-Brake Status	Foot-Brake Status	OEM remote Monitoring	R.S. OEM remote Stand Alone compatible
TOYOTA																	
Sequoia	2018-2019	•	•	•	•	•	•	•	•	•	•	•	•	•	•	•	•

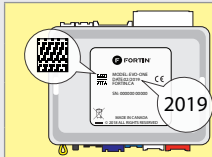

**COMPATIBLE MODULE REQUIRED:**

**QR CODE ON THE LABEL**  
MANUFACTURED AFTER: 2019

FIRMWARE VERSION

**79.[59]**  
TOYOTA/LEXUS MINIMUM

To add the firmware version and the options, use the **FLASH LINK UPDATER** or **FLASH LINK MOBILE** tool, sold separately.



**IF THE VEHICLE IS NOT EQUIPPED WITH FUNCTIONAL HOOD PIN:**

**A11**

**OFF**

Hood trigger (Output Status).



**Program bypass option:**

UNIT OPTION

DESCRIPTION

**C1**

OEM Remote status (Lock/Unlock) monitoring

**D5**

Lock after start



**Program remote starter option:**

FUNCTION

MODE

DESCRIPTION

**2**

**4**

(+) Start 2 (E1)

(+) Ignition 2 (E2)



**Program remote starter option for R.S. OEM REMOTE STAND ALONE:**

FUNCTION

MODE

DESCRIPTION

**38**

**2**

Enable Press 3x Lock to remote start with the OEM remote.

### MANDATORY INSTALL

\* HOOD PIN



**HOOD STATUS:** THE HOOD PIN SWITCH (INCLUDED) MUST BE INSTALLED IF THE VEHICLE CAN BE REMOTE STARTED WITH THE HOOD OPEN, SET FUNCTION A11 TO OFF.

**A11**

**OFF**

**SECURITY STICKER**



Included

**Notice:** the installation of safety elements are mandatory. The hood pin and the sticker are essential security elements and must be installed.

THIS MODULE MUST BE INSTALLED BY A QUALIFIED TECHNICIAN. A WRONG CONNECTION CAN CAUSE PERMANENT DAMAGE TO THE VEHICLE.

DESCRIPTION

② OBD-II connector

Under steering column

① Ignition connector

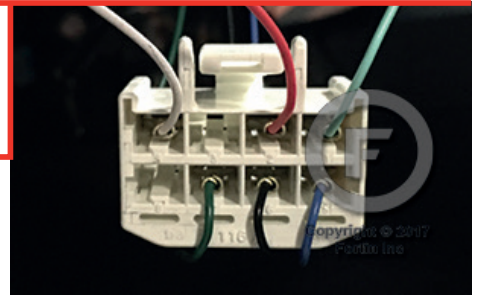
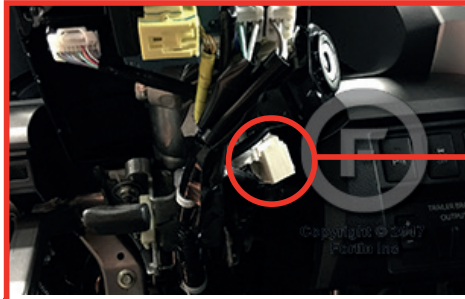
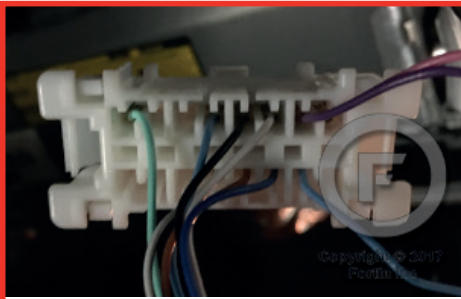

④ Driver kick panel

③ BCM

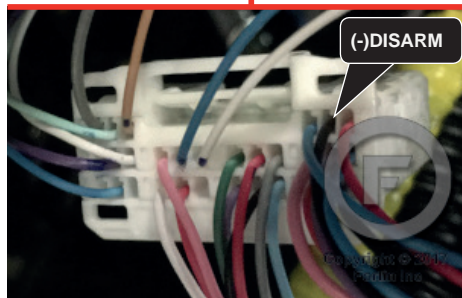
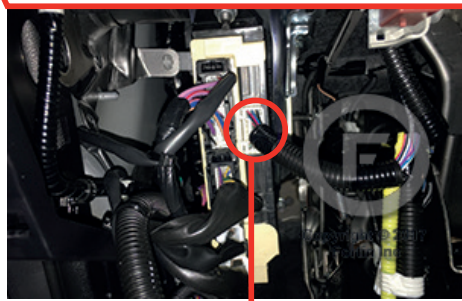

WIRING CONNECTION

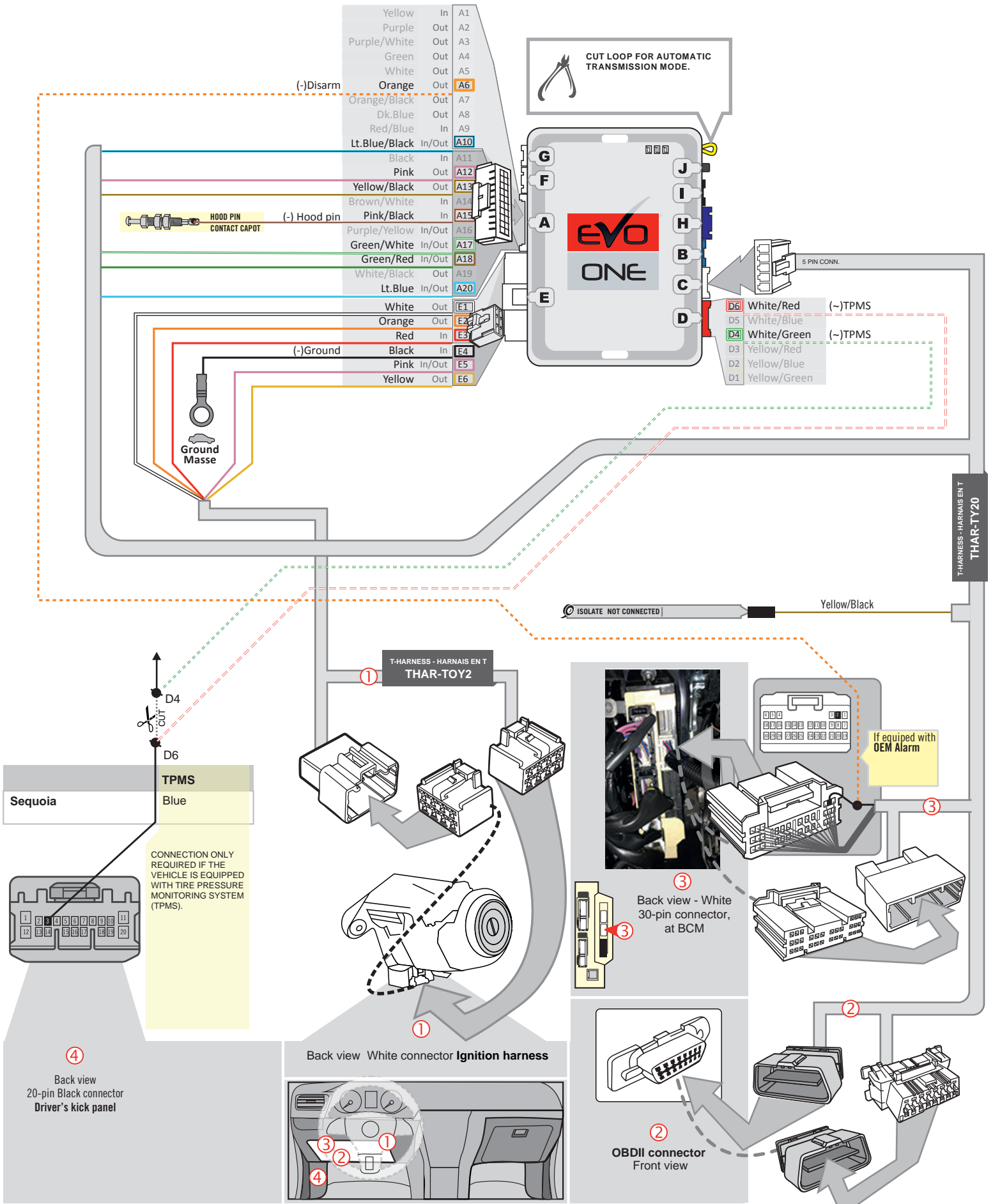



**KEY BYPASS PROGRAMMING PROCEDURE**

1

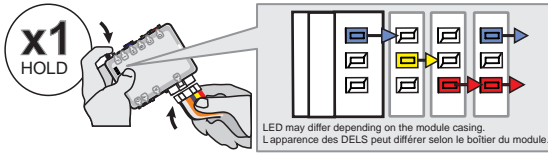

**Press and hold** the programming button:  
**Insert** the 6-Pin Main connector.

↳ **The LEDs will alternate between BLUE, RED, YELLOW & BLUE/RED flashes.**

2



**Release** the programming button when the LED's are RED and BLUE.

*If the LED's are not solid BLUE and RED **disconnect** the 6-Pin connector (Main-Harness) and go back to step 1.*

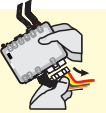

3

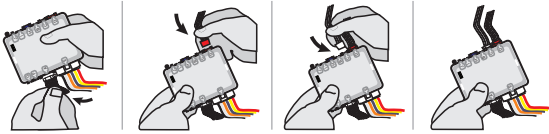

**Insert** the required remaining connectors.

4

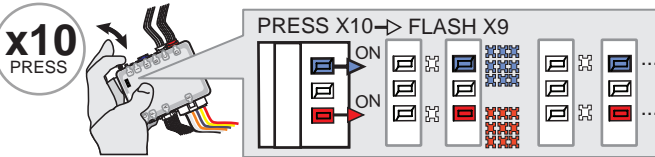

**Press and release** the programming button ten (10x) times.

↳ **The RED and BLUE LED's will alternate between 9 flashes and a pause.**

5

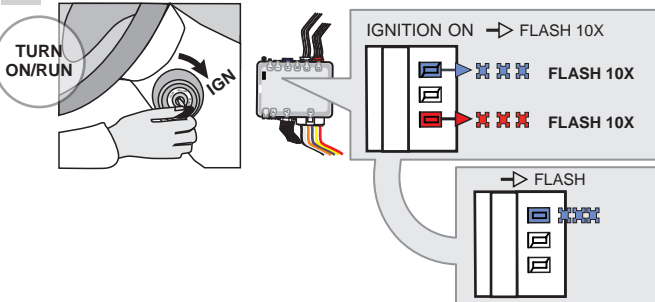

**Turn** the Ignition to the ON/RUN position.

↳ **The RED and BLUE LED's will flash rapidly 10x times. Key bypass programmed.**

↳ **The BLUE LED will flash rapidly. CAN-Bus programmed.**

6

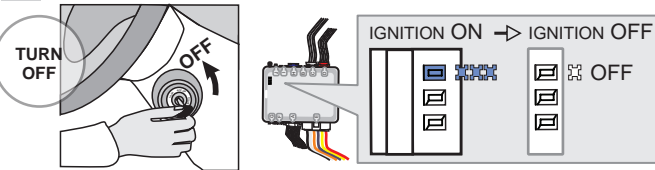

**Turn** the Ignition to the OFF position.

↳ **The BLUE LED will turn off.**



**The module is now programmed.**

Use the remote of the remote starter or security system to test all of the supported features to ensure proper programming.

REMOTE STARTER PROGRAMMING PROCEDURE



REFER TO THE **QUICK INSTALL GUIDE** INCLUDED WITH THE MODULE FOR THE REMOTE STARTER PROGRAMMING.

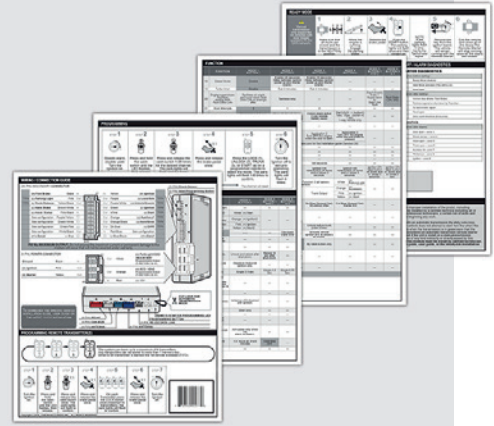

REMOTE STARTER FUNCTIONALITY



All doors must be closed.



Remote start the vehicle.



Unlock the doors with the remote-starter remote or the OEM remote.

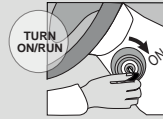

Insert and Turn the key to the Ignition ON/RUN position.



Press the brake pedal.



The vehicle can now be put in to gear and driven.

# THAR-ONE-TOY10 THARNNESS INSTALLATION

## ADDENDUM - SUGGESTED WIRING CONFIGURATION

VEHICLE	YEARS	Vehicle functions supported in this diagram (functional if equipped)															
		Transponder Bypass	T-harness	Lock	Unlock	Arm	Disarm	Parking Lights	Trunk (open)	Tachometer	Autolight Off	Door Status	Trunk Status	Hand-Brake Status	Foot-Brake Status	OEM remote Monitoring	R.S. OEM remote Stand Alone compatible
TOYOTA																	
Tundra	2018-2019	•	•	•	•	•	•	•	•	•	•	•	•	•	•	•	•



	<b>HARDWARE VERSION</b>	<b>BYPASS FIRMWARE VERSION</b>	To add the firmware version and the options, use the <b>FLASH LINK UPDATER</b> or <b>FLASH LINK MOBILE</b> tool, sold separately.
	MINIMUM <b>2</b>	<b>79.[54]</b>	
TOYOTA/LEXUS/SUBARU MINIMUM			

	Program bypass option:	UNIT OPTION	DESCRIPTION
		<b>C1</b>	OEM Remote status (Lock/Unlock) monitoring
<b>D5</b>	Lock after start		

	Program bypass option <b>IF THE VEHICLE IS NOT EQUIPPED WITH FUNCTIONAL HOOD PIN:</b>	UNIT OPTION	DESCRIPTION
		<b>A11</b> <b>OFF</b>	Hood trigger (Output Status).

	Program remote starter option:	FUNCTION	MODE	DESCRIPTION
		<b>2</b>	<b>4</b>	(+) Start 2 (E1)
			(+) Ignition 2 (E2)	

	Program remote starter option for R.S. OEM REMOTE STAND ALONE:	FUNCTION	MODE	DESCRIPTION
		<b>38</b>	<b>2</b>	Enable Press 3x Lock to remote start with the OEM remote.

<b>MANDATORY INSTALL</b>		<b>Notice:</b> the installation of safety elements are mandatory. The hood pin and the sticker are essential security elements and must be installed.		THIS MODULE MUST BE INSTALLED BY A QUALIFIED TECHNICIAN. A WRONG CONNECTION CAN CAUSE PERMANENT DAMAGE TO THE VEHICLE.
<b>* HOOD PIN</b>	HOOD STATUS: THE HOOD PIN SWITCH (INCLUDED) MUST BE INSTALLED IF THE VEHICLE CAN BE REMOTE STARTED WITH THE HOOD OPEN, SET FUNCTION A11 TO OFF.	<b>A11</b> <b>OFF</b>	<b>SECURITY STICKER</b> Included	

DESCRIPTION

② OBD-II connector

Under steering column

① Ignition connector

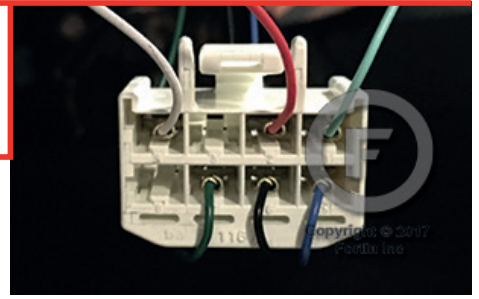
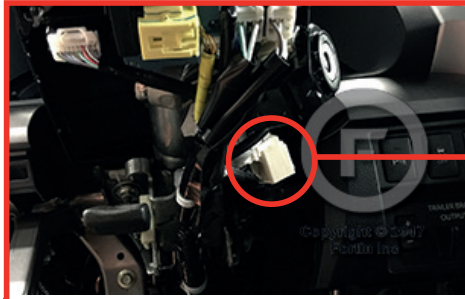
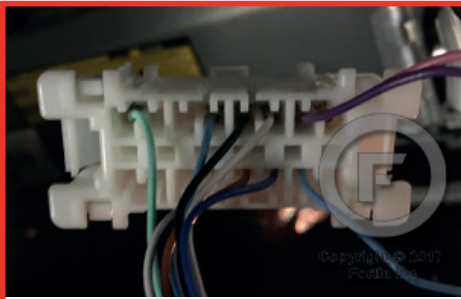

④ Driver kick panel

③ BCM

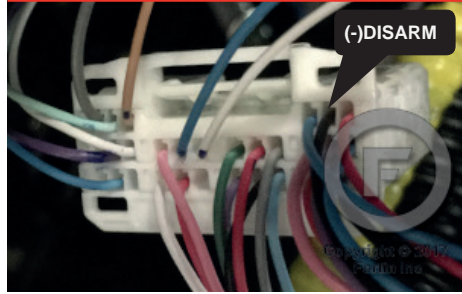
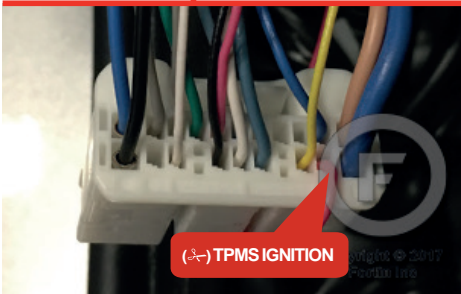
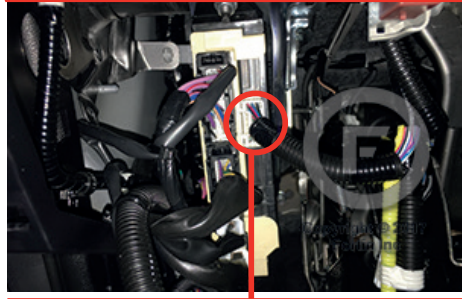
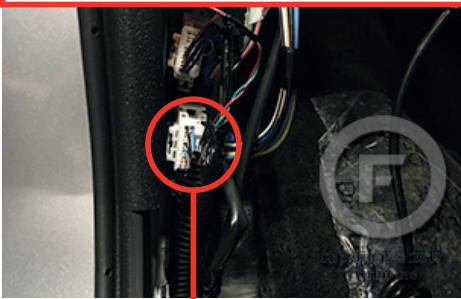

WIRING CONNECTION

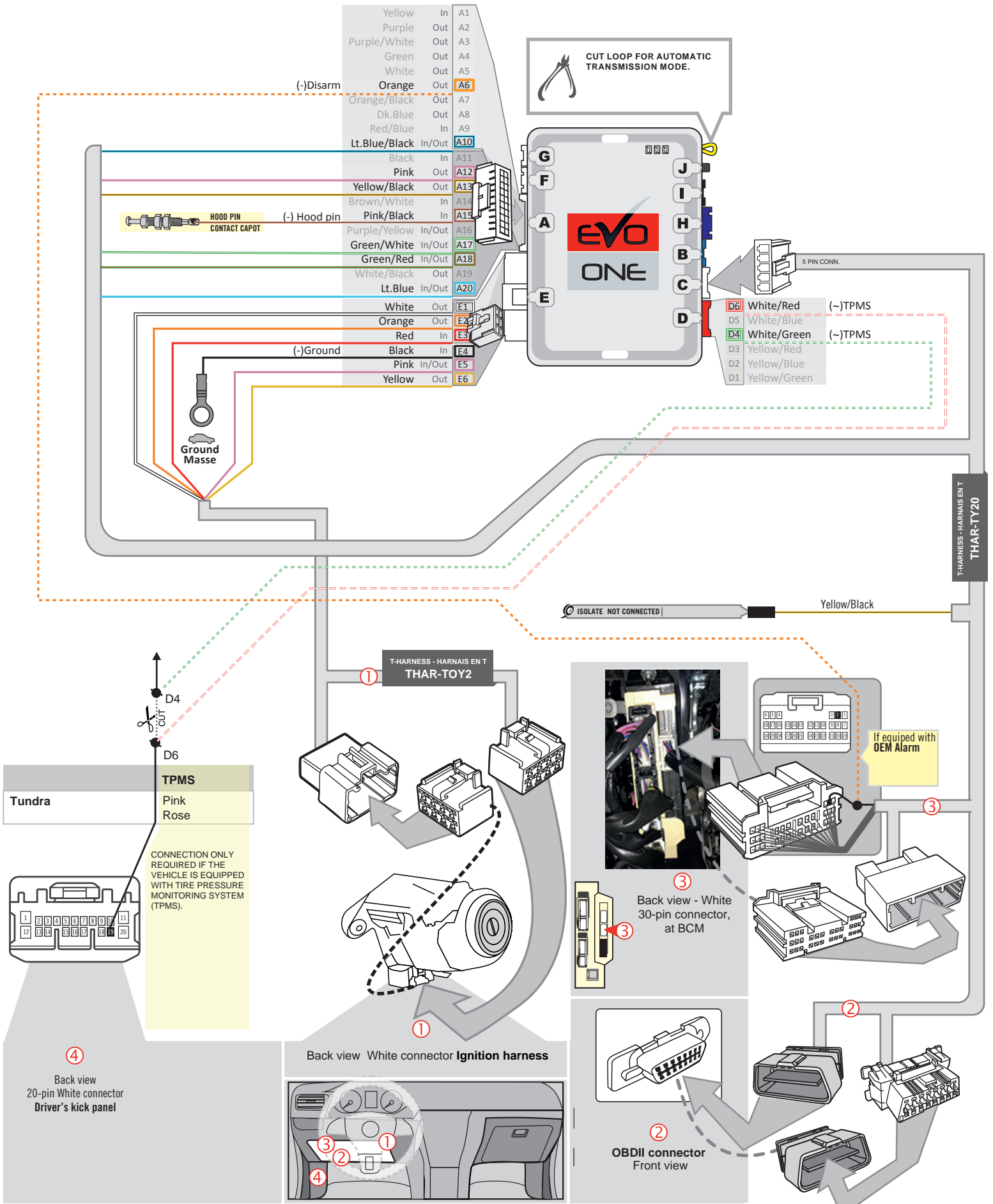

**KEY BYPASS PROGRAMMING PROCEDURE**

1

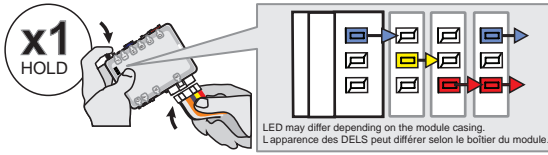

**Press and hold** the programming button:  
**Insert** the 6-Pin Main connector.

↳ **The LEDs will alternate between BLUE, RED, YELLOW & BLUE/RED flashes.**

2

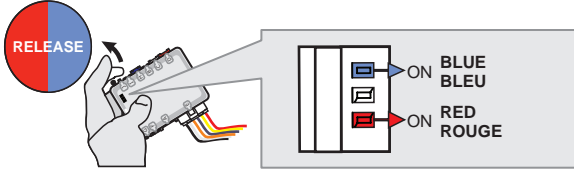

**Release** the programming button when the LED's are RED and BLUE.

*If the LED's are not solid BLUE and RED **disconnect** the 6-Pin connector (Main-Harness) and go back to step 1.*

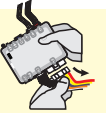

3

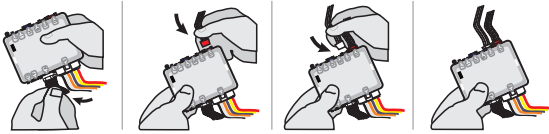

**Insert** the required remaining connectors.

4

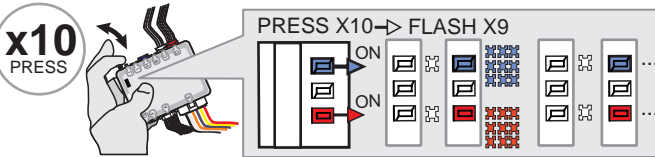

**Press and release** the programming button ten (10x) times.

↳ **The RED and BLUE LED's will alternate between 9 flashes and a pause.**

5

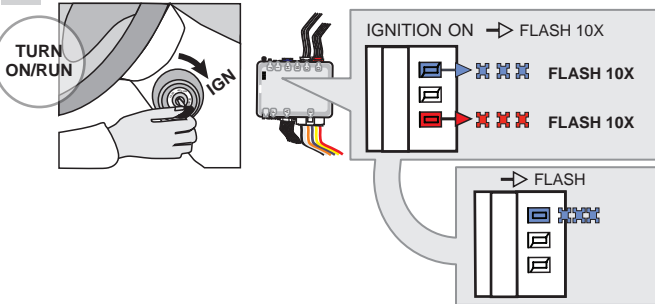

**Turn** the Ignition to the ON/RUN position.

↳ **The RED and BLUE LED's will flash rapidly 10x times. Key bypass programmed.**

↳ **The BLUE LED will flash rapidly. CAN-Bus programmed.**

6

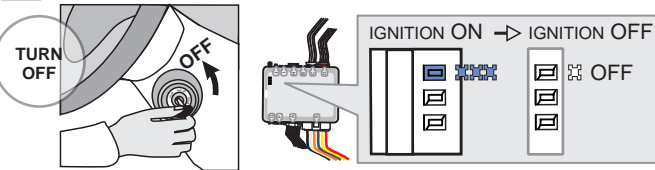

**Turn** the Ignition to the OFF position.

↳ **The BLUE LED will turn off.**



**The module is now programmed.**

Use the remote of the remote starter or security system to test all of the supported features to ensure proper programming.

REMOTE STARTER PROGRAMMING PROCEDURE



REFER TO THE **QUICK INSTALL GUIDE** INCLUDED WITH THE MODULE FOR THE REMOTE STARTER PROGRAMMING.

