

THAR-ONE-TOY10 THARNSS INSTALLATION

ADDENDUM - SUGGESTED WIRING CONFIGURATION



VEHICLE

YEARS

Vehicle functions supported in this diagram (functional if equipped)

TOYOTA

Tundra

2020-2021

Transponder Bypass	T-harness Harnais en T	Lock	Unlock	Arm	Disarm	Parking Lights	Trunk (open)	Tachometer	Autolight Off	Door Status	Trunk Status	Hand-Brake Status	Foot-Brake Status	OEM remote Monitoring	R.S. OEM remote Stand Alone compatible
•	•	•	•	•	•	•	•	•	•	•	•	•	•	•	•

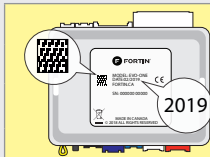

COMPATIBLE
MODULE
REQUIRED:

QR CODE ON THE
LABEL
MANUFACTURED
AFTER: 2019

FIRMWARE VERSION

79.[66]
TOYOTA/
LEXUS MINIMUM

To add the firmware version and the options, use the **FLASH LINK UPDATER** or **FLASH LINK MOBILE** tool, sold separately.



Program bypass option:

UNIT OPTION

DESCRIPTION

C1

OEM Remote status (Lock/Unlock) monitoring

D5

Lock after start



Program bypass option
IF THE VEHICLE IS NOT EQUIPPED
WITH FUNCTIONAL HOOD PIN:

UNIT OPTION

DESCRIPTION

A11

OFF

Hood trigger (Output Status).

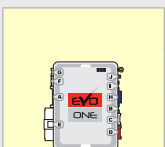

Program remote
starter option:

FUNCTION

MODE

DESCRIPTION

2

4

(+) Start 2 (E1)
(+) Ignition 2 (E2)

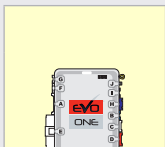

Program remote
starter option for R.S.
OEM REMOTE STAND
ALONE:

FUNCTION

MODE

DESCRIPTION

38

2

Enable
Press 3x Lock to remote start with the OEM remote.

MANDATORY INSTALL

* HOOD
PIN



HOOD STATUS: THE HOOD PIN SWITCH (INCLUDED) MUST BE INSTALLED IF THE VEHICLE CAN BE REMOTE STARTED WITH THE HOOD OPEN, SET FUNCTION A11 TO OFF.

A11

OFF

SECURITY STICKER



Included

Notice: the installation of safety elements are mandatory. The hood pin and the sticker are essential security elements and must be installed.

THIS MODULE MUST BE INSTALLED BY A QUALIFIED TECHNICIAN. A WRONG CONNECTION CAN CAUSE PERMANENT DAMAGE TO THE VEHICLE.

DESCRIPTION | DESCRIPTION

② OBD-II connector

Under steering column

① Ignition connector

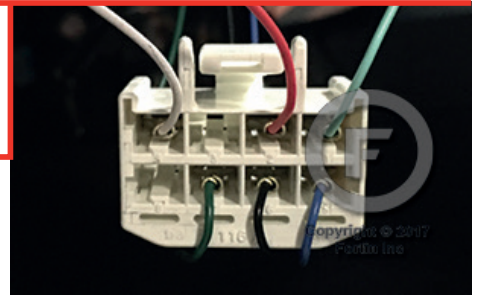
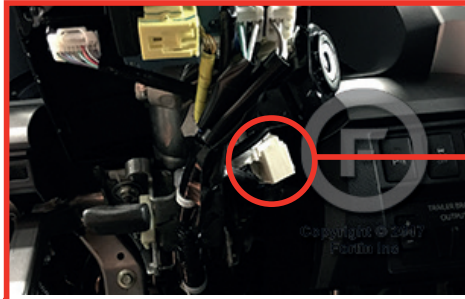
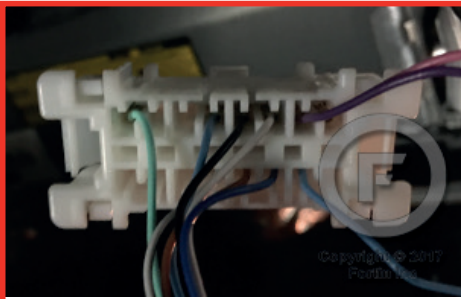

③ BCM

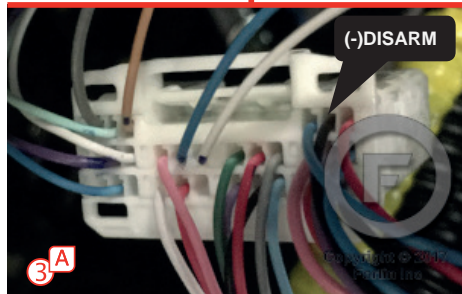
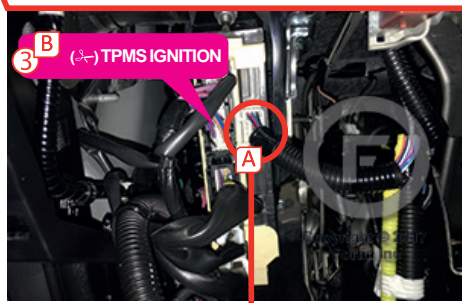

WIRING CONNECTION

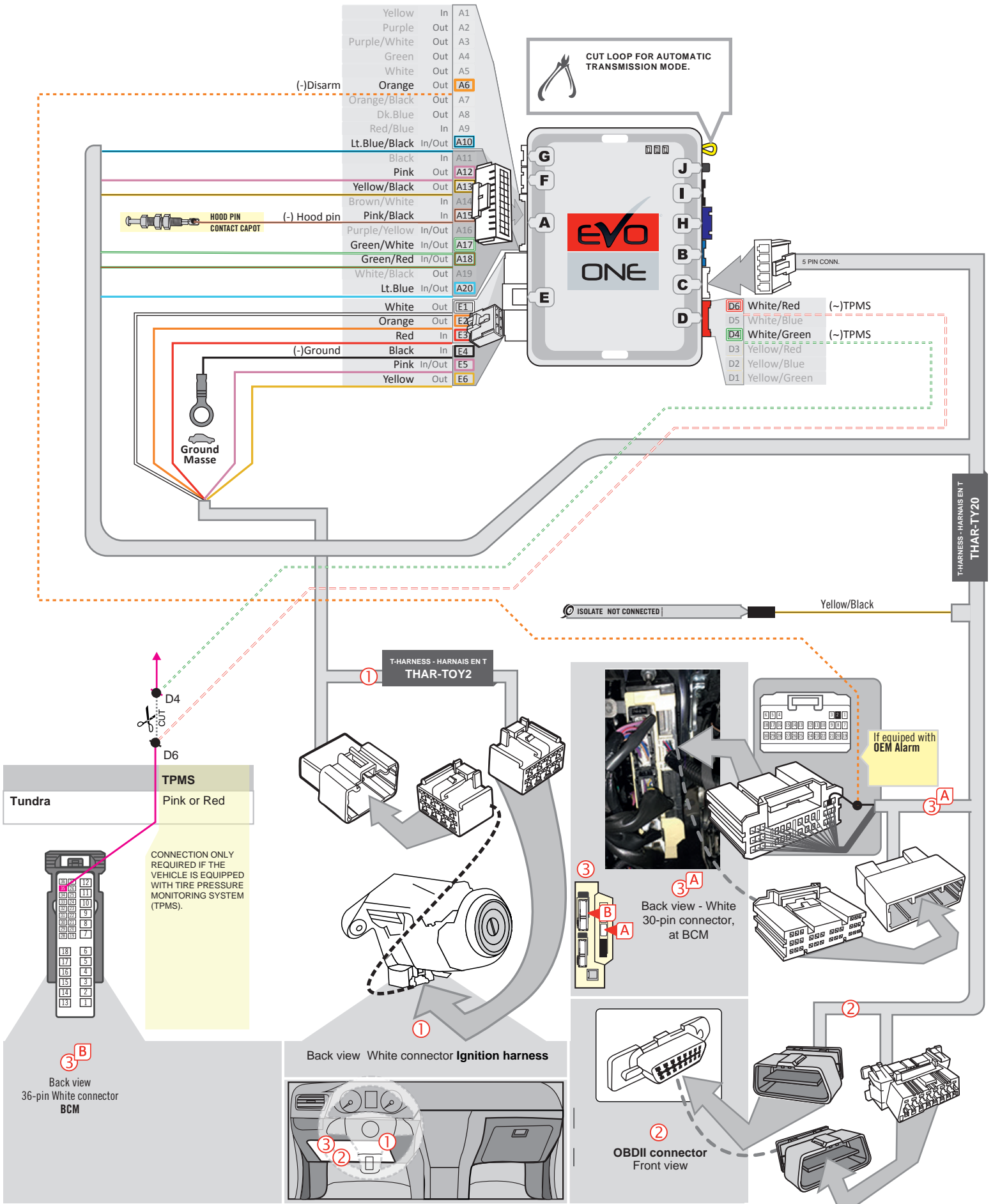

KEY BYPASS PROGRAMMING PROCEDURE

1

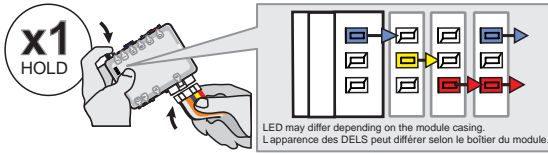

Press and hold the programming button:
Insert the 6-Pin Main connector.

↳ **The LEDs will alternate between BLUE, RED, YELLOW & BLUE/RED flashes.**

2

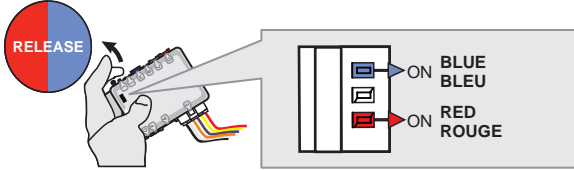

Release the programming button when the LED's are RED and BLUE.

*If the LED's are not solid BLUE and RED **disconnect** the 6-Pin connector (Main-Harness) and go back to step 1.*

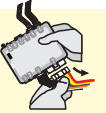

3

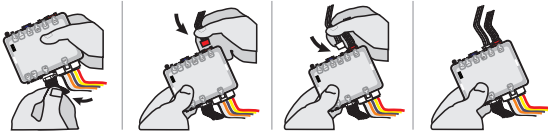

Insert the required remaining connectors.

4

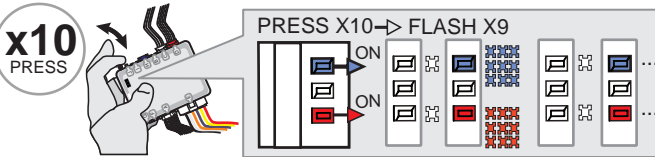

Press and release the programming button ten (10x) times.

↳ **The RED and BLUE LED's will alternate between 9 flashes and a pause.**

5

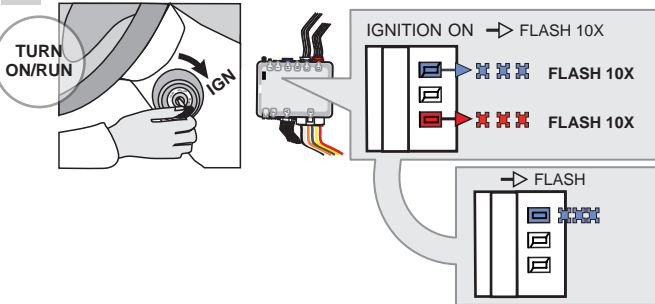

Turn the Ignition to the ON/RUN position.

↳ **The RED and BLUE LED's will flash rapidly 10x times. Key bypass programmed.**

↳ **The BLUE LED will flash rapidly. CAN-Bus programmed.**

6

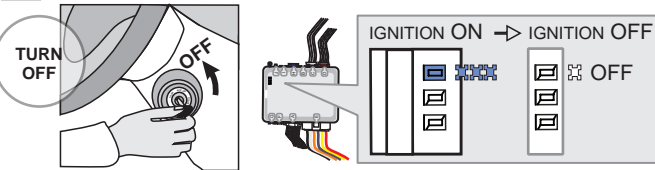

Turn the Ignition to the OFF position.

↳ **The BLUE LED will turn off.**



The module is now programmed.

Use the remote of the remote starter or security system to test all of the supported features to ensure proper programming.

REMOTE STARTER PROGRAMMING PROCEDURE



REFER TO THE **QUICK INSTALL GUIDE** INCLUDED WITH THE MODULE FOR THE REMOTE STARTER PROGRAMMING.

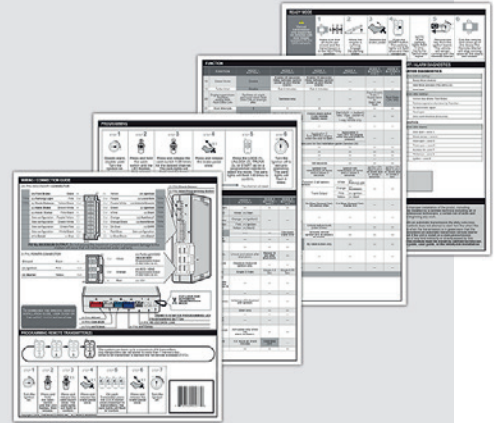

REMOTE STARTER FUNCTIONALITY



All doors must be closed.



Remote start the vehicle.



Unlock the doors with the remote-starter remote or the OEM remote.

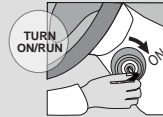

Insert and Turn the key to the Ignition ON/RUN position.



Press the brake pedal.



The vehicle can now be put in to gear and driven.

THAR-ONE-TOY10 THARNSS INSTALLATION

ADDENDUM - SUGGESTED WIRING CONFIGURATION



VEHICLE

YEARS

Vehicle functions supported in this diagram (functional if equipped)

VEHICLE	YEARS	Transponder Bypass	T-harness Harnais en T	Lock	Unlock	Arm	Disarm	Parking Lights	Trunk (open)	Tachometer	Autolight Off	Door Status	Trunk Status	Hand-Brake Status	Foot-Brake Status	OEM remote Monitoring	R.S. OEM remote Stand Alone compatible
TOYOTA																	
Sequoia	2018-2019	•	•	•	•	•	•	•	•	•	•	•	•	•	•	•	•

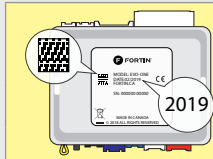

COMPATIBLE MODULE REQUIRED:

QR CODE ON THE LABEL
MANUFACTURED AFTER: 2019

FIRMWARE VERSION

79.[59]
TOYOTA/
LEXUS MINIMUM

To add the firmware version and the options, use the **FLASH LINK UPDATER** or **FLASH LINK MOBILE** tool, sold separately.



IF THE VEHICLE IS NOT EQUIPPED WITH FUNCTIONAL HOOD PIN:

A11

OFF

Hood trigger (Output Status).



Program bypass option:

UNIT OPTION

DESCRIPTION

C1

OEM Remote status (Lock/Unlock) monitoring

D5

Lock after start

		FUNCTION	MODE	DESCRIPTION
	Program remote starter option:	2	4	(+) Start 2 (E1)
				(+) Ignition 2 (E2)

		FUNCTION	MODE	DESCRIPTION
	Program remote starter option for R.S. OEM REMOTE STAND ALONE:	38	2	Enable Press 3x Lock to remote start with the OEM remote.

MANDATORY INSTALL

* HOOD PIN



HOOD STATUS: THE HOOD PIN SWITCH (INCLUDED) MUST BE INSTALLED IF THE VEHICLE CAN BE REMOTE STARTED WITH THE HOOD OPEN, SET FUNCTION A11 TO OFF.

A11

OFF

SECURITY STICKER



Included

Notice: the installation of safety elements are mandatory. The hood pin and the sticker are essential security elements and must be installed.

THIS MODULE MUST BE INSTALLED BY A QUALIFIED TECHNICIAN. A WRONG CONNECTION CAN CAUSE PERMANENT DAMAGE TO THE VEHICLE.

DESCRIPTION

② OBD-II connector

Under steering column

① Ignition connector

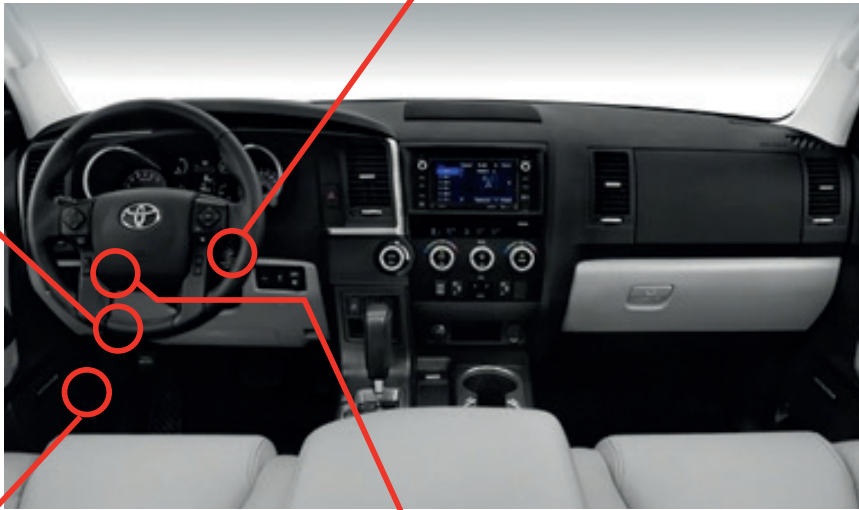
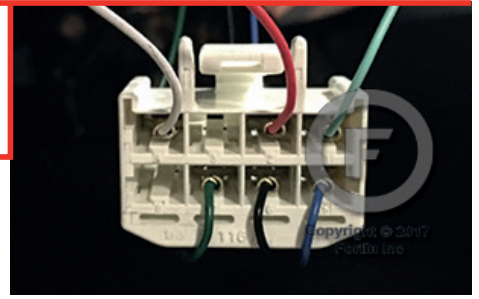
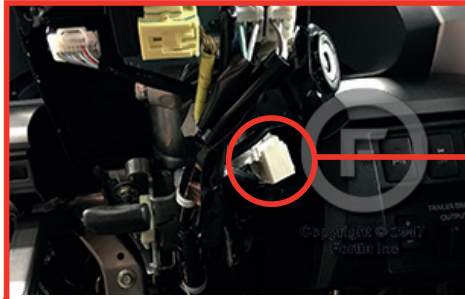
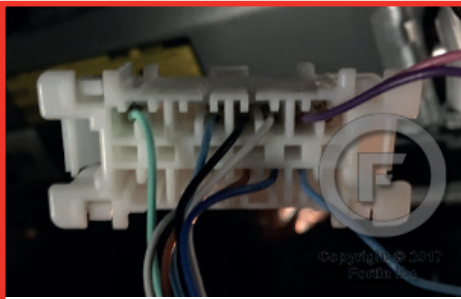

④ Driver kick panel

③ BCM

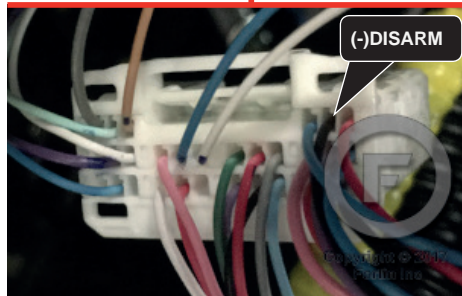
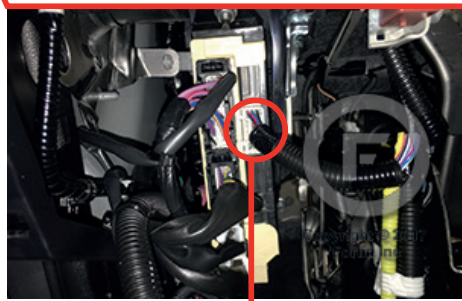

WIRING CONNECTION

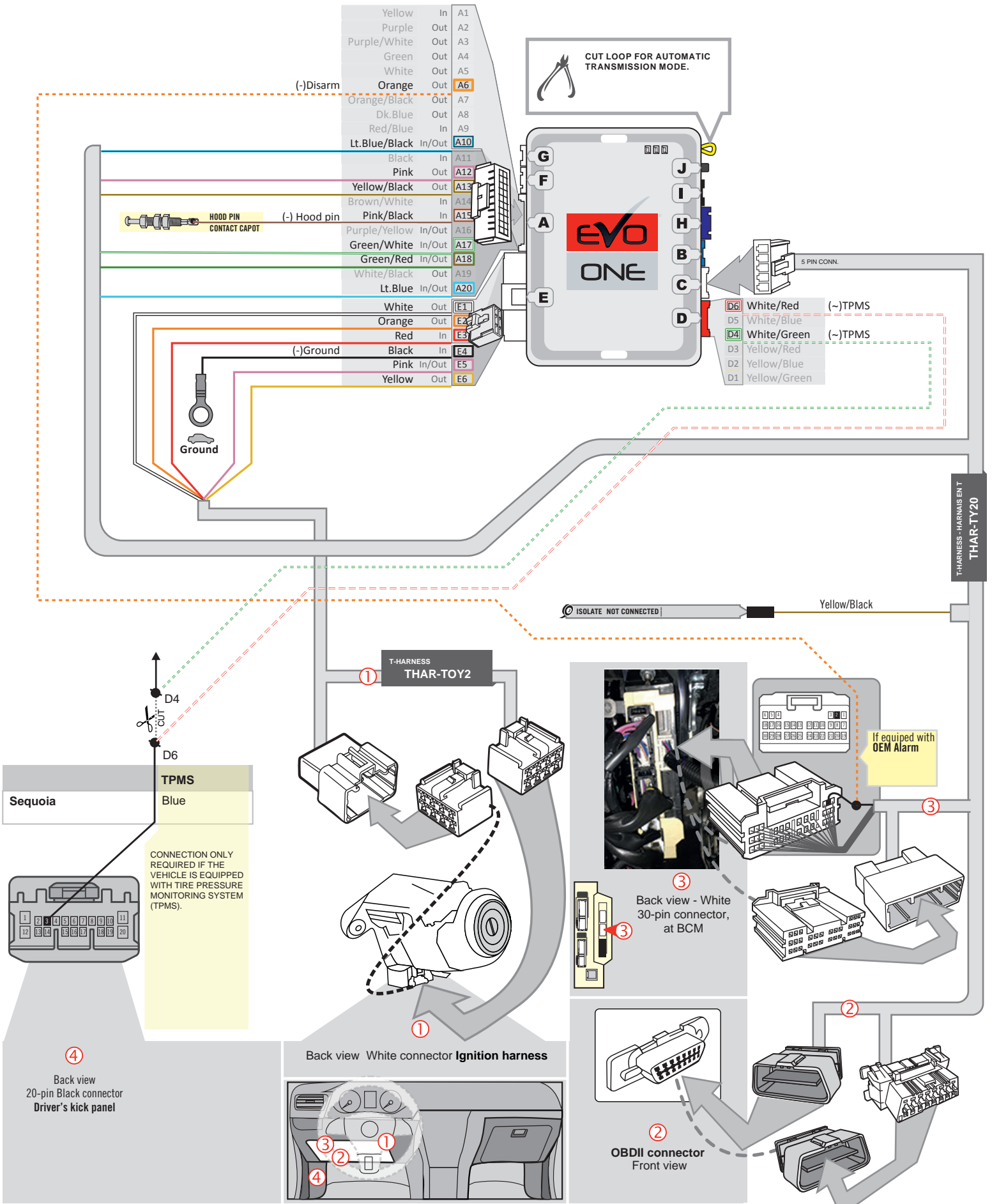

KEY BYPASS PROGRAMMING PROCEDURE

1

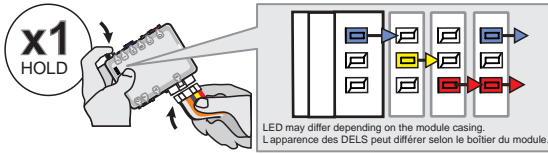

Press and hold the programming button:
Insert the 6-Pin Main connector.

↳ **The LEDs will alternate between BLUE, RED, YELLOW & BLUE/RED flashes.**

2



Release the programming button when the LED's are RED and BLUE.

*If the LED's are not solid BLUE and RED **disconnect** the 6-Pin connector (Main-Harness) and go back to step 1.*

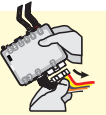

3

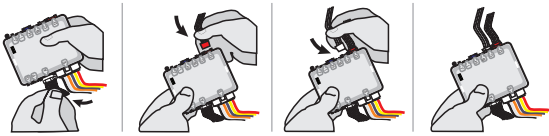

Insert the required remaining connectors.

4

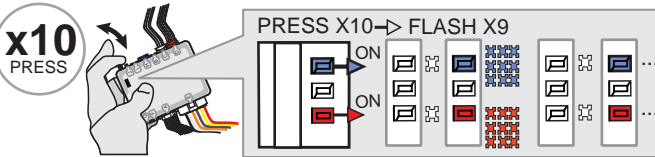

Press and release the programming button ten (10x) times.

↳ **The RED and BLUE LED's will alternate between 9 flashes and a pause.**

5

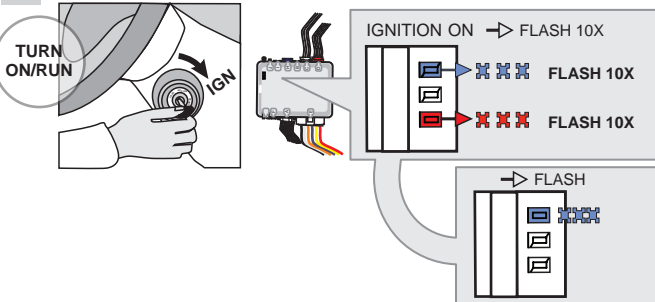

Turn the Ignition to the ON/RUN position.

↳ **The RED and BLUE LED's will flash rapidly 10x times. Key bypass programmed.**

↳ **The BLUE LED will flash rapidly. CAN-Bus programmed.**

6

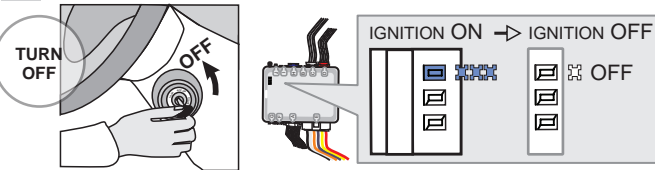

Turn the Ignition to the OFF position.

↳ **The BLUE LED will turn off.**



The module is now programmed.

Use the remote of the remote starter or security system to test all of the supported features to ensure proper programming.

REMOTE STARTER PROGRAMMING PROCEDURE



REFER TO THE **QUICK INSTALL GUIDE** INCLUDED WITH THE MODULE FOR THE REMOTE STARTER PROGRAMMING.

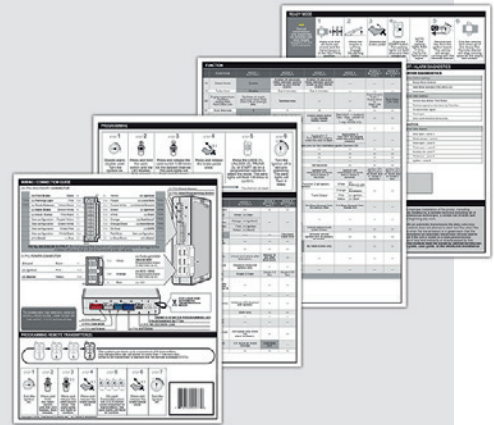

REMOTE STARTER FUNCTIONALITY



All doors must be closed.



Remote start the vehicle.



Unlock the doors with the remote-starter remote or the OEM remote.

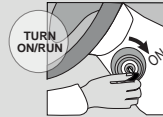

Insert and Turn the key to the Ignition ON/RUN position.



Press the brake pedal.



The vehicle can now be put in to gear and driven.

THAR-ONE-TOY10 THARNSS INSTALLATION

ADDENDUM - SUGGESTED WIRING CONFIGURATION

VEHICLE	YEARS	Vehicle functions supported in this diagram (functional if equipped)															
		Transponder Bypass	T-harness Harnais en T	Lock	Unlock	Arm	Disarm	Parking Lights	Trunk (open)	Tachometer	Autolight Off	Door Status	Trunk Status	Hand-Brake Status	Foot-Brake Status	OEM remote Monitoring	R.S. OEM remote Stand Alone compatible
TOYOTA																	
Tundra	2018-2019	•	•	•	•	•	•	•	•	•	•	•	•	•	•	•	•



	HARDWARE VERSION	BYPASS FIRMWARE VERSION	To add the firmware version and the options, use the FLASH LINK UPDATER or FLASH LINK MOBILE tool, sold separately.
	MINIMUM 2	79.[54] <small>TOYOTA/LEXUS/SUBARU MINIMUM</small>	

	Program bypass option:	UNIT OPTION	DESCRIPTION
		C1	OEM Remote status (Lock/Unlock) monitoring
D5	Lock after start		

	Program bypass option IF THE VEHICLE IS NOT EQUIPPED WITH FUNCTIONAL HOOD PIN:	UNIT OPTION	DESCRIPTION
		A11 OFF	Hood trigger (Output Status).

	Program remote starter option:	FUNCTION	MODE	DESCRIPTION
		2	4	(+) Start 2 (E1) (+) Ignition 2 (E2) (+) Démarreur 2 (E1) (+) Ignition 2 (E2)

	Program remote starter option for R.S. OEM REMOTE STAND ALONE:	FUNCTION	MODE	DESCRIPTION
		38	2	Enable Press 3x Lock to remote start with the OEM remote.

MANDATORY INSTALL

*** HOOD PIN**

HOOD STATUS: THE HOOD PIN SWITCH (INCLUDED) MUST BE INSTALLED IF THE VEHICLE CAN BE REMOTE STARTED WITH THE HOOD OPEN, SET FUNCTION A11 TO OFF.

A11 **OFF**

SECURITY STICKER

Included

Notice: the installation of safety elements are mandatory. The hood pin and the sticker are essential security elements and must be installed.

THIS MODULE MUST BE INSTALLED BY A QUALIFIED TECHNICIAN. A WRONG CONNECTION CAN CAUSE PERMANENT DAMAGE TO THE VEHICLE.

DESCRIPTION

② OBD-II connector

Under steering column

① Ignition connector

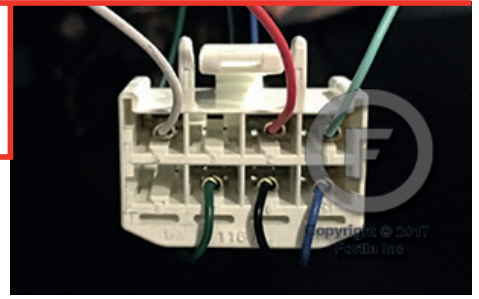
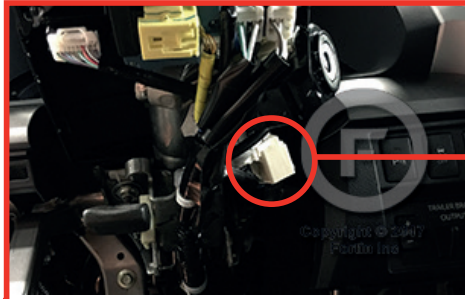
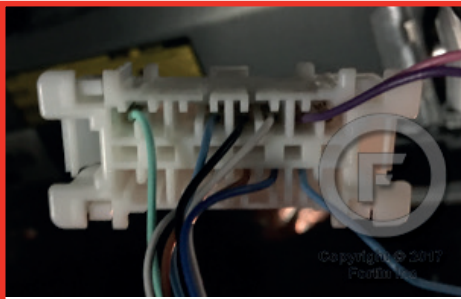

④ Driver kick panel

③ BCM

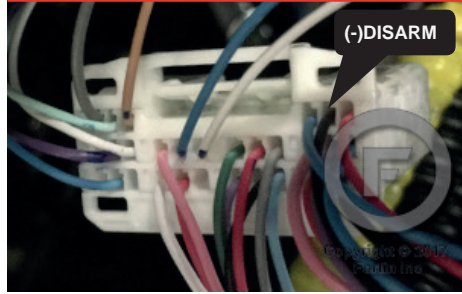
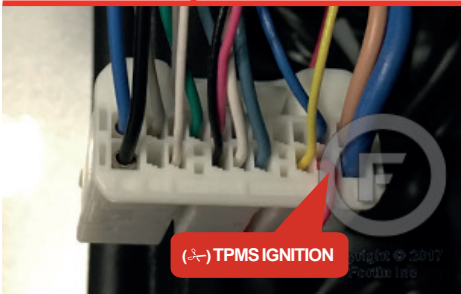
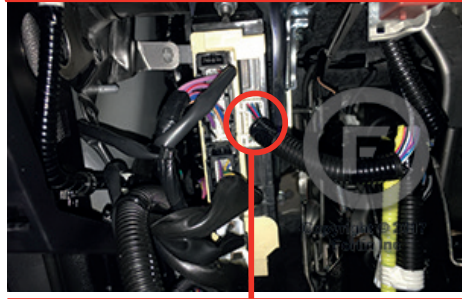
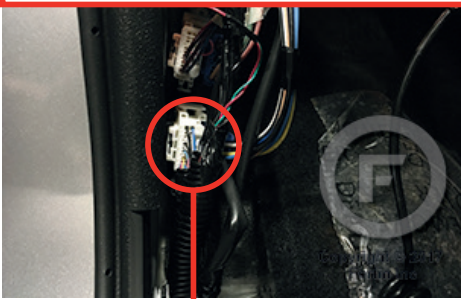

WIRING CONNECTION

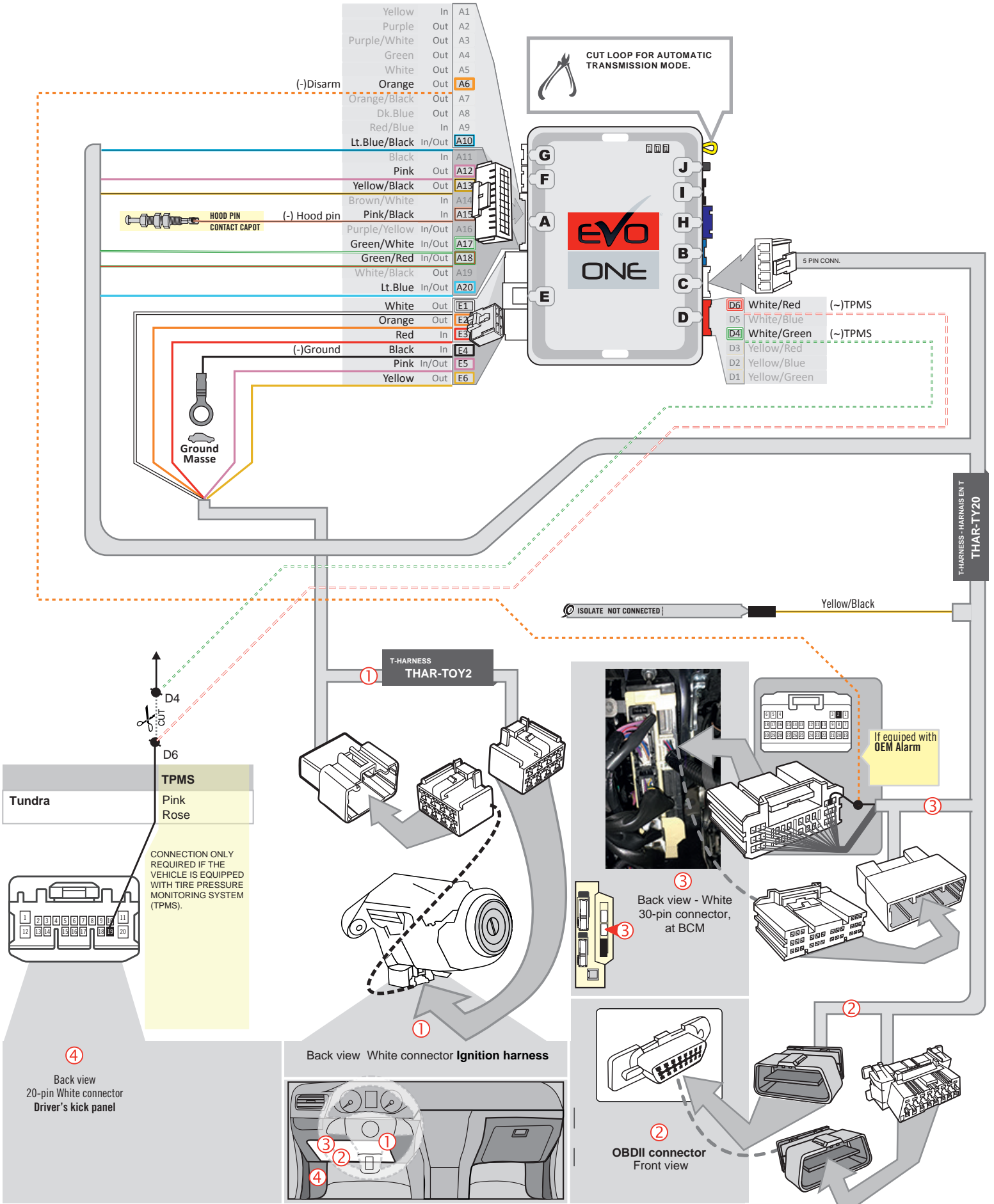

KEY BYPASS PROGRAMMING PROCEDURE

1

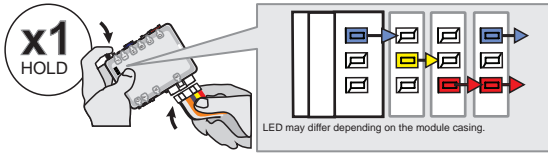

Press and hold the programming button:
Insert the 6-Pin Main connector.

↳ *The LEDs will alternate between BLUE, RED, YELLOW & BLUE/RED flashes.*

2



Release the programming button when the LED's are RED and BLUE.

If the LED's are not solid BLUE and RED disconnect the 6-Pin connector (Main-Harness) and go back to step 1.

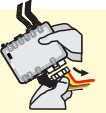

3

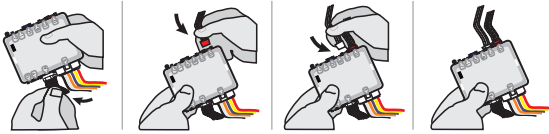

Insert the required remaining connectors.

4

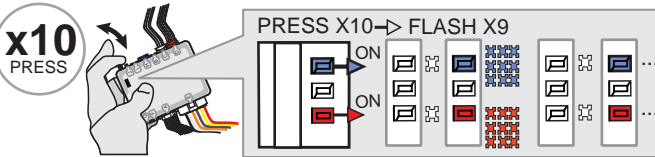

Press and release the programming button ten (10x) times.

↳ *The RED and BLUE LED's will alternate between 9 flashes and a pause.*

5

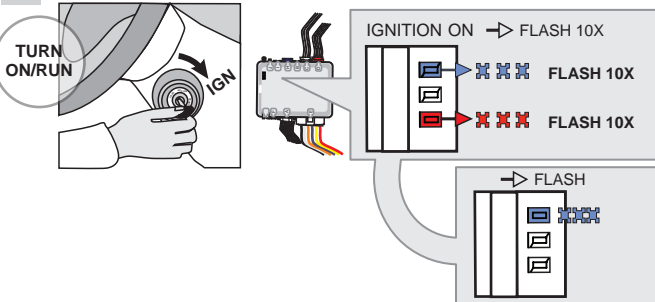

Turn the Ignition to the ON/RUN position.

↳ *The RED and BLUE LED's will flash rapidly 10x times. Key bypass programmed.*

↳ *The BLUE LED will flash rapidly. CAN-Bus programmed.*

6

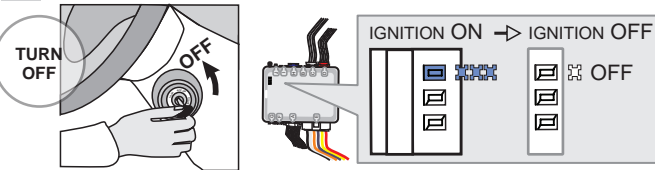

Turn the Ignition to the OFF position.

↳ *The BLUE LED will turn off.*



The module is now programmed.

Use the remote of the remote starter or security system to test all of the supported features to ensure proper programming.



REFER TO THE **QUICK INSTALL GUIDE** INCLUDED WITH THE MODULE FOR THE REMOTE STARTER PROGRAMMING.

