

THAR-ONE-HON5 T-HARNESS INSTALLATION

ADDENDUM - SUGGESTED WIRING CONFIGURATION

VEHICLE	YEARS	Vehicle functions supported in this diagram (functional if equipped)																
		Immobilizer Bypass	T-Harness	Lock	Unlock	Arm	Disarm	Trunk (open)	Horn	Parking Lights	Tachometer	Door Status	Trunk Status	Hood Status*	Hand-Brake Status	Foot-Brake Status	OEM Remote Monitoring	R.S. OEM remote Stand Alone compatible
HONDA																		
Accord	2008-2012	•	•	•	•	•	•	•	•	•	•	•	•	•	•	•	•	•

BYPASS FIRMWARE VERSION

73.[38]

HONDA/ACURA MINIMUM

To add the firmware version and the options, use the **FLASH LINK UPDATER** or **FLASH LINK MOBILE** tool, sold separately.

		UNIT OPTION	DESCRIPTION
	Program bypass option:	C1	OEM Remote status (Lock/Unlock) monitoring

		UNIT OPTION OPTION UNITE	DESCRIPTION
	Program bypass option (If equipped with OEM alarm):	D2	Unlock before / Lock after (Disarm OEM alarm)

	IF THE VEHICLE IS NOT EQUIPPED WITH FUNCTIONAL HOOD PIN:	A11	OFF	Hood trigger (Output Status).
--	--	------------	------------	-------------------------------

		FUNCTION	MODE	DESCRIPTION
	Program remote starter option:	32	3	DK.Blue (GWR) Shut Down After

		FUNCTION	MODE	DESCRIPTION
	Program remote starter option for R.S. OEM REMOTE STAND ALONE:	38	2	Enable Press 3x Lock to remote start with the OEM remote.

MANDATORY INSTALL I
*** HOOD PIN**

HOOD STATUS: THE HOOD PIN SWITCH (INCLUDED) MUST BE INSTALLED IF THE VEHICLE CAN BE REMOTE STARTED WITH THE HOOD OPEN, SET FUNCTION A11 TO OFF.

A11
OFF
SECURITY STICKER



Included

Notice: the installation of safety elements are mandatory. The hood pin and the sticker are essential security elements and must be installed.

THIS MODULE MUST BE INSTALLED BY A QUALIFIED TECHNICIAN. A WRONG CONNECTION CAN CAUSE PERMANENT DAMAGE TO THE VEHICLE.

DESCRIPTION |

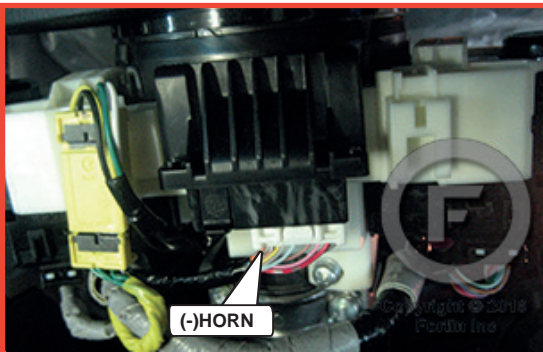
⑤ Steering column



④ Clutch switch

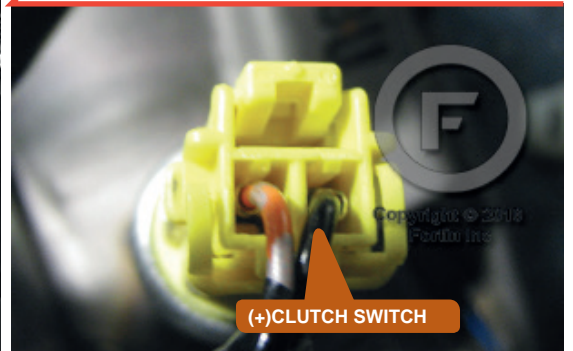
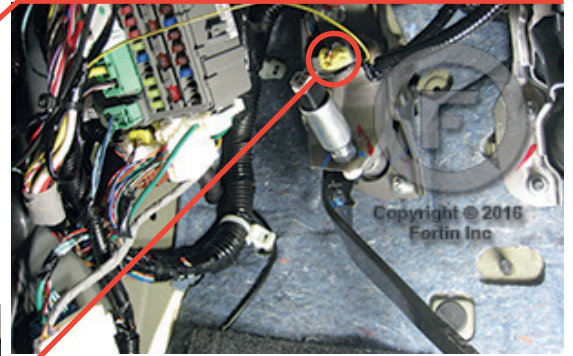

Ignition key barrel

③ Parking lights harness

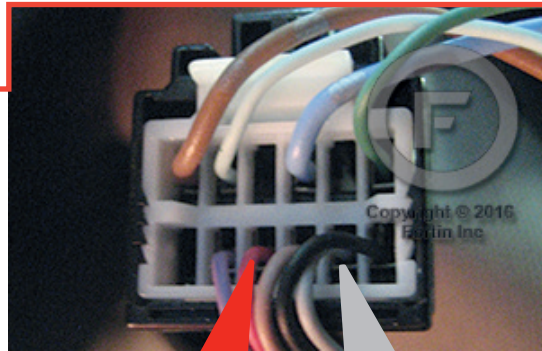
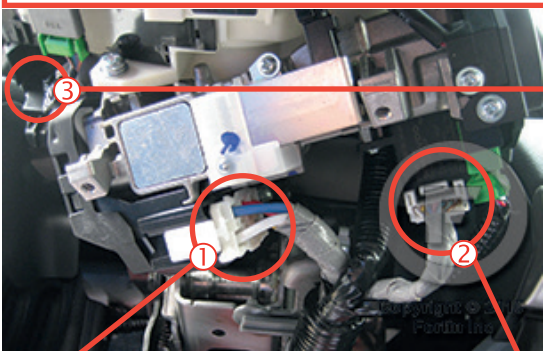

① Ignition harness

② immobiliser connector

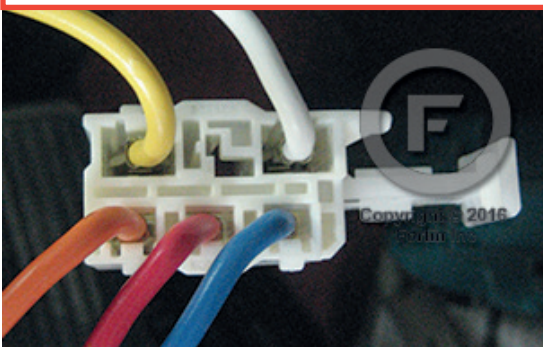

AUTOMATIC TRANSMISSION WIRING CONNECTION |

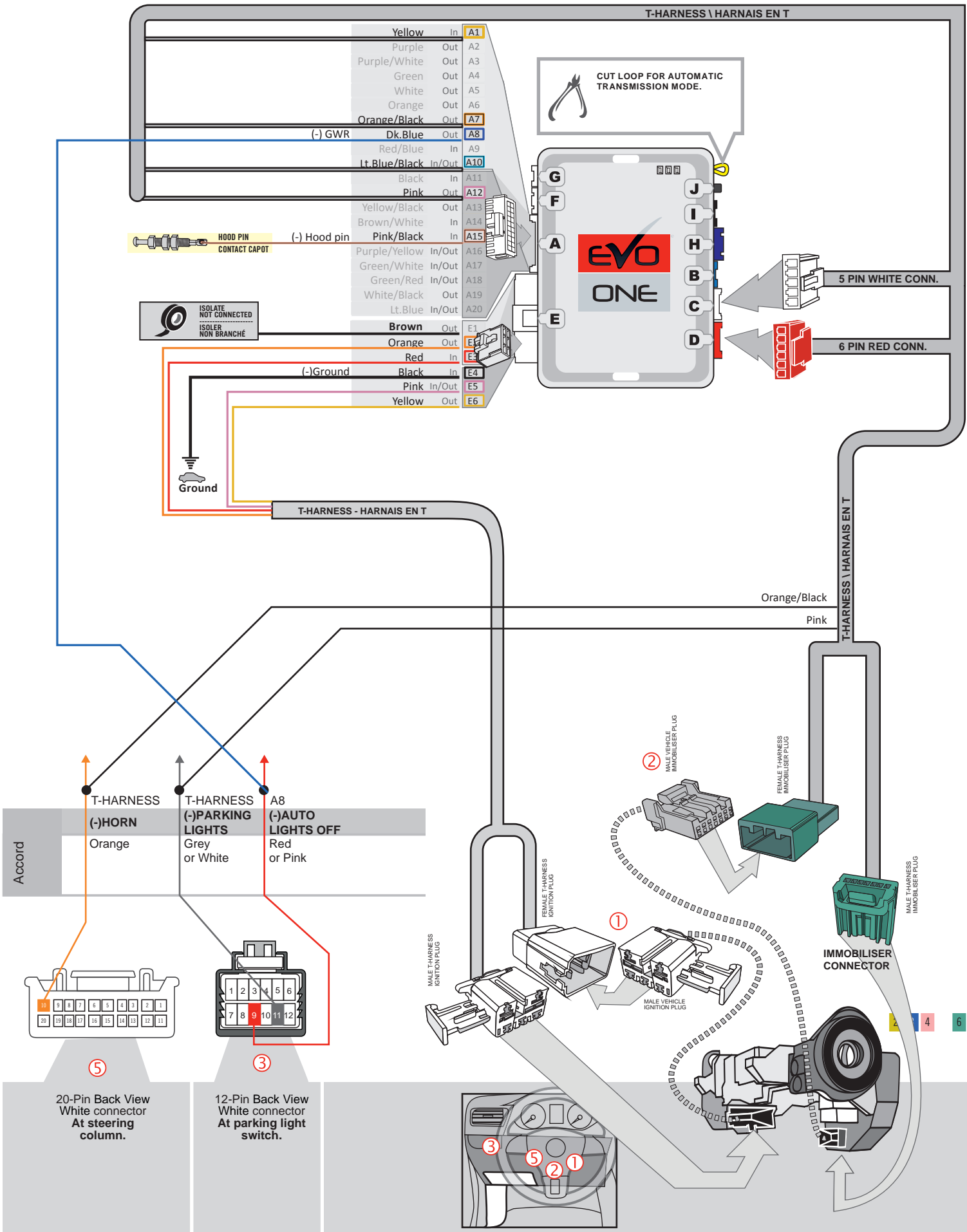

KEY BYPASS PROGRAMMING PROCEDURE

1

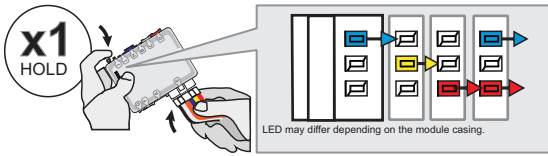

Press and hold the programming button:
Insert the 6-Pin Main connector.

↳ The LEDs will alternate between BLUE, RED, YELLOW & BLUE/RED flashes.

2

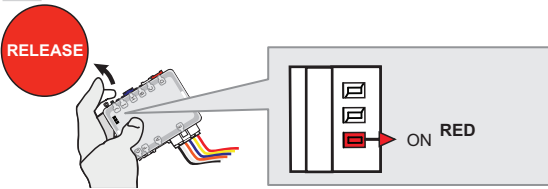

Release the programming button when the LED is RED.

If the LED is not solid RED disconnect the 6 Pin connector (Main-Harness) and go back to step 1.

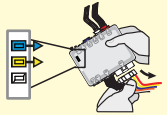

3

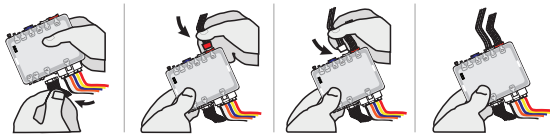

Insert the required remaining connectors.

4

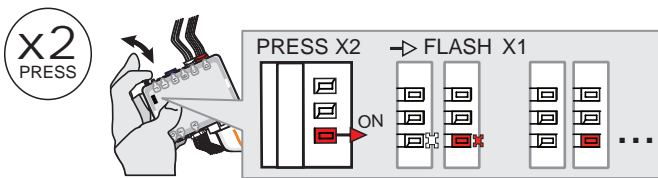

Press and release the programming button twice (2x).

↳ The RED LED will flash once and pause.

5

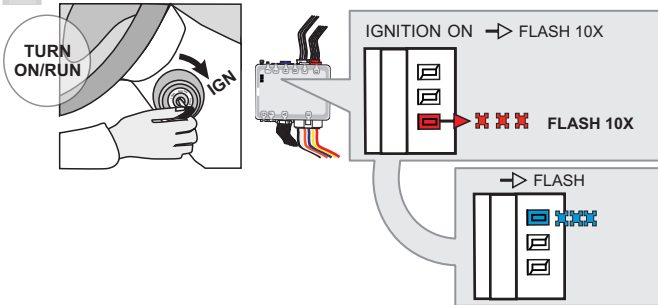

Turn the Ignition to the ON/RUN position.

↳ The RED LED will flash rapidly 10x times.
Key bypass programmed.

↳ The BLUE LED will flash rapidly.
CAN-Bus programmed.

6

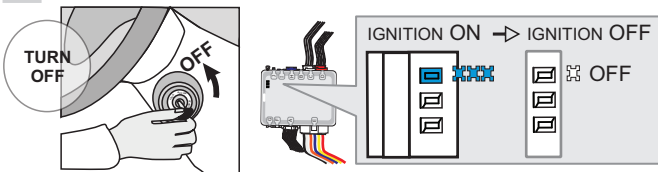

Turn the Ignition to the OFF position.

↳ The BLUE LED will turn off.



The module is now programmed.

Use the remote of the remote starter or security system to test all of the supported features to ensure proper programming.



REFER TO THE **QUICK INSTALL GUIDE** INCLUDED WITH THE MODULE FOR THE REMOTE STARTER PROGRAMMING.

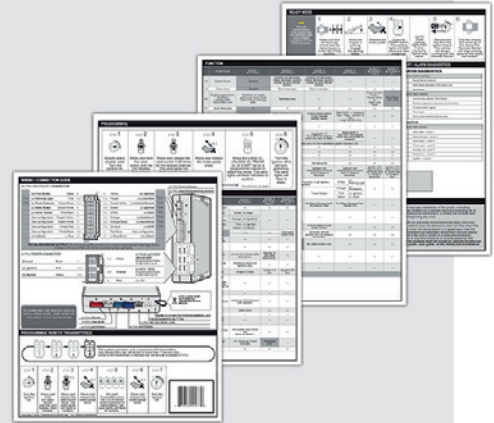

THAR-ONE-HON5 T-HARNESS INSTALLATION

ADDENDUM - SUGGESTED WIRING CONFIGURATION

VEHICLE	YEARS	Vehicle functions supported in this diagram (functional if equipped)																
		Immobilizer Bypass	T-Harness	Lock	Unlock	Arm	Disarm	Trunk (open)	Horn	Parking Lights	Tachometer	Door Status	Trunk Status	Hood Status*	Hand-Brake Status	Foot-Brake Status	OEM Remote Monitoring	R.S. OEM remote Stand-Alone compatible
HONDA Accord Crosstour	2010-2012	•	•	•	•	•	•	•	•	•	•	•	•	•	•	•	•	•

BYPASS FIRMWARE VERSION

73.[38]

HONDA/ACURA MINIMUM

To add the firmware version and the options, use the **FLASH LINK UPDATER** or **FLASH LINK MOBILE** tool, sold separately.

	Program bypass option:	UNIT OPTION	DESCRIPTION
		C1	OEM Remote status (Lock/Unlock) monitoring

	Program bypass option (If equipped with OEM alarm):	UNIT OPTION	DESCRIPTION
		D2	Unlock before / Lock after (Disarm OEM alarm)

	IF THE VEHICLE IS NOT EQUIPPED WITH FUNCTIONAL HOOD PIN:	UNIT OPTION	DESCRIPTION
		A11	OFF
			Hood trigger (Output Status).

	Program remote starter option:	FUNCTION	MODE	DESCRIPTION
		32	3	DK.Blue (GWR) Shut Down After

	Program remote starter option for R.S. OEM REMOTE STAND ALONE:	FUNCTION	MODE	DESCRIPTION
		38	2	Enable Press 3x Lock to remote start with the OEM remote.

MANDATORY INSTALL

* HOOD PIN



HOOD STATUS: THE HOOD PIN SWITCH (INCLUDED) MUST BE INSTALLED IF THE VEHICLE CAN BE REMOTE STARTED WITH THE HOOD OPEN, SET FUNCTION A11 TO OFF.

A11

OFF

SECURITY STICKER



Included

Notice: the installation of safety elements are mandatory. The hood pin and the sticker are essential security elements and must be installed.

THIS MODULE MUST BE INSTALLED BY A QUALIFIED TECHNICIAN. A WRONG CONNECTION CAN CAUSE PERMANENT DAMAGE TO THE VEHICLE.

DESCRIPTION

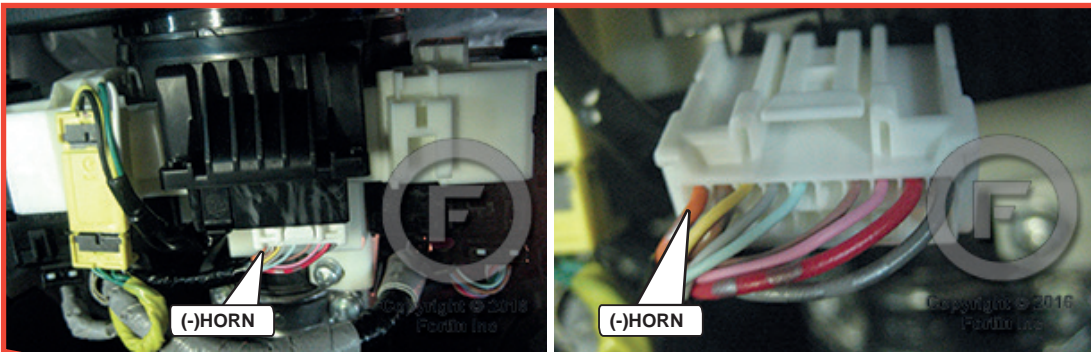
⑤ Steering column



Ignition key barrel

③ Parking lights harness

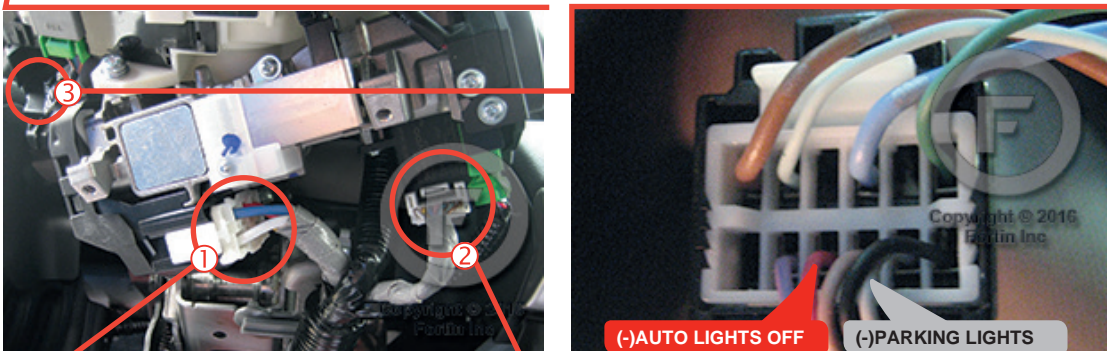

① Ignition harness

② immobiliser connector

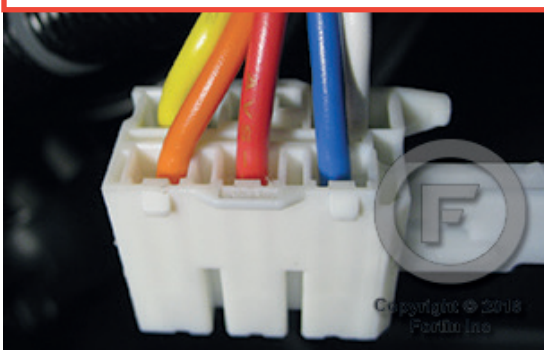

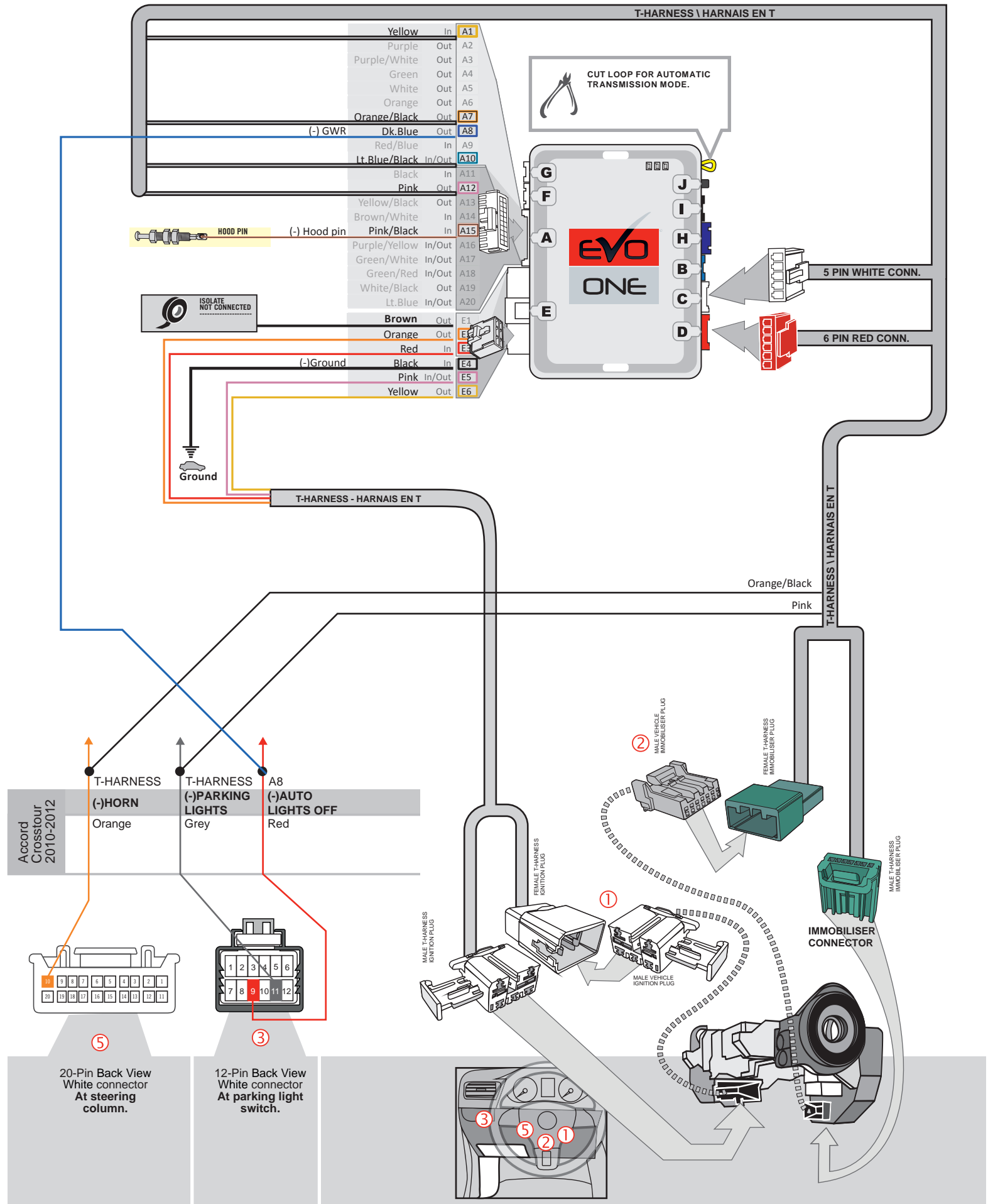

KEY BYPASS PROGRAMMING PROCEDURE

1

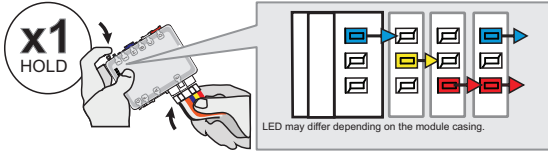

Press and hold the programming button:
Insert the 6-Pin Main connector.

↳ The LEDs will alternate between BLUE, RED, YELLOW & BLUE/RED flashes.

2

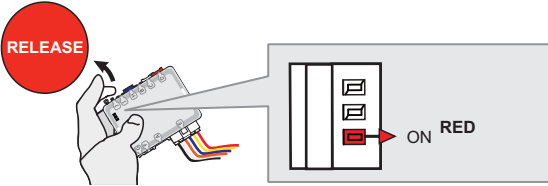

Release the programming button when the LED is RED.

If the LED is not solid RED disconnect the 6 Pin connector (Main-Harness) and go back to step 1.

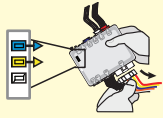

3

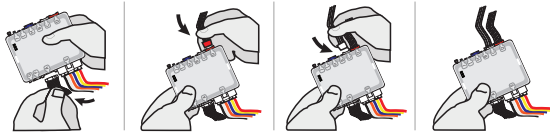

Insert the required remaining connectors.

4

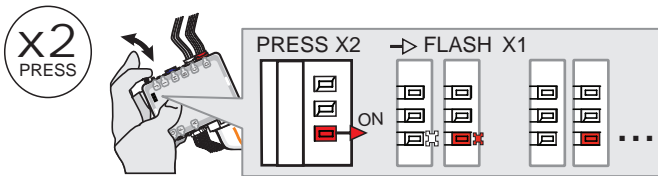

Press and release the programming button twice (2x).

↳ The RED LED will flash once and pause.

5

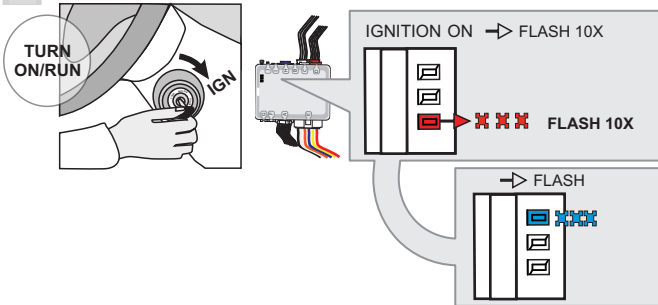

Turn the Ignition to the ON/RUN position.

↳ The RED LED will flash rapidly 10x times.
Key bypass programmed.

↳ The BLUE LED will flash rapidly.
CAN-Bus programmed.

6

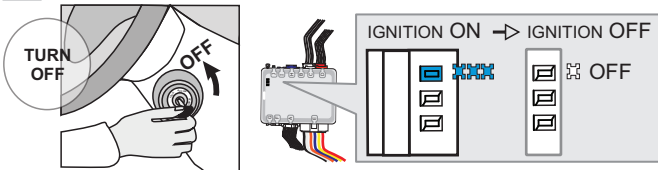

Turn the Ignition to the OFF position.

↳ The BLUE LED will turn off.



The module is now programmed.

Use the remote of the remote starter or security system to test all of the supported features to ensure proper programming.

REMOTE STARTER PROGRAMMING PROCEDURE



REFER TO THE **QUICK INSTALL GUIDE** INCLUDED WITH THE MODULE FOR THE REMOTE STARTER PROGRAMMING.

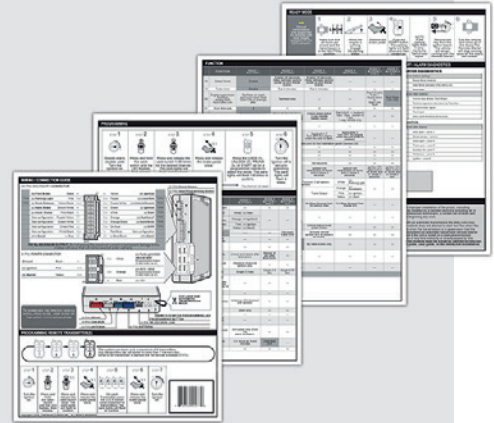

THAR-ONE-HON5 T-HARNESS INSTALLATION

ADDENDUM - SUGGESTED WIRING CONFIGURATION

VEHICLE	YEARS	Vehicle functions supported in this diagram (functional if equipped)																
		Immobilizer Bypass	T-Harness Harmais en T	Lock	Unlock	Arm	Disarm	Trunk (open)	Horn	Parking Lights	Tachometer	Door Status	Trunk Status	Hood Status*	Hand-Brake Status	Foot-Brake Status	OEM Remote Monitoring	R.S. OEM remote Stand Alone compatible
HONDA																		
Pilot	2009-2015	•	•	•	•	•	•	•	•	•	•	•	•	•	•	•	•	•







BYPASS FIRMWARE VERSION

73.[38]

HONDA/ACURA MINIMUM

To add the firmware version and the options, use the **FLASH LINK UPDATER** or **FLASH LINK MOBILE** tool, sold separately.

	PROGRAM BYPASS OPTION:	UNIT OPTION	DESCRIPTION	
	Program bypass option:	C1	OEM Remote status (Lock/Unlock) monitoring	
		Program bypass option (If equipped with OEM alarm):	D2	Unlock before / Lock after (Disarm OEM alarm)
	IF THE VEHICLE IS NOT EQUIPPED WITH FUNCTIONAL HOOD PIN:		A11	OFF

	PROGRAM REMOTE STARTER OPTION:	FUNCTION	MODE	DESCRIPTION
	Program remote starter option:	32	3	DK.Blue (GWR) Shut Down After
		Program remote starter option for R.S. OEM REMOTE STAND ALONE:	38	2

MANDATORY INSTALL
*** HOOD PIN**

HOOD STATUS: THE HOOD PIN SWITCH (INCLUDED) MUST BE INSTALLED IF THE VEHICLE CAN BE REMOTE STARTED WITH THE HOOD OPEN, SET FUNCTION A11 TO OFF.

A11
OFF
SECURITY STICKER



Included

Notice: the installation of safety elements are mandatory. The hood pin and the sticker are essential security elements and must be installed.

THIS MODULE MUST BE INSTALLED BY A QUALIFIED TECHNICIAN. A WRONG CONNECTION CAN CAUSE PERMANENT DAMAGE TO THE VEHICLE.

DESCRIPTION

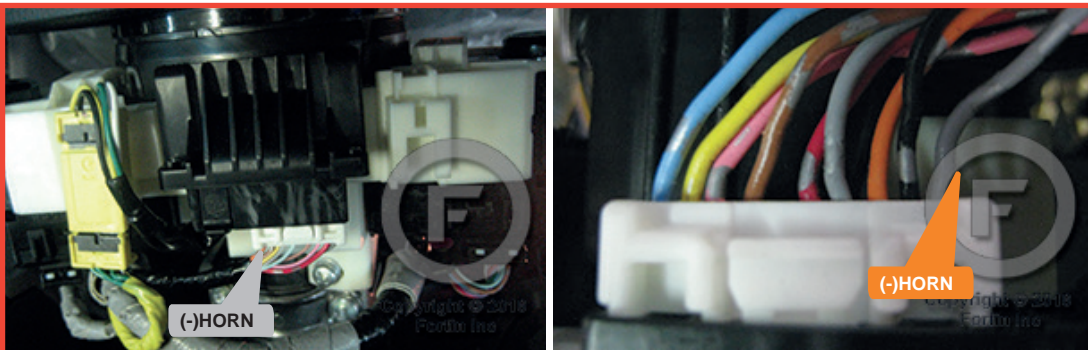
⑤ Steering column



Ignition key barrel

③ Parking lights harness

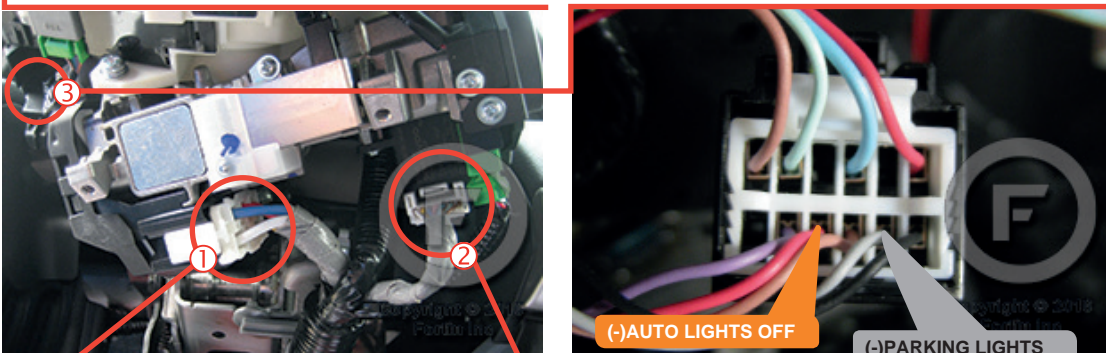

① Ignition harness

② immobiliser connector

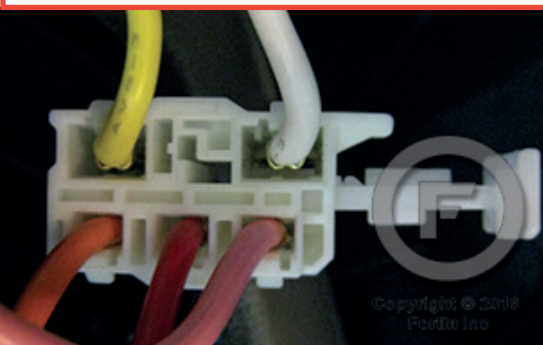

AUTOMATIC TRANSMISSION WIRING CONNECTION

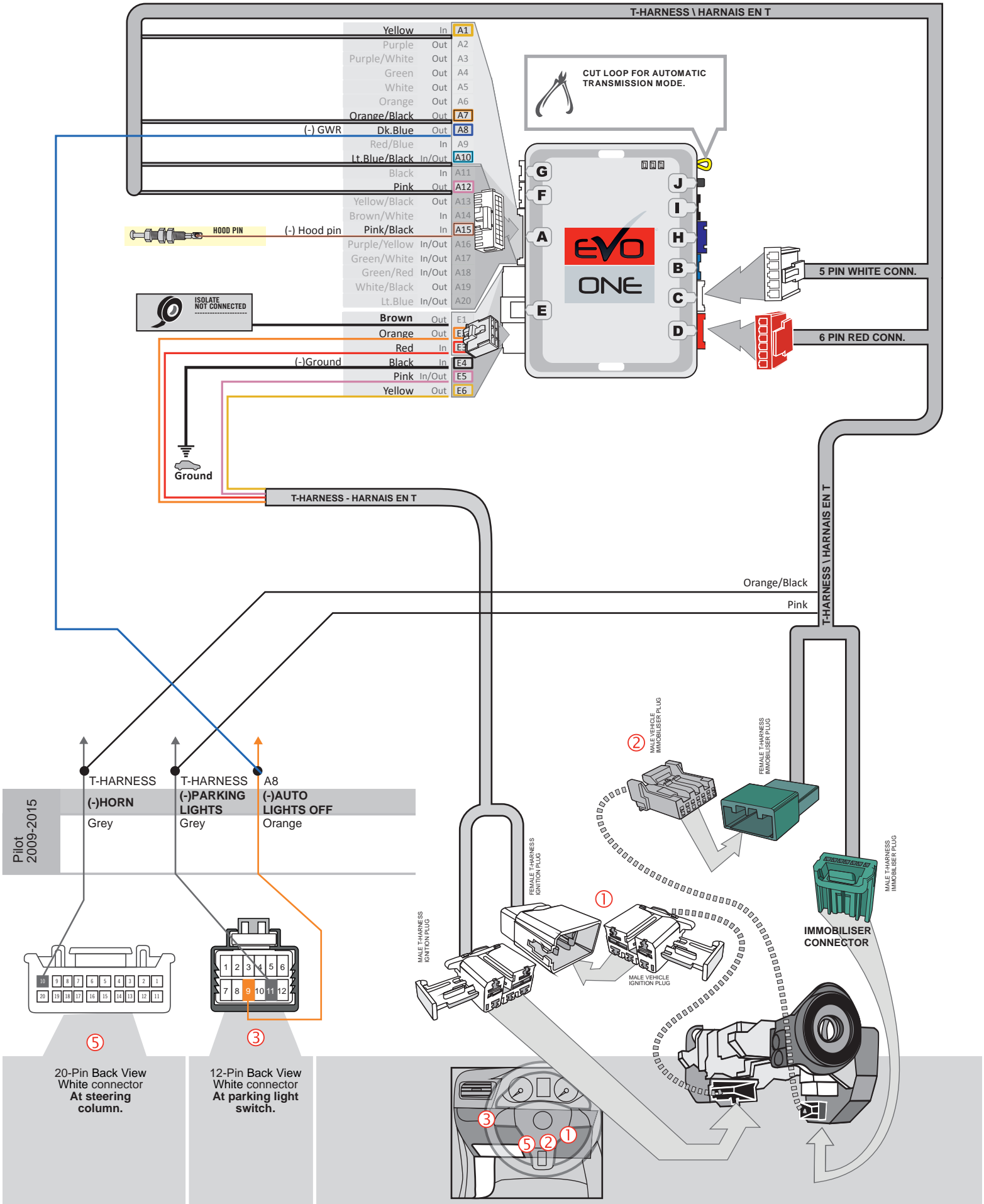

KEY BYPASS PROGRAMMING PROCEDURE

1

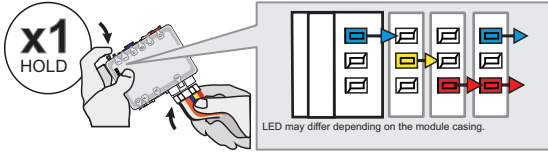

Press and hold the programming button:
Insert the 6-Pin Main connector.

↳ The LEDs will alternate between BLUE, RED, YELLOW & BLUE/RED flashes.

2

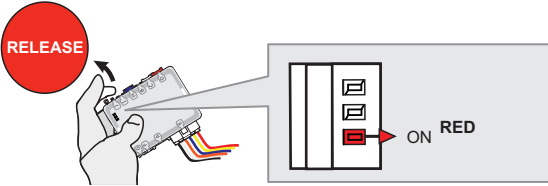

Release the programming button when the LED is RED.

If the LED is not solid RED disconnect the 6 Pin connector (Main-Harness) and go back to step 1.

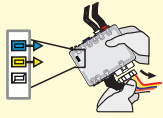

3

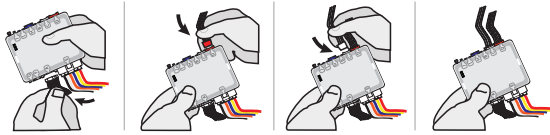

Insert the required remaining connectors.

4

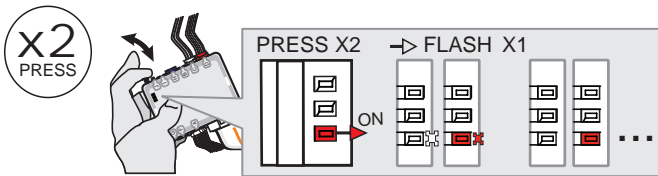

Press and release the programming button twice (2x).

↳ The RED LED will flash once and pause.

5

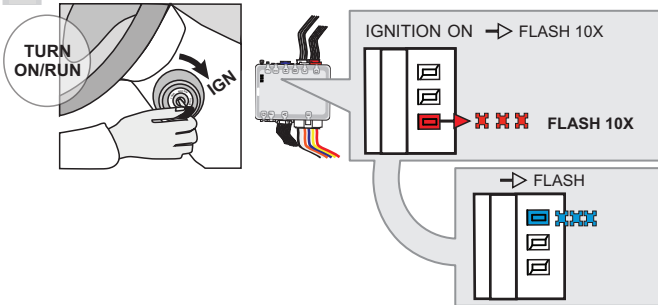

Turn the Ignition to the ON/RUN position.

↳ The RED LED will flash rapidly 10x times.
Key bypass programmed.

↳ The BLUE LED will flash rapidly.
CAN-Bus programmed.

6

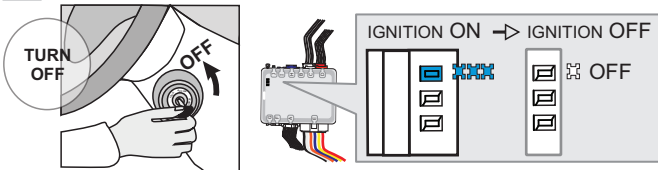

Turn the Ignition to the OFF position.

↳ The BLUE LED will turn off.



The module is now programmed.

Use the remote of the remote starter or security system to test all of the supported features to ensure proper programming.

REMOTE STARTER PROGRAMMING PROCEDURE



REFER TO THE **QUICK INSTALL GUIDE** INCLUDED WITH THE MODULE FOR THE REMOTE STARTER PROGRAMMING.

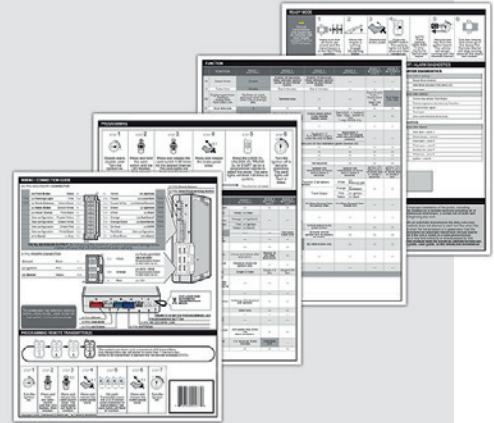

THAR-ONE-HON5 T-HARNESS INSTALLATION

ADDENDUM - SUGGESTED WIRING CONFIGURATION

VEHICLE	YEARS	Vehicle functions supported in this diagram (functional if equipped)															
		Immobilizer Bypass	T-Harness Harness en T	Lock	Unlock	Arm	Disarm	Trunk (open)	Horn	Parking Lights	Tachometer	Door Status	Trunk Status	Hood Status*	Hand-Brake Status	Foot-Brake Status	OEM Remote Monitoring
ACURA	TL	2009-2014	•	•	•	•	•	•	•	•	•	•	•	•	•	•	•

BYPASS FIRMWARE VERSION

73.[38]

HONDA/ACURA MINIMUM

To add the firmware version and the options, use the **FLASH LINK UPDATER** or **FLASH LINK MOBILE** tool, sold separately.

	Program bypass option:	UNIT OPTION	DESCRIPTION
		C1	OEM Remote status (Lock/Unlock) monitoring

	Program bypass option (if equipped with OEM alarm):	UNIT OPTION	DESCRIPTION
		D2	Unlock before / Lock after (Disarm OEM alarm)

	Program remote starter option:	FUNCTION	MODE	DESCRIPTION
		32	3	DK.Blue (GWR) Shut Down After

MANDATORY INSTALL

* HOOD PIN



HOOD STATUS: THE HOOD PIN SWITCH (INCLUDED) MUST BE INSTALLED IF THE VEHICLE CAN BE REMOTE STARTED WITH THE HOOD OPEN, SET FUNCTION **A11** TO OFF.

A11

OFF

SECURITY STICKER



Included

Notice: the installation of safety elements are mandatory. The hood pin and the sticker are essential security elements and must be installed.

THIS MODULE MUST BE INSTALLED BY A QUALIFIED TECHNICIAN. A WRONG CONNECTION CAN CAUSE PERMANENT DAMAGE TO THE VEHICLE.

DESCRIPTION

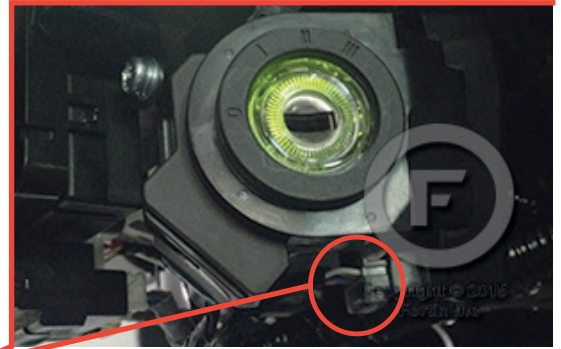
② Ignition key barrel



AUTOMATIC TRANSMISSION WIRING CONNECTION

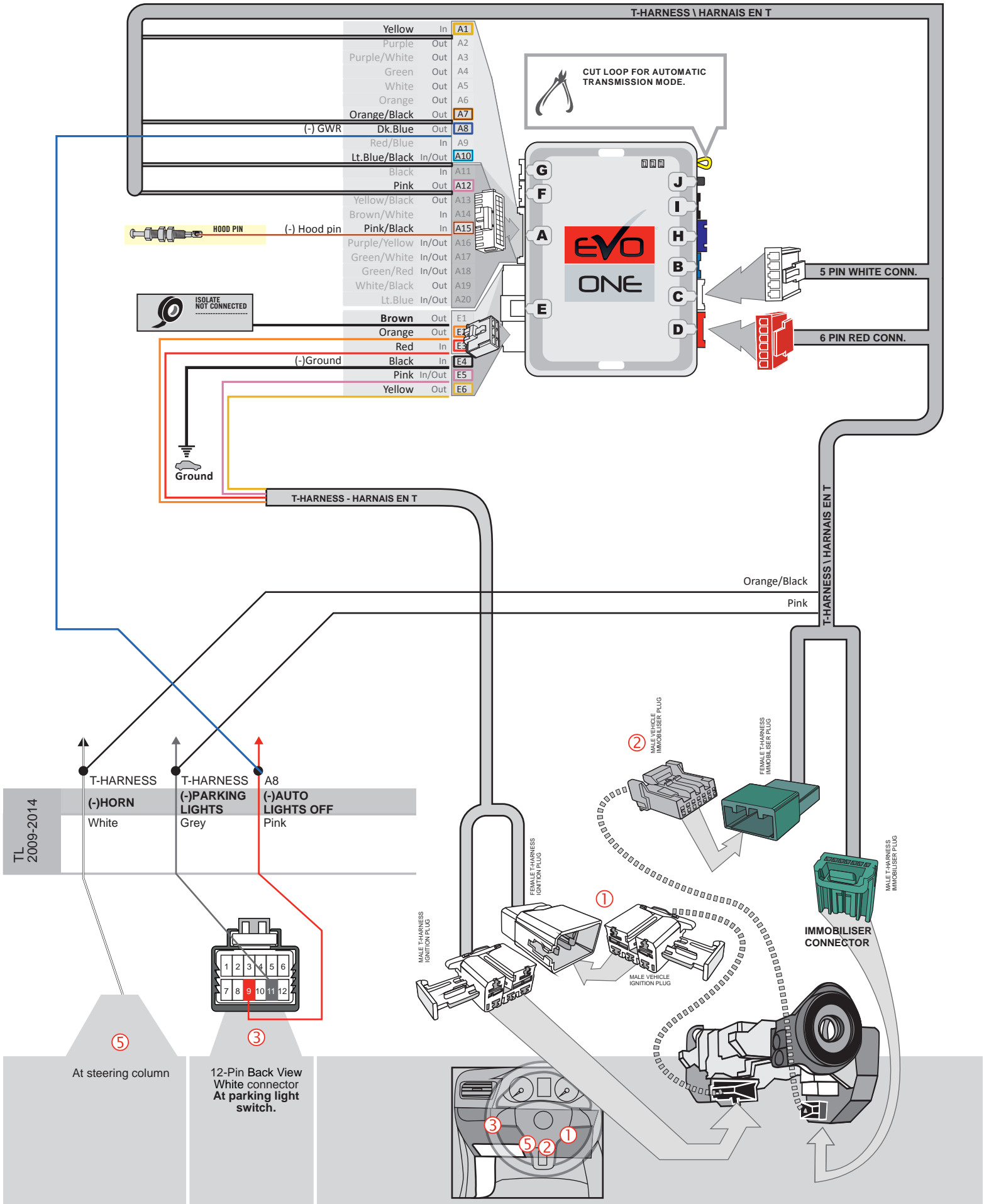

KEY BYPASS PROGRAMMING PROCEDURE

1

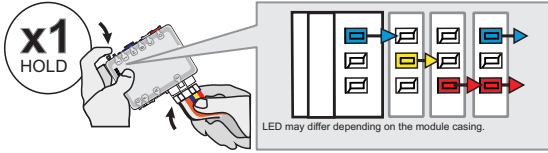

Press and hold the programming button:
Insert the 6-Pin Main connector.

↳ The LEDs will alternate between BLUE, RED, YELLOW & BLUE/RED flashes.

2

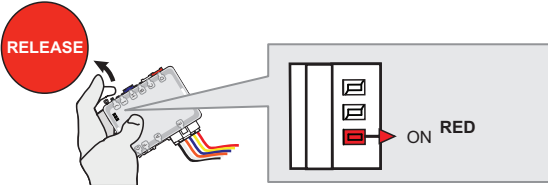

Release the programming button when the LED is RED.

If the LED is not solid RED disconnect the 6 Pin connector (Main-Harness) and go back to step 1.

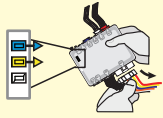

3

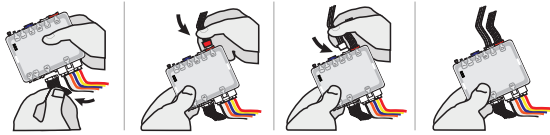

Insert the required remaining connectors.

4

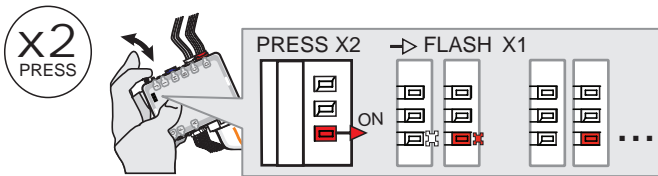

Press and release the programming button twice (2x).

↳ The RED LED will flash once and pause.

5

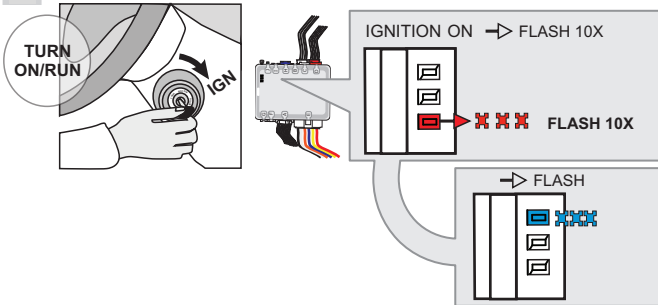

Turn the Ignition to the ON/RUN position.

↳ The RED LED will flash rapidly 10x times.
Key bypass programmed.

↳ The BLUE LED will flash rapidly.
CAN-Bus programmed.

6

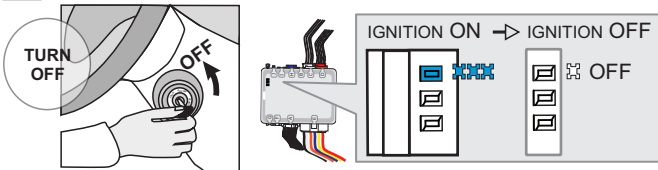

Turn the Ignition to the OFF position.

↳ The BLUE LED will turn off.



The module is now programmed.

Use the remote of the remote starter or security system to test all of the supported features to ensure proper programming.

REMOTE STARTER PROGRAMMING PROCEDURE



REFER TO THE **QUICK INSTALL GUIDE** INCLUDED WITH THE MODULE FOR THE REMOTE STARTER PROGRAMMING.

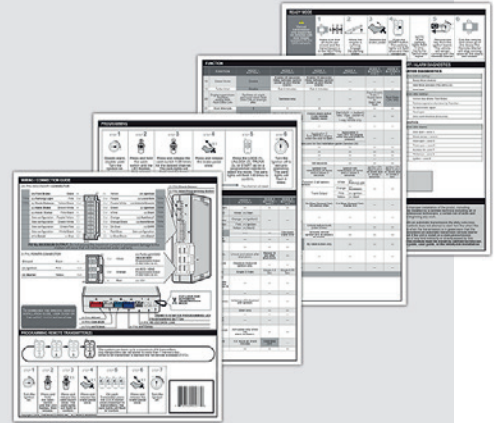

THAR-ONE-HON5 T-HARNESS INSTALLATION

ADDENDUM - SUGGESTED WIRING CONFIGURATION

VEHICLE	YEARS	Vehicle functions supported in this diagram (functional if equipped)																
		Immobilizer Bypass	T-Harness Harmais en T	Lock	Unlock	Arm	Disarm	Trunk (open)	Horn	Parking Lights	Tachometer	Door Status	Trunk Status	Hood Status*	Hand-Brake Status	Foot-Brake Status	OEM Remote Monitoring	R.S. OEM remote Stand Alone compatible
ACURA																		
TSX	2009-2014	•	•	•	•	•	•	•	•	•	•	•	•	•	•	•	•	•

BYPASS FIRMWARE VERSION

73.[38]

HONDA/ACURA MINIMUM

To add the firmware version and the options, use the **FLASH LINK UPDATER** or **FLASH LINK MOBILE** tool, sold separately.

	Program bypass option:	UNIT OPTION	DESCRIPTION
		C1	OEM Remote status (Lock/Unlock) monitoring

	Program bypass option (If equipped with OEM alarm):	UNIT OPTION	DESCRIPTION
		D2	Unlock before / Lock after (Disarm OEM alarm)

	IF THE VEHICLE IS NOT EQUIPPED WITH FUNCTIONAL HOOD PIN:	A11	OFF	Hood trigger (Output Status).
--	--	------------	------------	-------------------------------

	Program remote starter option:	FUNCTION	MODE	DESCRIPTION
		32	3	DK.Blue (GWR) Shut Down After

	Program remote starter option for R.S. OEM REMOTE STAND ALONE:	FUNCTION	MODE	DESCRIPTION
		38	2	Enable Press 3x Lock to remote start with the OEM remote.

MANDATORY INSTALL

*** HOOD PIN**

HOOD STATUS: THE HOOD PIN SWITCH (INCLUDED) MUST BE INSTALLED IF THE VEHICLE CAN BE REMOTE STARTED WITH THE HOOD OPEN, SET FUNCTION A11 TO OFF.

A11

OFF

SECURITY STICKER

Included

Notice: the installation of safety elements are mandatory. The hood pin and the sticker are essential security elements and must be installed.

THIS MODULE MUST BE INSTALLED BY A QUALIFIED TECHNICIAN. A WRONG CONNECTION CAN CAUSE PERMANENT DAMAGE TO THE VEHICLE.

DESCRIPTION

5 Steering column

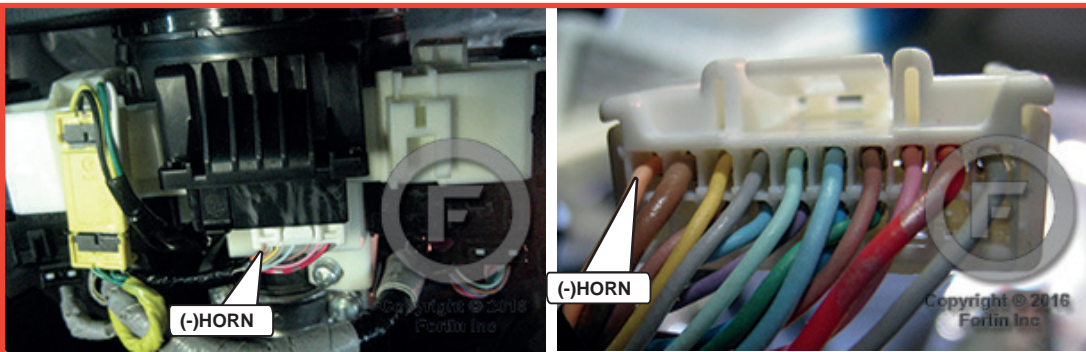

Ignition key barrel

3 Parking lights harness

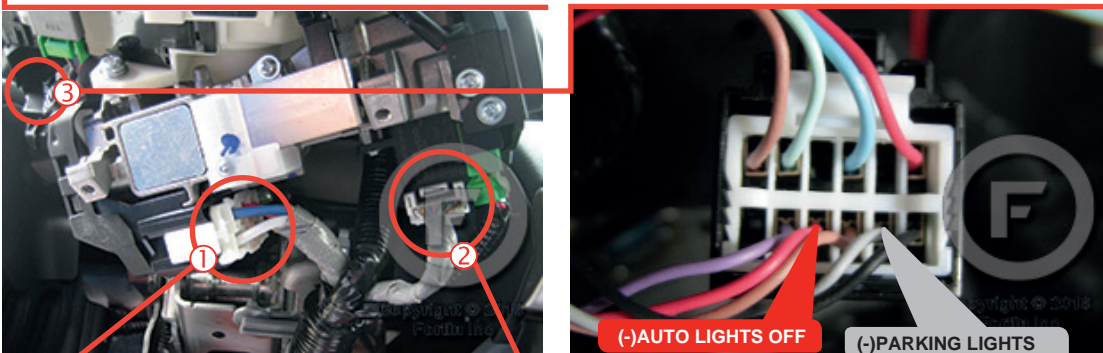

1 Ignition harness

2 immobiliser connector

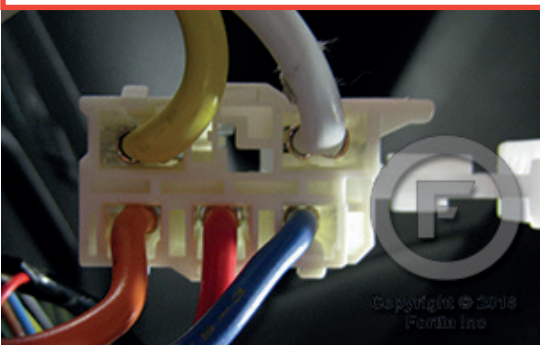

AUTOMATIC TRANSMISSION WIRING CONNECTION

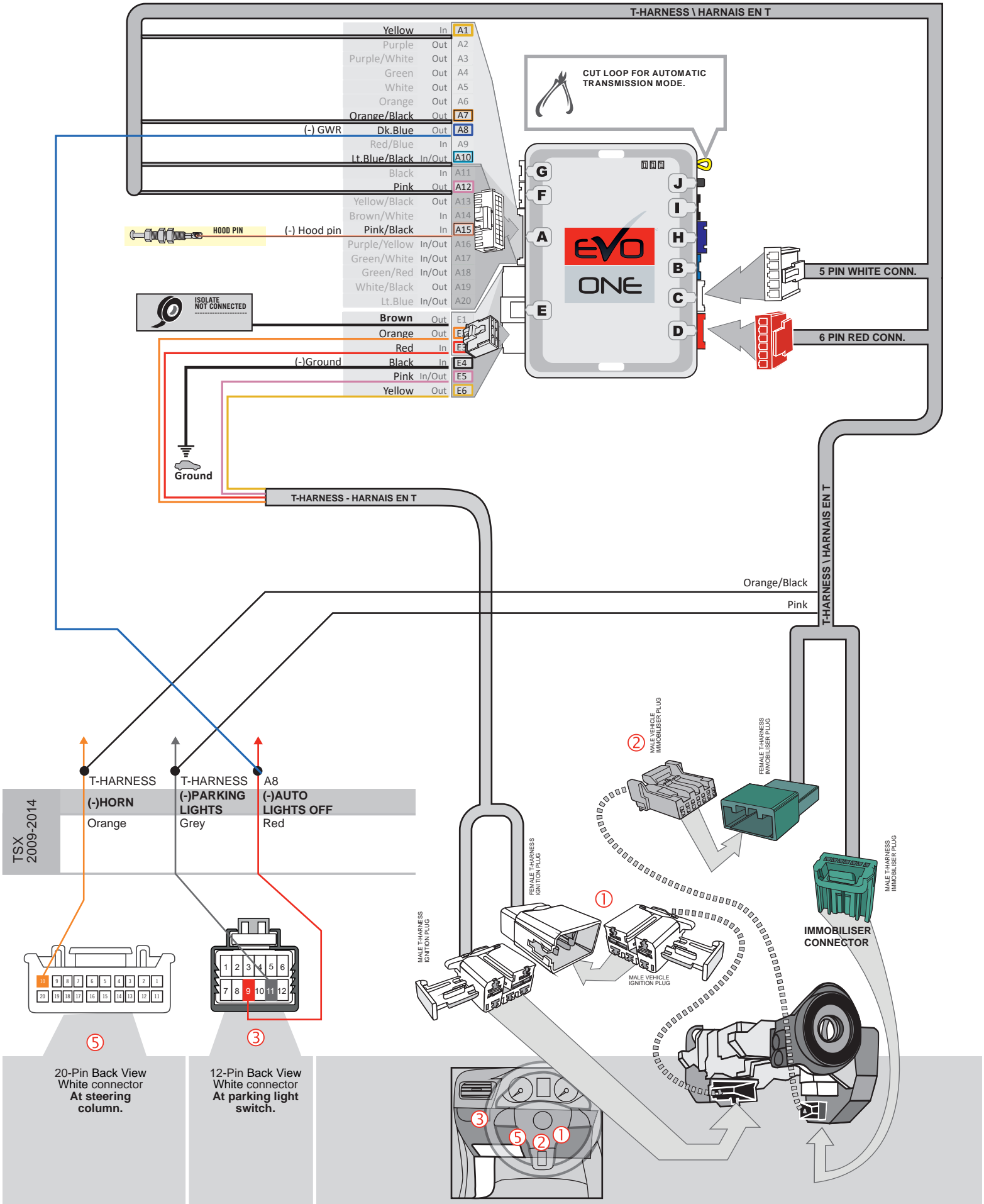

MANUAL TRANSMISSION WIRING CONNECTION

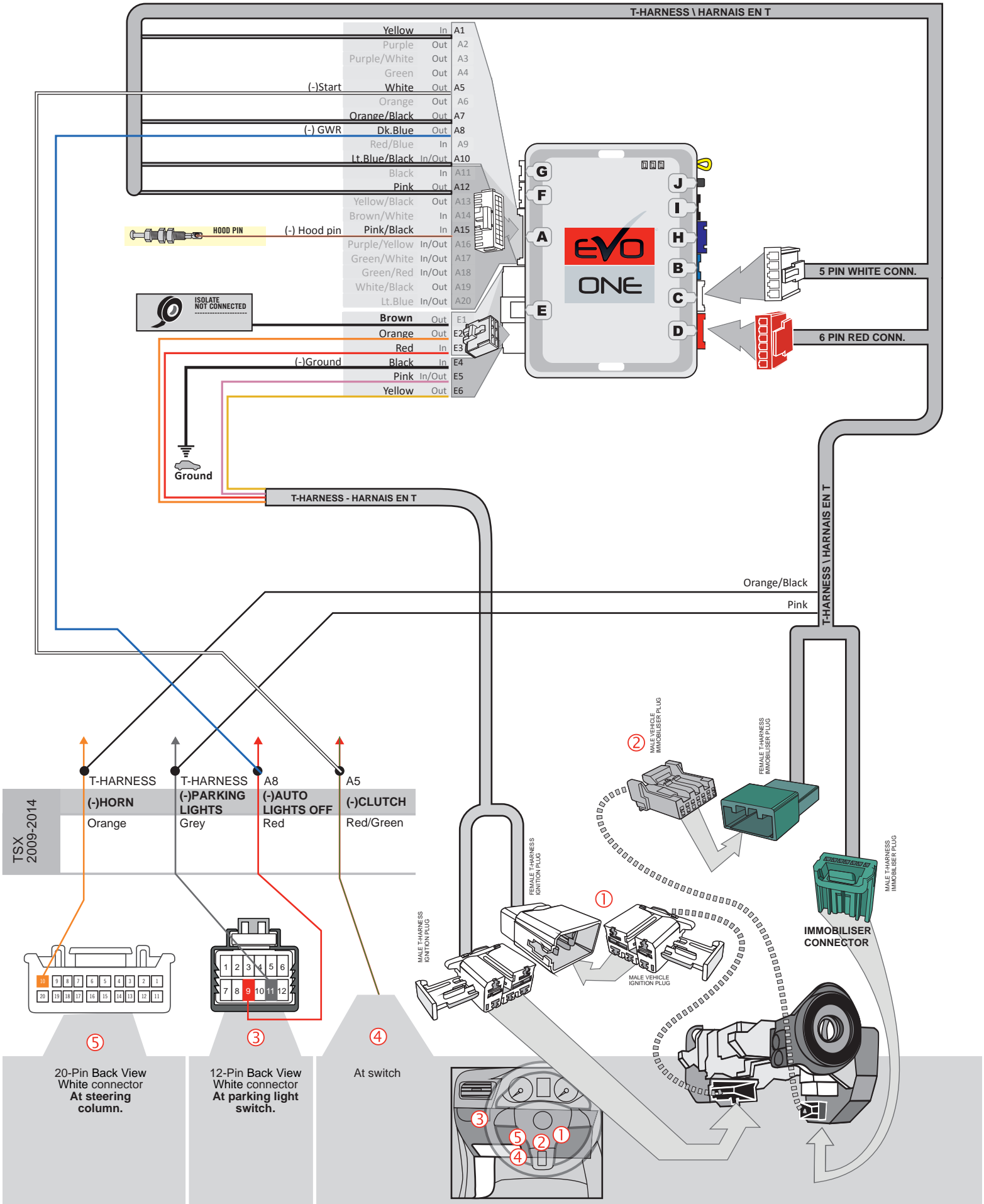

TSX 2009-2014

KEY BYPASS PROGRAMMING PROCEDURE

1

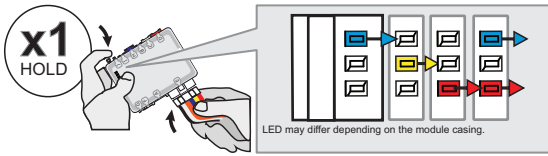

Press and hold the programming button:
Insert the 6-Pin Main connector.

↳ The LEDs will alternate between BLUE, RED, YELLOW & BLUE/RED flashes.

2

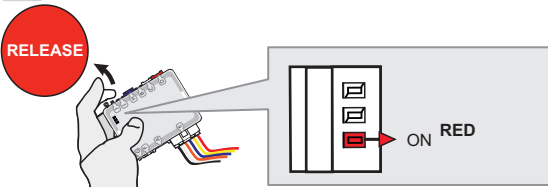

Release the programming button when the LED is RED.

If the LED is not solid RED disconnect the 6 Pin connector (Main-Harness) and go back to step 1.

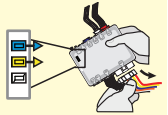

3

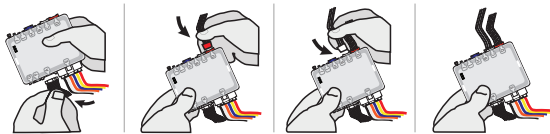

Insert the required remaining connectors.

4

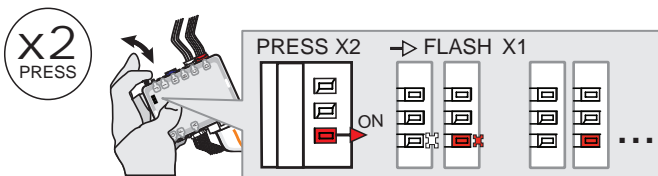

Press and release the programming button twice (2x).

↳ The RED LED will flash once and pause.

5

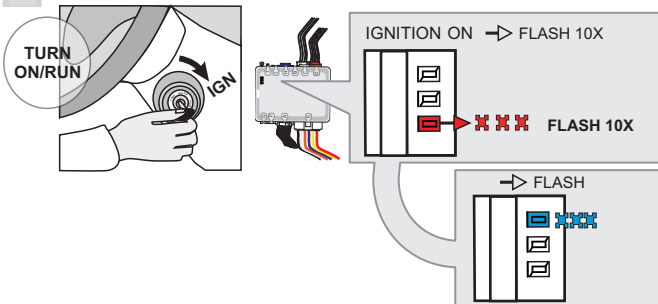

Turn the Ignition to the ON/RUN position.

↳ The RED LED will flash rapidly 10x times.
Key bypass programmed.

↳ The BLUE LED will flash rapidly.
CAN-Bus programmed.

6

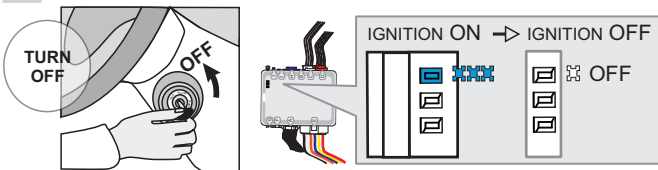

Turn the Ignition to the OFF position.

↳ The BLUE LED will turn off.



The module is now programmed.

Use the remote of the remote starter or security system to test all of the supported features to ensure proper programming.

REMOTE STARTER PROGRAMMING PROCEDURE



REFER TO THE **QUICK INSTALL GUIDE** INCLUDED WITH THE MODULE FOR THE REMOTE STARTER PROGRAMMING.

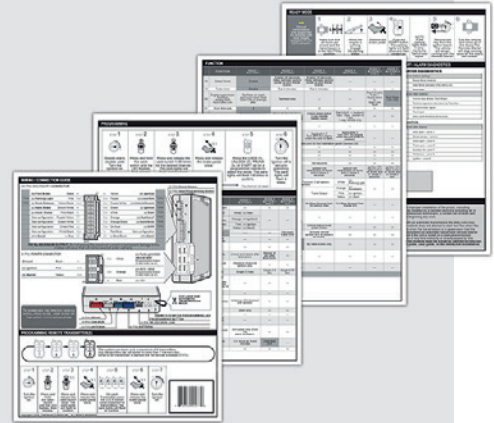

THAR-ONE-HON5 T-HARNESS INSTALLATION

ADDENDUM - SUGGESTED WIRING CONFIGURATION

VEHICLE	YEARS	Vehicle functions supported in this diagram (functional if equipped)																
		Immobilizer Bypass	T-Harness	Lock	Unlock	Arm	Disarm	Trunk (open)	Horn	Parking Lights	Tachometer	Door Status	Trunk Status	Hood Status*	Hand-Brake Status	Foot-Brake Status	OEM Remote Monitoring	R.S. OEM remote Stand-Alone compatible
ACURA																		
ZDX	2010-2013	•	•	•	•	•	•	•	•	•	•	•	•	•	•	•	•	•

BYPASS FIRMWARE VERSION

73.[38]

HONDA/ACURA MINIMUM

To add the firmware version and the options, use the **FLASH LINK UPDATER** or **FLASH LINK MOBILE** tool, sold separately.

		UNIT OPTION	DESCRIPTION
	Program bypass option:	C1	OEM Remote status (Lock/Unlock) monitoring

		UNIT OPTION	DESCRIPTION
	Program bypass option (If equipped with OEM alarm):	D2	Unlock before / Lock after (Disarm OEM alarm)

	IF THE VEHICLE IS NOT EQUIPPED WITH FUNCTIONAL HOOD PIN:	A11	OFF		Hood trigger (Output Status).
--	---	------------	------------	--	-------------------------------

		FUNCTION	MODE	DESCRIPTION
	Program remote starter option:	32	3	DK.Blue (GWR) Shut Down After

		FUNCTION	MODE	DESCRIPTION
	Program remote starter option for R.S. OEM REMOTE STAND ALONE:	38	2	Enable Press 3x Lock to remote start with the OEM remote.

MANDATORY INSTALL
*** HOOD PIN**

HOOD STATUS: THE HOOD PIN SWITCH (INCLUDED) MUST BE INSTALLED IF THE VEHICLE CAN BE REMOTE STARTED WITH THE HOOD OPEN, SET FUNCTION A11 TO OFF.

A11
OFF
SECURITY STICKER

Included

Notice: the installation of safety elements are mandatory. The hood pin and the sticker are essential security elements and must be installed.

THIS MODULE MUST BE INSTALLED BY A QUALIFIED TECHNICIAN. A WRONG CONNECTION CAN CAUSE PERMANENT DAMAGE TO THE VEHICLE.

DESCRIPTION

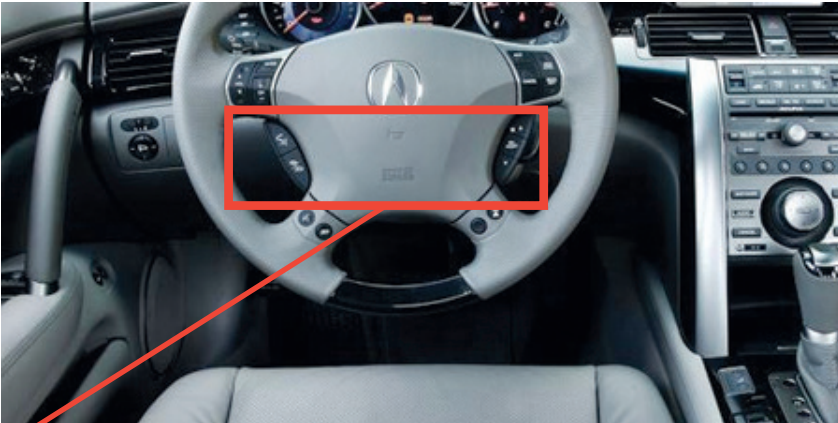

Ignition key barrel

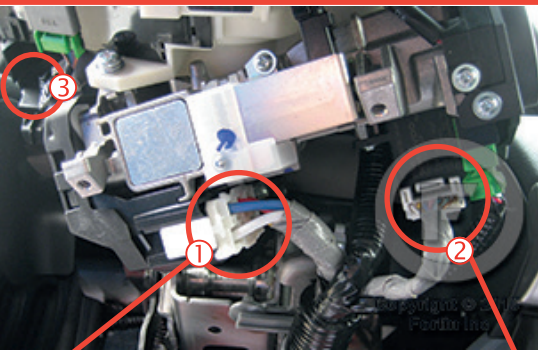

① Ignition harness

② immobiliser connector

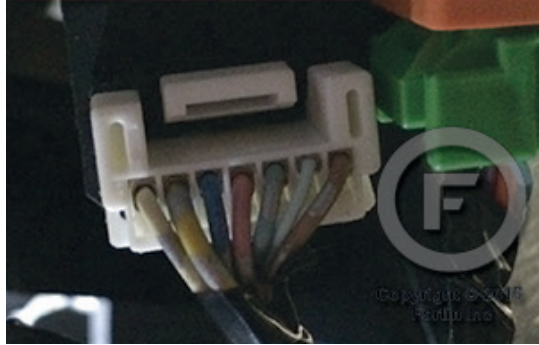

KEY BYPASS PROGRAMMING PROCEDURE

1

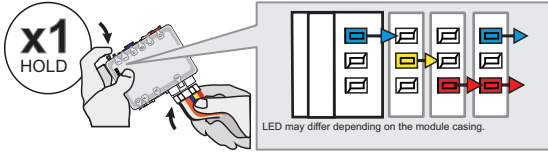

Press and hold the programming button:
Insert the 6-Pin Main connector.

↳ The LEDs will alternate between BLUE, RED, YELLOW & BLUE/RED flashes.

2

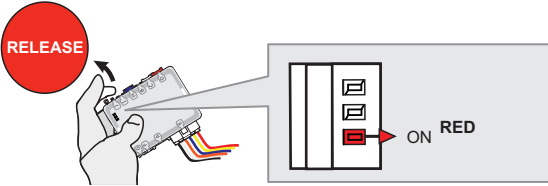

Release the programming button when the LED is RED.

If the LED is not solid RED disconnect the 6 Pin connector (Main-Harness) and go back to step 1.

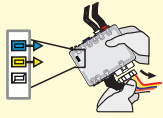

3

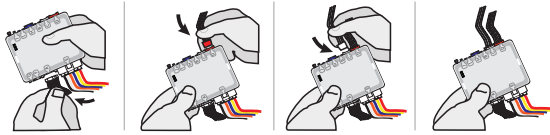

Insert the required remaining connectors.

4

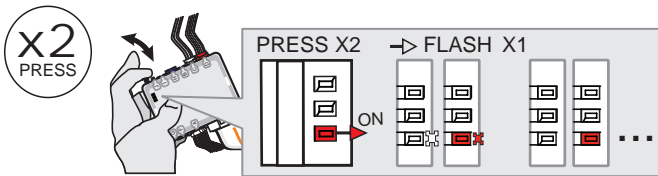

Press and release the programming button twice (2x).

↳ The RED LED will flash once and pause.

5

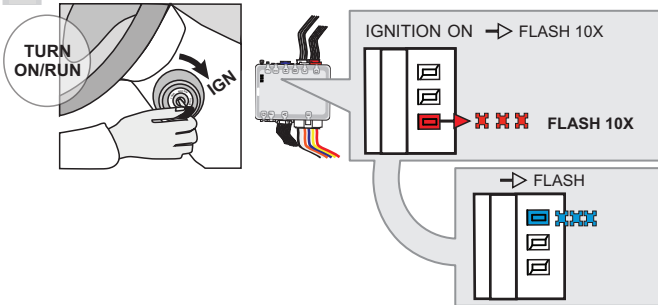

Turn the Ignition to the ON/RUN position.

↳ The RED LED will flash rapidly 10x times.
Key bypass programmed.

↳ The BLUE LED will flash rapidly.
CAN-Bus programmed.

6

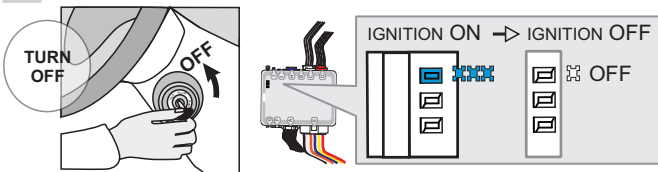

Turn the Ignition to the OFF position.

↳ The BLUE LED will turn off.



The module is now programmed.

Use the remote of the remote starter or security system to test all of the supported features to ensure proper programming.



REFER TO THE **QUICK INSTALL GUIDE** INCLUDED WITH THE MODULE FOR THE REMOTE STARTER PROGRAMMING.

