

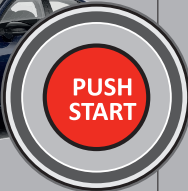

THAR-AUD2

THARNESS INSTALLATION

ADDENDUM - SUGGESTED WIRING CONFIGURATION

Vehicle functions supported in this diagram (functional if equipped)

VEHICLE	YEARS	 	Key Control	Lock	Unlock	Arm	Disarm	Trunk (open)	Tachometer	Door Status	Trunk Status	Hood Status*	Hand-Brake Status	Foot-Brake Status	AUX.1 Comfort Group		OEM Remote monitoring**
			Heated Seats	Rear defrost													
AUDI																	
A6 - S6	Push-to-Start	2019-2021	•	•	•	•	•	•	•	•	•	•	•	•	•	•	•
A7 - S7	Push-to-Start	2019-2021	•	•	•	•	•	•	•	•	•	•	•	•	•	•	•
A8 - S8	Push-to-Start	2019-2021	•	•	•	•	•	•	•	•	•	•	•	•	•	•	•
SQ8	Push-to-Start	2020-2021	•	•	•	•	•	•	•	•	•	•	•	•	•	•	•
RS6	Push-to-Start	2021	•	•	•	•	•	•	•	•	•	•	•	•	•	•	•
RS7	Push-to-Start	2019-2021	•	•	•	•	•	•	•	•	•	•	•	•	•	•	•





FIRMWARE VERSION

61.[12]

VW MINIMUM

To add the firmware version and the options, use the **FLASH LINK UPDATER** or **FLASH LINK MOBILE** tool, sold separately.

	PROGRAM BYPASS OPTION:	UNIT OPTION	DESCRIPTION
	Program bypass option:	C1	OEM Remote status (Lock/Unlock) monitoring
	Program bypass option:	D6	Push-to-Start



Parts required (Not included)

- 1x Vehicle Key
- 1x 1 AMP Diode

NOTES



**1 KEY REQUIRED FOR THE
INSTALLATION**

MANDATORY INSTALL

*HOOD PIN



HOOD STATUS: THE HOOD PIN SWITCH MUST BE INSTALLED IF THE VEHICLE CAN BE REMOTE STARTED WITH THE HOOD OPEN, SET FUNCTION A11 TO OFF.

A11

OFF

Notice: the installation of safety elements are mandatory. The hood pin is an essential security element and must be installed.

THIS MODULE MUST BE INSTALLED BY A QUALIFIED TECHNICIAN. A WRONG CONNECTION CAN CAUSE PERMANENT DAMAGE TO THE VEHICLE.

DESCRIPTION



① Rear BCM, in the trunk.

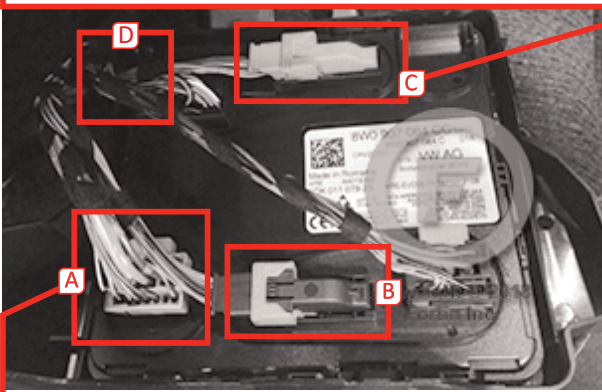

WIRING CONNECTION

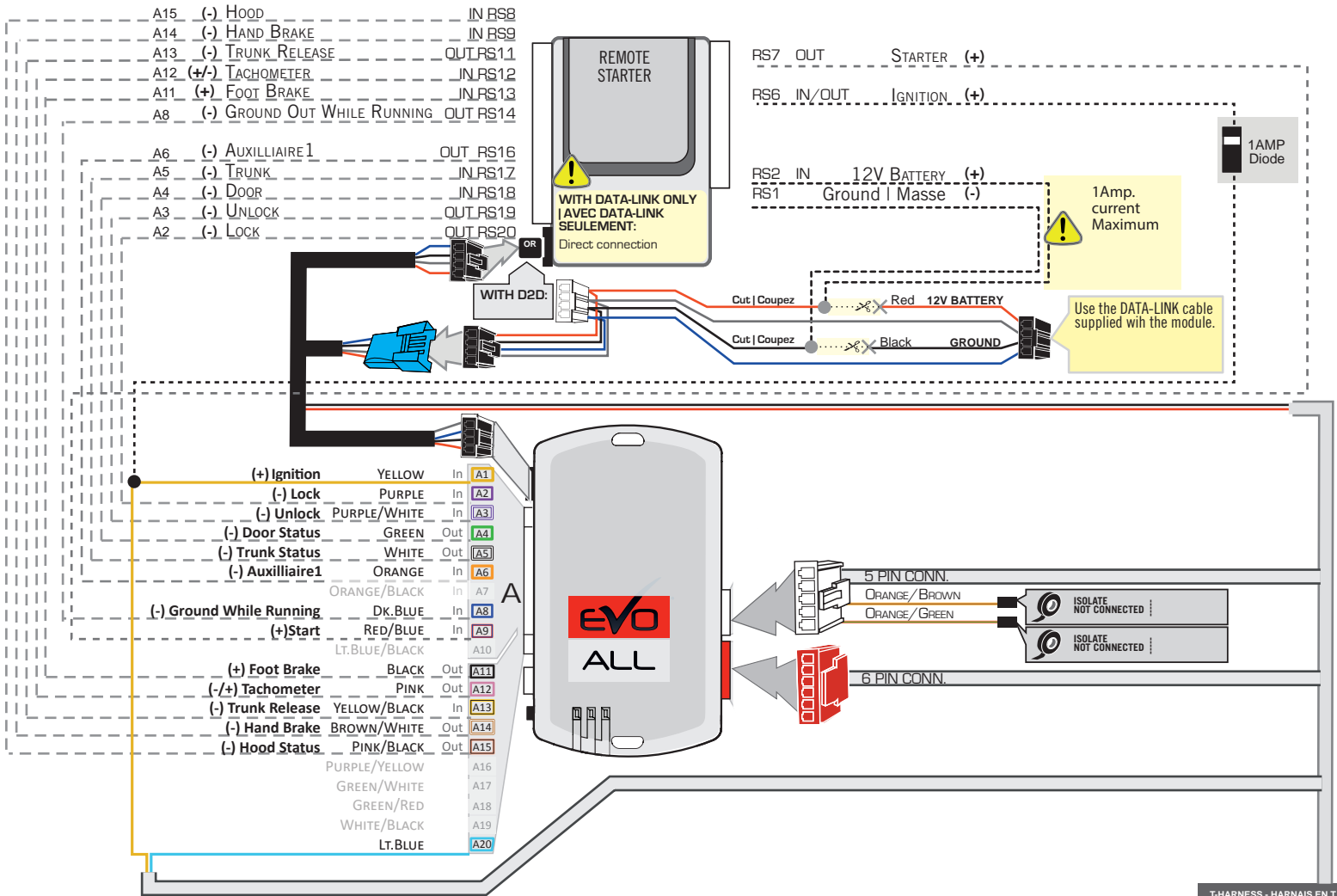

T-HARNISS - HARNAIS EN T
THAR-AUD2

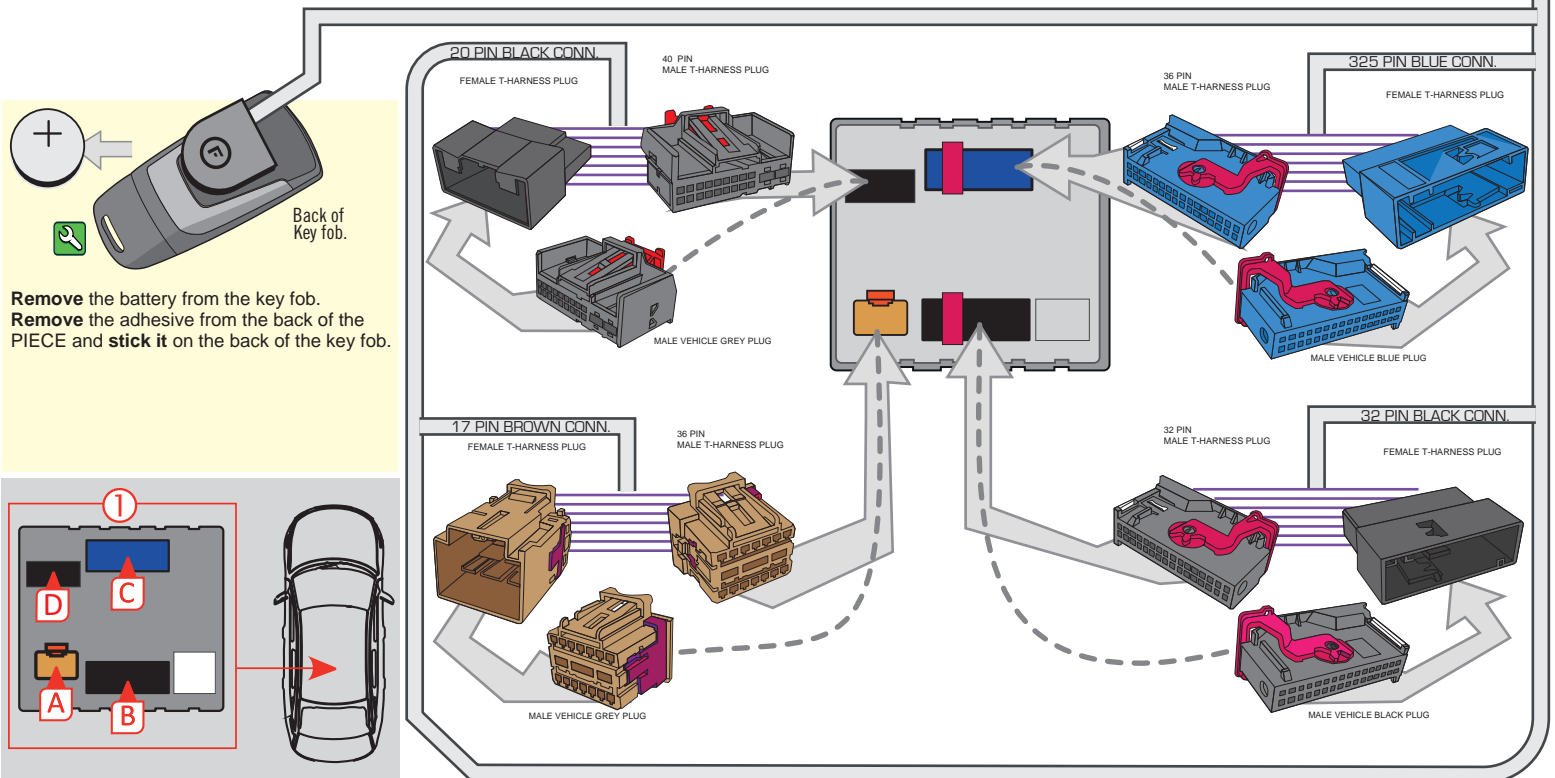

PROGRAMMING PROCEDURE

1

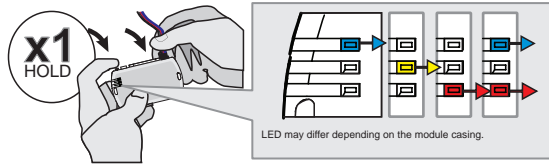

Press and hold the programming button:
Connect the 4-PIN Data-link harness (Black connector).

↳ The Blue, Red, Yellow and Blue & Red LEDs will alternatively illuminate.

2

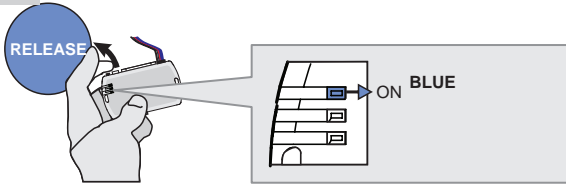

Release the programming button when the LED is BLUE.

Relâchez le bouton de programmation quand la DEL est BLEU.

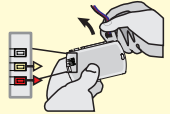

3

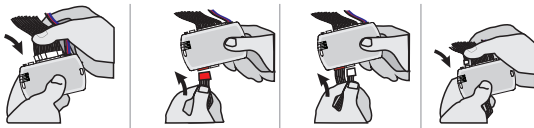

Insert the required remaining connectors.

4

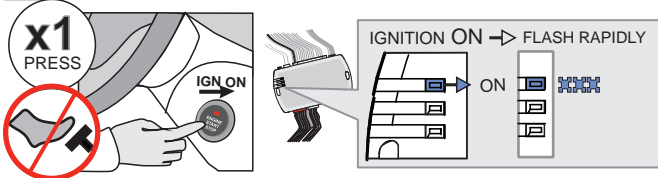

Do not press the brake pedal.
Press the Push-to-Start button once to turn on the ignition.

↳ The BLUE LED will flash rapidly.

5

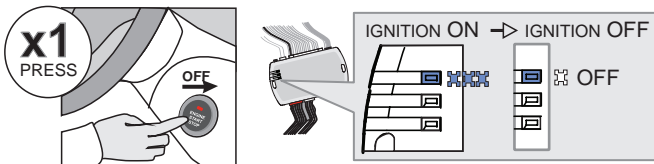

Press the Push-to-Start button once to turn off the ignition.

↳ The BLUE LED will turn off.



The module is now programmed.

REMOTE STARTER FUNCTIONALITY



All doors must be closed.

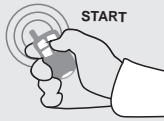

Remote start the vehicle.



Unlock the doors with either:

- The OEM remote
- The remote-starter remote.

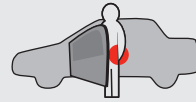

Enter the vehicle with the Intelligent SmartKey.



The vehicle can now be put in to gear and driven.

REGULAR INSTALLATION

ADDENDUM - SUGGESTED WIRING CONFIGURATION

VEHICLE	YEARS	Vehicle functions supported in this diagram (functional if equipped)														
		Key Control	Lock	Unlock	Arm	Disarm	Trunk (open)	Tachometer	Door Status	Trunk Status	Hood Status*	Hand-Brake Status	Foot-Brake Status	AUX.1 Comfort Group		OEM Remote monitoring**
AUDI																
A4	Push-to-Start	2017-2020	•	•	•	•	•	•	•	•	•	•	•	•	•	•
A5	Push-to-Start	2018-2020	•	•	•	•	•	•	•	•	•	•	•	•	•	•
A5 / S5 Sportback	Push-to-Start	2018-2020	•	•	•	•	•	•	•	•	•	•	•	•	•	•
Q5	Push-to-Start	2018-2020	•	•	•	•	•	•	•	•	•	•	•	•	•	•
Q7	Push-to-Start	2017-2021	•	•	•	•	•	•	•	•	•	•	•	•	•	•
SQ5	Push-to-Start	2018-2020	•	•	•	•	•	•	•	•	•	•	•	•	•	•
RS4	Push-to-Start	2017-2020	•	•	•	•	•	•	•	•	•	•	•	•	•	•
RS 5 Coupe	Push-to-Start	2018-2020	•	•	•	•	•	•	•	•	•	•	•	•	•	•
S5 Coupe	Push-to-Start	2018-2020	•	•	•	•	•	•	•	•	•	•	•	•	•	•



FIRMWARE VERSION

61.[12]

VW MINIMUM

To add the firmware version and the options, use the **FLASH LINK UPDATER** or **FLASH LINK MOBILE** tool, sold separately.

	Program bypass option:	UNIT OPTION	DESCRIPTION
		C1	OEM Remote status (Lock/Unlock) monitoring
		D6	Push-to-Start



Parts required (Not included)

- 1x Vehicle Key
- 4x 1 AMP Diode
- 1x 10Amp Fuse

NOTES



1 KEY REQUIRED FOR THE INSTALLATION

MANDATORY INSTALL

*HOOD PIN



HOOD STATUS: THE HOOD PIN SWITCH MUST BE INSTALLED IF THE VEHICLE CAN BE REMOTE STARTED WITH THE HOOD OPEN, SET FUNCTION A11 TO OFF.

A11

OFF

Notice: the installation of safety elements are mandatory. The hood pin is an essential security element and must be installed.

THIS MODULE MUST BE INSTALLED BY A QUALIFIED TECHNICIAN. A WRONG CONNECTION CAN CAUSE PERMANENT DAMAGE TO THE VEHICLE.

DESCRIPTION

Rear BCM, left side of trunk.

①

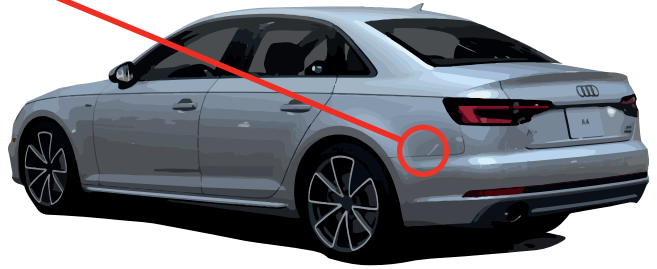

①

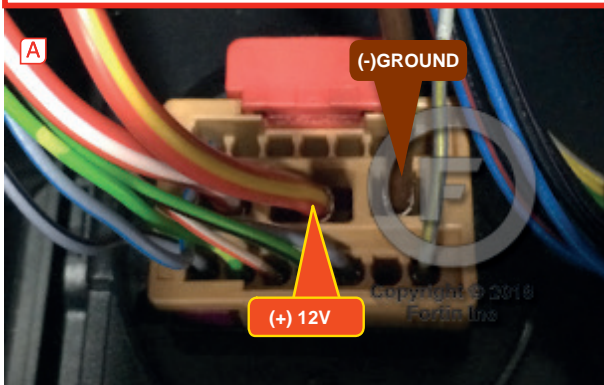
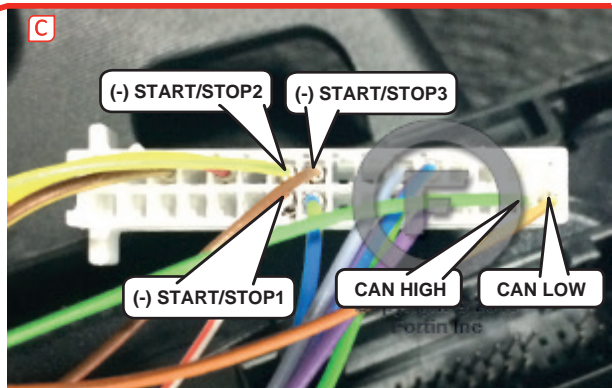
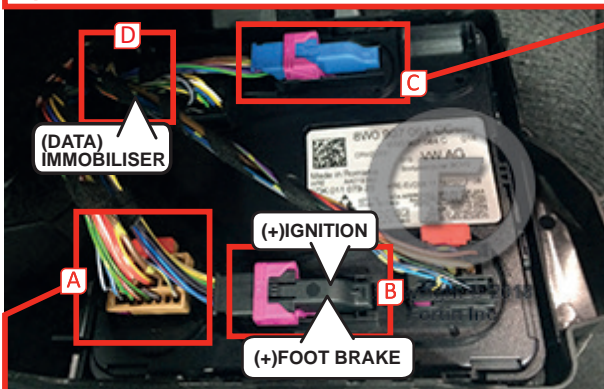

WIRING CONNECTION

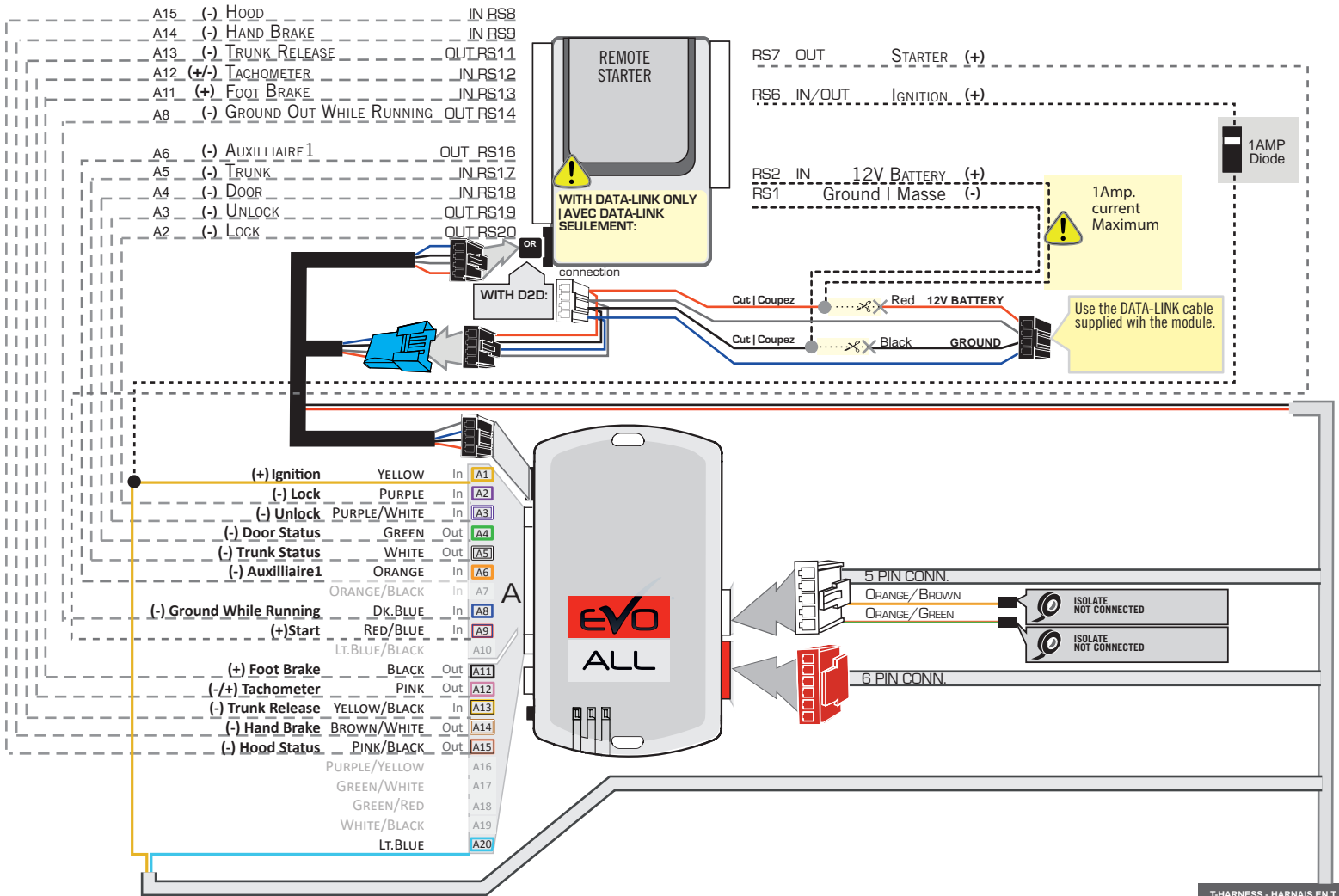

T-HARNES - HARNAIS EN T THAR-AUD2

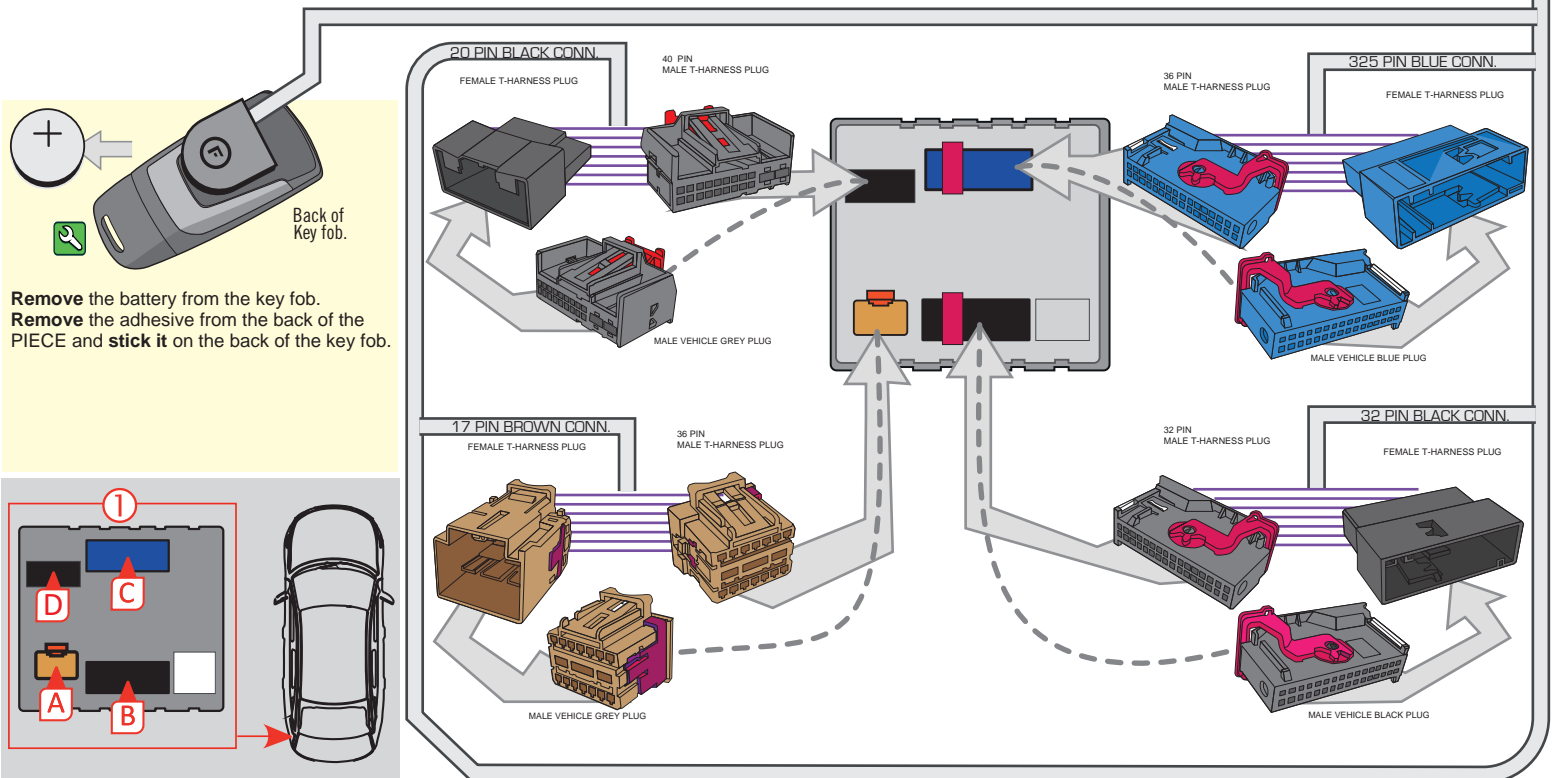

PROGRAMMING PROCEDURE

1

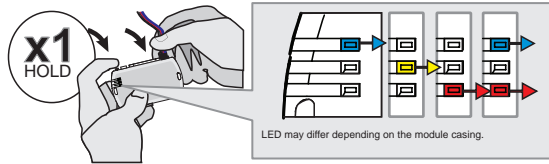

Press and hold the programming button:
Connect the 4-PIN Data-link harness (Black connector).

↳ The Blue, Red, Yellow and Blue & Red LEDs will alternatively illuminate.

2

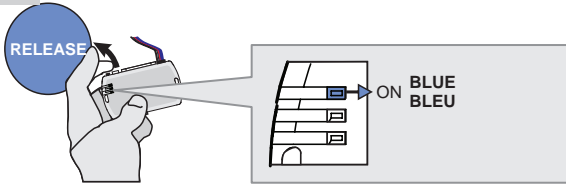

Release the programming button when the LED is BLUE.

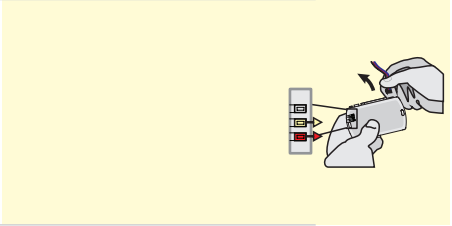

3

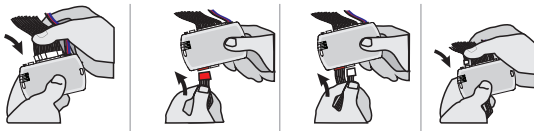

Insert the required remaining connectors.

4

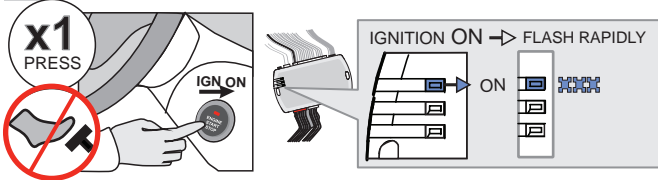

Do not press the brake pedal.
Press the Push-to-Start button once to turn on the ignition.
 ↳ The BLUE LED will flash rapidly.

5

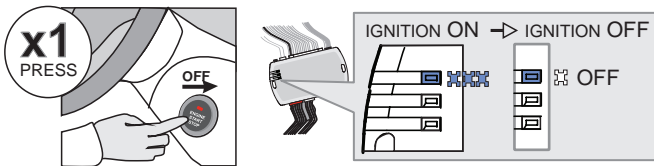

Press the Push-to-Start button once to turn off the ignition.
 ↳ The BLUE LED will turn off.



The module is now programmed.

REMOTE STARTER FUNCTIONALITY



All doors must be closed.

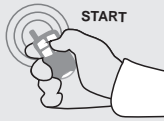

Remote start the vehicle.



Unlock the doors with either:

- The OEM remote
- The remote-starter remote.

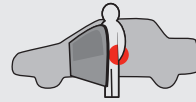

Enter the vehicle with the Intelligent SmartKey.



The vehicle can now be put in to gear and driven.

THAR-AUD2

THARNNESS STAND ALONE INSTALLATION

ADDENDUM - SUGGESTED WIRING CONFIGURATION



ONLY COMPATIBLE WITH AUTOMATIC TRANSMISSION VEHICLES.



Vehicle functions supported in this diagram (functional if equipped)

VEHICLE	YEARS	Key Control	Lock	Unlock	Arm	Disarm	Trunk (open)	Tachometer	Door Status	Trunk Status	Hood Status*	Hand-Brake Status	Foot-Brake Status	AUX.1 Comfort Group		OEM Remote monitoring**
														Heated Seats	Rear defrost	
AUDI																
A6 - S6	<i>Push-to-Start</i>	2019-2021	•	•	•	•	•	•	•	•	•	•	•	•	•	•
A7 - S7	<i>Push-to-Start</i>	2019-2021	•	•	•	•	•	•	•	•	•	•	•	•	•	•
A8 - S8	<i>Push-to-Start</i>	2019-2021	•	•	•	•	•	•	•	•	•	•	•	•	•	•
SQ8	<i>Push-to-Start</i>	2020-2021	•	•	•	•	•	•	•	•	•	•	•	•	•	•
RS6	<i>Push-to-Start</i>	2021	•	•	•	•	•	•	•	•	•	•	•	•	•	•
RS7	<i>Push-to-Start</i>	2019-2021	•	•	•	•	•	•	•	•	•	•	•	•	•	•



FIRMWARE VERSION

61.[11]

VW MINIMUM

To add the firmware version and the options, use the **FLASH LINK UPDATER** or **FLASH LINK MOBILE** tool, sold separately.



Program bypass option:

UNIT OPTION

DESCRIPTION

C1

OEM Remote status (Lock/Unlock) monitoring

D6

Push-to-Start

Program bypass option
OPTION COMFORT GROUP:

A5

OFF

AUTOMATIC TURN ON : option confort group

NOTES



1 KEY REQUIRED FOR THE INSTALLATION



Parts required (Not included)

1x Vehicle Key

MANDATORY INSTALL

*HOOD PIN



HOOD STATUS: THE HOOD PIN SWITCH MUST BE INSTALLED IF THE VEHICLE CAN BE REMOTE STARTED WITH THE HOOD OPEN, SET FUNCTION A11 TO OFF.

A11

OFF

Notice: the installation of safety elements are mandatory. The hood pin is an essential security element and must be installed.

THIS MODULE MUST BE INSTALLED BY A QUALIFIED TECHNICIAN. A WRONG CONNECTION CAN CAUSE PERMANENT DAMAGE TO THE VEHICLE.

PARTS REQUIRED (NOT INCLUDED)

1x **FLASH LINK UPDATER,**
 1x **FLASH LINK MANAGER**
 SOFTWARE | PROGRAMME
 1x Microsoft Windows Computer with Internet connection

OR

1x **FLASH LINK MOBILE**
 1x **FLASH LINK MOBILE APP**
 Smartphone *Android* or *iOS* with Internet connection (*provider charges may apply*).

MANDATORY

HOOD PIN



REMOTE START SAFETY OVERRIDE SWITCH

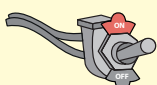





VALET SWITCH

Part #: RSPB available, Sold separately.

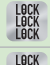
Notice: the installation of safety elements are mandatory. The hood pin and the valet switch are essential security elements and must be installed.

STAND ALONE CONFIGURATION

	Program bypass option	UNIT OPTION	DESCRIPTION
	OEM Remote Stand Alone Remote Starter:	D1.10 	By default, LOCK, LOCK, LOCK Par défaut, VERROUILLE, VERROUILLE, VERROUILLE
		D1.1 	
	Program bypass option with oem remote:	C1	OEM Remote Monitoring
	Program bypass option with RF KIT antenna:	H1 to H6	Supported RF Kits and select RF Kit

REMOTE STARTER FUNCTIONALITY



All doors must be closed.

3X 

Press the OEM remote's Lock button 3x to remote-start (or remote-stop) the vehicle.



START

The vehicle will START.

REMOTE STARTER DIAGNOSTICS
MODULE RED LED

x2 flash :	Brake ON
x3 flash :	No tach
x4 flash :	Ignition before start
x5 flash :	Hood Open

REMOTE STARTER WARNING CARD



CUT THIS WARNING CARD AND STICK IT ON A VISIBLE PLACE:
 or use the package **RSPB**, Sold separately.

WARNING | ATTENTION



REMOTE STARTER

THE VEHICLE CAN BE STARTED BY EITHER: PRESSING THE LOCK BUTTON ON THE OEM REMOTE 3 TIMES CONSECUTIVELY OR BY A SMARTPHONE. **TURN ON** THE SAFETY SWITCH LOCATED UNDER THE DASHBOARD BEFORE WORKING ON THE VEHICLE.

DESCRIPTION



① Rear BCM, in the trunk.

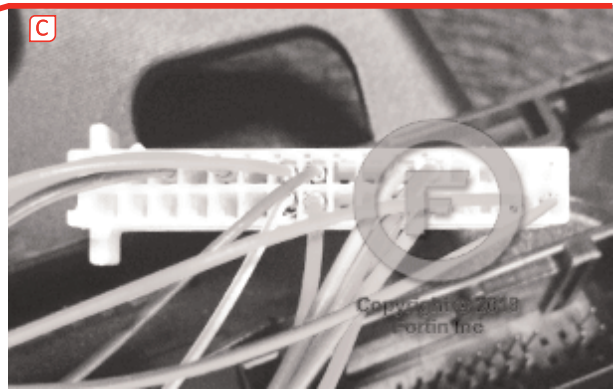
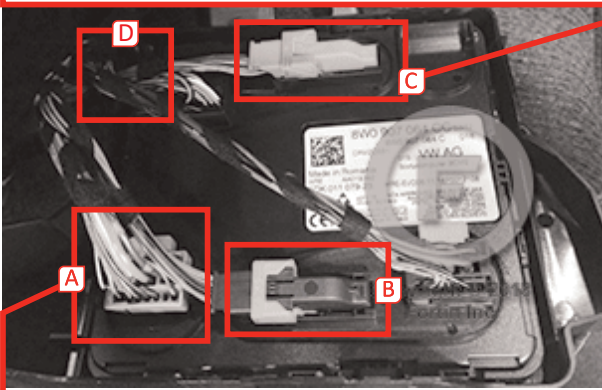

AUTOMATIC TRANSMISSION WIRING CONNECTION

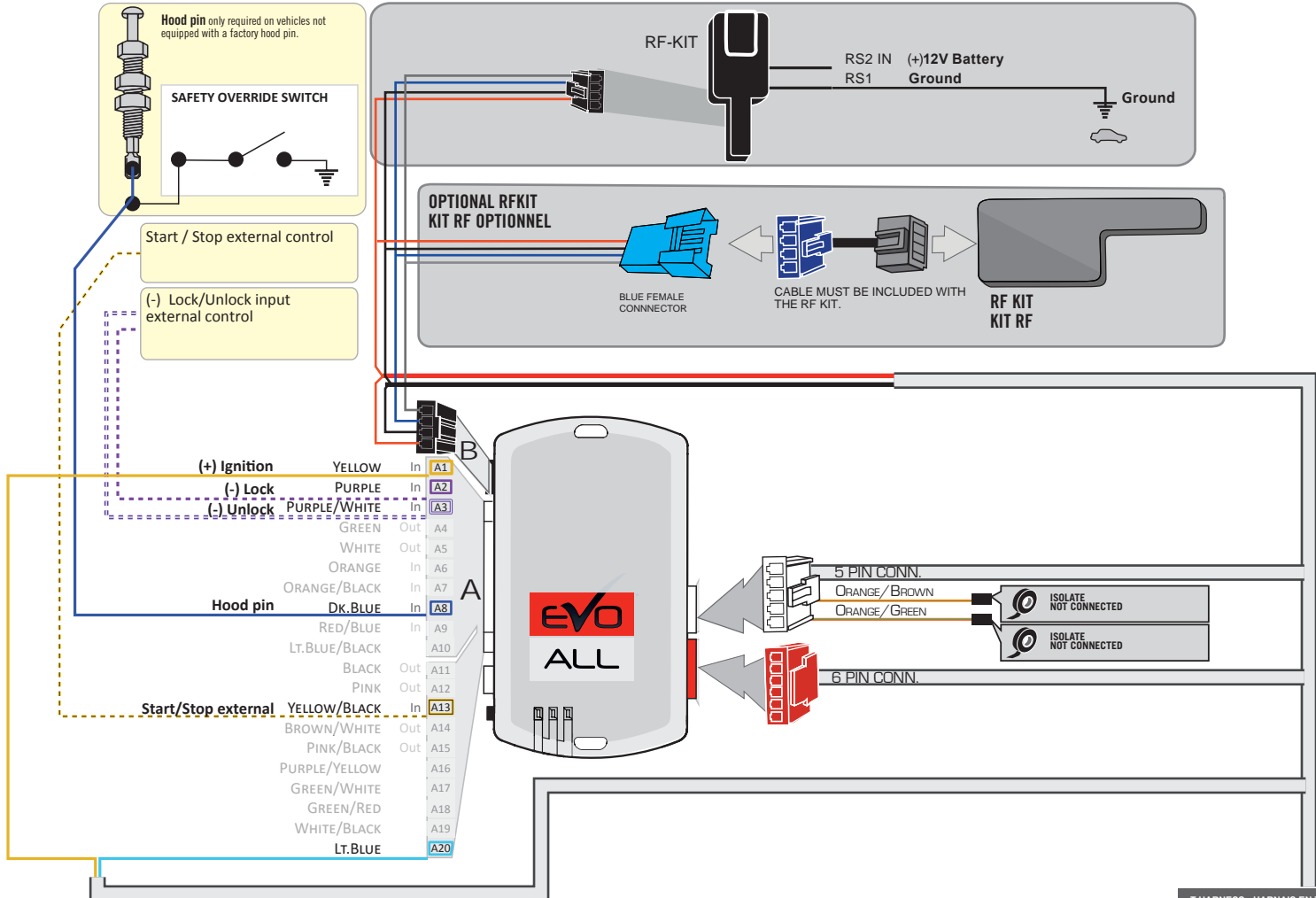

T-HARNESS - HARNAIS EN T
THAR-AUD2

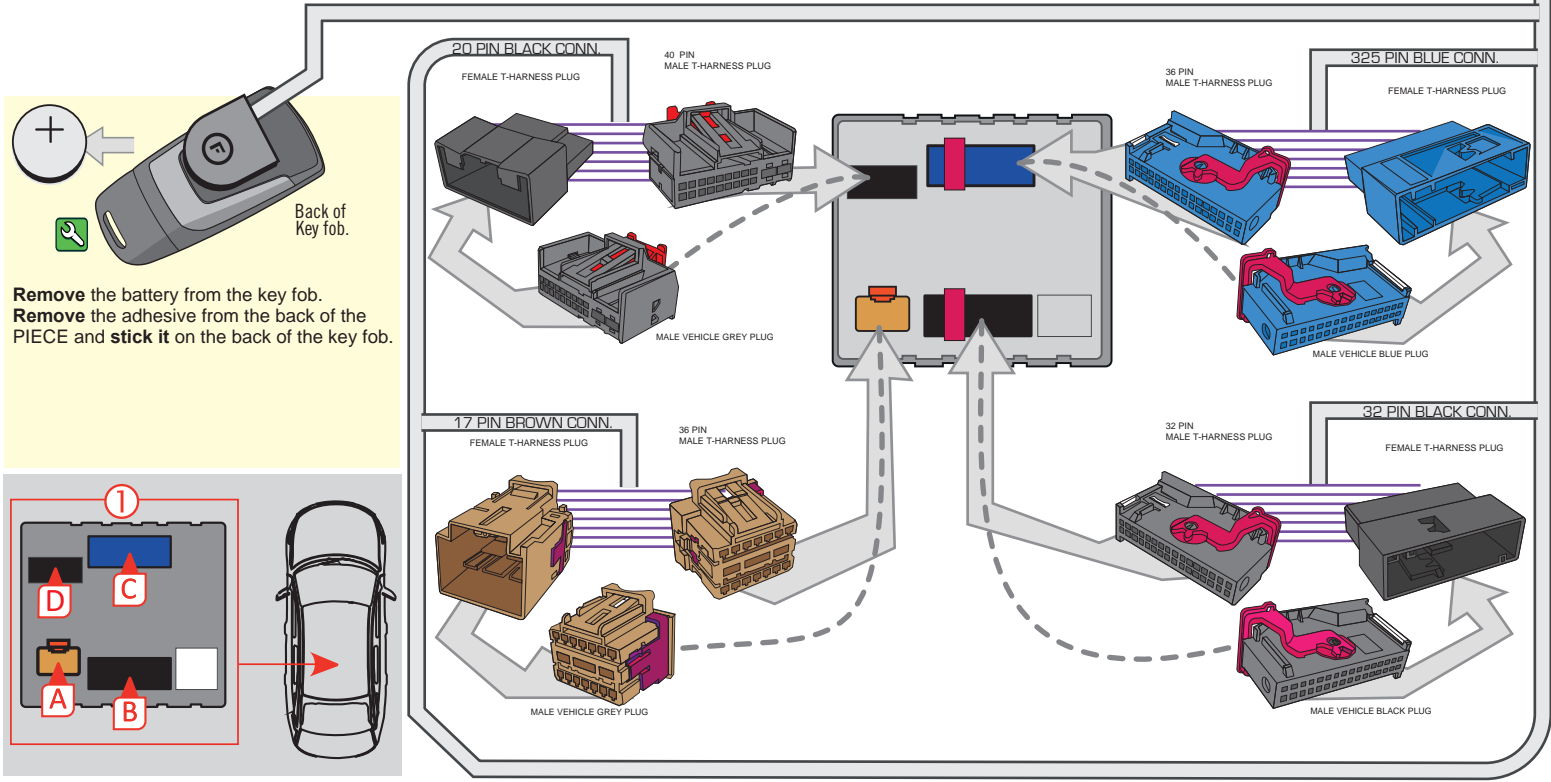

PROGRAMMING PROCEDURE

1

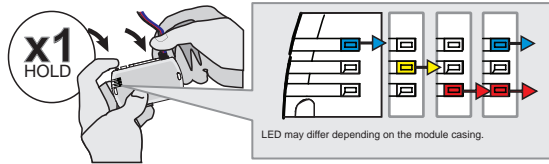

Press and hold the programming button:
Connect the 4-PIN Data-link harness (Black connector).

↳ The Blue, Red, Yellow and Blue & Red LEDs will alternatively illuminate.

2

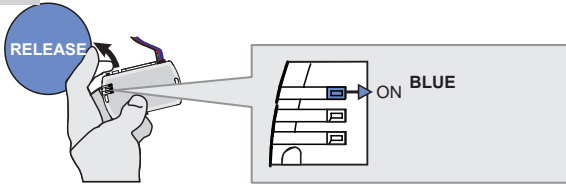

Release the programming button when the LED is BLUE.

If the LED is not solid BLUE disconnect the 4-Pin connector (Data-Link) and go back to step 1.

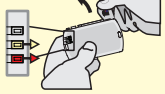

3

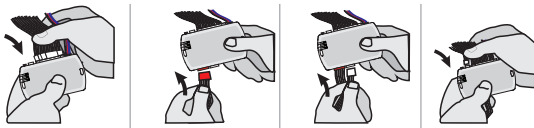

Insert the required remaining connectors.

4

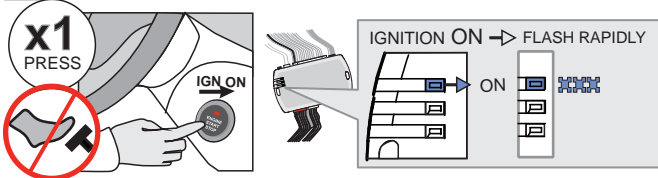

Do not press the brake pedal.
Press the Push-to-Start button once to turn on the ignition.
 ↳ The BLUE LED will flash rapidly.

5

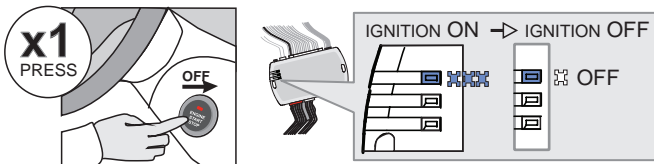

Press the Push-to-Start button once to turn off the ignition.
 ↳ The BLUE LED will turn off.



The module is now programmed.

REMOTE STARTER FUNCTIONALITY

DISTANCE



All doors must be closed.

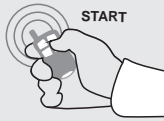

Remote start the vehicle.



Unlock the doors with either:

- The OEM remote
- The remote-starter remote.

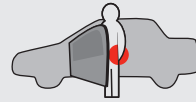

Enter the vehicle with the Intelligent SmartKey.



The vehicle can now be put in to gear and driven.

STAND ALONE INSTALLATION

ADDENDUM - SUGGESTED WIRING CONFIGURATION



ONLY COMPATIBLE WITH AUTOMATIC TRANSMISSION VEHICLES.



Vehicle functions supported in this diagram (functional if equipped)

VEHICLE	YEARS	Key Control	Lock	Unlock	Arm	Disarm	Trunk (open)	Tachometer	Door Status	Trunk Status	Hood Status*	Hand-Brake Status	Foot-Brake Status	AUX.1 Comfort Group		OEM Remote monitoring**
														Heated Seats	Rear defrost	
AUDI																
A4	Push-to-Start	2017-2020	•	•	•	•	•	•	•	•	•	•	•	•	•	•
A5	Push-to-Start	2018-2020	•	•	•	•	•	•	•	•	•	•	•	•	•	•
A5 / S5 Sportback	Push-to-Start	2018-2020	•	•	•	•	•	•	•	•	•	•	•	•	•	•
Q5	Push-to-Start	2018-2020	•	•	•	•	•	•	•	•	•	•	•	•	•	•
Q7	Push-to-Start	2017-2021	•	•	•	•	•	•	•	•	•	•	•	•	•	•
SQ5	Push-to-Start	2018-2020	•	•	•	•	•	•	•	•	•	•	•	•	•	•
RS4	Push-to-Start	2017-2020	•	•	•	•	•	•	•	•	•	•	•	•	•	•
RS 5 Coupe	Push-to-Start	2018-2020	•	•	•	•	•	•	•	•	•	•	•	•	•	•
S5 Coupek	Push-to-Start	2018-2020	•	•	•	•	•	•	•	•	•	•	•	•	•	•



FIRMWARE VERSION

61.[11]

VW MINIMUM

To add the firmware version and the options, use the **FLASH LINK UPDATER** or **FLASH LINK MOBILE** tool, sold separately.



Program bypass option:

UNIT OPTION

DESCRIPTION

C1

OEM Remote status (Lock/Unlock) monitoring

D6

Push-to-Start

Program bypass option
OPTION COMFORT GROUP:

A5

OFF

AUTOMATIC TURN ON : option confort group

NOTES



1 KEY REQUIRED FOR THE INSTALLATION



Parts required (Not included)

- 1x Vehicle Key
- 3x 1 AMP Diode
- 1x 10Amp Fuse

MANDATORY INSTALL

*HOOD PIN



HOOD STATUS: THE HOOD PIN SWITCH MUST BE INSTALLED IF THE VEHICLE CAN BE REMOTE STARTED WITH THE HOOD OPEN, SET FUNCTION **A11** TO OFF.

A11

OFF

Notice: the installation of safety elements are mandatory. The hood pin is an essential security element and must be installed.

THIS MODULE MUST BE INSTALLED BY A QUALIFIED TECHNICIAN. A WRONG CONNECTION CAN CAUSE PERMANENT DAMAGE TO THE VEHICLE.

PARTS REQUIRED (NOT INCLUDED)

1x **FLASH LINK UPDATER,**
1x **FLASH LINK MANAGER**
SOFTWARE | PROGRAMME
1x Microsoft Windows Computer with Internet connection

OR

1x **FLASH LINK MOBILE**
1x **FLASH LINK MOBILE APP**
Smartphone *Android* or *iOS* with Internet connection (*provider charges may apply*).
1x

MANDATORY

HOOD PIN



REMOTE START SAFETY OVERRIDE SWITCH

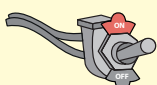





VALET SWITCH

Part #: RSPB available, Sold separately.

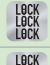
Notice: the installation of safety elements are mandatory. The hood pin and the valet switch are essential security elements and must be installed.

STAND ALONE CONFIGURATION

	Program bypass option	UNIT OPTION	DESCRIPTION
	OEM Remote Stand Alone Remote Starter:	D1.10 	By default, LOCK, LOCK, LOCK Par défaut, VERROUILLE, VERROUILLE, VERROUILLE
		D1.1 	
	Program bypass option with oem remote:	C1	OEM Remote Monitoring
	Program bypass option with RF KIT antenna:	H1 to H6	Supported RF Kits and select RF Kit

REMOTE STARTER FUNCTIONALITY



All doors must be closed.

3X 

Press the OEM remote's Lock button 3x to remote-start (or remote-stop) the vehicle.



START 

The vehicle will START.

REMOTE STARTER DIAGNOSTICS
MODULE RED LED

x2 flash :	Brake ON
x3 flash :	No tach
x4 flash :	Ignition before start
x5 flash :	Hood Open

REMOTE STARTER WARNING CARD



CUT THIS WARNING CARD AND STICK IT ON A VISIBLE PLACE:
or use the package **RSPB**, Sold separately.

WARNING | ATTENTION



REMOTE STARTER

THE VEHICLE CAN BE STARTED BY EITHER: PRESSING THE LOCK BUTTON ON THE OEM REMOTE 3 TIMES CONSECUTIVELY OR BY A SMARTPHONE. **TURN ON** THE SAFETY SWITCH LOCATED UNDER THE DASHBOARD BEFORE WORKING ON THE VEHICLE.

DESCRIPTION

Rear BCM, left side of trunk.

①

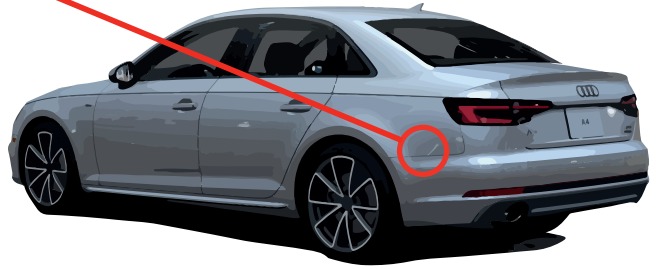

①

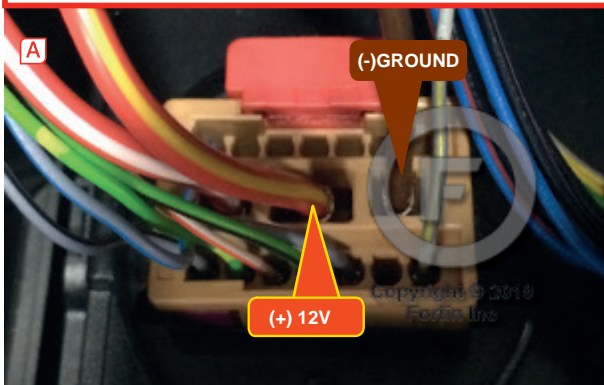
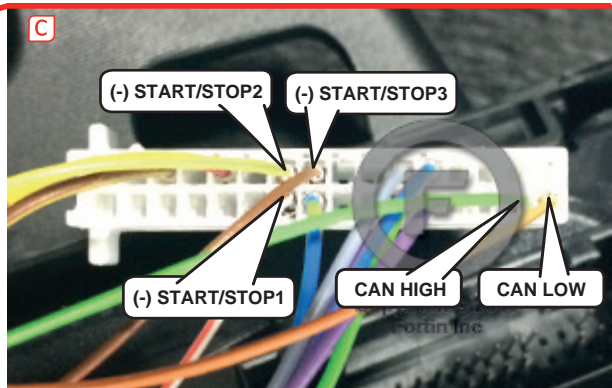
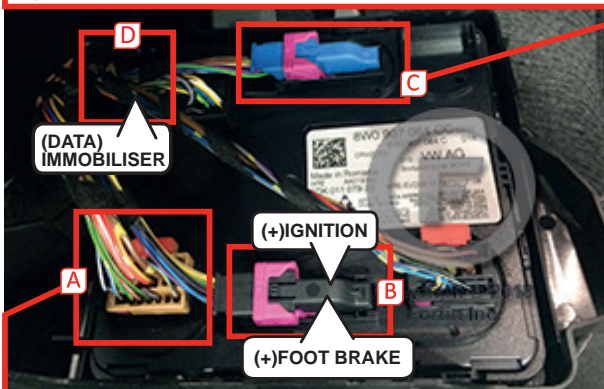

AUTOMATIC TRANSMISSION WIRING CONNECTION

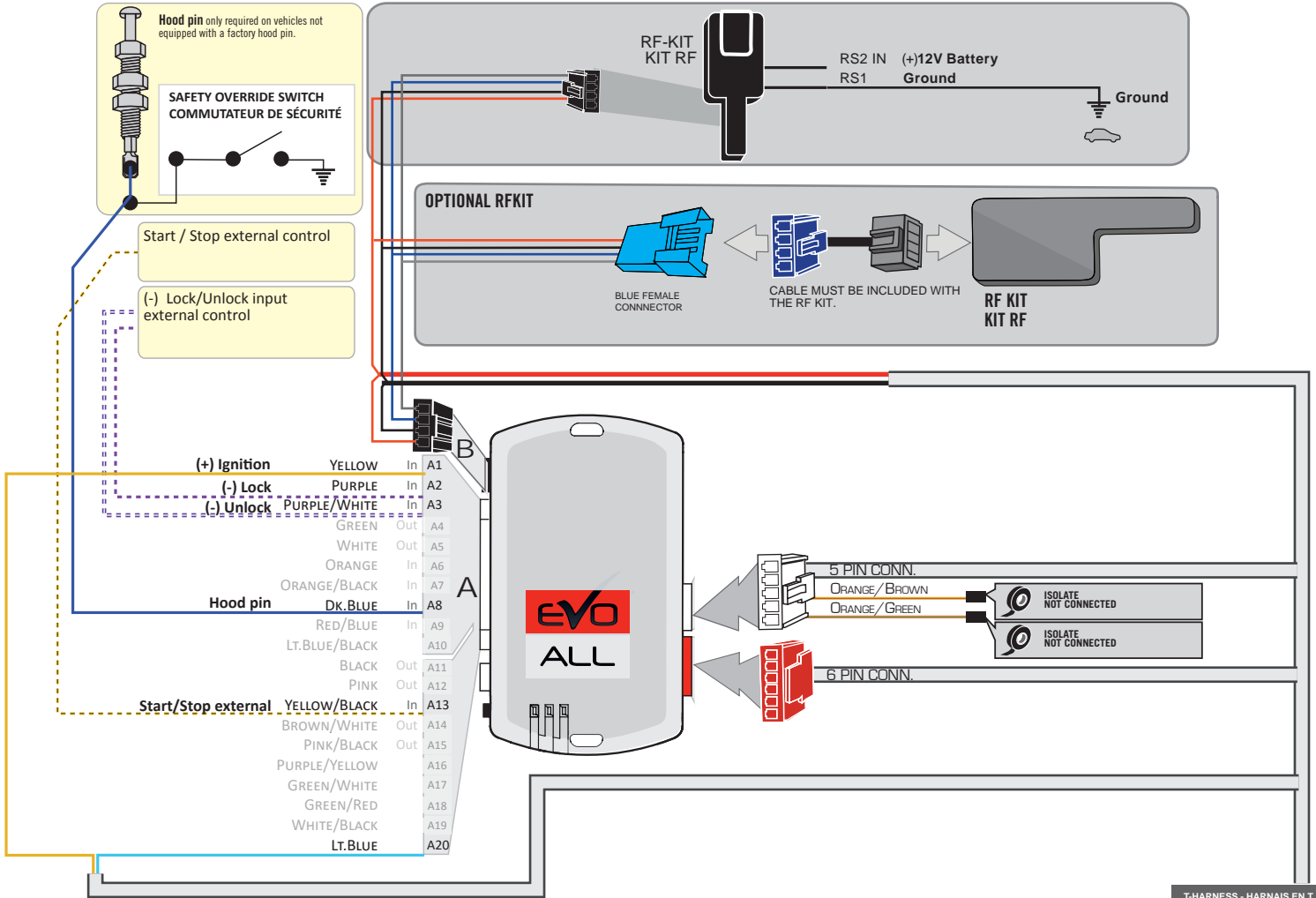

T-HARNESS - HARNAIS EN T
THAR-AUD2

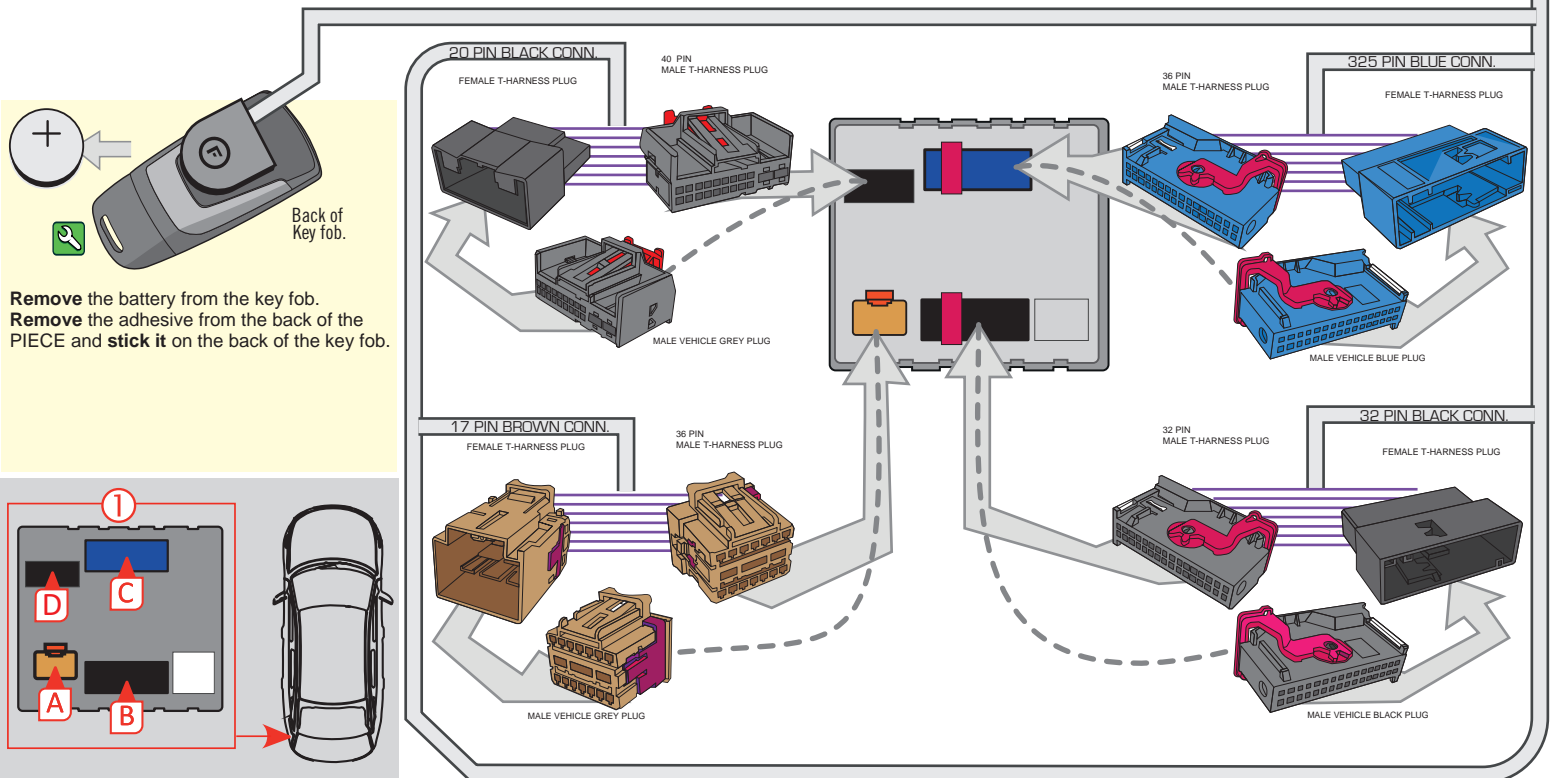

PROGRAMMING PROCEDURE

1

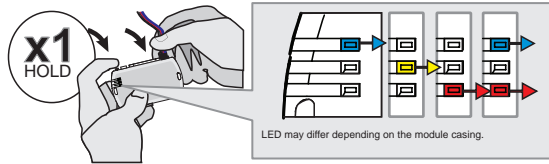

Press and hold the programming button:
Connect the 4-PIN Data-link harness (Black connector).

↳ The Blue, Red, Yellow and Blue & Red LEDs will alternatively illuminate.

2

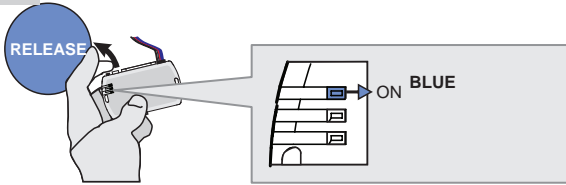

Release the programming button when the LED is BLUE.

If the LED is not solid BLUE disconnect the 4-Pin connector (Data-Link) and go back to step 1.

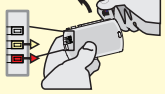

3

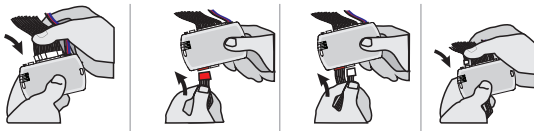

Insert the required remaining connectors.

4

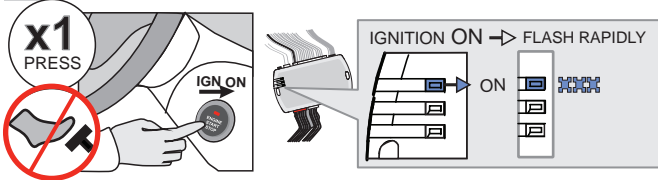

Do not press the brake pedal.
Press the Push-to-Start button once to turn on the ignition.
 ↳ The BLUE LED will flash rapidly.

5

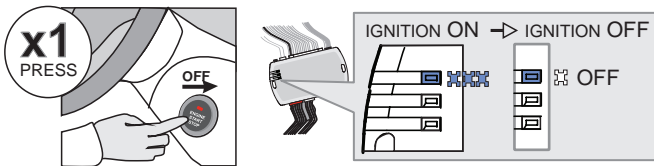

Press the Push-to-Start button once to turn off the ignition.
 ↳ The BLUE LED will turn off.



The module is now programmed.

REMOTE STARTER FUNCTIONALITY



All doors must be closed.

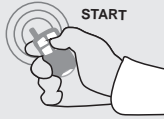

Remote start the vehicle.



Unlock the doors with either:
• The OEM remote
• The remote-starter remote.

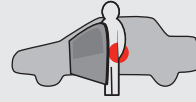

Enter the vehicle with the Intelligent SmartKey.



The vehicle can now be put in to gear and driven.

THAR-AUD2
THARNNESS INSTALLATION

ADDENDUM - SUGGESTED WIRING CONFIGURATION

VEHICLE	YEARS	Vehicle functions supported in this diagram (functional if equipped)														AUX.1 Comfort Group Groupe confort		R.S. OEM remote Stand Alone compatible	OEM Remote monitoring **
		Key Control	Lock	Unlock	Arm	Disarm	Trunk (open)	Tachometer	Door Status	Trunk Status	Hood Status*	Hand-Brake Status	Foot-Brake Status	Heated Seats	Rear defrost				
 <div style="position: absolute; top: 150px; left: 250px; border: 2px solid black; border-radius: 50%; padding: 10px; background-color: white; text-align: center;"> PUSH START </div>																			
AUDI																			
A6 - S6	<i>Push-to-Start</i>	2019-2021	•	•	•	•	•	•	•	•	•	•	•	•	•	•	•	•	•
A7 - S7	<i>Push-to-Start</i>	2019-2021	•	•	•	•	•	•	•	•	•	•	•	•	•	•	•	•	•
A8 - S8	<i>Push-to-Start</i>	2019-2021	•	•	•	•	•	•	•	•	•	•	•	•	•	•	•	•	•
SQ8	<i>Push-to-Start</i>	2020-2021	•	•	•	•	•	•	•	•	•	•	•	•	•	•	•	•	•
RS6	<i>Push-to-Start</i>	2021	•	•	•	•	•	•	•	•	•	•	•	•	•	•	•	•	•
RS7	<i>Push-to-Start</i>	2019-2021	•	•	•	•	•	•	•	•	•	•	•	•	•	•	•	•	•





BYPASS FIRMWARE VERSION

61.[12]

VW MINIMUM

To add the firmware version and the options, use the **FLASH LINK UPDATER** or **FLASH LINK MOBILE** tool, sold separately.

	UNIT OPTION	DESCRIPTION
 <p>Program bypass option:</p>	C1	OEM Remote status (Lock/Unlock) monitoring
	D6	Push-to-Start

	FUNCTION	MODE	DESCRIPTION
 <p>Program remote starter option for R.S. OEM REMOTE STAND ALONE:</p>	38	2	Enable : Press 3x Lock to remote start with the OEM remote.
<p>for COMFORT GROUP ACTIVATION:</p>	39	2	Temperature option : AUX.1 activated at 5°C, 5 seconds after remote started

Parts required (Not included)

- 1x Vehicle Key
- 3x 1 AMP Diode
- 1x 10Amp Fuse

NOTES

1 KEY REQUIRED FOR THE INSTALLATION

MANDATORY INSTALL

* HOOD PIN



HOOD STATUS: THE HOOD PIN SWITCH (INCLUDED) MUST BE INSTALLED IF THE VEHICLE CAN BE REMOTE STARTED WITH THE HOOD OPEN, SET FUNCTION **A11** TO OFF.

A11

OFF

SECURITY STICKER

Included

Notice: the installation of safety elements are mandatory. The hood pin and the sticker are essential security elements and must be installed.

THIS MODULE MUST BE INSTALLED BY A QUALIFIED TECHNICIAN. A WRONG CONNECTION CAN CAUSE PERMANENT DAMAGE TO THE VEHICLE.

DESCRIPTION



① Rear BCM, in the trunk.

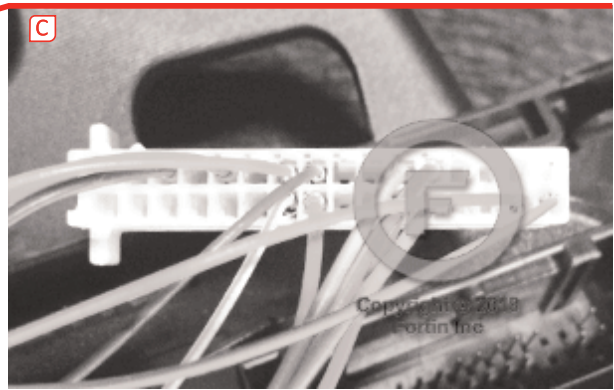
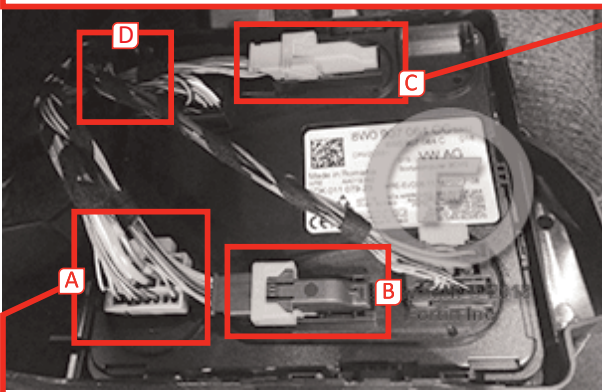

WIRING CONNECTION

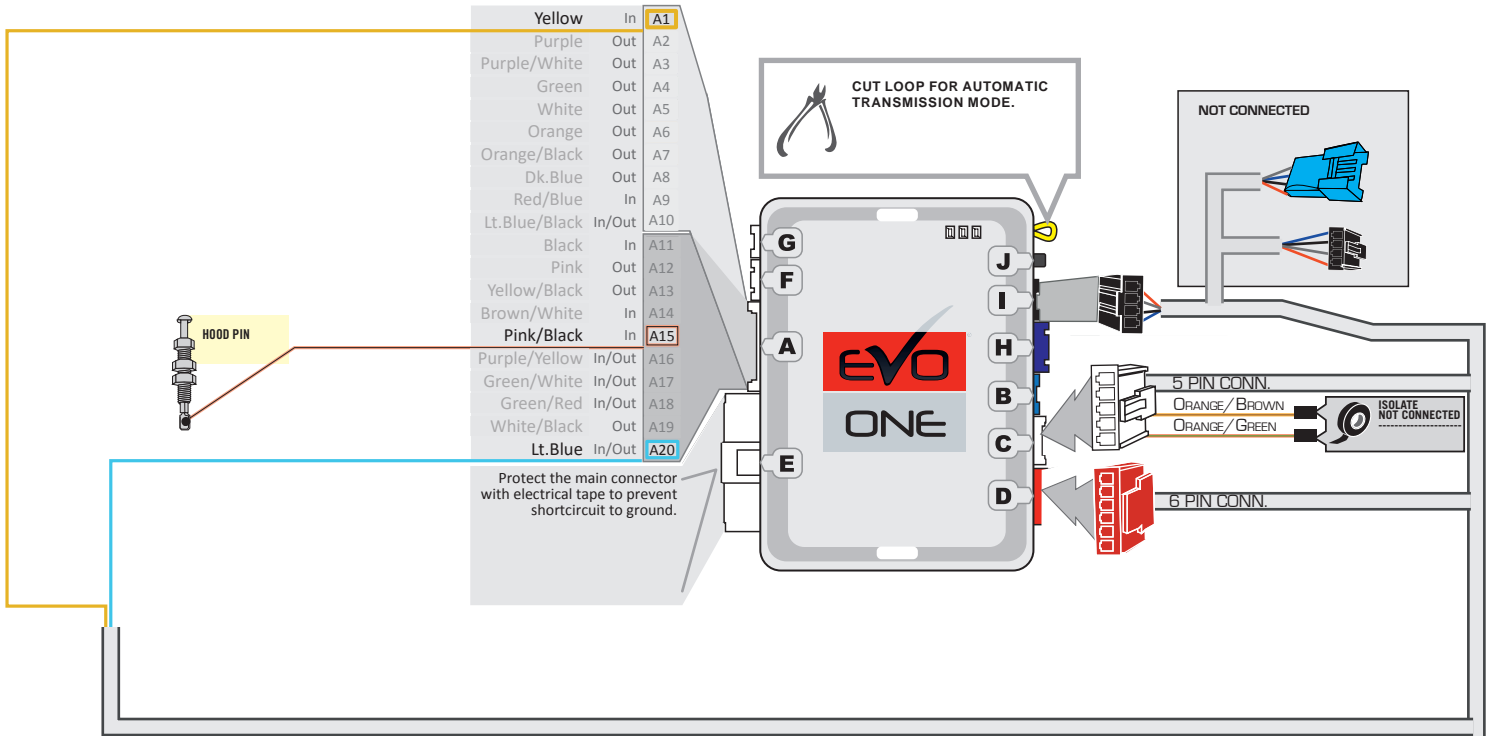

T-HARNESS - HARNAIS EN T
THAR-AUD2

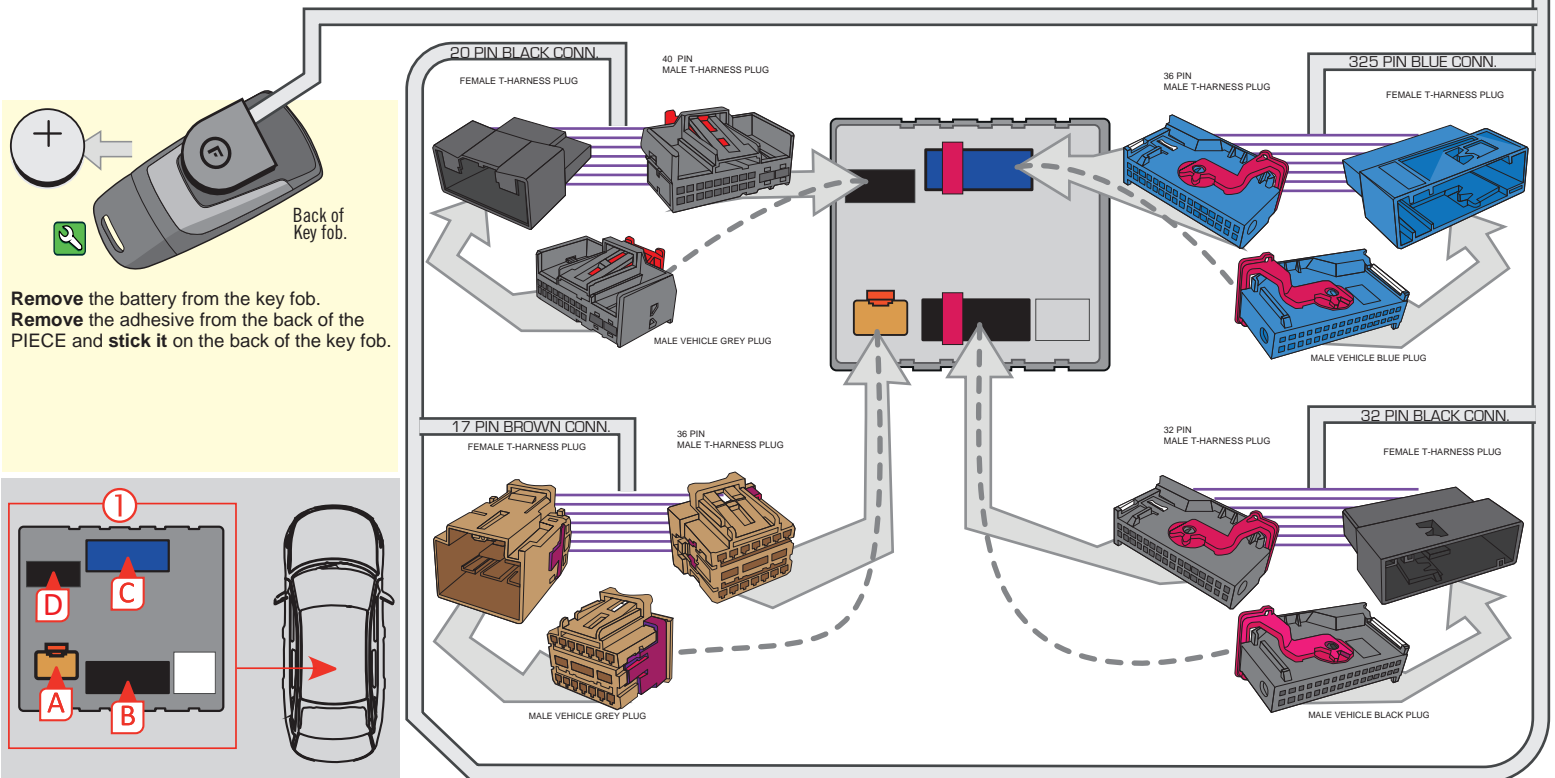

KEY BYPASS PROGRAMMING PROCEDURE

1

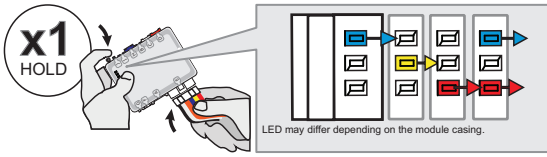

Press and hold the programming button:
Insert the 6-Pin Main connector.
 ↳ The LEDs will alternate between **BLUE, RED, YELLOW & BLUE/RED** flashes.

2

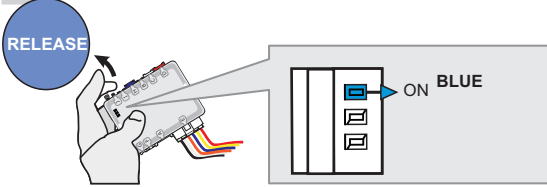

Release the programming button when the **BLUE LED** is ON.

Relâchez le bouton de programmation quand la DEL BLEUE est allumée.

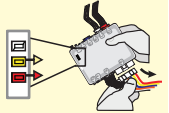

3

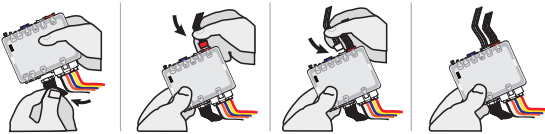

Insert the required remaining connectors.

4

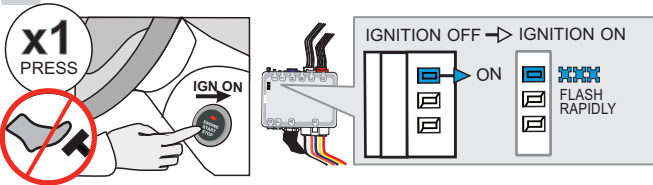

Do not press the brake pedal.
Press the Push-to-Start button once to turn on the ignition.
 ↳ The **BLUE LED** will flash rapidly.

5

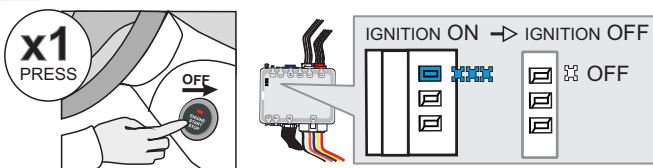

Press the Push-to-Start button once to turn off the ignition.
 ↳ The **BLUE LED** will turn off.



The module is now programmed.

REMOTE STARTER PROGRAMMING PROCEDURE



REFER TO THE **QUICK INSTALL GUIDE** INCLUDED WITH THE MODULE FOR THE REMOTE STARTER PROGRAMMING.

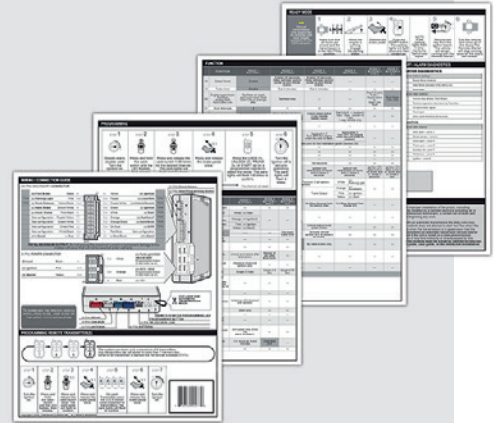

REMOTE STARTER FUNCTIONALITY



All doors must be closed.

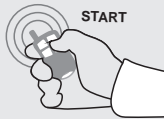

Remote start the vehicle.



Unlock the doors with either:

- The OEM remote
- The remote-starter remote.

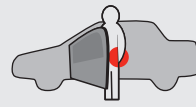

Enter the vehicle with the Intelligent SmartKey.



The vehicle can now be put in to gear and driven.

REGULAR INSTALLATION
ADDENDUM - SUGGESTED WIRING CONFIGURATION

Vehicle functions supported in this diagram (functional if equipped) |

VEHICLE	YEARS	Key Control	Lock	Unlock	Arm	Disarm	Trunk (open)	Tachometer	Door Status	Trunk Status	Hood Status*	Hand-Brake Status	Foot-Brake Status	AUX.1 Comfort Group		R.S. OEM remote Stand Alone compatible	OEM Remote monitoring**
														Heated Seats	Rear defrost		
AUDI																	
A4	Push-to-Start	2017-2020	•	•	•	•	•	•	•	•	•	•	•	•	•	•	•
A5	Push-to-Start	2018-2020	•	•	•	•	•	•	•	•	•	•	•	•	•	•	•
A5 / S5 Sportback	Push-to-Start	2018-2020	•	•	•	•	•	•	•	•	•	•	•	•	•	•	•
Q5	Push-to-Start	2018-2020	•	•	•	•	•	•	•	•	•	•	•	•	•	•	•
Q7	Push-to-Start	2017-2021	•	•	•	•	•	•	•	•	•	•	•	•	•	•	•
SQ5	Push-to-Start	2018-2020	•	•	•	•	•	•	•	•	•	•	•	•	•	•	•
RS4	Push-to-Start	2017-2020	•	•	•	•	•	•	•	•	•	•	•	•	•	•	•
RS 5 Coupe	Push-to-Start	2018-2020	•	•	•	•	•	•	•	•	•	•	•	•	•	•	•
S5 Coupe	Push-to-Start	2018-2020	•	•	•	•	•	•	•	•	•	•	•	•	•	•	•

BYPASS

61.[12]

VW MINIMUM

To add the firmware version and the options, use the **FLASH LINK UPDATER** or **FLASH LINK MOBILE** tool, sold separately.

		UNIT OPTION	DESCRIPTION
	Program bypass option:	C1	OEM Remote status (Lock/Unlock) monitoring
		D6	Push-to-Start

	FUNCTION	MODE	DESCRIPTION
	Program remote starter option for R.S. OEM REMOTE STAND ALONE:		
	38	2	Enable : Press 3x Lock to remote start with the OEM remote.
for COMFORT GROUP ACTIVATION:	39	2	Temperature option : AUX.1 activated at 5°C, 5 seconds after remote started

Parts required (Not included)

- 1x Vehicle Key
- 3x 1 AMP Diode
- 1x 10Amp Fuse

NOTES

1 KEY REQUIRED FOR THE INSTALLATION
MANDATORY INSTALL
*** HOOD PIN**

HOOD STATUS : THE HOOD PIN SWITCH (INCLUDED) MUST BE INSTALLED IF THE VEHICLE CAN BE REMOTE STARTED WITH THE HOOD OPEN, SET FUNCTION **A11** TO OFF.

A11
OFF
SECURITY STICKER

Included

Notice: the installation of safety elements are mandatory. The hood pin and the sticker are essential security elements and must be installed.

THIS MODULE MUST BE INSTALLED BY A QUALIFIED TECHNICIAN. A WRONG CONNECTION CAN CAUSE PERMANENT DAMAGE TO THE VEHICLE.

DESCRIPTION

Rear BCM, left side of trunk.

①



①

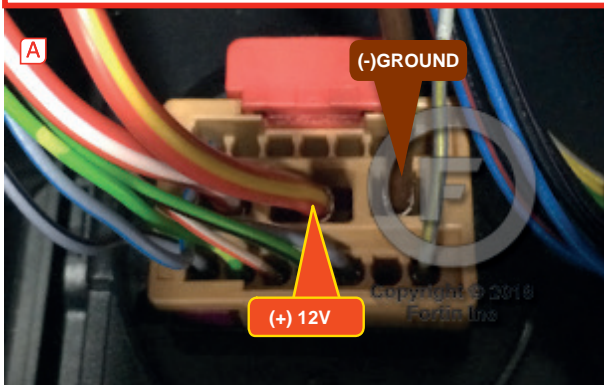
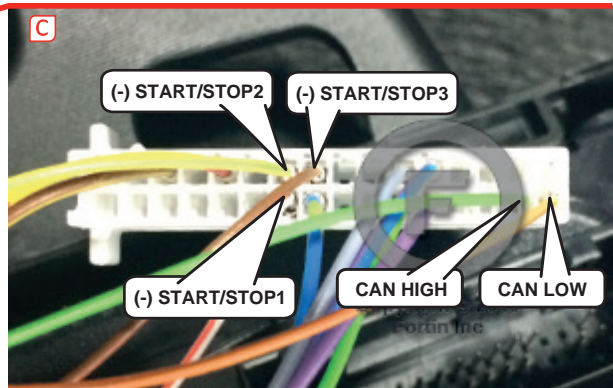
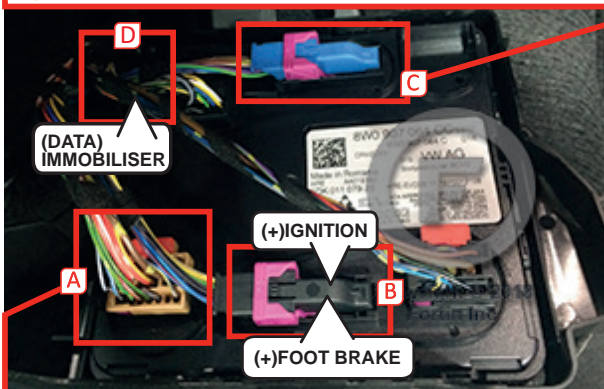

WIRING CONNECTION

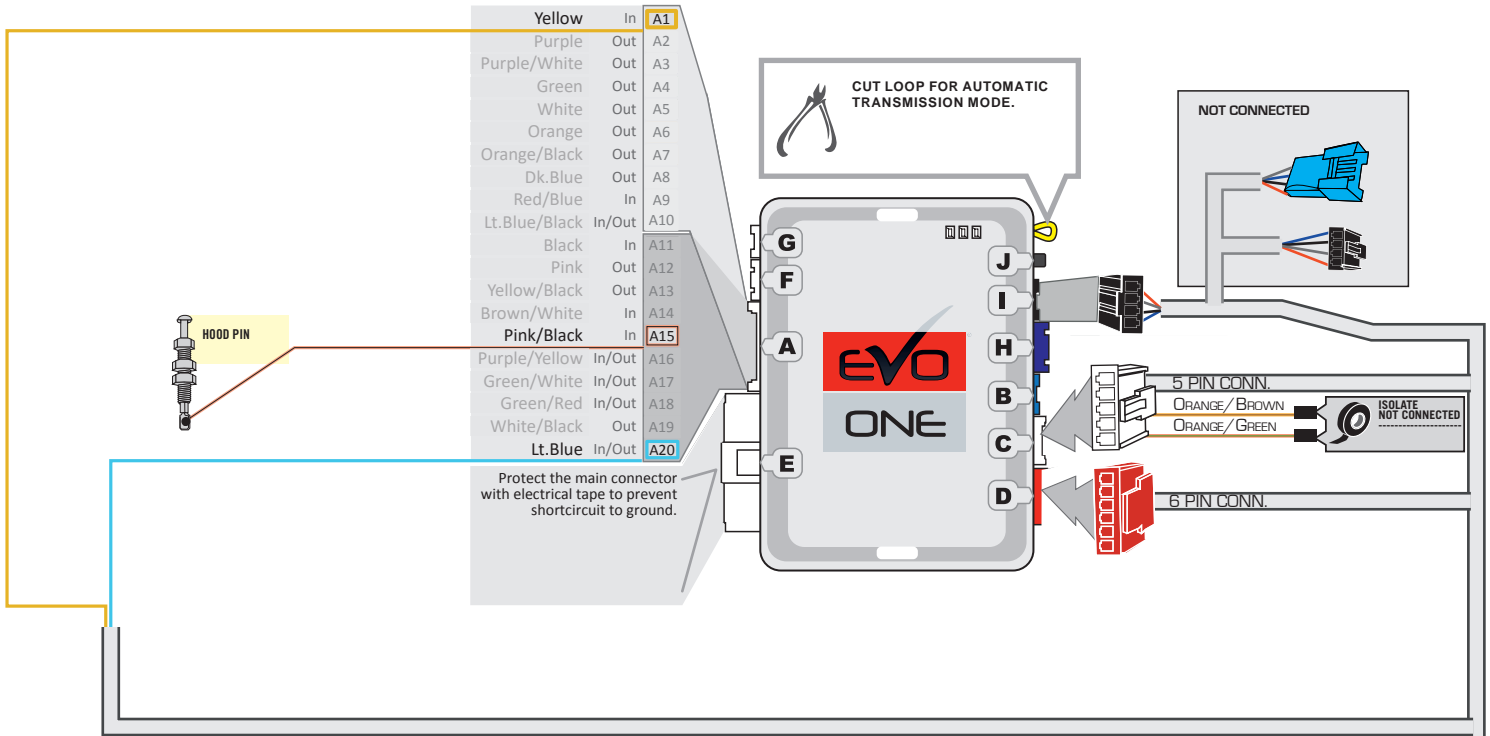

T-HARNESS - HARNAIS EN T
THAR-AUD2

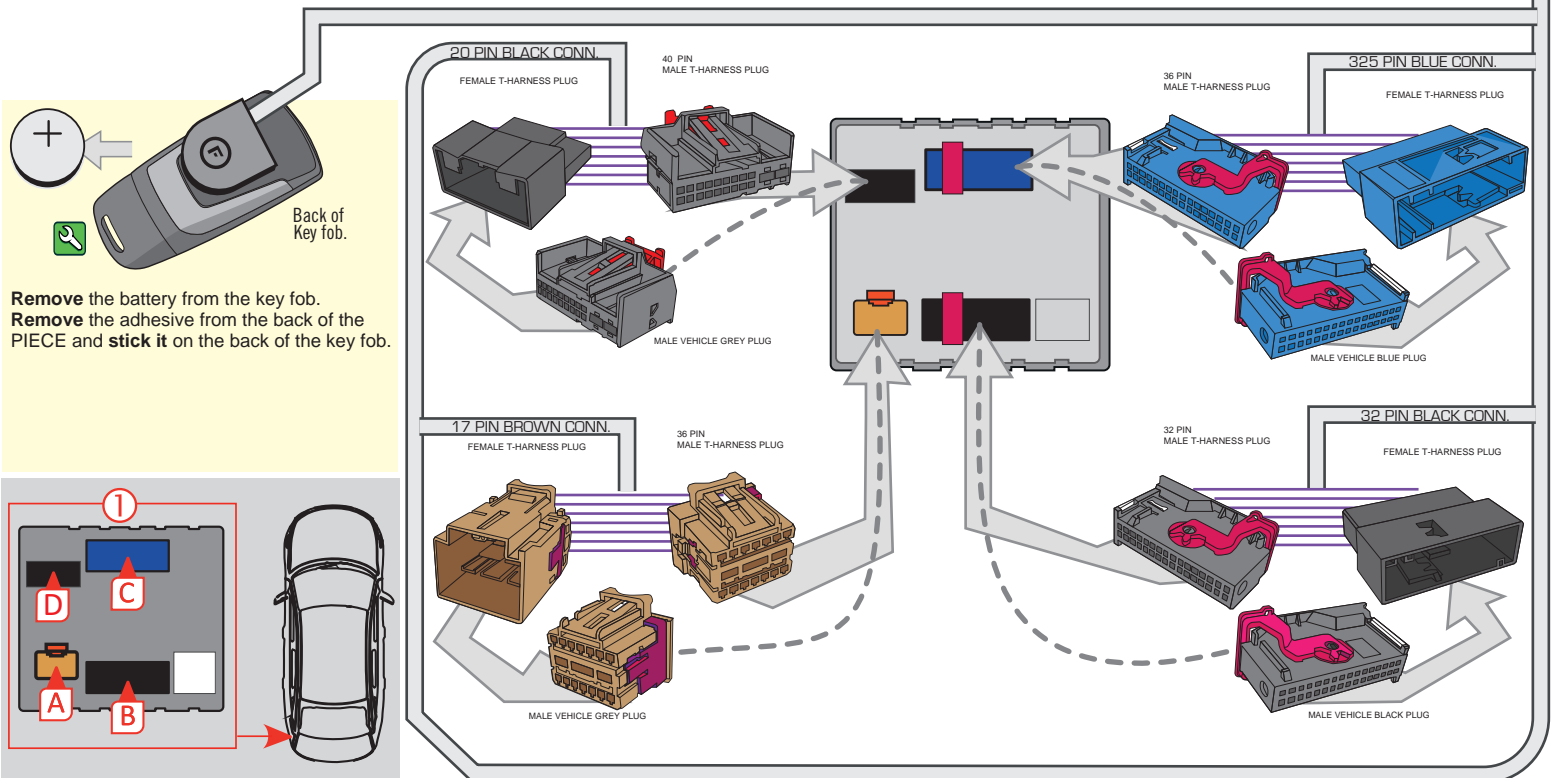

KEY BYPASS PROGRAMMING PROCEDURE

1

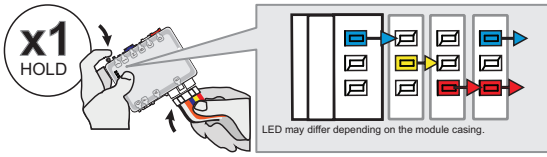

Press and hold the programming button:
Insert the 6-Pin Main connector.
 ↳ The LEDs will alternate between **BLUE, RED, YELLOW & BLUE/RED** flashes.

2

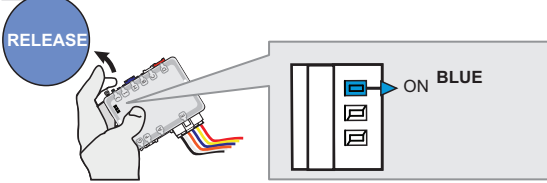

Release the programming button when the **BLUE LED** is ON.

If the **BLUE LED** is not ON solid **disconnect** the 6-Pin Main connector and go back to step 1.

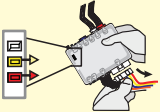

3

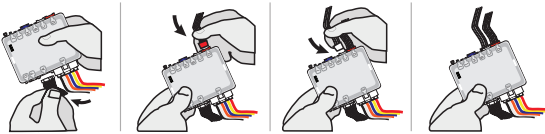

Insert the required remaining connectors.

4

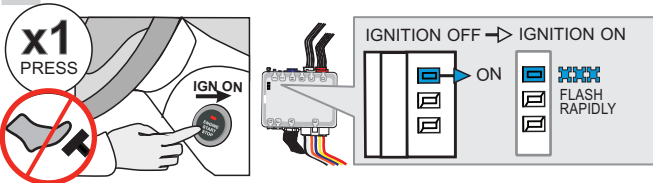

Do not press the brake pedal.
Press the Push-to-Start button once to turn on the ignition.
 ↳ The **BLUE LED** will flash rapidly.

5

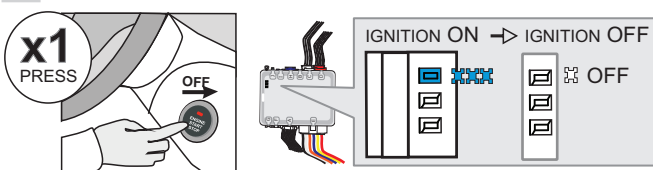

Press the Push-to-Start button once to turn off the ignition.
 ↳ The **BLUE LED** will turn off.



The module is now programmed.

REMOTE STARTER PROGRAMMING PROCEDURE



REFER TO THE **QUICK INSTALL GUIDE** INCLUDED WITH THE MODULE FOR THE REMOTE STARTER PROGRAMMING.

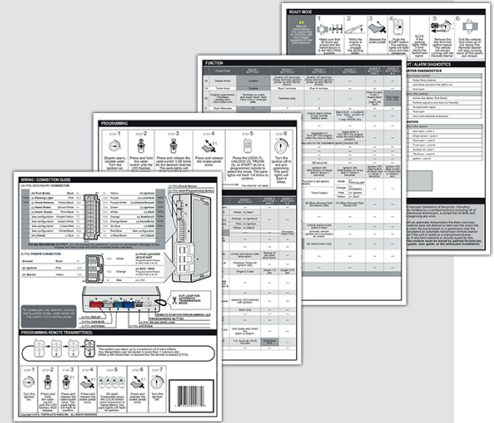

REMOTE STARTER FUNCTIONALITY

DISTANCE



All doors must be closed.



Remote start the vehicle.



Unlock the doors with either:

- The OEM remote
- The remote-starter remote.



Enter the vehicle with the Intelligent SmartKey.



The vehicle can now be put in to gear and driven.