

REGULAR & THAR-AUD1 INSTALLATION

ADDENDUM - SUGGESTED WIRING CONFIGURATION

VEHICLE	YEARS	Vehicle functions supported in this diagram (functional if equipped)														
		Immobilizer bypass	Lock	Unlock	Arm	Disarm	Tachometer	Trunk Release	Door Status	Trunk Status	Hood Status*	Hand-Brake Status	Foot-Brake Status	OEM Remote monitoring**		
																
VOLKSWAGEN																
Touareg	2011-2017	•	•	•	•	•	•	•	•	•	•	•	•	•	•	•

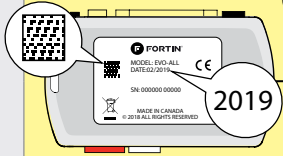

COMPATIBLE MODULE REQUIRED:

2019

QR CODE ON THE LABEL

MANUFACTURED AFTER: **2019**

CODE QR SUR

FIRMWARE VERSION
VERSION LOGICIELLE

60.[11]

MINIMUM

To add the firmware version and the options, use the **FLASH LINK UPDATER** or **FLASH LINK MOBILE** tool, sold separately.

NOTES

****OEM Remote Monitoring**

The vehicles OEM remote will remain functional when the vehicle is running, however, the intelligent access key will not unlock the doors when the vehicle is running.

	Parts required (Not included)	PAGE
WIRE TO WIRE DIAGRAM		
	1x 10Amp Fuse 3x 1 AMP Diode 1x Relay for key release	page 4
THARNESS DIAGRAM		
THARNESS THAR-AUD1	1x THAR-AUD1 1x THAR-AUD1	page 5

MANDATORY INSTALL

***HOOD PIN**



HOOD STATUS: THE HOOD PIN SWITCH MUST BE INSTALLED IF THE VEHICLE CAN BE REMOTE STARTED WITH THE HOOD OPEN, SET FUNCTION **A11** TO OFF.

A11

OFF
NON

Notice: the installation of safety elements are mandatory. The hood pin is an essential security element and must be installed.

THIS MODULE MUST BE INSTALLED BY A QUALIFIED TECHNICIAN. A WRONG CONNECTION CAN CAUSE PERMANENT DAMAGE TO THE VEHICLE.

NOTES

	Program bypass option:	UNIT OPTION	DESCRIPTION
		C1	OEM Remote status (Lock/Unlock) monitoring
		D6	Push-to-Start
		D5	Lock after start
		E4	FEATURE 1 : Disarm OEM alarm with transponder
	IF THE VEHICLE IS NOT EQUIPPED WITH FUNCTIONAL HOOD PIN:	A11	<div style="display: inline-block; border: 1px solid black; padding: 2px; text-align: center;"> OFF NON </div> Hood trigger (Output Status).
	Program bypass option (Vehicle diesel only):	D1.3	Diesel mode (Vehicle diesel only)

DESCRIPTION

① Ignition switch Connector

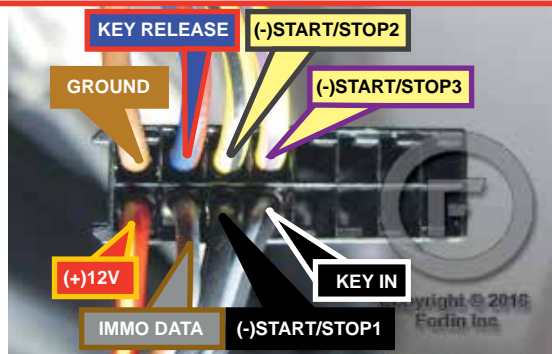

REMOVE THE PLASTIC PROTECTIVE CAP OVER THE KEY PORT TO SEE THE WIRE LOCATION.

② BCM, left of steering column, white connector with grey cover.

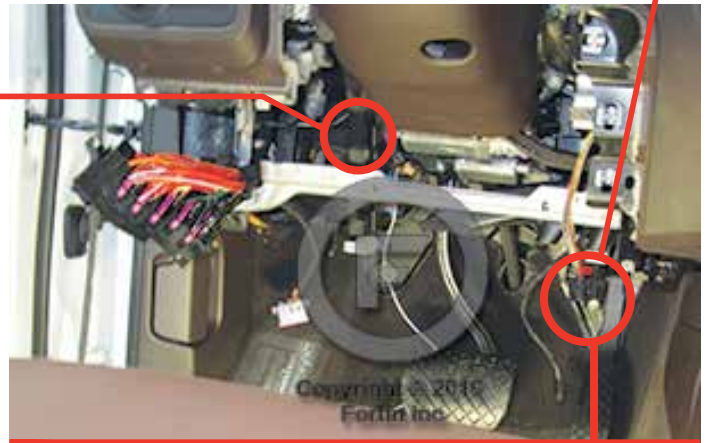
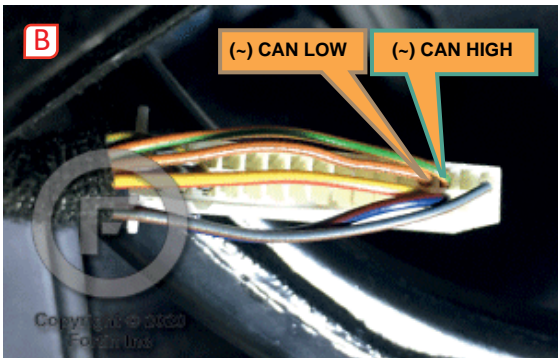
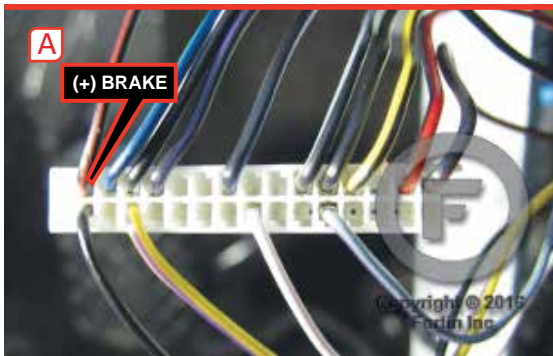

AUTOMATIC TRANSMISSION WIRING CONNECTION

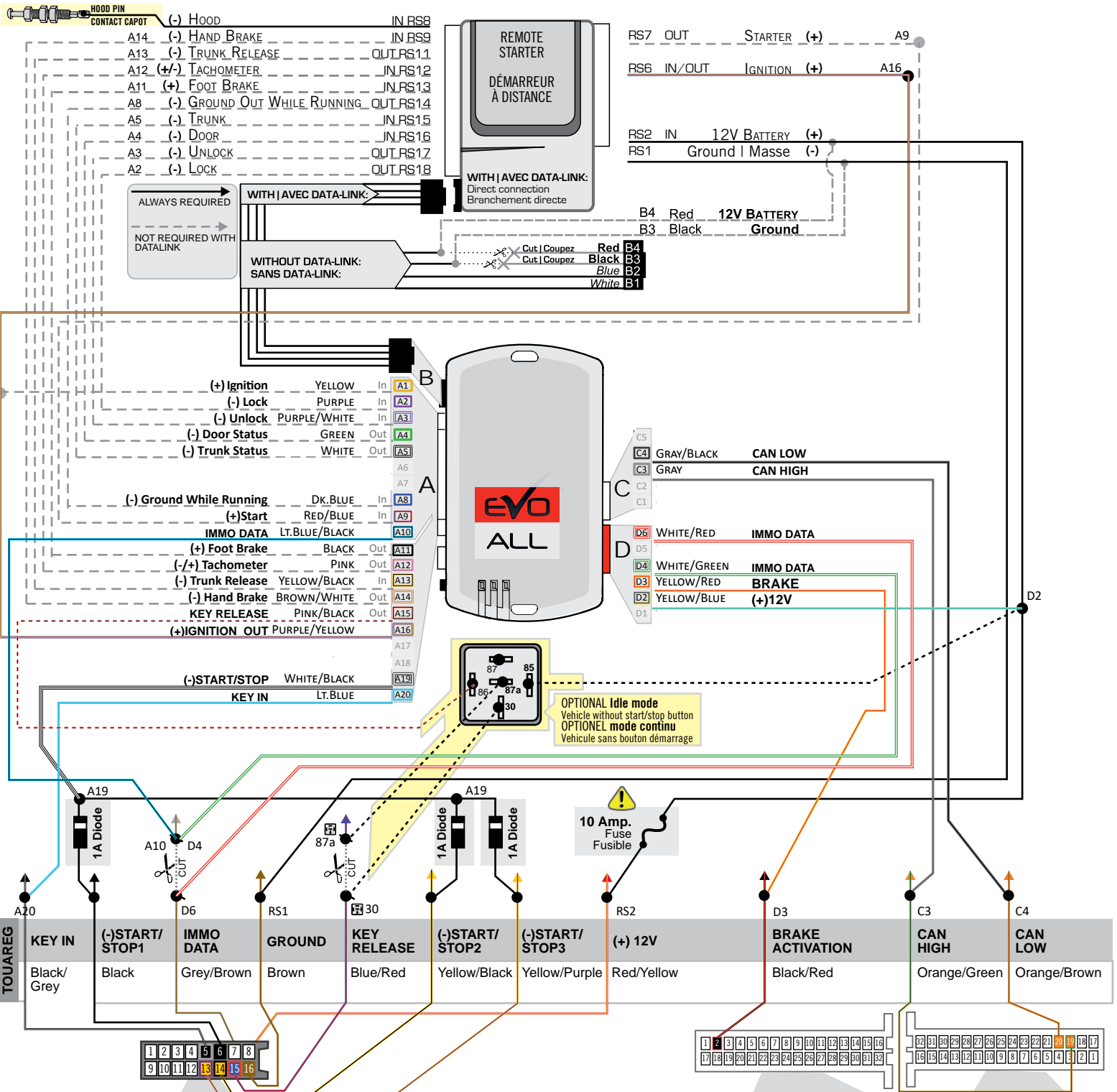

1 Back view. 16-pin Black connector. At key port.

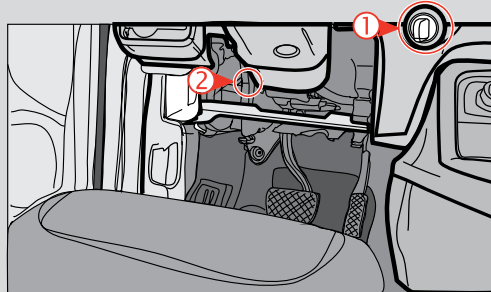
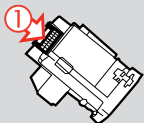

2A Back View - connector White Grey cover. At module comfort system.

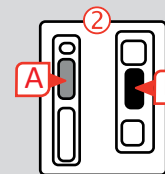

2B Back View - connector White 32-Pin with Black cover. At module comfort system.

THAR-AUD1 | AUTOMATIC TRANSMISSION CONNECTION

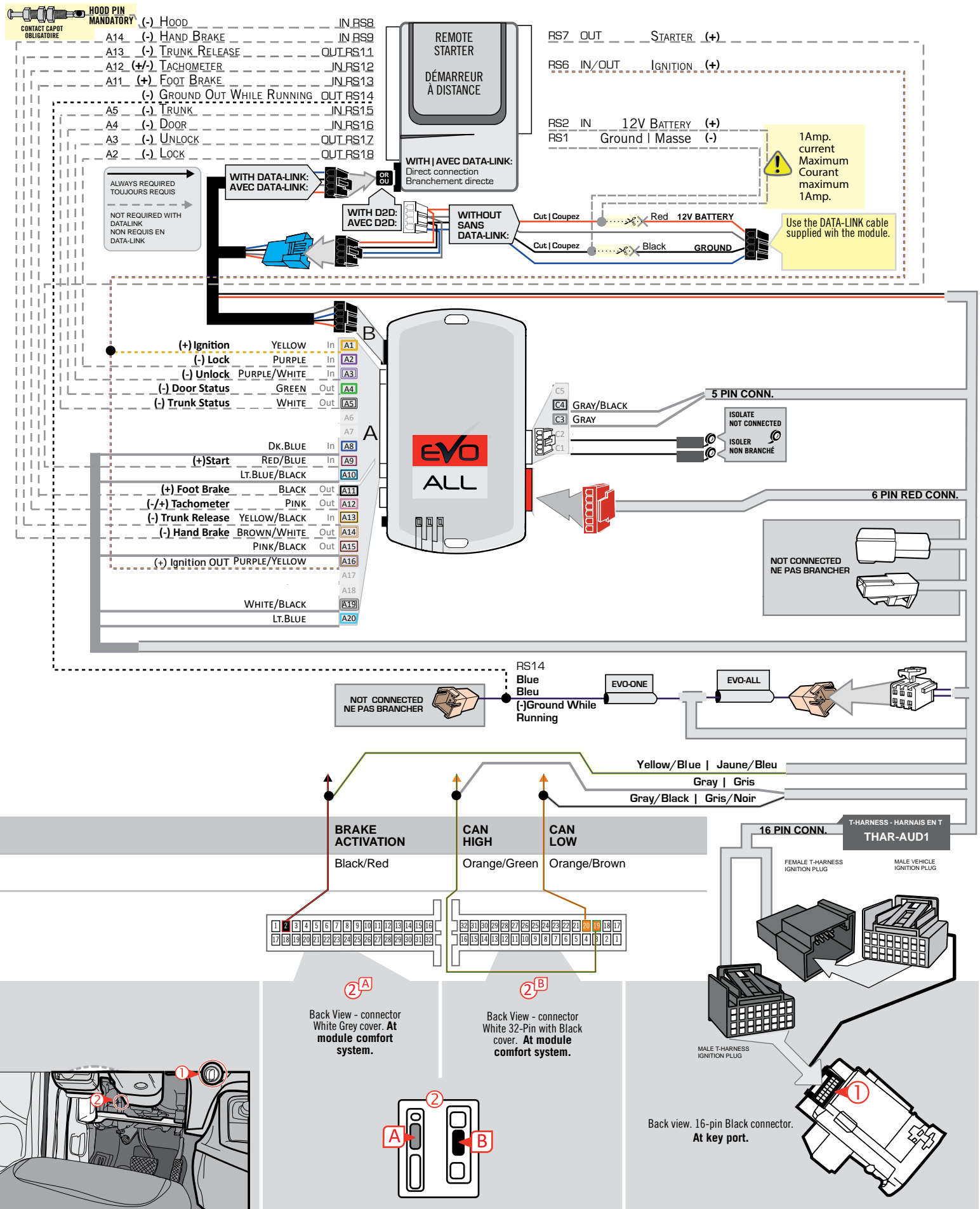

DCRYPTOR PROGRAMMING PROCEDURE



- Parts required (not included) Pièces requises (non incluses)**
- 1x **FLASH LINK UPDATER, FLASH LINK MANAGER**
SOFTWARE | PROGRAMME
 - 1x Microsoft Windows Computer with Internet connection

OR

- 1x **FLASH LINK MOBILE**
- 1x **FLASH LINK MOBILE APP**
- Smartphone *Android* or *iOS* with Internet connection
(Internet provider charges may apply)

BEFORE PROGRAMMING SET THE UNIT OPTIONS AND SAVE.

1

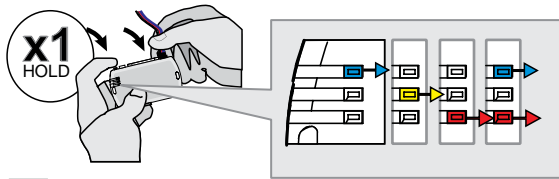

Press and hold the programming button:
Insert the 4-Pin (Data-Link) connector.

↳The Blue, Red, Yellow and Blue & Red LEDs will alternatively illuminate.

2

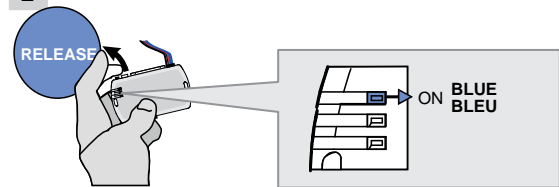

Release the programming button when the LED is BLUE.

If the LED is not solid BLUE disconnect the 4-Pin connector (Data-Link) and go back to step 1.

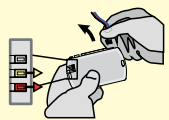

3

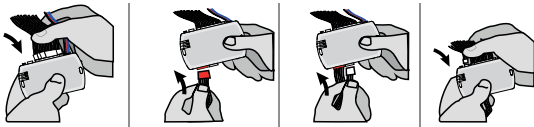

Insert the required remaining connectors.

4

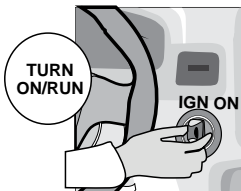

Insert and turn the key to the ignition ON position.

5

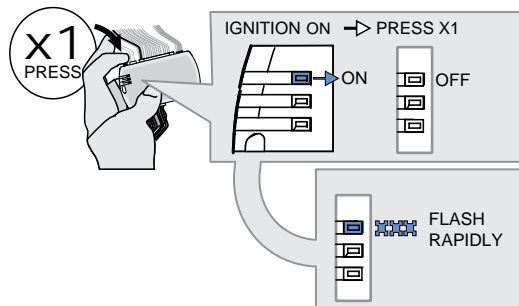

Press and release the programming button once (1x).

↳The BLUE LED will turn off.

↳The BLUE LED will flash rapidly.

KEY BYPASS PROGRAMMING PROCEDURE 2/3

6

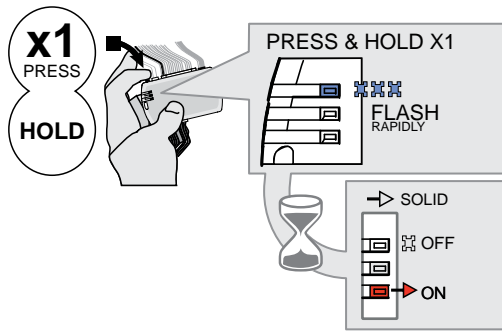

Press and Hold the programming button.

- ↳ Wait until the RED LED will turn ON solid.
- ↳ The BLUE LED will turn OFF.

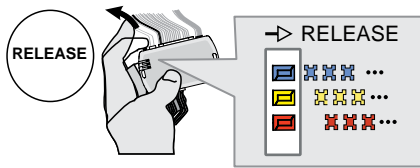

Release the programming button.

- ↳ The LEDs will alternate between BLUE, YELLOW and RED flashes.

OFF

ON

IGNITION ON



IGNITION OFF



Wait,

- ↳ The vehicle ignition turn ON than OFF a few times.

DO NOT TOUCH THE VEHICLE.

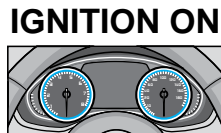

Wait,

- ↳ The vehicle ignition will turn ON .

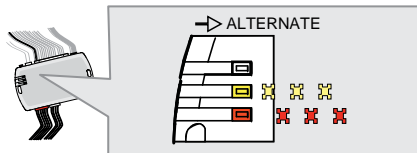

- ↳ The RED and YELLOW LEDs will alternate.

7

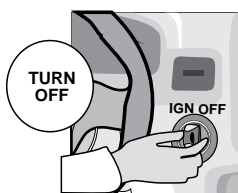

Turn the key to shut off the ignition.

KEY BYPASS PROGRAMMING PROCEDURE 3/3

8

Disconnect all the connectors and after the Data-Link (4-pins) connector.

9

Microsoft Windows Computer with Internet connection*

FLASH LINK UPDATER* **FLASH LINK MANAGER*** SOFTWARE

OR

Smartphone* (Internet provider charges may apply)

VEHICLE'S OBDII CONNECTOR **FLASH LINK MOBILE***

Use the tool: FLASH LINK UPDATER or FLASH LINK MOBILE to visit the DCryptor menu.

*Parts required (not included)

10

AFTER DCRYPTOR PROGRAMMING COMPLETED
Go back to the vehicle and **reconnect** the 4-Pin (Data-Link) connector and after, all the remaining connector.

REMOTE STARTER / ALARM VERIFICATION

The module is now programmed.

Test the remote starter. Remote start the vehicle.

REMOTE STARTER FUNCTIONALITY |

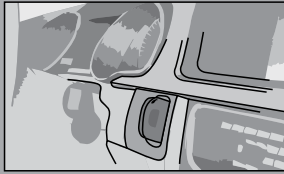

Vehicles with key port.

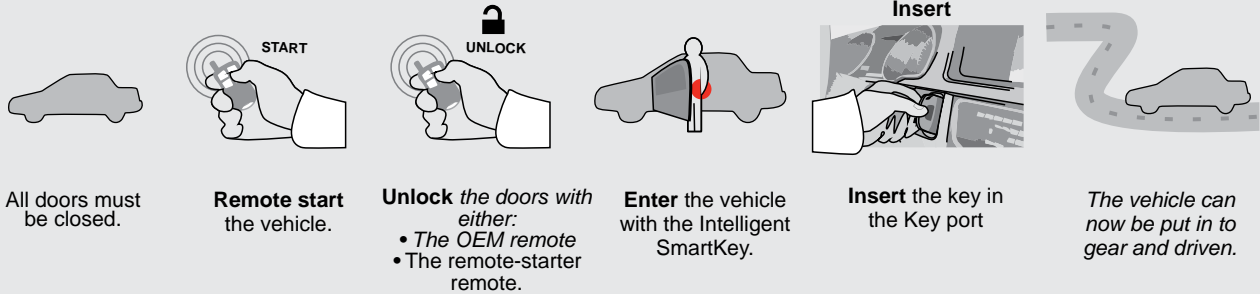

Vehicles with Push-to-Start.

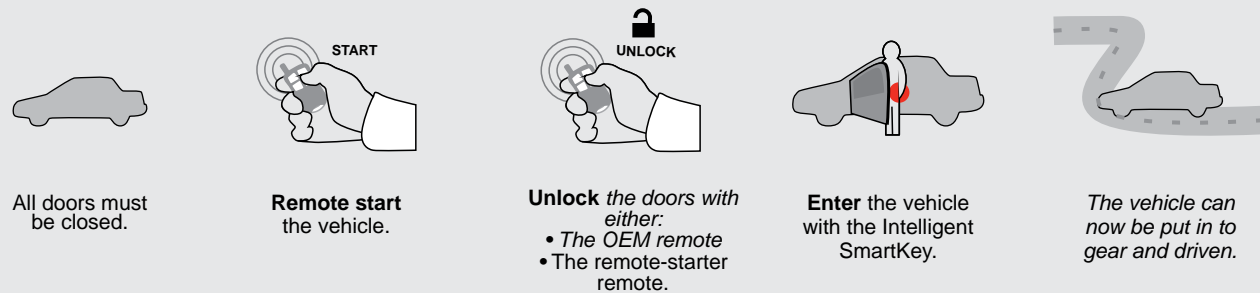

STAND ALONE & THAR-AUD1
INSTALLATION

ADDENDUM - SUGGESTED WIRING CONFIGURATION



ONLY COMPATIBLE WITH AUTOMATIC TRANSMISSION VEHICLES.



Vehicle functions supported in this diagram (functional if equipped)

VEHICLE	YEARS	Immobilizer bypass	Lock	Unlock	Arm	Disarm	Tachometer	Trunk Release	Door Status	Trunk Status	Hood Status*	Hand-Brake Status	Foot-Brake Status	OEM Remote monitoring**
VOLKSWAGEN N Touareg	2011-2017	•	•	•	•	•	•	•	•	•	•	•	•	•

	COMPATIBLE MODULE REQUIRED:	QR CODE ON THE LABEL MANUFACTURED AFTER: 2019	FIRMWARE VERSION 60.[11] MINIMUM	To add the firmware version and the options, use the FLASH LINK UPDATER or FLASH LINK MOBILE tool, sold separately.

NOTES

****OEM Remote Monitoring** The vehicles OEM remote will remain functional when the vehicle is running, however, the intelligent access key will not unlock the doors when the vehicle is running.

	Parts required (Not included)	PAGE
WIRE TO WIRE DIAGRAM	1x 5Amp Fuse 3x 1 AMP Diode 1x Relay for key release	page 5
THARNESS DIAGRAM		
THARNESS THAR-AUD1	1x THAR-AUD1	page 6

MANDATORY INSTALL

*HOOD PIN



HOOD STATUS: THE HOOD PIN SWITCH MUST BE INSTALLED IF THE VEHICLE CAN BE REMOTE STARTED WITH THE HOOD OPEN, SET FUNCTION A11 TO OFF.



Notice: the installation of safety elements are mandatory. The hood pin is an essential security element and must be installed.

THIS MODULE MUST BE INSTALLED BY A QUALIFIED TECHNICIAN. A WRONG CONNECTION CAN CAUSE PERMANENT DAMAGE TO THE VEHICLE.

NOTES

	Program bypass option:	UNIT OPTION	DESCRIPTION
		C1	OEM Remote status (Lock/Unlock) monitoring
		D6	Push-to-Start
		D5	Lock after start
		E4	FEATURE 1 : Disarm OEM alarm with transponder
	IF THE VEHICLE IS NOT EQUIPPED WITH FUNCTIONAL HOOD PIN:	A11	<div style="display: inline-block; border: 1px solid black; background-color: red; color: white; padding: 2px 5px;">OFF</div> Hood trigger (Output Status).
	Program bypass option (Vehicle diesel only):	D1.3	Diesel mode (Vehicle diesel only)

PARTS REQUIRED (NOT INCLUDED)

1x **FLASH LINK UPDATER,**
 1x **FLASH LINK MANAGER**
 SOFTWARE
 1x Microsoft Windows Computer with Internet connection

OR

1x **FLASH LINK MOBILE**
 1x **FLASH LINK MOBILE APP**
 Smartphone *Android* or *iOS* with Internet connection (*provider charges may apply*).

MANDATORY

HOOD PIN

REMOTE START SAFETY OVERRIDE SWITCH

VALET SWITCH

Part #: RSPB available, Sold separately.

Notice: the installation of safety elements are mandatory. The hood pin and the valet switch are essential security elements and must be installed.

STAND ALONE CONFIGURATION

	Program bypass option	UNIT OPTION	DESCRIPTION
	OEM Remote Stand Alone Remote Starter:	OR D1.10	By default, LOCK, LOCK, LOCK Par défaut, VERROUILLE,VERROUILLE,VERROUILLE
		D1.1	
	Program bypass option with oem remote:	C1	OEM Remote Monitoring
	Program bypass option with RF KIT antenna:	H1 to H6	Supported RF Kits and select RF Kit

REMOTE STARTER FUNCTIONALITY

All doors must be closed.

3X

Press the OEM remote's Lock button 3x to remote-start (or remote-stop) the vehicle.

The vehicle will START.

REMOTE STARTER DIAGNOSTICS
MODULE RED LED

x2 flash :	Brake ON
x3 flash :	No tach
x4 flash :	Ignition before start
x5 flash :	Hood Open

REMOTE STARTER WARNING CARD

CUT THIS WARNING CARD AND STICK IT ON A VISIBLE PLACE:
 or use the package **RSPB**, Sold separately.

WARNING | ATTENTION

REMOTE STARTER

THE VEHICLE CAN BE STARTED BY EITHER: PRESSING THE LOCK BUTTON ON THE OEM REMOTE 3 TIMES CONSECUTIVELY OR BY A SMARTPHONE. **TURN ON** THE SAFETY SWITCH LOCATED UNDER THE DASHBOARD BEFORE WORKING ON THE VEHICLE.

DESCRIPTION

① Ignition switch Connector

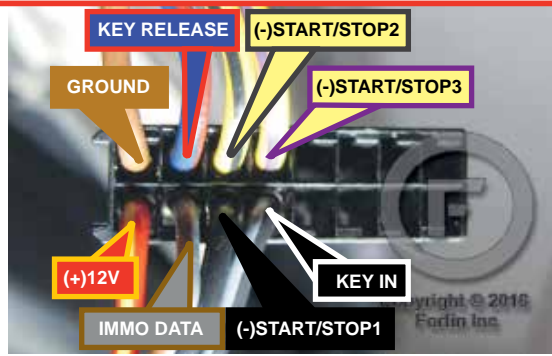

!
REMOVE THE PLASTIC PROTECTIVE CAP OVER THE KEY PORT TO SEE THE WIRE LOCATION.

② BCM, left of steering column, white connector with grey cover.

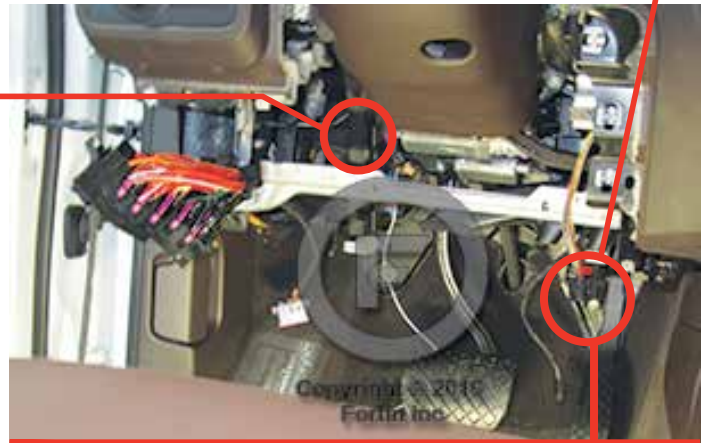
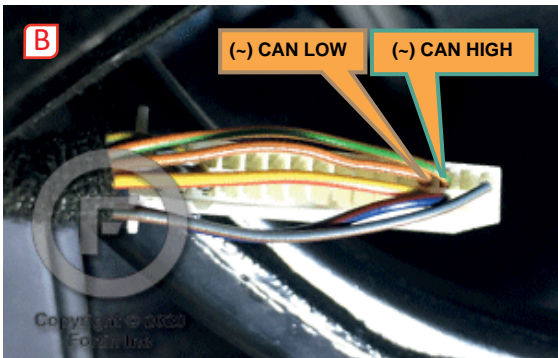
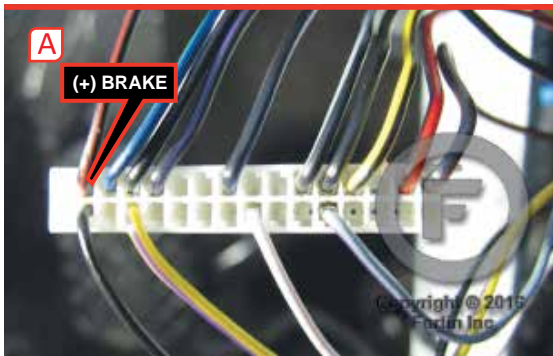

TOUAREG

AUTOMATIC TRANSMISSION WIRING CONNECTION

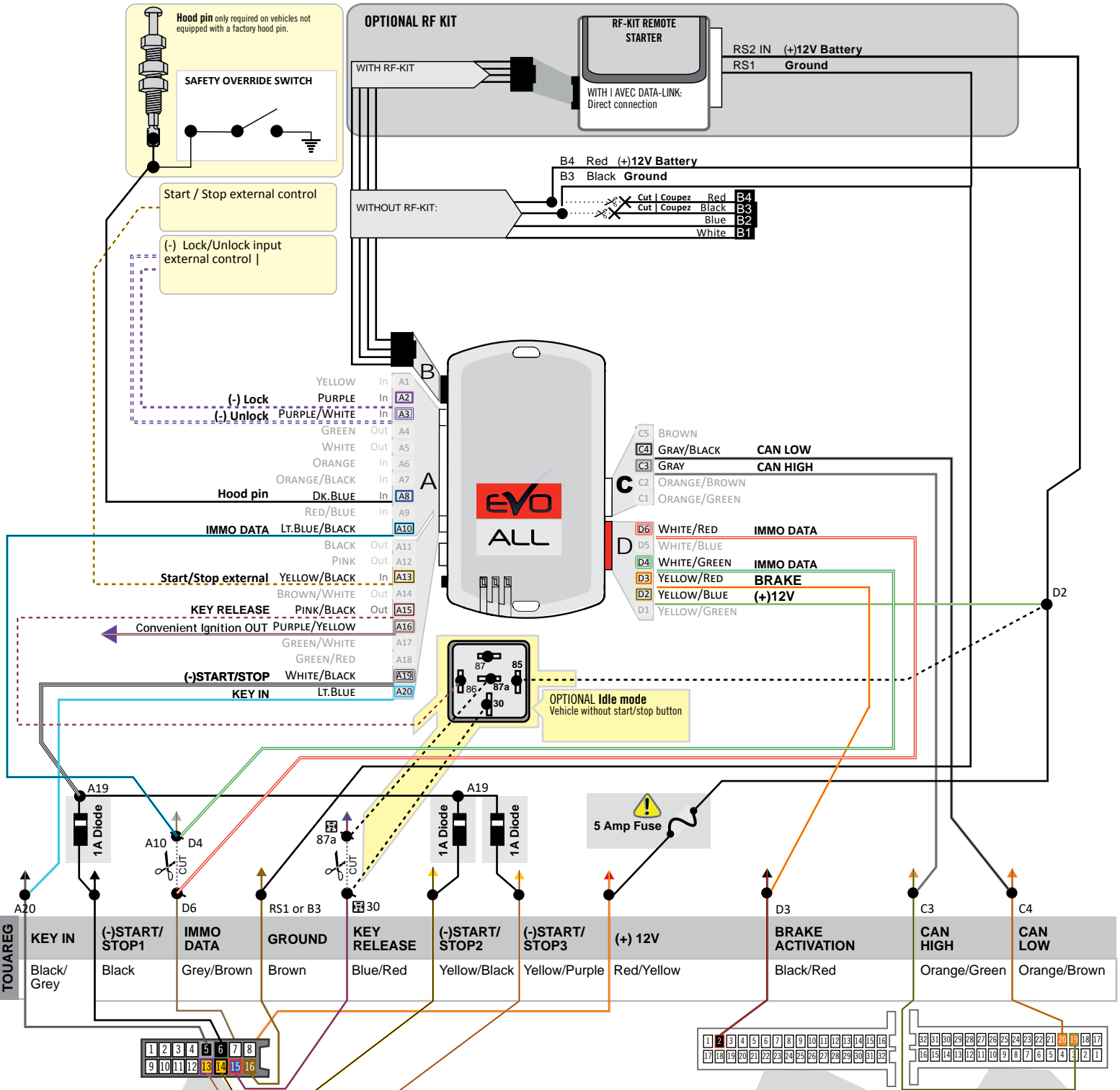

① Back view. 16-pin Black connector. At key port.

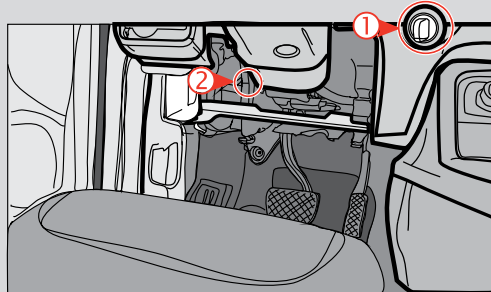
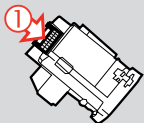

②A Back View - connector White Grey cover. At module comfort system.

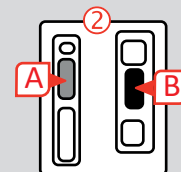

②B Back View - connector White 32-Pin with Black cover. At module comfort system.

THAR-AUD1 | AUTOMATIC TRANSMISSION CONNECTION

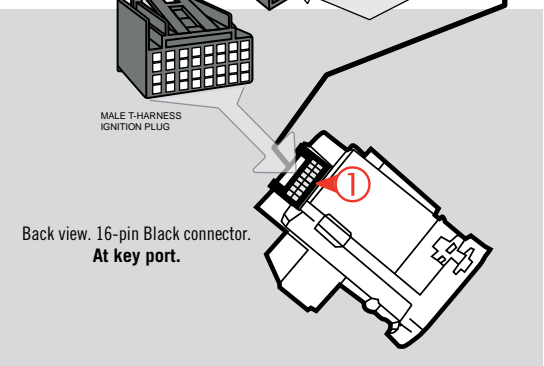
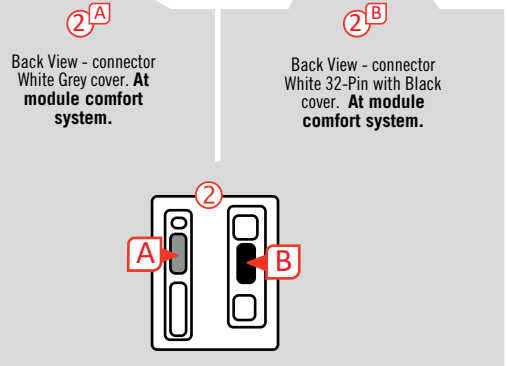
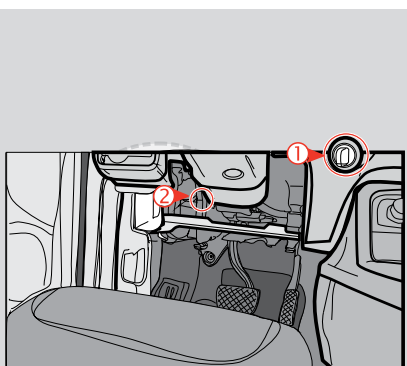
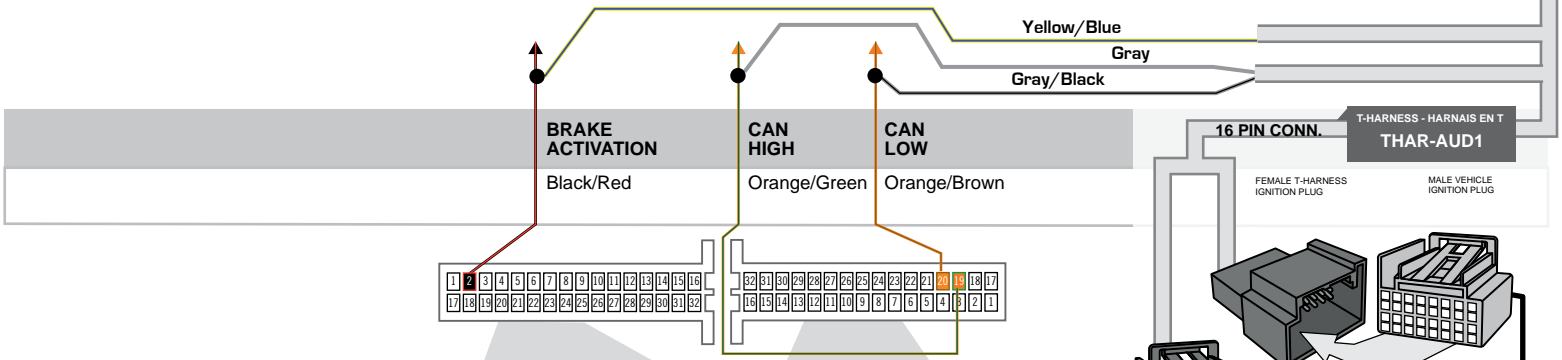
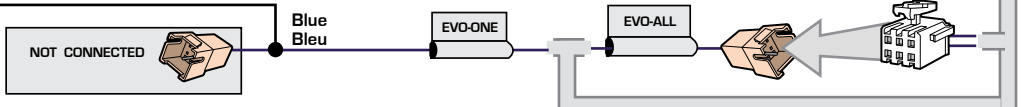
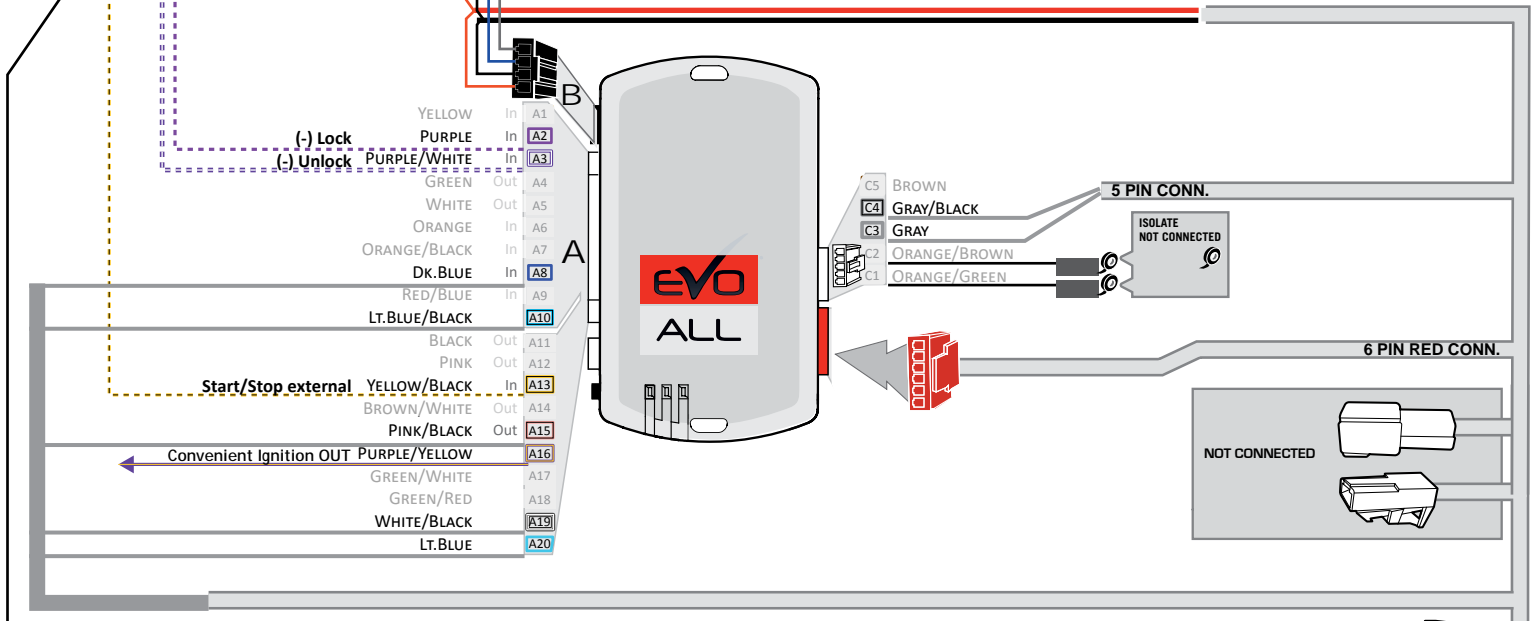
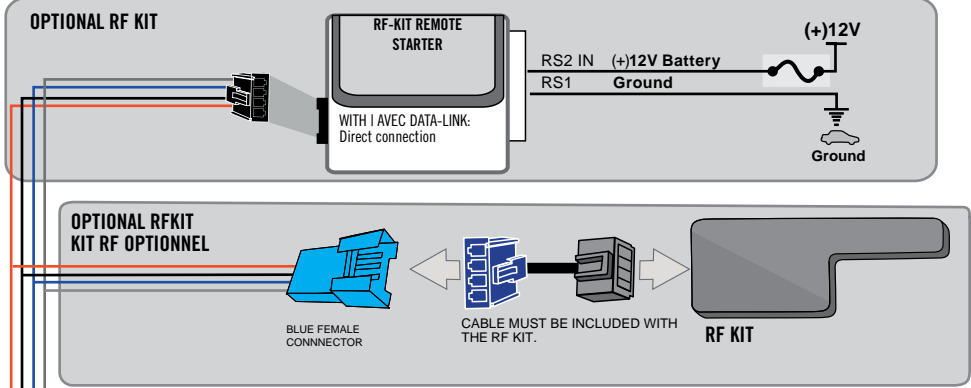
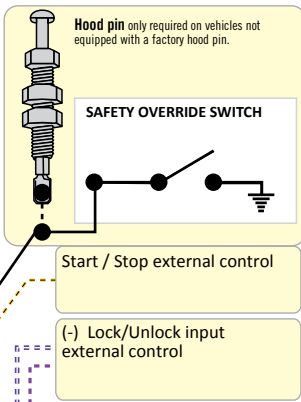

DCRYPTOR PROGRAMMING PROCEDURE



Parts required (not included)

- 1x **FLASH LINK UPDATER,**
- 1x **FLASH LINK MANAGER**
SOFTWARE
- 1x Microsoft Windows Computer with Internet connection

OR
OU

- 1x **FLASH LINK MOBILE**
- 1x **FLASH LINK MOBILE APP**
- 1x Smartphone *Android or iOS* with Internet connection
(Internet provider charges may apply)

BEFORE PROGRAMMING SET THE UNIT OPTIONS AND SAVE.

1

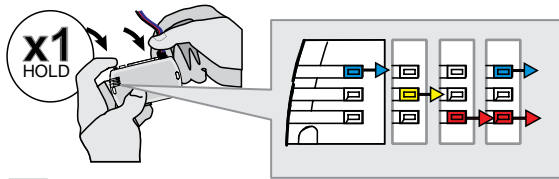

Press and hold the programming button:
Insert the 4-Pin (Data-Link) connector.

↳The Blue, Red, Yellow and Blue & Red LEDs will alternatively illuminate.

2

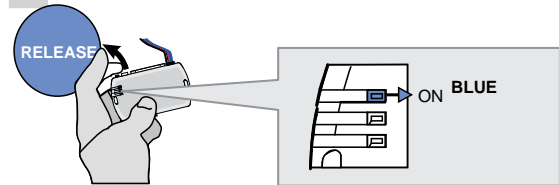

Release the programming button when the LED is BLUE.

If the LED is not solid BLUE disconnect the 4-Pin connector (Data-Link) and go back to step 1.

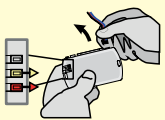

3

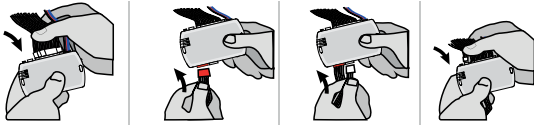

Insert the required remaining connectors.

4

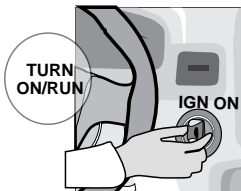

Insert and turn the key to the ignition ON position.

5

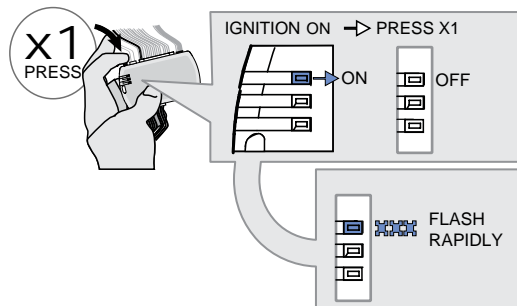

Press and release the programming button once (1x).

↳The BLUE LED will turn off.

↳The BLUE LED will flash rapidly.

KEY BYPASS PROGRAMMING PROCEDURE 2/3

6

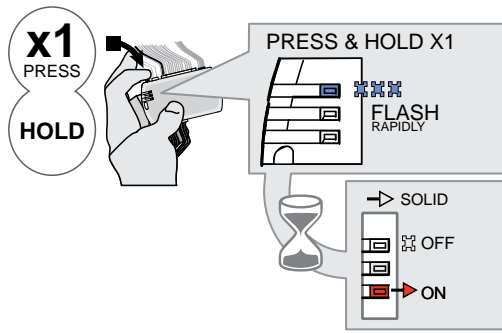

Press and Hold the programming button.

- ↳ Wait until the RED LED will turn ON solid.
- ↳ The BLUE LED will turn OFF.

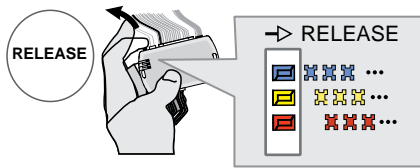

Release the programming button.

- ↳ The LEDs will alternate between BLUE, YELLOW and RED flashes.

OFF

ON

IGNITION ON



IGNITION OFF



Wait,

- ↳ The vehicle ignition turn ON than OFF a few times.

DO NOT TOUCH THE VEHICLE.

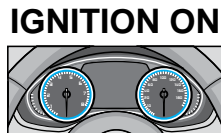

Wait,

- ↳ The vehicle ignition will turn ON .

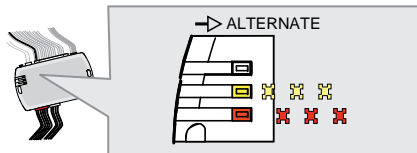

- ↳ The RED and YELLOW LEDs will alternate.

7

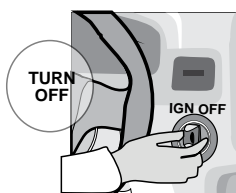

Turn the key to shut off the ignition.

KEY BYPASS PROGRAMMING PROCEDURE 3/3

8

Disconnect all the connectors and after the Data-Link (4-pins) connector.

9

Microsoft Windows Computer with Internet connection*

FLASH LINK UPDATER* **FLASH LINK MANAGER***
SOFTWARE

OR

Smartphone*
(Internet provider charges may apply)

VEHICLE'S OBDII CONNECTOR **FLASH LINK MOBILE***

Use the tool: FLASH LINK UPDATER or FLASH LINK MOBILE to visit the DCryptor menu.

*Parts required (not included)

10

AFTER DCRYPTOR PROGRAMMING COMPLETED
Go back to the vehicle and reconnect the 4-Pin (Data-Link) connector and after, all the remaining connector.

The module is now programmed.

REMOTE STARTER / ALARM VERIFICATION PROCEDURE
Test the remote starter. Remote start the vehicle.

REMOTE STARTER FUNCTIONALITY

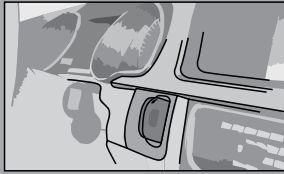

Vehicles with key port.

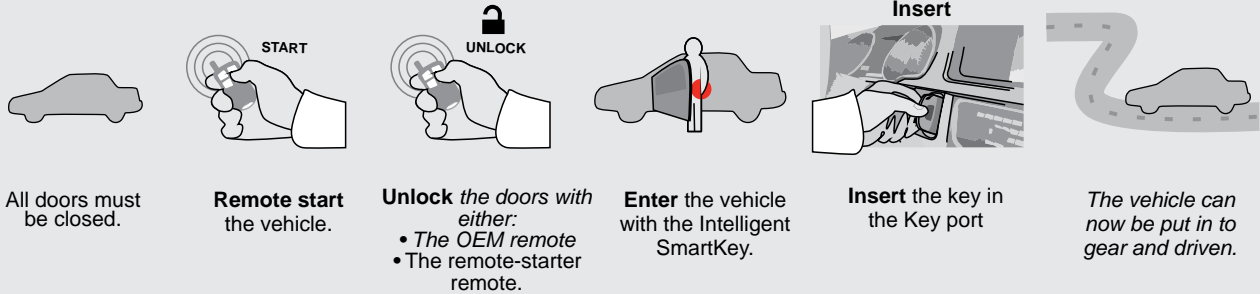

Vehicles with Push-to-Start.



THAR-AUD1

THARNESS INSTALLATION

ADDENDUM - SUGGESTED WIRING CONFIGURATION



Vehicle functions supported in this diagram (functional if equipped)

VEHICLE	YEARS	Immobilizer bypass	Lock	Unlock	Arm	Disarm	Tachometer	Trunk Release	Door Status	Trunk Status	Hood Status*	Hand-Brake Status	Foot-Brake Status	OEM Remote monitoring**	
AUDI															
A4	2009-2014	•	•	•	•	•	•	•	•	•	•	•	•	•	
	<i>TDI</i> 2009-2014	•	•	•	•	•	•	•	•	•	•	•	•	•	
	<i>Allroad</i> 2008-2014	•	•	•	•	•	•	•	•	•	•	•	•	•	
	<i>Allroad TDI</i> 2008-2014	•	•	•	•	•	•	•	•	•	•	•	•	•	
A5	2008-2014	•	•	•	•	•	•	•	•	•	•	•	•	•	
	<i>TDI</i> 2008-2014	•	•	•	•	•	•	•	•	•	•	•	•	•	
Q5	2009-2014	•	•	•	•	•	•	•	•	•	•	•	•	•	
	<i>TDI</i> 2009-2014	•	•	•	•	•	•	•	•	•	•	•	•	•	
RS5	2013-2014	•	•	•	•	•	•	•	•	•	•	•	•	•	
	<i>TDI</i> 2013-2014	•	•	•	•	•	•	•	•	•	•	•	•	•	
S4	2009-2014	•	•	•	•	•	•	•	•	•	•	•	•	•	
	<i>TDI</i> 2009-2014	•	•	•	•	•	•	•	•	•	•	•	•	•	
S5	2008-2014	•	•	•	•	•	•	•	•	•	•	•	•	•	
	<i>TDI</i> 2008-2014	•	•	•	•	•	•	•	•	•	•	•	•	•	
SQ5	2013-2014	•	•	•	•	•	•	•	•	•	•	•	•	•	
	<i>TDI</i> 2013-2014	•	•	•	•	•	•	•	•	•	•	•	•	•	

COMPATIBLE MODULE REQUIRED:

QR CODE ON THE LABEL

MANUFACTURED AFTER: **2019**

60.[10]

MINIMUM

To add the firmware version and the options, use the **FLASH LINK UPDATER** or **FLASH LINK MOBILE** tool, sold separately.

NOTES

****OEM Remote Monitoring**

The vehicles OEM remote will remain functional when the vehicle is running, however, the intelligent access key will not unlock the doors when the vehicle is running.

MANDATORY INSTALL

***HOOD PIN**



HOOD STATUS: THE HOOD PIN SWITCH MUST BE INSTALLED IF THE VEHICLE CAN BE REMOTE STARTED WITH THE HOOD OPEN, SET FUNCTION **A11** TO OFF.

A11

OFF

Notice: the installation of safety elements are mandatory. The hood pin is an essential security element and must be installed.

THIS MODULE MUST BE INSTALLED BY A QUALIFIED TECHNICIAN. A WRONG CONNECTION CAN CAUSE PERMANENT DAMAGE TO THE VEHICLE.

NOTES

<p>IF THE VEHICLE IS NOT EQUIPPED WITH FUNCTIONAL HOOD PIN:</p>		<p>A11</p>	<p>OFF</p>	<p>Hood trigger (Output Status).</p>
	<p>Program bypass option:</p>	<p>UNIT OPTION</p>		<p>DESCRIPTION</p>
		<p>C1</p>	<p>OEM Remote status (Lock/Unlock) monitoring</p>	
		<p>D6</p>	<p>Push-to-Start</p>	
<p>Program bypass option (If equipped with OEM alarm):</p>		<p>D2</p>	<p>Unlock before / Lock after (Disarm OEM alarm)</p>	

DESCRIPTION

④ HARNESS UNDER THE HOOD

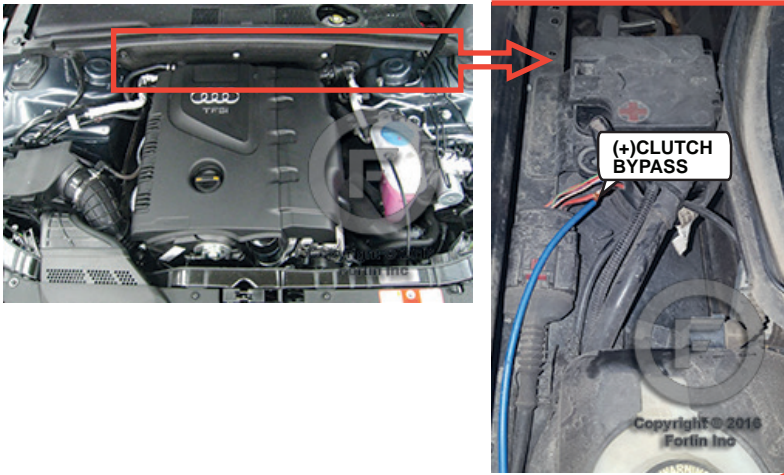

⑤ MANUAL TRANSMISSION: AT RELAY IN JUNCTION BOX - MAIN POWER

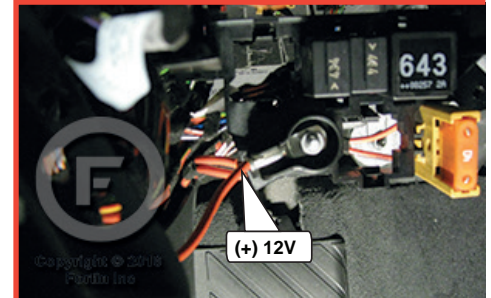

② UNDER STEERING COLUMN TWISTED PAIR

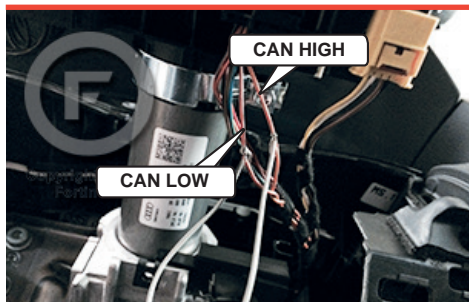

① KEY PORT

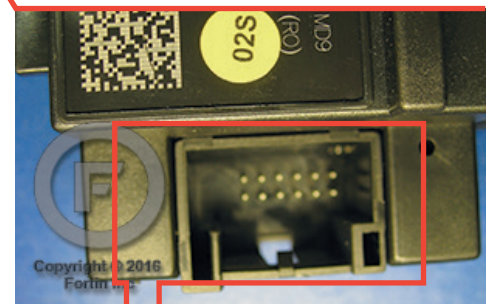

③ AT BRAKE SWITCH

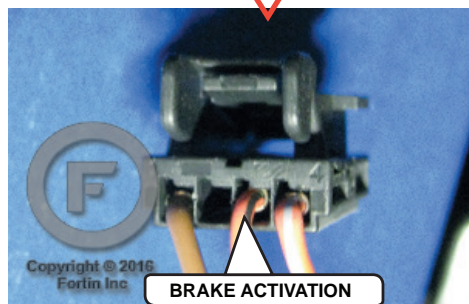
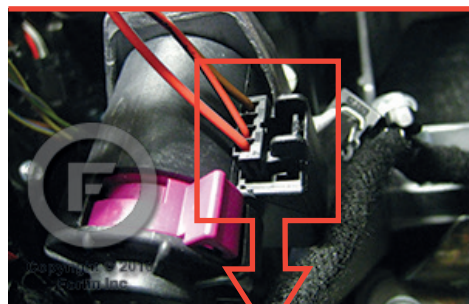

*AUTOMATIC TRANSMISSION

⚠ Remove the plastic protective cap over the Key Port to see the wire location.

AUTOMATIC TRANSMISSION WIRING CONNECTION

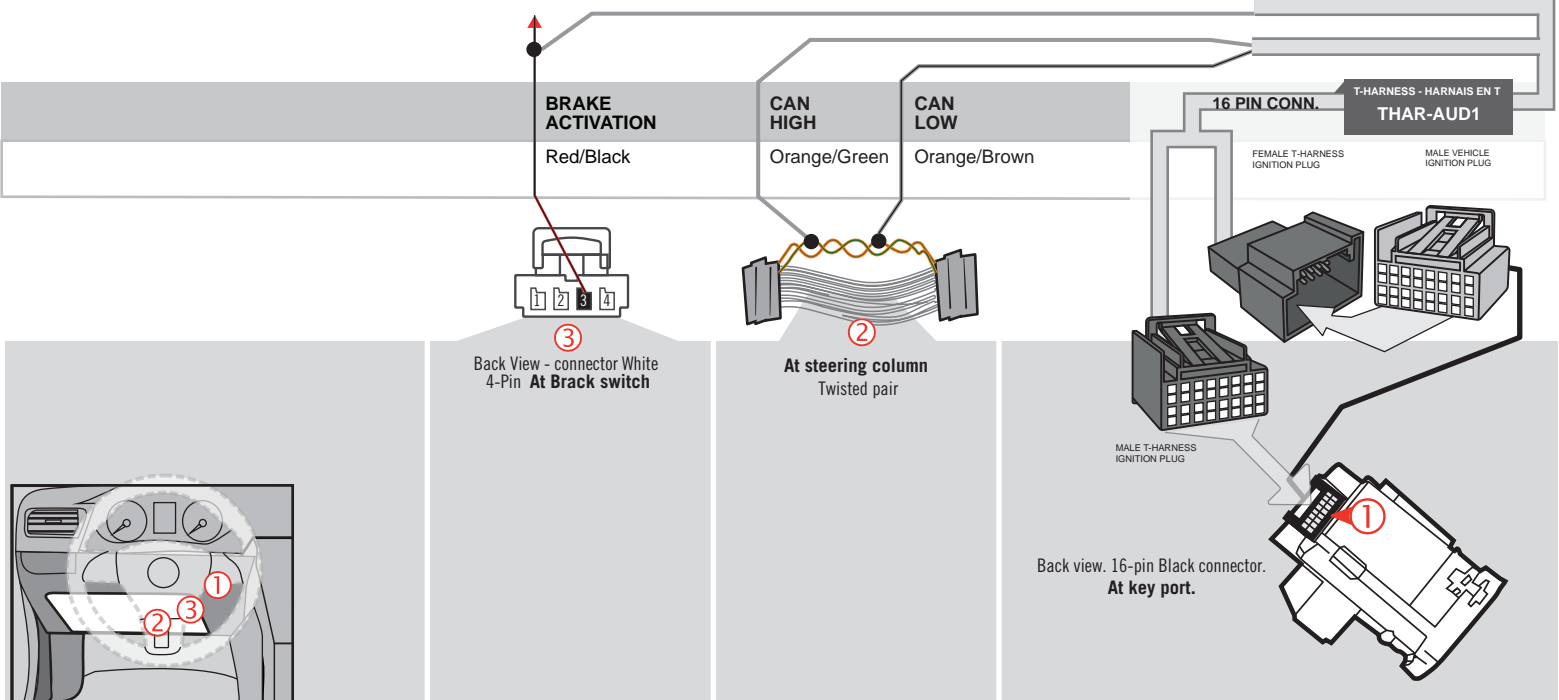
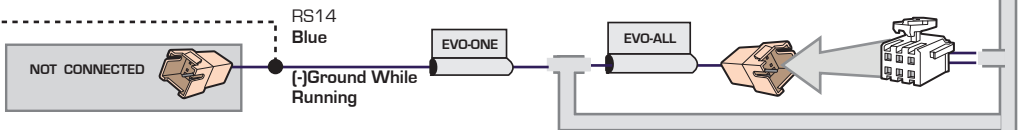
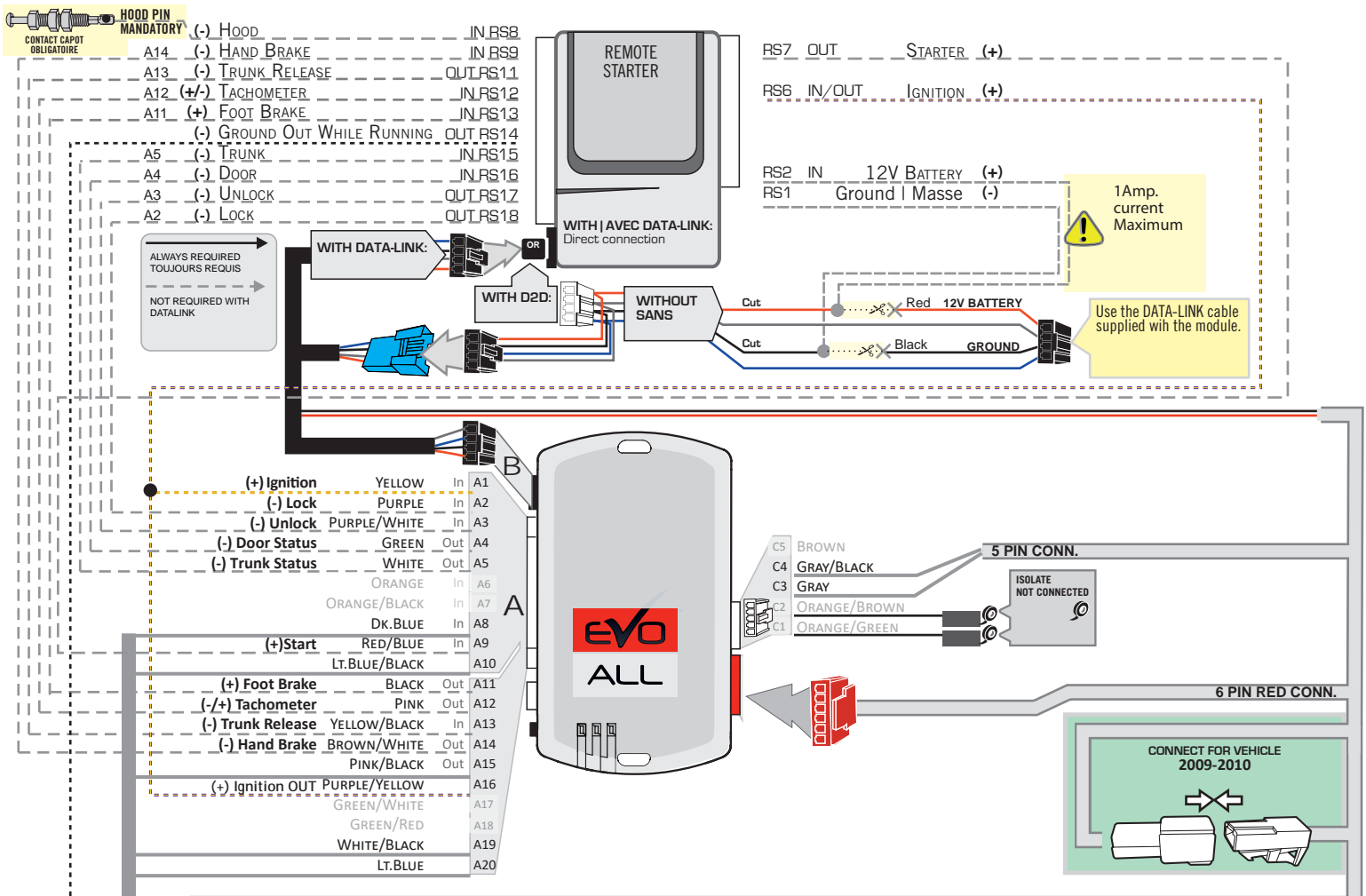

MANUAL TRANSMISSION WIRING CONNECTION

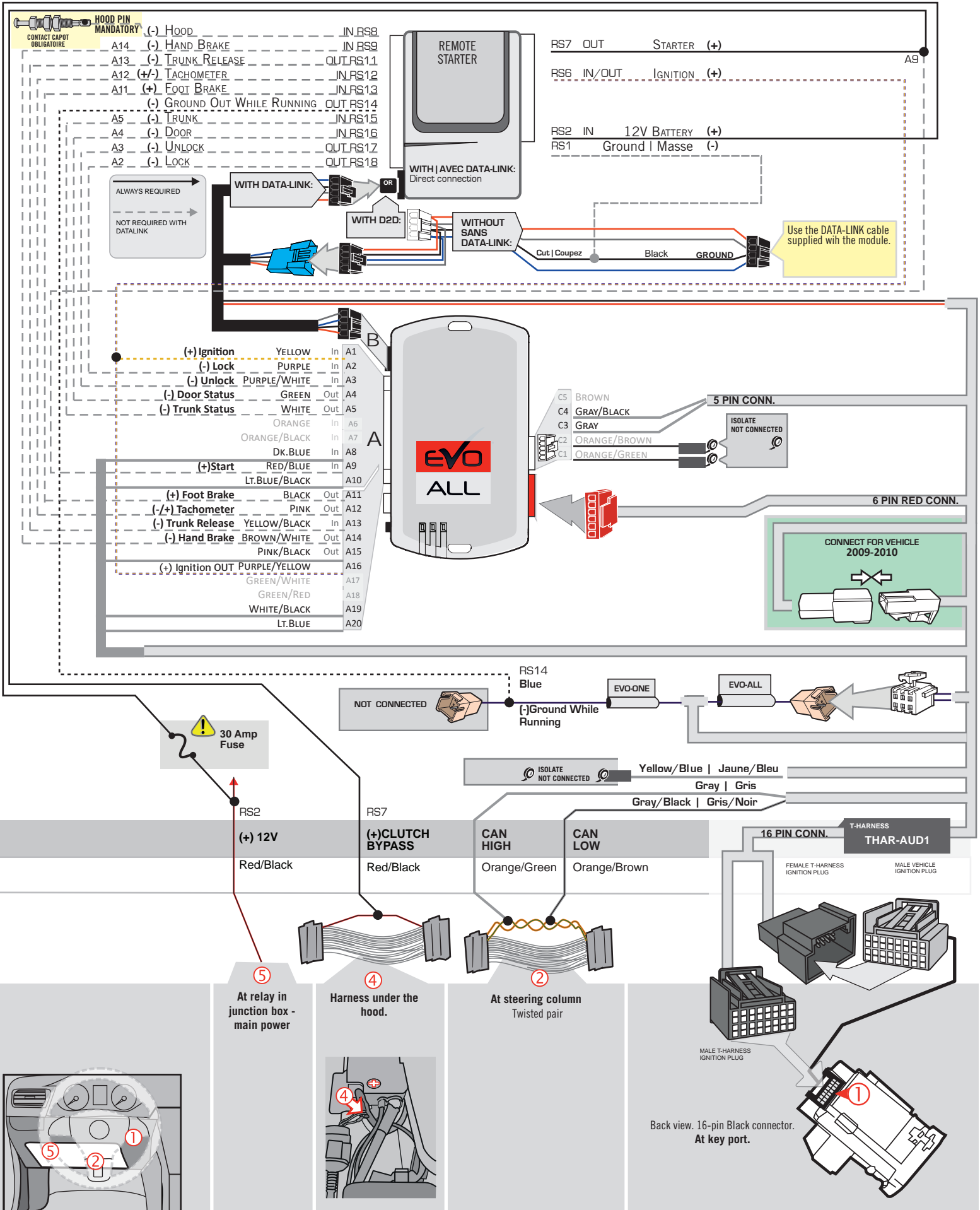

DCRYPTOR PROGRAMMING PROCEDURE



- Parts required (not included)**
- 1x **FLASH LINK UPDATER, SOFTWARE**
 - 1x **FLASH LINK MANAGER**
 - 1x Microsoft Windows Computer with Internet connection

OR
OU

- 1x **FLASH LINK MOBILE**
- 1x **FLASH LINK MOBILE APP**
- Smartphone *Android or iOS* with Internet connection
(Internet provider charges may apply)

BEFORE PROGRAMMING SET THE UNIT OPTION AND SAVE.

1

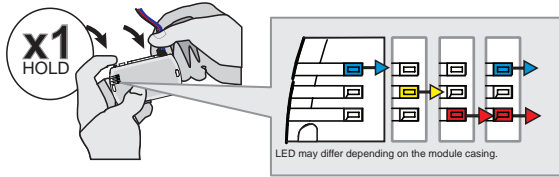

Press and hold the programming button:
Connect the 4-PIN Data-link connector (Black connector).

↳ The **BLUE, RED, YELLOW** and **BLUE & RED** LEDs will alternatively illuminate.

2

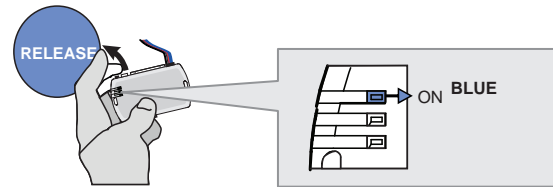

Release the programming button when the **BLUE** LED is ON.

If the LED is not solid **BLUE** **disconnect** the 4-Pin connector (Data-Link) and go back to step 1.

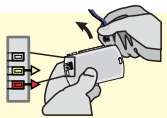

3

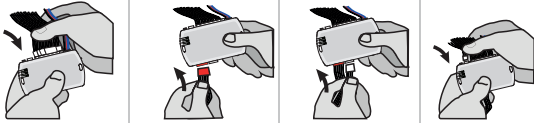

Insert the required remaining connectors.

4

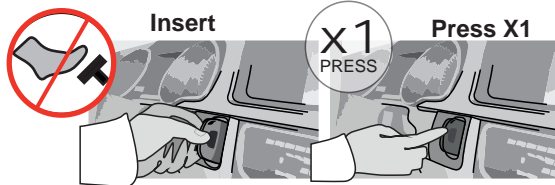

Insert the key into the key port and **Press** the key to turn **ON** the ignition.
(Do not press the brake pedal)

5

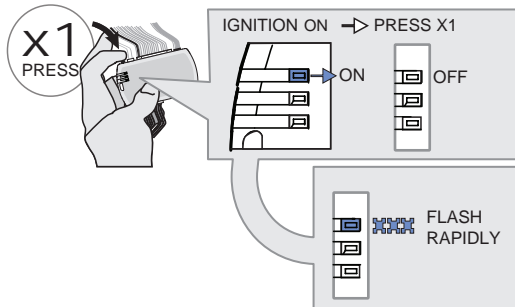

Press and release the programming button once (1x).

↳ The **BLUE** LED will turn off.

↳ The **BLUE** LED will flash rapidly.

6

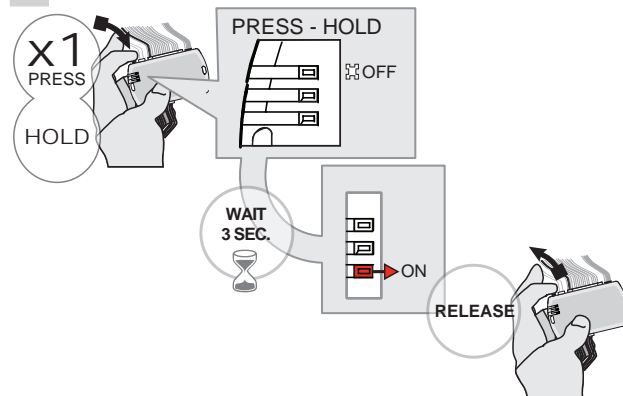

Press and hold the programming button.

↳ The **BLUE** LED will turn OFF.

Wait,

↳ The **RED** LED will turn ON.

Release the programming button.

KEY BYPASS PROGRAMMING PROCEDURE 2/2

7



WAIT,
this process may take up
to 2 minutes

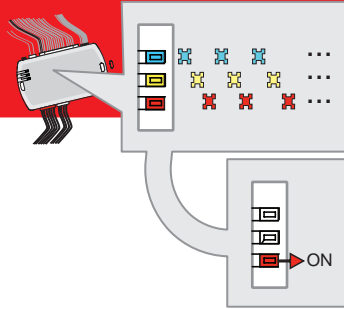

Wait, do not touch the
vehicle or the module.

↳The BLUE, RED and YELLOW
LEDs will rapidly alternate.

Wait,

↳The RED LED to turn ON.



8

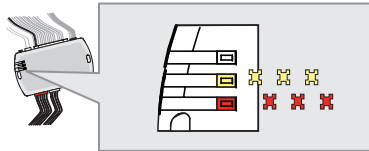

Wait,

↳**Wait** for the RED and YELLOW
LEDs to slowly alternate.

9



Press the key to shut off
the ignition.

10

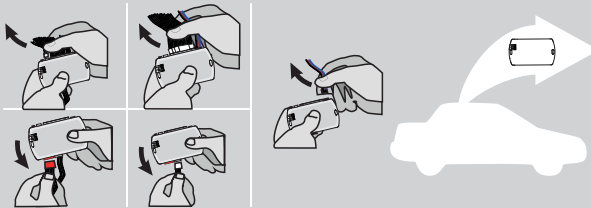

Disconnect all the connectors and after
the Data-Link (4-pins) connector.

11

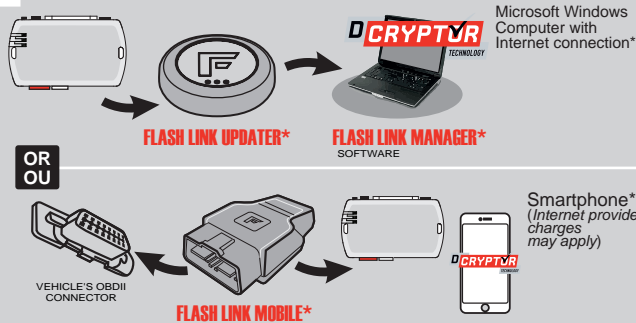

Use the tool:
FLASH LINK UPDATER or
FLASH LINK MOBILE
to visit the DCryptor menu.

*Parts required (not included)

12

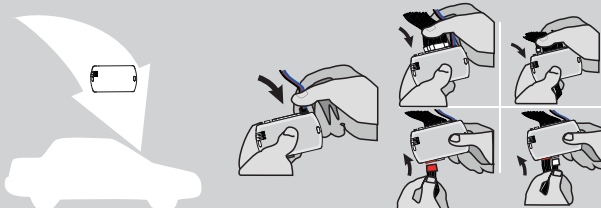

AFTER DCRYPTOR PROGRAMMING COMPLETED
Go back to the vehicle and **reconnect** the 4-Pin (Data-Link)
connector and after, all the remaining connector.



The module is now
programmed.



**REMOTE STARTER / ALARM VERIFICATION
PROCEDURE**

Test the remote starter. Remote start the vehicle.

REMOTE STARTER FUNCTIONALITY

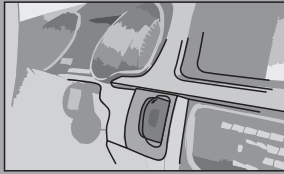

Vehicles with key port.

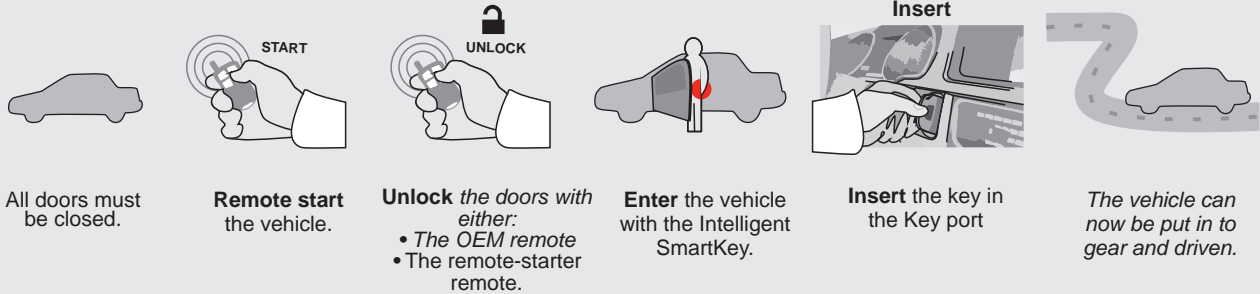

Vehicles with Push-to-Start.



THARNESS STAND ALONE INSTALLATION

ADDENDUM - SUGGESTED WIRING CONFIGURATION

THAR-AUD1



ONLY COMPATIBLE WITH AUTOMATIC TRANSMISSION VEHICLES.



Vehicle functions supported in this diagram (functional if equipped)

VEHICLE	YEARS	Immobilizer bypass	Lock	Unlock	Arm	Disarm	Tachometer	Trunk Release	Door Status	Trunk Status	Hood Status*	Hand-Brake Status	Foot-Brake Status	OEM Remote monitoring**
		AUDI												
A4	2009-2014	•	•	•	•	•	•	•	•	•	•	•	•	•
	<i>TDI</i> 2009-2014	•	•	•	•	•	•	•	•	•	•	•	•	•
	<i>Allroad</i> 2008-2014	•	•	•	•	•	•	•	•	•	•	•	•	•
	<i>Allroad TDI</i> 2008-2014	•	•	•	•	•	•	•	•	•	•	•	•	•
A5	2008-2014	•	•	•	•	•	•	•	•	•	•	•	•	•
	<i>TDI</i> 2008-2014	•	•	•	•	•	•	•	•	•	•	•	•	•
Q5	2009-2014	•	•	•	•	•	•	•	•	•	•	•	•	•
	<i>TDI</i> 2009-2014	•	•	•	•	•	•	•	•	•	•	•	•	•
RS5	2013-2014	•	•	•	•	•	•	•	•	•	•	•	•	•
	<i>TDI</i> 2013-2014	•	•	•	•	•	•	•	•	•	•	•	•	•
S4	2009-2014	•	•	•	•	•	•	•	•	•	•	•	•	•
	<i>TDI</i> 2009-2014	•	•	•	•	•	•	•	•	•	•	•	•	•
S5	2008-2014	•	•	•	•	•	•	•	•	•	•	•	•	•
	<i>TDI</i> 2008-2014	•	•	•	•	•	•	•	•	•	•	•	•	•
SQ5	2013-2014	•	•	•	•	•	•	•	•	•	•	•	•	•
	<i>TDI</i> 2013-2014	•	•	•	•	•	•	•	•	•	•	•	•	•

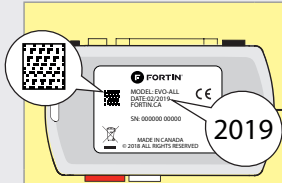

COMPATIBLE MODULE REQUIRED:

QR CODE ON THE LABEL MANUFACTURED AFTER: 2019

FIRMWARE VERSION

60.[10]

MINIMUM

To add the firmware version and the options, use the **FLASH LINK UPDATER** or **FLASH LINK MOBILE** tool, sold separately.

NOTES

****OEM Remote Monitoring**

The vehicles OEM remote will remain functional when the vehicle is running, however, the intelligent access key will not unlock the doors when the vehicle is running.

MANDATORY INSTALL

***HOOD PIN**



HOOD STATUS: THE HOOD PIN SWITCH MUST BE INSTALLED IF THE VEHICLE CAN BE REMOTE STARTED WITH THE HOOD OPEN, SET FUNCTION A11 TO OFF.

A11

OFF

Notice: the installation of safety elements are mandatory. The hood pin is an essential security element and must be installed.

THIS MODULE MUST BE INSTALLED BY A QUALIFIED TECHNICIAN. A WRONG CONNECTION CAN CAUSE PERMANENT DAMAGE TO THE VEHICLE.

NOTES

<p>IF THE VEHICLE IS NOT EQUIPPED WITH FUNCTIONAL HOOD PIN:</p>		<p>A11</p>	<p>OFF</p>	<p>Hood trigger (Output Status).</p>
	<p>Program bypass option:</p>	<p>UNIT OPTION</p>		<p>DESCRIPTION</p>
		<p>C1</p>	<p>OEM Remote status (Lock/Unlock) monitoring</p>	
		<p>D6</p>	<p>Push-to-Start</p>	
<p>Program bypass option (If equiped with OEM alarm):</p>		<p>D2</p>	<p>Unlock before / Lock after (Disarm OEM alarm)</p>	

PARTS REQUIRED (NOT INCLUDED)

1x **FLASH LINK UPDATER,**
1x **FLASH LINK MANAGER**
SOFTWARE
1x Microsoft Windows Computer with Internet connection

OR

1x **FLASH LINK MOBILE**
1x **FLASH LINK MOBILE APP**
Smartphone *Android* or *iOS* with Internet connection (*provider charges may apply*).
1x

MANDATORY

HOOD PIN



REMOTE START SAFETY OVERRIDE SWITCH

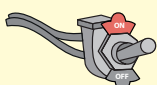





VALET SWITCH

Part #: RSPB available, Sold separately.

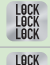
Notice: the installation of safety elements are mandatory. The hood pin and the valet switch are essential security elements and must be installed.

STAND ALONE CONFIGURATION | CONFIGURATION EN DÉMARREUR AUTONOME

	Program bypass option	UNIT OPTION	DESCRIPTION
	OEM Remote Stand Alone Remote Starter:	D1.10 	By default, LOCK, LOCK, LOCK Par défaut, VERROUILLE,VERROUILLE,VERROUILLE
		D1.1 	
	Program bypass option with oem remote:	C1	OEM Remote Monitoring
	Program bypass option with RF KIT antenna:	H1 to H6 H1 à H6	Supported RF Kits and select RF Kit

REMOTE STARTER FUNCTIONALITY



All doors must be closed.

3X 

Press the OEM remote's Lock button 3x to remote-start (or remote-stop) the vehicle.



START 

The vehicle will START.

REMOTE STARTER DIAGNOSTICS
MODULE RED LED

x2 flash :	Brake ON
x3 flash :	No tach
x4 flash :	Ignition before start
x5 flash :	Hood Open

REMOTE STARTER WARNING CARD | CARTE D'AVERTISSEMENT DE DÉMARREUR À DISTANCE



CUT THIS WARNING CARD AND STICK IT ON A VISIBLE PLACE:
or use the package **RSPB**, Sold separately.

WARNING | ATTENTION



REMOTE STARTER

THE VEHICLE CAN BE STARTED BY EITHER: PRESSING THE LOCK BUTTON ON THE OEM REMOTE 3 TIMES CONSECUTIVELY OR BY A SMARTPHONE. **TURN ON** THE SAFETY SWITCH LOCATED UNDER THE DASHBOARD BEFORE WORKING ON THE VEHICLE.

DESCRIPTION

② UNDER STEERING COLUMN
TWISTED PAIR

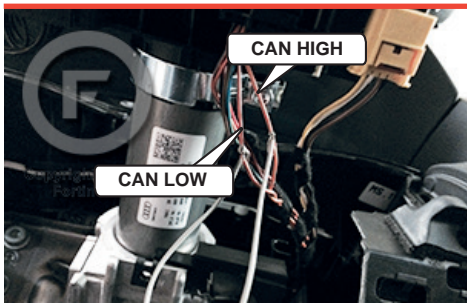

① KEY PORT



③ AT BRAKE SWITCH

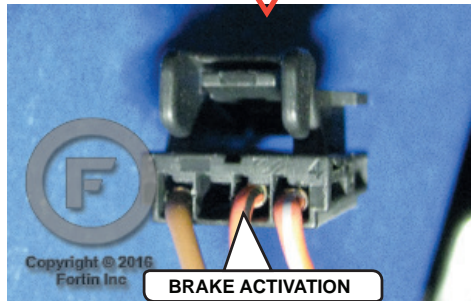
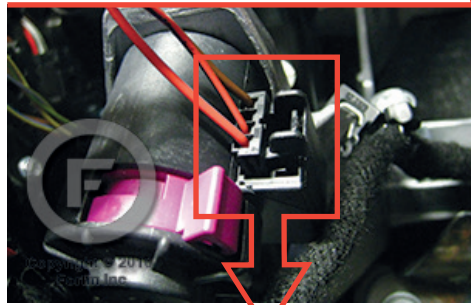

*AUTOMATIC TRANSMISSION

⚠ Remove the plastic protective cap over the Key Port to see the wire location.

AUTOMATIC TRANSMISSION WIRING CONNECTION

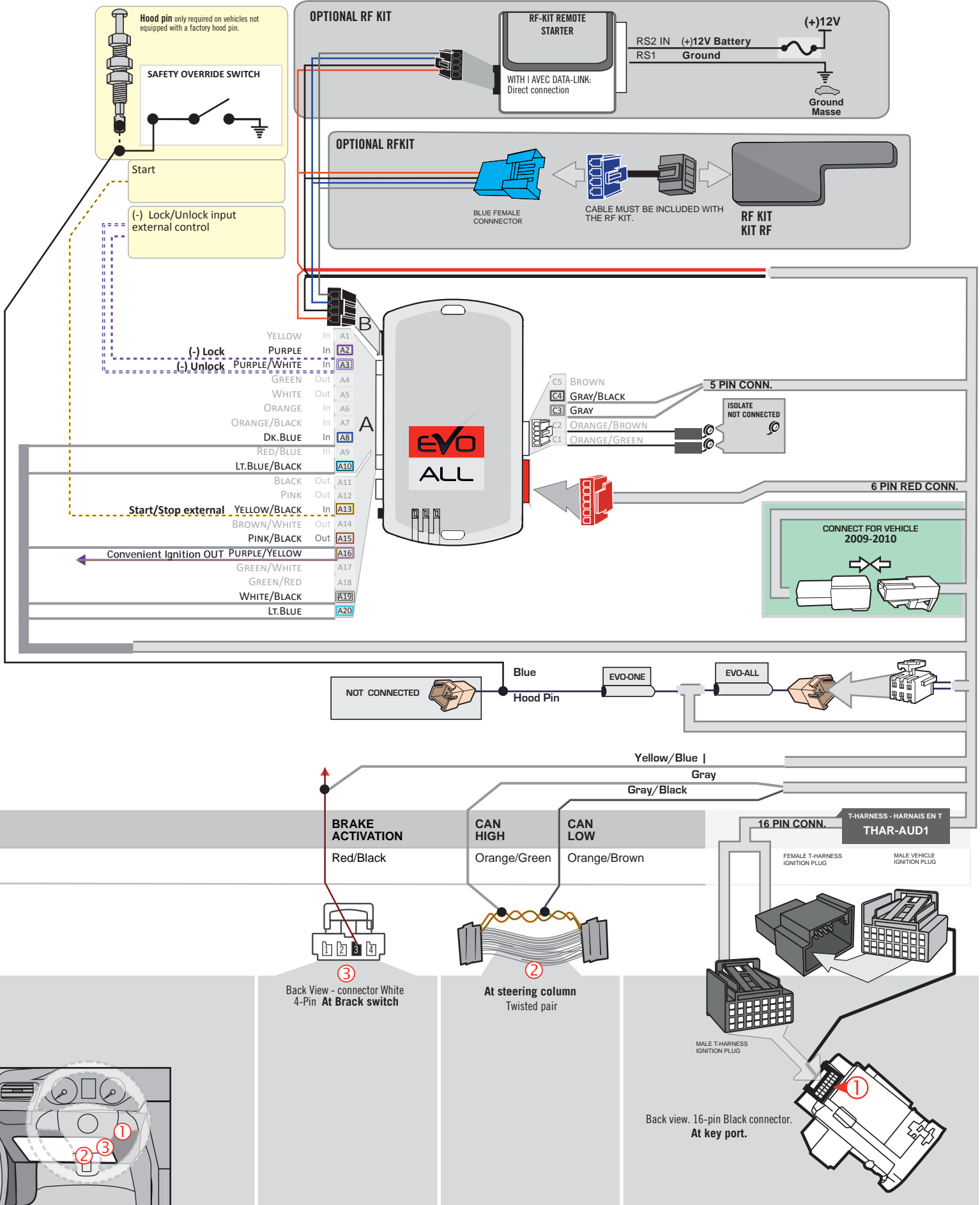

DCRYPTOR PROGRAMMING PROCEDURE |



- Parts required (not included)**
- 1x **FLASH LINK UPDATER, FLASH LINK MANAGER** SOFTWARE
 - 1x Microsoft Windows Computer with Internet connection

OR
OU

- 1x **FLASH LINK MOBILE**
- 1x **FLASH LINK MOBILE APP**
- 1x Smartphone *Android or iOS* with Internet connection
(Internet provider charges may apply)

BEFORE PROGRAMMING SET THE UNIT OPTION AND SAVE.

1

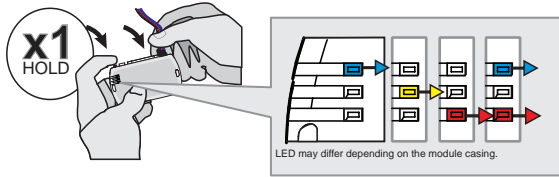

Press and hold the programming button:
Connect the 4-PIN Data-link connector (Black connector).

↳ The **BLUE, RED, YELLOW** and **BLUE & RED** LEDs will alternatively illuminate.

2

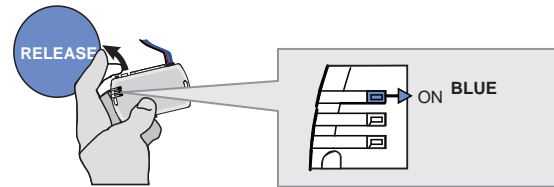

Release the programming button when the **BLUE LED** is ON.

If the LED is not solid **BLUE** **disconnect** the 4-Pin connector (Data-Link) and go back to step 1.

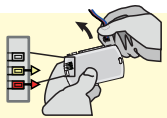

3

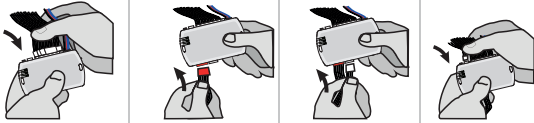

Insert the required remaining connectors.

4

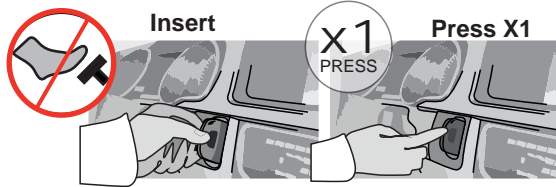

Insert the key into the key port and **Press** the key to turn **ON** the ignition.
(Do not press the brake pedal)

5

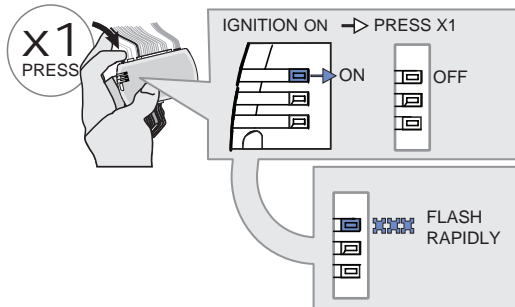

Press and release the programming button once (1x).

↳ The **BLUE LED** will turn off.

↳ The **BLUE LED** will flash rapidly.

6

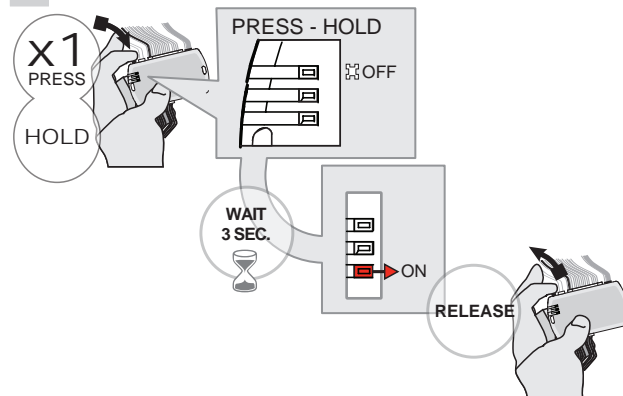

Press and hold the programming button.

↳ The **BLUE LED** will turn OFF.

Wait,

↳ The **RED LED** will turn ON.

Release the programming button.

KEY BYPASS PROGRAMMING PROCEDURE 2/2

7



WAIT,
this process may take up
to 2 minutes

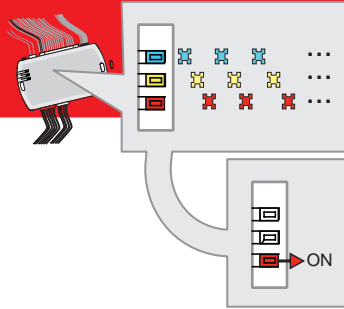

Wait, do not touch the
vehicle or the module.

↳The BLUE, RED and YELLOW
LEDs will rapidly alternate.

Wait,

↳The RED LED to turn ON.



8

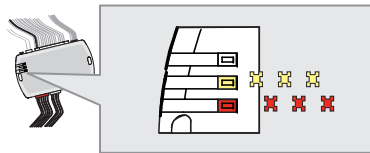

Wait,

↳**Wait** for the RED and YELLOW
LEDs to slowly alternate.

9



Press the key to shut off
the ignition.

10

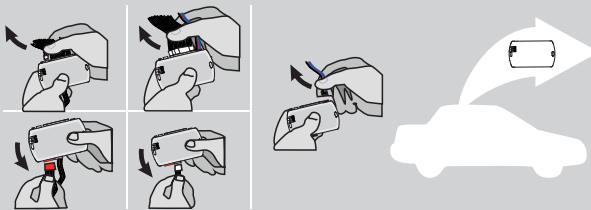

Disconnect all the connectors and after
the Data-Link (4-pins) connector.

11

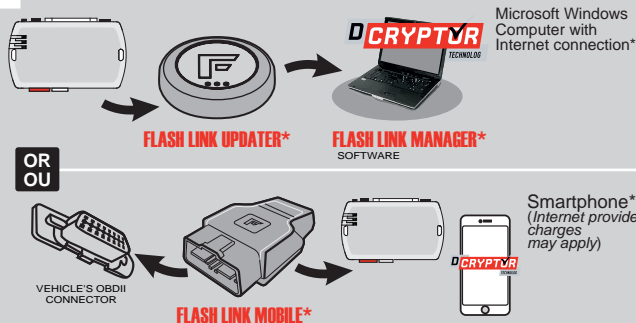

Use the tool:
FLASH LINK UPDATER or
FLASH LINK MOBILE
to visit the DCRYPTOR menu.

*Parts required (not included)

12

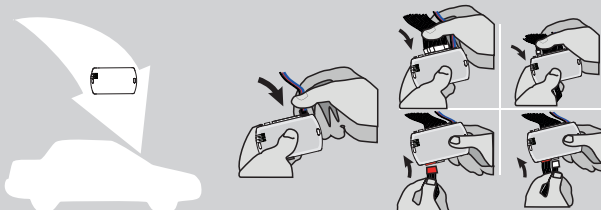

AFTER DCRYPTOR PROGRAMMING COMPLETED
Go back to the vehicle and **reconnect** the 4-Pin (Data-Link)
connector and after, all the remaining connector.



The module is now
programmed.



**REMOTE STARTER / ALARM VERIFICATION
PROCEDURE**

Test the remote starter. Remote start the vehicle.

REMOTE STARTER FUNCTIONALITY

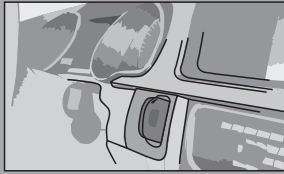

Vehicles with key port.



All doors must be closed.

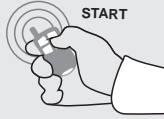

Remote start the vehicle.



Unlock the doors with either:
• The OEM remote
• The remote-starter remote.

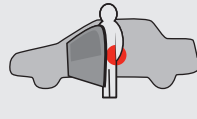

Enter the vehicle with the Intelligent SmartKey.

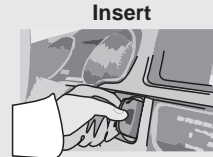

Insert the key in the Key port



The vehicle can now be put in to gear and driven.



Vehicles with Push-to-Start.



All doors must be closed.

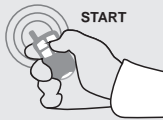

Remote start the vehicle.



Unlock the doors with either:
• The OEM remote
• The remote-starter remote.



Enter the vehicle with the Intelligent SmartKey.



The vehicle can now be put in to gear and driven.