

B01-B03 5/6 Hole Adapter Instructions

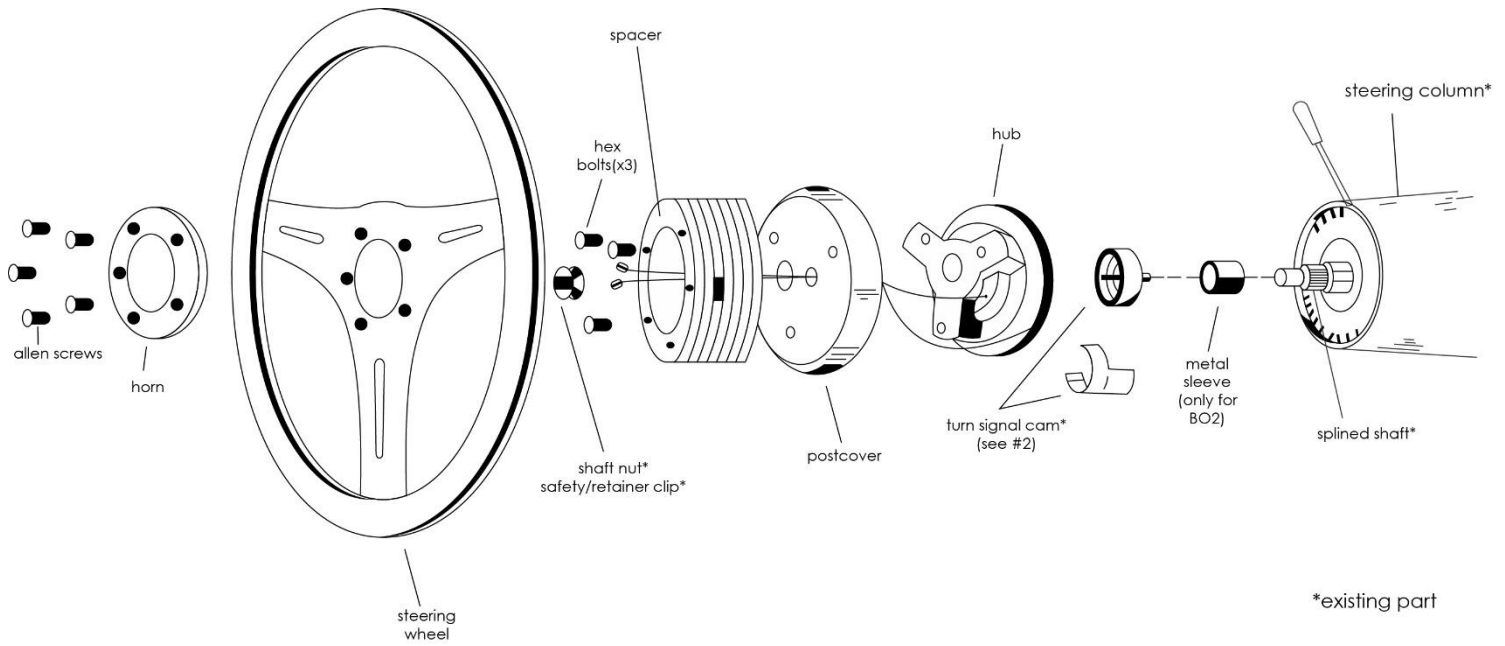

1. After removal of original wheel and associated hardware, slide the metal sleeve down over the splined shaft until it bottoms out.
***Note:** Not all columns need the sleeve; if this prevents it from bottoming or fitting snugly, do not use the sleeve.
 2. If your old wheel has a turn cam, remove and reinstall in the same position on the back of the new hub. This part is affixed to the steering wheel usually by a spring or screw.
***Note:** Some cams are molded into the wheel and are not removable, use roll pin(s) provided in this kit for these applications. See roll pin instructions on back.
 3. Apply some grease over the copper contact to reduce wear. Position the hub onto the splined shaft while observing that the wheel is aligned to "top" in accordance with the mark made when you removed the original wheel.
 4. Position the post cover so that the horn wires come up through the top.
 5. When using kit B01 on older Fords and there is a gap between the post cover and column, there is an adjustment that must be made. Loosen the bolt under the dash holding the column in position, move the column housing up or down as needed leaving about 1/8" gap and then retighten the bolts.
 6. Position the spacer so that the horn wires come up through the top. Secure and tighten the hub, post cover, and spacer with the three hex bolts provided in the kit. Tighten the shaft nut.
- Torque Requirements:**
Hex Bolts 10-12 ft/lbs
Shaft Nut 25-30 ft/lbs
7. Position the steering wheel and route the horn wires through the center of the wheel.
 8. Connect the horn wires to the terminals on the back of the horn wire.
 9. Install the horn button onto center of the wheel. Re-connect battery or replace horn fuse. Enjoy your new Forever Sharp steering wheel!

Roll Pin Instructions

These pins are for the purpose of doing a turn signal delete when the factory assembly cannot be used with the hub.

1. The pins, when inserted into the back of the hub must match the depth and position of the pins on your original wheel. The slot in the pins must face toward the center of the shaft. *Prior to installing the pins, mount the hub on the shaft and check for the proper clearance and turn signal operation.
2. Turn the hub and wheel in both directions. If the roll pins touch on the turn signal delete mechanism while turn signals are in the off position you will need to bend the pins in the necessary direction so they will clear without making any contact. Failure to do this will result in damage to your turn signals.

Note: On some wheels, you will need to bend the horn brush towards you. This brush is on the steering column right next to the turn signals.

3. After bending the contact, place the hub on the shaft and make sure the horn contact is touching the contact ring on the hub.