

FORM FIT HOOD PROTECTOR

Toyota Tacoma 2005 -

HDW 20E 05

Hardware Kit

- 3 – Large Bumpons
- 4 – 3M Anti-Abrasion Film Pad
- 4 – Clip Bodies
- 4 – Pins
- 4 – Nylon Washers
- 4 – 'L' Brackets
- 4 – #6 x 5/8" Truss Head Screws

Tools Required

- 1 – Phillips Screwdriver #2
- 1 – Tape Measure
- 1 – Grease Pencil



* **Note: This Part has 3 Supporting Clips- already installed on the protector**

Installation

1. Be sure that the hood is clean and dry inside and out.
2. Position the bumpons on the hood as shown in illustration #1. **Attention: The bumpons must be installed on the hood not the protector!!!!** If the bumpons are installed on the protector, they will wear through the paint.
3. Open the hood of the vehicle.
4. Using a tape measure and grease pencil, measure and mark the center of the leading edge of the hood.
5. Center the protector on the hood by aligning the notch on the leading edge of the protector with the mark determined in previous step.
6. Work from left to right pushing each of the protector supporting clips (already attached to protector) over the edge of the hood. Be sure the protector clips are fully seated against the hood edge.
7. Peel and fold an anti-abrasion film pad in half over the edge of the hood, underneath each of the four (4) holes in the protector. See *Illustration #2 and #3 – Step #7*.
- 8a) Place a clip over each of the anti-abrasion film pads on the edge of the hood as shown in *Illustration #3– Step #8a*.
- b) Insert a pin through the protector into each of the clips. See *Illustration #3 – Step #8b*.
- c) Place a nylon washer onto a #6 x 5/8" screw, then insert the screw through an 'L'- bracket and into the clip. See *Illustration #3 – Step #8c & 8d*.
- d) Make sure all the components are well seated together; the protector is centered on the hood, and then tighten the screws into the clips.
9. On some vehicles it may be necessary to adjust the hood bumpers and/or latch for proper clearance.

Note: Do not pull on the protector when opening or closing the hood.

Care Instruction

Clean the protector with a mild soap and water solution or plastic cleaner only. Do not use chemicals or solvents. Periodically check to make sure that the hardware is in place and that the protector is secure. **Avoid using automatic car washes.** Do not pull on the protector when opening or closing the hood.

Illustration #1: Bumpon Placement

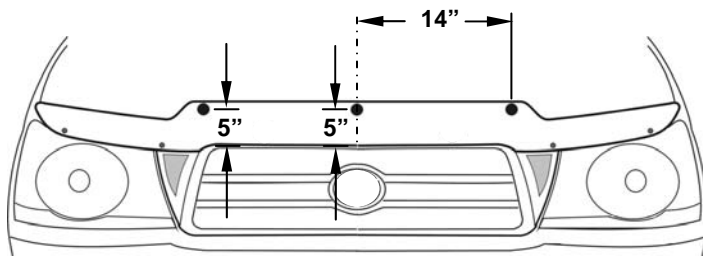

Illustration #2: Clip Location

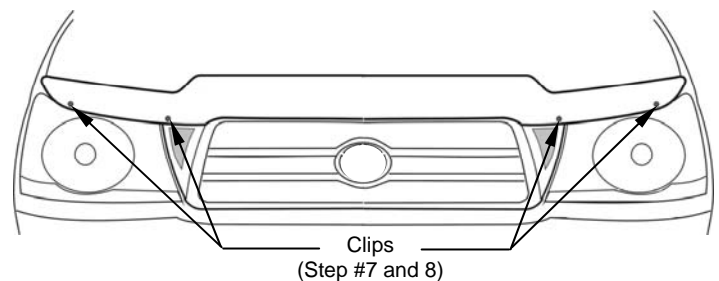
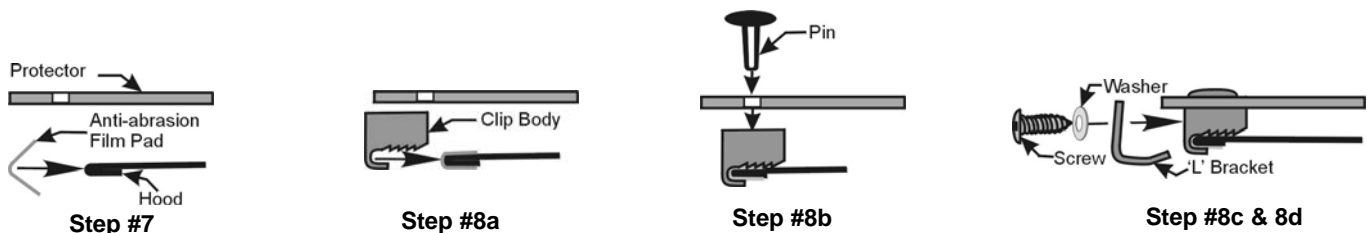

Illustration #3: Clip Configuration- Patent No. 6,892,427



Thank you for purchasing a **FORM FIT** hood protector. Retain this sheet for care instructions and kit information.

Made in Canada

Rev2.070627