

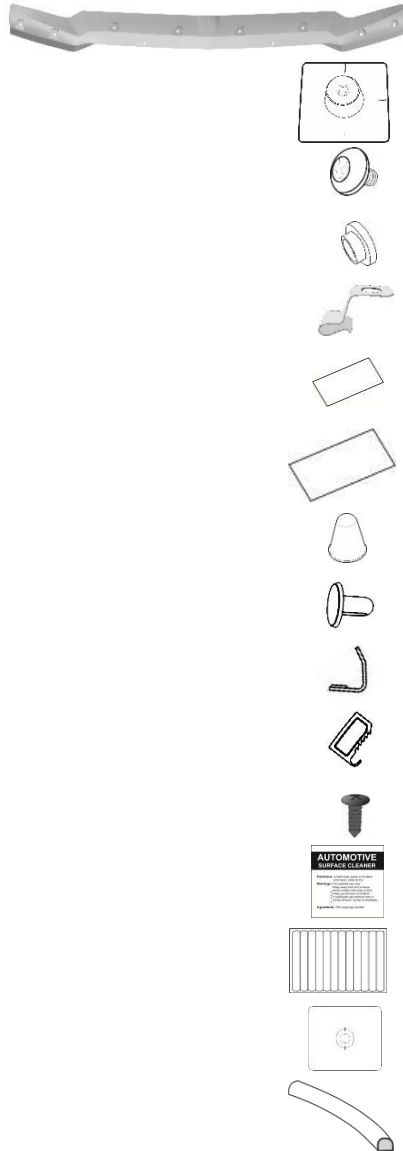

PARTS LIST

- Hood protector
- Adhesive pedestals (8)
- Torx head screws (8)
- Nylon shoulder washers (8)
- Metal mounting brackets (2)
- Abrasion pads (small) (2)
- Abrasion pads (large) (2)
- Bumpons (6)
- Pins (2)
- "L" brackets (2)
- Clip bodies (2)
- Screws (2)
- Surface cleaner (2)
- Re-usable tape strips (1)
- Pedestal locating template
- "D" Gasket



INSTALLATION

Ensure the vehicle is clean and completely dry before installation. This product uses a 3M adhesive that requires installation and curing temperatures of 15° to 43°C (60° to 110°F) for 1 hr to develop maximum adhesion to the hood surface. Failure to install this product at the proper temperature or allow adequate curing time before use is not covered under warranty.



CARE

Hand clean the protector using a mild soap and water solution or plastic cleaner only. Avoid automatic car-wash equipment where a brush and/or soft cloth may come in contact with the hood protector. Touch-less style automatic car-wash equipment is less likely to harm the hood protector.

SERVICE

Periodically check to confirm the protector is securely attached to the hood.

WARNINGS

Do not pull/push on the protector when opening/ closing the hood.

NOTE

On some vehicles it may be necessary to adjust the hood bumpers and/or latch for proper clearance.

NOTES

- In place of the T45 Torx bit, a 7/32" size Allen key will work.
- Do not use a power drill to turn in either the Torx head screws or the Phillips head screws.
- Use caution to not over-torque any of the screws.

TOOLS AND SUPPLIES REQUIRED

- T45 Torx bit or 7/32" Allen key
- #2 Phillips head screwdriver
- Measuring tape
- Masking Tape
- Clean cloth or soft paper towel
- Felt pen or grease pencil
- Hair dryer or heat gun

AUTOMOTIVE SURFACE CLEANER

Directions: Use this spray on surfaces that are clean, dry to dry.

Warnings: For outdoor use only.
 • Keep away from fire or flame.
 • Avoid contact with eyes or face.
 • Keep out of reach of children.
 • Do not use on painted surfaces.
 • Do not use on plastic surfaces.

Ingredients: 70% Isopropyl alcohol

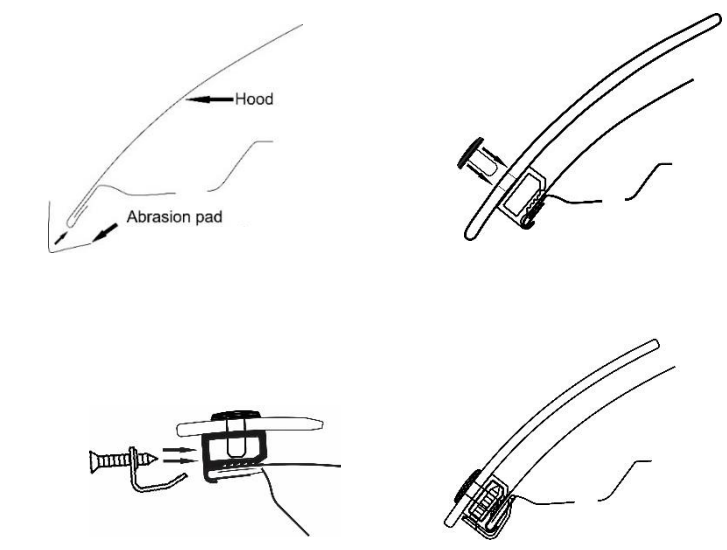
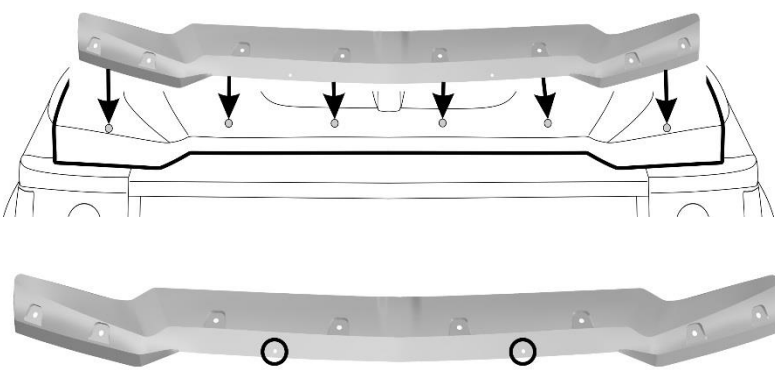
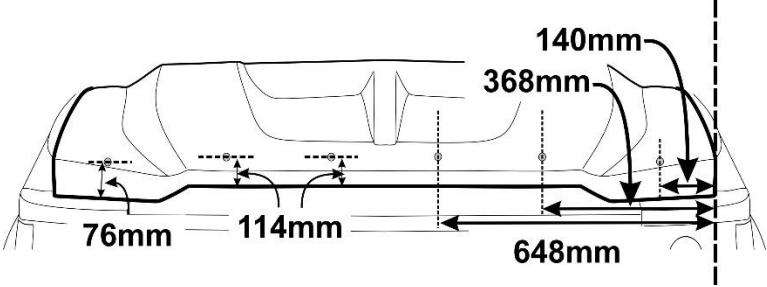
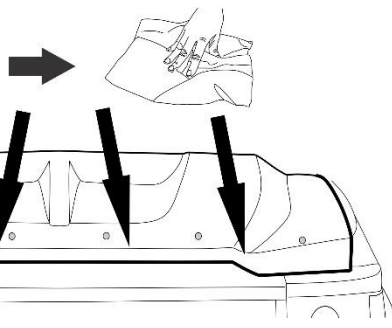

1. Use one of the surface wipes provided and wipe down the area (approximately 15cm (6 in.) from the hood edge) where the hood protector will be installed. Wipe dry with a soft cloth or paper towel. This will remove any wax or grease and will ensure a cleaner surface for the adhesive to bond to.
2. Place bumpons in locations shown in the illustration. Note that bumpons must be placed on the hood, not the hood protector. If they are placed on the hood protector, they will wear through the paint on your hood!

Metric conversion:

648mm = 25 1/2"	
368mm = 14 1/2"	114mm = 4 1/2"
140mm = 5 1/2"	76mm = 3"

3. Place the hood protector on the bumpons and center the protector on the hood.
4. Locate the two small holes on the front edge of the protector and wrap a large abrasion pad around the hood edge at these locations. On some applications it may be easier to stick the abrasion pad to the underside of the hood at the appropriate locations and then pick up the hood protector to wrap the abrasion pad around to the top surface of the hood.
5. With the hood protector in place, assemble the four pieces of the clip body (see illustrations) and loosely attach it to the edge of the hood. Ensure the hood is centered and tighten the screws into the clips. Note, the illustrations are generic. The actual shape at the leading edge of the protector may be different.

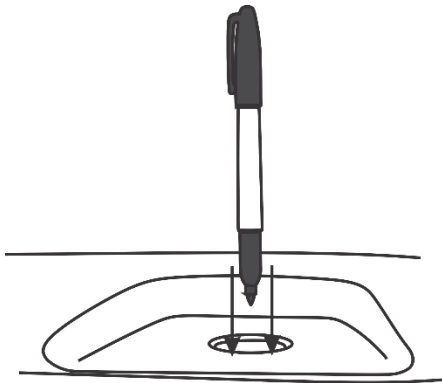
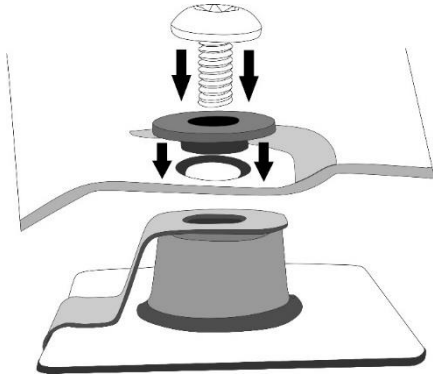
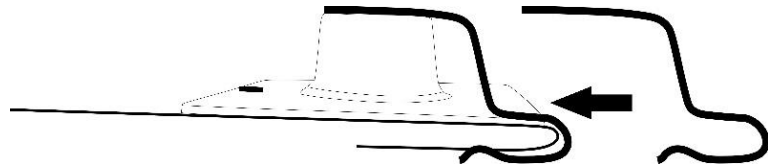

6. With the hood protector in position, locate the two pockets indicated in the illustration. Directly in front of these, at the hooded edge, place a small abrasion pad on the underside of the hood. The abrasion pad is oriented with the long edge aligned with the edge of the hood and centered under the pocket.

7. Lift the hood protector enough to place a mounting pedestal at the edge of the hood where the abrasion pad is and slide a bracket over each, as illustrated.

8. Assemble a Torx head screw and shoulder washer as illustrated and thread a screw through the hood protector and into both of the mounting pedestals which were temporarily attached in step 7. Note the pedestals are not permanently fastened so the screw will only turn in part way.

9. Center the hood protector on the hood by moving the mounting pedestals/brackets as required. Take care to ensure the brackets and mounting pedestals stay square to the hood edge.

10. Once hood protector is centered, take a felt marker (a fine point Sharpie works best) and insert it into the hole in each of the remaining "pockets" of the hood protector. Keeping the marker perpendicular to the hood surface, mark the hood surface with a dot. *****NOTE- IF YOUR HOOD HAS PAINT PROTECTION FILM, A PERMANENT MARKER MAY STAIN THE FILM. USE A DRY-ERASE MARKER OR A GREASE PENCIL.*****



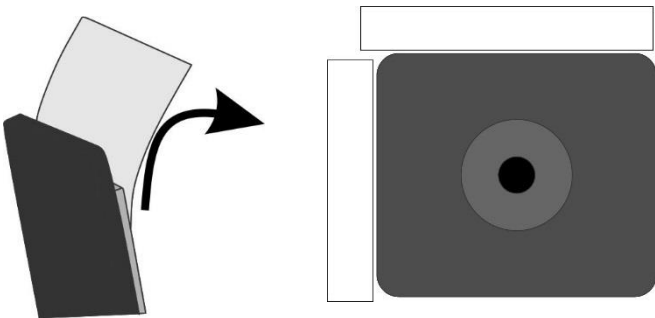
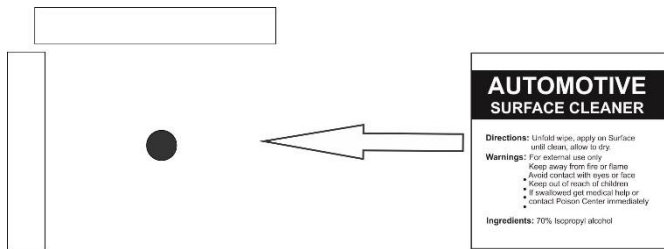
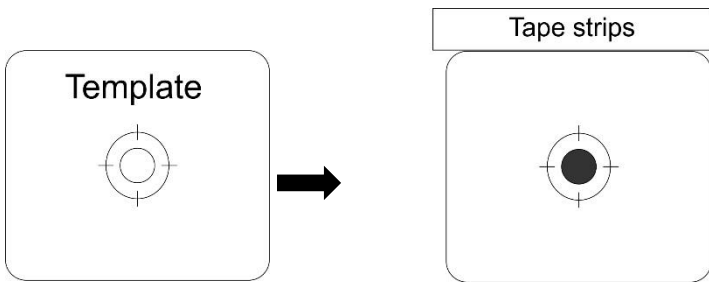

11. Remove the Torx head screws from the mounting pedestals and loosen the screws from the “L” brackets enough to allow removal of the hood protector from the hood. Remove the hood protector. *****Do not remove the temporarily installed pedestals.**

12. Locate the pedestal positioning template and place the template over a dot on the hood. Ensure the template is square to the hood edge. Using two of the repositionable tape strips, outline the template on two adjacent sides. Repeat for all dots. Depending on the application, it may be necessary to cut the tape strips in half to ensure there are enough to outline all locations. *****Outline the temporarily installed pedestals as well, then remove them.**

13. Using the automotive surface cleaner provided, clean an area approximately the size of the mounting pedestal at each location. Wipe dry with a clean cloth or paper towel. Take care to not contaminate the hood surface after it has been cleaned. Any surface contaminants will reduce the effectiveness of the adhesive.

14. Peel the red protective backing off one of the adhesive pedestals. Carefully place it on the hood surface exactly where the tape outline is. **Use care with this step as once the pedestal has been placed on the hood, it will be very difficult to remove.** Repeat for all locations.

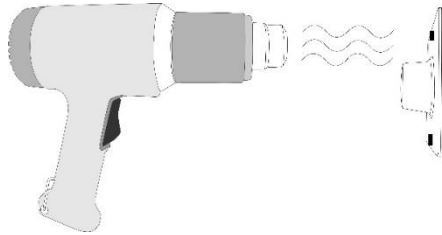
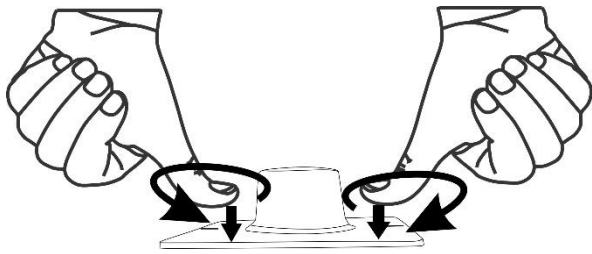

**AUTOMOTIVE
SURFACE CLEANER**

Directions: Untinted areas; apply on Surface
with ocean, allow to dry.

Warnings: For external use only.
• Keep away from face or hair.
• Avoid contact with eyes or face.
• Keep out of reach of children.
• If swallowed get medical help or
• Contact nearest Center immediately.

Ingredients: 70% Isopropyl alcohol

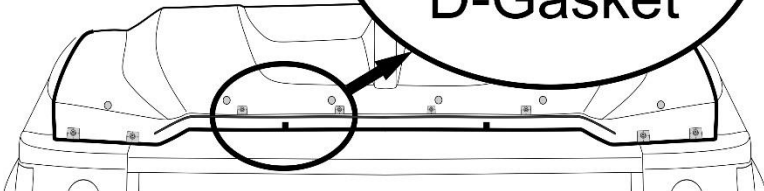
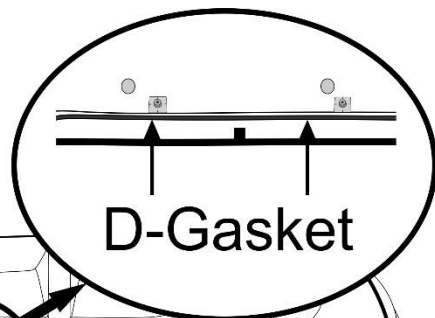
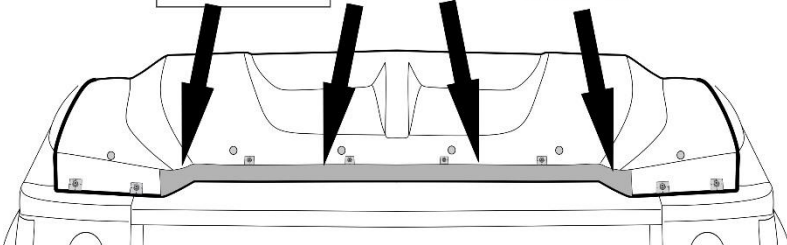
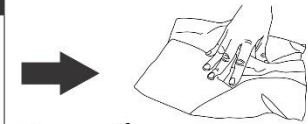

15. To ensure the adhesive is thoroughly bonded to the hood, "wet out" pedestal base by applying pressure with your thumb around the base of the pedestal.

****NOTE** While the bond between pedestal and hood is very good, using a heat gun to warm the pedestal bases to 40°C (105°F) and wetting them out a second time will ensure the best bond possible.**



Use caution not to overheat the pedestal or damage the paint!!

16. Clean the area indicated with a surface cleaner cloth. Wipe dry with a clean cloth or paper towel.

17. 48 inches of "D" gasket has been provided. This is to be placed as illustrated. Use caution when placing down. The adhesive is quite strong and once it is attached, it is quite difficult to re-position. It is recommended to peel back 1 to 2 inches of protective backing and stick in position. Peel and stick a short length at a time, ensuring the gasket is positioned correctly. To ensure the adhesive is thoroughly bonded to the hood, "wet out" "D" gasket by applying pressure with your thumb along the top of the gasket.

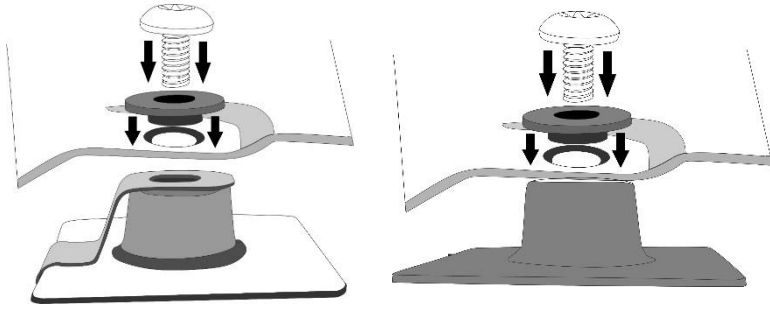

18. Place a Torx head screw through a shoulder washer and into a hole in hood protector. Ensure the shoulder portion of the washer slides into the hole in the hood protector. Loosely thread the screw into the mounting pedestal. See illustration for orientation of the shoulder washer. Repeat for all locations. **Don't forget to install the metal brackets at the two locations from step 6.**

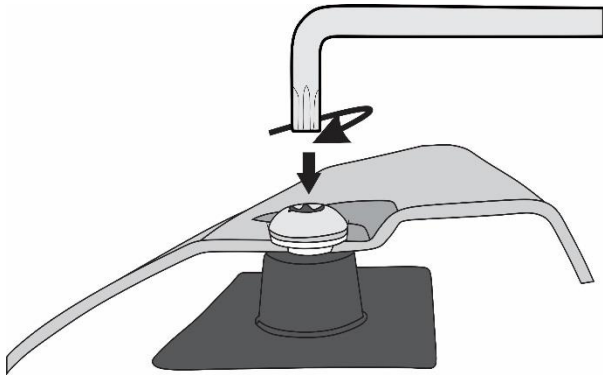

19. Once again, ensure the hood protector is centered on the hood and using a T45 Torx key, tighten all screws into the pedestals. Start in the center position and work outwards. Ensure the shoulder washers are seated properly. Do not overtighten.

20. Tighten the "L" brackets into the mounting clips.

**Thank you for purchasing
a Tough FormFit Guard
hood protector!**