



Installation Instructions  
**717912**  
2020 JEEP GLADIATOR  
3.6L ENGINE



**OVERVIEW:**

1. Take a moment to read and understand these instructions before installing your Flowmaster performance system.

**NOTE:** Please inventory all parts now before continuing and if necessary, report any missing items to our tech line. This will avoid potentially stranding your vehicle until any missing replacement parts arrive.

ITM #	PART #	DESCRIPTION	QTY.
1	71229-553	Muffler Assembly	1
2	26788M	Mid Pipe Assembly	1
3	26789M	Tailpipe Assembly	1
4	ST509B	Black Tip	1
N/A	PK1019	Hardware Pack includes:	1
5	MC300BS	3" Stainless Band Clamp	2

**REMOVE STOCK EXHAUST SYSTEM:**

2. Raise vehicle up on a hoist or rack to working height. If you don't have access to a hoist or rack, support vehicle with jack stands.

**WARNING:**  
Avoid serious burns! Allow your vehicle time to cool completely before touching any factory engine components.

**To ease preparation and installation of your new kit:**

- Apply penetrating lubricant to mounts, bolts and clamps before you remove them.
- Use stands as necessary to support parts as you detach them from your vehicle and again as you install new parts.

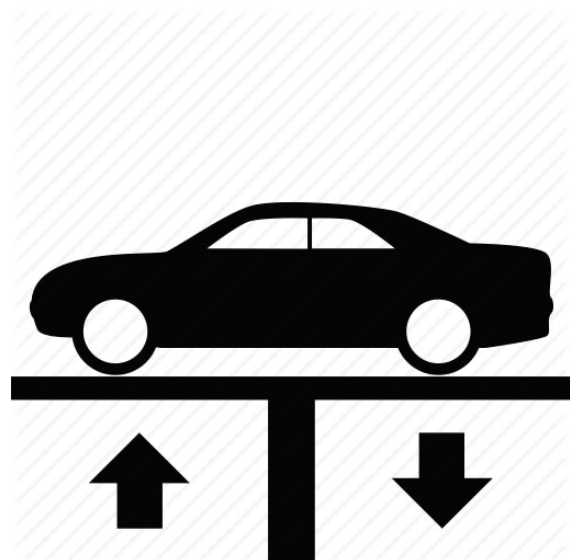

3. Cut tailpipe at muffler exit. Remove rear hanger mount, Disassemble hanger wires from isolators and remove tailpipe section from vehicle. Retain hanger mount for later use.

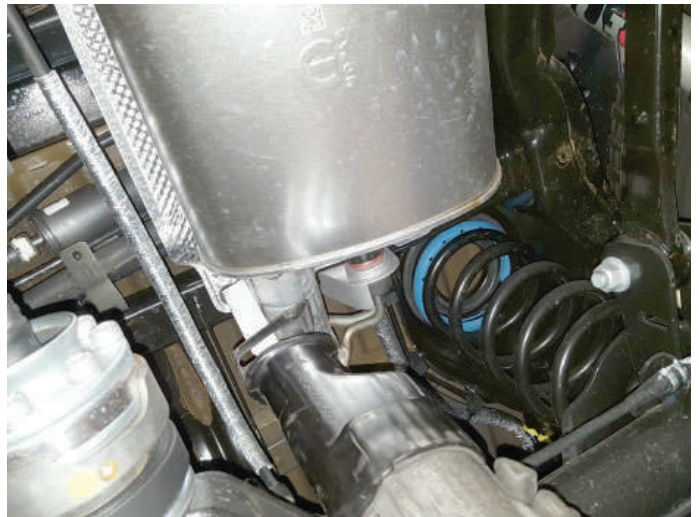

4. Support muffler and disassemble wire hangers from isolators. Loosen ball clamp, disconnect inlet pipe at cat. converter and remove exhaust system.



## INSTALL FLOWMASTER EXHAUST SYSTEM

5. Release tab to remove ball clamp from inlet pipe and retain it for later use. Remove nuts from stock and Flowmaster clamps, apply anti-seize compound to bolts and re-install nuts. Transfer rear hanger mount to FlowFX tailpipe assembly.

**NOTE:** The image in this step is intended for illustrative purposes only and may or may not accurately reflect components included in your kit.

6. Every slip fit connection in this kit must seat 3" deep except for muffler connections which must seat 2" deep. Find all slip fit components in your kit and mark them accordingly so your Flowmaster exhaust system fits properly onto your vehicle.



7. Place factory ball clamp (removed step 5) onto **muffler assembly (1)** then connect it to cat. converter. Tighten clamp enough to allow for adjustment.

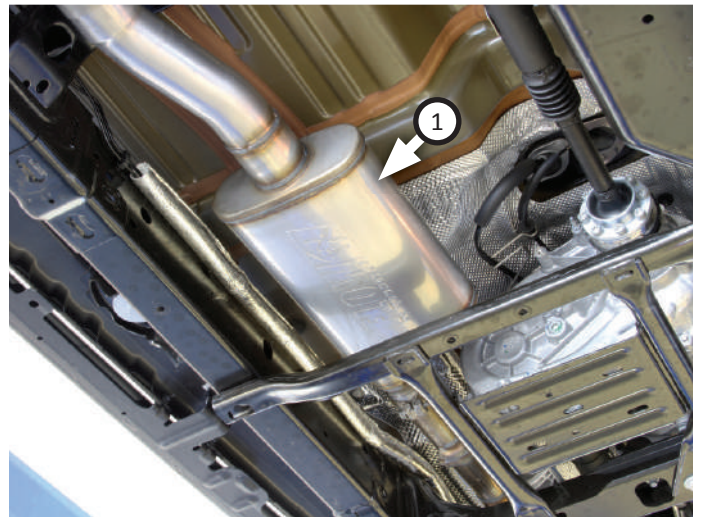

8. Place **clamp (5)** onto **mid pipe assembly (2)** then connect it to muffler. Insert wire hanger into isolators and tighten clamp just enough to allow for later adjustment.

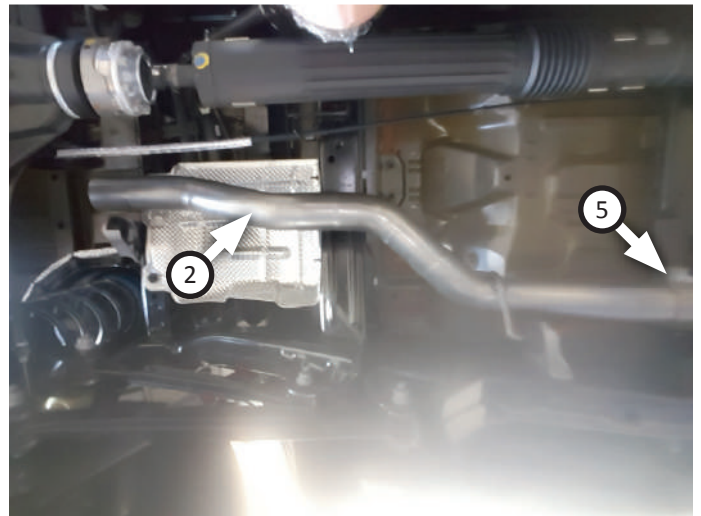

9. Place **clamp (5)** onto **tailpipe assembly (3)** and route it over axle then connect it to mid pipe. Re-bolt rear hanger mount back onto vehicle and tighten clamp just enough to allow for adjustment.



10. Place **tip (4)** onto tailpipe and tighten inlet. Rotate tailpipe and tip to desired distance from body or bumper, so angle cut on tip is properly positioned.

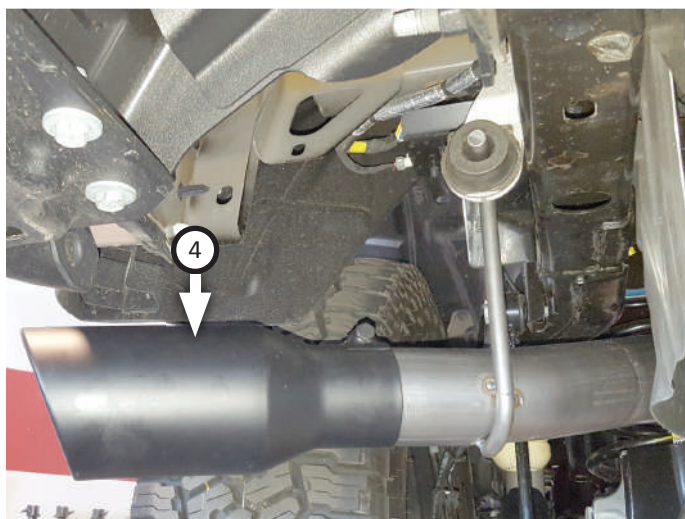

11. Adjust exhaust components for fit; maintaining ½" clearance and compensating for suspension, travel and vibration then tighten all clamps.
12. Recommended: Secure slip-fit connections with a 1-inch tack weld then spray high-temp paint over each weld to prevent rust and premature corrosion.



Congratulations, the installation of your FLOWMASTER performance exhaust system is now complete!





Installation Diagram  
**717912**  
2020 JEEP GLADIATOR  
3.6L ENGINE

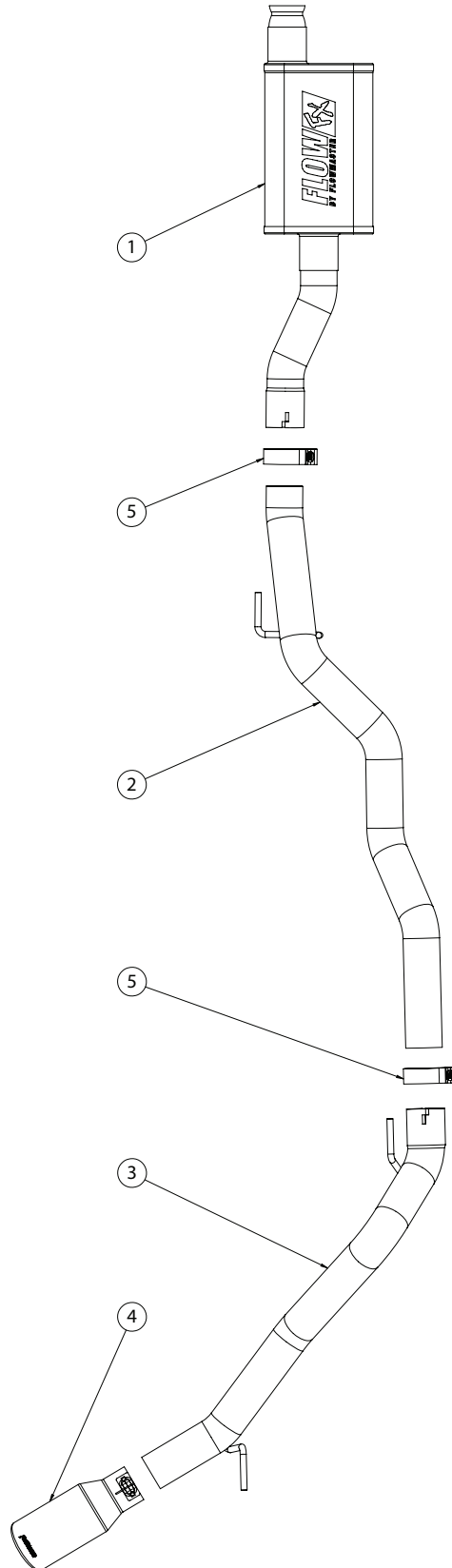

[View other performance exhaust systems made by Flowmaster on our website.](#)