



Installation Instructions for:  
**SYSTEM #717834**  
2015-2018 GMC CANYON & CHEVY COLORADO  
FITS: ALL MODELS WITH 3.6L ENGINE



**Removal:**

1) Raise the vehicle up on a hoist or rack to working height. If you do not have access to a hoist or rack raise the vehicle and support securely with jack stands. Spray a penetrating lubricant onto the bolt or nuts behind the catalytic converter as well as all of the rubber isolators supporting the system.



2) Support the muffler with a stand. Using a hacksaw or sawsall, cut the stock tailpipe off just behind the muffler. Separate the wire hangers on the tailpipe from the rubber mounts on the vehicle and remove the tailpipe from the vehicle. This step is not mandatory but makes removal easier.



3) Using a 15mm wrench, loosen the two nuts on the flanged connection behind the catalytic converter. Retain the nuts, they will be re-used. Separate the hanger on the pipe from the rubber mount on the vehicle and lower the inlet pipe and muffler from the vehicle.

**Installation:**

1) This is a list of cab designs, bed lengths and wheel bases that outlines the requirements for the front inlet pipe. Please follow the instructions for your particular wheelbase listed below. Double check all measurements before cutting your inlet pipe:

**128.3" WB – Extended Cab / 6' Bed** - Trim 12" from the back of inlet pipe #26713M.

**128.3" WB – Crew Cab / 5.1' Bed** - Trim 12" from the back of inlet pipe #26713M.

**140.5" WB – Crew Cab / 6' Bed** - Use inlet pipe #26713M with no modifications.



2) Connect the flange on inlet pipe assembly **#26713M** to the factory flange behind the flex pipe, and support the rear of the pipe with a stand. Reinstall the two nuts and tighten enough to hold, but still allow for adjustment.



3) Place clamp hanger assembly **502HA** over the back of the inlet pipe and connect to the rubber mount on the vehicle.



4) Place the provided 3" clamp over the inlet of the muffler, then slide the inlet onto the back of the inlet pipe about 2". Use a stand to support the muffler. Tighten the clamp just enough to hold in position. Place a provided 2 1/2" clamp onto each muffler outlet.



5) Remove the 3 factory rubber exhaust isolators from the mounts on the vehicle, two just forward of the rear axle and one at the rear of the vehicle.



6) Place the rubber isolators removed in the previous step onto the 3 wire hangers of tailpipe assembly **86486M**.



7) Place tailpipe assembly **#86486M** into position over the rear axle and slide into the muffler outlets. Support the rear of the assembly with a stand and connect the rubber hangers on the assembly to the wire mounts on the vehicle. Be sure that the pipes are slid into the muffler about 2.00" and tighten the clamps enough to hold in position.



8) Place the **#ST439** stainless tips onto the ends of the tailpipe assembly and adjust to the desired position. Tighten the pinch clamps on the tips enough to hold in position.

9) Adjust the position of all pipes and muffler to provide a satisfactory fit. A minimum 3/4" clearance around all parts of the system must be maintained; while also keeping suspension travel and vibration in mind.

10) Tighten all clamped connections down securely. Place the supplied 7/16" hanger keepers onto the end of the inlet pipe and tailpipe hangers and slide up to the rubber mounts to firmly hold the system in place.

11) For a more secure installation, we highly recommend welding all slip-fit connections.

PACKING LIST		
Qty.	Description	Part #
1	Inlet Pipe Assembly	26713M
1	Muffler	72198-Z
1	Tailpipe Assembly	86486M
2	Stainless Tip	ST439
<b>1</b>	<b>PARTS KIT (includes the following)</b>	<b>PK956</b>
1	• Front Clamp Hanger	502HA
2	• 2 1/2" Band Clamp	MC250BS
1	• 3" Band Clamp	MC300BS
4	• 7/16" Hanger Keeper	HW502



Installation diagram for:  
**SYSTEM #717834**  
**2015-2018 GMC CANYON & CHEVY COLORADO**  
FITS: ALL MODELS WITH 3.6L ENGINE

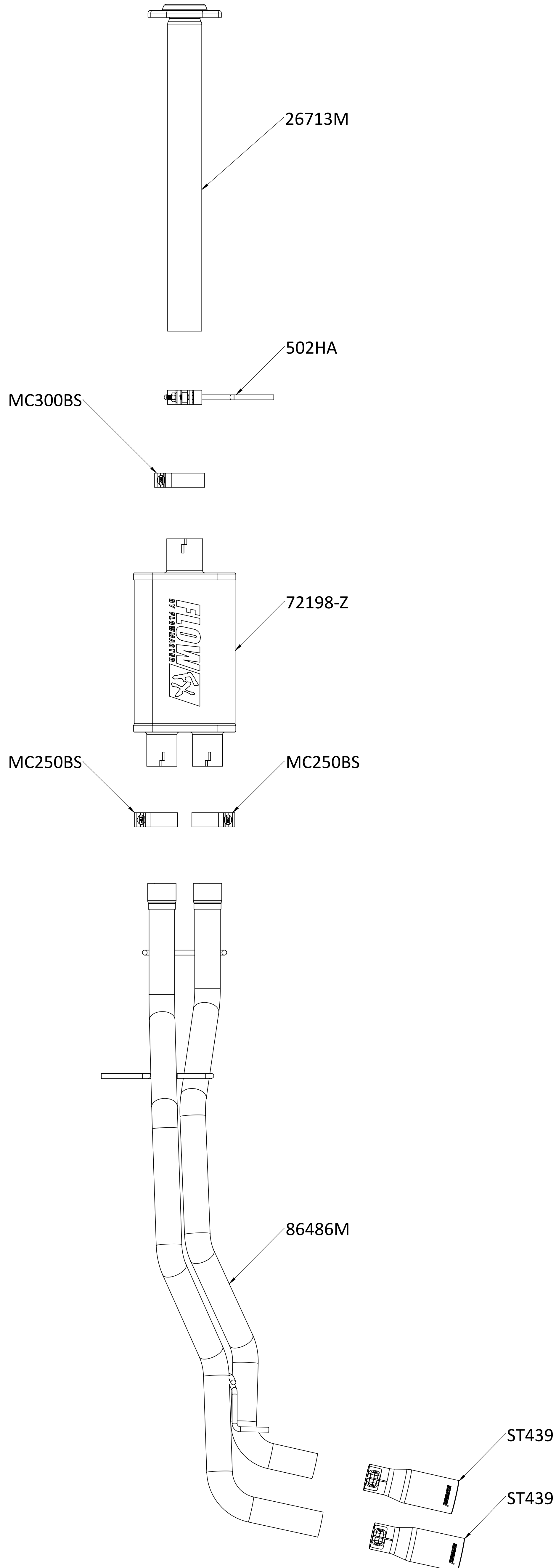

Discover other performance exhaust systems on our website.