

RSR WHEEL PROGRAM

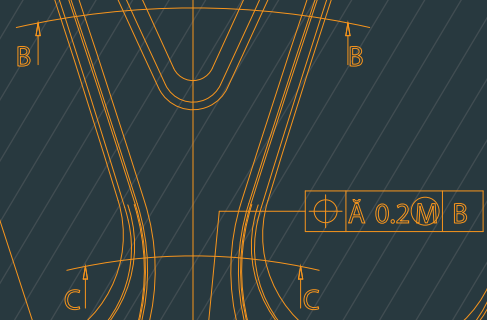

# HOLESHOT

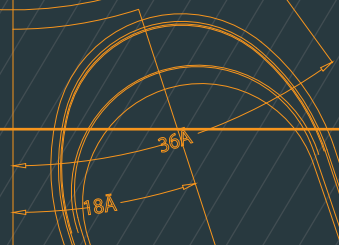

# RSR

RSR WHEEL PROGRAM

**FLOW FORMED CONSTRUCTION**

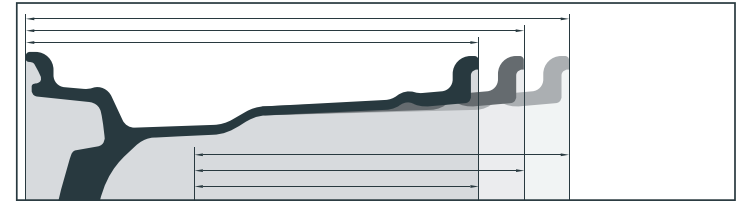

Fifteen52's RSR Wheel Program represents the brand's entrance into flow formed technology, carving out a collection of high performance wheels. The flow form manufacturing method utilizes rollers to apply high levels of pressure to form the inner barrel to specified widths. As the cast material is formed over the tooling, it begins to take on many of the properties of a forged wheel, aligning the grain structure and increasing tensile strength. The increase in strength allows for a thinner and lighter barrel, taking advantage of the benefits of a forged wheel without the high cost often associated with a fully-forged product. Slotting in between Fifteen52's Forged Wheel Program and Cast Monoblock offerings, the RSR Wheel Program of flow formed wheels is the perfect balance of style and performance. Launching in a 19-inch diameter, the Holeshot leads the RSR pack with an aggressive presence and technological improvements that can be felt on the twisting canyon roads.







# HOLESHOT RSR



Magnesium Grey

The Holeshot RSR came to fruition through a design exercise in perfecting the classic mesh wheel design. Improving on our Formula GT wheel of seasons passed, the Holeshot RSR has a stepped-lip profile and subtle face protrusion that embody the Fifteen52 style. Stepped, scalloped spokes give depth to the design while strategically cutting weight where it matters most. With the face offset from the slant of the lip, the visual impact of the lip depth could be retained while still ensuring proper clearance for a wide range of performance brakes.









## TARGETED FITMENTS

With two face profile variants and the ability to specify barrel depth through the flow forming process, the RSR Wheel Program is able to specifically target a wide range of vehicles and provide ideal fitments for each application. The wheel width, offset, centerbore, and bolt pattern can be specific to each SKU. To start, the Holeshoot RSR will be available in MK3 Ford Focus, MK7 Volkswagen Golf/Jetta, and FK8 Honda Civic Type R fitments with a number of additional applications slated for future production.

# HOLESHOT RSR



Radiant Silver

Alongside the new wheel, two new finishes join the Fifteen52 collection. Magnesium Grey is a unique finish that blends hues of Bronze and Gunmetal in a satin finish to give a stylish, dark demeanor to the Holeshot. On the other end of the spectrum, Radiant Silver glows across the sculpted contours of the new RSR wheel with a bright, satin silver finish. Whether bright or dark accents are your style, the two new finishes are sure to instantly transform your ride and truly stand out from the crowd.









## ACCESSORIES

Each wheel comes equipped with black anodized Motorsport Rings in the centerbore. Machined from aluminum and emblazoned with Fifteen52 spec details, the Motorsport Rings give the wheels a utilitarian appeal while promising to withstand the heat of abuse on your favorite mountain roads. Owners looking for an accent to match their car's brake calipers or paint can opt for Red and Blue anodized rings with corner designation graphics that will come in handy when it comes to motorsport applications and tire swaps.



















# WHEEL SPECS

INITIAL TARGETED FITMENT SPECIFICATIONS



PART NO.	COLOR	DIA.	WIDT	PCD	ET	CB	
RSHRS-99058+45	RADIANT SILVER	19	9	5X108	45	63.4	
RSHMG-99058+45	MAGNESIUM GREY	19	9	5X108	45	63.4	
RSHRS-98551+45	RADIANT SILVER	19	8.5	5X112	45	57.1	
RSHMG-98551+45	MAGNESIUM GREY	19	8.5	5X112	45	57.1	
RSHRS-99552+45	RADIANT SILVER	19	9.5	5X120	45	64.1	
RSHRS-99552+45	MAGNESIUM GREY	19	9.5	5X120	45	64.1	



FIFTEEN52 - FW2019\_LAUNCH\_MATERIALS / RSR WHEEL PROGRAM. HOLESHOT - 19" TARGETED FITMENTS



Feel the difference with Fifteen52.

[Learn more about wheels and tires we have.](#)