

## Leak Repair

# PermaDryPlus® Gaskets

Fel-Pro® PermaDryPlus gaskets are the problem-solving gaskets that feature the latest advanced technologies designed specifically for the aftermarket repair environment. These gaskets are the right choice for any application in which the OEM design and/or traditional replacement gaskets have been known to fail, or are difficult to install. When technicians install PermaDryPlus they can be confident of an easy, precise fit and superior sealing performance, even on problematic applications.

PermaDryPlus gaskets utilize various types of innovative technologies, depending on the application and type of seal required. Key benefits that apply to all are:

- One-piece, molded-rubber construction provides superior blow-out resistance
- Time-saving rigid carrier system provides instant fit without adhesives
- Lasts up to five times longer than cork-rubber
- Precision sealing beads reinforce critical areas
- Superior heat resistance assures longer life
- Torque limiters prevent overtightening
- Added features such as Hole-Locks®, Snap-Ups®, and locating tabs help make installation easier

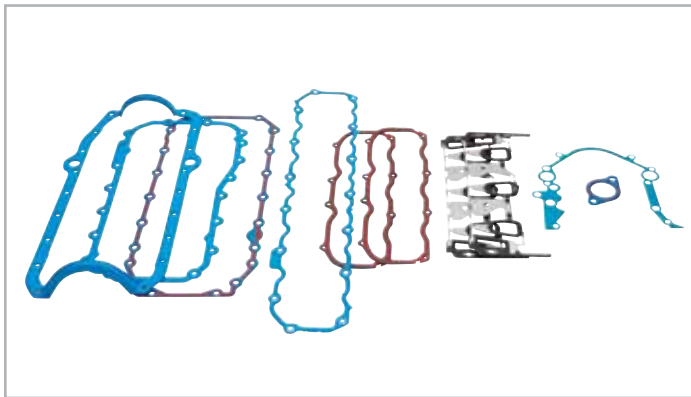

## PermaDryPlus Valve Cover Gaskets

These gaskets utilize precision edge-molded silicone rubber sealing beads on a rigid carrier to resist high heat and high vacuum, and to compensate for surface irregularities. Built-in torque limiters prevent overcompression and gasket-splitting, while locating tabs and bolt Hole-Locks reduce installation time and assure proper alignment.

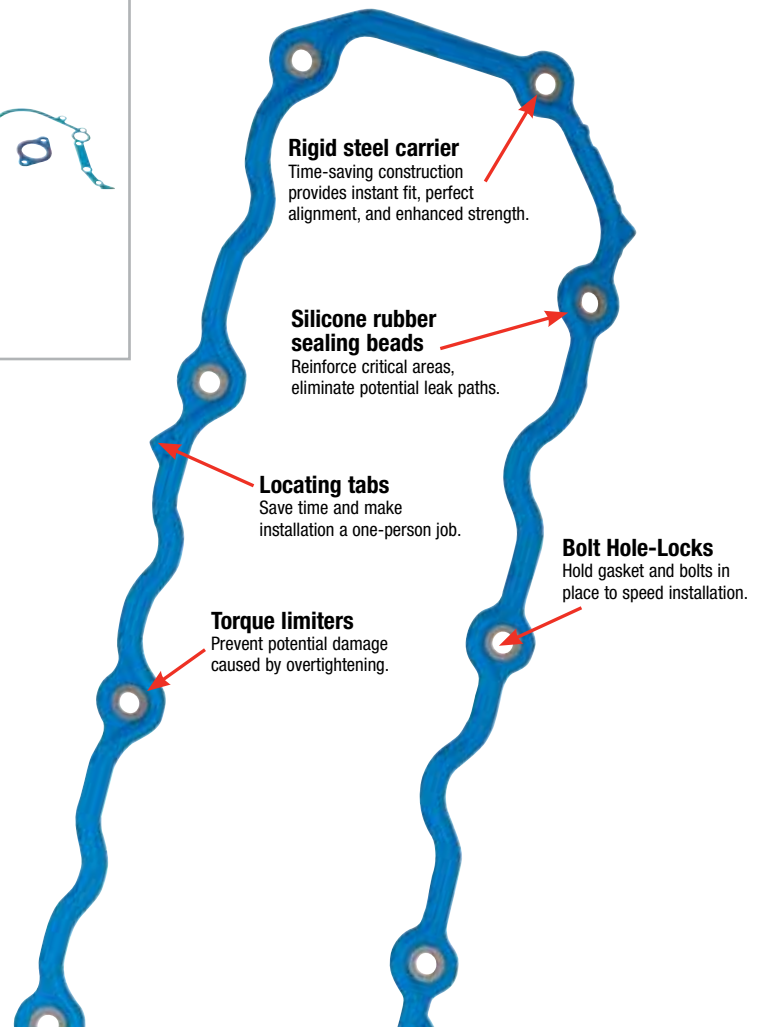

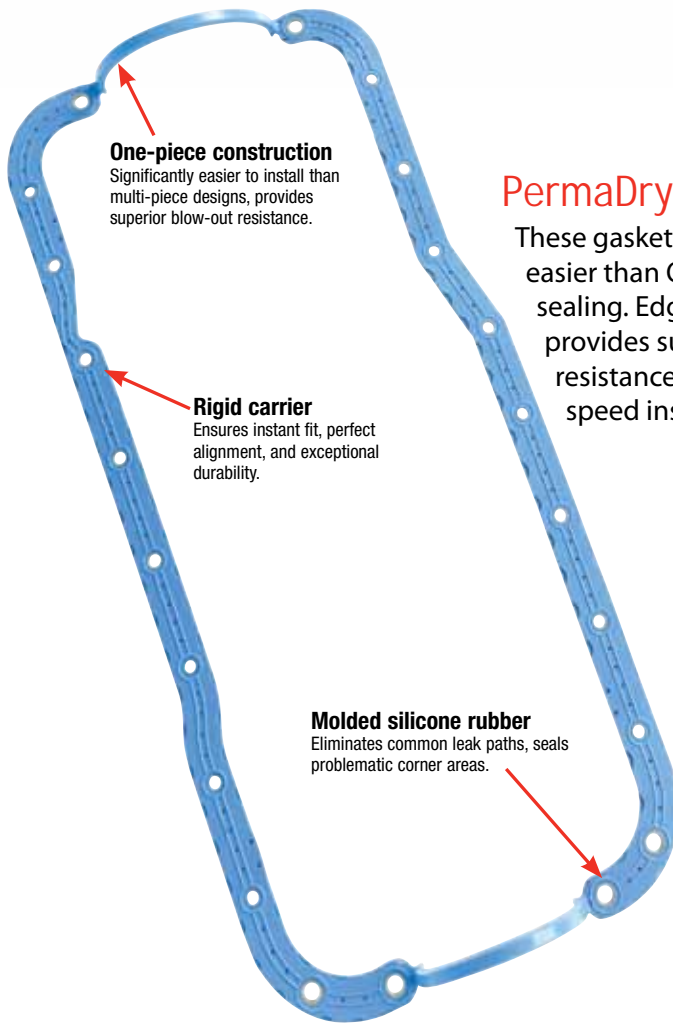

**One-piece construction**  
 Significantly easier to install than multi-piece designs, provides superior blow-out resistance.

**Rigid carrier**  
 Ensures instant fit, perfect alignment, and exceptional durability.

**Molded silicone rubber**  
 Eliminates common leak paths, seals problematic corner areas.

## PermaDryPlus® Oil Pan Gaskets

These gaskets' one-piece construction makes installation easier than OEM style multi-piece assemblies or RTV sealing. Edge-molded silicone rubber on a rigid carrier provides superior fit, and high heat and vacuum resistance, while the included Oil Pan SnapUps® speed installation.



**Oil Pan SnapUps**  
 Hold gasket and pan in place for quick bolt installation.

## PermaDryPlus Water Outlet Gaskets

These gaskets feature rigid composite carrier construction and silicone sealing beads. The carrier prevents overtorquing, while the molded rubber assures a secure seal. These gaskets are the perfect solution for warped or corroded thermostat housing flanges.

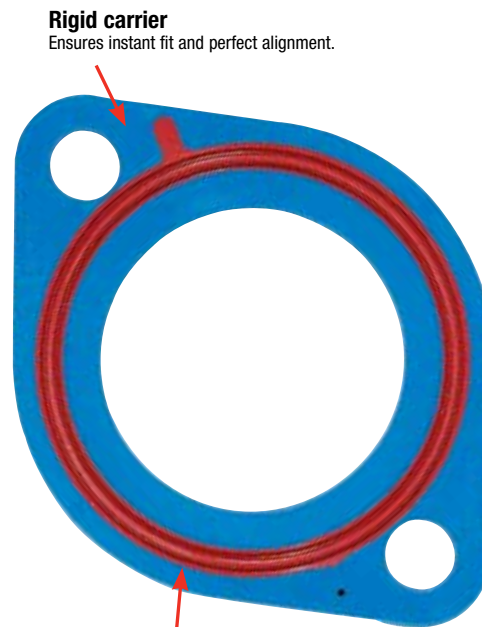

**Rigid carrier**  
 Ensures instant fit and perfect alignment.

**Silicone sealing beads**  
 Eliminate all leak paths, highly resistant to extreme temperatures.

## PermaDryPlus® Intake Manifold Gaskets

These long-lasting gaskets feature an aluminized steel carrier with fluoroelastomer rubber coating that is impervious to all types of coolants and oils. Edge-molded seals protect each port. Primary and secondary sealing beads provide additional protection while compensating for corrosion-roughened surfaces. And like all Fel-Pro® gaskets, these are engineered for easy installation as well.

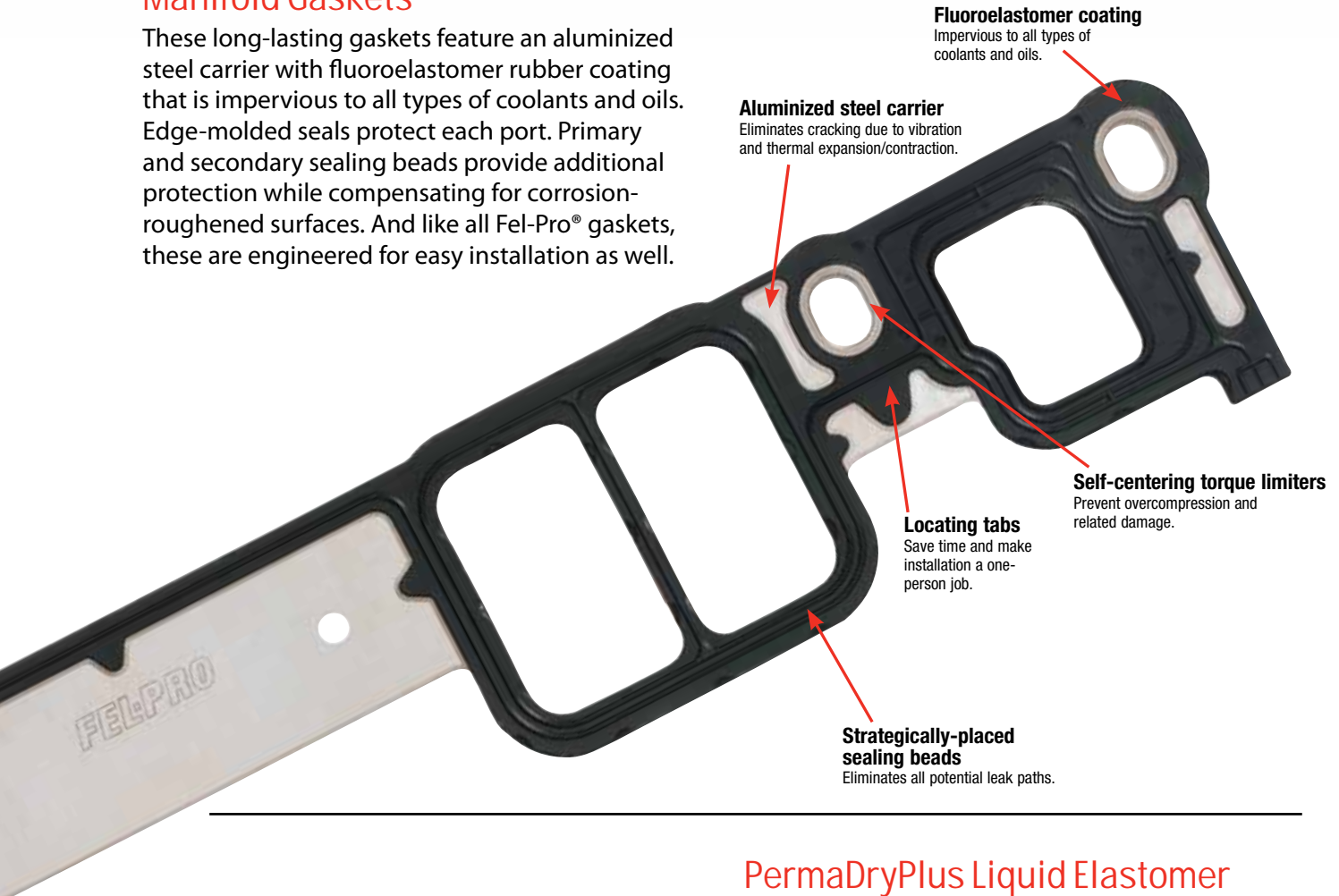

**Fluoroelastomer coating**  
Impervious to all types of coolants and oils.

**Aluminized steel carrier**  
Eliminates cracking due to vibration and thermal expansion/contraction.

**Locating tabs**  
Save time and make installation a one-person job.

**Self-centering torque limiters**  
Prevent overcompression and related damage.

**Strategically-placed sealing beads**  
Eliminates all potential leak paths.

## PermaDryPlus Liquid Elastomer Molded (LEM) Timing Cover Gaskets

Exclusive Fel-Pro PermaDryPlus Liquid Elastomer Molded (LEM) Timing Cover Gaskets offer a versatile, high performance sealing solution. The LEM process involves coating a metallic gasket core with a thin layer of silicone elastomer. The gasket is then bolstered in critical areas with silicone beading, allowing it to cope with the necessary clamping loads and provide superb sealing. It is easier to install (because of its rigid carrier design) than typical paper gaskets, with high durability and zero leakage.

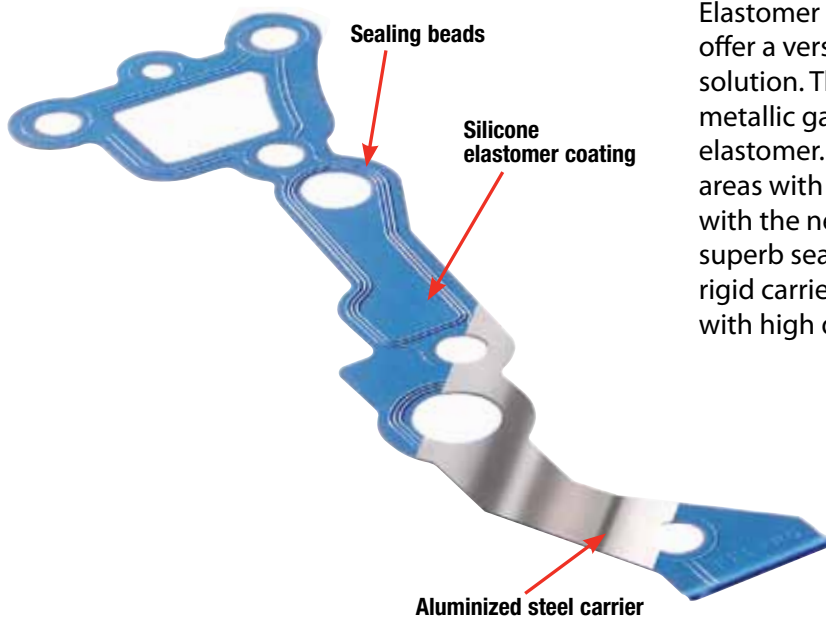

**Sealing beads**

**Silicone elastomer coating**

**Aluminized steel carrier**



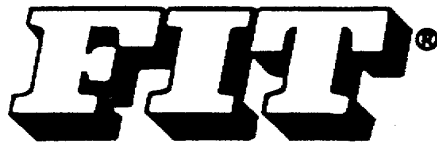

---

## FEL-PRO INSTALLATION TIPS

Fel-Pro products are the result of exhaustive research and strict quality control. However, no sealing product is better than the quality of its installation.

### INTAKE MANIFOLD GASKET

**CLEAN MATING SURFACES** of all foreign material including old gaskets, RTV, and oil. You may wish to use a degreaser.

**CHECK MANIFOLD CASTINGS** for flatness of gasket surface. Resurface or replace if severely distorted or corroded.

### ATTACH AND ALIGN END SEALS

---

**IMPORTANT:** These molded rubber silicone seals must be installed DRY without any chemical adhesive.

---

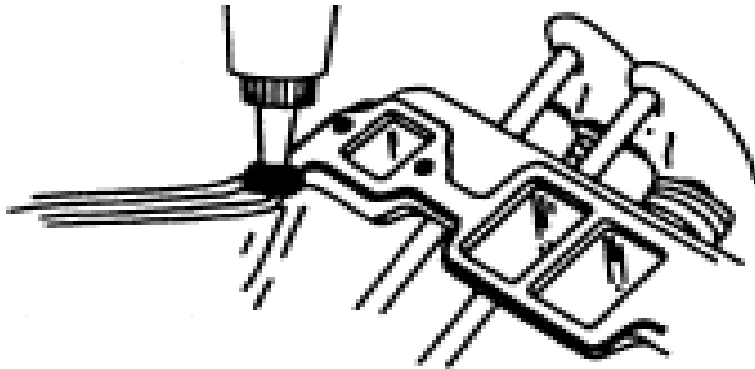

**PRIOR TO REINSTALLING INTAKE MANIFOLD** apply a small dab of silicone sealer to the 4 corner intersections between the end seals and gaskets.

**TEST RUN ENGINE.** Check all mating areas thoroughly to determine that all seals hold during operation.