



## ***Installation Instructions***

**FTS7006**

**2005-07 4wd Ford Super Duty Single Steering Stabilizer Kit**

### *PARTS LIST-*

<b>Qty</b>	<b>Part #</b>	<b>Description</b>
1	FT7006	Stabilizer
1	FT104	Tapered Sleeve
1	FT97150-6-106	3/8" Spacer
1	FT7006i	Instruction Sheet
1	50133501052	1/2"-13 x 3 1/2" Hex Head Bolt
1	50130004152	1/2 -13 C-Lock Washer
3	50000005152	1/2" SAE Flat Washer

### *TOOL LIST- (NOT INCLUDED)*

- Assorted Metric & SAE Sockets & Wrenches
- Torque Wrench

**READ ALL INSTRUCTIONS THOROUGHLY FROM START TO FINISH BEFORE BEGINNING INSTALLATION! IF THESE INSTRUCTIONS ARE NOT PROPERLY FOLLOWED, SEVERE FRAME, DRIVELINE AND / OR SUSPENSION DAMAGE MAY RESULT.**

**CHECK FOR FRAME AND SUSPENSION DAMAGE PRIOR TO INSTALLTION.**

**THIS KIT DOES NOT REQUIRE WELDING FOR INSTALLATION. DO NOT WELD ANY OF THESE COMPONENTS.**

## INSTALLATION-

1. Disconnect the negative terminal on the battery. Position the front tires of the vehicle straight ahead.
2. Remove the factory steering stabilizer from the truck and discard the stabilizer and the hardware.
3. Attach the shaft end of the stabilizer with the provided flat rubber bushings and cup washers to the original frame bracket and tighten until the rubber bushings swell.
4. Locate the supplied FT104 tapered sleeve, FT97150-6-106 spacer and ½" hardware. Extend the stabilizer enough to meet the mounting hole in the factory draglink. The tapered sleeve will need to be installed first from the top of the drag link with the smaller part of the taper going into the draglink first. Then attach the stabilizer with the bolt, spacer, and washers as shown in the diagram below. Torque the nut and bolt to 60 ft. lbs. SEE DIAGRAM BELOW

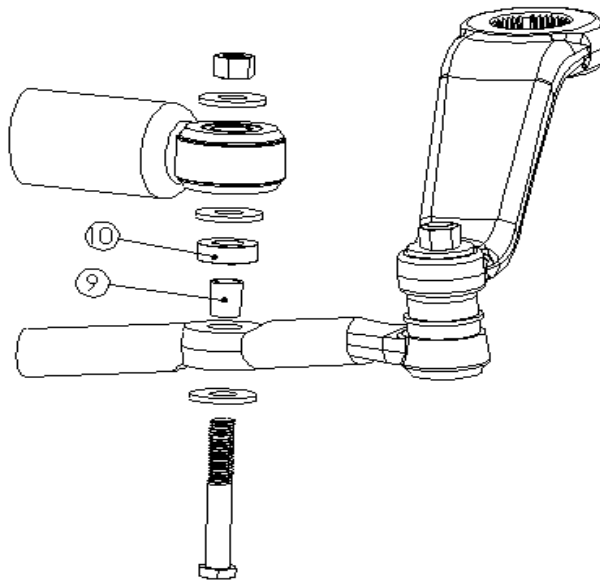

ITEM#	DESCRIPTION
9	FT97150-6-101
10	FT104

5. Recheck each nut and bolt for proper torque.
6. Check front-end alignment and set to factory specifications.