



# Installation Instructions

## Vengeance Front Sensor Bumper

Product Number: V3151, V3152  
Application: 2015+ GMC HD

### SAFETY

**Your safety and the safety of others is very important.**

- In order to help you make informed decisions about safety, we have provided installation instructions and other information.
- These instructions alert you to potential injury hazards.
- Please do a job safety analysis before each task to identify potential hazards for your situation and remove/protect against them.
- You must use your own good judgment.
- Read and understand all safety precautions and instructions before installing this product.

**THIS PRODUCT IS FOR OFFROAD USE ONLY. ALL LIABILITY FOR  
INSTALLATION AND USE RESTS WITH THE OWNER.  
CARELESS INSTALLATION AND OPERATION CAN RESULT IN SERIOUS  
INJURY OR EQUIPMENT DAMAGE.  
SENSORS FIELD OF VIEW WILL BE ALTERED WITH USE OF THE  
REPLACEMENT BUMPER.**

### Injury hazard

**Failure to observe these instructions could lead to severe injury or death.**

- Always remove jewelry and wear eye protection.
- Always use extreme caution when jacking up a vehicle for work. Set emergency brake and use tire blocks. Locate and use the vehicle manufacturers designated lifting points. Use jack stands.
- Always use appropriate and adequate care in lifting components into place.
- Always insure components will remain secure during installation and operation.
- Always wear safety glasses when installing this kit. A drilling operation will cause flying metal chips. Flying chips can cause serious eye injury.
- Always use extreme caution when drilling on a vehicle. Thoroughly inspect the area to be drilled (on both sides of material) prior to drilling, and relocate any objects that may be damaged.
- Always use extreme caution when cutting and trimming during fitting.
- Always tighten all nuts and bolts securely per installation instructions.
- Always route electrical cables carefully. Avoid moving parts, components that become hot and rough or sharp edges.
- Always insulate and protect all exposed wiring and electrical terminals.
- Always perform regular inspections and maintenance on mounts and related hardware.





# Installation Instructions

## Vengeance Front Sensor Bumper

Product Number: V3151, V3152

Application: 2015+ GMC HD

### I. Overview

Congratulations on your new purchase of the industries' best and most stylish front bumper available for the 2015 GMC HD. This bumper has been designed to be lightweight and easily customized with the industry's highest quality accessories.

Your front bumper designed in 3-D from digitized data, CNC laser cut, fabricated, and powder coated... all in the U.S.A.

Enjoy the fit and finish of a quality Vengeance GMC HD Front Bumper from Fab Fours Inc.





# Installation Instructions

## Vengeance Front Sensor Bumper

Product Number: V3151, V3152

Application: 2015+ GMC HD

### Parts List

- V315X Replacement Bumper
- Epoxy
- Instruction Manual

### Tools Required

- Socket Wrench with Extension (Ratcheting wrenches may also be convenient)
- 7mm, 10mm, 15mm, 18mm, 19mm, 3/4 Sockets and Box End Wrenches
- Flat head screw drivers
- Floor jack, jack stands, and/or a wood block.
- 9/16 drill bit w/ drill

## II. Removal of OEM Bumper

**Note: Save all OEM parts until installation is complete!**

- A. *Open hood and locate the twelve push pins on radiator cover. Using a flat head screw driver or similar tool, pull the head of the push pins up, remove push pin and lift radiator cover off. This will allow access to top grill bolts (Ref. Figure 1).***



Figure 1





# Installation Instructions

## Vengeance Front Sensor Bumper

Product Number: V3151, V3152

Application: 2015+ GMC HD

**B. Remove the fasteners connecting the grill to the frame with a 10mm socket. Four bolts are located at the top of the grill, two on each side (Ref. Figure 2a-b). There are multiple clips holding the grill to the vehicle.**



Figure 2a-bolts on LH side

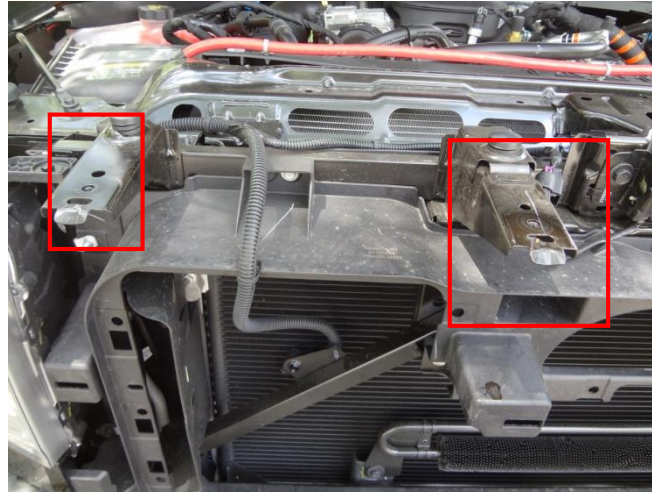

Figure 2b-grill removed-bolt locations RH



Figure 2c- example of clip holding grill





# Installation Instructions

## Vengeance Front Sensor Bumper

Product Number: V3151, V3152

Application: 2015+ GMC HD

**C. Disconnect electrical harness (Ref. Figure 3a) from vehicle and remove tow hooks. Tow hooks are mounted with one cross bolt through the side and a bolt through the bottom of the frame (Ref. Figure 3b).**



Figure 3a (TOW HOOK & OEM MOUNTING BRACKET)

**D. Remove bolts connecting bumper to mounting bracket (Ref. Figure 3a circles). There are two bolts on each side which require a socket wrench with an extension to easily reach from top and bottom. (Ref. Figure 3a-b). Carefully pull bumper away from vehicle.**





# Installation Instructions

## Vengeance Front Sensor Bumper

Product Number: V3151, V3152

Application: 2015+ GMC HD



Figure 3b (BOLT ACCESS FOR TOP BOLT ON MOUNTING BRACKET)

**E. Remove the fasteners connecting the OEM mounting bracket to the frame. Using a socket/wrench remove four bolts from the front of bracket connected to the bumper. Repeat process on each side of vehicle.**

**F. Remove OEM electrical harness from bumper. Disconnect harness from fog lights and sensors. Pop out the three plastic clips holding fog lights to fog light housing and carefully pull away. The plastic clips are indicated by a circle. Unbolt bumper support frames as necessary to more easily access sensors (Ref. Figure 6).**



Figure 6





# Installation Instructions

## Vengeance Front Sensor Bumper

Product Number: V3151, V3152

Application: 2015+ GMC HD

**NOTE: PARKING SENSORS ARE EXTREMELY DELICATE AND MUST BE HANDLED WITH CARE! Do NOT touch or shift the clear rubber grommet that surrounds the sensor face.**

**G. Remove OEM electrical harness from bumper. Disconnect harnesses from fog lights and sensors. Sensors can be disconnected from housing by depressing the plastic clip indicated by the red square (ref. Figure 8a).**

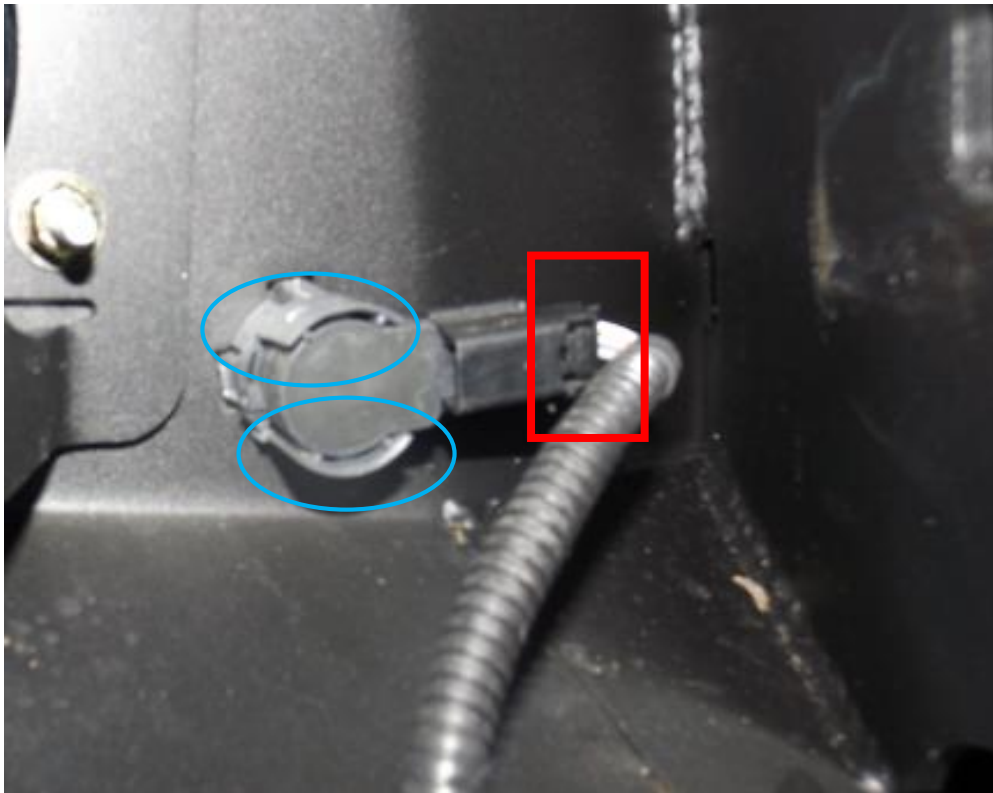

Figure 8

**H. CAREFULLY remove sensors from plastic housing by gently pulling the top and bottom tabs, indicated by blue circles (Ref. Figure 8a), away as sensor is pulled out. Do not push on front of sensor as this will damage the membrane. Place sensors face up in a safe location.**

**I. Remove plastic housing from OEM bumper by depressing the four plastic tabs around the inside and pushing housing out. All sensor housings will have to be placed into the Fab Fours bumper in the same location as they were removed from OEM bumper. (e.g.**





# Installation Instructions

## Vengeance Front Sensor Bumper

Product Number: V3151, V3152

Application: 2015+ GMC HD

*Outer right sensor clip must go into the outer right sensor hole in the Fab Fours bumper.)*

### III. Pre-Installation

**NOTE: PLEASE READ THE ENTIRE MANUAL BEFORE ATTEMPTING INSTALLATION!**

*Ignoring these steps will increase your probability of scratching the vehicle during product installation.*

**A. Remove the bumper from the shipping carton. Lay all items out on a blanket to prevent damage to the powder coating.**

**B. For sensor installation run sensor harness through the mounting brackets and across the light bar mount. Use the following images for the recommended orientation.**



Figure 9a (OVERALL SENSOR HARNESS ROUTING)







# Installation Instructions

## Vengeance Front Sensor Bumper

Product Number: V3151, V3152

Application: 2015+ GMC HD



Figure 9b (DRIVER SIDE SENSORS)

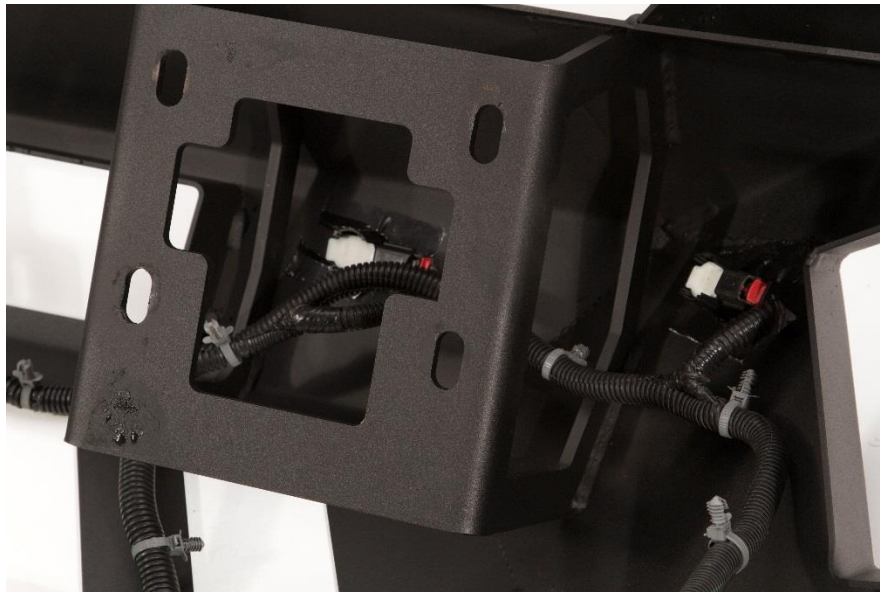

Figure 9c (PASSENGER SIDE SENSORS)

***C. After assuring sensors work in current orientation (after installation), epoxy should be applied to the housing on inside of bumper and allowed to dry. Epoxy may not need to be applied to inner sensors if clip is holding firmly, though it is recommended. At this time reconnect sensor harness to sensors and insert sensors into sensor housings making sure that the clear plastic grommet is on properly and sensors appear centered. Final installation of***





# Installation Instructions

## Vengeance Front Sensor Bumper

Product Number: V3151, V3152

Application: 2015+ GMC HD

*sensors on driver side should appear as shown above. (Ref. Figures 9a-c)*

### IV. Front Bumper Installation

- A. Mount the bumper to the truck. With the help of at least two others, and possibly a floor jack, to support the center of the bumper, lift the Fab Fours bumper into place.***
- B. Insert the stock 15mm bolts back into the flanges on the front of the frame. These bolts can be accessed through the cutouts on the bottom of your bumper.***
- C. Align the bumper top to bottom to ensure a perfect fit to the truck. Allow clearance to all painted surfaces, this is to allow for frame flex.***
- D. Fully tighten all fasteners between bumper and the truck.***
- E. Refer to Appendix A if a sensor warning or fault appears when starting the vehicle.***
- F. Enjoy your New Front Replacement Bumper from Fab Fours!***





# Installation Instructions

## Vengeance Front Sensor Bumper

Product Number: V3151, V3152

Application: 2015+ GMC HD

### V. Maintenance/Care

- Periodically check and tighten all fasteners.
- Stripped, fractured, or bent bolts or nuts need to be replaced.
- After washing of the vehicle make sure to fully dry all surfaces

### Contact Information

Fab Fours Inc.  
1312 Camp Creek Rd  
Lancaster, SC 29720

Phone (866)-385-1905  
Fax (866)-574-1424  
Email [Support@fabfours.com](mailto:Support@fabfours.com)



**More than expected... Better than expected.**





# Installation Instructions

## Vengeance Front Sensor Bumper

Product Number: V3151, V3152

Application: 2015+ GMC HD

### APPENDIX A. Troubleshooting Vehicle Sensors

- Start with a general inspection of the sensor fitment. Check that both the sensors and the sensor clips are fully secure and the sensors are properly centered in the housing.
- Confirm plastic housing is in the correct mounting holes. Misplaced sensor housings could compress sensor and give false readings or faults.
- Use a clean microfiber to wipe the front face of the sensor.
- Inspect connection. Be sure that the sensor is firmly seated into the harness.
- Run through several start cycles (i.e. fully turn the vehicle on and off).
- Finally, disconnect the battery to reset the sensors.

