

# INSTALLATION SHEET

## SOLID FOLD 2.0 Tool Box

**extang**  
AMERICA'S BEST  
SELLING TONNEAUS

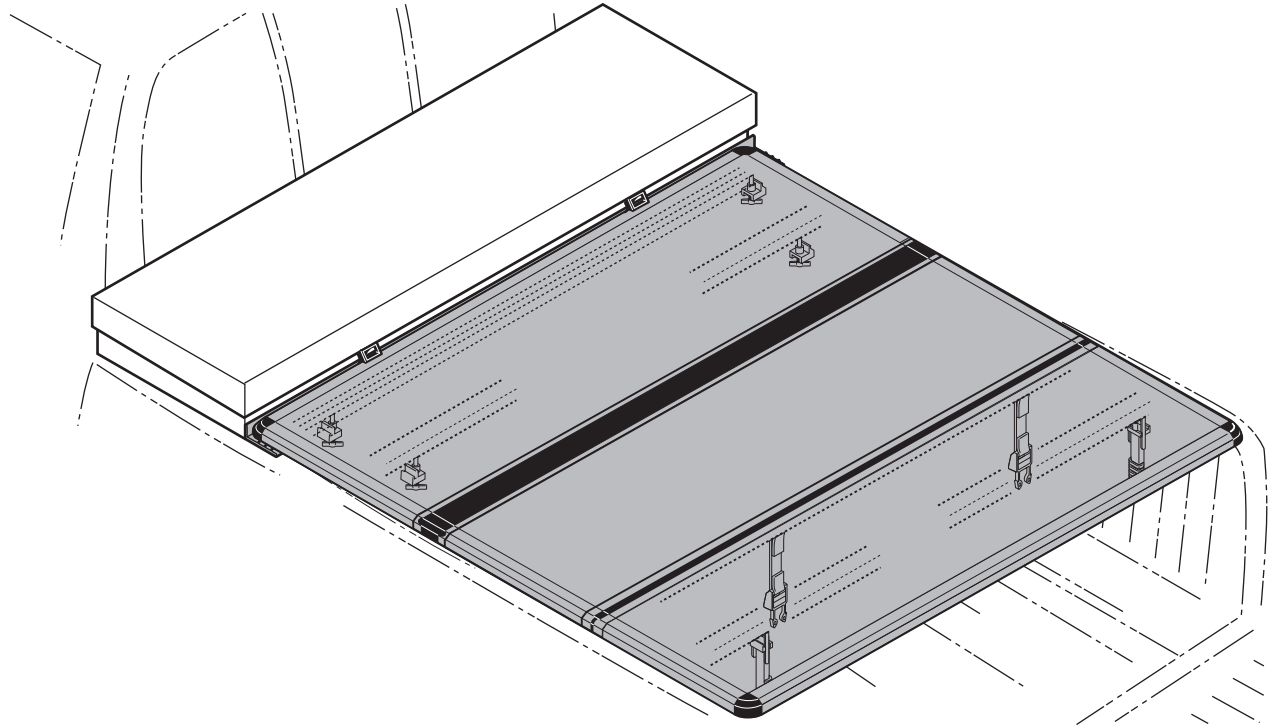

**1**



Wash truck bed.

**2**

Place L-channel against tool box with foam seal between the bottom of the L-channel and truck bed.

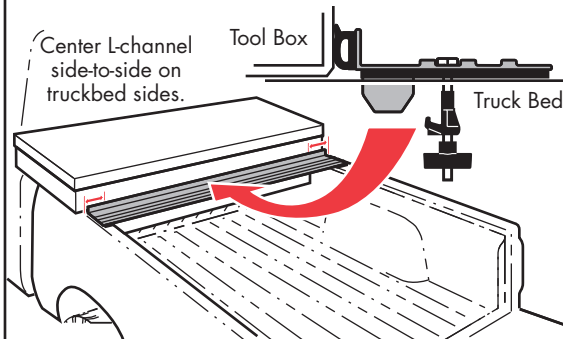

**3**

Ensure clamp is positioned under bed wall flange. Hand tighten until clamp contacts, then tighten an additional two turns.

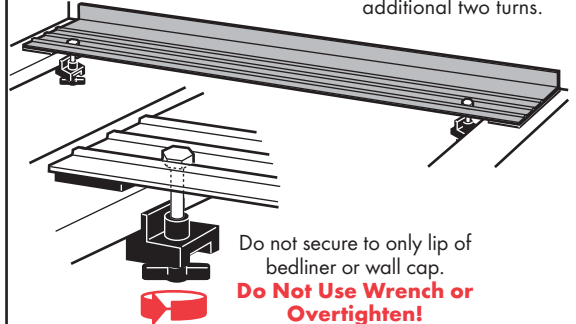

**4**

Place assembled cover front rail on top of L-channel.

Center Solid Fold 2.0™ side to side against tool box. Unfold the cover fully and adjust position over the truck bed for proper cab/tail alignment.

Carefully refold the cover without shifting its position on the truck bed.

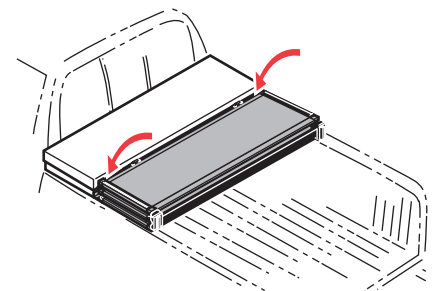
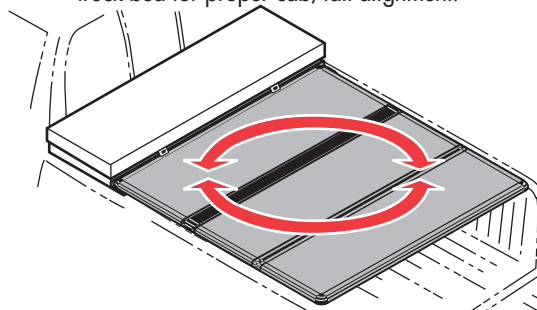
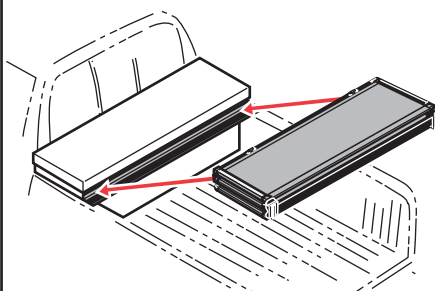

Tonneau Covers

4



If your truck has a bed cap or bedliner that covers the metal bed wall flange, you will need to remove enough so that all the clamps make solid contact.

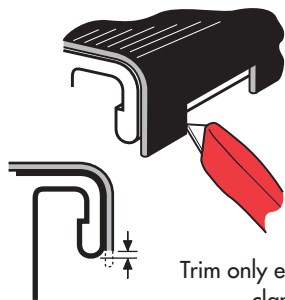

Trim only enough of the bed cap edge or liner wall so clamp contacts bottom of metal flange.

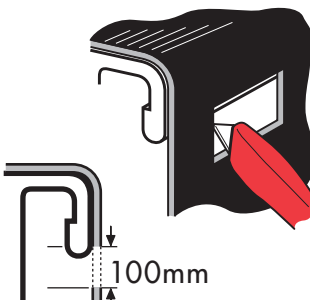
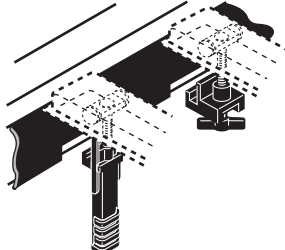

100mm

5

Ensure clamp is positioned under bed wall flange. Hand tighten until clamp contacts, tighten an additional two turns.



Do not secure to only lip of bedliner or wall cap.  
**Do Not Use Wrench or Overtighten!**

6

With tailgate open and front clamps secure, completely close the cover.

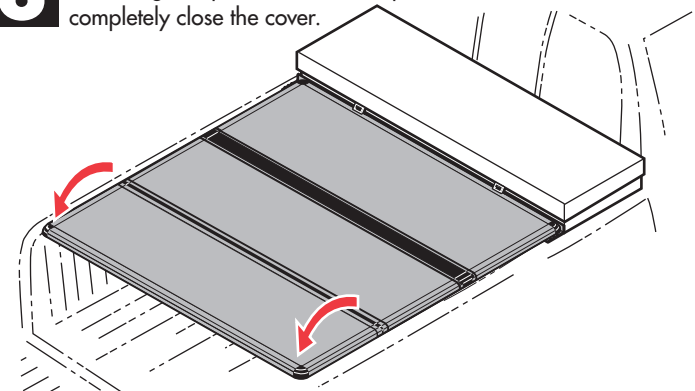

7

Slide rear clamp out to the bed wall.

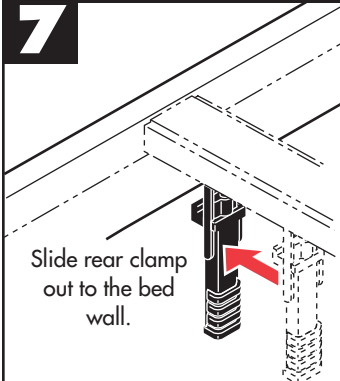

Pull rear clamp down and hook under bottom edge of bed wall flange.

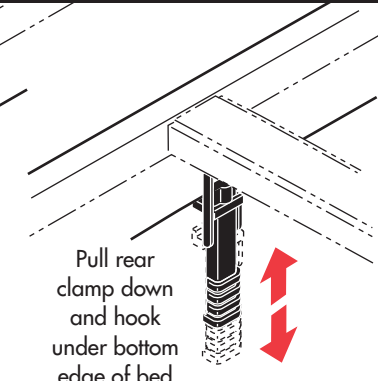

8

It is convenient to drive with the SOLID FOLD cover open. Release the rear clamps and fold the cover forward.

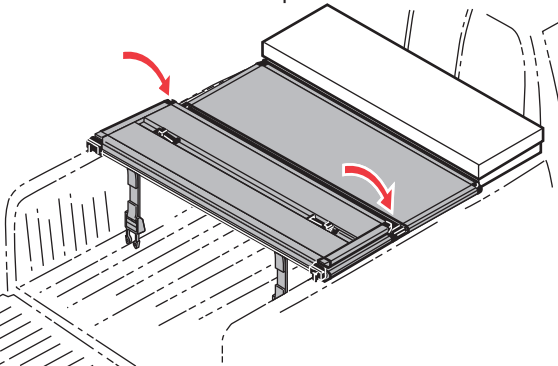

Fold the cover forward and fasten BOTH straps in the middle section to the front rail.

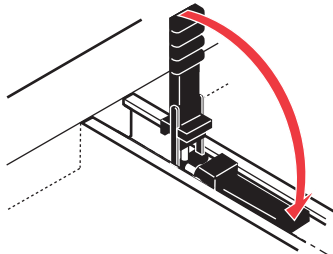

**IMPORTANT:** Before folding the second section of the cover, rear clamps must be stowed securely into rail.

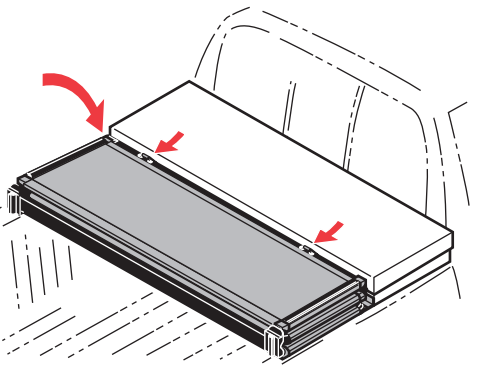

❄️ Remove any snow or foreign matter before folding cover. 🧤

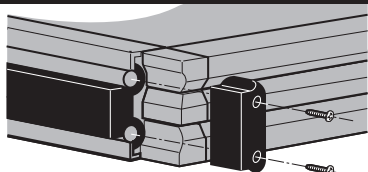

To remove foreign matter from panel hinges, remove one end cap and slide panels apart. Reassemble after cleaning.

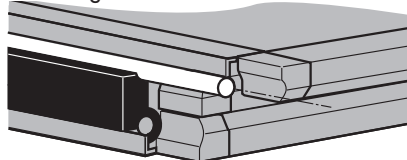

## IMPORTANT NOTICE

While driving, cover must be completely flat and secure with all four clamps in the closed position or completely folded up (all panels) and secured at the cab. **DO NOT DRIVE** with cover in partially opened position.

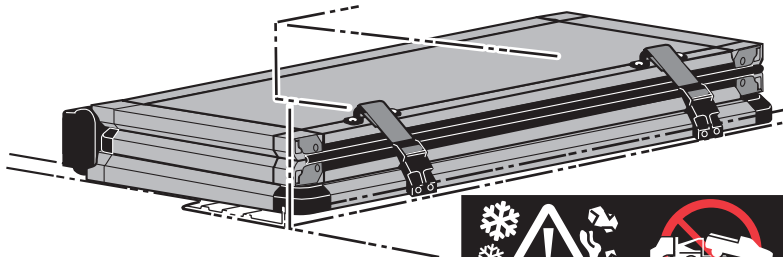

# SOLID FOLD 2.0 Tool Box

## Special Instructions for Alternative Brackets

SUPPLEMENT to INSTALLATION INSTRUCTIONS

### Dodge Dakota 08-11

**CAB CLAMP**  
Add clamp plate as shown here

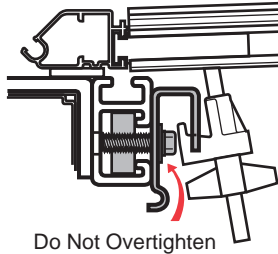

Do Not Overtighten

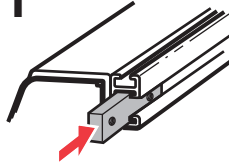

Add clamp plate as shown here

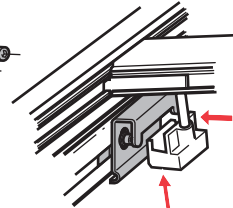
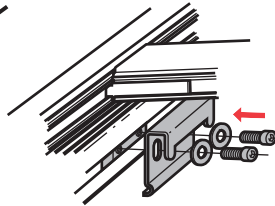

**TAILGATE CLAMP**

Hook clamp directly into factory rail

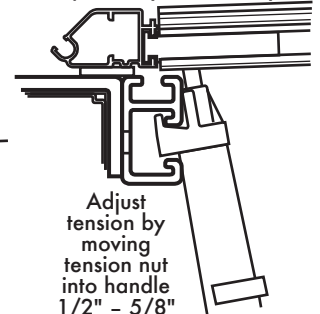

Adjust tension by moving tension nut into handle 1/2" - 5/8"

### Nissan Frontier 2005-

**CAB CLAMP**

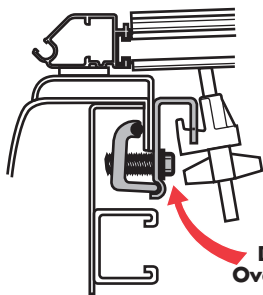

Do Not Overtighten

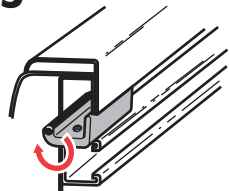

Add clamp plate as shown here

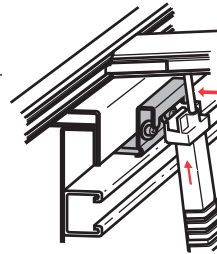
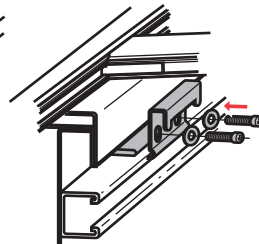

**TAILGATE CLAMP**

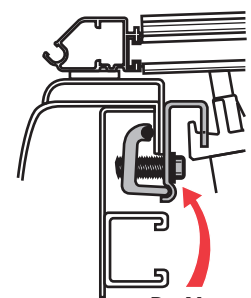

Do Not Overtighten

### Chevy Silverado/GMC Sierra 2007+, Chevy Colorado/GMC Canyon 2015+

Lower nut plate into stake pocket (rubber surface toward the interior of truck bed) with pliers.

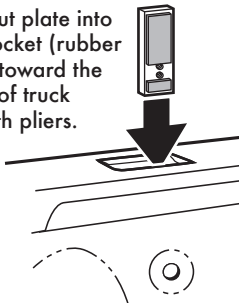

**Note: A bed liner will require trimming to access hole in bed.**

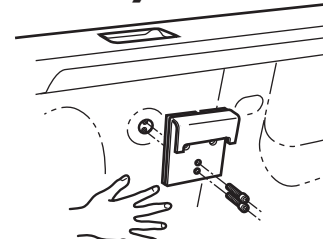
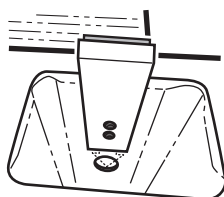

Align bracket to hole in bed sheet metal and screw through bracket and bed hole to the nut plate. Hand tighten.

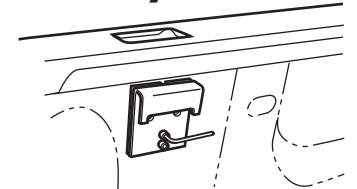

Align bracket with tonno spring latch and secure bracket to truck bed.

### All other Cargo Management equipped trucks

**CAB CLAMP**

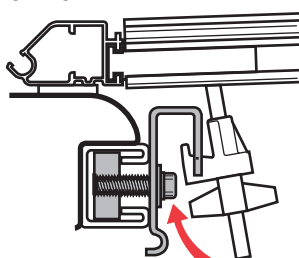

Do Not Overtighten

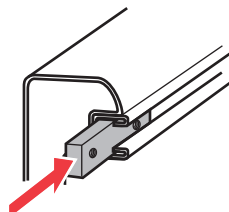

Add clamp plate as shown here

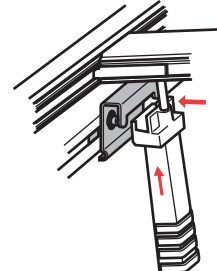
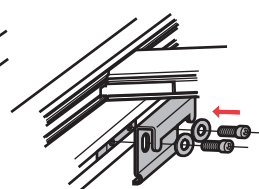

**TAILGATE CLAMP**

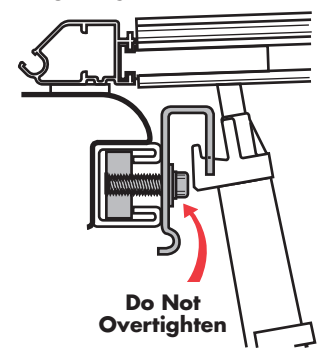

Do Not Overtighten

# SOLID FOLD 2.0 Tool Box

## Replacement Parts

