

# INSTALLATION SHEET

## TRIFECTA 2.0

**extang**  
truck bed covers

The Trifecta 2.0 truck bed cover comes fully assembled.  
Note any damaged or missing components before installing.

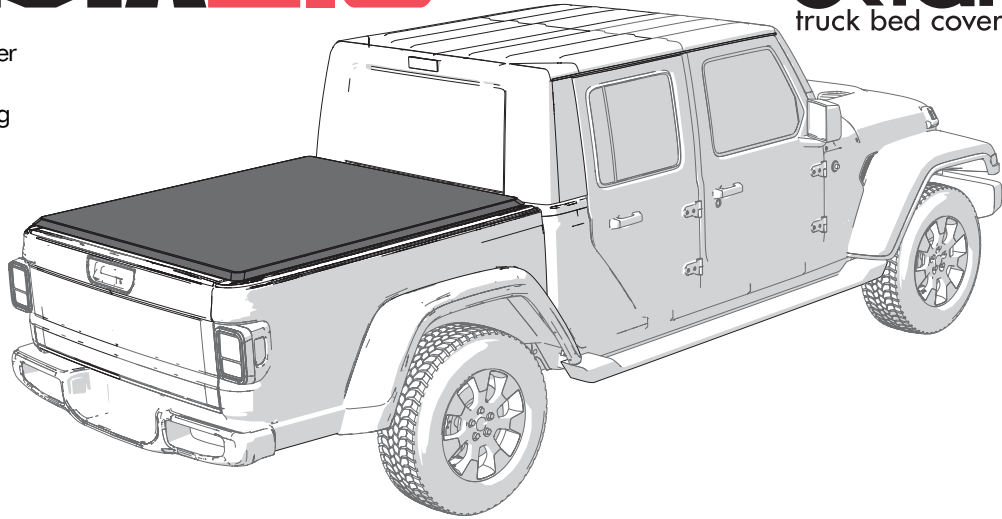

**1** It is important that all areas where the bed cover mounts are clean and free of debris prior to installing.

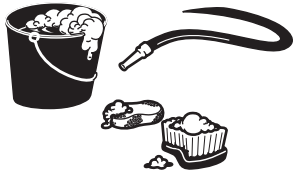

**2** If the bed rail caps are not trimmed in the rear/tailgate section, cut using the scribed lines to expose the area shown.

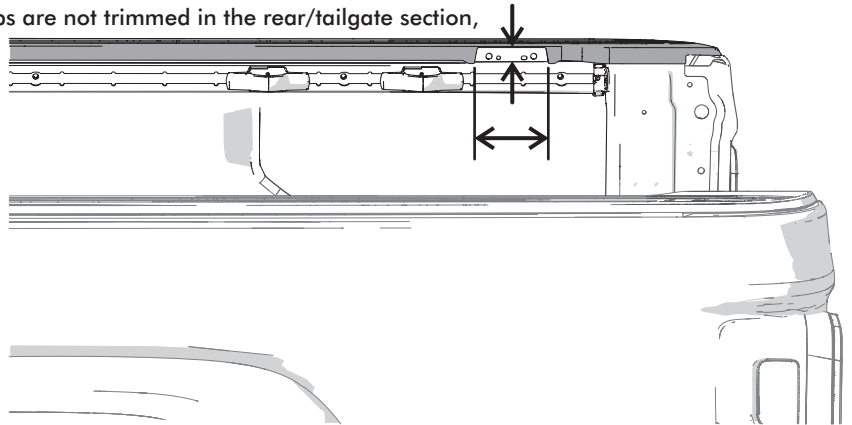

**3** Front/ Cab Brackets, insert the cab bracket screw (1) through the cab bracket washer (2) then through the upper hole of the cab bracket (3). Slide a second washer (2) on the screw on the backside of the bracket and thread into the well nut (4).

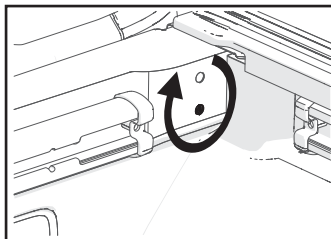

**NOTE:**  
For vehicles with a sprayed on bed liner, the threaded area in the bulkhead must be cleared of liner material.

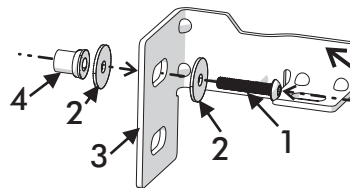

**Note:**  
Assemble the screw, washers and well nut just until contact is made, do not tighten the well nut.

Use the well nut as a guide to insert the cab bracket into the bulkhead wall. Thread the cab bracket bolt (5) through the bracket and into the bulkhead. Snug the well nut, tighten the bolt to **17.5 N-m (155 in-lb)**.

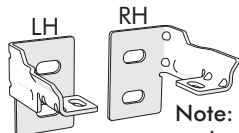

**Note:** There is a RH (passenger) side bracket and a LH (driver) side bracket.

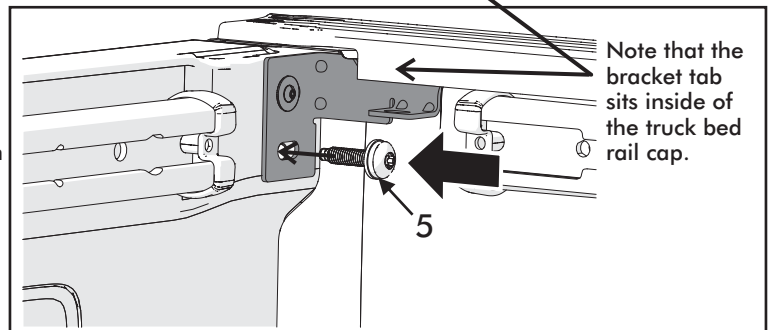

**4** Rear/tailgate Brackets. Attach the rear/tailgate brackets (7) to the bed rail through the bed rail holes using the rear bracket bolts (8). Tighten to **8 N-m (71 in-lb)**.

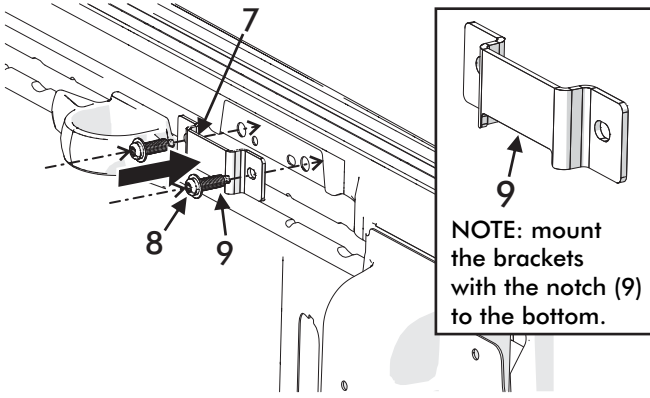

**5** Prior to placing the cover, remove both front clamp knobs.

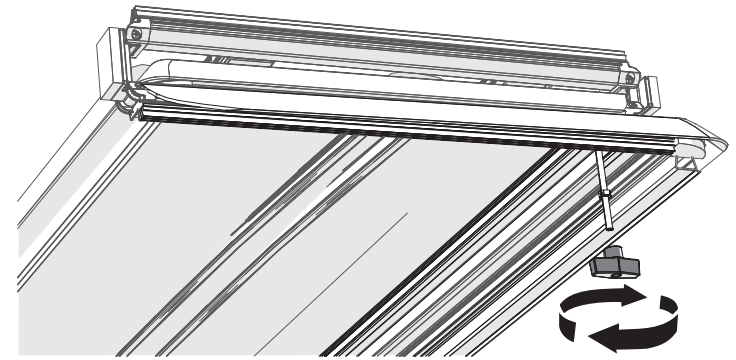

**6** Place the cover onto the truck bulkhead and bed rails, making sure to slide the cab clamp threaded rods (2) through the cab clamp brackets (3). Align both sides.

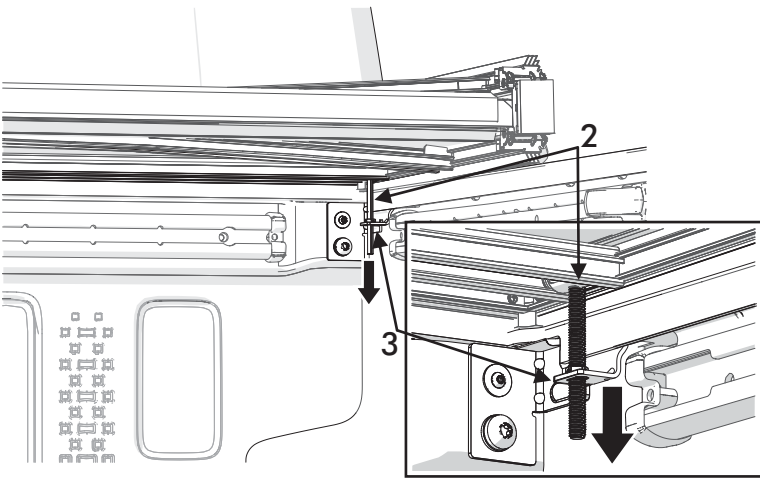

**7** Thread the cab clamp knobs back onto the threaded rods. **Do Not use a wrench or over-tighten.** Securely tighten both sides.

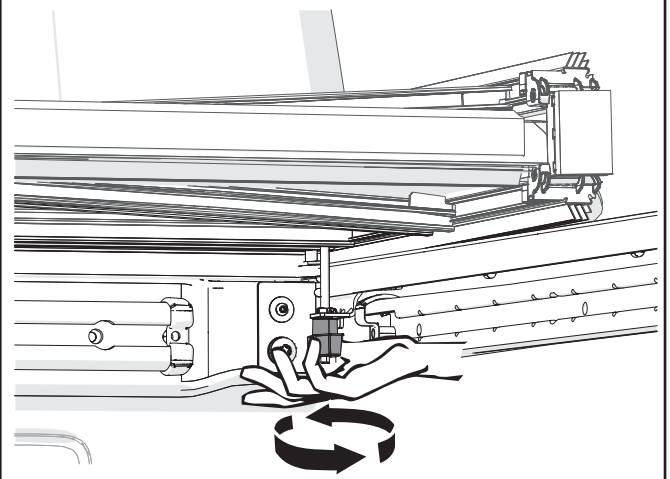

**8** Close the tailgate and unfold the cover. Check that the cover is parallel and square with the truck bed and bed rails. If not parallel or square, open the cover and loosen the cab clamps to reposition the cover.

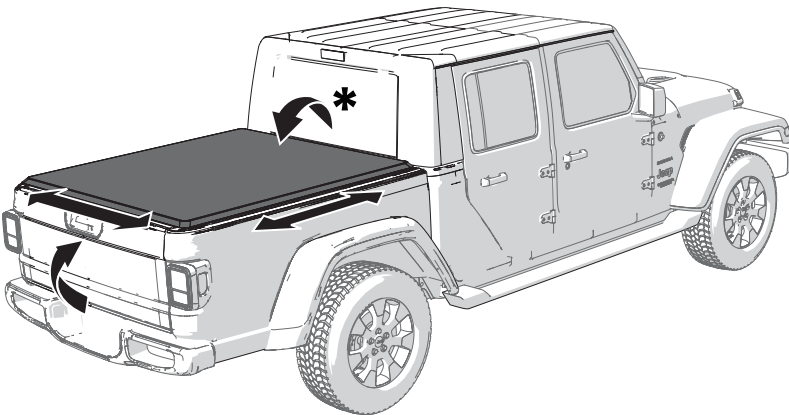

**\* NOTE: When opening the cover, be sure to stow the tail clamps into the cover bow to prevent damage to the tarp when folded.**

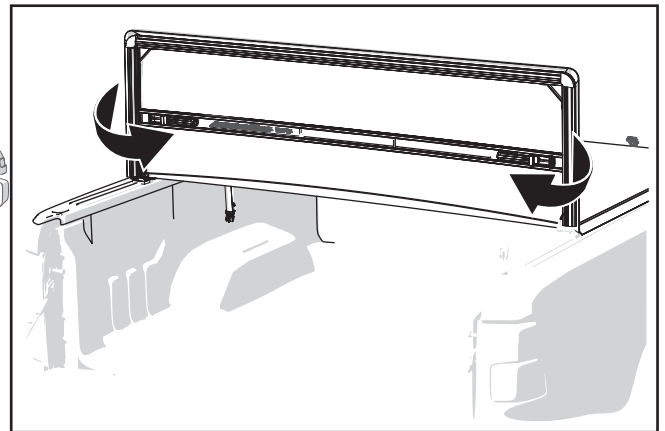

**9** Open the tailgate, swing the tail clamps down from the stowed position and slide them toward the truck bed rail. Swing the the clamps and pull down so the clamp jaw is tucked under the rear truck bed rail bracket.

**NOTE:** the clamp jaw fits up into the bracket notch.

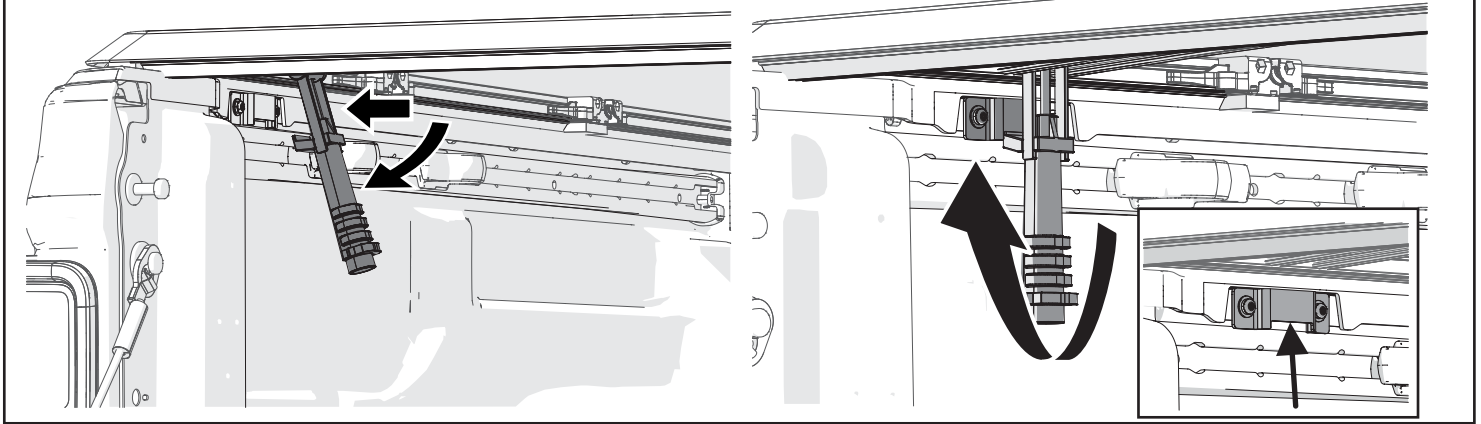

### DRIVING WITH THE BED COVER

For driving with the cover open, both cab clamps must be secured, and both straps must be latched.



When driving with the cover closed, both cab clamps and both tail clamps must be secured.

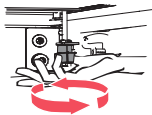
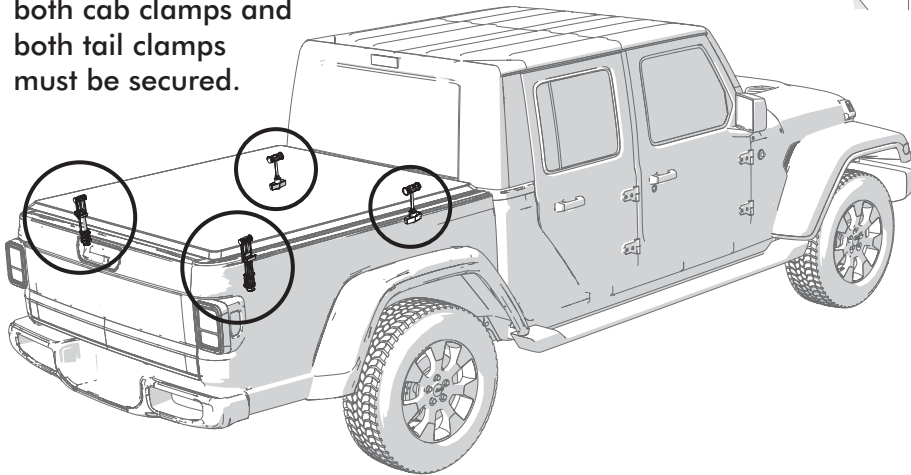

#### IMPORTANT

Re-tighten the front / cab clamps after the first week of driving the vehicle. Also periodically check the clamps to ensure they are secure.



Remove any snow or foreign matter before folding



#### IMPORTANT NOTICE

While driving, cover must be completely flat and secure with all four clamps in the closed position or completely folded up (all panels) and secured at the cab. **DO NOT DRIVE** with cover in partially opened position.

**Do NOT tow your vehicle from the rear with any Extang bed cover on your truck**



NOTE: To order replacement parts, it's best to contact our Customer Service Department for assistance, to ensure getting the correct part for your vehicle application. When ordering, xxx represents the 3-digit suffix, as referenced on the sales receipt or vehicle application list.

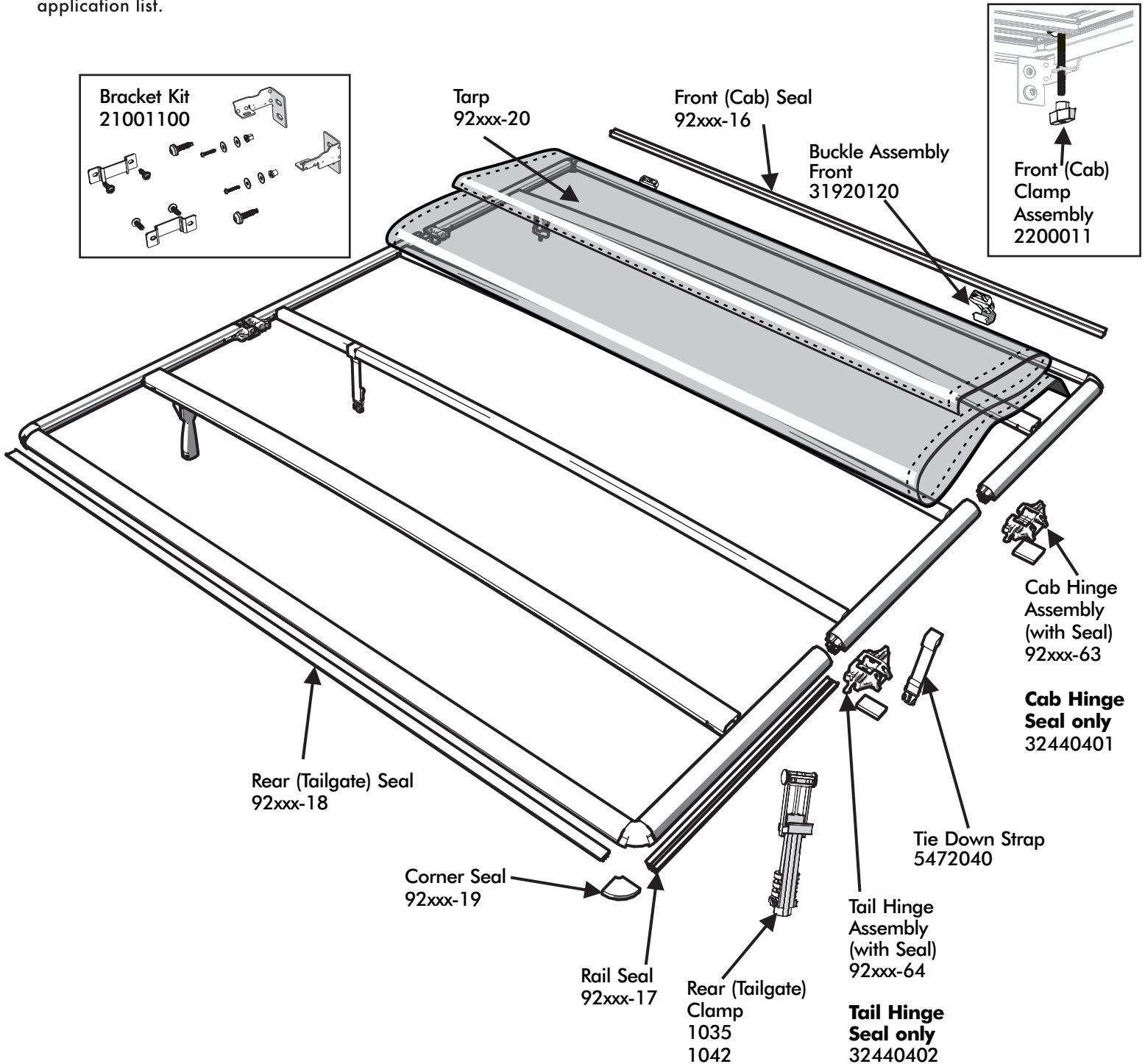

Specify: Year, Make, Model, bed length, Driver or Passenger side.  
Call Customer Service if frame or bow sections are required.