

Installation Instructions

For set # 8.3121

03-04 Toyota Corolla / Matrix
Rear axle beam bushing

ENERGY
SUSPENSION

It is recommended that if you are unfamiliar with this type of work that you refer to a qualified service center specializing in this type of work. It is also recommended that if you choose to do this work yourself that a factory service manual be obtained for the proper procedures pertaining to removal, replacement and proper torque specifications for your vehicle. This instruction set is intended as a guideline for the safe installation of Energy Suspension's polyurethane bushings, once you have removed the factory components from your vehicle.

Parts list:

- 2 - 3455 (inner bushing).
- 2 - 3454 (inner support bushing).
- 2 - 3453 (outer bushing).
- 2 - 15.10.465.39
(sleeve .875"O.D. x .563" I.D. x 3.750" LG).
- 4 - 9.11108 (grease).
- 1 - 17451 (this instruction sheet).

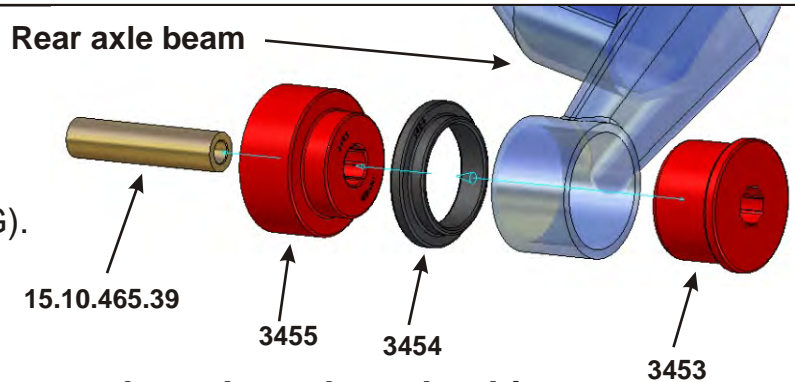

Apply grease to all metal parts that contact the polyurethane bushings.

Puller Setup

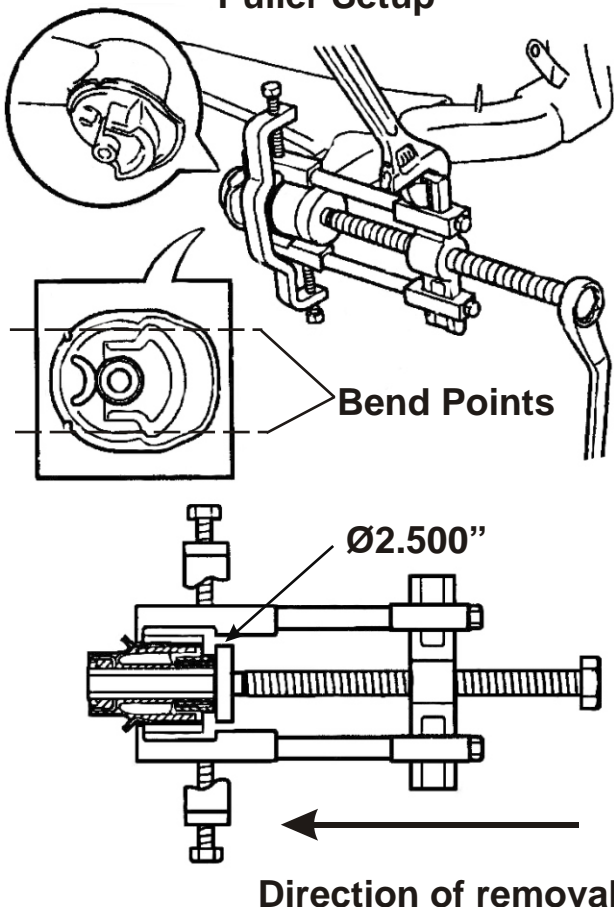

REMOVAL OF REAR AXLE CARRIER BUSHINGS:

Using a chisel and a hammer, bend the 2 portions of the bushing rib until the claws of a puller set can be hung. The I.D. of the axle beam is $\text{Ø}2.555$ ", use something with a O.D. of $\text{Ø}2.500$ " to push out the bushing.

CUTAWAY VIEW

Energy Suspension
Polyurethane bushings
installed.

